

9 June 2005

Dear Mr. Upchurch,

With great sadness I inform you that my husband Willis passed away on February 23rd, 2004. He had lung cancer.

He always enjoyed reading the Upchurch Bulletin and appreciated your work, though in recent years he was developing other interests besides genealogy. I will retain (and organize to the best of my ability)

his files, in the hope that someone in a younger generation of Reids will take up this activity.

Sincerely yours,

Jan Reid

P.S. I have donated his series of the Upchurch Files to a local historical society.

JANET W REID
1100 CHEROKEE CT
MARTINSVILLE, VA 24112

WSP-105-
6-12-05-

REC'D
13 JUN 2005

Mabry Mill

Built in 1910 — Blue Ridge Parkway, Virginia

Ed Mabry built this rustic grist mill near Meadows of Dan on unusually flat land that lacked a stream strong enough to generate power for milling. So he and his wife Lizzie began buying land in order to gain the water rights. By 1914, they had purchased five small parcels and built an extensive flume system. A small dam stored the runoff from rains and spring thaws.

The Mabrys operated two sets of stones, one for grinding cornmeal and the other for a grain mixture fed to livestock. Although the mill was smaller than most, Mabry was able to gain many loyal customers. Many of them also were drawn by the blacksmith shop, sawmill and carpentry shop he operated. Throughout his life, Ed Mabry was known as a talented handyman. "Carry it on to Ed" was common advice when repairs of any kind were required.

After he died in 1936, his wife operated the mill for a while on her own. When designing the Parkway in the 1930s and '40s, landscape architects quickly chose Mabry Mill as one of the special scenic places to be preserved. Although the mill remains operational, it grinds meal only occasionally. Just as it did when the Mabrys ran it, the mill remains a focal point of the community and a gathering place for neighbors.

Printed in Virginia on Acid-Free Recycled Paper 

WOLF RUN STUDIO

Clifton, VA 20124-0444 / (703) 250-6711 / www.wolfrunstudio.com

© 2000 Drawing by Bill Harrah, Text by Terry White

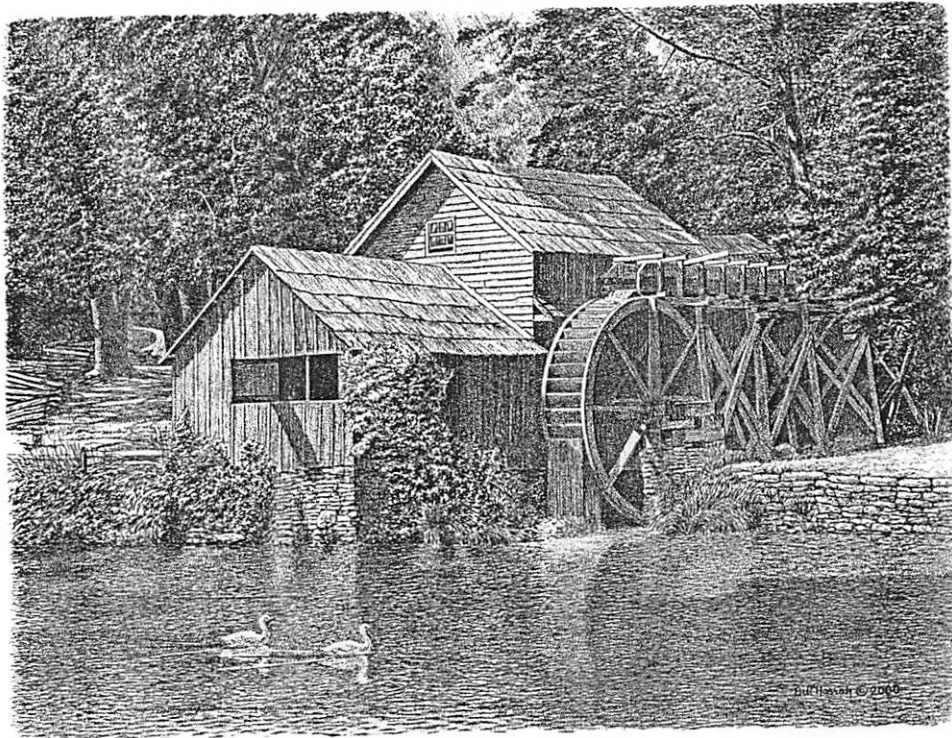

2 -
an Organic Chemist but my knowledge of this field served me well over a lifetime.

My second association with Prof Reid was when I joined the N.C. State Faculty as an Assistant Professor of Agronomy in 1953. As a junior member of the faculty I was treated with respect by Prof Reid. This helped me to grow as a professional.

Only much later, in corresponding with your husband, did I learn that Prof Reid was an avid fisherman. Willie said his father was well acquainted with every fishing hole in Wake Co, NC.

The above illustrates that there are many threads running through life. It is up to us to pull on these threads and take joy in where they lead us. I trust that you find you engaged in life and pulling on some of the threads of life.

With Appreciation and Respect.

P.S. Thanks for giving the U.P. paper to the local Unitarian Society P.U.

Sincerely yours



Phil Upchurch

[ROBERT PHILLIP UPCHURCH]

WILLIS ALTON REID, JR

① On 3 JUN 2004 RPH & SSU in the Genealogy Section of the N. C. State Archives noted under "13" in the Family History Shelves "A partial History of the Family of Thomas Yates Baker" compiled by Willis A. Reid, Jr Christmas 1969 - Hist 95 Page. As of 17 JUN 2004 it appears I do not have a copy of that book.

heritage in the Neuse River Basin of Northern Wake Co, NC. However, the NAIL-RAY book does not touch upon the Neuse River RAY's but deals with the Moccasin Creek Area RAY's. Other information tells me that the two RAY groups probably trace to a common RAY ancestor in the 1650-1750 era.

Evenso, the NAIL-RAY book is instructive re our Moccasin Creek interests as it shows these RAY's & the Uplandur were close neighbors in the 1750-1800 era on Moccasin Creek. Several Uplandur names are mentioned in the book. They even show land ownership of their RAY ancestors on Moccasin Creek about 1/2-1 mile upstream from where I have mapped Uplandur holdings & published in the UM a map of same.

I am in the very early stages of extracting the book an establishing relations with current members of the RAY NAIL association in IN. If you have any Ray interests, please let me know.

From past correspondence I know that you had some medical problems. I trust these matters are under control as that you

are active and enjoying life. Gallant and I are in great health except for one minor inconvenience. I have 6 more weeks to go in a 4-months healing process on a broken leg. I should be able to walk on 1 FEB 2003 - on Nelly Day.

It is hard to write you without mentioning once again the high regard I have for your late father Alton Reid. He was a kind, gentle teacher and I looked up to him in the 1940's as a student and in the 1950's when I was a young faculty member at N.C. State.

Wishing for you and yours a Merry Christmas and a great 2003

Sincerely yours



Phil Upchurch

{ROBERT PHILIP UPCHURCH}

is supposed to give us more free time. We will have to see how that works out. Projects seem to appear out of nowhere to fill any spare time.

My basic plan is now to spend more time on the Upchurch of NC. To this end I would like to spend several 2-week periods in Wake Co, NC over the next year or so. The first of these is planned for the first half of 2001 with strong hopes we can make it happen.

It would be a pleasure to hear from you as your time permits. If there are special issues I need to address, please let me know.

With best wishes for a blessed Christmas.

Sincerely yours
 Phil Upchurch
 {ROBERT PHILIP UPCHURCH}

WILLIS ALTON REID, JR

XFD-21981

Robert P. Upchurch
MICHAEL ENTERPRISES
6 Eagles Way Lane
Lake St. Louis, MO 63367-2240



15 DEC 1998

WILLIS A. REID, JR
6210 HOLLINS DRIVE
BETHESDA, MD 20817

Dear Cousin Willis,

Thank you for your subscription for the
U^B and Englandia for 1999 and for your order
for ~~the~~ back issue of Englandia. The back
issue should have reached you by now. You
can see that Professor Ransome is a key to
~~the~~ progress we are making on our English
Upchurch roots. I have already engaged him
for activities in 1999. He travels to England
each year for his own historical research
and he just fits us in. At about \$1500/year
it is expensive for our little Upchurch budget
but really cheap compared to what one might
pay for such service. I like the deal whereby
he has taken a personal interest in helping
us as opposed to what the normal hired
researcher might do.

Thanks also for sending the outvance for your parents. I had ~~the~~ one for your mother but not for your father. Rereading them brought back fond memories of the interactions I had with your father at N.C. State. The reference in your mother's outvance to Professor B. W. Miller also struck a cord. I had two courses under him and found him to be a fascinating personality. How I would have enjoyed discussing him with your mother.

Miller, I know we have overlapping family history interests and especially on the Wake Co / Franklin Co Border. I am constantly reworking my master outline and adding new reference materials to my very extensive files. If there is any special way in which we could help each other I would be more than happy to collaborate. There is so much to do and so many directions - one simply stays very busy - and often in a productive way.

Merry Christmas! ☺ Sincerely yours
Phil Upchurch

{ROBERT PHILIP UPCHURCH}

WILLIS A. REID, JR., Ph.D.

Home and Business Address:
6210 Hollins Drive
Bethesda, Maryland, U.S.A., 20817

Voice Phone: (301) 897-9625
FAX Phone: (301) 493-4169
e-mail: 74024.1511@compuserve.com

December 7, 1996

REC'D 12 DEC 1996

* COPIES MADE FOR BIFILES OF:

R.P. Upchurch
President, CEO and Chief Bottle Washer
Michael Enterprises
P.O. Box 387
Wentzville, MO 63385

- Δ FRANCES U
- Δ FRANCES GAY
- Δ THOMAS GAY
- Δ JUBAL U
- Δ BLAKE BAKER
- Δ WILLIFORD U

Dear Cousin Phil:

I really did receive your letter regarding Fannie GAY Wootton's speculation that Frances UPCHURCH was actually the daughter of a GAY/widow of an UPCHURCH rather than the daughter of Jubal UPCHURCH. You will recall that you asked my opinion of this. Mrs. Wootton's claim probably has merit. Although it is not prima facie evidence for the relationship, it is basically founded on two primary sources:

(1) the Franklin County Marriage bond of Williford UPCHURCH to Frances GAY (19 December 1820).

(2) the Franklin County will of Thomas GAY (written 2 February 1837), which names his daughter Frances BAKER, ~~and~~

However, Mrs. Wootton asserts that the Frances GAY of the marriage bond was the daughter of Thomas and Agnes GAY. What evidence does she have for this, i.e. that the Frances GAY of the 1820 marriage is indeed the same person as the Frances BAKER daughter/heir of Thomas GAY in 1837? She also states that the Frances GAY of the 1820 marriage bond "would have made her about 15 years old when she got married." Although 15 years is a reasonable marriageable age for a girl, I know of no evidence that this particular Frances [GAY][UPCHURCH][BAKER] was born around 1805. I estimated that Blake BAKER's wife Frances was born about 1800, but this was based on census records of age ranges of white females in the household. Neither of these gaps, however, detract from the importance and significance of two primary sources.

On the other hand, my speculation that Frances UPCHURCH was the daughter of Jubal UPCHURCH is just as shaky, if not less so. I am enclosing a copy of my 1989 letter to you, rather than repeat my arguments at the time. My argument, however, is at a disadvantage - it is not based on any primary source documents, only assumptions and unusual similarities (which may themselves have value here). On this basis, Mrs. Wootton's claims should probably have precedence. I would not make an out of hand dismissal of either.

You added some important information with the 1829 James UPCHURCH deed to Frances UPCHURCH. To me, the location of this property (in Wake County on the south side of Moccasin Creek) is most intriguing. I have detailed information on the disposition of Blake BAKER's property

in this area but no information as to how he acquired some of it in the first place. I know that he acquired 418 acres in an equity deed in 1856, but he had about 355 acres more for which there are no Wake County land records indicating that he ever acquired such property. I have been speculating that he acquired the property in 1829 as a dowry of his first wife, Frances UPCHURCH, though it now seems that she already owned the property at the time of her marriage to Blake BAKER. This is further evidence for Frances UPCHURCH nee GAY rather than nee UPCHURCH. All of Blake BAKER's real estate, by the way, was in Wake County, on the south side of Moccasin Creek.

This is beginning to look more and more like a staff study that I would have done 20 years ago in Command and General Staff College!

Sorry to be so late in responding. In my retirement, I'm working harder than I did when I was in uniform, only enjoying it more! But it has all been complicated by some rather serious medical problems. Four months after my mother passed away, I suffered a heart attack and underwent emergency by-pass surgery at the National Naval Medical Center. Four months into the recovery from that I developed recurrent melanoma and underwent surgery to remove all of the lymph nodes from my left axilla. There was evidence that the surgeons did not get there fast enough, so I had to get radiation therapy to the region. However, since the accepted treatment for this thing is to do nothing but wait for it to come back, I took a more aggressive approach and went hunting for some studies. Thanks to an old friend and former colleague from the Walter Reed Army Institute of Research, I am now on an experimental treatment protocol being managed out of Massachusetts General Hospital in Boston. So far, I'm one year out with no recurrence, but, believe me, one in this situation soon becomes a raving hypochondriac! Between cardiology at Navy Medical and oncology at Walter Reed, I'm wearing down a track between the 2 medical centers!

The good news is that Jan underwent successful neurosurgery for her trigeminal neuralgia and is reducing her medications significantly. Oldest son Blake graduated in physics from James Madison University and joined the Peace Corps. He's starting his third year in Zimbabwe. Youngest son Alex graduates (Mechanical Engineering) next week from McGill University in Montreal. He'll be returning home and job hunting.

Best Wishes,



P.S. I'm sending a copy of this, along with a printout of Blake BAKER's ancestors, to Mrs. Wootton. I note that she also asked about descendant of Richard Sandars BAKER

WILLIS ALTON REID, JR

XID-21981

WILLIS A. REID, JR., Ph.D.

Home and Business Address:
6210 Hollins Drive
Bethesda, Maryland, U.S.A., 20817

Voice Phone: (301) 897-9625
FAX Phone: (301) 493-4169
e-mail: 74024.1511@compuserve.com

7 December 1996

Mrs. Fannie M. Wootton
778 Selma Road
Wendell, NC 27591

COPY

Dear Mrs. Wootton:

Phil Upchurch referred your letter of September 4, 1996 to me for my opinion, since I was the one who originally proposed that Frances UPCHURCH was the daughter of Jubal UPCHURCH. Enclosed is a copy of my response to him and it speaks for itself; I won't repeat all of it here. I'm sure that Cousin Phil will be corresponding with you soon (hopefully without as much delay as I have done).

In that letter you also asked about the Richard S. BAKER's marriage. He was my great grandfather. He married Margaret ("Bettie") Baker (different BAKER family, but they were probably cousins if you go back far enough). She was the daughter of William J. BAKER (b. ca 1805, d. 23 March 1855; I don't have anything further on his ancestry) and Elizabeth HOPKINS (b. ca 1805, m. 21 November 1831, d. ?), who was the daughter of William HOPKINS (b. ?, d. ?) and Jane STRICKLAND (b. ?, m. ca 16 January 1801, d. ca 1859), who was the daughter of Mathew [sic] STRICKLAND (b. ?, d. ca 1829 in Franklin Co., NC) and Mary PERRY (b. ?, m. ca 5 January 1774 in Bute Co., NC, d. ?). The attached printout from my "Family Tree Maker" program gives you the descendents of Blake BAKER, Richard S. BAKER's father.

Sincerely,

Willis A. Reid, Jr.
Lieutenant Colonel (ret), U.S. Army

CF: R.P. Upchurch

WILLIS ALTON REID, JR

WILLIS A. REID, JR., PH.D.

6210 HOLLINS DRIVE

BETHESDA, MARYLAND 20817

Phone (301) 897-9625

XIN-21.981

11 February, 1989

Mr. R. P. Upchurch
c/o Michael Enterprises
P.O. Box 35804
Tucson, Arizona 85740

Dear Mr. Upchurch:

Your letter of 7 January, 1989 beat me to the draw. I had been informed of you and the Upchurch Bulletin last fall by our mutual cousin, Fritz McDuffie of Oak Ridge, TN, and have been meaning to write to you ever since. Before doing that, however, I felt obliged to spend a few weekends in the Library of Congress reviewing past issues of the Bulletin. I had not heard of this publication before, but found it fascinating reading. To be quite truthful, I have not spent very much time on the UPCHURCH side of my family until now. Most of my on-again, off-again researches have concentrated on the BAKER family. I was stimulated first by Fritz McDuffie, and then the Bulletin, to broaden my horizons to the UPCHURCH/PHILLIPS/RAY lines. In the process I have been developing family group sheets on various family members. Many of these have rather glaring holes and gaps in them so it will be some time before I can provide a complete set of data. The attached outlines are only those basic to my ancestry.

I (Willis Alton REID, Jr.) was born in Raleigh, NC (Rex Hospital to be exact) 15 Sep 1941. My parents are Willis Alton REID of Nash Co. (Whitakers/Red Oak area) and Mary Margaret (BAKER) REID of Wake Co. (Moccasin Creek area in Little River District). I attended Needham B. Broughton High School (Class of '59), North Carolina State College (B.S. in Zoology, 1963), the University of Kansas (M.A. in Zoology/Parasitology, 1965), and North Carolina State University (Ph.D. in Zoology/Parasitology, 1970). I entered active duty in the U.S. Army Medical Service Corps in 1965 and have now served 23 1/2 years of continuous commissioned service. I married Janet Lancaster WARNER (of Palm Beach, FL, but born in Boston, MA) 24 April 1966. She has a B.S. from Duke University (1966) and M.S. (1969) and Ph.D (1978) in Zoology from North Carolina State University. She was born 18 Oct 1944. We have two sons: Blake Dietrich REID, born 27 July 1971 in Rex Hospital, Raleigh, NC and Alexander Nathan REID, born 19 Sep 1974 at Walter Reed Army Hospital in Washington, DC. The names "Blake" and "Nathan" have family significance on my side of the family, as you will see below. My parents had only one other child, my sister Margaret ("Margie") Beatrice REID, born 21 July 1938 in Raleigh, NC. She is unmarried, and elementary school teacher in Raleigh, NC (Ravenscroft School).

My Great great grandfather was the Blake BAKER who married Frances UPCHURCH (Wake Co. marriage bond posted 16 Nov 1829). I would like to make a case for her being a "lost" daughter of Jubal UPCHURCH. In a 1986 issue of the Upchurch Bulletin [7(1):13-21] you stated that "there was another daughter of Jubal Upchurch, but her name has not been learned. We speculate that she married as a young woman and lived in the Franklin Co., NC area and had children." You go further, on page 21, to list her as "VI. Unknown daughter". According to rough calculations from the 1830 Franklin Co. census, Frances

UPCHURCH was born between 1800 and 1810 (this assumes that she was the free white female between 20 and 30 years old in the household of Blake BAKER). This age would put her in the same contemporary age group as the other children of Jubal UPCHURCH which you listed. In the 1840 Wake Co. Census, there were two females 30-40 years old in Blake BAKER's household. Secondly, I note that the "Unknown Daughter's" sister, Charlotte UPCHURCH, married a John SANDERS in 1833 and that in 1829 an Edwin SANDERS was the bondsman for the marriage bond of Blake BAKER and Frances UPCHURCH. They (Blake and Frances) named a son (my great grandfather) Richard Sanders BAKER. It is apparent that the SANDERS family was close to the BAKER and UPCHURCH families. Thirdly, the name "Richard" is not a common given name in the BAKER family; it is (as you well know) the basic given name in the UPCHURCH. It is likely that Frances UPCHURCH had a hand in naming her son for an UPCHURCH family member. I have been unable to find any other leads to the parentage of Frances UPCHURCH. The fact that the marriage bond was posted in Wake Co., instead of Franklin Co., is something of a sticking point, since there is no indication that the Jubal UPCHURCH family were ever Wake Co. residents. However, considering the back and forth movement of families in the Moccasin Creek area across the county line, I am becoming more inclined to treat the region almost as an independent jurisdiction in itself. The Blake BAKER-Frances UPCHURCH marriage was number 30 on your list of UPCHURCH marriages in the Upchurch Bulletin 4(4):149-151 (1983). For the moment, I am assuming that Frances UPCHURCH was the daughter of Jubal UPCHURCH. If you have more information on this, I would certainly appreciate it.

Frances (UPCHURCH) BAKER apparently died between 1840 and 1846, since she is not listed in the Blake BAKER household in 1850, and Blake BAKER remarried Margaret BUNN in 1846. Blake BAKER had a total of 12 children, but only 5 of them (the children of Frances UPCHURCH BAKER) are UPCHURCH descendants. Two of these (Richard Sanders BAKER and Thomas H. BAKER) were Confederate soldiers in Company K, 24th North Carolina Regiment. Thomas H. BAKER was wounded "gunshot with ilium fracture" at Sailors Creek, VA, captured, and later died at Fort McHenry Post Hospital (Baltimore, MD). Richard Sanders BAKER was wounded "miniball in the arm" at the Battle of Seven Pines, was captured at Petersburg late in the war, and was released at Fort Delaware. He enlisted as a 3rd Lieutenant and came home a Captain. I have his original commissioning paper when the unit was first formed as the "Poplar Spring Greys".

My grandmother's (Beatrice Gertrude PHILLIPS BAKER) side of the family is replete with UPCHURCHs. It was not until I started looking into this that I discovered that my grandmother and my grandfather (Thomas Yates BAKER) were actually third cousins (if the Frances UPCHURCH ancestry case mentioned above holds up). Her parents (William Nathan PHILLIPS and Mary Susan RAY) were also cousins. I will not go into complete narratives of each of these families as they are well outlined on the attached sheets. In short it appears that I am descended from Richard UPCHURCH (II) by three different lines: 1. via Frances UPCHURCH and Blake BAKER (if my postulate about Frances UPCHURCH's father holds water); 2. via Elizabeth Thany UPCHURCH and John PHILLIPS; 3. via Gilly UPCHURCH and James RAY. There may be a forth descendancy line if Susan PEARCE (the first wife of William Kearney PHILLIPS) is an UPCHURCH. I have seen this stated but have not seen any source of that information. Can you enlighten me any more on this?

Beatrice Gertrude PHILLIPS' mother was Mary Susan RAY, daughter of Albert Haywood RAY and Jacqueline Summerlin BRYANT, grand daughter of James RAY and Gilly UPCHURCH. I knew her as "Grandma Susan". She married William Nathan PHILLIPS when she was only 17 and they had 5 children (see attached sheet). I remember only one of these (other than my grandmother) - "Uncle

- △ 1 Blake BAKER b: Abt 1804 in Franklin Co., NC d: January 21, 1863 in Wake Co., NC
- △ +Frances UPCHURCH b: Abt 1800 m: Abt November 16, 1829 in Wake Co., NC d: Abt 1845
- 2 Thomas H. BAKER b: Abt 1831 d: May 21, 1865 in Fort McHenry Post Hospital, Baltimore, MD (POW)
- △ 2 Jasper BAKER b: Abt 1833 in Wake Co., NC d: Abt 1882
- △ +Virginia HICKS b: in Wake Co., NC m: Abt January 10, 1882
- 2 Richard Sanders BAKER b: March 19, 1833 in Wake Co. or Franklin Co., NC d: December 18, 1891 in Wake Co., NC
- △ +Elizabeth Margaret ("Bettie") BAKER b: January 21, 1841 in North Carolina m: December 20, 1865 in ? d: November 7, 1902 in Wake Co., NC
- 3 Eliza ("Lila") F. BAKER b: April 8, 1867 in Wake Co., NC d: December 9, 1870 in Wake Co., NC
- △ 3 Solon BAKER b: July 17, 1869 in Wake Co., NC d: August 26, 1942
- △ +Mary Simon BAKER b: April 1859 m: July 21, 1895 d: September 15, 1903
- △ 4 Minnie Ada BAKER b: July 13, 1895 in Wake Co., NC d: June 4, 1983 in Wake Co., NC
- △ +George Steven LOCKLEAIR b: October 21, 1896 in Sylvania, GA m: February 16, 1918 in Wake Co., NC d: January 23, 1960 in Durham, NC (VA Hospital)
- △ 5 Ada Eugenia LOCKLEAIR b: October 29, 1919
- △ +James Wesley PERRY b: August 14, 1918 in Franklin Co., NC m: July 22, 1941 in Wake Co., NC d: September 27, 1969 in Wake Co., NC
- △ 6 Wesley Earl PERRY b: May 17, 1942 in Franklin Co., NC d: April 9, 1987 in Guilford Co., NC
- △ +Glenda Jeanette PEEDIN b: June 9, 1943 in Johnston Co., NC m: May 9, 1964
- △ 7 Angela Dawn PERRY b: September 3, 1966
- △ +Robert Anderson DALTO b: in NY or NJ
- △ 7 Tonia Renee PERRY b: October 5, 1971 in Wake Co., NC
- △ 6 Carolyn Eugenia ("Gene") PERRY b: July 8, 1944
- △ +Charles Keith MARSHBURN b: December 19, 1943 in Wake Co., NC m: June 6, 1964
- △ 7 Christopher Keith MARSHBURN b: December 20, 1972
- △ 7 Jonathan Derick MARSHBURN b: December 24, 1981
- △ 5 George Thomas LOCKLEAIR b: October 11, 1921 in Wake Co., NC d: May 10, 1964
- △ +Eva Lee Mavis ALFORD b: November 28, 1923 in Wake Co., NC m: June 6, 1943
- △ 6 Alma Lee LOCKLEAIR b: May 11, 1946 in Wake Co., NC d: July 9, 1964 in Wake Co., NC
- △ 6 Mavis Ilene LOCKLEAIR b: May 15, 1949 in Wake Co., NC
- △ +George Wiley LAMBERT b: in Nash Co., NC m: February 1958
- △ *2nd Husband of Mavis Ilene LOCKLEAIR:
- △ +Raymond CHOQUETTE b: in New Hampshire m: February 15, 1975
- △ *3rd Husband of Mavis Ilene LOCKLEAIR:
- △ +Dennis Floyd BRANTLEY b: February 27, 1952 in Nash Co., NC m: October 28, 1983
- △ 6 Sandra Kay LOCKLEAIR b: October 19, 1950 in Wake Co., NC
- △ +Ronnie Martin CORTNER b: February 19, 1949 in Jefferson City, MO m: August 17, 1967
- △ 6 George Thomas LOCKLEAIR, Jr. b: October 6, 1954 in Wake Co., NC
- △ +Doris Kathryn WILLIAMS b: July 28, 1954 in Franklin Co., NC m: May 31, 1975
- △ 7 Jeremy Thomas LOCKLEAIR b: April 12, 1977 in Wake Co., NC
- △ 6 Johnny Wayne LOCKLEAIR b: March 10, 1956 in Wake Co., NC
- △ +Cindy Juanita O'NEAL b: July 1, 1957 in Wake Co., NC m: July 2, 1982
- △ 5 Solon Baker LOCKLEAIR b: January 25, 1925 in Wake Co., NC d: July 7, 1977
- △ +LaRue KING b: December 28, 1929 in Wake Co., NC m: May 29, 1948
- △ 6 Solon Baker LOCKLEAIR b: March 16, 1949
- △ +Judy Rose HODGE b: January 23, 1950 m: November 19, 1971
- △ 7 Steven Brian LOCKLEAIR b: September 27, 1972 in Wake Co., NC
- △ 7 Lori Anne LOCKLEAIR b: July 7, 1975 in Wake Co., NC
- △ *2nd Wife of Solon Baker LOCKLEAIR:
- △ +Bonnie Lee SHERRON b: August 18, 1957 m: September 1, 1983
- △ 7 Joshua Shane LOCKLEAIR b: August 25, 1989
- △ 6 George Dennis LOCKLEAIR b: April 3, 1951 in Wake Co., NC
- △ +Cathy Patricia JOHNSON b: October 2, 1951 in Wake Co., NC m: January 29, 1971
- △ 6 Mary Ruth LOCKLEAIR b: May 21, 1953 in Wake Co., NC
- △ 6 Anthony Steven LOCKLEAIR b: August 30, 1959 in Franklin Co., NC
- △ +Paula Ann JEANS b: February 2, 1962 m: February 2, 1978
- △ 7 Steven Anthony LOCKLEAIR b: June 4, 1979
- △ 7 Tonya Michele LOCKLEAIR b: May 24, 1981
- △ 7 Allison Nichole LOCKLEAIR b: May 7, 1987
- △ 5 Hutch Steven LOCKLEAIR b: September 23, 1926
- △ +Betty Lou MARSHALL b: November 22, 1933 in Wake Co., NC m: January 8, 1949
- △ 6 Linda Lou LOCKLEAIR b: February 18, 1950
- △ 6 Deborah Sue LOCKLEAIR b: June 14, 1951
- △ +Gerald Richard LAMBERT b: May 23, 1950 in Nash Co., NC
- △ 5 Mary Addie LOCKLEAIR b: December 27, 1928 in Wake Co., NC d: September 27, 1933
- △ 5 Alma Doris LOCKLEAIR b: January 5, 1931 in Wake Co., NC

..... +Homer Edison BELL b: November 22, 1929 in Franklin Co., NC m: June 29, 1951
 6 Rhonda Lee BELL b: December 2, 1961
 +Ronald Lee OWEN b: March 28, 1964 in Wilson Co., NC m: August 27, 1988
 5 Alice Marie LOCKLEAIR b: February 1, 1933 in Wake Co., NC
 +Charlie Taylor WALL b: May 18, 1930 in Wake Co., NC m: February 10, 1951
 6 Georgia Marie WALL b: February 15, 1957 in Raleigh, NC
 6 Gary Michael WALL b: December 23, 1962 in Raleigh, NC
 5 Norma Faye LOCKLEAIR b: April 11, 1937 in Wake Co., NC
 +Luther Wayne LILES b: February 14, 1937 m: May 1954 d: January 15, 1985 in Chapel Hill, NC
 (UNC Medical Center)
 6 Donna Faye LILES b: May 19, 1955 in Wake Co., NC
 +Manuel RODRIQUEZ m: November 6, 1976 in Los Angles, CA
 7 Gabriel Nathaniel RODRIQUEZ b: August 30, 1977 in San Bernadino, CA
 7 Melissa Andrea RODRIQUEZ b: July 28, 1981 in San Bernadino, CA
 *2nd Husband of Donna Faye LILES:
 +Edward Donald PERRY b: March 14, 1941 m: 1982 in California
 *2nd Wife of Solon BAKER:
 +Mensie ("Mance") PERRY b: May 1881 m: December 16, 1903 in Wake Co., NC at Joe Perry's Residence
 4 Willie Mae BAKER
 4 Alma Radah BAKER b: October 16, 1904
 +Henry HESTER
 *2nd Husband of Alma Radah BAKER:
 +Ralph Pitt BROWN b: August 11, 1910 d: July 12, 1989
 *3rd Husband of Alma Radah BAKER:
 +Roland Travis FOUNTAIN b: January 31, 1911 in Rocky Mount, Nash Co., NC m: April 10, 1939 d:
 March 1, 1959 in Rocky Mount, Edgecombe Co., NC
 *3rd Wife of Solon BAKER:
 +Artelia MARTIN b: April 16, 1869 m: March 4, 1913 d: June 17, 1936 in Wake Co., NC
 3 Francis ("Frank") Marion BAKER b: February 8, 1871 d: February 23, 1951
 +Lelia [Lela] CHEVES m: February 23, 1898 in Franklin Co., NC at Jim Cheave's residence
 4 Francis Marion BAKER, Jr. b: February 25, 1910 in Franklin Co., NC
 +Ruth STRICKLAND m: February 25, 1934
 5 Janice BAKER b: December 7, 1934
 +J.B. LAND m: 1951
 5 Raeford BAKER b: October 28, 1940
 +Karen CARDWELL m: June 18, 1966
 5 Willis Bennett BAKER b: August 2, 1948
 4 Richard BAKER b: May 27, 1902
 +Lena CHEAVES m: February 1, 1931
 5 James Richard BAKER b: May 17, 1934 d: July 9, 1950
 5 Betty Jo BAKER b: August 4, 1942
 4 Julia Berniece BAKER b: June 19, 1900
 +John William TEACHEY b: January 23, 1893 m: January 4, 1924 d: November 7, 1969
 3 Grace Truman BAKER b: January 30, 1872 in Wake Co., NC
 +John Henry FOWLER b: Abt 1874 m: May 19, 1898
 4 Christine Baker FOWLER
 +James B. SAPPENFIELD
 4 Willie Grace FOWLER
 +Marion JONES
 4 Margie Lee FOWLER b: April 1899 d: February 13, 1904 in Hattiesburg, MS
 3 Geneva ("Neva"/"Nevie") Gray BAKER b: March 15, 1874 d: March 21, 1952
 +Ebbie Cooke STALLINGS b: July 9, 1879 m: December 25, 1900 d: Aft 1969 in Wake Co., NC
 4 Donald Wayne STALLINGS b: July 1, 1902 → [1879-?-RPU]
 +Pauline Mae PEARCE m: January 1, 1931
 5 Donna Faye STALLINGS b: March 25, 1948
 4 Zemora ("Zip") Helen STALLINGS b: August 1, 1904
 +George Theodore KINNEY b: October 19, 1901 m: September 1, 1930 d: in Raleigh, Wake Co., NC
 5 Barbara Helen KINNEY b: November 15, 1934
 +Edward Milton FOLEY b: December 25, 1933 m: December 18, 1955
 6 George Keven FOLEY b: September 25, 1958
 6 Kenneth Woodall FOLEY b: January 5, 1961
 6 Christopher Patrick FOLEY b: May 14, 1964
 4 Grace Marie STALLINGS b: April 8, 1919
 +Frank Thomas SCARBOROUGH b: October 19, 1913 m: December 6, 1939
 5 Marie Annette SCARBOROUGH b: December 9, 1946
 +Sidney HOLMS b: August 21, 1942 m: July 19, 1965
 5 Judy Grey SCARBOROUGH b: August 11, 1951
 +Louis AMBROSIO m: September 22, 1968
 6 Jenell Marie AMBROSIO b: October 8, 1969

- 3 Willis Walters BAKER b: July 28, 1878 in Wake County, NC (Little River Twnshp] d: February 7, 1971 in Fayetteville, NC
 - + Caroline ("Carrie") McQUEEN b: in Fayetteville, NC, Cumberland Co., NC m: September 2, 1914
 - 4 Willis Walters BAKER, Jr.
 - + Katherine WHITE
 - 4 Margaret BAKER
 - + Dominic DiCENZO
 - 5 Linda DiCENZO
 - 5 Susan DiCENZO
- 3 Thomas Yates BAKER b: March 7, 1880 in Wake Co., NC d: April 5, 1965 in Wake Co., NC
 - + Beatrice Gertrude PHILLIPS b: July 18, 1885 in Franklin Co., NC m: October 15, 1905 in Franklin Co., NC d: July 28, 1971 in Raleigh, Wake Co., NC
 - 4 Beatrice Gladys BAKER b: December 29, 1906 in Wake Co., NC
 - 4 Elizabeth Helen BAKER b: October 25, 1908 in Wake Co., NC d: May 23, 1987 in Wake Co., NC
 - + James Roy JOYNER b: in Wake Co., NC m: October 15, 1930 d: 1994 in Wake Co., NC
 - 5 Betty Baker JOYNER b: August 7, 1931
 - + Clifton Earl CRANDELL b: in Pitt Co., NC m: August 11, 1951
 - 6 Martha Helen CRANDELL b: August 23, 1954
 - + Edward HART
 - 7 Jaishree Rahda HART
 - 6 Sue Ann CRANDELL b: January 12, 1956
 - + David SPARROW
 - 7 Rebekah SPARROW
 - 7 Daughter of SPARROW
 - 6 Clifton Earl CRANDELL, Jr. b: February 17, 1957
 - 6 Maribeth CRANDELL b: June 12, 1958
 - 6 Carolyne Jean CRANDALL b: October 29, 1959
 - 5 Jimmy Yates JOYNER b: August 13, 1935 in Wake Co., NC
 - + Ruth Mary TEMPLE b: June 10, 1936 in Wake Co., NC m: March 28, 1959
 - 6 Mary Elizabeth JOYNER b: June 15, 1961
 - + Andy Curtis BRANNAN b: in Zebulon, Wake Co., NC m: April 18, 1987 in Wake Co., NC
 - 6 Anna Lynn JOYNER b: August 6, 1963
 - + Michael Ray STOTT m: June 11, 1989 in Joyner Homeplace, Zebulon, NC
 - 6 Nancy Jean JOYNER b: December 13, 1965
 - 5 Jean Helen JOYNER b: November 10, 1938
 - + Donald Wayne WILLIAMS m: June 5, 1961
 - 6 Donald Wayne WILLIAMS, Jr. b: May 16, 1962
 - + Rebecca Ann REEDER b: December 6, 1959 m: August 12, 1984
 - 7 Kara Tiffany WILLIAMS b: December 1, 1985
 - 6 Thomas Earl WILLIAMS b: April 12, 1963
 - 6 Jeanene Bea WILLIAMS b: November 21, 1967
 - + Kenneth Jeffrey SMITH b: August 30, 1966 m: December 7, 1985
 - 7 Celia Lynn SMITH b: November 3, 1985
 - 5 Richard Patrick JOYNER b: March 4, 1945
 - + Bonnie Lou MURRAY m: June 1, 1969
 - 4 Mary Margaret BAKER b: March 21, 1912 in Zebulon, Wake Co., NC d: April 29, 1995 in Raleigh, NC
 - + Willis Alton REID b: August 6, 1907 in Whitakers, Nash Co., NC m: October 14, 1933 in Home of Thomas Yates Baker, Wake Co., NC d: July 11, 1991 in Raleigh, Wake Co., NC
 - 5 Margaret ("Margie") Beatrice REID b: July 21, 1938
 - 5 Willis Alton REID, Jr. b: September 15, 1941 in Raleigh, NC
 - + Janet Lancaster WARNER b: October 18, 1944 in Boston, MA m: April 24, 1966 in Raleigh, NC
 - 6 Blake Dietrich REID b: July 27, 1971 in Raleigh, NC
 - 6 Alexander Nathan REID b: September 19, 1974 in Washington, DC (Walter Reed Army Hospital)
 - 4 Thomas Yates BAKER, Jr. b: September 8, 1915 in Zebulon, Wake Co., NC d: August 17, 1958 in Raleigh, Wake Co., NC
 - + Margaret Irene GARDNER b: February 4, 1920 in Mt. Gilead, Montgomery Co., NC m: February 8, 1941 in York, SC
 - 5 Peggy Nash BAKER b: September 21, 1941 in Charlotte, NC
 - + John Parry FERN b: July 7, 1941 in Scranton, PA m: June 5, 1965 in Raleigh, NC d: January 18, 1994 in Charlotte, NC
 - 5 Thomas Yates BAKER III b: May 10, 1945 in Charlotte, NC
 - + Brenda Kay BURGESS
 - *2nd Wife of Thomas Yates BAKER III:
 - + Gwendolyn ("Gwen") Dean STRICKLAND b: July 14, 1948 in Raleigh, NC m: October 27, 1979 in Raleigh, NC
 - 6 Thomas Yates ("Yates") BAKER IV b: 1985
 - 6 Meredith Brooke BAKER b: August 6, 1981
 - 3 Mat Ransom BAKER b: August 7, 1875 in Wake Co., NC d: September 29, 1875 in Wake Co., NC
 - 2 Augustus BAKER b: Abt 1835

- △... 2 Agnes C. BAKER b: Abt 1838 in Wake Co., NC d: Aft 1880
- △..... +Atlas J. STALLINGS b: Abt 1839 in Wake Co., NC m: December 6, 1865 in Wake Co., NC
- △..... 3 Minnie STALLINGS b: Abt 1867
- △..... +Joshua PEARCE
- △..... 3 Eliza ("Lizzie") R. STALLINGS b: May 1868 d: Abt 1905
- △..... +John W. JOYNER b: February 25, 1852 in Franklin Co., NC m: December 13, 1894 in Zebulon, Wake Co., NC d: April 13, 1914 in Franklin Co., NC
- △..... 4 Elizabeth Mae JOYNER b: June 11, 1898
- △..... +Charlie Clifton MARTIN b: November 18, 1891 in East Bend, NC m: May 18, 1918 in Winston Salem, NC d: June 15, 1970 in Kinston, NC
- △..... 5 John W. MARTIN b: July 23, 1923 in Spring Hope, NC
- △..... +Lillian Mary BRYSON b: October 5, 1926 in Bryson City, NC m: June 8, 1948 in Durham, NC
- △..... 3 Charles A. STALLINGS b: Abt 1870
- △..... 3 Blake STALLINGS b: December 1873
- △..... +Siddie PERRY b: December 1879
- △..... 4 Bernard STALLINGS
- △..... +Hattie PERRY
- △..... 4 Voncille STALLINGS
- △..... 3 Bryant S. STALLINGS b: May 14, 1872 d: November 8, 1935
- △..... +?? ??: 1st wife of Bryant STALLINGS
- △..... 4 Valmore STALLINGS
- △..... 4 Russell STALLINGS
- △..... *2nd Wife of Bryant S. STALLINGS:
- △..... +Sarah W. GAY b: May 30, 1874 d: April 11, 1922
- △..... 4 Woodrow STALLINGS
- △..... +Sadie Mae DOYLE
- △..... 5 Sarah STALLINGS
- △..... 5 Wilson STALLINGS
- △..... +Dixie ??: wife of Wilson STALLINGS
- △..... 4 Retta STALLINGS
- △..... 4 Agnes STALLINGS
- △..... +?? PERRY: husband of Agnes STALLINGS
- △..... 4 Clarice STALLINGS
- △..... +Lonnie WILLIAMS
- △..... 4 Ruby STALLINGS
- △... 2 James B. BAKER
- △*2nd Wife of Blake BAKER:
- △ +Margaret BUNN b: Abt 1806 m: Abt November 27, 1846 in Wake Co., NC
- △... 2 Joseph B. BAKER b: Abt 1848
- △..... +Alamance ("Mance") PHILLIPS b: January 26, 1854 in Franklin Co., NC m: December 23, 1875 in Franklin Co., NC at W.K. PHILLIPS residence d: Aft 1914 in Franklin Co., NC
- △..... 3 Sudie BAKER
- △..... +[1] Edgar T. GRIFFIN
- △..... 4 Donovan GRIFFIN
- △..... 3 Mildred BAKER
- △..... +J. J. RICHARDSON
- △..... 3 Lula Gray BAKER
- △..... +H. C. BARBEE
- △..... 3 Henry Kearney BAKER
- △..... +Minnie GILL
- △..... 4 Dorothy BAKER
- △..... 4 Louise BAKER
- △..... 4 Henry Kearney BAKER, Jr.
- △..... +Ruth DEAN b: in Wendell, Wake Co., NC
- △..... 5 Joan BAKER
- △..... +Charles DRIVER
- △..... 3 Birdie BAKER
- △..... +[1] Edgar T. GRIFFIN
- △... 2 Burwell BAKER b: November 19, 1847
- △..... +Clara WHITLEY m: February 13, 1879 in Wake County, N.C.
- △... 2 Rebecca ("Becky") BAKER b: Abt 1853
- △..... +James Adolphus ("Dollie") FERRELL m: August 24, 1871
- △..... 3 James B. FERRELL b: 1877
- △..... 3 Willie A. FERRELL b: 1878
- △... 2 Wesley ("Wes") BAKER b: February 8, 1857
- △..... +Idis ALFORD m: January 4, 1899 in Franklin Co., NC at John Alford's residence d: Abt 1900 in Wake Co., NC
- △..... 3 Stillborn child of Wesley BAKER b: Abt 1900
- △... 2 John D. BAKER b: Abt 1857 in Wake County, NC
- △ +..... +Neda Bell ("Zedie") FRAZIER m: October 9, 1910 in Franklin Co., NC at J.J. Pearce's

- △... 2 Benjamin BAKER b: March 12, 1860 in Wake Co., NC d: June 21, 1928 in Wake Co., NC
- △..... +Emily Jane JOYNER b: September 7, 1860 m: February 22, 1882 in Wake County, N.C. d: June 3, 1932
- △..... 3 Benjamin Claude BAKER d: December 5, 1972 in Wake Co., NC
- △..... +Pauline HAGWOOD
- △..... 4 Jane BAKER
- +?? PEARCE
- △..... 4 Hilda BAKER
- +?? WARD
- △..... 4 Cleo BAKER
- +?? COLLINS
- △..... 3 Lorna BAKER
- +?? FERRELL
- △..... 3 Mae Belle BAKER
- +?? POOLE
- △..... 3 Lillian BAKER
- +?? POOLE
- △..... 3 Nora BAKER
- +?? WILDER
- 2 Leanora M. BAKER d: September 15, 1863

↓

usually ~~the~~ latter. As I write this it is 6:45 AM on a Sunday Morning. I have declared Sunday to be "Play days" but Sallaine likes to sleep until 7-8 AM each day. It's about time for me to go get her up.

Back to the Meccasin Creek Area. Much Upshur activity was on the Franklin County side but there was also quite a bit on the Wake side. I have always been interested in a tract in Wake County which my ancestor Nathan U, I obtained from Julius Johnson sometime in the period 1787-1792. Because of this transaction it has been speculated that the MACKET who married Nathan U, I was the daughter of Julius Johnson. I think Nathan^{U, I} sold the tract to Matthew Stuchland in 1802 or 1809 as an action related to the move of Nathan U, I from the Wake/Franklin border to the western part of Wake Co. (Green level). I have just tried to find some documentation on the Julius Johnson tract and it will not surface. However, from memory I

Place a red X and a highlight on the enclosed map showing where I recall the property as being located. You will note this in a map you sent me in 1989. If I am correct Nathaniel, I had land very close to your Baber. I mention all of this to indicate that I have a keen interest in the south/west area of Moccasin Creek (The Wake side) also.

There are a number of projects underway that will help us with our interest in the Moccasin Creek Area. One cousin plans to develop a booklet on the various streams in the area. This can be a great help in locating property as many old deeds & wills make mention of streams. Several years ago I started a "Stream File" for the area and have gradually added to it.

I hope that we can stay in touch in 1991 and be of assistance to each other.

☺ Sincerely yours
Phil W. Church
{ROBERT PHILIP WPKWPKW}

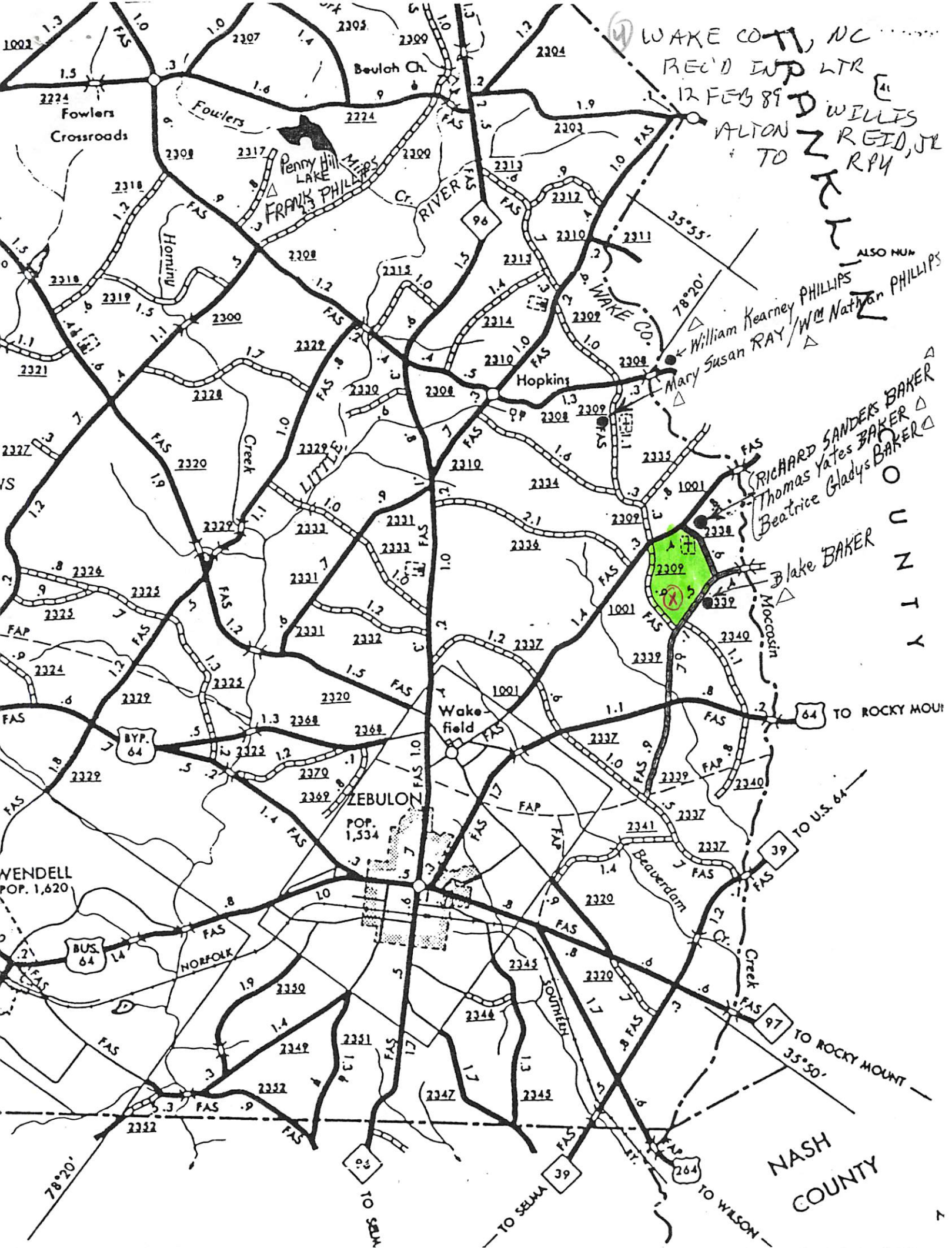

WAKE CO., NC
REC'D IN P LTR
12 FEB 89
D WILLES
ALTON REID, JR
TO ZEBULON

ALSO NUM
PHILLIPS
William Kearney PHILLIPS
Mary Susan RAY / Wm Nathan PHILLIPS

RICHARD SANDERS BAKER
Thomas Yates BAKER
Beatrice Gladys BAKER

Blake BAKER

C
N
I
Y

64 TO ROCKY MOUNT

39 TO U.S. 64

97 TO ROCKY MOUNT
35°50'

NASH
COUNTY

78°20'

39

39

264

WILLIS. ALTON REED, JR

XID-21981

MICHAEL ENTERPRISES
R. P. UPCHURCH
6 EAGLES WAY LANE

LAKE ST. LOUIS, MISSOURI 63367-2240



23 SEP 1996

Dr. WILLIS A. REED, JR
6210 HOLLINS DRIVE
BETHESDA, MD 20817

Dear Cousin Willis,

Enclosed is a copy of a 4 SEP 1996 letter from
Cousin Fannie Wootten which has stimulated me
to spend several hours on the subject she
addresses. It appears to me the weight of evidence
has shifted away from Frances U who and
Blake Baker being the daughter of Jubal U. I think
the evidence is now rather good that at the
time that Frances U and Blake Baker she was
the widow of Mullyford U.

Note my enclosed Profile for Mullyford U (3 pages,
10 items). See item (3) which adds to evidence
cited by Cousin Fannie.

Could you study this matter and let me
know what you think?

It now seems clear to me that Mullyford
U was the son of James U, VII + gr of Richard U, III
with All Best Regards!

Sincerely yours
Phil Upchurch

(U) [ROBERT PHILIP UPCHURCH]

of a good friend, Dr Edmond Weber of Tucson, AZ. He will visit us later this year. He has a PhD in physics from Cal Tech and is a whiz with computers. As a side comment, he got his undergraduate degree from McGill where your son Alex is enrolled.

Thanks for the picture. The story about the animals is great. I am still working on getting a dog.

Over the past year I have received an excellent packet from Mrs Wallace Harold Alford (nee Dorothy Lucille Baker). I believe she sent you the same information. I recently received this packet and have sent her details and have asked for more input. She is an excellent cooperator.

I am anxious to share any information that I have that you might find useful. My records are not on computer but I'll be happy to copy any of my Master outlines for your use. Enclosed is a sheet showing what is missing on your line. I will be grateful for any answer you provide.

Now that I am retired more time can be spent on family history. We will take two

-3-

with trips in May and November for family history work. This May we will cover TN and NC. Next November Texas will be the target. I have been in touch with Edythe Trippitt, whom I believe you know, and we are working on arrangements for me to give an Upchurch lecture in Zebulon probably on the afternoon of Sunday 28 MAY 1995.

My contacts in the Zebulon area are growing and over time it should be possible to learn a lot more about family history in the area.

Please let me know of any ideas you have about how we can help each other.

☺ sincerely yours
Phil Upchurch

[ROBERT PHILLIP UPCHURCH]

MISSING DETAILS ⁴ON THE FAMILY
OF MARY MARGARET (BAKER) REID

16 JAN
1995

1) For Mary Margaret Baker

a) where was she born?

b) where did she marry?

2) For Margaret Beatrice Reid - All OK.

3) For Willie Alton Reid, Jr

a) where were you and Jan married?

b) was Blake Dietrich Reid born 7 JUL 1971 or 27 JUL 1971?

WILLIS ALTON REID, JR
①

XID-21981

REC 10
19 DEC 1994

Dear Cousin Robert Phillip Upchurch,

Welcome to the ranks of great unworked retired. I prefer to think of it as a career change. I am only now getting back into the Baker/Phillips/Roy/Upchurch genealogy after a several year hiatus, and with the help of "Family Tree Maker" for Windows. I highly recommend the program and it's so easy to use.

I thought that you might appreciate the enclosed clippings regarding your cousin ^(my mother) Margaret BAKER REID (great granddaughter of Frances U. and g-g-granddaughter of Elizabeth Thony U. and her sister Gilly Upchurch). The property referenced in the clippings is her home on Dixie Trail in Raleigh.

Peace
on
Earth

Willis

TWO CLIPPINGS FILED
UNDER MARY MARGARET
BAKER

1940 | 1920 | 1900 | 1880 | 1860 | 1840 | 1820 | 1800 | 1780 | 1760 | 1740 | 1720 | 1700 | 1680 | 1660 | 1640 | 1620 | 1600 | 1580 | 1560

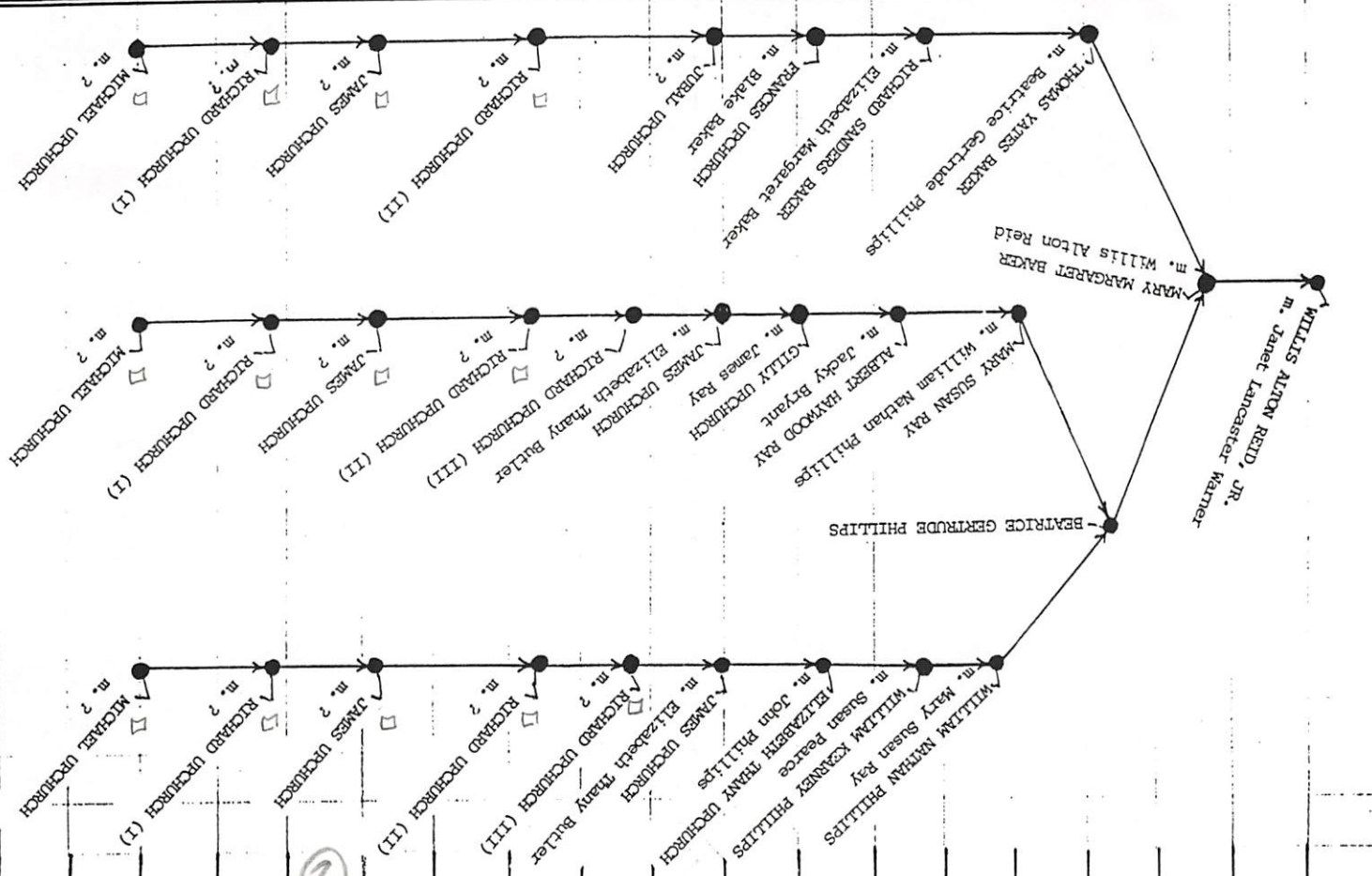
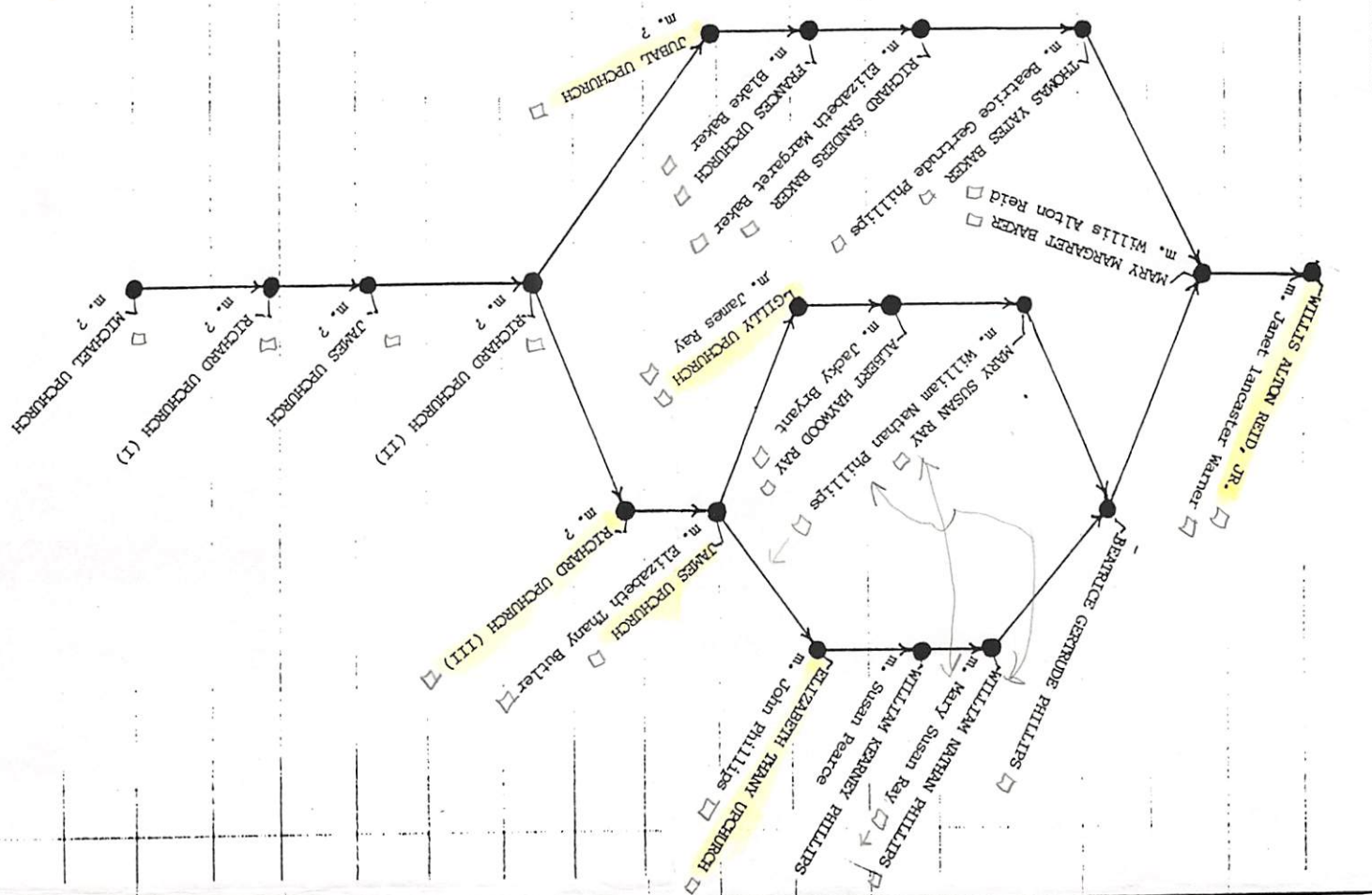

1940 | 1920 | 1900 | 1880 | 1860 | 1840 | 1820 | 1800 | 1780 | 1760 | 1740 | 1720 | 1700 | 1680 | 1660 | 1640 | 1620 | 1600 | 1580 | 1560

1994 SEASON'S GREETINGS FROM THE REIDS

3

Dear Friends,

How time flies! It seems like only last month that we were sending our last year's greetings. Now it's time to do it again and to fill you in on the comings and goings over the past year.

Willis officially retired in 1993, but he's working just as hard now (and having more fun) than he did when he had to put on a uniform every day. He is consulting under a contract from the Walter Reed Army Institute of Research to help them manage their technology transfer program. The nice part about it is that he does most of the work at home and pretty much sets his own work schedule (no calls before 9:00 am, please). He does, however, get over to WRAIR regularly and, through his consulting work, maintains contacts with all of his good friends there and up at Fort Detrick. The home office is now equipped with the separate phone line for the FAX machine (301-493-4169), which is active 24 hours a day, and early in the year we went onto CompuServe for e-mail. Our e-mail address is: 74024.1511@compuserve.com.

Willis takes off about one week per month to go down to Raleigh and take care of some of his mother's affairs. She is not well and this is an opportunity for Willis to look after things around her house. During these trips, he usually finds an opportunity to pick up some good NC barbecue for the freezer, and, on the return trip, to swing by our place in Floyd County, Virginia. Roger Barber, who is more than just a tenant on the property, is doing a fantastic job in helping us to improve the place, and he has supervised some major renovation and reconstruction efforts, including a whole three room addition to the cabin. Roger also blessed us with the newest addition to our family - the pick of the litter from his dog Oprah's pups. "Sean", now six months old and 33 pounds, is a cross between Australian Shepherd and Border Collie (the vet wrote "Aussie Collie" on his records), and is a real people-dog, frisky but even tempered. Recently he had a life experience - he caught the frisbee in mid-air! He sits and fetches on command; now if we could only get him to come. He desperately wants to be friends with "E-T" the cat, but he (E-T) is having nothing to do with this upstart intruder, and is perfecting his most ferocious hissing, swatting, and dog avoidance techniques. Sean learned early to keep out of range of those claws.

Jan is continuing her work on copepod taxonomy as a Resident Research Associate at the Smithsonian's Museum of Natural History, and this year she assumed her new duties as the President of the Biological Society of Washington. She is grateful to be more or less back to a normal routine after a long siege of trigeminal neuralgia in the spring. She has been spending a lot of time at the dentist having many old metallic (and electroconductive) fillings replaced, a new treatment which seems to be helping. She is grateful to Willis, Blake and Alex for so much cooking, housework and taxiing this summer,



(4)

to E-T for keeping her company in bed, and more recently to Sean for forcing her outside on those long, healthy early morning walks. She has lost 15 pounds, but she doesn't recommend the method. Willis is doing his best to put weight back on her and he is largely succeeding - he is now the chief cook of the family. Fortunately, though, Jan has been able to get down to the museum on a fairly regular basis, and with the new e-mail address, can communicate with her colleagues all over the world. We are truly hitch-hikers on the Information Highway.

After graduating in Physics from James Madison University last December, Blake came home and waited to hear from the Peace Corps - and waited - and waited - and waited. Finally he heard - Zimbabwe! He left in October, and is now in Harare (the capital) taking his in-country training. In January, he moves down to far southern Zimbabwe, to the Malungudzi Secondary School. It's about 60 km from Beitbridge, on the South African border. There, for 2 years, he will be teaching high school level science and probably math. The whole school has only 7 teachers, including him. We've had two letters and a phone call from him so far. His Christmas "wish list" included AA batteries, suntan lotion (SPF 8), elephant repellent, razor blades, packets of powdered Gatorade (anything but orange flavor!), colored chalk, film (ASA 200), durable short sleeve shirts, a Venda phrase book, watercolor pens and paper, a solar power pack, and his banjo. One problem he reports is that, although the official language is English, the tribal language in that area is Venda, and it is an unwritten language which fewer than 500 whites speak. That means that there are no dictionaries or phrase books to fall back on, so he's winging it. He would really enjoy mail, but we don't know his address at the school yet. Send any letters or cards to us and we will forward them. In the meantime, over New Years, you will find him white water rafting along 15 miles of the Zambezi River below Victoria Falls (Class 5 rapids!). By the way, Blake isn't really that much shorter than Alex; he just refused to put on shoes for the photo.

While Blake is roughing it in Zimbabwe, Alex is languishing in what must be relative comfort in urban Montreal. He is in his third year of Mechanical Engineering at McGill University and by all reports is doing well (although we hear that math this semester is a killer). This summer, he worked at the Instrumentation Division of the Walter Reed Army Institute of Research. He was fabricating devices, widgets, and gadgets that our WRAIR medical scientists use for their research, and was heard to say once that "This is great. I'm being paid for taking shop." With Alex working regular hours at WRAIR, and Blake working irregular hours as a temp, both of them devoted the summer to putting on the Wildwood Summer Theater's 30th annual musical production, "The Mystery of Edwin Drood". It was Blake's swan song for WST and he produced the play; Alex grew a beard for a chorus part (but with lines). The production was a smash hit. We saw it three times, and we were glad to get reacquainted with the boys afterwards.

We wish you all a happy Christmas and year's-end holiday with home and family.

Willis & Jan Reid

5

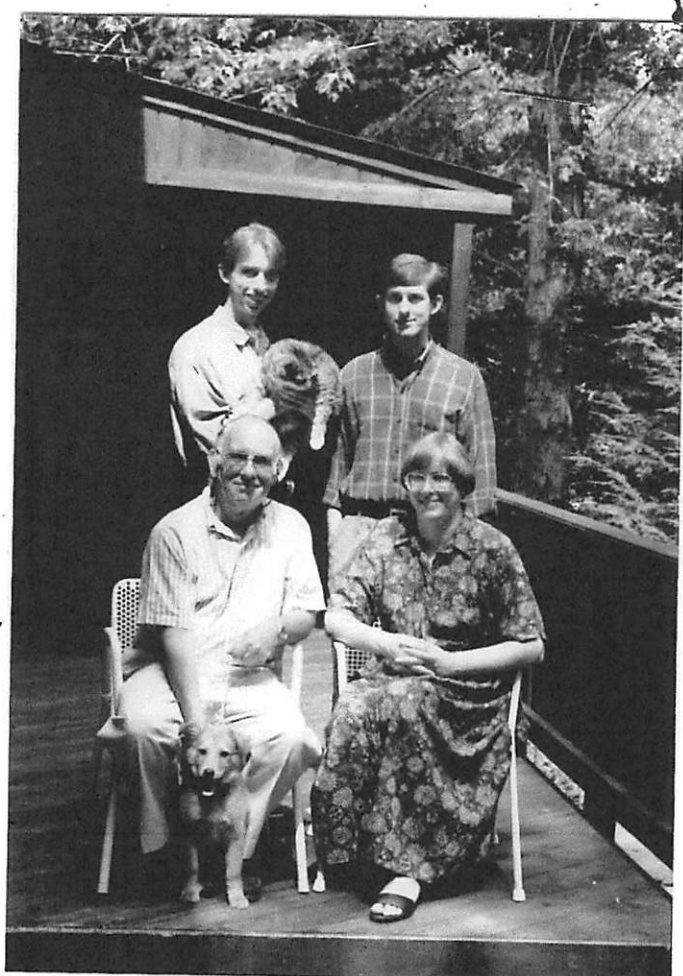

D. Willis
 E. Jan
 A. Blake
 C. Alex
 B. E-T (CAT)
 F. Sean (DOG)

REID
 August 1994

A B C
 D E
 F

WILLIS = WILLIS ALTON REID, JR

① From Bible of William Kearney Phillips (in N.C. Gen. Soc. Jour. NOV 1988).

I. William Kearney Phillips 1831-1914

A. William Nathan Phillips

1. Beatrice Gertrude Phillips

a. ♀ and Miller A. Reid, Sr

i. Miller A. Reid, Jr, M.D. submitted

~~the~~ Bible to N.C. Gen Soc. Jour.

His address:

6210 Hollins Drive
Bethesda, MD 20817

② 25 MAR 1989

RPA called WAR, JR to thank him for his letter of 12 FEB 1989 and to offer agreement that his Frances U is dau of Jubal U. Told him I have partly processed his packet and will get the rest of it. He agrees that a Foundation is a good idea. Told him I knew his father. [COPIED FOR FOUNDATION FILE]

③ See Pg 7 of 4 JUN 1978 Dr Edythe M. Fryzett to RPA

"I have found a third Frances U - named Blake Baker - Wake Co, NC marriage bond dated Nov 16, 1829. Am enclosing a copy of the children of Blake and Frances (See Pg 16417 filed with Frances U - RPA). This search was done by a friend, Miller Reid, who is now in Brazil and can do no more research until he returns in about 5 years.

WILLIS ALTON REID, JR ①

XFD-21981

MICHAEL ENTERPRISES
P. O. BOX 35804
TUCSON, ARIZONA 85740



25 DEC 1993

Dr WILLIS A. REID, JR
6210 HOLLINS DRIVE
BETHESDA, MD 20817

Dear Cousin Willie,

Thanks for your renewal on the U B for 1994 and for your letter. I was sorry to learn of the passing of your father. I recall him with the greatest respect as I have reported to you before. He was a kind and compassionate person and as a teacher had great communication skills. I first came to experience this as a student in his classes in the 1940's. Later in the 1950's & 1960's when he was a senior faculty member and I was a junior faculty member at N. C. State he accepted me fully as a professional and a colleague. He was a gentleman of the first order.

We continue to make excellent progress in documenting the Upchurch Family. I was especially pleased to locate the exact site of the land in Franklin Co, NC owned

by your ancestor Richard Upchurch, III at his death in 1817. We are now researching ownership on the boundaries of this tract with the strong belief that adjoining areas were owned by other members of the family in the 1750-1850 era. I have a record of a mill owned by your ancestor Jubal Upchurch in the same vicinity and hope to locate the site in due course.

Enclosed is a copy of the Master outline sheet for the Thomas & Peter Baker, Sr. Family with three follow-on sections. I have highlighted missing items. Perhaps you have some of these or know of other events not recorded on these sheets such as births, deaths, marriages. If you have anything you can send to upgrade this Master outline I would appreciate it.

With All Best Wishes for the New Year!



Sincerely yours
Phil Upchurch

[ROBERT PHILIP UPCHURCH]

WILLIS ALTON REID, JR

XID-21981

REC'D
21 DEC 1993

WILLIS A. REID, JR., Ph.D

6210 Hollins Drive
Bethesda, Maryland 20817

(301) 897-9625

December 15, 1993

Mr. Robert P. Upchurch
c/o Michael Enterprises
P.O. Box 35804
Tucson, AZ 85740

Dear Mr. Upchurch:

It just occurred to me that I had not notified you of the passing of my father, Willis Alton Reid (XID number 21979) on July 11, 1991. He died suddenly of a cerebral hemorrhage at his home in Raleigh, NC. He was 84 years old. He is buried in the Baker Family Cemetery near Zebulon, NC. He was survived by his widow, Margaret Baker Reid (XID 21973) of Raleigh, NC, his daughter Margaret ("Margie") Beatrice Reid (XID 21980) of Raleigh, NC, his son Willis Alton Reid, Jr. (XID 21981) of Bethesda, MD, and two grandsons, Blake Dietrich Reid (XID 21982) and Alexander Nathan Reid (XID 21983), also of Bethesda, MD.

You will recall from the *Upchurch Bulletin* of April 1989 (Volume 10, Number 2) that Margaret B. Reid is the ggd of Frances Upchurch (XID 21952), the daughter of Jubal Upchurch (XID 158). She is also "descended from two gd of Richard U. III, namely Elizabeth Thany U. [XID 992] and Gilly U [XID 991]." My father was therefore related to the Upchurch clans by marriage.

Sincerely,

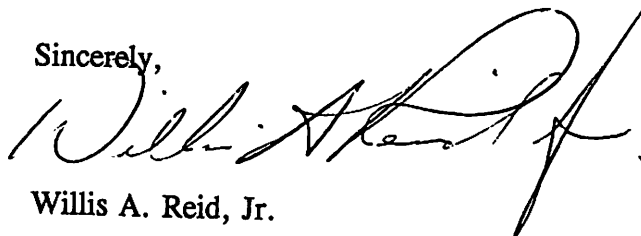

Willis A. Reid, Jr.

WILLIS ALTON REID, JR

XID-21981

MICHAEL ENTERPRISES

P. O. BOX 35804

TUCSON, ARIZONA 85740

NOVEMBER 1992

INVOICE

As we begin our 14th year (1993) of publishing the UPCHURCH BULLETIN, we are pleased to have identified some 31,000 individuals linked back to Michael U. I, first immigrant to the USA in 1649 from England. Cost of production and postage has increased but we will continue to offer the 1993 subscription rate of \$15.00 for the 4 issues published. We encourage you to also contribute to the UPCHURCH RESEARCH FUND so that we may collect and publish interesting information, or honor our loved ones. BOUND and UNBOUND issues are available for all back volumes. Give a gift to a relative or a friend. Help preserve our unique Upchurch heritage.

1. Please enter my subscription* for Vol.14(1993)@ \$15.00. \$15.00

2. Please send UNBOUND back volumes @ \$12.00/volume:

B-1-93

\$ _____ \$ _____ \$ _____ \$ _____ \$ _____ \$ _____ \$ _____ \$ _____
1-1980 2-1981 3-1982 4-1983 5-1984 6-1985 7-1986 8-1987
\$ _____ \$ _____ \$ _____ \$ _____ \$ _____
9-1988 10-1989 11-1990 12-1991 13-1992

\$ -

3. Please send BOUND volumes @ \$25.00/volume:

\$ _____ \$ _____ \$ _____ \$ _____ \$ _____ \$ _____ \$ _____ \$ _____
1-1980 2-1981 3-1982 4-1983 5-1984 6-1985 7-1986 8-1987
\$ _____ \$ _____ \$ _____ \$ _____ \$ _____
9-1988 10-1989 11-1990 12-1991 13-1992

\$ -

4. UPCHURCH RESEARCH FUND:

Reid 5 DEC 92 ch# 5119
for 15 years 30,000 Willis A. Reid

Research \$ _____
MEMORIAL GIFT: \$ _____

\$ -
\$ -

(For Memorial Gift please indicate name of person(s) being honored: (Mother, Father, Brother, Sister, Aunt, Uncle, Child, Grandparents, etc.)

(This will be published in the UPCHURCH BULLETIN)

NAME: _____ RELATIONSHIP _____

LTC. Willis A. Reid, Jr, Janet W. Reid
6210 Hollins Dr, Bethesda, MD 20811

TOTAL \$ 15.00

Please make check payable to : MICHAEL ENTERPRISES

897-9625 Mail to: MICHAEL ENTERPRISES, P. O. Box 35804, Tucson, AZ 85740

NAME: _____
ADDRESS: _____
CITY: _____ STATE _____ ZIP _____

*Some reductions available for those on a restricted budget. Write for details.

Gift(s) (Please include payment)

NAME: _____
ADDRESS: _____
CITY: _____ STATE _____ ZIP _____

WILLIS ALTON REID, JR

XID-21981

MICHAEL ENTERPRISES

P. O. BOX 35804

TUCSON, ARIZONA 85740

NOVEMBER 1990

INVOICE

UPCHURCH BULLETIN, Volume 12 (1991) will be published at the same rate of \$15.00 per year. Subscriptions for renewal are requested for the new four issues which will be published. We encourage you to also contribute to the UPCHURCH RESEARCH FUND so that we may collect and publish interesting information, or honor our loved ones. BOUND and UNBOUND issues are available on all back issues. Give a gift to a relative or a friend.

1. Please enter my subscription* to the UPCHURCH BULLETIN VOLUME 12 (1991) @ \$15.00.

\$15.00

2. Please send back UNBOUND volumes @ \$12.00 per volume

B-191

Volume: \$ 1-1980 \$ 2-1981 \$ 3-1982 \$ 4-1983 \$ 5-1984

\$ 6-1985 \$ 7-1986 \$ 8-1987 \$ 9-1988 \$ 10-1989 \$ 11-1990 \$

3. Please send BOUND volumes @ \$25.00 per volume

Volume: \$ 1-1980 \$ 2-1981 \$ 3-1982 \$ 4-1983 \$ 5-1984

\$ 6-1985 \$ 7-1986 \$ 8-1987 \$ 9-1988 \$ 10-1989 \$ 11-1990 \$

4. UPCHURCH RESEARCH FUND:

Research: \$

MEMORIAL GIFT: \$

\$

(For memorial gifts please indicate name of person(s) being memorialized: (Mother, Father, Brother, Sister, Aunt, Uncle, Child, Grandparents, etc.).

(This will be published in the UPCHURCH BULLETIN)

NAME: RELATIONSHIP

Reid's DEC 1990 ch # 4662 for 15 signed 28 NOV Miller A. Reid

LTC Willis A. Reid, Jr & Janet W. Reid 897-9625 TOTAL

\$15.00

Make check payable to: MICHAEL ENTERPRISES.

Mail to: MICHAEL ENTERPRISES, P. O. Box 35804, Tucson, AZ 85740

NAME: Willis A. Reid, Jr. ADDRESS: 6210 Hollins Drive CITY: Bethesda STATE MD ZIP 20817

Gift(s) (Payment included above).

Send to:

NAME:

ADDRESS:

CITY: STATE ZIP

*A few subscriptions are available for those on a restricted budget. Please write for details.

WILLIS ALTON REID, JR

RID-21981

MICHAEL ENTERPRISES

P. O. BOX 35804
TUCSON, ARIZONA 85740

NOVEMBER 1989

INVOICE

UPCHURCH BULLETIN, Volume 11 (1990) will be published at the same rate of \$15.00 per year. Subscriptions for renewal are requested for the new four issues which will be published. We encourage you to also contribute to the UPCHURCH RESEARCH FUND so that we may collect and publish interesting information, or honor our loved ones. BOUND and UNBOUND issues are available on all back issues. Give a gift to a relative or a friend.

1. Please enter my subscription* to the UPCHURCH BULLETIN 1990 (Vol. 11) @ \$15.00.

\$ 15.00 B-3-90

2. Please send back UNBOUND volumes @ \$12.00 per volume

Rec'd 30 NOV 89 ch # 4174 for 15 unpaid - Willis A. Reid Jr

Volume: 1-1980 2-1981 3-1982 4-1983 5-1984

WTC Willis A. Reid Jr. & Janet W. Reid

6-1985 7-1986 8-1987 9-1988 10-1989

3. Please send BOUND volumes @ \$25.00 per volume

897 9625

Volume: 1-1980 2-1981 3-1982 4-1983 5-1984

6-1985 7-1986 8-1987 9-1988 10-1989

4. UPCHURCH RESEARCH FUND:

Research: \$

MEMORIAL GIFT: \$

(For memorial gifts please indicate name of person(s) being memorialized: (Mother, Father, Brother, Sister, Aunt, Uncle, Child, Grandparents, etc.).

(This will be published in the UPCHURCH BULLETIN)

NAME: RELATIONSHIP

TOTAL

\$ 15.00

Make check payable to: MICHAEL ENTERPRISES.

Mail to: MICHAEL ENTERPRISES, P. O. Box 35804, Tucson, AZ 85740

NAME: Willis A. Reid, Jr.
ADDRESS: 6210 Hollins Drive
CITY: Bethesda STATE MD ZIP 20817

Gift(s) (Payment included above).

Send to:

NAME:
ADDRESS:
CITY: STATE ZIP

*A few subscriptions are available for those on a restricted budget. Please write for details.

12 February 1989

□ Dear Cousin Phil,

On re-reading this letter I've come to the decision, ^{that} in due consideration of the possible sensitivities of surviving (some of them) descendants of William Nathan Phillips and Mary Susan Ray, my statements concerning his "condition" at the time of his death and her "treatment" by the Phillips family when remarrying (Hugie Patterson) are best kept between us and should not appear in print. To do so may offend someone and I'm the one who would end paying for it.

- Agreed?

□ Willis

→ [WILLIS ALTON REID, SA]

△ P.S. - You might have known my father from your years at N.C. State. He started there on the Chemistry faculty in 1930 after graduating from Wake Forest College. Except for a break in the late 1930's for a Ph.D. at the University of Wisconsin. He taught general and organic chemistry there for over 40 years until retiring in 1975. If there's a good fishing hole in Wake County, he knows it!

- P.P.S. Throughout the materials contained herein, I've used "ca" (=about) for marriage dates when they were determined from a marriage bond (unless the bond specifically stated the date of the wedding). Routinely, the ceremony actually occurred after the bond was posted.

† note - photo of Thomas Yates Baker, Sr in Photo File 89-9
 photo of home built by Richard Sandeen Baker in Photo File 89-10

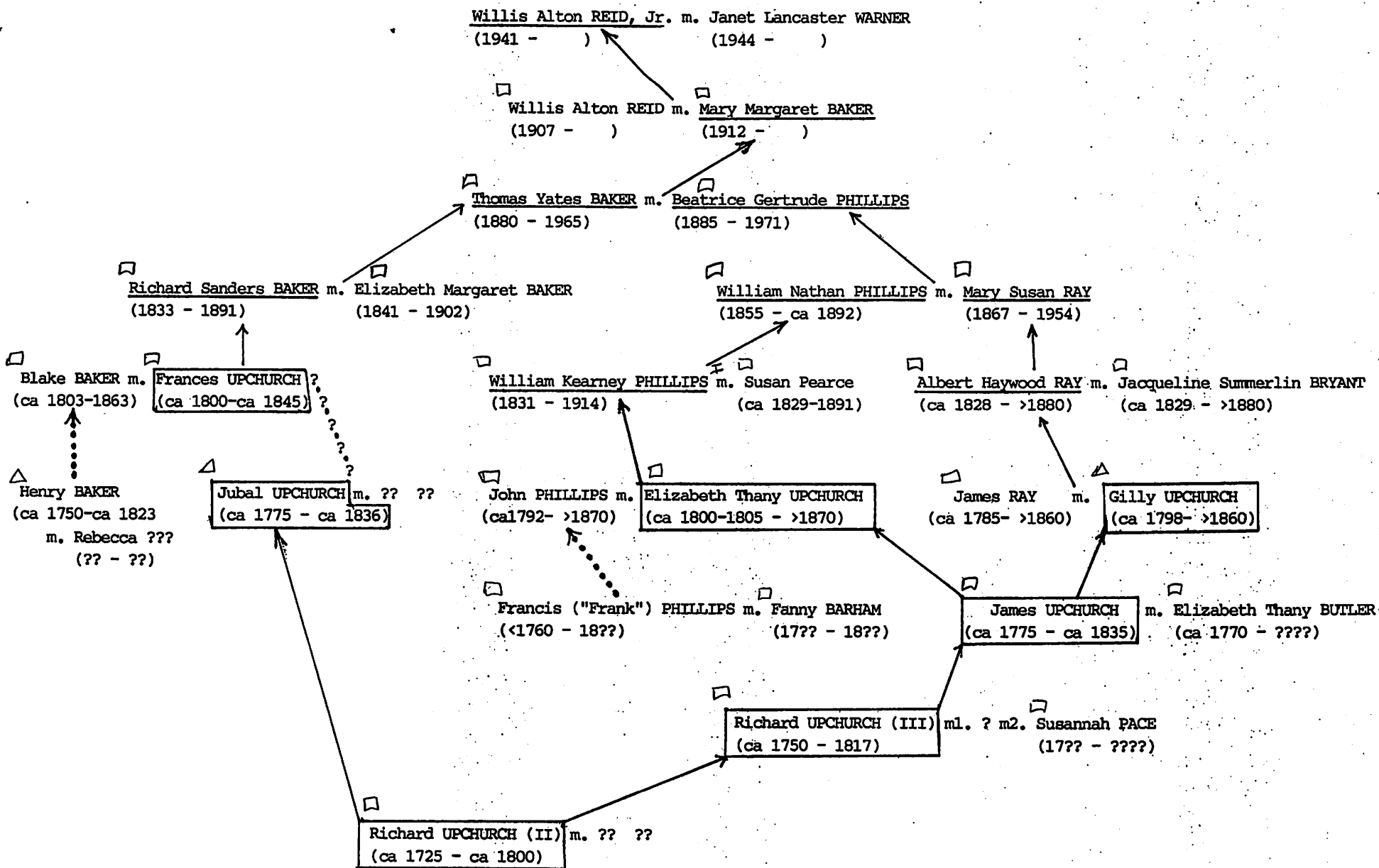

(underline) = UPCHURCH descendant

-----> = Line of descent from Richard UPCHURCH (II)

[] = UPCHURCH ancestor

?.?.?.?.?.?.?.? = Line of descent is circumstantial and speculative, but possible

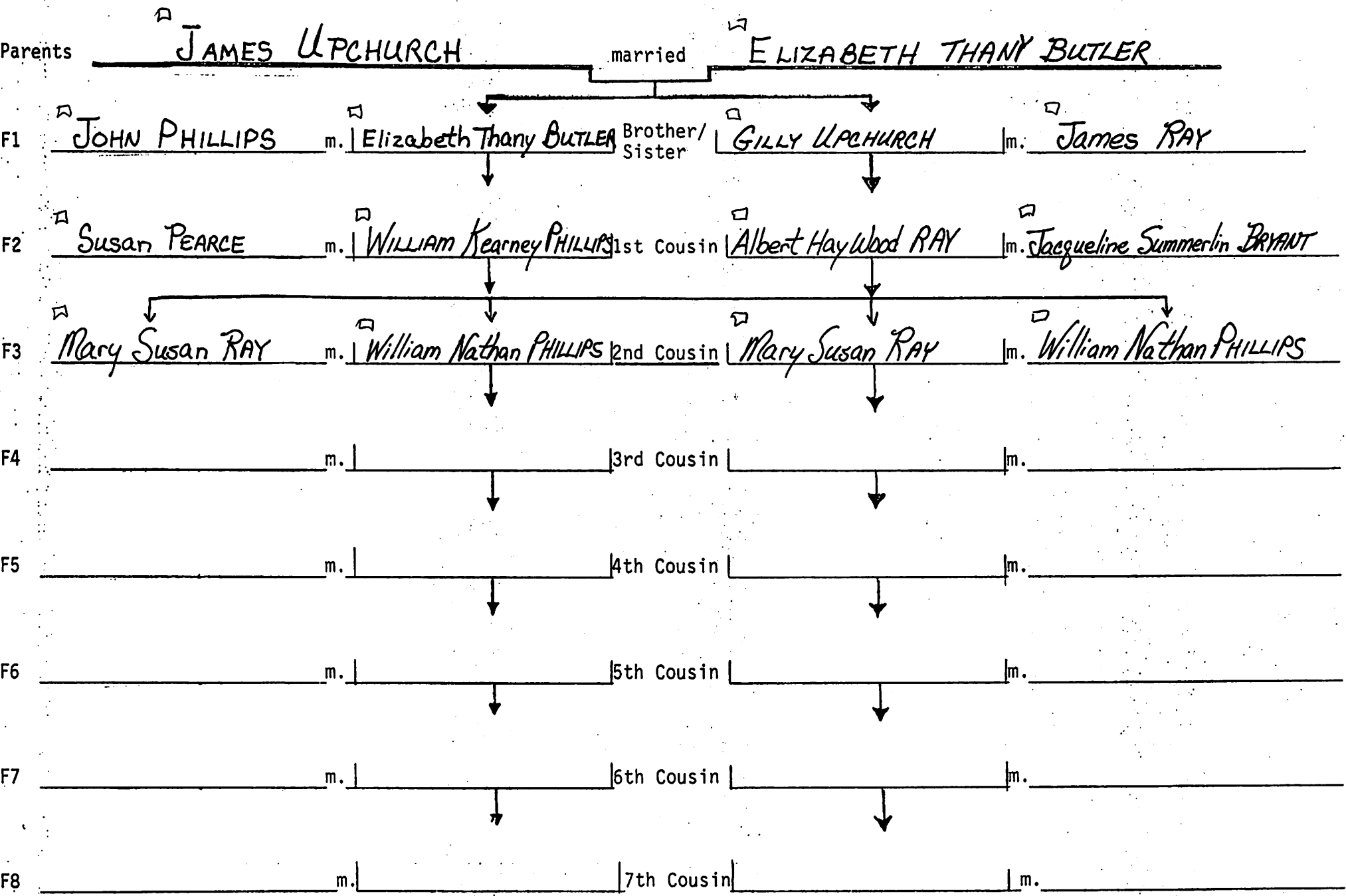

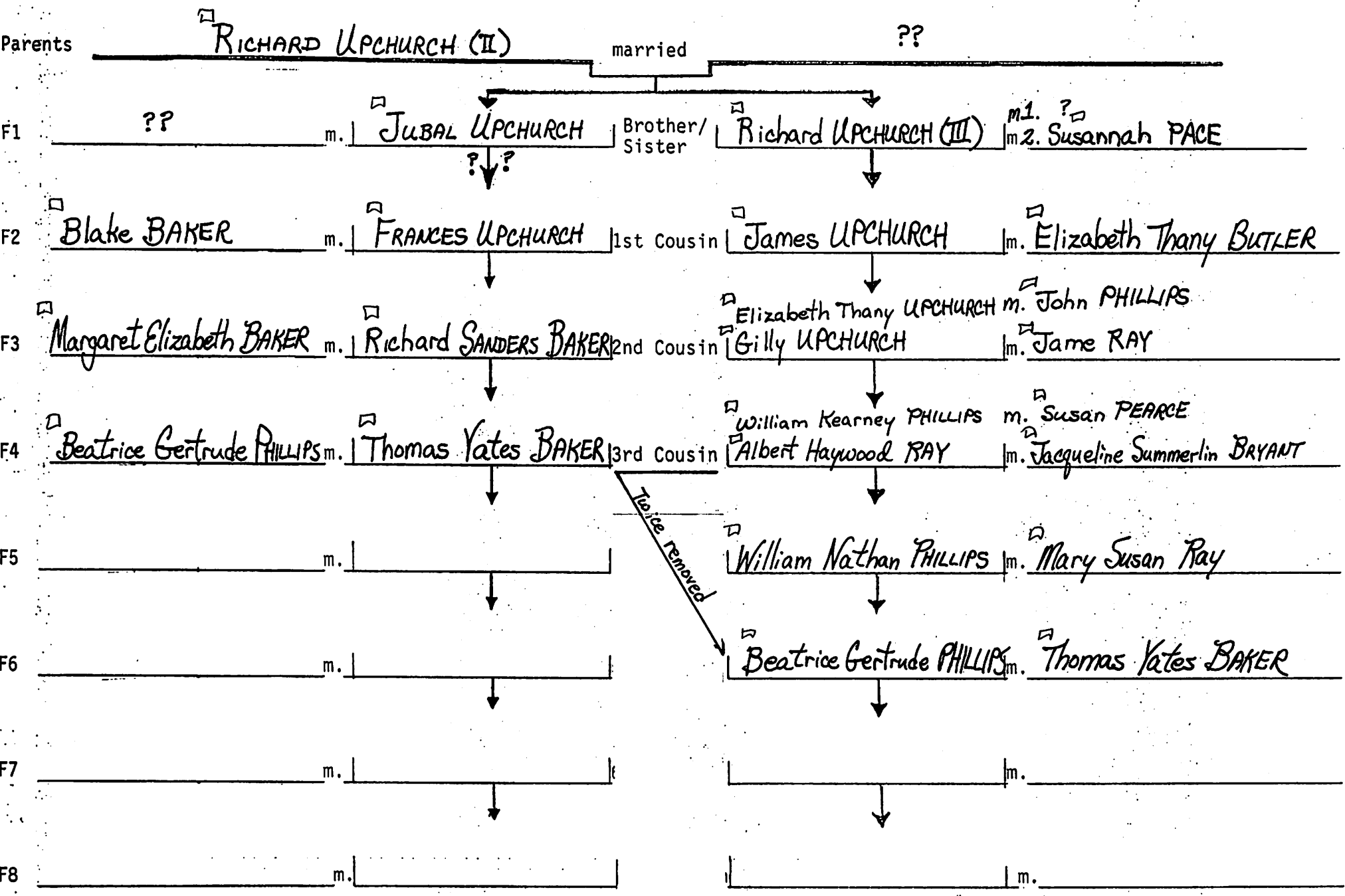

WILLIS A. REID, JR., PH.D.

6210 HOLLINS DRIVE

BETHESDA, MARYLAND 20817

Phone (301) 897-9625

11 February, 1989

Mr. R. P. Upchurch
- c/o Michael Enterprises
- P.O. Box 35804
- Tucson, Arizona 85740

Dear Mr. Upchurch:

Your letter of 7 January, 1989 beat me to the draw. I had been informed of you and the Upchurch Bulletin last fall by our mutual cousin, Fritz McDuffie of Oak Ridge, TN, and have been meaning to write to you ever since. Before doing that, however, I felt obliged to spend a few weekends in the Library of Congress reviewing past issues of the Bulletin. I had not heard of this publication before, but found it fascinating reading. To be quite truthful, I have not spent very much time on the UPCHURCH side of my family until now. Most of my on-again, off-again researches have concentrated on the BAKER family. I was stimulated first by Fritz McDuffie, and then the Bulletin, to broaden my horizons to the UPCHURCH/PHILLIPS/RAY lines. In the process I have been developing family group sheets on various family members. Many of these have rather glaring holes and gaps in them so it will be some time before I can provide a complete set of data. The attached outlines are only those basic to my ancestry.

I (Willis Alton REID, Jr.) was born in Raleigh, NC (Rex Hospital to be exact) 15 Sep 1941. My parents are Willis Alton REID of Nash Co. (Whitakers/Red Oak area) and Mary Margaret (BAKER) REID of Wake Co. (Moccasin Creek area in Little River District). I attended Needham B. Broughton High School (Class of '59), North Carolina State College (B.S. in Zoology, 1963), the University of Kansas (M.A. in Zoology/Parasitology, 1965), and North Carolina State University (Ph.D. in Zoology/Parasitology, 1970). I entered active duty in the U.S. Army Medical Service Corps in 1965 and have now served 23 1/2 years of continuous commissioned service. I married Janet Lancaster WARNER (of Palm Beach, FL, but born in Boston, MA) 24 April 1966. She has a B.S. from Duke University (1966) and M.S. (1969) and Ph.D (1978) in Zoology from North Carolina State University. She was born 18 Oct 1944. We have two sons: Blake Dietrich REID, born 27 July 1971 in Rex Hospital, Raleigh, NC and Alexander Nathan REID, born 19 Sep 1974 at Walter Reed Army Hospital in Washington, DC. The names "Blake" and "Nathan" have family significance on my side of the family, as you will see below. My parents had only one other child, my sister Margaret ("Margie") Beatrice REID, born 21 July 1938 in Raleigh, NC. She is unmarried, and elementary school teacher in Raleigh, NC (Ravenscroft School).

My Great great grandfather was the Blake BAKER who married Frances UPCHURCH (Wake Co. marriage bond posted 16 Nov 1829). I would like to make a case for her being a "lost" daughter of Jubal UPCHURCH. In a 1986 issue of the Upchurch Bulletin [7(1):13-21] you stated that "there was another daughter of Jubal Upchurch, but her name has not been learned. We speculate that she married as a young woman and lived in the Franklin Co., NC area and had children." You go further, on page 21, to list her as "VI. Unknown daughter". According to rough calculations from the 1830 Franklin Co. census, Frances

Δ UPCHURCH was born between 1800 and 1810 (this assumes that she was the free
 Δ white female between 20 and 30 years old in the household of Blake BAKER).
 □ This age would put her in the same contemporary age group as the other children
 □ of Jubal UPCHURCH which you listed. In the 1840 Wake Co. Census, there were
 Δ two females 30-40 years old in Blake BAKER's household. Secondly, I note that
 □+□ the "Unknown Daughter's" sister, Charlotte UPCHURCH, married a John SANDERS
 in 1833 and that in 1829 an Edwin SANDERS was the bondsman for the marriage
 □+□ bond of Blake BAKER and Frances UPCHURCH. They (Blake and Frances) named a
 □ son (my great grandfather) Richard Sanders BAKER. It is apparent that the
 - SANDERS family was close to the BAKER and UPCHURCH families. Thirdly, the
 □ name "Richard" is not a common given name in the BAKER family; it is (as
 - you well know) the basic given name in the UPCHURCH family. It is likely that
 Δ Frances UPCHURCH had a hand in naming her son for an UPCHURCH family member.
 □ I have been unable to find any other leads to the parentage of Frances UPCHURCH. The fact
 - that the marriage bond was posted in Wake Co., instead of Franklin Co., is
 □ something of a sticking point, since there is no indication that the Jubal
 - UPCHURCH family were ever Wake Co. residents. However, considering the back
 - and forth movement of families in the Moccasin Creek area across the county
 □ line, I am becoming more inclined to treat the region almost as an independent
 □+□ jurisdiction in itself. The Blake BAKER-Frances UPCHURCH marriage was number
 - 30 on your list of UPCHURCH marriages in the Upchurch Bulletin 4(4):149-151
 Δ (1983). For the moment, I am assuming that Frances UPCHURCH was the daughter
 □ of Jubal UPCHURCH. If you have more information on this, I would certainly
 - appreciate it.

□ Frances (UPCHURCH) BAKER apparently died between 1840 and 1846, since she
 Δ+Δ is not listed in the Blake BAKER household in 1850, and Blake BAKER remarried
 +Δ Margaret BUNN in 1846. Blake BAKER had a total of 12 children, but only 5 of
 □ them (the children of Frances UPCHURCH BAKER) are UPCHURCH descendants. Two
 Δ+Δ of these (Richard Sanders BAKER and Thomas H. BAKER) were Confederate soldiers
 Δ in Company K, 24th North Carolina Regiment. Thomas H. BAKER was wounded
 - "gunshot with ilium fracture" at Sailors Creek, VA, captured, and later died at
 Δ Fort McHenry Post Hospital (Baltimore, MD). Richard Sanders BAKER was wounded
 - "miniball in the arm" at the Battle of Seven Pines, was captured at Petersburg
 □ late in the war, and was released at Fort Deleware. He enlisted as a 3rd
 - Lieutenant and came home a Captain. I have his original commissioning
 - paper when the unit was first formed as the "Poplar Spring Greys".

□ My grandmother's (Beatrice Gertrude PHILLIPS BAKER) side of the family is
 - replete with UPCHURCHs. It was not until I started looking into this that
 □ I discovered that my grandmother and my grandfather (Thomas Yates BAKER)
 □ were actually third cousins (if the Frances UPCHURCH ancestry case mentioned
 □+□ above holds up). Her parents (William Nathan PHILLIPS and Mary Susan RAY)
 - were also cousins. I will not go into complete narratives of each of these
 - families as they are well outlined on the attached sheets. In short it appears
 □ that I am descended from Richard UPCHURCH (II) by three different lines:
 □+□ 1. via Frances UPCHURCH and Blake BAKER (if my postulate about Frances
 □ UPCHURCH's father holds water); 2. via Elizabeth Thany UPCHURCH and
 □+□+□ John PHILLIPS; 3. via Gilly UPCHURCH and James RAY. There may be a forth
 □+□ descendancy line if Susan PEARCE (the first wife of William Kearney PHILLIPS)
 - is an UPCHURCH. I have seen this stated but have not seen any source of
 - that information. Can you enlighten me any more on this?

□+□+□ Beatrice Gertrude PHILLIPS' mother was Mary Susan RAY, daughter of Albert
 Δ+□ Haywood RAY and Jacqueline Summerlin BRYANT, grand daughter of James RAY
 □+□+□ and Gilly UPCHURCH. I knew her as "Grandma Susan". She married William
 - Nathan PHILLIPS when she was only 17 and they had 5 children (see attached
 - sheet). I remember only one of these (other than my grandmother) - "Uncle

△ Kearney" (William Kearney PHILLIPS, Jr.), who lived in Henderson, NC. He
 - liked to get the woodworking from old houses that were being torn down and
 - rework the wood into useful items. Our family is full of such "Uncle
 - Kearney things" as lamps, tables and candlesticks. Even though he was
 □ called "Jr." William Kearney PHILLIPS was his grandfather, not his father.
 △ Jefferson Haywood PHILLIPS died in 1958 from a heart attack here in
 - Washington, DC while carrying groceries. I do not think that he ever
 □ married. The Willie G. PHILLIPS that you inquired about was actually
 □ Wilhelmina G. PHILLIPS. She died unmarried at Dorothea Dix State Hospital
 △ in Raleigh, NC. I was told that Frank Judson PHILLIPS was a "gambler in
 - Ohio", that he married and had 2 children, one of whom was living in
 - California.

△ William Nathan PHILLIPS died fairly young in 1891 or 1892. There are con-
 - flicting accounts of how he died, some say he fell off his horse and others
 - say he fell down the stairs. The prevailing opinion is that, whichever it
 △ was, he was*intoxicated at the time. However, his death left Mary Susan a

[MARY SUSAN RAY]
 [BEATRICE GERTRUDE PHILLIPS]

* see note on front

- 25 year old widow with 5 kids. All of the children went to live with their
 △ grandfather, William Kearney PHILLIPS, who lived only a couple of miles away,
 □ + △ and he provided for their upbringing and education. My grandmother attended
 - the Oxford (NC) Female Seminary for one year and attended school for a year
 △ in New Jersey, living with her aunt and uncle, Elizabeth Davis (PHILLIPS)
 □ + □ and Marshall V. McDUFFIE (the grandparents of Fritz McDUFFIE). I remember her
 - as an inveterate reader, an educated woman who could actually read Latin!
 △ + △ Mary Susan (RAY) PHILLIPS remarried Hugie PATTERSON and you will find her
 - under his household in the 1900 Wake Co. Census. Actually, her son
 △ + △ Jefferson PHILLIPS is listed with them (he is listed as "stepson" to Hugie
 - PATTERSON) but he may have only been visiting at the time the census taker
 △ + △ came around. She had three children by her second marriage: Patricia
 △ + △ PATTERSON, Mary PATTERSON, and Clyde PATTERSON (I am sorry but I do not have
 - the vital statistics on these children.) My information is that the PHILLIPS
 △ + △ family felt that Mary Susan was marrying beneath her station, since Hugie
 □ + * □ PATTERSON was only a tenant farmer, but I haven't found any evidence that she
 △ + △ was actually ostracized for this. She is buried with her 2nd husband in a
 - small roadside family plot on County Road #2309 near Duke's Lake, in Wake Co.

△ You are, of course, familiar with the autobiography of William Kearney
 □ PHILLIPS. From reading this alone, one would get the impression that he was
 - a man of successful but somewhat modest means. That is an understatement!
 - Among numerous family papers uncovered after my grandparents' deaths, are
 △ + △ copies of W. K. PHILLIPS' estate papers, for which my grandfather, T.Y.
 △ BAKER, was one of three executors. A copy of W. K. PHILLIPS' 1914 will
 - (written in 1911) is enclosed. You will note that the properties that were
 - divided among his heirs included: 22 tracts of land in Wake and Franklin
 - Counties, totaling more than 2,220 acres; 4 lots with houses in Zebulon, NC;
 □ 4 lots without houses in Zebulon, NC; and one sale and feed stables. His
 - cash distributions totaled more than \$23,000 (in 1917 dollars) and the
 - contents of his safe contained over 70 promissory notes totaling more than
 - \$40,000 and secured by mortgages, deeds of trust, livestock, etc! (although
 - many of these were considered "uncollectible")(I am enclosing a copy of
 △ that inventory as well). It appears that Mr. PHILLIPS was not only a farmer
 - and a merchant; he was the Moccasin Creek Banker, as well!

- I am still compiling the PHILLIPS/RAY/UPCHURCH connections to my BAKER
 - lines and will be happy to correspond concerning these particular issues. I
 - am particularly interested in confirming my postulation relative to the
 □ + □ ancestry of Frances UPCHURCH and in getting more information about James
 □ + □ RAY (who married Gilly UPCHURCH), Susan PEARCE (wife of William Kearney

|

+ PHILLIPS), and Jacky BRYANT (wife of Albert Haywood RAY). I am afraid,
 - however, that you will have to bear with me on tardiness in writing. Until
 - I retire from the Army and have time to go into it full time I am limited to
 - only occassional visits to the National Archives, Library of Congress etc.
 - and scattered evenings when I can concentrate for any extended period. My
 - wife says if I can make money at it she will let me buy an IBM-PC to replace
 - this little old Kaypro 4; I may take her up on it and go pro. In the meantime,
 - please find enclosed a check for \$15.00 for my subscription to the Upchurch
 - Bulletin (1989).

Sincerely,
 Willis A. Reid, Jr.
 Willis A. Reid, Jr.

- P.S. Copies of two photographs are also enclosed. One is of the original
 "Richard BAKER Homeplace", located in Wake County on Road #2338 on the way
 - to Pearces in Franklin County. The adjoining property to this is now the
 - Zebulon Country Club. The photograph was probably taken about 1905, since
 - the house went through a major rebuilding in 1911. and again the the 1950s.
 - This original log cabin is now the living room of the current house, where
 my aunt Gladys BAKER now lives (Route #3, Zebulon, NC). The person standing
 in the front yard is my grandfather, Thomas Yates BAKER. The house was
 originally built by Richard Sanders BAKER. The other photograph is of
 Thomas Yates BAKER taken about 5 years before his death in 1965 (he died
 - in an automobile accident of U.S. 64 just east of Zebulon).

WALTER REED ARMY INSTITUTE OF RESEARCH
 Washington, D.C. 20307-5100



WILLIS A. REID, JR.
 LIEUTENANT COLONEL, MSC, USA

Office: (301) 427-5029
 Autovon: 291-5029
 Residence: (301) 897-9625

Chief, Department of Parasitology
 Division of Experimental Therapeutics

+ DESCENDANTS OF THOMAS YATES BAKER AND BEATRICE GERTRUDE PHILLIPS
 + [son of Richard Sanders BAKER and Elizabeth Margaret BAKER of Wake Co., NC]
 + [daughter of William Nathan PHILLIPS and Mary Susan RAY of Franklin Co., NC]

Thomas Yates BAKER:
 - b. 7 Mar 1880 (Wake Co., NC);
 - d. 5 April 1965 (Wake Co., NC);
 - bur. Baker Family Cemetery, Baker Road #2338, Rt. #3, Zebulon, Wake Co., NC.
 m. 15 Oct 1905 to Beatrice Gertrude PHILLIPS Of Franklin Co., NC
 - b. 18 July 1885 (Franklin Co., NC);
 - d. 28 July 1971 (Mary Elizabeth Hospital, Raleigh, Wake Co., NC);
 - bur. Baker Family Cemetery, Baker Road #2338, Rt. #3, Zebulon, Wake Co., NC.
 - Issue:

1. Beatrice Gladys BAKER:
 - b. 29 Dec 1906 (Wake Co., NC);
 d. [in 1989 living in the BAKER Homeplace ("Richard Baker Homeplace"), Baker Road #2338, Rt. #3, Zebulon, Wake Co., NC].
 - Unmarried/no issue.

2. Elizabeth Helen BAKER:
 - b. 25 Oct 1908 (Wake Co., NC);
 - d. 23 May 1987 (Wake Co., NC),
 - bur. 25 May, 1987, Zebulon (NC) City Cemetery.
 m. 15 Oct 1930 to James Roy JOYNER (of Wake Co., NC):
 - b. ?
 - d. [in 1989 living in Wake Co., NC]

+ Issue: See "Descendants of Elizabeth Helen BAKER & James Roy JOYNER" file.

3. Mary Margaret BAKER:
 - b. 21 Mar 1912;
 - d. [in 1989 living at 1439 Dixie Trail, Raleigh, Wake Co., NC.]
 m. 14 Oct 1933 to Willis Alton REID (of Nash Co., NC):
 - b. 6 Aug 1907 (Nash Co., NC);
 - d. [in 1989 living at 1439 Dixie Trail, Raleigh, Wake Co., NC.]

+ Issue: See "Descendants of Mary Margaret BAKER & Willis Alton REID" file

4. Thomas Yates BAKER, Jr.:
 - b. 8 Sep 1915 (Wake Co., NC);
 - d. 17 Aug 1958 (Raleigh, Wake Co., NC)
 - bur. Baker Family Cemetery, Baker Road #2338, Rt. #3, Zebulon, Wake Co., NC.
 m. 8 Feb 1941 to Margaret Irene GARDNER (of ? Co., NC):
 - b. ? ;
 - d. [in 1989 living in Cary, Wake Co., NC]

+ Issue: See "Descendants of Thomas Yates BAKER, Jr & Margaret Irene GARDNER" file.

DESCENDANTS OF RICHARD SANDERS BAKER AND ELIZABETH ("BETTIE") MARGARET BAKER
 [son of Blake BAKER & Frances UPCHURCH][dua of William J. BAKER & Eliza HOPKINS]

10

Richard Sanders BAKER:

b. 19 Mar 1833 (Wake or Franklin Co., NC)

d. 18 Dec 1891 (Wake co., NC)

bur. Baker Family Cemetery, Baker Road #2338, Wake Co., NC.

m. ca 20 Dec 1865 to Elizabeth Margaret ("Bettie") BAKER

b. 21 Jan 1841

d. 7 Nov 1902 (Wake Co., NC)

bur. Baker Family Cemetery, Baker Road #2338, Wake Co., NC.

Issue:

1. Eliza ("Lila") F. BAKER:

b. 8 Apr 1867 (Wake Co., NC);

d. 9 Dec 1870 (Wake Co., NC);

bur. Baker Family Cemetery, Baker Road #2338, Zebulon, Wake Co., NC.

No Issue (died in childhood)

2. Solon BAKER:

b. 17 July 1869 (Wake Co., NC);

d. ??

m1. 21 July 1897 to Mary S. BAKER:

b. ?

d. 15 Sep 1903

Issue of m1: See "Descendants of Solon BAKER" File.

m2. Mensie ("Mancie") PERRY (of Wake Forest, Wake Co., NC), 16 Dec 1903

b. ??

d. ??

Issue of m2: See "Descendants of Solon BAKER" File.

3. Francis ("Frank") Marion BAKER:

b. 8 Feb 1871;

d. 23 Feb 1951.

m. 23 Feb 1898 to Lelia ("Lela") CHEVES (of Franklin Co., NC) "at Jim Cheves' residence".

Issue: See "Descendants of Francis Marion BAKER" File.

4. Grace Truman BAKER:

b. 30 Jan 1872 (Wake Co., NC);

d. ??

m. 19 May 1898 to J. Henry FOWLER (son of M. L. FOWLER, a "cotton buyer in Hattiesburg, MS").

Issue: See "Descendants of Grace Truman BAKER" File.

5. Geneva ("Neva", "Nevie") Gray BAKER:

b. 15 Mar 1874 (Wake Co., NC);

d. 21 Mar 1952 (Wake co., NC);

bur. Stallings Cemetery near Hopkins Community (Wake Co., NC).

m. 25 Dec 1900 to Ebbie Cooke STALLINGS (son of George Baskville and Rowena (BUNN) STALLINGS): b. 9 July 1879, d. >1969.

Issue: See "Descendants of Geneva Gray BAKER" File.

6. Willis Walters BAKER:

b. 28 July 1878 (Wake Co., NC);

d. 7 or 8 Feb 1971 (Fayetteville, Cumberland Co., NC)

m. 2 Sep 1914 to Caroline ("Carrie") McQUEEN of Fayetteville, Cumberland Co., NC):

b. ? .

d. ? .

Issue: See "Descendants of Willis Walters BAKER" File.

7. Thomas Yates BAKER:

b. 7 Mar 1880 (Wake Co., NC);

d. 5 April 1965 (Wake Co., NC);

bur. Baker Family Cemetery, Baker Road #2338, Rt. #3, Zebulon, Wake Co., NC.

m. 15 Oct 1905 to Beatrice Gertrude PHILLIPS (dau of William Nathan PHILLIPS and Mary Susan RAY of Franklin Co., NC)

b. 18 July 1885 (Franklin Co., NC);

d. 28 July 1971 (Mary Elizabeth Hospital, Raleigh, Wake Co., NC);

bur. Baker Family Cemetery, Baker Road #2338, Rt. #3, Zebulon, Wake Co., NC.

Issue: See "Descendants of Thomas Yates BAKER" File.

8. Mat Ransom BAKER:

b. 7 Aug 1875 (Wake Co., NC);

d. 29 Sep 1875 (Wake Co. NC);

bur. Baker Family Cemetery, Baker Road #2338, Rt. #3, Zebulon, Wake Co., NC.

No Issue.

DESCENDANTS OF BLAKE BAKER AND FRANCES UPCHURCH

Blake BAKER (son of Henry BAKER of Franklin Co., NC) was born ca 1803 or 1804, according to Federal Census Records. He lived most of his adult life in Wake Co., NC on the Moccasin Creek boundary with Franklin Co. He died intestate on 21 Jan 1863 in Wake Co and his son Richard Sanders BAKER was named the executor of his estate. Blake BAKER married twice. He first married Frances UPCHURCH (Wake Co. marriage bond posted 16 Nov 1829). For several reasons it is thought that she was the daughter of Jubal UPCHURCH (b. ca 1775 [VA?], d. ca 1836 [NC]) of Franklin Co., NC; the granddaughter of Richard UPCHURCH (b. ca 1725 [VA], d. ca 1800 [VA]) of Surry Co.(?), VA; and the great great great granddaughter of Michael UPCHURCH (b. ca 1620 in England, d. ca 1681 in VA), the progenitor of the UPCHURCH clan in America. She died between 1840 and 1846. The children of Blake BAKER and Frances UPCHURCH were:

Blake BAKER:

b. ca 1803/4 (Franklin Co., NC)
d. 21 Jan 1863 (Wake Co., NC)
m. ca 16 Nov 1829 (Wake Co.) to Frances UPCHURCH
b. ca 1800 - 1810
d. ca 1840 - 1846

Issue:

1. Thomas H. BAKER:

b. ca 1831;
d. 21 May 1865 (CSA, POW, Ft. McHenry Post Hospital, Baltimore, MD),
bur. "near hospital".
Unmarried?/no known issue.

2. Jasper BAKER:

b. ca 1833;
d. ?? ;
m. ca 10 Jan 1882 to Virginia HICKS.

3. Richard Sanders BAKER:

b. 19 Mar 1833 (Wake Co., NC)
d. 18 Dec 1891 (Wake Co., NC)
bur. Baker Family Cemetery, Baker Road #2338, Wake Co., NC.
m. 20 Dec 1865 to Elizabeth "Bettie" Margaret BAKER:
b. 21 Jan 1841;
d. 7 Nov 1902 (Wake Co., NC);
bur. Baker Family Cemetery, Baker Road #2338, Wake Co., NC.
Issue: See "Descendants of Richard Sanders Baker" File

4. Augustus BAKER:

b. ca 1835/6;
d. >1860 ;
m. ??
Issue: Insufficient data

5. Agnes C. BAKER:

b. ca 1838/9;
d. >1880 (in 1880 living in Wake Co., NC)
m. ca 6 Dec 1865 (Wake Co. mb) to Atlas J. STALLINGS (son of Bryant STALLINGS and Nancy ??):
b. ca 1839/40,
d. >1880.
Issue: See "Descendants of Agnes C. Baker" File

DESCENDANTS OF BLAKE BAKER AND MARGARET BUNN

13

Blake BAKER (son of Henry BAKER of Franklin Co., NC) was born ca 1803 or 1804, according to Federal Census Records. He lived most of his adult life in Wake Co., NC on the Moccasin Creek boundary with Franklin Co. He died intestate 21 Jan 1863 in Wake Co. Blake BAKER married twice. He first married Frances UPCHURCH (Wake Co. marriage bond posted 16 Nov 1829). He married second Margaret BUNN (ca 27 Nov 1846, Wake Co. marriage bond). She was born ca 1806 and died after 1880. The children of the second marriage were:

Blake BAKER:

b. ca 1803/4 (Franklin Co., NC)

d. 21 Jan 1863 (Wake Co., NC)

m2. 27 Nov 1846 to Margaret BUNN (Wake Co., NC mb)

Issue:

1. Joseph B. BAKER:

b. ca 1847

d. ??

m. 23 Nov 1875 to Alamance PHILLIPS (daughter of William Kearney and Nancy (PEARCE) PHILLIPS of Franklin Co., NC)

Issue: See "Descendants of Joseph B. BAKER and Alamance PHILLIPS" file

2. Burwell BAKER:

b. 19 Nov 1847

d. ca 1919

m. 13 Feb 1879 to Clara WHITLEY of Wake Co., NC

Issue: See "Descendants of Burwell BAKER & Clara WHITLEY" file.

3. Rebecca ("Becky") BAKER:

b. ca 1853

d. ??

m. ?? to James Adolphus ("Dollie") FERRELL

Issue: see "Descendants of Rebecca BAKER & James Adolphus FERRELL" file

4. Wesley ("Wes") BAKER

b. 8 Feb 1857

d. 10 Oct 1930

m. 4 Jan 1899 to Idis ALFORD

Issue: none (Idis BAKER and the newborn died during first childbirth. Wes

BAKER never remarried and lived with his brother Benjamin and family.

5. John D. BAKER:

b. ca 1857

d. ??

m. ?? to "Zedie" FRAZIER of Youngsville, Franklin Co., NC

Issue: Insufficient data

6. Benjamin BAKER:

b. 12 Mar 1860

d. 21 Jun 1928

m. 22 Feb 1882 to Emily Jane JOYNER

b. 7 Sep 1860

d. 3 Jun 1932

Issue: See "Descendants of Benjamin BAKER & Emily Jane Joyner" file

7. Leanora M. BAKER:

b. ??

d. 15 Sep 1863

Unmarried/ No Issue

DESCENDANTS OF JAMES RAY & GILLY UPCHURCH

B:DESCJR

4

□+□

△ James RAY:

— b. ca 1785

— d. >1860 (presumably in Wake Co., NC)

□+□ m. ??? to Gilly UPCHURCH [dau of James UPCHURCH (ca 1775-ca 1835) and

□ Elizabeth Thaney (BUTLER) UPCHURCH (ca 1770 - ??), both of Wake Co., NC;

□+□ sister of Elizabeth UPCHURCH, wife John PHILLIPS]

— b. ca 1798

— d. >1860

— Issue:

you have him listed as "Alvin" in the UB

□ 1. Albert Haywood RAY:

— b. ca 1828 (Wake Co., NC)

— d. >1880

□ m. ca 6 Nov 1853 to Jacqueline ("Jacky") Summerlin BRYANT of Franklin Co., NC.

□+□ Issue: See "Descendants of Albert Haywood RAY & Jacqueline Summerlin (BRYANT) RAY."

△ 2. Thomas RAY:

— b. ca 1838 (Wake Co., NC)

— d. >1895

□ m. ca 29 Oct 1866 to Martha STALLINGS (Wake Co., NC mb)

— Issue: Insufficient data

△ 3. Bryant RAY:

— b. ca 1839 (Wake Co., NC)

— d. >1860

— m. ??

— Issue: Insufficient data

△ 4. Norman RAY:

— b. ca 1842 (Wake Co., NC)

— d. >1860

□ m. ?? to Nancy POWELL

— Issue: Insufficient data

△ 5. Burwell J. RAY:

— b. ca 1833 (Wake Co., NC)

— d. > 1895

△ m1. ca 6 Feb 1856 to Elizabeth Jane JEANS (GEAN)(of Wake Co., NC)

△ m2. >1880 to Piety HICKS

△+△+△ Issue: "Doc", Penina, Tommy + others(?)

△ 6. Henderson RAY:

— b. <1830

— d. >1895

△ m. ca 7 Feb 1849 to Annie (Emma) PRIVETTE (PRIVOTT)(of Wake Co., NC)

△+△ Issue: Green, Levin + others(?)

△ 7. Thaney (Thena) RAY:

— b. <1830

— d. ??

△ m. ca 15 Mar 1842 to Israel PRIVETTE (of Wake Co., NC)

— Issue: Insufficient data

□ + □ DESCENDANTS OF JAMES RAY & GILLY UPCHURCH (page 2)

△ 8. Lizzie RAY:

— b. <1830
— d. ??

□ + △ + △ m. ?? to Fernie WIGGS (an Elizabeth RAY married John WIGGS in Wake Co., NC ca 18 Dec 1840)
— Issue: Insufficient data

△ 9. Candace (Ross?) RAY:

— b. <1825
— d. ??

△ + △ m. ?ca 18 Jun 1836 to a DENTON (a Candis RAY married Willie M. GLENN in Wake Co., NC ca 1 Jan 1848)
— Issue: Insufficient data

- Sources: Wake County Censuses for 1860, 1870, 1880; Upchurch Bulletin 1(1): 19-23 (1980)"...Outline of the James Upchurch Subclan..." ; Upchurch Bulletin "Ray-Upchurch Reunion of Moccasin Creek North Carolina" 9(1):37 (1988) (children 6-9) ; Marriage Bonds of Wake and Franklin Cos. (Ingmire, F. T., 1984)

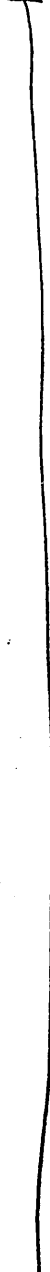

△ John PHILLIPS:

— b. ca 1792

△ d. <4 Dec 1876 (date of probate of will is John PHILLIPS, Franklin Co., NC)

△ + □ m. ca 14 Aug 1821 to Elizabeth Thany UPCHURCH (daughter of James and

□ Thany (BUTLER) UPCHURCH of Franklin Co., NC)

— b. ca 1796

△ d. >1880 (living with son Little Berry PHILLIPS in 1880 Franklin Co., NC Census)

— Issue:

□ 1. Son

△ 2. Presley J. PHILLIPS

— b. ca 1822/3

— d. 1860-1870

△ m. ca 3 Feb 1841 to Mary PEARCE of Franklin Co., NC

— b. ca 1824/5

— d. >1870

□ + □ Issue: See "Descendants of Presley J. PHILLIPS & Mary PEARCE" file.

□ 3. Daughter

— b. 18??

□ d. ca 1833 (first memory of William Kearney PHILLIPS in his autobiography)

△ 4. William Kearney PHILLIPS:

— b. 25 Jan 1831

— d. 1914

□ m1. 12 Oct 1851 to Susan PEARCE

— b. ca 1829

— d. 7 Mar 1891

□ Issue: See "Descendants of William Kearney Phillips" File

□ m2. 9 Dec 1891 to Mrs Nancy H. HARRIS (nee CHAMBLEE)

— b. ?? Mar 1834

— d. >1910

— No Issue to m2

△ + △ 5. John B.(?) PHILLIPS ["J. B. PHILLIPS" of John PHILLIPS' 1872 Franklin Co. will?]:

— b. ca 1834

— d. 1850-1872

△ m. ca 7 Oct 1852 a "Jack" B. PHILLIPS posted a marriage bond for marriage of Charlotte UPCHURCH in Franklin Co., NC.

△ + △ 6. Little Berry PHILLIPS ("L. B. PHILLIPS" of John PHILLIPS' 1872 Franklin Co. will?):

— b. 30 Apr 1838

— d. 9 May 1922

— bur. City Cemetery, Raleigh, Wake Co., NC

△ + △ m. ca 2 Dec 1866 to Rosa C. BAKER (Franklin Co. mb)(Dau of Henry and Caroline (BRAIM) BAKER of Franklin Co., NC)

— b. ca 1843

— d. ??

□ Sources: William Kearney PHILLIPS autobiography; Franklin Co. NC Census 1850, 1860, 1870, 1880; Will of John PHILLIPS, 1872, Franklin Co., NC; "Little Berry Phillips" Upchurch Bulletin (1988) 9(1):5-7

DESCENDANTS OF WILLIAM KEARNEY PHILLIPS

△ William Kearney PHILLIPS:

- b. 25 Jan 1831 (Franklin Co., NC)
- d. ca 5 Aug 1914 (Franklin Co., NC will probate date)
- ml. 12 Oct 1851 to Susan PEARCE (Franklin Co. marriage bond posted 7 Oct 1851)
 - b. ca 1829
 - d. 7 Mar 1891

- Issue:

- △ 1. Elizabeth Susan PHILLIPS:
 - b. 10 Sep 1852 (Franklin Co., NC)
 - d. 6 Jan 1857
 - Unmarried/No Issue

△ 2. Alamance ("Alamancy", "Mance", "Mancy") PHILLIPS:

- b. 26 Jan 1854
- d. >1914

- + □ + □ m. 23 Dec 1875 to Joseph B. BAKER (son of Blake and Margaret BUNN BAKER of Wake Co., NC)
 - b. ca 1848
 - d. ??

□ + □ Issue: See "Descendants of Joseph B. & Alamance PHILLIPS BAKER" file.

□ 3. William Nathan PHILLIPS:

- b. 12 Sep 1855
- d. 1892
- m. ca 1883 to Mary Susan RAY
 - b. 22 Jun 1867
 - d. 10 Oct 1954

□ Issue: See "Descendants of William Nathan PHILLIPS" file.

□ 4. Williford Kearney PHILLIPS:

- b. 13 Mar 1857
- d. 15 May 1858
- Unmarried/No Issue.

□ 5. Erastus Buchanan PHILLIPS:

- b. 4 July 185? (probably 1859 rather than 1857, since Williford K. PHILLIPS was born less than 4 months earlier)
- d. 1 Dec 1862
- Unmarried/No Issue

□ 6. Elizabeth Davis PHILLIPS:

- b. 27 Nov 1860
- d. >1914
- m. to Marshall V. McDUFFIE

□ + □ Issue: See "Descendants of Elizabeth Davis PHILLIPS McDUFFIE" file.

□ m2. 9 Dec 1891 to Mrs Nancy H. HARRIS (nee CHAMBLEE)

- b. ?? Mar 1834
- d. >1910
- No Issue to m2

□ + □ Sources: William Kearney PHILLIPS autobiography; William Kearney PHILLIPS will (Franklin Co., NC, 1914); William Kearney PHILLIPS family bible; Census Records; Cemetery Records.

William Kearney PHILLIPS (WKP), in his 1908 autobiography, stated that his grand-
 father Frank PHILLIPS moved to Wake County, NC from Southampton County, VA late
 in the 18th Century and "settled on a plantation near Penny Hill". The Penny Hill
 area is located in what is now Little River District of Wake County, on the west
 side of N.C. Route 96 near Mitchell's Mill Pond and Fowler's Crossroads. Penny
 Hill Lake is fed by Fowlers Mill Creek, a tributary of Little River. WKP also
 stated that Frank PHILLIPS met and married his wife, Fanny BARHAM, after moving
 to Wake County. Fritz McDuffie relates that he has found rather convincing evi-
 dence in the southern Virginia records that Frank PHILLIPS married Fannie BARHAM
 in Southampton County, VA (30 Jan 1787) before he moved to N.C. This is a logical
 error on WKP's part, since the BARHAM family was prominent in Wake County during
 his (WKP's) time. It is possible that Frank PHILLIPS, his wife Fanny, and several
 BARHAM family members immigrated together. There is still a Wake County Community
 of BARHAM in Little River District, on the Franklin County line (north of N.C.
 Route 96, south of U.S. 401). Both of the names "Frank" and "Francis" appear in
 the official Wake County records. I am assuming them to be the same person. He
 is listed in the 1790 Census for Hillsborough of Wake County (household of 1
 male >16 years, 1 male <16 years, 1 free white female, & 7 slaves). He is also
 listed in the 1800 and 1810 censuses. Between 1796 and 1799 he witnessed 4 land
 sale transactions, at least one occurring in Little River District (one on
 Little River, one on "Juliuses Branch and on the county line", and on the east
 side of "Powels Creek" and one on Crabtree Creek. I presume that "Frank" is the
 usual nickname for "Francis", and that he moved to Wake County sometime during
 the 13 year period between his 1787 marriage and the 1790 Census. WKP stated
 that Frank PHILLIPS moved to western N.C. with his entire family except son John
 "in the early part of the nineteenth century." This presumably would have occurred
 after 1810, and would therefore have been to Buncombe, Burke, Ashe, Wilkes, Surry,
 Iredell, Lincoln or Rutherford Counties.

Frank (Francis?) PHILLIPS:

- b. <1760
- d. 18??
- Δ m. 30 Jan 1787 to Fanny BARHAM in Southampton Co., VA
- Issue:

1. Billie PHILLIPS:

- b. 17??
- d. 18??
- m. ?
- Issue: Insufficient data

2. Ben (Benjamin?) PHILLIPS:

- b. 17??
- d. 18??
- m. ?
- Issue: Insufficient data

3. Barham PHILLIPS:

- b. 17??
- d. 18??
- m. ?
- Issue: Insufficient data

4. Dollie PHILLIPS:

- b. 17??
- d. 18??
- m. ?
- Issue: Insufficient data.

5. John PHILLIPS:

- b. ca 1792
- d. >1870

Δ + □ + □ m. ca 14 Aug 1821 to Elizabeth Thany UPCHURCH (dau of James and Thany
 (BUTLER) UPCHURCH of Franklin Co., NC)
 - b. ca 1800
 - d. >1870

□ Issue: See "Descendants of John PHILLIPS" file.

+ DESCENDANTS OF ALBERT HAYWOOD RAY & JACQUELINE SUMMERLIN BRYANT
 + [Son of James RAY & Gilly UPCHURCH of Wake Co., NC]
 + [Daughter of ?? BRYANT and ?? ??]

△ Albert Haywood RAY:

- b. ca 1828 (Wake Co., NC)
- d. >1880 (Wake Co., NC)

△ m. ca 11 Jun 1853 to Jacqueline Simmerlin BRYANT

- Issue:

1. Bryant W. RAY:

- b. ca 1855 (Wake Co., NC)
- d. ??
- m. ??
- Issue: Insufficient data

2. Monroe H. RAY:

- b. ca 1856/7 (Wake Co., NC)
- d. ??
- m. ??
- Issue: Insufficient data

3. John D. RAY:

- b. ca 1858/9 (Wake Co., NC)
- d. ??
- m. ??
- Issue: Insufficient data

4. Ann A. RAY:

- b. ca 1860-1862 (Wake Co., NC)
- d. ??
- m. ??
- Issue: Insufficient data

△ 5. Joseph H. RAY:

- b. 12 Dec 1862 (Wake Co., NC)
- d. 26 Feb 1936
- bur. Hopkins Chapel Baptist Church Cemetery, Wake Co., NC
- m. ?? ?? to Mary HORTON
- Issue: Insufficient data

6. George W. RAY:

- b. 9 Nov 1864 (Wake Co., NC)
- d. 3 Oct 1937
- bur. Hopkins Chapel Baptist Church Cemetery, Wake Co., NC
- m. ?? ?? to Joe Ella FERRELL
- Issue: Insufficient data

△ 7. Mary Susan RAY:

- b. 22 Jun 1867 (Wake Co., NC)
- d. 10 Oct 1954 (Wake Co., NC)
- bur. Family Cemetery at site of Old Ray Schoolhouse, near Hopkins Chapel and Dukes Lake, Wake Co., NC
- m. to William Nathan PHILLIPS of Franklin Co., NC

+ Issue: See "Descendants of William Nathan PHILLIPS & Mary Susan RAY" file.

□ - □ DESCENDANTS OF ALBERT HAYWOOD RAY & JACQUELINE SUMMERLIN BRYANT (page 2)

□ 8. Elizabeth J. RAY:

— b. ca 1869

— d. ??

— m. ??

— Issue: Insufficient data

□ 9. Martha E. RAY:

— b. ca 1872

— d. ??

— m. ??

— Issue: Insufficient data

— Sources: Federal Census, Wake Co., NC - 1870, 1880; Cemetery Records; Wake & Franklin County marriage bonds.

DESCENDANTS OF WILLIAM NATHAN PHILLIPS

△ William Nathan PHILLIPS:

- b. 12 Sep 1855
- d. 1892
- + □ m. ca 1883 to Mary Susan RAY (dau of Albert H. RAY and Jacqueline BRYANT RAY, of Wake Co., NC)
- b. 22 Jun 1867
- d. 10 Oct 1954
- Issue: See below

□ 1. Beatrice Gertrude PHILLIPS

- b. 18 Jul 1885 (Franklin Co., NC)
- d. 28 Jul 1971 (Raleigh, Wake Co., NC)
- bur. Baker Family Cemetery, Baker Road #2338, Zebulon, Wake Co., NC.
- + □ m. 15 Oct 1905 to Thomas Yates BAKER [son of Richard Sanders and Elizabeth Margaret ("Bettie") (BAKER) BAKER of Wake Co., NC]
- b. 7 Mar 1880 (Wake Co., NC)
- d. 5 Apr 1965 (Wake Co., NC)
- bur. Baker Family Cemetery, Baker Road #2338, Zebulon, Wake Co., NC
- Issue: See "Descendants of Thomas Yates BAKER" file.

△ 2. Frank Judson PHILLIPS

- b. Jan 1887
- d. ??
- m. ??
- Issue: Insufficient data

△ 3. William Kearney PHILLIPS, Jr. (or, more accurately, II)

- b. 18 Mar 1889
- d. 1971 (Mary Parham Hospital, Henderson, NC)
- bur. Sunset Memorial Gardens, Henderson, NC
- △ m. ?? to Effie BARKER
- b. ca 1883
- d. 23 Mar 1973 (Henderson, NC)

△ 4. Jefferson Haywood PHILLIPS

- b. ? Jan 1891 (Franklin Co., NC)
- d. 1 Feb 1958 (Washington, DC)
- m. ??
- Issue: Insufficient data

△ 5. Wilhelmina ("Willie") G. PHILLIPS

- b. Mar 1893
- d. ?? at Dorothea Dix State Hospital, Raleigh, Wake Co., NC
- Unmarried/no issue

□ + □ DESCENDANTS OF THOMAS YATES BAKER, JR. & MARGARET IRENE GARDNER
 □ + □ [son of Thomas Yates BAKER and Beatrice Gertrude PHILLIPS of Wake Co., NC]
 - [daughter of ?? GARDNER and ?? ??]

□ Thomas Yates BAKER, Jr.:

- b. 8 Sep 1915 (Wake Co., NC);
- d. 17 Aug 1958 (Raleigh, Wake Co., NC)
- bur. Baker Family Cemetery, Baker Road #2338, Rt. #3, Zebulon, Wake Co., NC.
- m. 8 Feb 1941 to Margaret Irene GARDNER (of ? Co., NC):
- b. ?
- d. [in 1989 living in Cary, Wake Co., NC]
- △ m2. 197? to Jack PETERSON

- Issue:

△ 1. Peggy Nash BAKER:

- b. 21 Sep 1941;
- d. [in 1988 living in Fort Mill, SC.]
- △ m. 5 Jun 1965 to John Parry FERN, Jr. (of Cherry Hill, NJ):
- b. ?
- d. [in 1989 living in Fort Mill, SC]
- No issue.

△ 2. Thomas Yates BAKER, III:

- b. 10 May 1945;
- d. [in 1989 living in in Raleigh, Wake Co., NC.]
- △ m1. ? to Brenda Kay BURGESS of Winston Salem, NC.
- No Issue in m1.

- △ m2. ? to Gwendolyn STRICKLAND of Wake Co., NC
- b. ??
- d. [in 1989 living in Raleigh, Wake Co., NC]

- Issue:

△ a. Thomas Yates BAKER, IV:

- b. ca 1979.
- d. [in 1989 living in Raleigh, Wake Co., NC]
- Unmarried/no issue

DESCENDANTS OF ELIZABETH HELEN BAKER & JAMES ROY JOYNER

□ + □ [daughter of Thomas Yates BAKER and Beatrice Gertrude PHILLIPS of Wake Co., NC]
- [son of ?? Joyner and ?? ?? of Wake Co., NC]

□ Elizabeth Helen BAKER:

- b. 25 Oct 1908 (Wake Co., NC);
- d. 23 May 1987 (Wake Co., NC),
- bur. 25 May, 1987, Zebulon (NC) City Cemetery.
□ m. 15 Oct 1930 to James Roy JOYNER (of Wake Co., NC):
- b. ?
- d. [in 1989 living in Wake Co., NC]

- Issue:

△ 1. Betty Baker JOYNER:

- b. 7 Aug 1931;
- d. [in 1989 living in Houston, TX].
△ m. 11 Aug 1951 to Clifton Earl CRANDELL of Pitt Co., NC.
- b. ??
- d. [in 1989 living in Houston, TX]

□ + □ Issue: See "Descendants of Betty Baker JOYNER and Clifton Earl CRANDELL" file

△ 2. Jimmy Yates JOYNER:

- b. 13 Aug 1935;
- d. [in 1989 living at Rt. #5, Box 230, Zebulon, NC.]
△ m. 28 Mar 1959 to Ruth Mary TEMPLE of Wake Co., NC.:
- b. 10 Jun 1936
- d. [in 1989 living at Rt. #5, Zebulon, NC]

□ + □ Issue: See "Descendants of Jimmy Yates JOYNER and Ruth Mary TEMPLE" file

△ 3. Jean Helen JOYNER:

- b. 10 Nov 1938;
- d. [in 1989 living at Rt. # 5, Zebulon, NC.]
△ m. 5 Jun 1961 to Donald Wayne WILLIAMS of Wake Co., NC.
- b. ??
- d. ??

□ + □ Issue: See "Descendants of Jean Helen JOYNER and Donald Wayne WILLIAMS" file

△ 4. Richard Patrick JOYNER:

- b. 5 Mar 1945;
- d. [in 1989 living at Rt. #5, Zebulon, Wake Co., NC.]
△ m. 1 Jun 1969 to Bonnie Lou MURRAY of Wake Co., NC.
- b. ??
- d. [in 1989 living at Rt. #5, Zebulon, Wake Co., NC]

□ + □ Issue: See "Descendants of Richard Patrick JOYNER and Bonnie Lou MURRAY" file

- △ + □ DESCENDANTS OF WILLIS ALTON REID & MARY MARGARET BAKER
- △ + △ [Son of Eaton Willis REID & Malinda Gray MOORE of Nash Co., NC]
- + □ [daughter of Thomas Yates BAKER & Beatrice Gertrude PHILLIPS of Wake Co., NC]

□ Mary Margaret BAKER:

- b. 21 Mar 1912;
- d. [in 1989 living at 1439 Dixie Trail, Raleigh, Wake Co., NC.]
- m. 14 Oct 1933 to Willis Alton REID (of Nash Co., NC):
- b. 6 Aug 1907 (Nash Co., NC);
- d. [in 1989 living at 1439 Dixie Trail, Raleigh, Wake Co., NC.]
- Issue:

△ 1. Margaret ("Margie") Beatrice REID:

- b. 21 July 1938 (Raleigh, Wake Co., NC)
- d. [in 1989 living at 6015 Sentinel Drive, Raleigh, Wake Co., NC.]
- Unmarried, no issue.

□ 2. Willis Alton REID, Jr.:

- b. 15 Sep 1941 (Rex Hospital, Raleigh, Wake Co., NC);
- d. [in 1989 living at 6210 Hollins Drive, Bethesda, Montgomery Co., MD].

△ m. Janet Lancaster WARNER:

- △ b. 18 Oct 1944 (Boston, MA, daughter of Clarence Steffens and Elizabeth Tyler (LANCASTER) WARNER);
- △ d. [in 1989 living at 6210 Hollins Drive, Bethesda, Montgomery Co., MD].

- Issue:

△ a. Blake Dietrich REID:

- b. 27 July 1971 (Rex Hospital, Raleigh, Wake Co., NC);
- d. [in 1989 living at 6210 Hollins Drive, Bethesda, Montgomery Co., MD].
- Unmarried, no issue.

△ b. Alexander Nathan REID:

- b. 19 Sep 1974 (Walter Reed Army Medical Center, Washington, DC)
- d. [in 1989 living at 6210 Hollins Drive, Bethesda, Montgomery Co., MD].
- Unmarried, no issue.

□+□ Soures: Personal knowledge; personal communication - Willis Alton REID and Mary Margaret (BAKER) REID; Family Bible Records; Birth Certificates; Marriage Licenses.

WILLIS ALTON REID, JR XFD-21981

6 MAY 1989

DR WILLIS A. REID, JR
6210 HOLLINS DRIVE
BETHESDA, MD 20817

Dear Cousin Willie,

It has taken me much longer to process your letter of 11 FEB 89 with its many enclosures than I thought likely. This is because it contained such a large volume of relevant information and because I have been pressed to do a number of other things. The past week I returned to it for the third major session and just this AM have finished a complete extraction. The Will & Inventory together furnished me over 200 profile sheets. And now I have just read the profile on William Kearney Phillips, I - what a person!

I am delighted with what you have done and agree that Thomas d 1700-1845 is the missing dau of Jubal U. I don't have proof but everything fits.

As for Susan Pearce who was WKP, I, we know she was the dau of William Pearce b 23 MAY 1803 and her wife was Susan U. Enclosed is a copy of my three page profile on Susan U. My

and you in 1970 from a year or so ago. Perhaps we can do better now. It would be helpful if we could have a better estimate of her age. If she were born in 1770 as the census shows there would be the question of whether or not she would have been on the 1790 census. If she was born in 1790 it seems highly unlikely that she was a daughter of Richard II and this reinforces the validity of the assumption that she was a girl of Richard II by one of his sons. Any light you can shed on this linkage will be appreciated.

I was quite fascinated by the map you sent. The main body of Upper Verde land on the Mojave Creek area on the Franklin side but some got over into Utah. My GGGF Nathan II, I found a tract in Utah very close to your books. If my memory serves me right it was bounded by S.D. Roads 2337, 2338, 2309 + 1001. It first showed up in due course. That would have been ca 1800.

Well, I can assure you in a sentence to help each other. I'll gladly send copies of whatever I have that could be useful to you.

Let me ask some questions to this point bearing upon current/recent generations.

- 1) If you yourself
- a) where were you married?

2) For your parents

- where were they married?
- when and where was your mother born?

3) For Thomas Yaler Baker, Jr

- where was he married?

4) For Elizabeth Helen Baker

- where did she marry?
- when and where was James Roy Jagers born?
- did she have just four children?
- where were her four children born?
- when were her four children married?
- when and where was Captain Earl Cardell born?
- when was Ruth Mary Temple born?
- when and where was David Wayne Williams born?
- when and where was Bonnie Lou Murray born?
- did/does she have any grandchildren? If so, details?

5) For Thomas Yaler Baker, Jr

- where did he marry?
- when and where was Margaret Irene Gardner born?
- did he have just two children?

6) For Peggy Ann Baker

- where was she born?
- when did she marry?
- when and where was John Barry Fern, Jr born?

7) For Thomas Yaler Baker, III

- where was he born?
- when + where was he married the 1st & 2nd times?
- when and where was Brenda Kay Burgess born?
- what is the full maiden name of Gwendolyn Strickland when & where was she born & who was her father?
- did/does he have just one child?
- when and where was Thomas Yaler Baker III born?

you may not know all of the above details but anything you have or can get will be appreciated. This would complete the master outline for the family of Thomas Tilton Baker, Sr.

The Inventory for William Conway Phillips, Jr shows a Joseph B. Baker in one place and a Benjamin Baker in another. Do you suppose these are one and the same? If so it gives me a full name.

There is a bundle that was James B. Baker. Can you conclude if he is or is not a son of Beche Baker?

I will leave in mind the questions issue related to William Nathan Phillips, his wife & her 2nd wy. The will is so constructed so that such things can be kept out of the lime light. They are, however, important to our understanding of our family heritage

It is with a great deal of pleasure that I recall your father. It would have been 40+ years ago that I took Organic Chemistry from him and it served me well. I remember him later as a senior member of the faculty and as a kind and cordially southern gentleman. My wife holds from Wash Co (Mammoth Spring Hope). Give him my regards.

With my sincere wishes, in case you can use them as our share with others

Sincerely yours
Phil Williams
[ROBERT PHILLIP WILKINSON]

WILLIS ALTON REID, JR

XID-21981

MICHAEL ENTERPRISES
P. O. BOX 35804
TUCSON, ARIZONA 85740

November 1988

I N V O I C E

Now is the time to subscribe to the 1989 (Volume 10) issues of UPCHURCH BULLETIN so the publication can come to you without interruption. We continue to charge \$15.00 per year for the four issues. Financial contributions to the UPCHURCH RESEARCH FUND are encouraged so that we may collect and publish interesting information on our family. BOUND AND UNBOUND issues are available for the years 1980-1988 and may be ordered on this form. Also, think of giving the UPCHURCH BULLETIN to a relative or friend as a gift.

1. Please enter my subscription* to the UPCHURCH BULLETIN for 1989 (Volume 10) for which I enclose \$15.00.

\$ 15.00 B-4-89

2. Please send me back UNBOUND volumes of the UPCHURCH BULLETIN for which I enclose \$12.00 for each year desired:

VOLUME:	1-1980	(\$ _____)	6-1985	(\$ _____)
	2-1981	(\$ _____)	7-1986	(\$ _____)
	3-1982	(\$ _____)	8-1987	(\$ _____)
	4-1983	(\$ _____)	9-1988	(\$ _____)
	5-1984	(\$ _____)		

*Rec'd 18 FEB 89
4397 for 15 mgmt
12 FEB Willis A. Reid
LTC Willis A. Reid, Jr
Janet W. Reid.*

Total enclosed for UNBOUND\$ _____

897-9625

3. Please send me back BOUND volumes of the UPCHURCH BULLETIN for which I enclose \$25.00 for each year desired:

VOLUME:	1-1980	(\$ _____)	6-1985	(\$ _____)
	2-1981	(\$ _____)	7-1986	(\$ _____)
	3-1982	(\$ _____)	8-1987	(\$ _____)
	4-1983	(\$ _____)	9-1988	(\$ _____)
	5-1984	(\$ _____)		

Total enclosed for BOUND \$ _____

4. Please accept the extra sum of money enclosed for the UPCHURCH RESEARCH FUND. If this is a MEMORIAL GIFT please indicate the name of person(s) being memorialized: (Mother, Father, Brother, Sister, Aunt, Uncle, Child, Grandparents, etc.).

NAME: _____ RELATIONSHIP _____
(This will be published in the UPCHURCH BULLETIN.)

TOTAL

\$ 15.00

Make check payable to: MICHAEL ENTERPRISES.

Mail to: MICHAEL ENTERPRISES, P. O. BOX 35804, TUCSON, AZ 85740.

Your current mailing address:

NAME Willis A. Reid, Jr.
ADDRESS 6210 Hollins Drive
CITY Bethesda STATE MD ZIP 20817

GIFT(s): (Payment included above).

Sent to:
NAME _____
ADDRESS _____
CITY _____ STATE _____ ZIP _____

*A few subscriptions are available at a reduced rate for those on a restricted or severely restricted budget. Please write for details.

WILLIS ALTON

REID, JR X10-21981

7 JAN 1939

DR. WILLIS A. REID JR
6210 HOLLINS DRIVE
BETHESDA, MD 20817

Dear Dr Reid,

My subscription to the N.C. Genealogical Society journal accidentally lapsed. In catching up on this publication I acquired the past 1938 issue last week and was delighted to see your entry on the William Kearney Phillips Bible. This provided some new information for me and I dropped everything to extract and record the details.

As you will see from the enclosed sheets I am keenly interested in the entire extended Upchurch family. William Kearney Phillips was the daughter of Elizabeth Upchurch, I know her lineage back to England. Also, her wife was the daughter of Susan Upchurch. I have not been able to fit Susan into the fold yet but hope to do so.

My Upchurch ancestor arrived in the Mousen Creek Area of central N.C. (New southern Franklin Co) about 1755. They lived side by side with the Phillips Babers and intermarried.

All of this, of course, is leading up to ask about the depth of your interest in your family history and about the prospect of exchanging details with you. You and I are cousins (distant). I'd be glad to send a sketch of our line back to Michael U, if you so desire showing how we are related.

William Kearney Phillips wrote a short autobiography which I have published in the U.S.. Do you have access to this? (the autobiography?) I also published a picture of his brother Little Benny Phillips and a little story about him. I have visited the family cemetery of William Kearney Phillips in Franklin Co, NC. Have you seen this?

Could you supply any of the following:

- 1) For yourself
 - a) what does the 'A' in your name stand for?
 - b) when and where were you born?
 - c) Did you marry / have children? If so, details?
 - d) what was the full maiden name of your mother and when and where was she born?
- 2) For Beatrice Gertrude Phillips
 - a) when and where did she marry?
 - b) what were the names of her children?
 - c) who was the father of Thomas Tyler Baker

3) For William Nathan Phillips

a) what ~~was~~ his wife's full maiden name
(I have only Mary S. —)

b) Did he have just 2 children - your
GM - Beatrice Gertrude Phillips and another
G. Phillips (?). These are the two I have.

Please ~~let~~ me know if you have
any questions about your heritage in
N.C. I may not be able to answer
but I have a huge reference file that
applies to central N.C.

Sincerely yours
Phil Upchurch

[ROBERT PHILLIP UPCHURCH]