

Williford Upchurch

XID-49358

Commentary: Williford Upchurch (XID 49358) was the son of James Upchurch VII and grandson of Richard Upchurch III, head of Clan #4. Williford is thought to have been born circa 1797 in Franklin County, NC. Williford Upchurch married 1820 (Franklin Co, NC) Frances Gay, daughter of Thomas Gay. On 16 Nov 1829 Frances (Gay) Upchurch married Blake Baker. It is presumed that Williford Upchurch died before this marriage and had left his wife a widow.

Jay Buck 9 Nov 2016

Acknowledgements: The following Biofile was transcribed by Carla Michaels, collaborator and volunteer at our Cary Facility in Wake County, NC.

(1) Per attachment #32 West letter of 18 May 1975 to RPU- Franklin Co, NC Marriage Bonds- Williford Upchurch married Frances Gay 19 Dec 1820- Bondsman and witness: Simeon Carpenter and S. Patterson. Williford Upchurch = son of James Upchurch, VII and gs/o Richard Upchurch, III.

(2) See page 26 of 2 Feb 1978 letter Elna E. Burkhalter to RPU
A search for land sale for Benjamin Upchurch, none located Vol. 22 1825-26 and refers to adjacent lands of Jubal, Berkley, Williford, Britton, Littleberry, and heirs of Benjamin, deceased. No will or inventory found.

(3) See Deed File for land transfer James Upchurch to Frances Upchurch
In this deed written 15 Nov 1829 for &100 James Upchurch of Franklin Co, NC sells 200 acres in Wake Co, NC on south side of Moccasin Creek to Frances Upchurch of Wake Co, NC this being land James Upchurch inherited from the late Williford Upchurch as the only lawful legatee. Adjoins Green Burne, Littleberry Burne. Witnessed by Wright Young and a second person spelling unclear [maybe Letha (Young) Upchurch or Lula (Young) Upchurch]. For registration on 20 Jan 1830 which was proved by oath of Kearney Upchurch.

[Note: Above gives much new but unconnected information.

1. Who was father of Williford Upchurch- probably a son of Richard Upchurch II.
2. Was Frances Upchurch a married name or maiden name and is she 4th, 5th, or 6th generation?
3. Relationships of James Upchurch and Williford Upchurch- normal in that land goes father to son in which case James Upchurch is son of Williford Upchurch- but may not be a normal case.
4. Note that witness Wright Young has same name as person Calvin Upchurch named or his best friend to receive large inheritance following the death of Calvin's wife Agnes (Young) Upchurch.
5. Is Kearney Upchurch the gs of Richard Upchurch III or an earlier Kearney?- RPU]

(4) From Wake Treasures Vol. 3 No. 2 (Summer 1993) page 40. Bastardy Bonds and Records Wake Co, NC 1820 CR 099.102.1

Gilly Bunn/Williford Upchurch

State vs. Williford Upchurch Capia WARRANT: To Sheriff of Franklin County, Greeting: You are hereby Commanded to take the body of Williford UPCHURCH if found in your County and him safely keep so you will have him before Justices of our County Court of Pleas & Quarter Sessions to be held for county of Wake, at Court-House in Raleigh the Third Monday in November next...to Answer a charge of Bastardy committed on the body of Gilly Bun &c...Herein fail not...Witness: Benjamin S, KING AD Sept. 1820 Issued 2nd October 1820 BS

KING CC [added notes] to Hand 6 Oct 1820 To November Term 1820 Wake [on back of same]
Not found J. DINSON (DENSON?) Shff by Geo BLACKNALL.

(5) Per attachment #26 West Letter of 18 may 1975 to RPU
Grantors- Franklin Co, NC “1828 **Williford Upchurch** to John Pate- Deed of Trust Book 25 Pg. 21

(6) **Williford Upchurch** of Wake Co, NC gave a deed of trust 26 May 1827 Franklin Co, NC Deed Bk 23 Page 118 (41, Pg. 169)

(7) **Williford Upchurch** of Wake Co, NC gave a deed of trust 19 May 1828. Franklin Co, NC Deed Bk 25 Pg. 21 (41, Pg. 178) [same as item (5)]

(8) James Upchurch bought a negro, witnessed by **Williford Upchurch** 18 Apr 1814, Franklin Co, NC Deed Bk 16 Pg. 256 [41, Pg. 94]

(9) Thomas Gay deed of gift in Franklin Co, NC to his daughter, Frances Upchurch [nee Frances Gay] who intermarried with **Williford Upchurch** [**Williford Upchurch**] 2 Oct 1824 Deed Bk 21 Pg. 315 (41 Pg. 153)

(10) RPU proposal regarding **Williford Upchurch** as of 22 Sep 1996

Williford Upchurch was the son of James Upchurch, VII and the grandson of Richard Upchurch, III (Head of Clan).

There is a slot in the James Upchurch, VII household on the 1800 Census for Franklin Co, NC for a son b. 1790-1800. This son = **Williford Upchurch** born about 1797.

There is a slot in the James Upchurch, VII household on the 1810 Census for Franklin Co, NC for a son b 1794-1800. This son = **Williford Upchurch** born about 1797.

Williford Upchurch married 1820 (Franklin Co, NC) Frances Gay, daughter of Thomas Gay. On 16 Nov 1829 Frances (Gay) Upchurch married Blake Baker. It is presumed that **Williford Upchurch** died before this marriage and left his wife a widow.

On 15 Nov 1829 James Upchurch VII sells to Frances Upchurch 200 acres of land for \$100 in Wake Co, NC and states that he inherited this land from the late **Williford Upchurch** as his sole lawful legatee.

In order to explain why **Williford Upchurch** had only his father as a legatee we might assume that Williford and Frances divorced or something happened to cause Frances to have no call on the land of her late husband. We are also inclined to presume that Williford and Frances

had no living children at the time he died or they would presumably be heirs at law. It would seem Williford Upchurch died intestate.

(11) From Letter 7 Dec 1996 Willis Alton Reid, Jr. to RPU

[Concerns issue of whether the Frances Upchurch who married 16 Nov 1829 (Wake Co, NC) was daughter of Jubal Upchurch, Head of Clan or widow of **Williford Upchurch** of the Richard Upchurch, III/James Upchurch, VII Sub-clan]

Copies made for biofiles of:

Frances Upchurch

Frances Gay

Thomas Gay

Jubal Upchurch

Blake Baker

Williford Upchurch

See next page

Dear Cousin Phil

I really did receive your letter regarding Fannie GAY Wootton's speculation that Frances UPCHURCH was actually the daughter of a GAY/widow of an UPCHURCH rather than the daughter of Jubal UPCHURCH. You will recall that you asked my opinion of this. Mrs. Wootton's claim probably has merit. Although it is not prima facie evidence for the relationship, it is basically founded on two primary sources:

(1) the Franklin County Marriage bond of Williford UPCHURCH to Frances GAY (19 December 1820).

(2) the Franklin County will of Thomas GAY (written 2 February 1837), which names his daughter Frances BAKER, ~~and~~

However, Mrs. Wootton asserts that the Frances GAY of the marriage bond was the daughter of Thomas and Agnes GAY. What evidence does she have for this, i.e. that the Frances GAY of the 1820 marriage is indeed the same person as the Frances BAKER daughter/heir of Thomas GAY in 1837? She also states that the Frances GAY of the 1820 marriage bond "would have made her about 15 years old when she got married." Although 15 years is a reasonable marriageable age for a girl, I know of no evidence that this particular Frances [GAY][UPCHURCH][BAKER] was born around 1805. I estimated that Blake BAKER's wife Frances was born about 1800, but this was based on census records of age ranges of white females in the household. Neither of these gaps, however, detract from the importance and significance of two primary sources.

On the other hand, my speculation that Frances UPCHURCH was the daughter of Jubal UPCHURCH is just as shaky, if not less so. I am enclosing a copy of my 1989 letter to you, rather than repeat my arguments at the time. My argument, however, is at a disadvantage - it is not based on any primary source documents, only assumptions and unusual similarities (which may themselves have value here). On this basis, Mrs. Wootton's claims should probably have precedence. I would not make an out of hand dismissal of either.

You added some important information with the 1829 James UPCHURCH deed to Frances UPCHURCH. To me, the location of this property (in Wake County on the south side of Moccasin Creek) is most intriguing. I have detailed information on the disposition of Blake BAKER's property in this area but no information as to how he acquired some of it in the first place. I know that he acquired 418 acres in an equity deed in 1856, but he had about 355 acres more for which there are no Wake County land records indicating that he ever acquired such property. I have been speculating that he acquired the property in 1829 as a dowry of his first wife, Frances UPCHURCH, though it now seems that she already owned the property at the time of her marriage to Blake BAKER. This is further evidence for Frances UPCHURCH nee GAY rather than nee UPCHURCH. All of Blake BAKER's real estate, by the way, was in Wake County, on the south side of Moccasin Creek.

(12) Franklin Co, NC Wills- Bradley Vol. 1 Entry 356

356. JAMES UPCHURCH 1 May 1833 Mar Ct 1850 (Bk. N, p. 318)

To my wife THANY- lend to her for life 400 acres where I now live; also negroes Esther, Richard, Rilly, Abram, Clary & Harriet; livestock, household & kitchen furniture, farming utensils, crops. To my son KEARNEY- 278 acres of Mocason Creek joining Burkely Upchurch, Larkin Upchurch, John Pearce & others, where he now lives; at my wife's death, I also give him half the negroes I have lent her. To my son JIMMISON – 400 acres where I now live; the other half of my negroes that I have loaned my wife. At my wife's death, the residue of my estate to be sold & the money to be divided among my children & granddaughters as follows: GILLY RAY the wife of James Ray, ELIZABETH PHILLIPS the wife of John Phillips, CLOA COOLEY the wife of John Cooley Jr, THOMAS UPCHURCH, JIMMISON UPCHURCH & my granddaughter LECY UPCHURCH.

Ex. my son Kearney Upchurch

Wit. Matthew Strickland, Cornwell. P. Strickland, Saml Harris, Moses Harris, N. L. Harris

List of Names:

James Upchurch, VII

Kearney Upchurch

James Ray

Gilly Upchurch

Elizabeth Thaney Upchurch

John Phillips

Clea Upchurch= Cloe Jane Upchurch

John Cooley, Jr.

Cornwell P. Strickland

Moses Harris

Will file

Thany Upchurch= nee Elizabeth Thaney Butler

Burkley Upchurch

John Pearce

Thomas Upchurch [cross list under UFU less than or equal to 1850 NC Wake/Franklin border]

Jimmison Upchurch= Jamison Upchurch

Lecy Upchurch

Matthew Strickland

Samuel Harris

N. L. Harris

Larkin Upchurch

Stream file: Moccasin Creek

Note: This is the family of James Upchurch, VII- head of the Richard Upchurch III/James Upchurch VII sub-clan. Since the 1833 will of James Upchurch, VII does not mention a son

Williford Upchurch, it is presumed that Williford Upchurch died before 1833- but a best guess is that granddaughter Lecy Upchurch is the daughter of Williford Upchurch. The son Thomas Upchurch, alive in 1833 is yet to be identified otherwise in the records. RPU)

(13) Franklin Co, NC – Estate Papers 1811-1825- Vol. II Bradley 103-105

(25) JOHN WILLIAMS

17 Sep 1820. Thomas Williams (with Cordy W. Ferrell, Thomas Dunn & Loftis Pippen securities) apptd admr.

5 Oct 1820. Inventory taken by Thomas Williams. Included were 10 negroes.

Dec Ct 1820. Petition of Nancy Williams widow of John Williams dec'd vs Thomas Williams admr of sd John, Lucy, Polly, Thomas, Rebecca, William, Joseph John & Alfred Williams. She stated that her husband died owned 842 acres on Crooked Creek joining William Harrison, Jesse Richards & others; that Lucy, Polly, Thomas, Rebecca William, Joseph John & Alfred are his children. Petition for dower.

2, 3 Nov 1820 & 1 Jan & 16 Feb 1821. Sale of property by Thomas Williams admr. Buyers:

the widow	John Alford (of Jno)	James Baker Jr	Amos Bridges
Tho Broom	Simon Carpenter	Edward Cooley	Jacob H. Cooley
Jeremiah Denby	Alsey Denton	John Dunn Jr	Nat Dunn
Wm Dunn	Cordy Ferrell	Ozbon Gay	Robt C. Hall
Willis Horton	Wm Horn	Joel Jenkins	Matthew Medling
Kinchen Mullins	J. Pate	Nathan Pearce	Bailey Perry
Jeremiah Perry	Josiah D. Perry	Frederick Read	Jesse Richards
Sherrod Sanders	William Sanders	Charles Sandiford	Matthew Strickland
C. J. Strother	Jas Thompson	Buckner Upchurch	Jubal Upchurch
Wm Verrell	Nat Williams	Thos Williams	Jas Wright

Joseph Young

Negroes noted: Evans, Jerry, Green, Sam, Phillis & child, Mason with 4 children.

1 Jan 1822. Sale of property. Buyers:

Thos Broom	John Carpenter	John Dunn	Kinchen Freeman
Richd Reaveis Jr	H. W. Tharp	Littleberry Upchurch	Nancy Williams
Joseph Young			

1 Jan 1824. Hire of negroes:

Evans	Green	Jerry	Mary	Phillis & 3 children
Samuel				

Those who hired:

John Carpenter	Wm Carter	Nat Dunn	Henry Jones
Mumford Pippen	N. Williams		

Dec Ct 1825. Petition of Amos Wheelus & his wife Mary by his gdn Wm Hammonds, Alfred, Lucy, Rebecca, Thomas, Wm Henderson Williams, & Jno R. Williams, by their gdn Hardy W. Tharpe. They stated that John William died intestate 4 Jul 1820 owning 800 acres joining Wm Harrison, Jesse Richards, James Baker & others. His children were the abovesd, Mary having married sd Wheelus. Petition for division. Commissioners: Henry Baker, Nat Dunn, Everitt Pearce, Nathan Pearce, Jeremiah Tharpe, Henry Williams, Simon Williams

3 Feb 1826. Hire of negroes. Those who hired:

Nathaniel Dunn	William Edwards	William Jackson	Basdell Thomas
Nancy Williams			

1827. Negroes hired:

Boen	Celia	Green	Jane	Jerry	Mary
Phillis	Sam	Sec..y	Shute	Simon	Surry

Those who hired:

James Baker	William Carter	Loftis Pipen	William Roles
Basdil Thomas	Jubal Upchurch	Stephen Upchurch	<u>Williford Upchurch</u> ↑
Henry Williams	Nancy Williams		

Accounts 1828 - 1829 for by Lucy S., Thomas, Rebecca, William H., John R. Williams by Alfred Williams gdn.

14 Mar 1831. Alfred Williams, with Hardy Tharp & Thomas Broom securities, apptd gdn to Thomas, William H., Rebecca & John R. Williams.

Accounts 1833 - 34 for Thomas A., John H., Rebecca, William H. Williams by Alfred Williams gdn.

(14) NOTE: See Item **(4)** Pg. 2- It seems possible that the out-of-wedlock child sired by **Williford Upchurch** could be the GD Lecy Upchurch mentioned in the will of James Upchurch, VII- father of Williford Upchurch- RPU- speculation 2 Nov 2000

(15) Franklin Co, NC Will Book I, J- Bradley Pg. 52

352-(45) WILLIAM HARRISON estate sale. [Note; A long series of transactions.]

[Note: The list of transactions/names is about five pages long. The Upchurch names included are listed below:]

#1. Buyers 5, 6, 7, 8 Oct 1829: Alfred Upchurch

 Stephen Upchurch

#2 Buyers 2, 3, 4 Dec 1829: The Jubal Upchurch Plantation was rented by

 William Chamblee

 Calvin Upchurch hired slaves

#3 Buyers 5 Dec 1829 (at Cedar Creek Plantation)

 No Upchurches

#4 Buyers 8 Dec 1829 (at Home Plantation)

 Calvin Upchurch

Jones Cook Exocr. Dec Ct 1829

#5 Notes & Judgments due the estate:

 James Upchurch

 Calvin Upchurch

#6 Bad Notes & Judgments

 Jubal Upchurch

 Britton Upchurch

 Littleberry Upchurch

#7 Richard Fox- Constable Reported Receipts from Judgments

 La--- Upchurch

 Berry Upchurch

 Nancy Upchurch

 Bentley Upchurch

 Stephen Upchurch

 Calvin Upchurch

#8 Other Accounts Due:

 James Upchurch

 Larkin Upchurch

 Calvin Upchurch

Williford Upchurch, dec'd

 Dec Ct 1829

(16) From letter 22 Mar 1997 Carolyn Edwards to RPU

I. John Perry- will 1796 "Old John Perry"

A. Ann Perry

married Henry Baker

1. Elizabeth Baker

married Osborne (Ausborne) Gay*

*Thomas Gay, Sr.

1. Osborne Gay

2. Thomas Gay, Jr.

3. Agnes Gay married Ephraim Perry

4. Frances Gay married **Willifred Upchurch**

5. Aley Gay married Joseph Young

a. Agnes Young married Calvin Upchurch

b. Fenner Young married 21 Jan 1840 (Wake Co, NC) Ruth Perry

(17) Franklin Co, NC - Will Book G - Bradley - Pg. 78

672-(44) Sale of property of WILLIAMSON RICHARDS dec'd, 21 Jan 1821. Buyers were

JAMES FERRELL	AUGUSTIN HARGROVES	JOHN COOLEY	JEREMIAH WILLIAMS
ACRIL YOUNG	the widow(who hired Daniel)		ALEXANDER YOUNG
JULIUS TIMBERLAKE	LEWIS MEDLIN	HENRY HARRIS	HENRY BAKER
BAILEY GAY	WILLIAM RICHARDS	JEREMIAH WILLIAMS	JACOB ALFORD JR
DEMPSEY DENTON	OSBORN GAY	JOEL COOLEY	WILLIAM HARRISON
THOMAS GAY	JOHN RICHARDS(who hired Tom)		NATHANL. PERRY
POLLY JONES	LEAH STRICKLAND	ROBERT C. HALL	SIMON G. JEFFREYS(who
bought Mingo)	ISHAM YOUNG	CHARLES SANDIFORD	ROBERT FREEMAN
JOHN BAKER(who bought 100 acres joining MATTHEW MEDLIN)	WILLIFRED UPCHURCH ¹		
JAMES UPCHURCH	BAILEY PERRY	JOEL SANDIFORD	WILLIAM VERRILL
NATHL. WILLIAMS	THOMAS YOUNG	JOHN P. STRICTLAND	JOSEPH WINTER
JOHN PATE	Signed by WM. HARRISON admr. Jun Ct 1821.		

(18) Item in Letter 14 May 1984 Eleanor Grace Williamson to RPU

Note: Grace was looking for evidence re: the 1803 Upchurch → Carpenter name change.

NC Marriage Bonds (not all extracted)

1. Benjamin Carpenter and Nancy Hopson- 29 Nov 1828

Wake Co- Bondsman: Robert King and Witness: B. S. King

2. Simeon Carpenter and Elizabeth Pierce- 19 Mar 1808

Franklin Co- Bondsman: J(ohn) Foster; Witness: G. Hill, Jr.

3. Simeon Carpenter and Martha Bunn- 10 January 1840

Nash Co- Bondsman: Berkley Cone; Witness: B. H. Blount

4. Churchill Carpenter and Belvey Hopkins- 9 Aug 1824

Wake Co- Peter K. Hopkins, Bondsman; Witness: B. S. King

5. Jubal Upchurch and Dicey Mainord- 8 Jan 1855

Wake Co- Bondsman: Josiah C. Mainor; Witness: Thomas J. Utley

6. Wiley Upchurch and Ailsey Adams- 4 Feb 1822

Franklin Co- Bondsman: Jacob H. Cooley; Witness: S. Patterson

7. **Williford Upchurch** and Frances Gay- 19 Dec. 1820

Franklin Co. Simeon Carpenter bondsman; S. Patterson witness

8. Williford Upchurch and Frances Royster- 6 Dec 1854

Wake Co, NC- Bondsman Benjamin J. Perk; Witness: Thomas J. Utley

(19) Franklin Co, NC Deed made 1 Feb 1828- given to RPU 29 Oct 2006 by Carla Jones- copy in her Biofile & Geographical File

Extract: Churchwell Carpenter of Greene Co, AL [s/o John Carpenter, Sr. & Elizabeth Upchurch, per Carla] sells to John Pearce, Jr. of Wake Co, NC for \$850 an 850A tract of land in Franklin Co, NC being on Crooked Creek Waters and consisting of two adjoining parcels.

Parcel #1

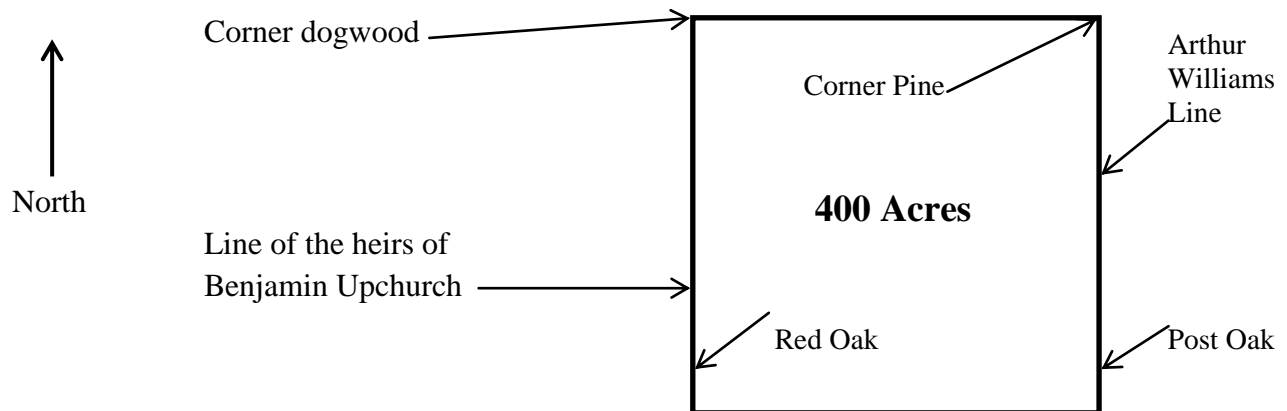

Williford Upchurch**XID-49358**

Parcel #2 (that #1 & #2 join is implied- not explicitly state-RPU)

Adjoins lands of:

Jubal Upchurch

Buckner Upchurch

Williford Upchurch

Britton Upchurch

Little Berry Upchurch

Benjamin Upchurch

This parcel at one point
sold to Henry R Jones
by John Carpenter, Sr.

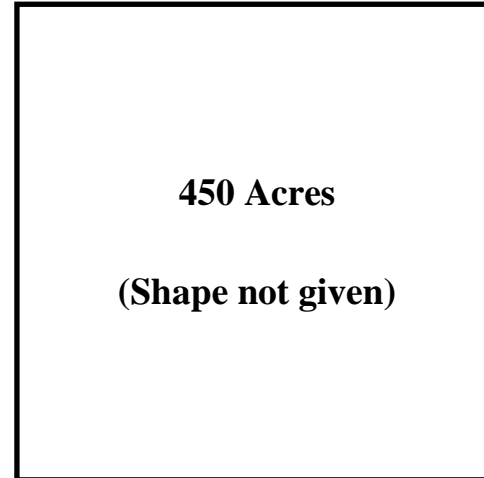

[Note: Somehow the
parcel had to transfer
from Jones to Churchwell
Carpenter- RPU]

Witnesses: Aug Hargrove; William Roles
Registered: 27 Sep 1828

(20) See RPU letter 23 Jun 2007 to Simon NMN Rogers in which there is speculation that **Williford Upchurch** is buried in the Simon Rogers Cemetery in Franklin Co, NC.

(21) Upchurch & Related Tax Listings- Franklin Co, NC 1798-1864- To RPU from Carla Jones
29 Oct 2006

Captain William Stone's District 1823

Simion Carpenter				1WP	
John Carpenter	1611 acres	\$2 per acre	\$3222		6BP
James Upchurch	509 ¾ acres	\$1.50 per acre	\$764.62		1BP
Littlebury Upchurch	319 acres	\$3 per acre	\$957	1WP	3BP
<u>Willifred Upchurch</u>				1WP	
Britton Upchurch	118 ¾ acres	\$2 per acre	\$237.50	1WP	
Larkin Upchurch	166 acres	\$1.50 per acre	\$249	1WP	
Burkly Upchurch	200 acres	\$2 per acre	\$400		
Jubal Upchurch	2500 acres	\$2 per acre	\$5000	3WP	7BP

Williford Upchurch**XID-49358**

Jubal Upchurch for	500 acres	\$2 per acre	\$1000	1BP
Nancy Upchurch				

Captain Wm. Stone's District 1824

John Carpenter	1,211 acres	\$1,816	7BP
Churchwell Carpenter	400 acres worth \$600	1WP	1BP
Littlebery Upchurch	319 acres worth \$957		
Littleberry Upchurch	444 acres worth \$666	1WP	3BP
James Upchurch	509 acres worth \$764		1BP
<u>Williford Upchurch</u>			1WP
Brinkley Upchurch	200 acres worth \$400		1WP
Britton Upchurch	118 acres worth \$236		1WP
Larkin Upchurch	166 acres worth \$332		1WP
Jubal Upchurch	2450 acres worth \$4900		7BP

Captain Stone's District 1825

Churchwell Carpenter	400 acres worth \$1.50 per acre	\$600	1WP	3(?) BP
John Carpenter	1,211 acres worth \$2 per acre	\$2,422		6BP
James Upchurch	400 acres worth \$1.50 per acre	\$600		1BP
<u>Williford Upchurch</u>	109 ¾ acres \$1.50	\$164	1WP	1BP
Brinkley Upchurch	200 acres worth \$1.50	\$300	1WP	
Berry Upchurch	319 acres \$3 per acre	\$957	1WP	5BP
Jubal Upchurch	1,976 acres \$1.50 per acre	\$2,964		5BP
Britton Upchurch	118 3/4 acres \$1.50 per acre	\$178	1WP	
Nancy Upchurch	505 acres \$1.50 per acre	\$757		1BP
Larkin Upchurch	166 acres worth \$1.50 per acre	\$249	1WP	

Captain Stone's District 1826

John Carpenter	100 acres \$1.25		
	100 acres \$1 per acre or \$350		
Churchwell Carpenter	400 acres \$1 per acre	\$400	
James Upchurch	509 acres \$1.25	\$763	1BP
Berry Upchurch	319 acres \$3 per acre	\$957	1WP 5BP
Jubal Upchurch	2,375 acres \$1.25	\$3,562	4BP
Nancy Upchurch	505 acres \$1.25 per acre	\$750	1BP
Stephen Upchurch			1WP
Larkin Upchurch	166 acres \$1.25 per acre	\$249	1WP
Burkely Upchurch	200 acres \$1.50	\$300	

Williford Upchurch**XID-49358**Captain Stone's District 1827

John Carpenter	200 acres \$1.25			
	100 acres worth \$1 per acre	total \$350		
Brinkley Upchurch	140 acres worth \$1.50	\$210		
James Upchurch	507 acres worth \$1.25	\$855	1BP	
Berry Upchurch	315 acres worth \$3 per acre	\$945	1WP	4BP
Nancy Upchurch	505 acres worth \$1.50 per acre	\$750		
Jubal Upchurch	600 acres worth \$1.25 per acre			
Jubal Upchurch	1200 acres worth \$1 per acre			
Jubal Upchurch	450 acres worth \$1.50 per acre			
Jubal Upchurch	214 acres worth \$1 per acre	totaling \$2,989	6BP	
Larkin Upchurch	166 acres worth \$2 per acre	\$332	1WP	

Captain Bridgers District 1828

John Perce	450 acres worth \$2.50 per acre			
John Pearce	400 acres worth \$1 per acre			
John Pearce	200 acres worth \$1.25 per acre (is this John Carpenter's land?)			
John Pearce	100 acres worth \$1 per acre	totaling \$1,900		
	(is this John Carpenter's land?)			
Jubal Upchurch	1,050 acres worth \$1.50 per acre			
Jubal Upchurch	1,414 acres worth \$1 per acre	totaling \$2,989	1WP	1BP
Calvin Upchurch			1WP	2BP 1 stud
Stephen Upchurch			1WP	1BP
Nancy Upchurch	500 acres worth \$1.50 per acre	\$750		
Berkley Upchurch	140 acres worth \$1.50 per acre	\$210		
James Upchurch	570 acres worth \$1.50 per acre	\$855		1BP

1823-1828 Listings

John Pearce	Burkely Upchurch
John Carpenter	Calvin Upchurch
Simon Carpenter	Stephen Upchurch
Churchwell Carpenter	Brinkley Upchurch
James Upchurch	Larkin Upchurch
Jubal Upchurch, I	Little Berry Upchurch
Britton Upchurch	<u>Williford Upchurch</u>
Nancy Upchurch	

Williford Upchurch**XID-49358**

(22) Upchurch and Related Tax Listings- Franklin Co, NC 1798-1864- to RPU from Carla Jones
29 Oct 2006

Captain Alford's District 1818

John Carpenter	1,211 acres	\$2.50 per acre	\$3027.50		7BP
Jubal Carpenter	400 acres	\$2.00 per acre	\$800	1WP	1BP
Phillip Pearce	292 acres	\$2.00 per acre	\$584		1BP
Stephen Pearce	310 acres	\$2.50 per acre	\$1085		6BP
Willie Pearce	168 acres	\$2.50 per acre	\$420	1WP	
Haley Pearce				1WP	
Eley Pearce	205 acres	\$3.00 per acre	\$615	1WP	1BP
James Upchurch	400 acres	\$1.50 per acre	\$600	2WP	1BP
Burkley Upchurch	200 acres	\$1.50 per acre	\$300	1WP	
Jubal Upchurch	2,037 acres	\$3.00 per acre	\$6,111	2WP	11BP
Britton Upchurch	100 acres	\$1.50 per acre	\$150		
Claibon Upchurch				1WP	

Captain Williams' District 1819

John Carpenter	1,211 acres	\$2.50 per acre	\$3027.50		8BP
Jubal Carpenter	400 acres	\$2.00 per acre	\$800	1WP	3BP
Phillip Pearce	292 acres	\$2.00 per acre	\$584	1WP	1BP
Haley Pearce				1WP	
Eley Pearce	205 acres	\$3.00 per acre	\$615	1WP	1BP
Willie Pearce	168 acres	\$2.50 per acre	\$420	1WP	
Stephen Pearce	310 acres	\$2.50 per acre	\$775		6BP
James Upchurch	487 acres	\$1.25 per acre	\$608.75		1BP
Briton Upchurch	100 acres	\$1.50 per acre	\$150	1WP	
Claibon Upchurch	138 acres	\$2.50 per acre	\$345		1WP
Note: loose list says 128 acres					
Jubal Upchurch	2,025 acres	\$3.00 per acre	\$6,075	2WP	14BP
Burkley Upchurch	200 acres	\$1.50 per acre	\$300		

Captain Williams District 1820

John Carpenter	1,611 acres	\$3827.50		10BP
Eley Pearce	205 acres	\$615	1WP	1BP
Hardy Pearce			1WP	
Stephen Pearce	310 acres	\$775		6BP
Wiley Pearce	168 acres	\$252	1WP	1BP
Britton Upchurch	100 acres	worth \$200	1WP	

Williford Upchurch**XID-49358**

Brinkley Upchurch	218 acres	\$436	1WP	
Jubal Upchurch	2,165 acres	\$5,410	1WP	10BP
Jubal Upchurch for	500 acres	\$1,250		1BP
Nancy Upchurch				
James Upchurch	487 acres	\$608.50	1WP	2BP
Larken Upchurch	40 acres	\$80		
Littleberry Upchurch	319 acres	\$957	1WP	3BP

Captain Bridges' District 1820-1829

Jubal Upchurch	600 acres worth \$1.50 per acre			
Jubal Upchurch	1200 acres worth \$1.00 per acre		1WP	2BP
Jubal Upchurch	450 acres worth \$1.50 per acre			
Jubal Upchurch	214 acres worth \$1.00 per acre			
Calvin Upchurch			1WP	2BP 1 stud & jack
Stephen Upchurch			1WP	1BP
Nancy Upchurch	500 acres worth \$1.50 per acre	\$750		1BP
Burkley Upchurch	140 acres worth \$1.50 per acre	\$210		
Britton Upchurch	383 acres worth \$2 per acre	\$768	1WP	1BP
Nathan Pearce	382 acres worth \$2 per acre			
Nathan Pearce	400 acres worth \$2.50 per acre	\$1,764		2BP
Burrell Pearce			1WP	
James Upchurch	570 acres worth \$1.50 per acre	\$855		1BP
Stephen Pearce	440 acres worth \$1.50 per acre	\$660		2BP
Willie Pearce			1WP	
Haley Pearce	220 acres worth \$2 per acre	\$400	1WP	1BP

Captain Dunns District 1821

John Carpenter	1611 acres worth \$2.50 per acre	\$4027.50		12BP
Phillip Pearce	300 acres worth \$1.50 per acre	\$450		
Haley Pearce			1WP	
Wiley Pearce			1WP	
James Upchurch	487 acres worth \$1.50 per acre	\$730.50		1BP
Britton Upchurch	100 acres worth \$1 per acre	\$100	1WP	
Littleberry Upchurch	218 acres worth \$1.50 per acre	\$327		
Claiborn Upchurch			1WP	
<u>Williford Upchurch</u>			1WP	

Captain William Stone's District 1822

John Carpenter	1611 acres worth \$2.50 per acre	\$4,428	1WP	5BP
----------------	----------------------------------	---------	-----	-----

Williford Upchurch**XID-49358**

Phillip Pearce	300 acres worth \$2 per acre	\$600	1WP	
Wiley Pearce			1WP	
Haley Pearce			1WP	
James Upchurch	509 acres worth \$1.50 per acre	\$763.50		
Burkley Upchurch	218 acres worth \$1.50 per acre	\$545	1WP	
Littleberry Upchurch	762 acres worth \$2.50 per acre	\$1,905	2WP	3BP
Jubal Upchurch	3500 acres worth \$2 per acre	\$7,000		4BP
Britton Upchurch	100 acres worth \$2 per acre	\$200	1WP	
<u>Williford Upchurch</u>			1WP	1BP
Larkin Upchurch	166 acres worth \$2 per acre	\$332	1WP	

1818-1822 Listings

Phillip Pearce	Jubal Carpenter	Larkin Upchurch
Stephen Pearce	James Upchurch	Little Berry Upchurch
Eli Pearce	Jubal Upchurch, I	<u>Williford Upchurch</u>
Willie Pearce	Brittain Upchurch	
Haley Pearce	Nancy Upchurch	
Nathan Pearce	Burkley Upchurch	
Nathan Pearce	Claburn Upchurch, I	
Burrell Pearce	Calvin Upchurch	
Hardy Pearce	Stephen Upchurch	
John Carpenter	Brinkley Upchurch	

(23) Franklin Co, NC Will of possible interest- RPU extract 30 Jun 2007- From: Franklin Co, NC Original Wills, Vol. 2 1862-1900 by S. E. Bradley, Jr.
Pg. 28

116. Thomas (x) Gay 2 Fb 1837 Jun Ct 1839 (Bk K, folio 217)

To my wife Agness- lend to her all my property for her life, & after her death as follows. To my son OZBON- 640 acres including where I now live. To my daughter MARY GAY – negro girl Cynthia, 1 bed & furniture, & 1 of her sisters to take her & to take care of her for life & after her death whichever sister takes her is to have her property. To my children BAILEY GAY, OZBON GAY, MARY GAY, AGNESS PERRY, MORNING JONES, FRANCESSE BAKER & my grandson FENNER YOUNG- all my property not otherwise disposed of.

Ex. my son Bailey Gay, my friend & son-in-law Ephraim Perry

Wit. Brian Greer, Nathan Pearce, Benjamin Baker

Note #1 This same will appears in Will Book K Franklin Co, NC 1834-1840 by S. E. Bradley, Jr #348 Pg. 82 – added info:

Ozbon = Osborn

Morning = Mourning

Brian Greer = Brian Green

Note #2 Again in Book K- #385, Pg. 90- The Sep 1830 Court addresses a petition by the heirs which says the widow AGNES is now deceased and assets (slaves) should be sold.

Added info:

Blake Baker (husband of Frances)

Ephraim Perry (husband of Agnes)

James Baker (new executor) [how related?] [ordered by Dec 1830 Court to sell assets]

Sale: 23 Jan 1840

Slaves purchased by: Wright Young, Bryan Green, Thos. R. Debnam, Blake Baker, Ephraim Perry, Calvin Upchurch, Fener Young, Nathan Pearce, John Griffin- Mar Court 1880

Note: From Kinfolks pg. 153- 2 deeds- Thomas Gay on 2 Oct 1824 gives land to grandchildren Agnes Young [pg. 193 married Calvin Upchurch] & Fenner Young, children of Joseph Young & Agnes (Gay) Young & to Frances (Gay) Upchurch; his daughter who married **Williford Upchurch** [pg. 193 Joseph Young had son Bryant Young] [& Wright Young]

RPU Interpretation:

I. Thomas Gay will 1837

A. Frances Gay

married (1st) **Williford Upchurch** - per 1824 deed

married (2nd) Blake Baker- per 1837 will

(24) From: Bunn Families of SEUS- Vol. 1 John, David, James, and Wrightman Bunn- 2006 by Danny Calier Bunn- Pg. 2

I. John Bunn d. 1804 (Wake Co., NC)

A. Jesse Bunn- had issue by wife #1 but apparently none by wife #2, Levinia Walker

- △ 2. JESSE² BUNN (*JOHN BURN¹ (BUNN)*) was born Abt. 1760, and died 1816 in Wake Co., NC⁴. He married (1) UNKNOWN, was born ⁵. He married (2) LEVINIA WALKER 06 Nov 1813 in Wake Co., NC, USA⁶. She was born ⁷, and died 1825 in Wake Co., NC.

Notes for JESSE BUNN:

Jesse Bunn served in the Revolutionary War (p. 1023, Vol. 16, State Records of North Carolina). He enlisted in 1782 for a period of 18 months and was a Private in Raiford's Co. 19th Regt. of NC Continental Lines (Abraham Shepard, Col.) He was discharged from service in 1783. Jesse owned in excess of 1000 acres of land in Wake and Franklin counties of North Carolina. Most of his property lay along the Moccasin Creek that divided those counties.

Children of JESSE BUNN and UNKNOWN are:

- △△ i. ALFRED WALKER³ BUNN, m. REBEKAH MEDLIN, 28 Feb 1826, Wake Co., NC, USA⁸.

Notes for ALFRED WALKER BUNN:

After the death of his mother Alfred received 220 acres of land (p. 69, Record Book 7, Wake Co., NC) in Wake Co., NC, that his father had left to his mother at his death. That property was located where Spring Branch joined Moccasin Creek in Wake County. In addition, Alfred received 31 more acres in that same area that was his share of what his brother Jesse Walker Bunn would have received from his mother had he been living at the time of the division.

3. △ ii. DELILAH BUNN, d. 22 Sep 1868, Green Co., AL.
4. △ iii. ELIZABETH BUNN, b. Abt. 1795; d. Marshall Co., MS.
5. △ iv. GREEN WALKER BUNN, b. 1788, Wake Co., NC; d. Oct 1851, Franklin Co., NC.
△ v. JESSE WALKER BUNN, b. Abt. 1799, Wake Co., NC⁹; d. Bet. 1818 - 1825.

Notes for JESSE WALKER BUNN:

Jesse Walker Bunn served in the War of 1812. His military records indicate that he was only 15 years old when he was enlisted into the 43rd US Infantry in North Carolina by Lieut. Combs for a period of 5 years on April 18, 1814. The records further indicate that he had blue eyes, light hair, and a fair complexion and that he was born in Wake County, NC. While on duty, Jesse was at Camp Federal Point, Camp Greenfield and was confined at Fort Hampton for desertion. Last entry indicates that he was "learning music." This documentation can be found at the Olivia Raney Library, Raleigh, NC on microfilm #233 titled US Army Register of Enlistments 1798-May 17, 1815, Vol. 3, page 93.

△ Jesse Walker Bunn acquired land in Wake County, NC, from John Hopkins on 13 Jan 1818. However he did not live long enough to received land from his father who had left 850 acres (p. 384, Record Book 12, Wake Co., NC) to his wife Levinia that was to be divided among his children at her death. Apparently Jesse Walker Bunn died prior to 1826 since in the division of that land in 1826 after the death of Levinia (p. 69, Record Book 7, Wake Co., NC) his share was divided among his surviving siblings.

- △ vi. GILLY BUNN, b. Abt. 1800, NC¹⁰.

Notes for GILLY BUNN:

- △ Williford Upchurch was to appear before the Justices of Franklin County, NC, Court of Pleas and Quarters Session to be held in Wake County, NC, in November of 1820 to answer a charge of Bastardy, committed on the body of Gilly Bunn. The 1850 census for Franklin Co., NC, indicates that Polly Bunn, 14, was living in the household with Gilly. The 1870 census for Franklin Co., NC, indicates that Ann Medlin was living in the household with Gilly Bunn at the time of survey.

6. △ vii. RILEY WALKER BUNN, b. Abt. 1803, NC.
7. △ viii. WILEY WALKER BUNN, b. 1807, NC.

(25) FROM: *Bunn Families of SEUS – Vol 1 – John, David, James and Wrightman Bunn* – 2006 by Danny Calier Bunn

The note below deals with the John Bunn Section of Vol. 1. A careful look at the 75 pages of this section reveals only two UPCHURCH notations – one on page 2 where **Williford U** (s/o James U VII and gs/o Richard U III) fathers a child by Gilly Bunn gd/o John Bunn. A second notations occurs on page 60 where the 1816 will of Jesse Bunn (s/o John Bunn) shows Abel U SR owes the late Jesse \$50.

More study is likely to reveal more Upchurch connections for this John Bunn Family – probably from descendants of female Upchurches.

A Note to Readers

The father of John Bunn is unknown. There is documentation available in courthouse records in the counties of Northampton and Wake, North Carolina that tend to indicate that John's father might have been ^Δ William Burn/Bunn who resided in Northampton County. William had six sons and one daughter. The names of his sons were William, James, Jacob, Owen, David, and John. The name of his daughter is unknown. She married Isaac Vick.

Land records in Northampton County pertaining to William's son, John, ended abruptly in 1778. That was the same year that the John Bunn, residing in Wake County, entered a land grant for three hundred acres of land in that county. Apparently John did not receive that grant for documentation showing that the grant had been issued could not be found in the North Carolina Archives in Raleigh. However, John initiated another request for a grant that was entered on May 27, 1779. He received that grant on September 30, 1785. Could it be that the John residing in Wake County was the same as the one residing in Northampton County? The land received by John in the grant is located in southeastern Wake County, on the eastern side of SR 2308 between the community of Hopkins and Moccasin Creek.

Land records in Northampton County for another of William's son, ^ΔDavid, ceased shortly after that of his brother John. David sold two hundred acres of land in Northampton County in 1781. That same year the name David Bunn appears on the Tax List for Wake County with acreage tax shown to be two hundred acres. Could this be the David from Northampton County and the brother of John Bunn? ^ΔOdam Bunn, son of the Northampton County David Bunn, also left that county around 1790, and his name appears on the Wake County Tax List for the year 1792. Did Odam follow his father to Wake County?

Although documentation to prove that John and David living in Wake were the same as the John and David residing in Northampton has not been found, one could very well come to that conclusion after carefully reviewing all of the information available in those counties. If it can be proven that John Bunn residing in Wake County was the son of William in Northampton County, then John would be a direct descendant of the ^ΔOwen Bunn/Burn/Burne mentioned in the Introduction who resided in Isle of Wight County, Virginia.

In the March 1779 Minutes, Wake County Court of Pleas and Quarters, John Burn/Burn covey land to his son ^ΔJesse Burn/Bunn. Land records pertaining to that transaction could not be found. However, at the division of Jesse's land at his death, some of the land shown on the division map, when plotted onto a topographical map, overlays the two hundred and seventy acra land grant that John received. So, it appears that the land received by John in the grant was that mentioned in the minutes that was conveyed to Jesse.

Williford Upchurch**XID-49358**

(26) Upchurch & Related Tax Listings- Franklin Co, NC 1798-1864- To RPU from Carla Jones
29 Oct 2006

District- **Williford Upchurch**

1822 Capt. Wm. Stone	1WP	1BP	"Williford"
1823 Capt. Wm. Stone	1WP		"Willifred"
1824 Capt. Wm. Stone	1WP		"Wiliford"
1825 Capt. Stone	109 ¾ acres	1WP	1BP "Williford"

(27) Franklin County, NC Will Book H – Bradley p. 32

210-(171) Account for heirs of JOHN WILLIAMS dec'd by ALFRED WILLIAMS guardian. 1826-27. Names mentioned:

G. Glenn	P. C. Person	Henry Williams	Nancy Williams
Hardy W. Tharp(former guardian)		<u>Williford Upchurch</u> ↑	Stephen Upchurch
James Baker	Basdil Thomas	Jubal Upchurch	William Roles
William Carter	Loftis Pippin		

Heirs: Lucy L., Thomas, Rebecca, William H., John R. Williams.

Slaves named:

Jerry	Green	Mary	Sceney	Simon	Boen
Sam	Surry	Celia	Phillis	Jane	Shade

Mar Ct 1827

(28) NC Marriages**Williford Upchurch**

North Carolina Marriages, 1759-1979	marriage: 19 Dec 1820	Franklin, North Carolina	spouse: Frances Gay
--	--------------------------	-----------------------------	---------------------

(29) Summary of Upchurches with the given name **Williford**

I) Richard U II

A) Richard U III, Head of Clan #4

1) Williford U b abt 1797 d 1825 +/- 4 yrs. Lived Franklin Co. NC. XID 49358

2) James U VII

(a) Kearney U

(i) Williford Kearney U CSA 1832 – 1880 – Raleigh grocer, bur City Cemetery
in Raleigh. XID 1125

- 3) Burkely U SR
 - (a) Ersula U
 - (i) James Wesley U
 - (I) Williford J. U (1886 – 1925) XID 12979
 - A. Williford Garmen U (1918 – 1996) Bus Driver in Raleigh. XID 32404
- B) Moses U – Head of Upchurch clan # 1
 - 1) Sims U
 - (a) Williford U b abt 1841 CSA, died in Civil War XID 688

Added notes:

- 1. No Upchurch has yet been located with the middle name Williford – RPU 9 Mar 2009
- 2. There is a Wiliford Denton U SR and JR of the Joseph U/Felix George U subclan – Robert H U line. For these WDU's, the name Wiliford clearly spelled with one L (see his biofile)