

PEEBLES

○ EXCERPT FROM INDEX OF BOOK "THE GOODWIN FAMILY OF CENTRAL N.C." BY THOMAS JERRY GOODWIN, SR - 2009 RPU 24NOV 2012. - NOTE: INDIVIDUALS LISTED AS MEMBERS OF THE \_\_\_\_\_ FAMILY - [WAKE/CHATHAM COUNTIES]

Peebles

Edgar D Jr. 262  
Edgar D. 139, 262  
Elsie Ruth 262  
Mary A. 262

PEEBLES

○ THE COUNCILS - FROM VATD NC - 2ND ED 1978 - BY: IRMA  
RAGAN HOLLAND - [RPU REFERENCE CODE (35)] PG(S) 163  
FROM GENERAL INDEX

PEEBLES

Carlyle, 21  
Carol, 94  
Cecil, Sr., Jr., 94  
Charlotte Wayne, 21  
Donna Gayle, 21  
Edgar Davdk, Sr., Jr., III., 99  
George, 99  
Gordan Ervin,,93  
Jeffrey, 93  
Joyce Dawn, 94  
Lay Sharon, 99  
Lester, 94  
Maurice Jerome, 93  
Mary Ann, 99  
Pete, 94  
Ronnid, 93  
Ruth, 99  
Sandra Elizabeth, 99  
Stafford Randolph, 93  
Tim, 94  
Todd, 93  
Tracy Herman, 93  
Troy McCree, 93  
Vernon Craig, 21  
Wayland Albert, 21  
Wayland Craig, 21

① I. Edward Peebler and Annie Huttrell

A. Reuben S. Peebler

md 1st ———

md 2nd 29 JUL 1878 (Saline Co, IL)

Elizabeth C. Bramlet b 1858 dau

of John D. Bramlet of the John 4<sup>th</sup> /  
Samuel H. Subclass.

(29, Pg 220)

The Pace Family of Wake Co, NC is shown below as presented in the Wake Co, NC Heritage Book - Families 591 (Willis Pace), 590 (Pressley P. Pace) and 589 (Charles D. Pace) - See their profiles for Articles. (\*)

I. - - PACE

He lived in Buffalo Dist. + Little River Dist in Eastern Wake Co, NC & owned 900 acres. He was adopted by Thompson Bunch in 1799 who d in 1802

A. Willis Pace b abt 1790 (?) d 1857 ± 3 YRS Bunch in 1799 who d in 1802  
md (1st) 5 JUN 1816 (Wake Co, NC) Polly GILLS leaning [Willis Pace as only heir]  
witnesses = Charles Horton & Joel King  
md (2nd) 4 SEP 1839 (Wake Co, NC) Susan Eddins witnesses: Benjamin Marshall & W. B. HAYES

☐ = IN PACE CEM ZEBOLON, NC AREA PACE FAMILY

1. ☐ Pressley P. Pace b 4 JAN 1830 d 24 JUL 1899 → Their home "Cottage Home" burned on 28 MAR 1908 but rebuilt - PACE CEM is in the yard -  
md 14 FEB 1856 (Wake Co, NC) ☐ Rebecca Scarborough b 28 MAY 1830 d 9 JUL 1901  
D/o Daniel Scarborough & Mary - -

a. ☐ Charles D. Pace [AKA Henry Daniel Pace] b 27 FEB 1865 d 30 MAY 1954  
md (1st) 2 JAN 1888 (?) ☐ Emma Clevia Peebles b 21 OCT 1867 d 4 MAR 1933  
D/o John D. Peebles & Ann Watkins  
md (2nd) 29 APR 1920 (?) Annie Evers of Raleigh, NC

b. ☐ Ola V. Pace b 14 NOV 1896 (?) d 1 JUL 1918 Newer md

c. ☐ Mary Catre Pace b 24 AUG 1861 d 25 NOV 1920 md (?) Sylvester V. Horton (whom see for 7 children)

d. ☐ Debbie A. Pace "Dally" b 23 SEP 1866 d 1 JUL 1883

e. Willis M-D Pace

- 2. Wesley Pace b abt 1835
- 3. Willis Pace
- 4. Jane Pace
- 5. Annalija Pace
- 6. Mary Pace b 1821 md 4 JUL 1846 (?) Wootson Bolton
- 7. ☐ Burling Pace md (?) Sam Bunch

- a. William Harney Bunch md (?) Betty Jane Scarborough
- b. Stanley Bunch
- c. Henry Bunch
- d. Sarah Bunch

- i. ☐ William Matoka Pace 4 MAY 1890 - 15 NOV 1952 NM
- ii. ☐ Annie Rebecca Pace md (?) Andrew Jones
- iii. ☐ Percy Pace b 1 JAN 1892 d 4 MAY 1967 md (?) Louville Green
- iv. ☐ John Daniel Pace b 13 OCT 1893 d 2 OCT 1923 md (?) CLARA ROBERTSON D/o Washington P. Robertson
- v. ☐ Fred David Pace b 10 FEB 1896 d 1 SEP 1951 md (?) Ola Tippett
- vi. ☐ Ora C. Pace b 16 MAR 1889 d 12 MAY 1890
- vii. ☐ Robert Lee Pace b 7 NOV 1897 d 7 JUN 1898
- viii. ☐ Charlie Boy Pace b 17 NOV 1901 d 24 NOV 1980 md (?) Annie Ruth Mangum
- ix. ☐ Waman Green Pace b 4 JUL 1921 - KIA Germany 26 NOV 1943

- i. Clyde L. BUNCH
- ii. Bertha Elizabeth Bunch
- iii. Grace Bunch md (?) -- PERRY
- iv. Annie Bunch md (?) -- THOMPSON



## EMMA CLEVIA PEEBLES

2

PACE CEMETERY RECORDS - GREEN PACE ROAD - ZEBULON, NC  
RECORDED BY RPU 29 MAR 2005

PACE FAMILY  
□ = IN WORK  
CO, NC HERITAGE  
BOOK (FAMILIES  
- 589, 590, 591)  
OR FIT INTO  
FAMILY KNOWN

- A1- Johnnie Scarboro Pace - BRD 18 FEB 1934 - 15 AVE 1998
- A2- Louise Pace Duke - MOT 13 NOV 1916 - 7 OCT 1993
- B1- - - PACE d 1895 AGE 12 YRS
- B2- - - HORTON d 1898 AGE 19 MOS
- \* B3- H/W Sylvester V. Horton 30 OCT 1856 - 31 JUL 1918
- \* Mary Pace Horton 24 OCT 1861 - 26 NOV 1920 [MARY CATRE PACE]
- B4- Fred D. Pace 10 FEB 1896 - 1 SEP 1951 [FRED DAVID PACE]
- B5- Charles W. Pace 15 JUL 1918 - 2 NOV 1933
- B6- Gola Tippet Pace 15 OCT 1893 - 3 MAR 1947
- B7- Charles Wayne Pace SSGT-USA - Korea 1 APR 1929 - 2 MAR 1972
- C1- - - PACE 28 XXX 1930 - 9 MAY 1901 [REBECCA SCARBROUGH
- C2- Debbie A. Pace 23 SEP 1866 - 1 JUL 1883 → - 28 MAY 1830 - 9 JUL 1901
- C3- Presley P. Pace 4 JAN 1830 - 24 JUL 1893
- C4- Robert Lee Pace 7 NOV 1897 - 27 JUN 1898 [BRD & ST]
- Ora C. Pace 18 MAR 1889 - 12 MAY 1890
- C5 - Warren G. Pace SSGT shot down + died - Germany
- Bus NEUVILLE EN-COUDR2 - BELGIUM 15 JUL 1921 - 26 NOV 1943
- +0 s/o C. D. PACE & ANNIE G. PACE
- C6- Janny D. Pace 13 OCT 1893 - 20 OCT 1923 [JOHN DANIEL PACE]
- C7- H/W Andrew N. Jones 22 SEP 1873 - 21 JUN 1939
- Annie Pace Jones 6 JUN 1879 - 20 FEB 1991 [ANNIE REBECCA PACE]
- C8 - MATOKA PACE 4 MAY 1890 - 15 NOV 1952 [LILLIAN MATOKA PACE]
- D-1 Gola V. Pace 14 NOV 1889 - 15 JUL 1918
- □ D-2 BURLINE L. PACE 22 JUN 1832 - 4 AVE 1909 [WIF OF SAM BUNCH]
- D-3 Emma C. Pace 21 OCT 1867 - 4 MAR 1913 [EMMA CLEVIA PEEBLES] ↑
- D-4 C. D. Pace 23 FEB 1865 - 30 MAY 1954 [CHARLES D. PACE]
- D5 - Annie Green Pace 31 OCT 1886 - 18 JUN 1962
- D6- H/W Perry Page Pace 1 JAN 1892 - 4 MAY 1927
- Lovell Green Pace 21 JUN 1896 - 18 APR 1980
- D7 H/W Charle B. Pace 1907 - 1980
- Annie M. Pace 1908 - 1994 [ANNIE RUTH MANGUM]
- \* Grandparents of Douglas Scales Chamberlain
- ↓ s/o FRED DAVID PACE

① See Pt 5 JUN 1987 Cleora Maxine Beard to RPH

I. Etheldred J. Peebles and Lucretia Tyner

A. May Eliza Peebles

1. Susan Jane Phillips

a. Robert Bruce Beard and Meta

Eleanor U, dau of John William

U, sr of the Nathans U I/Burtis

U solidam

② See Pt 3 NOV 1987 Cleora Maxine Beard to RPH

Etheldred Farrell Peebles and Lucretia Tyner.



- ① See N.C. Supreme Court Case # 20107 Wake Co 1902  
James W. W (son of Kearney W of the Richard W III/  
James W Subclan) sued George E. Robertson  
for slander. J. D. Peebles witness for the  
Plaintiff said "I am here to the Plaintiff by my."

① see 1860 census - Wake Co NC

In the slave holdings listings for A. Peebles was  
on one side of Kearney H and James A. Temple  
was on the other side.

JAMES WILEY PEEBLES

Apex Herald WED 3 MAY 1995 Apex, NC



JoAnne Peebles Williams

# Williams, Peebles exchange

## Vows

JoAnne Peebles and Jeffrey Thomas Williams, both of Raleigh, were married April 22, 1995 at Hayes Barton United Methodist Church. Rev. Mike Frese officiated the double ring ceremony. Following the ceremony, a reception was held in the church fellowship hall.

The bride is the daughter of Mr and Mrs. Julian Donald Peebles of Raleigh. She is the granddaughter of the late Mr and Mrs. William Norman Clement and the late Mr and Mrs. James Wiley Peebles, all formally of Raleigh.

The groom is the son of Mr and Mrs. Thomas Edgar Williams of Raleigh and the grandson of Mrs. Cloyce Williams of Apex and the late Mr. Williams. He is also the grandson of the late Mr. and Mrs. George Watts Horton, formally of Apex.

The bride, escorted to the altar by her father and given in marriage by her parents, wore a formal white satin and lace gown headed with pearls and a medium length train.

Maid of Honor was Charlotte J. Totulis, cousin of the bride of Raleigh. Bridesmaids were Karen P. Rabon and Lisa P. Klein, sisters of the bride and both of Raleigh, Denise W. Hutchins, sister of the groom of Greenville South Carolina, Alison Nipp of Atlanta, Kelly Stasko of Carrboro and Julie Wessler of Raleigh, all friends of the bride.

The groom's father served as best man. Groomsmen were Michael Peebles, brother of the bride of Knightdale, Chad Andrews of Charlotte, Frank Ragsdale of Wake Forest, Trey Reeves of Durham, Chris Cody, Tommy Haugh, and Chris Ford all of Raleigh, friends of the groom.

Following their honeymoon to St. Thomas, the couple will reside in Raleigh.

I. James Wiley Peebles <sup>nr</sup>

X. William Norman Clement

A. Julian Donald Peebles  
md ( ) - - Clement ←

- 1. JoAnne Peebles ←
- 2. Karen Peebles  
md ( ) - - Rabon
- 3. Lisa Peebles  
md ( ) - - Klein
- 4. Michael Peebles

I. - - Williams  
md ( ) Cloyce - -

X. George Watts Horton

A. Thomas Edgar Williams  
md ( ) - - Horton ←

MO

- 1. Jeffrey Thomas Williams
- 2. Denise Williams  
md ( ) - - Hutchins

Charlotte J. Totulis - Cousin of Bride



③ From email 11 MAY 2010 Janet (Peebles) McLin AKA

She has traced her ancestry to blacks listed on the 1870 census of House Creek TWP in Western Wake Co., NC.

She would like suggestions on how to proceed. She would have liked to know more about individuals who owned her ancestors. The individuals she listed are shown below. One presumes they lived in House Creek TWP circa 1870

△ Clairborn Fletcher - Her GGGF

AKA

△ Clairborne Hays

or as

△ Clairborne Hayer

Her sisters:

△ Caroline Hayer

or as

△ Caroline Hays

④

19 JUN

2010

Subject: Response

From: phil@upchurchstory.com

Date: Sat, Jun 19, 2010 11:01 am

To: "Janet Peebles McLin" <~~XXXXXXXXXXXXXXXXXXXX~~>

Hi Janet---

I have now returned from two extended trips and have worked on the request presented in your email of 11 May. Sorry for the delay.

I have made a Biofile sheet for each of the individuals you mentioned and have placed copies in my system. In the process I did not find a case in which the names had been encountered before. However, they are now in my records and I can contact you if they show up again from another source.

I do not know of any of my ancestors that would have been in House Creek Township and owned slaves. Of course in family history we always have to be prepared for surprises.

As to suggestions as to how to proceed I have two. One is to go to the Olivia Raney Family History Center on Poole Road in Raleigh. They are well equipped to guide you and they have many resources right there in the Center. My other suggestion is to check in with the Mormon Church (Church of Latter Day Saints) in Raleigh. They are happy to help you and when I was getting started they were of much help to me.

Good luck on your search. I'll be glad to get in touch with you if I come across something that might be of interest to you and I trust you will contact me if you run across any Upchurch information.

Phil Upchurch





Apex Herald WED 3 MAY 1995 Apex, NC



# Williams, Peebles exchange Vows

JoAnne Peebles and Jeffrey Thomas Williams, both of Raleigh, were married April 22, 1995 at Hayes Barton United Methodist Church. Rev. Mike Frese officiated the double ring ceremony. Following the ceremony, a reception was held in the church fellowship hall.

The bride is the daughter of Mr and Mrs. Julian Donald Peebles of Raleigh. She is the granddaughter of the late Mr and Mrs. William Norman Clement and the late Mr and Mrs. James Wiley Peebles, all formally of Raleigh.

The groom is the son of Mr and Mrs. Thomas Edgar Williams of Raleigh and the grandson of Mrs. Cloyce Williams of Apex and the late Mr. Williams. He is also the grandson of the late Mr. and Mrs. George Watts Horton, formally of Apex.

The bride, escorted to the altar by her father and given in marriage by her parents, wore a formal white satin and lace gown headed with pearls and a medium length train.

Maid of Honor was Charlotte J. Totulis, cousin of the bride of Raleigh. Bridesmaids were Karen P. Rabon and Lisa P. Klein, sisters of the bride and both of Raleigh, Denise W. Hutchins, sister of the groom of Greenville South Carolina, Alison Nipp of Atlanta, Kelly Stasko of Carrboro and Julie Wessler of Raleigh, all friends of the bride.

The groom's father served as best man. Groomsmen were Michael Peebles, brother of the bride of Knightdale, Chad Andrews of Charlotte, Frank Ragsdale of Wake Forest, Trey Reeves of Durham, Chris Cody, Tommy Haugh, and Chris Ford all of Raleigh, friends of the groom.

Following their honeymoon to St. Thomas, the couple will reside in Raleigh.

JoAnne Peebles Williams

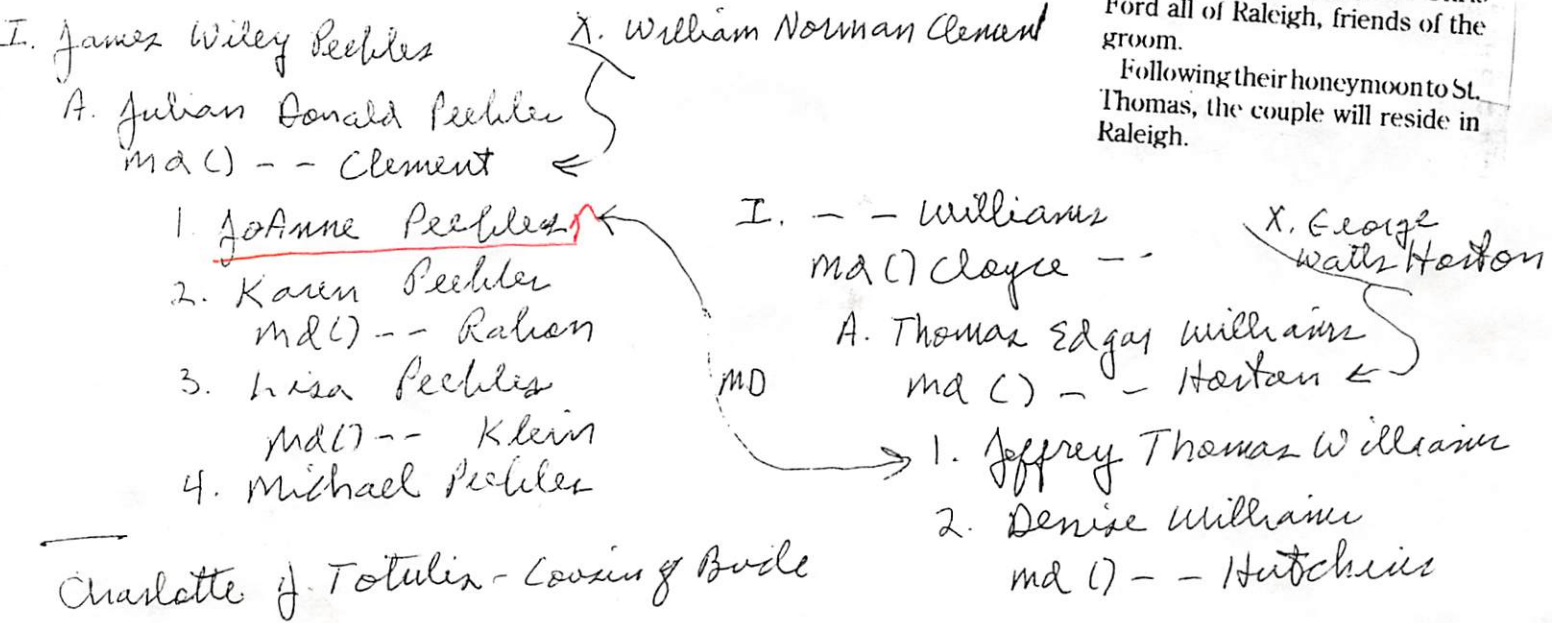



○ Extract of will of <sup>Δ</sup>William Cross [b. 1754 (VA) - Ancestor of RPH  
 To RPH from Vicki Marie Barefoot 5 MAY 1990 - written  
 30 JUN 1814; Probated 14 FEB 1815 - Wake Co, NC.

• Leaves to wife <sup>Δ</sup>Rachel all land & negroes and all property

• Names his "first" five children - in order

Δ Δ Δ Δ Δ SARAH, MARTHA, FRANCES, WILLIAM, MARY

Leaves \$5 to each but only to be paid  
 after wife Rachel dies.

• Names his "second" five children twice - the order named

Δ Δ Δ Δ Δ { 1st. NANCY, PRISCILLA, THOMAS, ELIZABETH, RICHARD  
 and NANCY, PRISCILLA, THOMAS, RICHARD, ELIZABETH

To these 5 he leaves:

WITNESSES:

<sup>Δ</sup> SHERROD  
 HARRIS

<sup>Δ</sup> JOHN  
 PEEBLES

<sup>Δ</sup> —  
 WEATHERS

ELIZABETH - nothing listed

NANCY - one bed + furniture on which she now  
 lies - after death of wife Rachel

PRISCILLA - one bed + furniture on which she  
 now lies - after death of wife Rachel.

RICHARD - one negro man SAM - after the  
 death of wife Rachel

THOMAS - Land after death of wife Rachel

William signed  
 by making a  
 mark.

• An unclear line implies that other assets at death  
 of wife Rachel, "be they great or small" be divided equally  
 between the "last" five children and named them.

RPH QUESTIONS - 27 NOV 2009

- why nothing to Elizabeth? - maybe already married??
- When Thomas died before his mother Rachel - why did the  
 land go to just 3 of the children of his brother Richard  
 and to none of his other children - and why none  
 to 3 sisters of Thomas (or their heirs)

JOHN PEEBLES

① See Wake Co, NC Genealogical Society Newsletter FEB 1986 (Vol 4 #11)

A. John Peebles ↑ d 1825 (Wake Co, NC)

1. Rebecca Peebles mtd 1807 (Wake Co, NC) Samuel Harris  
Rebecca d < 1825

2. Sarah (Sally) Peebles mtd 1807 (Wake Co, NC)  
Theophilus Dean.

~~Samuel Harris~~ John Peebles mtd 2nd Winnefred Robertson.

Info from Regenia Bernard Rt 5 Box 102 Fulton, MO 65251



○ The Pace Family of Wake Co, NC is shown below as presented in the Wake Co, NC Heritage Book - Families 591 (Willis Pace), 590 (Pressley P. Pace) and 589 (Charles D. Pace) - See their profiles for Articles. (\*)

I. - - PACE

A. Willis Pace \* b abt 1790(?) d 1857 13 YRS Bunch in 1799 who d in 1802  
 Md (1st) 5 JUN 1816 (Wake Co, NC) Polly GILLS leaving Willis Pace as only heir  
 witness = Charles Hartman & Joel King  
 Md (2nd) 4 SEP 1839 (Wake Co, NC) Susan Eddins  
 witnesses: Benjamin Marshall & W. B. HAYES

□ = IN PACE CEM ZEBOLON, NC AREA PACE FAMILY

1. □ Pressley P. Pace b 4 JAN 1830 d 24 JUL 1899 → Their home "Cottage Home" burned on 28 MAR 1908 but rebuilt - PACE CEM is in the yard  
 Md 14 FEB 1856 (Wake Co, NC) □ Rebecca Scarborough b 28 MAY 1830 d 9 JUL 1901  
 D/o Daniel Scarborough & Mary - -

a. □ Charles D. Pace [AKA Henry Daniel Pace] b 27 FEB 1865 d 30 MAY 1954  
 Md (1st) 2 JAN 1888 (?) □ Emma Clevia Peebles b 21 OCT 1867 d 4 MAR 1933  
 D/o John D. Peebles & Ann Watkins  
 Md (2nd) 29 APR 1920 (?) □ Annie Green of Raleigh, NC

i. □ William Matoka Pace 4 MAY 1890 - 15 NOV 1952 NM  
 ii. □ Annie Rebecca Pace Md (?) Andrew Jones  
 iii. □ Perry Pace b 15 JAN 1892 d 4 MAY 1967  
 Md (?) Louisville Green  
 iv. □ John Daniel Pace b 13 OCT 1893 d 2 OCT 1923 Md (?) CLARA ROBERTSON D/o Washington P. Robertson  
 v. □ Fred David Pace b 10 FEB 1896 d 1 SEP 1951  
 Md (?) Lola Tippett  
 vi. □ Ora C. Pace b 16 MAR 1889 d 12 MAY 1890  
 vii. □ Robert Lee Pace b 7 NOV 1897 d 7 JUN 1898  
 viii. □ Charlie Boy Pace b 17 NOV 1901 d 24 NOV 1980 Md (?) Annie Ruth Mangum  
 ix. □ Waman Green Pace b 4 JUL 1921 - KIA Germany 26 NOV 1943

i. Clyde L. BUNCH  
 ii. Bertha Elizabeth Bunch  
 iii. Grace Bunch Md (?) -- PERRY  
 iv. Annie Bunch Md (?) -- THOMPSON

b. □ Lola V. Pace b 14 NOV 1894 (?) d 1 JUL 1918 Never md  
 c. □ Mary Catre Pace b 24 AUG 1861 d 25 NOV 1920 Md (?) Sylvester V. Hartman (whom see for 7 children)  
 d. □ Delbie A. Pace "Dally" b 23 SEP 1866 d 1 JUL 1883

e. Willis McD Pace  
 2. Wesley Pace b abt 1835  
 3. Willis Pace  
 4. Jane Pace  
 5. Annaliza Pace  
 6. Mary Pace b 1821 Md 4 JUL 1846 (?) Wootson Bolton  
 7. □ Berline Pace Md (?) Sam Bunch

a. William Harney Bunch Md (?) Betty Jane Scarborough  
 b. Stanley Bunch  
 c. Henry Bunch  
 d. Sarah Bunch



Apex Herald WED 3 MAY 1995 Apex, NC



JoAnne Peebles Williams

# Williams, Peebles exchange Vows

JoAnne Peebles and Jeffrey Thomas Williams, both of Raleigh, were married April 22, 1995 at Hayes Barton United Methodist Church. Rev. Mike Frese officiated the double ring ceremony. Following the ceremony, a reception was held in the church fellowship hall.

The bride is the daughter of Mr and Mrs. Julian Donald Peebles of Raleigh. She is the granddaughter of the late Mr and Mrs. William Norman Clement and the late Mr and Mrs. James Wiley Peebles, all formally of Raleigh.

The groom is the son of Mr and Mrs. Thomas Edgar Williams of Raleigh and the grandson of Mrs. Cloyce Williams of Apex and the late Mr. Williams. He is also the grandson of the late Mr. and Mrs. George Watts Horton, formally of Apex.

The bride, escorted to the altar by her father and given in marriage by her parents, wore a formal white satin and lace gown headed with pearls and a medium length train.

Maid of Honor was Charlotte J. Totulis, cousin of the bride of Raleigh. Bridesmaids were Karen P. Rabon and Lisa P. Klein, sisters of the bride and both of Raleigh, Denise W. Hutchins, sister of the groom of Greenville South Carolina, Alison Nipp of Atlanta, Kelly Stasko of Carrboro and Julie Wessler of Raleigh, all friends of the bride.

The groom's father served as best man. Groomsmen were Michael Peebles, brother of the bride of Knightdale, Chad Andrews of Charlotte, Frank Ragsdale of Wake Forest, Trey Reeves of Durham, Chris Cody, Tommy Haugh, and Chris Ford all of Raleigh, friends of the groom.

Following their honeymoon to St. Thomas, the couple will reside in Raleigh.

I. James Wiley Peebles

A. Julian Donald Peebles  
m d ( ) - - Clement

- 1. JoAnne Peebles
- 2. Karen Peebles  
m d ( ) - - Rabon
- 3. Lisa Peebles  
m d ( ) - - Klein
- 4. Michael Peebles

X. William Norman Clement

I. - - Williams  
m d ( ) Cloyce - -

A. Thomas Edgar Williams  
m d ( ) - - Horton

X. George Watts Horton

- 1. Jeffrey Thomas Williams
- 2. Denise Williams  
m d ( ) - - Hutchins

Charlotte J. Totulis - Cousin of Bride



Apex Herald WED 3 MAY 1995 Apex, NC



# Williams, Peebles exchange

## Vows

JoAnne Peebles and Jeffrey Thomas Williams, both of Raleigh, were married April 22, 1995 at Hayes Barton United Methodist Church. Rev. Mike Frese officiated the double ring ceremony. Following the ceremony, a reception was held in the church fellowship hall.

The bride is the daughter of Mr and Mrs. Julian Donald Peebles of Raleigh. She is the granddaughter of the late Mr and Mrs. William Norman Clement and the late Mr and Mrs. James Wiley Peebles, all formerly of Raleigh.

The groom is the son of Mr and Mrs. Thomas Edgar Williams of Raleigh and the grandson of Mrs. Cloyce Williams of Apex and the late Mr. Williams. He is also the grandson of the late Mr and Mrs. George Watts Horton, formally of Apex.

The bride, escorted to the altar by her father and given in marriage by her parents, wore a formal white satin and lace gown headed with pearls and a medium length train.

Maid of Honor was Charlotte J. Totulis, cousin of the bride of Raleigh. Bridesmaids were Karen P. Rabon and Lisa P. Klein, sisters of the bride and both of Raleigh, Denise W. Hutchins, sister of the groom of Greenville South Carolina, Alison Nipp of Atlanta, Kelly Stasko of Carrboro and Julie Wessler of Raleigh, all friends of the bride.

The groom's father served as best man. Groomsmen were Michael Peebles, brother of the bride of Knightdale, Chad Andrews of Charlotte, Frank Ragsdale of Wake Forest, Trey Reeves of Durham, Chris Cody, Tommy Haugh, and Chris Ford all of Raleigh, friends of the groom.

Following their honeymoon to St. Thomas, the couple will reside in Raleigh.

JoAnne Peebles Williams

I. James Wiley Peebles

X. William Norman Clement

A. Julian Donald Peebles  
m d ( ) - - Clement

- 1. JoAnne Peebles
- 2. Karen Peebles ↑  
m d ( ) - - Rabon
- 3. Lisa Peebles  
m d ( ) - - Klein
- 4. Michael Peebles

I. - - Williams  
m d ( ) Cloyce - -

X. George Watts Horton

A. Thomas Edgar Williams  
m d ( ) - - Horton

MO

- 1. Jeffrey Thomas Williams
- 2. Denise Williams  
m d ( ) - - Hutchins

Charlotte J. Totulis - Cousin of Bride



Apex Herald WED 3 MAY 1995 Apex, NC



# Williams, Peebles exchange

## Vows

JoAnne Peebles and Jeffrey Thomas Williams, both of Raleigh, were married April 22, 1995 at Hayes Barton United Methodist Church. Rev. Mike Frese officiated the double ring ceremony. Following the ceremony, a reception was held in the church fellowship hall.

The bride is the daughter of Mr and Mrs. Julian Donald Peebles of Raleigh. She is the granddaughter of the late Mr and Mrs. William Norman Clement and the late Mr and Mrs. James Wiley Peebles, all formally of Raleigh.

The groom is the son of Mr and Mrs. Thomas Edgar Williams of Raleigh and the grandson of Mrs. Cloyce Williams of Apex and the late Mr. Williams. He is also the grandson of the late Mr. and Mrs. George Watts Horton, formally of Apex.

The bride, escorted to the altar by her father and given in marriage by her parents, wore a formal white satin and lace gown headed with pearls and a medium length train.

Maid of Honor was Charlotte J. Totulis, cousin of the bride of Raleigh. Bridesmaids were Karen P. Rabon and Lisa P. Klein, sisters of the bride and both of Raleigh, Denise W. Hutchins, sister of the groom of Greenville South Carolina, Alison Nipp of Atlanta, Kelly Stasko of Carrboro and Julie Wessler of Raleigh, all friends of the bride.

The groom's father served as best man. Groomsmen were Michael Peebles, brother of the bride of Knightdale, Chad Andrews of Charlotte, Frank Ragsdale of Wake Forest, Trey Reeves of Durham, Chris Cody, Tommy Haugh, and Chris Ford all of Raleigh, friends of the groom.

Following their honeymoon to St. Thomas, the couple will reside in Raleigh.

JoAnne Peebles Williams

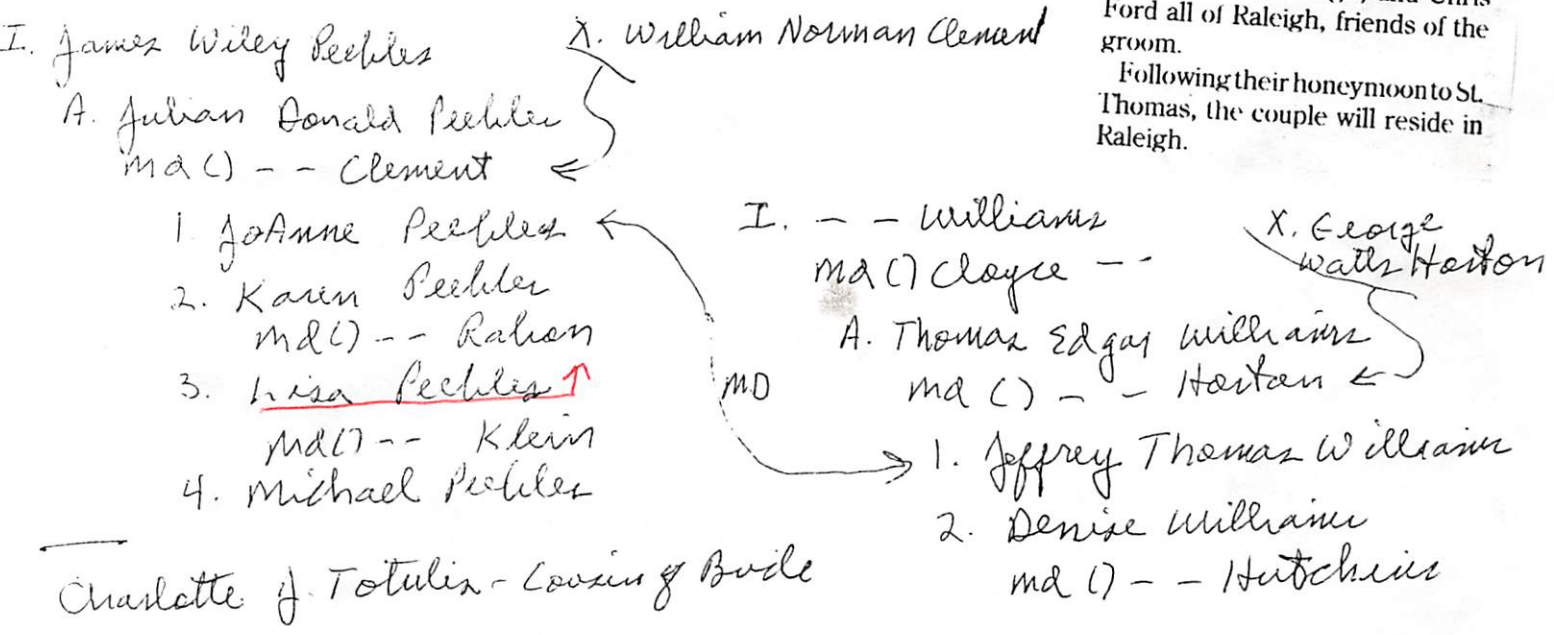

## MAY ELIZA PEEBLES

① see pt 5 JUN 1987 Cleora Maxine Beard to RPH

I. Elnored J. Peebles and Lucretia Tynes

A. May Eliza Peebles b 1810 (Northampton Co, NC) and John Dawson Phillips b ca 1810  
 - Northampton Co, NC (VA?) & Northampton Co, NC.

1. Susan Jane Phillips

a. Robert Bruce Beard and  
 Meta Eleanor U, dau of  
 John William U, Sr of the  
 Nathans U I / Buster U  
 Suldam.



Apex Herald WED 3 MAY 1995 Apex, NC



JoAnne Peebles Williams

# Williams, Peebles exchange Vows

JoAnne Peebles and Jeffrey Thomas Williams, both of Raleigh, were married April 22, 1995 at Hayes Barton United Methodist Church. Rev. Mike Frese officiated the double ring ceremony. Following the ceremony, a reception was held in the church fellowship hall.

The bride is the daughter of Mr and Mrs. Julian Donald Peebles of Raleigh. She is the granddaughter of the late Mr and Mrs. William Norman Clement and the late Mr and Mrs. James Wiley Peebles, all formally of Raleigh.

The groom is the son of Mr and Mrs. Thomas Edgar Williams of Raleigh and the grandson of Mrs. Cloyce Williams of Apex and the late Mr. Williams. He is also the grandson of the late Mr. and Mrs. George Watts Horton, formally of Apex.

The bride, escorted to the altar by her father and given in marriage by her parents, wore a formal white satin and lace gown headed with pearls and a medium length train.

Maid of Honor was Charlotte J. Totulis, cousin of the bride of Raleigh. Bridesmaids were Karen P. Rabon and Lisa P. Klein, sisters of the bride and both of Raleigh, Denise W. Hutchins, sister of the groom of Greenville South Carolina, Alison Nipp of Atlanta, Kelly Stasko of Carrboro and Julie Wessler of Raleigh, all friends of the bride.

The groom's father served as best man. Groomsmen were Michael Peebles, brother of the bride of Knightdale, Chad Andrews of Charlotte, Frank Ragsdale of Wake Forest, Trey Reeves of Durham, Chris Cody, Tommy Haugh, and Chris Ford all of Raleigh, friends of the groom.

Following their honeymoon to St. Thomas, the couple will reside in Raleigh.

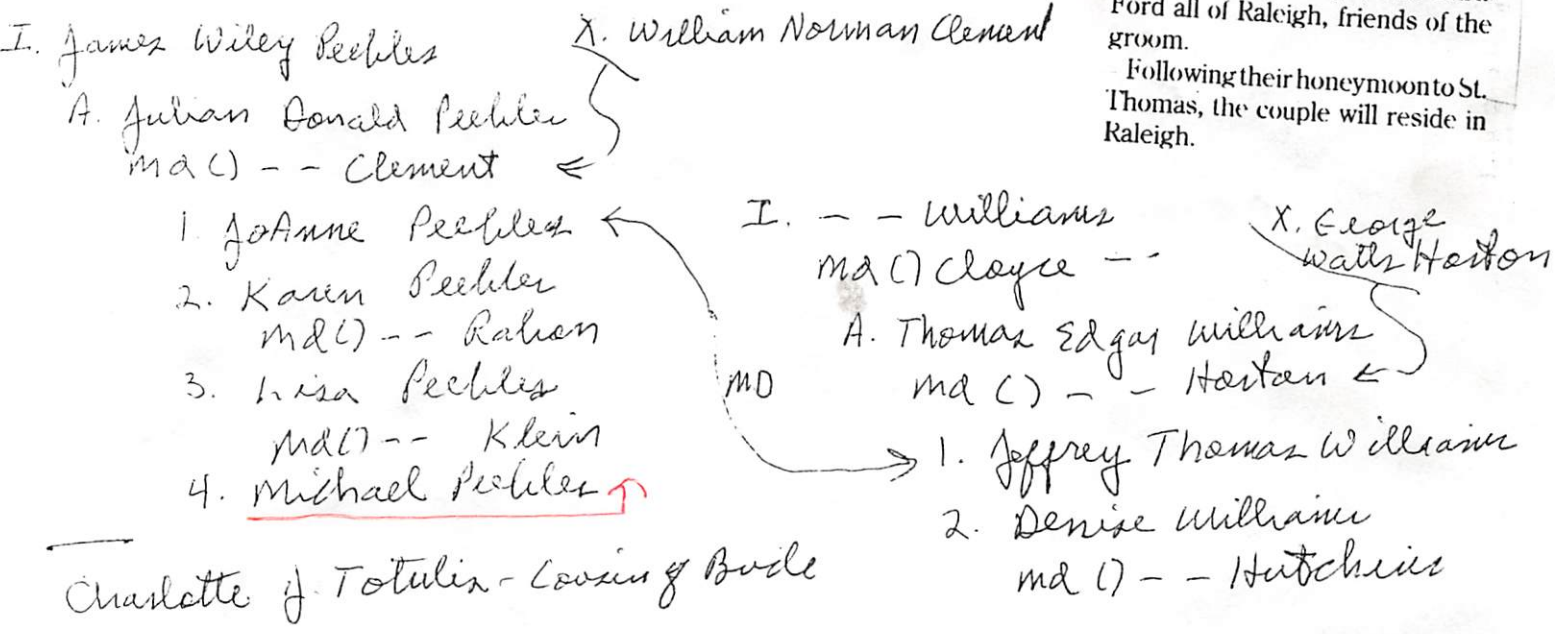



THE BEDDINGFIELD FAMILY OF FALLS OF THE NEUSE TOWNSHIP - F-80 - WAKE CO NC HERITAGE BOOK

I. ALEXANDER<sup>SR</sup> BEDDINGFIELD & CIVIL WAR - BUR

BOARDSVILLE, VA AMONG COMRADES

MDC) PALMYRA CHAPPELL ←

A. EUGENE CROCKER BEDDINGFIELD

MDC) ← b 1862 d 1926 lived in Millbrook

NANCY  
PEEBLES  
OF WAKE  
CO, NC

AKA - RESTAURANT NAME = CARY-BEDD-

INGFIELD HOUSE. WAS STATE REP 2 TERMS

SEVERAL TERMS COUNTY COMMISSIONER

SENATE 1922 TRUSTEE EAST CAROLINA

TEACHERS COLLEGE IN 1920'S - Elected RAILROAD COMM.

I. ELIAS & CHAPPELL

→ b 1817 - Gave land for Midway BAPT CH became Millbrook BAPT Church

→ A. PALMYRA CHAPPELL

B. EDWARD

CHAPPELL

1. Charles Amos Beddingfield, <sup>SR</sup> 3rd child

MDC) Mary Perry of Union Co, NC - God Meredith 1702

a. Charlotte Beddingfield

↳ 3 OF HER

b. Mary Beddingfield

DAU ATTENDED

AUTHOR  
F-80

← c. Edna Earl Beddingfield

MEREDITH

MDC) - - YAKBOROUGH

d. Alice Beddingfield

e. Eleanor Beddingfield

f. Charles Amos Beddingfield, Jr

g. Eugene Beddingfield.

2-7

B. NO FURTHER ISSUE

old midway BAPT Church organized 1875 AKA SIDNEY METHODIST CHURCH

- ① See N.C. Supreme Court Case # 20107 - Wake Co. 1900  
James W. W. (son of Kearney W. of the Michael W. W.)  
James W. Subdan) vs. George E. Robertson for  
slander. Patrick Peebles is mentioned.

- ① Elizabeth C. Bramlet b. 1858 and 29 JUL 1878 (Saline Co, IL)  
Reuben S. Peebles ↑ son of Annie (Nuttall) & Edward  
Peebles. one son. NFI on Elizabeth. She was not listed  
as an heir of her father when he died. This was  
the 2nd my for Reuben. Elizabeth is the dau  
of John Daniel Bramlet of the John A III/Samuel  
A Sudan (29, Pg 220)

See It 9 FEB 1999 Daniel Scarborough Hoyle, Jr to RPH PCS =   
 DAN RESPONDS TO RPH REQUEST TO LEIK DOUGLAS SCALES CHAMBLEE  
 TO AMOS HORTON, II - SHOWN BELOW + OTHER WAKE CO, NC ENTRIES  
 ALREADY KNOWN

I. Daniel Horton b England  
 d 1716 (Sunny Co, VA)  
 md (1) Martha Trimms

F. David Horton, Jr  
 md (1) Elizabeth Robertson

A. Amos Horton, I b abt 1710  
 (Sunny Co, VA) d abt 1791  
 (Lancaster Co, SC) md abt

A. Littleberry Horton md (1)  
 Penelope (Penny) Pierce (Pearce)

AUNT/NIECE  
 IST COUSINS

1730 (Sunny Co, VA) SARAH PEEBLES!

i. Amos Horton, II b abt  
 1735 (Sunny Co, VA) d 28 MAR  
 1821 (Wake Co, NC) md 25 MAY  
 1767 (Brunswick Co, VA)  
 VIRGINIA (PEOPLES) EZZELL  
 "GAINNEY". [She md (1st) -- TOOKE  
 & (2nd) WILLIAM EZZELL

→ SAME → md Mary Catie Pace  
 i. Deane Mae Horton  
 (I) Daniel Scarborough  
 Hoyle, Sr  
 (A) JR  
 m. Cassandra Horton  
 (I) Douglas Scales  
 Chamblee

[32] [20] a. Jesse Horton b 7 JAN 1773  
 (Hanging Rock, SC) d 2 AUG  
 1850 (Pleasant Ridge, Greene  
 Co, AL) md 15 MAR 1799 (Wake  
 Co, NC) Sarah Elizabeth  
 Chamblee d/o ISAAC CHAMBLEE  
 & LUCRETIA JONES

[52] b. Sarah Horton b 1770 (Brunswick Co, VA)  
 md 2 DEC 1788 (Wake Co, NC)  
 John Wesley Scarborough, I  
 i. Daniel Scarborough

c. Hartwell (Heartwell) Horton. 1st  
 (COUSINS)  
 md (1st) NANCY VODER  
 md (2nd) NANCY VADEN  
 i. Cynthia Horton

x. Rebecca Scarborough  
 md (1) Presley P. Pace  
 y. Mary Catie Pace

X. At this point there records have a  
 conflict - The following 4 are presented  
 as children of Daniel Horton in 1 spot & as of Amos Horton in another

1. Rebecca Horton [said to be stepdaug of Amos Horton II & dau of  
 Virginia Peoples by an earlier husband] md John Sledge, Sr [1]
2. Sarah Horton md John Collier, Sr; 3. Elizabeth Horton md  
 Hugh Lucy; Alexander Horton md (1) Sarah Bland.



Western Wake Herald WED 29 JUN 1988 Apex, NC

# Local dairies provide window to town history.

By Robert Ham

In the early 1930's there were several dairies operating in western Wake County. Here in Apex W.A. Peebles Dairy was in operation from 1930 to 1943. The old Peebles dairy barn is still standing on Hunter Street, just east of the Western Wake Hospital. The Peebles sold some of the dairy's pasture land so that the hospital could be built in that area. There is a gravel road that runs off Hunter Street through the old dairy that is named very appropriately Peebles Street.

The reason I started investigating the history and location of the dairy is that I am a bottle collector and that collection includes milk bottles. Several years ago I found several old milk bottles in an old well that had been filled in next to my backyard. When I cleaned up one

of the old bottles, it stated in raised glass letters on the neck of the bottle, "A bottle of milk is a bottle of health." A large capital "P" was on the bottom of the bottle. The front of the bottle had the name "W.A. Peebles Dairy, Apex, North Carolina." Susan Castlebury Behringer of Apex also has a collection of milk bottles and she was able to trade me out of the bottle about a year ago.

It was almost ten years ago when I found the milk bottle. Mrs. W.A. Peebles was 90 years of age at the time and was still living in the old house at the dairy. She gave me some paper lids that were left from the dairy. The milk bottle lids had the following words printed on the label "Peebles Dairy, Grade A Raw Buttermilk, phone 469." There was also a drawing of a woman churning buttermilk. Mrs.

## ROUND THESE PARTS

Peebles told me that they had to close the dairy in 1943 and sell the dairy cows and equipment because they could not get enough help during World War II to keep all the cows fed and milked and deliver the milk. She said that while they were selling the dairy cows that one of the calves decided not to have any part of the auction and ran off into the woods. It was about three days before they could catch the calf and sell it. Mrs. Peebles told me that while the dairy was in operation, it had home delivery routes

in Apex, New Hill, Cary and Raleigh.

Mrs. Peebles told me about the good old days when she attended the old Cary Academy and lived with her aunt who ran the Walker-Page Hotel. She remarked that she enjoyed attending the Academy, but she did not like the three mile walk every morning to the old High House down at what is now the High House Road in Cary. Back in those times the girls wore very long dresses. On rainy days the old dirt roads would naturally be muddy. The hems on all the girls dresses would be muddy before they got back to the Academy.

Seeing the old glass milk bottles reminds me of how we would wash out the milk bottles after we had used the milk. We put them on the porch for the milkman to pick up when he made his deliveries. Now, as far as I know,

one dairy in the area still makes home deliveries. And, the milk is certainly not in glass bottles anymore.

This also reminds me of the time that my spouse, Betty Ham, left a note to the milkman that turned our front porch into a dairy case. At that time my wife

was a well organized school teacher. She even had well organized notes. On this note she listed all the items that she wanted from one through five. 1. quart buttermilk; 2. quart homegenized milk; 3. quart chocolate milk; 4. pint cream; 5.

pint cottage cheese. The milkman did not realize that she had listed the five items and he therefore left fifteen containers of dairy products on the porch. You can imagine how I felt when I opened the door to get in the milk.

In a few years a glass milk bottle will only be recognized by the older generations. If one is found somewhere the young people will wonder what type of glass container it was.



Zebulon Record THUR 7 SEP 1995 Zebulon, NC

I. William H. Peeden, Sr

A. Joseph Verlon Peeden "Monk"  
md () Brenda Walston

1. Pam Peeden md Scott Langley

a. Jennifer Langley

b. Chris Langley

2. Penny Peeden md () Tommy Oakley

B. Dorothy Peeden md () -- Jackson

C. Pattie Peeden md () -- Bunn

D. William H. Peeden, Jr

E. Bernice R. Peeden ↑ ♂

**Joseph V. Peeden**

Joseph Verlon "Monk" Peeden, 62, of 1501 Stone Stream Drive, Knightdale, died Tuesday, Aug. 29. Funeral was 2 p.m. Thursday, Aug. 31, at L. Harold Poole Funeral Service chapel. Burial was at Gethsemane Memorial Gardens in Zebulon.

Peeden was a construction superintendent for Bobbitt and Associates.

Surviving: wife, Brenda Walston Peeden; daughters and sons-in-law, Pam P. and Scott Langley of Garner, Penny P. and Tommy Oakley of Knightdale; grandchildren, Jennifer and Chris Langley; sisters, Dorothy P. Jackson of Wilson, Pattie P. Bunn of Kenly; brothers, William H. Peeden Jr. of Wilson, Bernice R. Peeden of Fremont.

Zebulon Record THUR 7 SEP 1995 Zebulon, NC

I. William H. Peeden, Sr

A. Joseph Verlon Peeden "Monk"  
md () Brenda Walston

1. Pam Peeden md Scott Langley

a. Jennifer Langley

b. Chris Langley

2. Penny Peeden md () Tommy Oakley

B. Dorothy Peeden md () -- Jackson

C. Pattie Peeden md () -- Bunn

D. William H. Peeden, Jr

E. Bernice R. Peeden ♂

**Joseph V. Peeden**

Joseph Verlon "Monk" Peeden, 62, of 1501 Stone Stream Drive, Knightdale, died Tuesday, Aug. 29. Funeral was 2 p.m. Thursday, Aug. 31, at L. Harold Poole Funeral Service chapel. Burial was at Gethsemane Memorial Gardens in Zebulon.

Peeden was a construction superintendent for Bobbitt and Associates.

Surviving: wife, Brenda Walston Peeden; daughters and sons-in-law, Pam P. and Scott Langley of Garner, Penny P. and Tommy Oakley of Knightdale; grandchildren, Jennifer and Chris Langley; sisters, Dorothy P. Jackson of Wilson, Pattie P. Bunn of Kenly; brothers, William H. Peeden Jr. of Wilson, Bernice R. Peeden of Fremont.



Zebulon Record THUR 7 SEP 1995 Zebulon, NC

I. William H. Peeden, Sr

A. Joseph Verlon Peeden "Monk"

md () Brenda Walston

1. Pam Peeden md Scott Langley

a. Jennifer Langley

b. Chris Langley

2. Penny Peeden md () Tommy Oakley

B. Dorothy Peeden md () -- Jackson

C. Patti Peeden md () -- Bunn

D. William H. Peeden, Jr

E. Bernice R. Peeden ♂

**Joseph V. Peeden**

Joseph Verlon "Monk" Peeden, 62, of 1501 Stone Stream Drive, Knightdale, died Tuesday, Aug. 29. Funeral was 2 p.m. Thursday, Aug. 31, at L. Harold Poole Funeral Service chapel. Burial was at Gethsemane Memorial Gardens in Zebulon.

Peeden was a construction superintendent for Bobbitt and Associates.

Surviving: wife, Brenda Walston Peeden; daughters and sons-in-law, Pam P. and Scott Langley of Garner, Penny P. and Tommy Oakley of Knightdale; grandchildren, Jennifer and Chris Langley; sisters, Dorothy P. Jackson of Wilson, Pattie P. Bunn of Kenly; brothers, William H. Peeden Jr. of Wilson, Bernice R. Peeden of Fremont.

Zebulon Record THUR 7 SEP 1995 Zebulon, NC

I. William H. Peeden, Sr

A. Joseph Verlon Peeden "Monk"  
md () Brenda Walston

1. Pam Peeden ↑ md Scott Langley

a. Jennifer Langley

b. Chris Langley

2. Penny Peeden md () Tommy Oakley

B. Dorothy Peeden md () -- Jackson

C. Pattie Peeden md () -- Bunn

D. William H. Peeden, Jr

E. Bernice R. Peeden ♂

**Joseph V. Peeden**

Joseph Verlon "Monk" Peeden, 62, of 1501 Stone Stream Drive, Knightdale, died Tuesday, Aug. 29. Funeral was 2 p.m. Thursday, Aug. 31, at L. Harold Poole Funeral Service chapel. Burial was at Gethsemane Memorial Gardens in Zebulon.

Peeden was a construction superintendent for Bobbitt and Associates.

Surviving: wife, Brenda Walston Peeden; daughters and sons-in-law, Pam P. and Scott Langley of Garner, Penny P. and Tommy Oakley of Knightdale; grandchildren, Jennifer and Chris Langley; sisters, Dorothy P. Jackson of Wilson, Pattie P. Bunn of Kenly; brothers, William H. Peeden Jr. of Wilson, Bernice R. Peeden of Fremont.

Zebulon Record THUR 7 SEP 1995 Zebulon, NC

I. William H. Peeden, Sr

A. Joseph Verlon Peeden "Monk"  
md () Brenda Walston

1. Pam Peeden md Scott Langley

a. Jennifer Langley

b. Chris Langley

2. Penny Peeden md () Tommy Oakley

B. Dorothy Peeden md () -- Jackson

C. Pattie Peeden md () -- Bunn

D. William H. Peeden, Jr

E. Bernice R. Peeden ♂

**Joseph V. Peeden**

Joseph Verlon "Monk" Peeden, 62, of 1501 Stone Stream Drive, Knightdale, died Tuesday, Aug. 29. Funeral was 2 p.m. Thursday, Aug. 31, at L. Harold Poole Funeral Service chapel. Burial was at Gethsemane Memorial Gardens in Zebulon.

Peeden was a construction superintendent for Bobbitt and Associates.

Surviving: wife, Brenda Walston Peeden; daughters and sons-in-law, Pam P. and Scott Langley of Garner, Penny P. and Tommy Oakley of Knightdale; grandchildren, Jennifer and Chris Langley; sisters, Dorothy P. Jackson of Wilson, Pattie P. Bunn of Kenly; brothers, William H. Peeden Jr. of Wilson, Bernice R. Peeden of Fremont.



Zebulon Record THUR 7 SEP 1995 Zebulon, NC

I. William H. Peeden, Sr

A. Joseph Verlon Peeden "Monk"  
md () Brenda Walston

1. Pam Peeden md Scott Langley

a. Jennifer Langley

b. Chris Langley

2. Penny Peeden md () Tommy Oakley

B. Dorothy Peeden md () -- Jackson

C. Pattie Peeden md () -- Bunn

D. William H. Peeden, Jr

E. Bernice R. Peeden ♂

**Joseph V. Peeden**

Joseph Verlon "Monk" Peeden, 62, of 1501 Stone Stream Drive, Knightdale, died Tuesday, Aug. 29. Funeral was 2 p.m. Thursday, Aug. 31, at L. Harold Poole Funeral Service chapel. Burial was at Gethsemane Memorial Gardens in Zebulon.

Peeden was a construction superintendent for Bobbitt and Associates.

Surviving: wife, Brenda Walston Peeden; daughters and sons-in-law, Pam P. and Scott Langley of Garner, Penny P. and Tommy Oakley of Knightdale; grandchildren, Jennifer and Chris Langley; sisters, Dorothy P. Jackson of Wilson, Pattie P. Bunn of Kenly; brothers, William H. Peeden Jr. of Wilson, Bernice R. Peeden of Fremont.

Zebulon Record THUR 7 SEP 1995 Zebulon, NC

I. William H. Peeden, Sr ↑

A. Joseph Verlon Peeden "Monk"  
md D Brenda Walston

1. Pam Peeden md Scott Langley

a. Jennifer Langley

b. Chris Langley

2. Penny Peeden md (D) Tammy Oakley

B. Dorothy Peeden md (D) -- Jackson

C. Pattie Peeden md (D) -- Bunn

D. William H. Peeden, Jr

E. Bernice R. Peeden ♂

**Joseph V. Peeden**

Joseph Verlon "Monk" Peeden, 62, of 1501 Stone Stream Drive, Knightdale, died Tuesday, Aug. 29. Funeral was 2 p.m. Thursday, Aug. 31, at L. Harold Poole Funeral Service chapel. Burial was at Gethsemane Memorial Gardens in Zebulon.

Peeden was a construction superintendent for Bobbitt and Associates.

Surviving: wife, Brenda Walston Peeden; daughters and sons-in-law, Pam P. and Scott Langley of Garner, Penny P. and Tommy Oakley of Knightdale; grandchildren, Jennifer and Chris Langley; sisters, Dorothy P. Jackson of Wilson, Pattie P. Bunn of Kenly; brothers, William H. Peeden Jr. of Wilson, Bernice R. Peeden of Fremont.



I. Phillip Perry b 1885

A. Jeremiah Perry b . 1931

1. John Perry "Speck" b 1969 (FCNC)

a. Willie Perry b Aft 1850 → CA

i. Wesley B. Perry CSA b 1877

Bath  
Don Pearce  
Bapt ch

(E) Charles Wesley Perry b 2 JUL 1861 (FCNC) d 14 JAN 1938 (FCNC)

Md 20 JAN 1920 (FCNC) Amy Jane Pearce b (FCNC)

d 12 SEP 1923 (FCNC) d/b Dallas Pearce & Rebecca

Doyle

Bar Gethsemane Mem Gdn

(A) Alton Charles Perry b 1 JUN 1894 (FCNC) d 9 AVE 1970 (FCNC)

md (FCNC) Mattie Lou Murga b 9 OCT 1895 (FCNC) d JAN 1976

(1) Virian Perry b 18 AUG 1917 (WCNC)

md (1st) (WCNC) John Fred Wood

md (2nd) 2 MAY 1938 (WCNC) Matthew Beasley d 30 DEC 1947 (WCNC)

(a) Vicki John Wood - MS UNC-E - Employed IBM-Raleigh

(b) Gwendalyn Faye Beasley md (1) Bobby Gill

(i) Wanda Gill ; (ii) Freddie Gill

(c) Sandra Joan Beasley md (1) Bob Jones

(i) Leigh Ann Jones ; (ii) Dale Jones

(B) James Ollie Perry b 9 JAN 1896 (C) d 5 DEC 1955 (San Diego, GA)

md (1st) (C) Evelyn Mancrieff ; md (2nd) 3 SEP 1947 (C) Bernia Richardson

(1) James Wesley Perry b 14 AUG 1918 (C) d 29 SEP 1969 (C) (BUR Gethsemane

was a med. Eng ← md 22 SEP 1947 (C) Ada Locklear

(a) Earl Perry md (1) Glenda Peedin

(i) Tanya Renae Perry ; (ii) Angela Dawn Perry

(b) Eugenia Perry Grad Peace Col. md (1) Charles Keith Marshburn

(i) Christi Keith Marshburn

(2) Douglas Hockney Perry b 26 JUL 1920 - Career = Railroads

md (1st) 10 MAY 1941 (C) Ann Hicks ; md (2nd) 23 AUG 1964 (C) MERRISE THOMPSON SPENSE

(a) Donald Perry Grad East Carolina - Worked N.C. Tax Dept

md (1st) 10 MAY 1941 (C) Ann Hicks ; md (2nd) 23 AUG 1964 (C) Brenda Tant

(i) Ryan Perry

(b) Debra Perry - Attended Hardhangers

worked telephone ← (3) Miriam Harris Perry b 3 SEP 1922 md 15 FEB 1941 (C) Peyton Hawk

Grad Guilford ← (a) Paul Harris md (1) Diane Bowling

works ← (i) Windy Harris (ii) Kimberly Harris [unclear + Glenda ??]

(b) Laura Harris ; (c) Gloria Harris

(4) Demas Broxton Perry b 1 OCT 1924 (C) d 11 MAR 1966

md (C) 11 AVE 1950 (C) EVA ROBERTS

(a) RANDY Perry ; (b) Vicki Perry ; (c) David Perry DEWARD

(C) Hattie Frances Perry b 5 NOV 1903 (FCNC) d 14 OCT 2003 (FCNC) md (1) "RED" STALLINGS



Survey Map for Subdivision of Property of ELISIE T. U  
 (nee MARY ELISIE TINGEN WIDOW OF HUGH KYLE U s/o ALBERT  
 DOCTOR U OF THE NATHAN U, I / BURTIS U Subclass) - Rec'd  
 9 JAN 2010 by RPA from Spaley (Caraway Smiths - original  
 document filed WC/NC-Land Records - Western Wake C

SURVEYOR = A. EARL SMITH  
 of SMITH & SMITH SURVEYORS  
 RES Certified on 11 MAY 1988  
 PROPERTY DIVIDED INTO  
 4 LOTS  
 SAW MILL BRANCH RUNS  
 SOUTH ALONG THE EASTERN  
 EDGE OF THE PROPERTY  
 ALSO SEE OTHER SHEETS SENT ON  
 SAME DAY - A, B, D, E (SHEETS), F, G

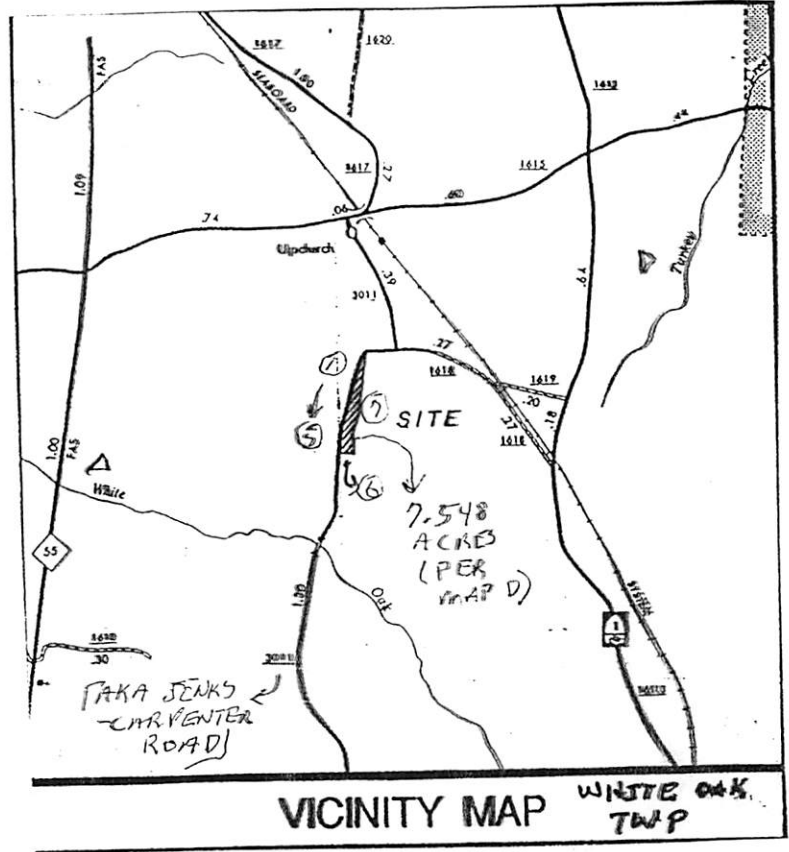

ADJACENT LAND OWNERS:

- ① OTIS T. HOOIG
- ② WAYNE R. HERNDON
- ③ PATRICIA S. SMITH
- ④ ROY H. PEEDIN
- ⑤ HOWARD GRAY HALL
- ⑥ ROBERT W. NICKMAN
- ⑦ HILDA F. CARPENTER w/o ROLAND CARPENTER PER SPALEY 5 JUN 2010

NOTE: See Map D surveyed for Hugh Kyle U on  
 7 MAR 1969 in which 32.789 Acres across the  
 Road from the above 7.548 Acres and 19.670  
 Acres south of the 7.548 Acres (Total = 50.459A  
 + 7.548A = 58.007A) were partitioned off  
 Hugh died 29 FEB 1972; Elsie died 2 SEV 1994  
 GROSS ACRES OF THE 4 LOTS  
 1 = 2.596; 2 = 1.751; 3 = 1.529; 4 = 1.683 = 7.559A

ADC MAP - RALEIGH/CARY  
 WAKE CO., NC

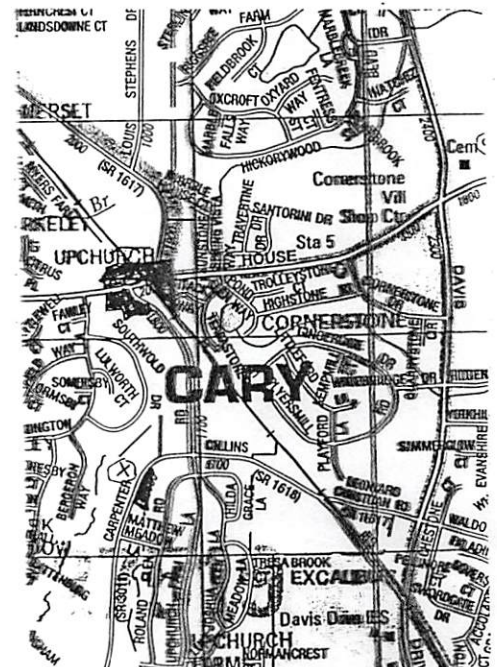

① see ltr 10 CT 1989 Eva Annie Lane Smith DRPH

Alissa Marie Peek (twin) b 5 DEC 1986

(Houston, TX) is dau of Tina Lynne Braun  
who is step-dau of Dick Barkley Smith  
of the James H, IV / Barnwell U subclass

- Perry Franklin Smith



① see ILS 1 OCT 1989 Eva Annie Lane Smith @ RPH

Allison Christine Peek ↑ (twin) b 5 DEC 1986

(Houston, TX) is dau of Tina Lynne Brown  
who is step-dau of Rich Barkley Smith  
of the James H, IV / Burnell U Subsidiary  
- Perry Franklin Smith.

① See SA 20 JUN 1990 James Shannon Elder to RPH  
Jizzie Mae b 31 MAY 1899 d 9 DEC 1976 and  
Charles Elbert Peck b 18 DEC 1892 d 4 MAR 1969.  
Jizzie is dau of Joseph Alonzo & (The Charles)  
 Thomas Gay II, Sr. Suburban

② See SA 30 OCT 1990 James Shannon Elder to RPH  
Jizzie Mae II [not Elizabeth] b Fairburn, GA - lived  
 an Elder St in Fairburn, GA but d in a hospital  
 in Atlanta, GA (Bur-Holly Hill Cem, Fairburn, GA)  
 and 10 MAY 1941 Charles Elbert Peck b Palmetto, GA  
 Bur-AS WIF. No children. CEPA was son of  
 Joseph R. Peck and Josephine Elizabeth Richards



① see ltr 1 OCT 1989 Eva Anne Lone Smith DRPI

Cody Michael Peek ↑ b. 22 FEB 1988 (Houston,

TX) is son of Tina Lynne Braun who is  
step-daughter of Dick Barkley Smith of the  
James W, Jr / Burnell W Subidan - Perry Franklin  
Smith.

○ see It's 21 APR 1993 Jeallayne NMN Rogers & RPA

I. Joseph Rogers, Sr [will written 18 FEB 1752 (Northampton Co, NC) - probated FEB Court 1752]. m. Mary Fargeson

A. Reuben Rogers b. 1 NOV 1735 (Sandy Co, VA) & 1829 (GA)  
m. 15 DEC 1767 (Johnston Co, NC) Temperance  
James b. 24 AUG 1751. They moved to GA 1773

1. John Rogers b. 24 APR 1769 & Taliferro Co, GA  
[will written / signed 14 SEP 1829, probated SEP 1836]  
m. Nancy Swain [da. of John Swain]

a. Susan Rogers b. ca 1803 m. William  
Winfrey Peek b. 3 MAY 1799 (Hancock Co, GA)  
& 27 MAY 1884 (Cedartown, GA)

i.g.

Emily Asenath Peek b. 6 MAR 1825 (Taliferro Co, GA)  
& 8 DEC 1897 (Penfield, GA) m. (Cedartown, GA)  
William Francis Jones

(I) Jennie Lula Jones m. 1880 Ebenezer Peek ↑

(A) Susie Lane Peek b. 1872 & 1983 m. 1910  
Robert Luther Neighbors

(1) Reba Belle Neighbors\* b. 1925 (Shawnee, OK)  
m. 1941 Delmar L. Collins & 1983

\* Director Emeritus of Will Rogers Memorial PO Box 2633 Edmond,  
OK 73083



See Its 21 APR 1993 Jeallayne NMN Rogers & RPA

I. Joseph Rogers, Sr [will written 18 FEB 1752 (Northampton Co, NC) - probated FEB court 1752]. and Mary Fargerson

A. Reuben Rogers b 1 NOV 1735 (Savoy Co, VA) d 1829 (GA) and 15 DEC 1767 (Johnston Co, NC) Temperance James b 24 AUG 1751. They moved to GA 1773

1. John Rogers b 24 APR 1769 d Taliferro Co, GA [will written/signed 14 SEP 1829, probated SEP 1836] and Nancy Swain [daur of John Swain]

a. Susan Rogers b ca 1803 and William Winfrey Peek b 3 MAY 1799 (Hancock Co, GA) d 27 MAY 1884 (Cedartown, GA)

↓ i.g.  
Emily Asenath Peek b 6 MAR 1825 (Taliferro Co, GA) d 8 DEC 1891 (Penfield, GA) and (Cedartown, GA) William Francis James

(I) Jennie Lula James and 1880 Ebenezer Peek

(A) Susie Lane Peek b 1892 d 1983 and 1910 Robert Luther Neighbors

(I) Reba Belle Neighbors\* b 1925 (Shawnee, OK) and 1941 Delmar I. Collins d 1983

\* Director Emeritus of Will Rogers Memorial PO Box 2633 Edmond, OK 73083

MABEL HELEN PEEK

① See Family Chart 5 JAN 1981 William Joseph U & ROY

Mabel Helen Peek [daughter Robert Peek] b 25 MAR 1894

d 10 SEP 1967 mtd 2 MAY 1918 Alfonso C. Crowley

b 28 FEB 1882 d 14 APR 1955. Their dau Ruth

Crowley mtd 2 JUN 1953 William Joseph M U

of the William U Sr / Abel U Sr Sablan.



① See Jt 10 OCT 1989 Eva Annie Jones Smith ID R04  
Megon Cathleen Peek b 7 OCT 1983 (Houston, TX)  
is dau of Tina Lynne Brown who is step-dau  
of Rich Borkley Smith of the James A, II /  
Barnell H Gulistan - Perry Franklin Smith

① see ftr 1 OCT 1989 Eva Anne Lane Smith D R 04

Michael Peek m d 16 MAY 1981 (Houston, TX)

Tina Lynne Brown b 10 SEP 1961 (Houston, TX),  
step-daughter of Dick Barkley Smith of the James  
W. IV / Burnell W. Subclass - Perry Franklin Smith

② see ftr 4 NOV 1989 Eva Anne Lane Smith D R 04

Michael Ray Peek b 14 FEB 1959 (Houston, TX)

m d Tina Lynne Brown.



ROBERT PEEK

① see Family Chart 5 JAN 1981 William Joseph U & ROY

~~Alfonso C. C.~~ Robert Peek d 1919 wd  
Adeline Stafford. Their dau Mahel Helen  
Peek b 25 MAR 1894 ~~wd~~ had a dau  
Ruth Crowley who wd 2 JUN 1953  
William Joseph U of the William U IV / Aluel  
U sa Sublan.

*[Handwritten notes in orange ink, illegible]*

OFFICE OF THE COMPTROLLER GENERAL  
WASHINGTON, D.C. 20548

*[Handwritten initials]*

Zebulon Record THUR 7 SEP 1995 Zebulon, NC

I. William H. Peeden, Sr

A. Joseph Verlon Peeden "Monk"  
md () Brenda Walston

1. Pam Peeden md Scott Langley

a. Jennifer Langley

b. Chris Langley

2. Penny Peeden md () Tammy Oakley

B. Dorothy Peeden md () -- Jackson

C. Pattie Peeden md () -- Bunn

D. William H. Peeden, Jr

E. Bernice R. Peeden ♂

**Joseph V. Peeden**

Joseph Verlon "Monk" Peeden, 62, of 1501 Stone Stream Drive, Knightdale, died Tuesday, Aug. 29. Funeral was 2 p.m. Thursday, Aug. 31, at L. Harold Poole Funeral Service chapel. Burial was at Gethsemane Memorial Gardens in Zebulon.

Peeden was a construction superintendent for Bobbitt and Associates.

Surviving: wife, Brenda Walston Peeden; daughters and sons-in-law, Pam P. and Scott Langley of Garner, Penny P. and Tommy Oakley of Knightdale; grandchildren, Jennifer and Chris Langley; sisters, Dorothy P. Jackson of Wilson, Pattie P. Bunn of Kenly; brothers, William H. Peeden Jr. of Wilson, Bernice R. Peeden of Fremont.



○ The Zebulon Record THUR 30 JUL 1987 Zebulon, NC

*Clara Peedin Phillips*

Mrs. Clara Peedin Phillips, 71, of Selma, died Saturday, July 25.  
Surviving: stepsons, Theibert Phillips of Smithfield, C.B. Phillips of Zebulon, Bobby Phillips and Kenneth Phillips, both of Selma, Keith Phillips of Pine Level; stepdaughters, Mrs. Ruth Pittman of California, Mrs. Ethel Cowan of Pikeville, Mrs. Mary Estelle Mitchell of Durham; brothers, Troy Peedin, Cooper Peedin, L.B. Peedin and Walter Peedin, all of Selma; sisters, Mrs. Lucille Raynor of Micro, Mrs. Mary Price of Norfolk, Va., Mrs. Helen Baker of Smithfield.

○ See file 7 DEC 1976 Willie Alton Reid, Jr. DRPU

[NOTE: The individuals below have been placed in the Jubal W/ Frances W subclass but not given XIA's since there is still debate as to whether the Frances W was the dau of Jubal W or the dau of a Gay & thus nee Frances Gay who was married to of the Richard W, III/ James W VII subclass - RPU 7 JAN 1997]

- △ 1 Blake BAKER b: Abt 1804 in Franklin Co., NC d: January 21, 1863 in Wake Co., NC
- △ + Frances UPCHURCH b: Abt 1800 m: Abt November 16, 1829 in Wake Co., NC d: Abt 1845
- 2 Thomas H. BAKER b: Abt 1831 d: May 21, 1865 in Fort McHenry Post Hospital, Baltimore, MD (POW)
- △ 2 Jasper BAKER b: Abt 1833 in Wake Co., NC d: Abt 1882
- △ + Virginia HICKS b: in Wake Co., NC m: Abt January 10, 1882
- 2 Richard Sanders BAKER b: March 19, 1833 in Wake Co. or Franklin Co., NC d: December 18, 1891 in Wake Co., NC
- + Elizabeth Margaret ("Bettie") BAKER b: January 21, 1841 in North Carolina m: December 20, 1865 in ? d: November 7, 1902 in Wake Co., NC
- 3 Eliza ("Lila") F. BAKER b: April 8, 1867 in Wake Co., NC d: December 9, 1870 in Wake Co., NC
- △ 3 Solon BAKER b: July 17, 1869 in Wake Co., NC d: August 26, 1942
- △ + Mary Simon BAKER b: April 1859 m: July 21, 1895 d: September 15, 1903
- ..... 4 Minnie Ada BAKER b: July 13, 1895 in Wake Co., NC d: June 4, 1983 in Wake Co., NC
- ..... + George Steven LOCKLEAIR b: October 21, 1896 in Sylvania, GA m: February 16, 1918 in Wake Co., NC d: January 23, 1960 in Durham, NC (VA Hospital)
- ..... 5 Ada Eugenia LOCKLEAIR b: October 29, 1919
- ..... + James Wesley PERRY b: August 14, 1918 in Franklin Co., NC m: July 22, 1941 in Wake Co., NC d: September 27, 1969 in Wake Co., NC
- ..... 6 Wesley Earl PERRY b: May 17, 1942 in Franklin Co., NC d: April 9, 1987 in Guilford Co., NC
- ..... + Glenda Jeanette PEEDIN b: June 9, 1943 in Johnston Co., NC m: May 9, 1964
- ..... 7 Angela Dawn PERRY b: September 3, 1966
- ..... + Robert Anderson DALTO b: in NY or NJ
- ..... 7 Tonia Renee PERRY b: October 5, 1971 in Wake Co., NC
- ..... 6 Carolyn Eugenia ("Gene") PERRY b: July 8, 1944
- ..... + Charles Keith MARSHBURN b: December 19, 1943 in Wake Co., NC m: June 6, 1964
- ..... 7 Christopher Keith MARSHBURN b: December 20, 1972
- ..... 7 Jonathan Derick MARSHBURN b: December 24, 1981
- ..... 5 George Thomas LOCKLEAIR b: October 11, 1921 in Wake Co., NC d: May 10, 1964
- ..... + Eva Lee Mavis ALFORD b: November 28, 1923 in Wake Co., NC m: June 6, 1943
- ..... 6 Alma Lee LOCKLEAIR b: May 11, 1946 in Wake Co., NC d: July 9, 1964 in Wake Co., NC
- ..... 6 Mavis Ilene LOCKLEAIR b: May 15, 1949 in Wake Co., NC
- ..... + George Wiley LAMBERT b: in Nash Co., NC m: February 1958
- ..... \*2nd Husband of Mavis Ilene LOCKLEAIR:
- ..... + Raymond CHOQUETTE b: in New Hampshire m: February 15, 1975
- ..... \*3rd Husband of Mavis Ilene LOCKLEAIR:
- ..... + Dennis Floyd BRANTLEY b: February 27, 1952 in Nash Co., NC m: October 28, 1983
- ..... 6 Sandra Kay LOCKLEAIR b: October 19, 1950 in Wake Co., NC
- ..... + Ronnie Martin CORTNER b: February 19, 1949 in Jefferson City, MO m: August 17, 1967
- ..... 6 George Thomas LOCKLEAIR, Jr. b: October 6, 1954 in Wake Co., NC
- ..... + Doris Kathryn WILLIAMS b: July 28, 1954 in Franklin Co., NC m: May 31, 1975
- ..... 7 Jeremy Thomas LOCKLEAIR b: April 12, 1977 in Wake Co., NC
- ..... 6 Johnny Wayne LOCKLEAIR b: March 10, 1956 in Wake Co., NC
- ..... + Cindy Juanita O'NEAL b: July 1, 1957 in Wake Co., NC m: July 2, 1982



GLENDA JEANETTE REEDIN

XFD-28530

(2)

See Reference 49

I. Matthe Adna Punette of the Richard II, III/  
Barbely U Sabdan - Anna U Line

A. Berna sisco Richardson

1. James Wesley Perry b 14 AUG 1918  
& 29 SEP 1969 (bur - Gettysburg Mem.  
Garden, Reidsville, NC) and 22 SEP 1941  
Ada Locklear.

a. Earl Perry - and Glenda Reedin

i. Tanya Renae Perry

ii. Angela Dawn Perry

b. Eugenia Perry and Keith Marshall

i. Christi Keith Marshall

SADIE

PEEDIN

○ Zelinton Record THUR 9 JAN 1997 Zelinton, NC

SADIE PEEDIN ↑

FESTUS LEROY OLIVER

PAUL A. LONG

**Sadie Peedin Oliver Long**

Sadie Peedin Oliver Long of Smithfield died Friday, Dec. 27, 1996. Graveside service was Saturday, Dec. 28, 1996, at the Creech Cemetery.

She was the widow of Festus Leroy Oliver who died in 1926 and Paul A. Long who died in 1959.

Surviving: son, M.J. Oliver of Smithfield; stepson, George Long of Norfolk, Va.; daughter, Nina Oliver Lassiter of Smithfield; stepdaughter, Olivia Long Taylor of Mesa, Ariz.; grandchildren, Terry C. Lassiter of Smithfield, Kathy Oliver Hardee of Camp Lejeune, Melvin Oliver Jr. of Middlesex, Susan Taylor Einstien of Phoenix, Ariz., Charles Taylor of Arkansas Pass, Texas; eight great-grandchildren.

Memorial contributions may be made to the charity of one's choice.

Arrangements by Underwood Funeral Home.



① see It's 21 APR 1993 Joullayne NMN Roger & RPA

I. Joseph Rogers, sr [will written 18 FEB 1752 (Northampton Co, NC) - probated FEB court 1752]. and Mary Fargerson

A. Reuben Rogers b 1 NOV 1735 (Sandy Co, VA) & 1829 (GA) md 15 DEC 1767 (Johnston Co, NC) Temperance James b 24 AUG 1751. They moved to GA 1773

1. John Rogers b 24 APR 1769 & Taliferro Co, GA [will written / signed 14 SEP 1829, probated SEP 1836] md Nancy Swain [daughter of John Swain]

a. Susan Rogers b ca 1803 md William Winfrey Peek b 3 MAY 1799 (Hancock Co, GA) & 29 MAY 1884 (Cedartown, GA)

↓ i.g.  
Emily Asenath Peek b 6 MAR 1825 (Taliferro Co, GA) & 8 DEC 1891 (Penfield, GA) md (Cedartown, GA) William Francis Jones

(I) Jennie Lula Jones md 1880 Ebenezer Peek

(A) Susie Tone Peek ↑ b 1892 & 1983 md 1910

Reuben Luther Neighbors

(I) Reba Belle Neighbors\* b 1925 (Shawnee, OK) md 1941 Delmar L. Collins & 1983

\* Director Emeritus of Will Rogers Memorial PO Box 2633 Edmond, OK 73083

○ See It's 21 APR 1993 Joublayne NMN Rogers & RPA

I. Joseph Rogers, Sr [will written 18 FEB 1752 (Northampton Co, NC) - probated FEB Court 1752]. and Mary Fargerson

A. Reuben Rogers b 1 NOV 1735 (Sandy Co, VA) d 1829 (GA) and 15 DEC 1767 (Johnston Co, NC) Temperance James b 24 AUG 1751. They moved to GA 1773

1. John Rogers b 24 APR 1769 d Taliferro Co, GA [will written/signed 14 SEP 1829, probated SEP 1836] and Nancy Swain [sister of John Swain]

a. Susan Rogers b ca 1803 and William Winfrey Peek b 3 MAY 1799 (Hancock Co, GA) d 27 MAY 1884 (Cedartown, GA)

↓ i.g.  
Emily Asenath Peek b 6 MAR 1825 (Taliferro Co, GA) d 8 DEC 1891 (Penfield, GA) and (Cedartown, GA) William Francis Jones

(I) Jennie Lula Jones and 1880 Ebenezer Peek

(A) Susie Lane Peek b 1892 d 1983 and 1910 Robert Luther Neighbors

(I) Reba Belle Neighbors\* b 1925 (Shawnee, OK) and 1941 Delmar L. Collins d 1983

\* Director Emeritus of Will Rogers Memorial PO Box 2633 Edmond, OK 73083



① See 12 JUN 1979 Lt (Pg 12) Julia Elizabeth U to RPA  
Hal Holt Peel, III and Margaret Elaine  
Pittman b 13 FEB 1954. Margaret is son  
of Robert Daniel Pittman Sr + gd of Jessie  
Eleanor U b 25 JUN 1882 y William / Abel  
U. Class.

② See Lt 15 JUL 1989 Robert Daniel Pittman, Sr to RPA  
HNP, III b 15 JUN 1951 and 12 SEP 1971 (Tupelo, MS)  
Margaret Elaine Pittman b Clarksdale, MS. Two  
children.

① see 12 JUN 1979 It (Pg 12) Julia Elizabeth U. Class  
Hal Holt Peel, IV b 3 JAN 1975 is son of  
 Margaret Elaine Pittman, gr of Robert  
 Daniel Pittman, Sr + gr of Jenna Eleanor  
U b 25 JUN 1882 of William / Adel U. Class.

② see It 15 JUL 1989 Robert Daniel Pittman, Sr ARP4  
HNP, IV b 3 JAN 1975 (Tupelo, MS)

SEARCHED - 200 1979  
 INDEXED - 200 1979  
 SERIALIZED - 200 1979  
 FILED - 200 1979

JUN 1979  
 JUN 1979  
 JUN 1979  
 JUN 1979

JUN 1979  
 JUN 1979  
 JUN 1979  
 JUN 1979

JUN 1979  
 JUN 1979  
 JUN 1979  
 JUN 1979

JUN 1979  
 JUN 1979  
 JUN 1979  
 JUN 1979

JUN 1979  
 JUN 1979  
 JUN 1979  
 JUN 1979



① See #1 15 JUL 1989 Robert Daniel Pittman, Sr. AKA  
Jeffrey Peel b 22 NOV 1977 (Tupelo, MS) is son  
of Margaret Elaine Pittman of The Williams U, IV/  
Abel U, Sr. Sudan - Leona Glanor U

SALLY

PEEL

○ From Ltr 20 MAY 2002 Cynthia Ann Madden to RPM

I. Benjamin W - Head of class

A. Elizabeth W (b. abt 1771) (ndc) John Carpenter

biological  
Parents not established  
25 MAY 2002 - RPM

1. Winifred Upchurch <sup>1803</sup> → Winifred Carpenter  
a. Harriet R. Sanderford - For marriage & descendants see below:

**Husband: Langford H. Wedgeworth** (3)

Born: December 08, 1821 in: Gainsville, Sumter County, AL  
 Married: 1858 in: Greene County, AL  
 Died: January 21, 1888 in: Lauderdale County, MS  
 Father: James Wedgeworth  
 Mother: Jinsey Walker

**Wife: Harriet R. Sanderford**

Born: April 08, 1836 in: Greene County, AL  
 Died: July 17, 1905 in: Lauderdale County, MS  
 Father: James Sanderford  
 Mother: Winifred Carpenter  
 Other Spouses: John Swilley - 1 CHILD - MARTHA SWILLEY b 1853

Both buried in  
Lockhart Methodist  
Cemetery, Lauderdale  
CO, MS

**CHILDREN**

I	Name: Lucinda J. Wedgeworth Born: 1861 married Died: 1940 Spouse: E. L. Price	- in: Lauderdale County, MS in: Lauderdale County, MS	} 1 CHILD HATTIE PRICE b 1885
F			
2	Name: James G. Wedgeworth Born: 1863 Married: September 01, 1882 Spouse: L. Hoffman	in: Lauderdale County, MS	
M			
3	<input type="checkbox"/> Name: Charles Campbell Wedgeworth Born: February 09, 1866 Married: August 04, 1886 Died: October 09, 1939 <input type="checkbox"/> Spouse: Ella Lee Miller	in: Choctaw County, AL in: Lauderdale County, MS in: Bienville Parish, LA	
M			
4	Name: Sarah Lonnie Wedgeworth Born: 1868 Married: December 07, 1887 Spouse: Charles R. Cox	in: Lauderdale County, MS	
F			
5	Name: John Kelly Wedgeworth Born: February 1870 Married: November 18, 1891 Spouses: Grace Walker, Hattie A. Miller	in: Lauderdale County, MS	
M			
6	Name: William Lankford Wedgeworth Born: September 1873 Married: May 02, 1896 Died: 1960 Spouse: Sally Peel ↑	in: Lauderdale County, MS in: Lauderdale County, MS in: Lauderdale County, MS	
M			

○ From list of Jimmie Walker U, Sr who died 11 MAY 2010, Apex, NC

I. Clyde Walker U s/o Albert Baker U of the Watson U, F/  
Burtis U subclass. Gilbert Burtis U subclass.

A. Jimmie Walker U, Sr.

1. Pamela Jill U

△ 2. Sandra Fagell

△ m d ( ) Aaron Peeler

△ a. Christopher Peeler

△ b. Evans Peeler.



○ KY UPCHURCH BIRTHS - DOWNLOAD IN LTR 20JAN  
 2001 - CHARLES JOHN PETERSON, JR TO RPU PG (29)

Certifi	Child		County	Mother		DY	MO	YR	
15674	MCCLANAHAN MAHALA	NICOLE	PLSKI	UPCHURCH DONNA	M	3	4	1998	32
360	MCGINNIS EVELYN	SUE	CLNTN	UPCHURCH PEGGY	J	6	1	1971	1
54479	MCGINNIS STEVEN	RAY	CLNTN	UPCHURCH PEGGY		13	12	1968	109
47182	MCKINNEY KELLEY	DIANE	JEFFN	UPCHURCH SAMMY	J	15	9	1961	95
28440	MCKINNEY WILLIAM	MATTHEW	JEFFN	UPCHURCH SAMMY	J	27	7	1966	57
40869	MCWHORTER JOY	LEE	WAYNE	UPCHURCH LORETTA		8	9	1966	82
2881	MCWHORTER LOIS	ANN	WAYNE	UPCHURCH LORETTA		16	1	1965	6
43783	MOON PAULA	DAWN	BARRN	UPCHURCH GLENDA	F	23	9	1984	88
91052	MORGAN DONALD	C	MOCRY	UPCHURCH NANNIE		17	9	1923	187
20507	MORGAN LYLE	L	BARRN	UPCHURCH IMOGENE		21	4	1949	42
43052	MORGAN STEVEN	U	BARRN	UPCHURCH IMOGENE		3	7	1953	87
10781	MORRIS LELOR	E	WAYNE	UPCHURCH LOLA		11	2	1924	22
59413	MORROW ANTHONY	CHARLES	WAYNE	UPCHURCH BETTY		23	11	1965	119
15741	MORROW BRIAN	SCOTT	PLSKI	UPCHURCH BETTY	S	5	4	1969	32
36485	MORROW CRYSTAL	LEE	PLSKI	UPCHURCH BETTY	S	8	9	1975	73
48441	MORROW DUANE	REED	WAYNE	UPCHURCH BETTY		5	9	1964	97
26739	MOSELEY HALEY	ELIZABETH	JEFFN	UPCHURCH SANDRA		22	7	1994	54
39140	MULLINS BRENDA	J	WAYNE	UPCHURCH VELMA		13	7	1959	79
92847	MULLINS JESSE	W	WAYNE	UPCHURCH VELMA		15	6	1957	199
49370	NANKIVELL FRANK	A	TAYLR	UPCHURCH VESTA		21	9	1953	99
24	NANKIVELL JAMES	B	ADAIR	UPCHURCH VESTA		2	1	1945	1
38	NANKIVELL PEGGY	J	ADAIR	UPCHURCH VESTA		9	1	1946	1
71771	NEAL JEFFERY	O	WAYNE	UPCHURCH JEWELL		21	11	1954	144
9128	NEAL JOYCE	A	WAYNE	UPCHURCH JEWELL		24	1	1956	19
67819	NEAL STEVIE	LEE	CLNTN	UPCHURCH LOIS	J	25	11	1962	136
19454	NEAL TIMOTHY	WAYNE	WAYNE	UPCHURCH LOIS		28	2	1964	39
25909	NEUHARD ANTHONY	DAVID	JEFFN	UPCHURCH REBECCA	K	14	7	1973	52
36130	PACE TRACY	LYNN	WARRN	UPCHURCH JOYCE	A	22	8	1974	73
25449	PARMLEY STEVEN	DWAYNE	WAYNE	UPCHURCH MARY	E	10	5	1961	51
66148	PARRIGIN CARLA	L	CLNTN	UPCHURCH BONNIE		21	12	1955	133
20130	PARRIGIN JAMES	D	CLNTN	UPCHURCH BONNIE		29	5	1953	41
35459	PATTON JOHN	G	CLNTN	UPCHURCH IDA		11	11	1924	71
36262	PATTON ODEAN		CLNTN	UPCHURCH IDA		7	7	1930	73
36261	PATTON ORA	D	CLNTN	UPCHURCH IDA		7	7	1930	73
39926	<del>PEELER AMY</del>	<del>LOVE</del>	HPKNS	UPCHURCH BETTY	L	13	8	1961	80
52097	PEELER DAVID	NEIL	HPKNS	UPCHURCH BETTY	L	14	10	1962	105

○ From Obit of Jimmie Walker U, Sr who died 11 MAY 2010, Apex, NC

I. Clyde Walker U s/o Albert Dozier U of the Waltham U, F/  
Benton U subclass. Gilbert Benton U subclass.

A. Jimmie Walker U, Sr.

1. Pamela Jull U

△ 2. Sandra Fagell

△ m d (1) Aaron Peeler

△ a. Christopher Peeler

△ b. Evans Peeler.

○ KY UPCHURCH BIRTHS - DOWNLOAD IN LTR 20 JAN  
 2001 - CHARLES JOHN PETERSON, JR TO RPU PG (29)

Certifi	Child		County	Mother		DY	MO	YR		
15674	MCCLANAHAN	MAHALA	PLSKI	UPCHURCH	DONNA	M	3	4	1998	32
360	MCGINNIS	EVELYN	CLNTN	UPCHURCH	PEGGY	J	6	1	1971	1
54479	MCGINNIS	STEVEN	CLNTN	UPCHURCH	PEGGY		13	12	1968	109
47182	MCKINNEY	KELLEY	JEFFN	UPCHURCH	SAMMY	J	15	9	1961	95
28440	MCKINNEY	WILLIAM	JEFFN	UPCHURCH	SAMMY	J	27	7	1966	57
40869	MCWHORTER	JOY	WAYNE	UPCHURCH	LORETTA		8	9	1966	82
2881	MCWHORTER	LOIS	WAYNE	UPCHURCH	LORETTA		16	1	1965	6
43783	MOON	PAULA	BARRN	UPCHURCH	GLENDA	F	23	9	1984	88
91052	MORGAN	DONALD	MCCRY	UPCHURCH	NANNIE		17	9	1923	187
20507	MORGAN	LYLE	BARRN	UPCHURCH	IMOGENE		21	4	1949	42
43052	MORGAN	STEVEN	BARRN	UPCHURCH	IMOGENE		3	7	1953	87
10781	MORRIS	LELOR	WAYNE	UPCHURCH	LOLA		11	2	1924	22
59413	MORROW	ANTHONY	WAYNE	UPCHURCH	BETTY		23	11	1965	119
15741	MORROW	BRIAN	PLSKI	UPCHURCH	BETTY	S	5	4	1969	32
36485	MORROW	CRYSTAL	PLSKI	UPCHURCH	BETTY	S	8	9	1975	73
48441	MORROW	DUANE	WAYNE	UPCHURCH	BETTY		5	9	1964	97
26739	MOSELEY	HALEY	JEFFN	UPCHURCH	SANDRA		22	7	1994	54
39140	MULLINS	BRENDA	WAYNE	UPCHURCH	VELMA		13	7	1959	79
92847	MULLINS	JESSE	WAYNE	UPCHURCH	VELMA		15	6	1957	199
49370	NANKIVELL	FRANK	TAYLR	UPCHURCH	VESTA		21	9	1953	99
24	NANKIVELL	JAMES	ADAIR	UPCHURCH	VESTA		2	1	1945	1
38	NANKIVELL	PEGGY	ADAIR	UPCHURCH	VESTA		9	1	1946	1
71771	NEAL	JEFFERY	WAYNE	UPCHURCH	JEWELL		21	11	1954	144
9128	NEAL	JOYCE	WAYNE	UPCHURCH	JEWELL		24	1	1956	19
67819	NEAL	STEVIE	CLNTN	UPCHURCH	LOIS	J	25	11	1962	136
19454	NEAL	TIMOTHY	WAYNE	UPCHURCH	LOIS		28	2	1964	39
25909	NEUHARD	ANTHONY	JEFFN	UPCHURCH	REBECCA	K	14	7	1973	52
36130	PACE	TRACY	WARRN	UPCHURCH	JOYCE	A	22	8	1974	73
25449	PARMLEY	STEVEN	WAYNE	UPCHURCH	MARY	E	10	5	1961	51
66148	PARRIGIN	CARLA	CLNTN	UPCHURCH	BONNIE		21	12	1955	133
20130	PARRIGIN	JAMES	CLNTN	UPCHURCH	BONNIE		29	5	1953	41
35459	PATTON	JOHN	CLNTN	UPCHURCH	IDA		11	11	1924	71
36262	PATTON	ODEAN	CLNTN	UPCHURCH	IDA		7	7	1930	73
36261	PATTON	ORA	CLNTN	UPCHURCH	IDA		7	7	1930	73
39926	PEELER	AMY	HPKNS	UPCHURCH	BETTY	L	13	8	1961	80
52097	PEELER	DAVID	HPKNS	UPCHURCH	BETTY	L	14	10	1962	105



○ See Profile of John Marion U - Entry 8 SEP 1995

I. William David U, Sr of the William U, IV / John U, V  
Subclass - David U Line

A. Francis Bowler U "Frank" DDS md 1926 Joe Rachel Fone

1. Becky Fone U md DON Peeler - 6 children

2. Ann Coats U md Robert Mainord Todd, Jr M.D. - 4 children

B. Joanna Bond U b ca 1899 - still living

md (1st) Cole McKimney - No Issue

md (2nd) Arthur Sivers - No Issue

C. Angelyn U - md 1st (?) David Todd Simpson - No Issue  
md 2nd (?) Collett Creek - No Issue

D. William David U, Jr

1. William David U, III M.D. b 1934 d 1994 (Auto Accident)  
(Bar-Friendship Baptist Church, Henry Co, TN)  
md Ann Gaddy. They had four children all girls

2. Charles Marian U, M.D.

md (?) Sally McClure. Two children - both boys

E. Katherine U md Robert W. Huntington, Jr. M.D. "BOB"

1. Robert W. Huntington, III, M.D. "BOBBY"

md Danna Burgess - Two children both girls

2. Ann Bowler Huntington md Alan Feldman - 3 children

3. Edith W. Huntington md Hugo Rosgado - 1 child, a son

4. Deborah I. Huntington "Debbie" md  
Andrew S. Ward. They have two children

○ KY UPCHURCH BIRTHS - DOWNLOAD IN LTR 20JAN  
 2001 - CHARLES JOHN PETERSON, JR TO RPU PG (30)

Certifi	Child			County	Mother	DY	MO	YR	
17029	<del>PEELER</del>	<del>DONNA</del>	<del>J</del>	HPKNS	UPCHURCH BETTY	8	4	1958	35
46501	PEELER	FRANK	SCOTT	HPKNS	UPCHURCH BETTY	L	23	8	1965 94
10402	PEELER	JACK	U	HPKNS	UPCHURCH BETTY		23	2	1960 21
13960	PERDUE	GENIEVA	L	WAYNE	UPCHURCH EFFIE		9	11	1933 28
62444	PERKINS	CHARLES	A	PLSKI	UPCHURCH PHYLLIS		17	7	1947 125
31882	PHELPS	BILLY	RAY	WARRN	UPCHURCH DORIS	R	14	7	1971 64
51849	PHELPS	RONALD	JAY	WARRN	UPCHURCH DORIS	R	30	11	1972 104
38102	PIERCE	LOLA	F	PLSKI	UPCHURCH MARY		25	6	1949 77
72726	PIERCE	STEPHEN	K	CLNTN	UPCHURCH MARY		16	12	1953 146
75045	PIERCE	TIMOTHY		HARDN	UPCHURCH HELEN		30	9	1956 151
39164	PIERCE	WANDA	J	CLNTN	UPCHURCH MARY		18	6	1955 79
50802	PIERCEY	HOLLY	ANN	PLSKI	UPCHURCH TERESA	A	16	12	1984 102
23237	PIERCEY	AMY	MICHELLE	PLSKI	UPCHURCH TERESA	A	1	7	1988 47
5047	PIERCY	JAMIE	LEE	BARRN	UPCHURCH TERESA	A	9	3	1983 11
21862	PILE	RITA	K	CLNTN	UPCHURCH LEVA		26	3	1948 44
64571	POE	BRENDA	G	WAYNE	UPCHURCH LOIS		4	11	1959 130
61907	POE	ELDRED	L	WAYNE	UPCHURCH LULA		16	11	1940 124
24896	POE	ESTEL	F	WAYNE	UPCHURCH LULA		5	5	1930 50
21130	POE	EVERETT	G	WAYNE	UPCHURCH LULA		4	4	1939 43
8215	POORE	BETTY	JUNE	WAYNE	UPCHURCH MARGIA		19	1	1964 17
38552	POORE	BILLY	J	WAYNE	UPCHURCH MARGIE		21	6	1949 78
12674	POORE	EMERY	DAVID LANIER	FYETE	UPCHURCH MARIAN	L	4	4	1998 26
14844	POORE	JACK	L	WAYNE	UPCHURCH MARGIE		8	2	1948 30
27724	POTTON	FLONNIE	B	CLNTN	UPCHURCH IDA		10	6	1927 56
54441	PYLE	LARRY	D	CLNTN	UPCHURCH WILLIS		9	10	1945 109
14967	RAMSEY	FREDDIE	K	CLNTN	UPCHURCH ELIZABETH		26	4	1933 30
47842	RAMSEY	JOHN	F	WAYNE	UPCHURCH ELIZABETH		4	9	1931 96
72984	RAMSEY	JOYCE	E	PLSKI	UPCHURCH ELIZABETH		21	12	1950 146
7264	RAMSEY	KIRK	GORDON	PLSKI	UPCHURCH ORETTA		8	2	1963 15
31952	RAMSEY	MICHAEL	S	PLSKI	UPCHURCH AMERICA		28	6	1948 64
39218	RAMSEY	RAY	H	WAYNE	UPCHURCH ARCO		29	10	1922 79
26379	RAMSEY	ROSA	N	WAYNE	UPCHURCH ELIZABETH		20	5	1939 53
61633	RECTOR	VELA	M	WAYNE	UPCHURCH LELA		13	9	1928 124
57917	RECTOR	VIRGINIA	A	WAYNE	UPCHURCH SUDIE		29	5	1926 116
42696	REED	JUDITH	E	MASON	UPCHURCH LOIS		17	8	1946 86
60197	RILEY	JAMES	TROY	CLNTN	UPCHURCH MARRANN		21	12	1965 121

○ From list of Jimmie Walker U, Sr who died 11 MAY 2010, Apex, NC

I. Clyde Walker U s/o Albert Baker U of the Walker U, F/  
Burtis U subclass. Gilbert Burtis U subclass.

A. Jimmie Walker U, Sr.

1. Pamela Jill U

△ 2. Sandra Fay U

△ m d (1) Aaron Peeler

△ a. Christopher Peeler

△ b. Evan Peeler.



FRANK SCOTT PEELER

○ KY UPCHURCH BIRTHS - DOWNLOAD IN LTR 20JAN  
 2001 - CHARLES JOHN PETERSON, JR TO RPU PG (30)

Certifi	Child			County	Mother		DY	MO	YR	
17029	PEELER	DONNA	J	HPKNS	UPCHURCH BETTY		8	4	1958	35
46501	<del>PEELER</del>	<del>FRANK</del>	<del>SCOTT</del> ↑	HPKNS	UPCHURCH BETTY	L	23	8	1965	94
10402	PEELER	JACK	U	HPKNS	UPCHURCH BETTY		23	2	1960	21
13960	PERDUE	GENIEVA	L	WAYNE	UPCHURCH EFFIE		9	11	1933	28
62444	PERKINS	CHARLES	A	PLSKI	UPCHURCH PHYLLIS		17	7	1947	125
31882	PHELPS	BILLY	RAY	WARRN	UPCHURCH DORIS	R	14	7	1971	64
51849	PHELPS	RONALD	JAY	WARRN	UPCHURCH DORIS	R	30	11	1972	104
38102	PIERCE	LOLA	F	PLSKI	UPCHURCH MARY		25	6	1949	77
72726	PIERCE	STEPHEN	K	CLNTN	UPCHURCH MARY		16	12	1953	146
75045	PIERCE	TIMOTHY		HARDN	UPCHURCH HELEN		30	9	1956	151
39164	PIERCE	WANDA	J	CLNTN	UPCHURCH MARY		18	6	1955	79
50802	PIERCEY	HOLLY	ANN	PLSKI	UPCHURCH TERESA	A	16	12	1984	102
23237	PIERCY	AMY	MICHELLE	PLSKI	UPCHURCH TERESA	A	1	7	1988	47
5047	PIERCY	JAMIE	LEE	BARRN	UPCHURCH TERESA	A	9	3	1983	11
21862	PILE	RITA	K	CLNTN	UPCHURCH LEVA		26	3	1948	44
64571	POE	BRENDA	G	WAYNE	UPCHURCH LOIS		4	11	1959	130
61907	POE	ELDRED	L	WAYNE	UPCHURCH LULA		16	11	1940	124
24896	POE	ESTEL	F	WAYNE	UPCHURCH LULA		5	5	1930	50
21130	POE	EVERETT	G	WAYNE	UPCHURCH LULA		4	4	1939	43
8215	POORE	BETTY	JUNE	WAYNE	UPCHURCH MARGIA		19	1	1964	17
38552	POORE	BILLY	J	WAYNE	UPCHURCH MARGIE		21	6	1949	78
12674	POORE	EMERY	DAVID LANIER	FYETE	UPCHURCH MARIAN	L	4	4	1998	26
14844	POORE	JACK	L	WAYNE	UPCHURCH MARGIE		8	2	1948	30
27724	POTTON	FLONNIE	B	CLNTN	UPCHURCH IDA		10	6	1927	56
54441	PYLE	LARRY	D	CLNTN	UPCHURCH WILLIS		9	10	1945	109
14967	RAMSEY	FREDDIE	K	CLNTN	UPCHURCH ELIZABETH		26	4	1933	30
47842	RAMSEY	JOHN	F	WAYNE	UPCHURCH ELIZABETH		4	9	1931	96
72984	RAMSEY	JOYCE	E	PLSKI	UPCHURCH ELIZABETH		21	12	1950	146
7264	RAMSEY	KIRK	GORDON	PLSKI	UPCHURCH ORETTA		8	2	1963	15
31952	RAMSEY	MICHAEL	S	PLSKI	UPCHURCH AMERICA		28	6	1948	64
39218	RAMSEY	RAY	H	WAYNE	UPCHURCH ARCO		29	10	1922	79
26379	RAMSEY	ROSA	N	WAYNE	UPCHURCH ELIZABETH		20	5	1939	53
61633	RECTOR	VELA	M	WAYNE	UPCHURCH LELA		13	9	1928	124
57917	RECTOR	VIRGINIA	A	WAYNE	UPCHURCH SUDIE		29	5	1926	116
42696	REED	JUDITH	E	MASON	UPCHURCH LOIS		17	8	1946	86
60197	RILEY	JAMES	TROY	CLNTN	UPCHURCH MARRANN		21	12	1965	121

○ KY UPCHURCH BIRTHS - DOWNLOAD IN LTR 20 JAN  
 2001 - CHARLES JOHN PETERSON, JR TO RPU PG (30)

Certifi	Child			County	Mother		DY	MO	YR	
17029	PEELER	DONNA	J	HPKNS	UPCHURCH BETTY		8	4	1958	35
46501	PEELER	FRANK	SCOTT	HPKNS	UPCHURCH BETTY	L	23	8	1965	94
10402	PEELER	JACK	U	HPKNS	UPCHURCH BETTY		23	2	1960	21
13960	PERDUE	GENIEVA	L	WAYNE	UPCHURCH EFFIE		9	11	1933	28
62444	PERKINS	CHARLES	A	PLSKI	UPCHURCH PHYLLIS		17	7	1947	125
31882	PHELPS	BILLY	RAY	WARRN	UPCHURCH DORIS	R	14	7	1971	64
51849	PHELPS	RONALD	JAY	WARRN	UPCHURCH DORIS	R	30	11	1972	104
38102	PIERCE	LOLA	F	PLSKI	UPCHURCH MARY		25	6	1949	77
72726	PIERCE	STEPHEN	K	CLNTN	UPCHURCH MARY		16	12	1953	146
75045	PIERCE	TIMOTHY		HARDN	UPCHURCH HELEN		30	9	1956	151
39164	PIERCE	WANDA	J	CLNTN	UPCHURCH MARY		18	6	1955	79
50802	PIERCEY	HOLLY	ANN	PLSKI	UPCHURCH TERESA	A	16	12	1984	102
23237	PIERCY	AMY	MICHELLE	PLSKI	UPCHURCH TERESA	A	1	7	1988	47
5047	PIERCY	JAMIE	LEE	BARRN	UPCHURCH TERESA	A	9	3	1983	11
21862	PILE	RITA	K	CLNTN	UPCHURCH LEVA		26	3	1948	44
64571	POE	BRENDA	G	WAYNE	UPCHURCH LOIS		4	11	1959	130
61907	POE	ELDRED	L	WAYNE	UPCHURCH LULA		16	11	1940	124
24896	POE	ESTEL	F	WAYNE	UPCHURCH LULA		5	5	1930	50
21130	POE	EVERETT	G	WAYNE	UPCHURCH LULA		4	4	1939	43
8215	POORE	BETTY	JUNE	WAYNE	UPCHURCH MARGIA		19	1	1964	17
38552	POORE	BILLY	J	WAYNE	UPCHURCH MARGIE		21	6	1949	78
12674	POORE	EMERY	DAVID LANIER	FYETE	UPCHURCH MARIAN	L	4	4	1998	26
14844	POORE	JACK	L	WAYNE	UPCHURCH MARGIE		8	2	1948	30
27724	POTTON	FLONNIE	B	CLNTN	UPCHURCH IDA		10	6	1927	56
54441	PYLE	LARRY	D	CLNTN	UPCHURCH WILLIS		9	10	1945	109
14967	RAMSEY	FREDDIE	K	CLNTN	UPCHURCH ELIZABETH		26	4	1933	30
47842	RAMSEY	JOHN	F	WAYNE	UPCHURCH ELIZABETH		4	9	1931	96
72984	RAMSEY	JOYCE	E	PLSKI	UPCHURCH ELIZABETH		21	12	1950	146
7264	RAMSEY	KIRK	GORDON	PLSKI	UPCHURCH ORETTA		8	2	1963	15
31952	RAMSEY	MICHAEL	S	PLSKI	UPCHURCH AMERICA		28	6	1948	64
39218	RAMSEY	RAY	H	WAYNE	UPCHURCH ARCO		29	10	1922	79
26379	RAMSEY	ROSA	N	WAYNE	UPCHURCH ELIZABETH		20	5	1939	53
61633	RECTOR	VELA	M	WAYNE	UPCHURCH LELA		13	9	1928	124
57917	RECTOR	VIRGINIA	A	WAYNE	UPCHURCH SUDIE		29	5	1926	116
42696	REED	JUDITH	E	MASON	UPCHURCH LOIS		17	8	1946	86
60197	RILEY	JAMES	TROY	CLNTN	UPCHURCH MARRANN		21	12	1965	121

## PEERCY FAMILY

NOTE TO BE FILED WITH:

PERCY FAMILYPEERCY FAMILY

PIERCY FAMILY

PEARCY FAMILY

A.A. of 29 AUG 1999 RPA notes that the above four names have often been used interchangeably in a common line of descent. All RPA Profiles for the three will now be maintained under the family name PERCY and these will be filed by first name irrespective of the spelling of the last name. Much of this body of detail pertains to Wayne Co, KY and to members of the George W. Class. However, in the Wayne Co, KY Cemetery Book one finds about an equal number of PEERCY & PIERCY entries but no PEARCY or PERCY entries.

The filing plan described above was triggered by RPA receipt of the book "The Percy-Piercy-Pearcy Genealogy from Devon, Wiltshire, England - from approximately 1690 to Slipford, Wayne County, Kentucky, 1998" by Billy Joe Young - a descendant of George W. - Head of Class. Up to this point RPA had 1 Pearcy, 1 Percy, 0 Peercy & about 50 Piercy entries.



## PEEPLES

○ EXCERPT FROM INDEX OF BOOK "THE GOODWIN FAMILY OF CENTRAL N.C." BY THOMAS JERRY GOODWIN, SR - 2009 RPU 24NOV2012. - NOTE: INDIVIDUALS LISTED AS MEMBERS OF THE \_\_\_\_\_ FAMILY - [WAKE/CHATHAM COUNTIES]

Peebles  
Eve Lehrer 747  
Mark 747

Seawell Upchurch

North Carolina  
Marriages, 1759-1979

birth: 1855

marriage: 04 Feb 1880 Wake, North Carolina

spouse: Charity Peeples



© 1994 by the University of North Carolina

① Christina Kay U b 21 NOV 1945 (Hansburg, IL)  
and 27 MAR 1965 (Hansburg, IL) Charles Michael  
Peeples b 19 JUL 1946. Christina is dau of  
Robert Fendle U & gd of David Patterson U  
of the William U IV / David U Subdarn  
(39, Pg 15)

② see notes of Jean U (F) 1 JUL 1980 call to RPH  
I Done & Minnie U

A. Robert Fendle U d 17 AUG 1979

1. Christina Kay U  
and Charles Peeples

2. Jean U (F)

All of above from Hansburg IL

③ See David Patterson U for info Rec'd 10 SEP 1982 by RPH

Charles Michael Peeples b 19 JUL 1946 and 27 MAR 1965

Cristina Kay U b 21 NOV 1945 (Hansburg, IL). They  
have 2 children - Todd Michael Peeples + Erik Michael  
Peeples.

Cristina is dau of Robert Fendle U, gd of David Patterson U,  
g gd of Ira William U + gggd of David Philip U b ca 1811



① Erik Michael Peeples ↑ b 12 APR 1976 (Harrisburg, IL) is son of Christina Kay U of the William U IV / David U Suldan - David Patterson U. (39, Pg 15)

② see David Patterson U for info Reid 10 SEP 1982 by RPU  
Erik Michael Peeples b 12 APR 1976 is son of Cristina Kay U, gr of Robert Lendle U, ggr of David Patterson U, ggg of Ira William U + gggg of David Philip U b ca 1811.

③ Birth announcement sent 24 DEC 1982 by Donald Eugene U to RPU

**Births**  
Todd Peeples wishes to announce the arrival of a baby brother, Erik Micheal, born April 12 at the Ferrell Hospital in Eldorado. He weighed seven pounds, five and three-fourths ounces. The parents are Mr. and Mrs. Mike Peeples of 27 West Virginia St. Maternal grandparents are Mr. and Mrs. Robert Upchurch and paternal grandmother is Mrs. Vernelia Peeples, all of Harrisburg.

→ TODD MICHAEL PEEPLES □  
→ ERIK MICHAEL PEEPLES ↑  
→ [CHARLES MICHAEL PEEPLES □  
CRISTINA KAY U □  
→ ROBERT LENDLE U □

J

WILEY PEEBLES

Nannie E. Upchurch

birth: 1882

North Carolina  
Marriages, 1759-1979

marriage: 28 Jun 1903

Wake County, North  
Carolina

spouse: J. Wiley  
Peebles

*[Faint, illegible text, likely bleed-through from the reverse side of the page]*



① See 12 JUN 1979 It (Pg 9) Julia Elizabeth U to RPY  
Patsy Lee Peoples b 15 JUN 1935 md 15 AUG 1954  
Billie Joe U b 12 NOV 1936. He was son of  
Earl Carter U & gr of Joseph Oscar U b  
4 OCT 1879 of William / Adel U (Clar.)

↳ (Should be Adel U, sr / John U Sulclan  
Robert Burton U, sr line - RPY)

② See Biofile of Joseph Oscar U - Entry 28 AUG 1996  
For PLP the spelling of the last name is given as  
PEOPLES not PEEPLES



① See David Patterson U for info Recd 10 SEP 1982 by RPM

Todd Michael Peepler b 28 MAR 1969 is son of Christina  
Kay U, gr of Robert Seulle U, gr of David Patterson U,  
gr of Ira William U + gr of David Philip U b ca 1811

② Todd Michael Peepler b 28 MAR 1969 (Nawshung, IL)  
is son of Christina Kay U of the William U IV/  
David U Suldan - David Patterson U (39, pg 15)

FROM: It 25 AUG 2004 James Roy Taylor & RPA Pg(29) →

I. Abel U, Sr - Head of clan  
A. John U b 22 APR 1814 (NC)

- 1. Elizabeth F. U b 6 JUL 1846 (Greene Co, AL)
  - a. Bessie Frances Coleman b 11 FEB 1879 (Greene Co, AL)
    - i. Minnie Buford Wilson

**Minnie Buford Wilson** (Bessie Frances Coleman, Elizabeth F.) was born on 27 Aug 1908 in , Greene, Alabama. She died on 10 Sep 1987 in , Pickens, Alabama.

Minnie BRIDGES Birth Date: 27 Aug 1908 Death Date: 10 Sep 1987 Social Security Number: 420-88-0583  
State or Territory Where Number Was Issued: Alabama Death Residence Localities ZIP Code: 35447  
Localities: Carrollton, Pickens, Alabama

Minnie married **Dock S. Bridges**. Dock was born on 13 Feb 1902. He died on 26 Feb 1994 in , Pickens, Alabama.

Dock BRIDGES Birth Date: 13 Feb 1902 Death Date: 26 Feb 1994 Social Security Number: 417-07-7967  
State or Territory Where Number Was Issued: Alabama Death Residence Localities ZIP Code: 35447  
Localities: Carrollton, Pickens, Alabama

Dock and Minnie had the following children:

- + 45 F i. **Sarah Frances Bridges** was born on 31 Oct 1929. She died on 1 Apr 1988.
- + 46 M ii. **James Walter Bridges Sr.** was born on 20 Feb 1932.
- + 47 F iii. **Shelba Dean Bridges** was born on 4 Mar 1937.
- + 48 M iv. **Bernice O'Neal Bridges** was born on 28 Aug 1938.

47. **Shelba Dean Bridges** (Minnie Buford Wilson, Bessie Frances Coleman, Elizabeth F.) was born on 4 Mar 1937.

Shelba married (1) **Gerald Latham "Bud"**. They had the following children:

- 90 M i. **Richard Gerald Latham "Ricky"** was born on 4 Apr 1958.
- + 91 M ii. **Michael Dwain Latham** was born on 23 Jul 1962.

Shelba married (2) **P. M. Johnston**.

91. **Michael Dwain Latham** (Shelba Dean Bridges, Minnie Buford Wilson, Bessie Frances Coleman, Elizabeth F.) was born on 23 Jul 1962.

Michael married (1) **Teresa Rena Bryant**. They had the following children:

- 126 F i. **Jennifer Bryant Latham** was born on 13 Apr 1984.

Michael married (2) Virginia Eloise Peeples on 13 Jun 1992.



ON PEET

O. N. PEET

① see William G. U. file - O. N. Peet, William G. U. & others  
incorporated "North Carolina Cotton Oil Company"  
23 APR 1892