

① See Itt 18 AUG 1997 Eleanor Louise Baker to RPA Pg 51

I. George U - Head of clan

A. John U, VI

1. Lucinda U

a. William Benton Hughes

i. Laura Arco Hughes md (2nd) 21 FEB 1912

(1) Leander Brake "Lee" b. 1 AUG 1867.  
Details on their child Ruby Mae Brake are given below.

② See Itt 19 JUN  
1999 Eleanor  
Louise Baker to  
RPA - Pg 489

AJRP 27 OCT 1941

(8 Illinois St, Danville,  
IL) [son of Harley  
Charley Pate &  
Lucille Margarette  
Johnson] md 21 SEP  
1962 (Roxmble,  
Vermilion Co, IL).  
3 children.

- ..... 10 Ruby Mae BRAKE 1920 -
- ..... (3)+ [617] Howard Glenn MATTHEWS 1920 - 1977 d: 20 May 1977
- ..... \*1st Husband of Ruby Mae Brake:
- ..... + [618] James Harlan BLACK 1917 - 1954 m: 07 November 1938  
d: 12 April 1954
- ..... 11 Calvin James BLACK 1941 -
- ..... - [620] Patricia HORATH 1944 - m: 08 September 1962
- ..... 12 [621] Tina Louise BLACK 1967 -
- ..... \*2nd Wife of Calvin James Black:
- ..... + [622] Clara Evelyn HORATH 1946 - m: 02 September  
1972
- ..... 12 [623] Timothy James BLACK 1973 -
- ..... 12 [624] Kenneth Lee BLACK 1973 -
- ..... 12 [625] Eric Alan BLACK 1982 -
- ..... 11 [626] Barbara Sue BLACK 1943 -
- ..... + [627] Albert John Randall PATE 1941 - m: 21 September  
1962
- ..... 12 [628] Kimberly Jo PATE 1963 -
- ..... 12 [629] James Harlan PATE 1966 -
- ..... 12 [630] Lucinda Sue PATE 1968 - 1968 d: 15 December  
1968
- ..... 11 [631] Thomas John BLACK 1945 - 1947 d: 20 March 1947
- ..... 11 [632] John Robert BLACK 1951 -
- ..... + [633] Jeanine Eloyce DAVIS 1952 - m: 22 March 1969
- ..... 12 [634] Phillip Michael BLACK 1969 -
- ..... 12 [635] Brian Jon BLACK 1975 -
- ..... \*3rd Husband of Ruby Mae Brake:
- ..... + [636] Donald Keith JACKSON 1909 - m: 14 March 1956
- ..... 11 [637] Sandra Kay JACKSON 1957 -
- ..... + [638] William Jackson GERARD 1957 - m: 02 February  
1980
- ..... 12 [639] Christopher Jackson GERARD 1980 -
- ..... 12 [640] Aimee Nicole GERARD 1982 -
- ..... 11 [641] Marion Hughes JACKSON 1958 -
- ..... + [642] Kellie Marie REGAN 1959 - m: 30 December 1980
- ..... 12 [643] Kevin Wayne JACKSON 1981 -

AZILEE ANNA PATE

XFO-20138

① See Ht 25 APR 1988 Loren Mc Kager Lamborn DRPL  
Azilee Anna Pate b 2 NOV 1928 (LaFollette, TN)  
wd 30 NOV 1950 (Harriman, TN) Loren Mc Kager Lamborn  
→ Loren Mac Lamborn b 30 JUN 1922 (Rugby, TN),  
son of Martania Isabel Crabtree of the  
George W / Joseph W Suldam.

FROM: DISPATCH APEX HISTORICAL SOCIETY - NOV 2008 PG 6, 7

## Apex

Historical Raleigh (enlarged and revised edition)  
With Sketches of Wake County (from 1771)  
And Its Important Towns  
Descriptive, Biographical, Educational, Industrial, Religious, Illustrated  
By Moses N. Amis - 1913

△ The town of Apex had its beginning with the close of the Civil War. Among its first settlers were J. McC. Ellington, H. C. Olive, Q. I. Hudson, W. F. Utley, W. H. Harward, Brinkley Olive, A. N. Betts and others, △△△ who contributed to its life in the beginning and afterwards. It was incorporated by the Legislature of 1871-'72, with the late Hon. H. C. Olive as its first mayor. It derived its name from being the highest point on the survey of the Raleigh & Augusta Air Line Railroad.

Until 1905 it was but a small town, where the standard of virtue, intelligence and patriotism was high, but where little progress in material things had been made. In that year, beginning with the organization of a bank and the establishment of a tobacco market, began a new life for the town and surrounding community. Fire later destroying a number of unsightly frame buildings, the first brick structure was soon erected. Again, in June, 1911, nearly all the remaining old frame buildings in the business section were also consumed by fire. Now the principal street of the town (Salem) is lined with handsome pressed-brick-front stores. Business houses have continued to increase in number, until now nearly everything to complete a small city is here represented. This metropolis of western Wake is one of the busiest, most attractive and substantially built towns of its size in North Carolina. Its streets are well laid out and splendidly shaded in the residential sections, while the business part of the town is marked with buildings of beautiful architectural designs and substantial construction.

Apex has a population of about one thousand, and, being located in the centre of one of the best agricultural sections of the State, has a large rural territory from which to draw life and sustenance. It is in the limited "Old Belt" tobacco<sup>1</sup> lands of North Carolina and Virginia, which produce the finest yellow-wrapper tobacco. The tobacco market at Apex is one of its chief industries. It is equipped with two splendid warehouses, three large prizehouses<sup>2</sup>, markets about two million pounds of tobacco annually, and enjoys the distinction of making the highest average price per pound of any market in the State. It is the centre of a fine cotton-production section, the receipts of this staple being from three to five thousand bales of cotton per year.

Public education in Wake County has always found some of its most potent advocates and influences at Apex. Notable among those who have wielded an influence throughout the county in this respect are the late Hon. H. C. Olive, State Senator and for many years chairman of the Wake County Board of Education; Hon. L. J. Sears, at present, and for many years past, chairman of the same board, and Hon. Percy J. Olive, an ex-representative and a public man who has taken an especial interest in the schools. That these gentlemen are and were but the exponents of the sentiment around them is witnessed by the fact that Apex has one of the finest and best-equipped schools in the county, and that every school in White Oak Township levies a local tax to supplement the general education fund.

Few communities in the State have had more additions to their population within the past five years than has that of which Apex is the centre. Those seeking desirable homes have found here a happy combination of advantages—fine lands, intelligent, virtuous and hospitable neighbors, good markets, good roads, good schools and good churches. No fictitious values have been placed upon the lands; for, with the true idea of progress, the efforts of those who have done most for the community's upbuilding have been directed to keeping the real estate at its true value. Contributing mostly to this and at present forming the most valuable of its citizenship, without disparagement to others, may be mentioned Messrs. W. F. Utley, W. H. Harward, A. B. Hunter, L. S. Olive, Percy J. Olive, Dr. W. Wade Olive, S. W. Stone, J. B. Mason, J. W. Lassiter, W. B. Upchurch, J. H. Sears, A. V. Baucom, A. C. Hughes, C. P. Sellars, W. B. Johnson, A. D. Upchurch, Samuel Watkins, Jr., A. T. Seymour, C. R. Weaver, S. T. Bennett, B. H. Pate, J. R. Cunningham, S. V. Hudson, S. S. Rogers, J. R. Norris, G. C. Norris, R. J. Bolling, Dr. R. W. Stephens, Dr. R. W. Johnson, Dr. C. B. Wilkerson, J. F. Mills, S. A. Branch, W. H. F. Branch, L. J. Sears, M. G. Upchurch, G. E. Upchurch, H. B. Harward, J. R. Harward, R. L. Bagley, J. C. Burns, Q. I. Hudson and others.



B

H

PATE

DEED BK: 332 PG: 5

WAKE CO, NC DEED FOR LAND OF ISHAM SIMS U LYING IN CHATHAM AND WAKE CO. - PROCEEDINGS IN CHATHAM CO - THIS FOLLOW ON DEED IN WAKE <sup>Δ</sup>332/5

F 11 JUL 1918

R 16 JUL 1918

M 30 APR 1917

Δ Isham Sims U d 5 APR 1916 leaving 13 children. One child M. R. U [Matthew Robert U] et al took court action 1 NOV 1916 in Chatham Co, NC vs another child G. W. U [George Winston U] et al to partition the land of ISU

This deed is the final evidence in WAKE CO, NC of how the proceedings unfolded in Chatham Co, NC. A RECAP:

The Special Proceedings led to a Chatham Co, NC Court order on 20 NOV 1916 for the Chatham County Commission especially appointed to sell the property at the highest bidder at the Court House steps in Pittsboro. They were

M. R. U, J. M. BROADWELL [James Mahlon Broadwell - head of Josephine Frances U one of the 13 heirs] & FRED W. BYNUM.

At a 5 JAN 1917 auction Partners Nevins & Flournoy were high bidder at 26,000. However, later W. T. HUNT & brother added \$1,500 causing a 2nd Auction on 12 MAR 1917 (order), held 2 APR 1917 - Result: W. T. HUNT & S. L. HUNT bid \$27,500 but assigned their right to Partners trading as W. L. NEVINS & L. B. FLOURNOY.

The Commission submitted their report 2 APR 1917 and the Court on 28 APR 1917 authorized them to issue a deed to WLN & LBF. Land Description (no shape given):

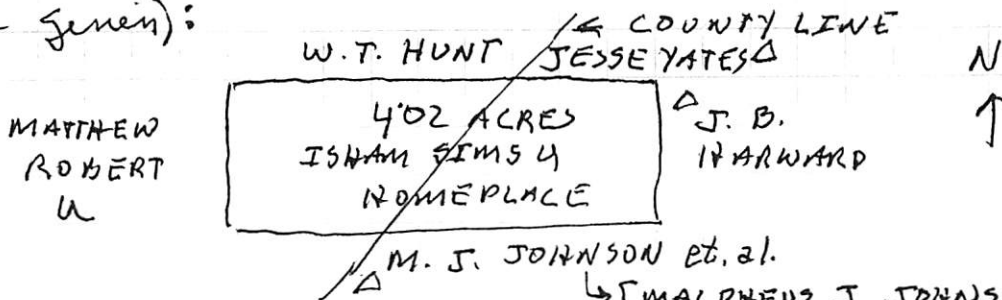

Notarized 1 MAY 1917 by B. N. PATE, N.P. for Chatham Co, NC (Also for Wake Co, NC?) - Registered in Chatham Co, NC 7 MAY 1918 - Follow on actions in Wake Co, NC as shown above.

[NOTE: I would guess the individuals who bought the 402 acres were interested in the timber as timber is mentioned in the proceedings - RP4 4 JAN 2010



○ The Naaman Mills Family by W. A. Mills - Pg 84-88

I. Abraham Mills

A. Naaman Mills

1. Lucretia Mills - GGM of RFD

2. Shadrach Mills

a. Hilliard Jackson Mills - see below

b. Thomas Haynes Mills - see another extract

c. No further issue

14. HILLIARD JACKSON MILLS, son of Shadrach Mills and Patsy Wilson, was born 1 Jul 1845 in Wake Co., NC, and died 25 May 1920. He married 29 Jun 1873 Mary Hellen Yates (b 14 Sep 1839, d 6 Nov 1909), daughter of Anderson Yates and Julie Hellen Smith. They were married by JP A.C. Council, in Green Level, NC. They are buried at Rock Springs Church Cem., Apex, NC.

Hilliard served in the Confederate Army during the Civil War. For more info see ch GRANDSONS OF NAAMAN MILLS: SOLDIERS IN THE CIVIL WAR.

Hilliard was a farmer. He resided in Chatham Co., NC (Grove P.O.) with his father on FC/1860; and Wake Co., NC (White Oak Twp.) with his cousin, Elijah L. Mills and family on FC/1870. Hilliard and his family resided in Wake Co., NC (White Oak Twp.) on FC/1880-1920. The FC/1880 contained the following info on the Agricultural Schedule regarding Hilliard's farm:

1880 - 40 acres of tilled land. 12 acres of woodland and forest. Value of farm, including land, fences and buildings - \$400. Value of farming implements and machinery - \$50. Value of livestock - \$150. Cost of fertilizers purchased in 1879 - \$22. Amount paid for wages for farm labor in 1879, including value of board - \$55. 18 weeks of white hired labor in 1879 upon farm. Estimated value of all farm productions sold, consumed, or on hand for 1879 - \$400. 1 mules and asses of all ages on hand 1 Jun 1880.

In Hilliard's compiled military service record from the Civil War, he is described as being 5 feet, 6 inches tall. On 10 May 1902, he applied for a soldier's pension from the State of NC, for wounds that he received during the Civil War. His application was approved.

After Mary Hellen's death, Hilliard m 2ndly 10 Nov 1910 Kiddie Holt (b ca 1838, d 19\_\_). Hilliard left a will. He lived to age 74.

Hilliard and Mary Hellen's children:

- NUMBER OF CHILDREN
- 14 → 1. John Anderson Mills (b 18 Jan 1874, d 4 May 1957) m 4 Nov 1894 Elizabeth Ann Roberta Snipes (b 29 Sep 1869, d 30 Jul 1938), daughter of Ausburn Snipes and Sarah Barbee. Married by Bap. Min. Thomas Pate in Wake Co., NC. Buried at Catawba Springs Chr. Ch. Cem., Wake Co., NC. John was a farmer. Resided in Wake Co., NC (White Oak Twp.) on FC/1900-1920. John lived to age 83. Their children:
- (1) MALE Mills (b 24 Jun 1895, d 24 Jun 1895).
- 14 → (2) Hugh Edward Mills (b 11 Aug 1896, d 16 Oct 1957) m 19 Dec 1915 Mary Susan Pendergraft (b 17 Jul 1895, d 9 May 1946), daughter of Nathaniel Pendergraft and Polly Walker Gooch. Married by JP B.H. Pate in Apex, NC. Buried at Wake Chapel Chr. Ch. Cem., Fuquay-Varina, NC. Hugh was a farmer. Resided in Wake Co., NC (Holly Springs Twp.) on FC/1920. After Mary's death, Hugh m 2ndly 17 Nov 1948 Lanie F. Lamb (b ca 1893, d 19\_\_). He m 3rdly 27 Feb 1954 Beulah Vann (b ca 1908). Hugh and Mary's children:
- 12 → (3) William Franklin Mills (b 29 Jul 1899, d 21 May 1956) m 8 Nov 1921 Lula Mae Churchill (b 3 May 1902, d Sep 1981). Married by Min. G.N. Cowan, in Apex, NC.
- (4) FEMALE Mills (b 1 Aug 1901, d 1 Aug 1901).
- (5) Harry Dalton Mills (b 23 Sep 1902). Nfi.
- 4 → (6) Dewey Hobson Mills (b 9 Mar 1905, d 20 Jul 1967) m 1926 Ada Thomas (b 3 Sep 1911). Married in Fayetteville, NC

○ The Naaman Mills Family By W. A. Mills - Pg 33

A. Abraham Mills

1. Naaman Mills

a. Lucretia Mills - GEM OF RPM

b. Matthew Mills

i. John Addison Mills

(I) Columbus Washington Mills

b 4 MAY 1855 d 7 FEB 1928

Details on #9 of his 9 children shown  
below [#1 → #8 are elsewhere]

- (9) Lois Vivian Mills (b 17 Mar 1900, d 25 Nov 1989) m 21 Dec 1919  
Leamon Joseph Council (b 30 Nov 1896, d 3 Feb 1979). Married by JP  
B.H. Pate, in Apex, NC. Buried at Green Level Bap. Ch. Cem., Apex,  
NC. Their children:
- (A) Auba Conway Council (b 22 Aug 1921) m 19\_\_ Verta Mae Beasley.  
(B) Grace Elizabeth Council (b 24 Feb 1923) m 19\_\_ Dewey W. Wood.  
(C) Elsie Mae Council (b 25 May 1926) m 19\_\_ Exum Ray Sauls.  
(D) Lester Booth Council (b 18 Aug 1929) m 19\_\_ Jacqueline \_\_\_\_.  
(E) Billy Wray Council (b 10 Jul 1934) m 21 Dec 1957 Sarah Bryson (b  
19 Jul 1935). Their children:  
(a) Sarah Lynette Council (Adp) (b 30 Mar 1967) m 19\_\_ Joseph V.  
Ianone, Jr. Their child:  
a1) Sarah Jessica Iannone (b 19 Apr 1991).  
(b) Richard Wray Council (Adp) (b 29 Oct 1969).  
(F) Ralph Edward Council (b 5 Aug 1938) m 19\_\_ Patricia Brannon.



○ See str 19 JUN 1999 Eleanor Lewis Baker D RPA-Pg 491, 2

I. Laura Arco Hughes of the George W. John U VI Subclass  
- Lounda U Lind.

A. Bailey Mae Brake

i. Barbara Sue Black

a. James Harlan Pate b 15 SEP 1966 (Danville,  
Vermilion Co, IL) md (1st) 27 JUN 1985

(Rensselle, Vermilion Co, IL). April

Michelle Smith<sup>1)</sup> b 6 MAY 1966 (Louisville,  
Jefferson Co, KY)

md (2nd) 26 MAY 1990 (Rensselle, IL)

Jeri Belts Whitaker<sup>2)</sup> b 15 APR 1970  
(Crawfordsville, Montgomery Co, IN)

i.<sup>1)</sup> Samantha Marie Pate b 10 APR  
1987 (Bartow, Polk Co, FL)

ii.<sup>2)</sup> Jason Wayne Whitaker Pate\*  
b 5 MAR 1986

iii.<sup>2)</sup> Hannah Terry Pate b 11 AUG 1990  
(Danville, IL)

iii.<sup>2)</sup> Bailey Morgan Pate b 9 SEP 1992

\* NOTE: It seems  
clear that in a  
child of Jeri  
Belts Whitaker  
and Michelle  
James Harlan  
Pate is the  
father or not  
is not made  
clear. At the least  
he would be the  
step-father - RPA

○ see ltr 8 FEB 2002 Danny Calvin Bunn & RPH

I. Laurence Fletcher Brantley of the Richard W. III /

Bushely U Subelan - Ambrose Amor U line

A. Worley Brantley b 23 DEC 1928 (Nash Co, NC)

md 12 AUG 1950 (Nash Co, NC) Dorothy Lamm

1. Dennis Ray Brantley b 2 JAN 1952

md () - - -

a. Kevin Ray Brantley b 11 SEP 1976

2. Danny Carson Brantley b 23 MAY 1953

md () Bessie Rose Pate ?

a. Tammy Rose Brantley b 11 SEP 1976

b. Daniel Carson Brantley b 14 JUN 1981

3. David Erwin Brantley b 8 MAR 1956

4. Deborah K. Brantley b 4 JAN 1959

md () Jerry Wayne Joyner

a. Jason Wayne Joyner b 9 AUG 1982

5. Katie Brantley

md () David Dertch Flowers, Jr

a. Issue - b 6 JUN 1984 vs 9 AUG 1982 ??

6. Joyce Marie Brantley b 2 MAR 1964

7. Wendy Lynn Brantley b 22 MAR 1972 ( )

d 23 MAR 1972



① See Obituary of Cloie Holt who died 18 SEP 1991

I. Bessie Iona Womble of the Merit & Whitney & Suburban - Hesper Ave & Line.

A. Cloie Holt b abt 1909 (D) d 18 SEP 1991 (L) (Sun - Hillcrest Cem., Apex, NC). md (1) -- Pate

1. Earl F Pate of Raleigh, NC

2. Betty Pate ↑  
md (1) -- Coleman / of Apex, NC

② See Obituary of Richard L. Coleman who d 14 MAR 1996

The wife of the deceased survived and is identified in the article as Betty Pate Coleman - hence see Betty Pate ↑

BETTY

PATE

XID-48124<sup>(2)</sup>

① The Apex Herald WED 20 MAR 1996 Apex, NC

RICHARD L. COLEMAN

BETTY PATE ↑

**RICHARD L. COLEMAN**

Richard L. Coleman, 57, of Apex died Thursday, March 14, 1996. A funeral service celebrating his life was held Saturday, March 16, at Apex Baptist Church with Rev. Phil Qualls and Rev. Chuck Thompson officiating. Burial was at the Apex Cemetery.

Surviving: wife, Betty Pate Coleman; son, Kevin Coleman of Apex; daughter, Lori Schomburg of Wake Forest; two grandsons.

Memorials may be made to Hospice of Wake County, 4513 Creedmoor Rd., Raleigh, NC 27612; or Apex Baptist Church, 110 S. Salem St., Apex, NC 27502.



Item to RPU from Hope Blockford via email 12 OCT 2012

(See her profile for signature)

She found this item while researching in the Wake Co, NC Register of Deeds office.

CROSSFILE:

- △ APEX, NC
- △ HENRY ODESSA HOLLAND
- △ FRANKLIN PIERCE U

882  
 CERTIFICATE OF INCORPORATION  
 OF  
 THE BANK OF APEX.

BK000000FPG00050

BK000000FPG00051

This is to Certify, That we, the undersigned, do hereby associate ourselves into a corporation under and by virtue of the laws of the State of North Carolina, as contained in Chapter 5 of the Consolidated Statutes of 1919, regulating banking in the State of North Carolina, and the amendments thereto, and do severally agree to take the number of shares of capital stock in said corporation set opposite our respective names, and to that end do hereby set forth:

1. The name of this corporation is The Bank of Apex.
2. The location of the principal office of the corporation in this State is in the Town of Apex, County of Wake, State of North Carolina.
3. The objects for which this corporation is formed are as follows:
  - (a) To engage in the banking business both as a Commercial Bank and as a Savings Bank and in general to do all kinds of banking subject to the provisions of the banking laws of the State of North Carolina.
  - (b) To act as administrator, guardian, trustee receiver or depository and to take, accept and execute any and such trusts and powers of whatever nature and description which may be conferred upon or entrusted to said corporation by agreement, grant, devise, bequest, assignment, or otherwise, or by order of any court of record, and to take, receive, hold, manage or convey any property or estate, real or personal, which may be the subject of any such trust, and for compensation shall have such commission as may be fixed by law or agreed upon.
4. The total authorized capital stock of this corporation is One Hundred Thousand (\$1000,000.00) dollars, divided into two thousand (2000) shares of the par value of Fifty (\$50.00) Dollars each, but the corporation may organize and begin business when Twenty Five Thousand (\$25,000.00) dollars of the capital stock composed of five hundred (500) shares, shall have been subscribed and paid for.
5. The names and postoffice addresses of the subscribers for stock and the number of shares subscribed for by each, the aggregate of which being the amount of capital stock with which the corporation will commence business are as follows:

Name	Postoffice Address	Number of Shares
A.B. Hunter, C	Apex, N.C.	130
W.T. Hunt, C	Apex, N.C.	74
H.O. Holland, C	Apex, N.C.	10
W.C. Johnson, C	Apex, N.C.	16
A.M. Council, C	Apex, N.C.	10
Bryant H. Pate, C	Apex, N.C.	10
Dr. Chas H. Bryan, C	Apex, N.C.	10
F.P. Upchurch, C	Apex, N.C.	10
W.B. Drake, C	Raleigh, N.C.	90
J.L. Crowder, C	Apex, N.C.	10
R.C. Sears, C	Apex, N.C.	10
A.V. Baucom, C	Apex, N.C.	15
Dr. R.W. Johnson, C	Apex, N.C.	10
Dr. J.C. Mann, C	Apex, N.C.	20
G.C. Norris, C	Raleigh, N.C.	13
B.P. Pearson, C	Apex, N.C.	10
H.L. Poe, C	Apex, N.C.	12
A.T. Seymour, C	Apex, N.C.	12
Sam Watkins, C	Apex, N.C.	15
C.R. Weaver, C	Apex, N.C.	10

NORTH CAROLINA, COUNTY OF WAKE.  
 This is to certify that on this the 30th day of May 1927, before me, Hugh W. Lassiter, a Notary Public in and for said State and County, personally appeared this day A.B. Hunter, W.T. Hunt, H.O. Holland, W.C. Johnson, A.M. Council, Bryant H. Pate, Dr. Charles P. Bryan, F.P. Upchurch, W.B. Drake, J.L. Crowder, R.C. Sears, A.V. Baucom, Dr. R.W. Johnson, Dr. J.C. Mann, G.C. Norris, B.P. Pearson, H.L. Poe, A.T. Seymour, Sam Watkins and C.R. Weaver who I am satisfied are the persons named in and who executed the foregoing certificate of incorporation of The Bank of Apex, and I having made known to them the contents thereof, they did each acknowledge that they signed, sealed and delivered the same as their voluntary act and deed, for the uses and purposes therein expressed.

6. The period of existence of this corporation is limited to sixty years.  
 IN TESTIMONY WHEREOF, WE HAVE HEREUNTO set our several hands and affixed our respective seals this the 30th day of May 1927.

In Testimony Whereof, I have hereunto set my hand and affixed my Notarial seal, this the 31st day of May 1927.  
 Hugh W. Lassiter, Notary Public.  
 (Notarial seal) My Commission expires Jan. 15th, 1928.  
 I, R.O. Self, Clerk of the North Carolina Corporation Commission, do hereby certify that the foregoing Certificate of Incorporation of the Bank of Apex, Apex, N.C., has been examined and is hereby approved.  
 This 1st day of June, 1927.  
 By Order of the Commission.  
 R.O. Self, Clerk.

(Official seal)  
 Filed June 1st, 1927.  
 W.N. Everett, Secretary of State.  
 STATE OF NORTH CAROLINA, DEPARTMENT OF STATE.  
 I, W.N. Everett, Secretary of State of the State of North Carolina, do hereby certify the foregoing and attached (Five (5) sheets) to be a true copy of the certificate of incorporation of the Bank of Apex, and the probates thereon as the same is taken from and compared with the original filed in this office on the 1st day of June A.D. 1927.  
 In Witness Whereof, I have hereunto set my hand and affixed my Official seal.  
 Done in office at Raleigh, this 2nd day of June in the year of our Lord 1927.  
 (Seal)  
 I.L.S.  
 W.N. Everett, Secretary of State.

○ Zebulon Record THUR 4 NOV 1999 Zebulon, NC

I. MACK PATE

md (1) Ethel - -

A. Thurman Baxter Pate

md (1) Dorothy Hardy

1. Tommy Pate

B. Coy Pate !!

#### Thurman Baxter Pate

Thurman Baxter Pate, 79, of Zebulon, died Tuesday, Oct. 26, at his home. Funeral service was Saturday, Oct. 30, at L. Harold Poole Funeral Service chapel, Knightdale. Burial was at Gethsemane Memorial Gardens.

He was a self-employed farmer and a tobacco warehouseman. He was a veteran of World War II, serving in the Marine Corps in the Pacific. He was preceded in death by his parents, Mack and Ethel Pate; a brother, Coy Pate; and a sister, Clara P. Whittington.

Surviving: wife, Dorothy Hardy Pate; son, Tommy Pate and his wife, Evelyn, of Zebulon; two grandsons; sister, Elizabeth Pate Griffin and her husband, Elmo, of Raleigh; nieces and nephews.

Memorial contributions may be made to Hospice of Wake County, 1300 St. Mary's St., Fourth Floor, Raleigh 27605.



See Obituary of Claire Holt who died 18 SEP 1991

I. Bessie Iona Womble of the Mores & Whitney &  
Subden - Hesper Ann & line.

A. Claire Holt b abt 1909 (?) d 18 SEP 1991 (?) (Bur-  
Hillcrest Cem., Apex, NC). md (?) - - Pate

1. Earl F Pate of Raleigh, NC

2. Betty Pate  
md (?) - - Coleman / of Apex, NC

EARLE PATE

EARLE F

PATE

○ Zebulon Record THUR 31 DEC 1998 Zebulon, NC

CLARA GARRETT  
EARLE F PATE ↑

**Clara G. Pate**

Clara Garrett Pate, 68, of Raleigh, died Monday, Dec. 21. Funeral services were Thursday, Dec. 24, at Bryan-Lee Funeral Home, Garner. Entombment was at Montlawn Memorial Park.

She was a retired employee of the N.C. Department of Agriculture.

Surviving: husband, Earle F. Pate; daughter, Ann P. Smith and her husband, Joseph Smith Jr., of Zebulon; son, Neal F. Pate and his wife, Pamela R. Pate, of Clayton; two grandchildren.

Memorial contributions may be made to Turner Memorial Baptist Church Building Fund, 3704 Benson Road, Garner 27529, or the Rex Cancer Center, 4420 Lake Boone Trail, Raleigh 27607.

## EDMUND PATE

① See 1979 Article in NC Clean Soc Jour - filed under Andrew Johnson (US Pres).

James Johnson 1801-1860<sup>+</sup> was son of Jesse Johnson, an Uncle of Andrew Johnson (US Pres)

James Johnson and Dudley Gowen 1805-1860<sup>+</sup>. She inherited 49 acres of land adjoining Edmund Pate, Hardy Penny, William D. Turner and Sterling Johnson.



DEATH CERTIFICATE OBTAINED N.C. - WAKE CO, REGISTER OF DEEDS ON 1906T2007

OFFICE OF VITAL STATISTICS

CERTIFICATE OF DEATH

1188

REGISTRATION DISTRICT NO. 92-95 REGISTRAR'S CERTIFICATE NO. 1188

1. PLACE OF DEATH a. COUNTY <u>Wake</u>		b. TOWNSHIP		c. LENGTH OF STAY (in 1s)		2. USUAL RESIDENCE (Where deceased lived. If institution: residence before admission) a. STATE <u>North Carolina</u> b. COUNTY <u>Johnston</u>	
4. CITY OR TOWN <u>Raleigh</u>		In Place of Death Within City Limits? YES <input checked="" type="checkbox"/> NO <input type="checkbox"/>		e. CITY OR TOWN <u>Clayton</u>		In Place of Residence In City Limits? YES <input type="checkbox"/> NO <input type="checkbox"/> On a Farm? YES <input type="checkbox"/> NO <input checked="" type="checkbox"/>	
3. FULL NAME OF (If not in hospital or institution, give street address or location) HOSPITAL OR INSTITUTION <u>Rex Hospital</u>				d. STREET ADDRESS or R. F. D. NO. <u>538 W. Second St.</u>			
3. NAME OF DECEASED (Type or Print) First <u>Arnold</u> Middle <u>Millard</u> Last <u>Batts</u>				4. DATE OF DEATH Month <u>10</u> Day <u>31</u> Year <u>66</u>			
5. SEX <u>M</u>		6. COLOR OR RACE <u>White</u>		7. MARRIED <input checked="" type="checkbox"/> NEVER MARRIED <input type="checkbox"/> WIDOWED <input type="checkbox"/> DIVORCED <input type="checkbox"/>		8. DATE OF BIRTH <u>7-17-1909</u>	
9. AGE (In years last birthday) <u>57</u>		10. USUAL OCCUPATION (Give kind of work done during most of working life, even if retired) <u>Bus Driver</u>		11. BIRTHPLACE (State or foreign country) <u>Virginia</u>		12. CITIZEN OF WHAT COUNTRY? <u>USA</u>	
13. FATHER'S NAME <u>George Batts</u>		14. MOTHER'S MAIDEN NAME <u>Estelle Pate</u>		NAME OF HUSBAND OR WIFE <u>Ithel Tart Wall Batts</u>			
15. WAS DECEASED EVER IN U. S. ARMED FORCES? (Yes, no, or unknown) (If yes, give war or dates of service) <u>Yes WW II</u>		16. SOCIAL SECURITY NO. <u>240-07-8195</u>		17. INFORMANT'S NAME AND ADDRESS <u>Mrs. A.M. Batts 538 W. Second St., Clayton, N.C.</u>			
18. CAUSE OF DEATH—ENTER ONLY ONE CAUSE PER LINE FOR (a), (b) and (c). PART I. DEATH WAS CAUSED BY: IMMEDIATE CAUSE (a) <u>Diseased carcinoma</u> ANTECEDENT CAUSES—Conditions, if any, which gave rise to above cause (a), stating the underlying cause last. DUE TO (b) <u>none unknown</u> DUE TO (c) _____ PART II. OTHER SIGNIFICANT CONDITIONS CONTRIBUTING TO DEATH BUT NOT RELATED TO TERMINAL DISEASE CONDITION GIVEN IN PART I (a)						INTERVAL BETWEEN ONSET AND DEATH <u>8 wks</u>	
19a. ACCIDENT SUICIDE HOMICIDE <input type="checkbox"/> <input type="checkbox"/> <input type="checkbox"/>		19b. DESCRIBE HOW INJURY OCCURRED. (Enter nature of injury in Part I or Part II of item 18)					
20a. TIME OF INJURY MONTH, DAY, YEAR HOUR <u>M</u>		20b. INJURY OCCURRED WHERE AT <input type="checkbox"/> NOT WHERE AT WORK <input type="checkbox"/>		20c. PLACE OF INJURY (e.g., in or about home, farm, factory, street, office bldg., etc.)		20d. CITY OR TOWNSHIP COUNTY STATE	
21. I attended the deceased from <u>9/18/66</u> 19 <u>66</u> to <u>10/31</u> 19 <u>66</u> and last saw her/him alive on <u>10/31/66</u> 19 <u>66</u> . Death occurred at <u>9:15 p.m.</u> on the date stated above; and to the best of my knowledge from the causes stated.							
22a. SIGNATURE <u>Ernest B. Page Jr.</u> (Date or title)				22b. ADDRESS <u>Raleigh NC</u>		22c. DATE SIGNED <u>11/3/66</u>	
23a. BURIAL, CREMATION, REMOVAL (Specify) <u>Burial</u>		23b. DATE <u>11-3-66</u>		23c. NAME OF CEMETERY OR CREMATORY <u>Macedonia Cemetery</u>		23d. LOCATION (City, town, or county) (State) <u>Wake County N. C.</u>	
24. DATE REC'D BY LOCAL <u>NOV 8 1966</u>		25. REGISTRAR'S SIGNATURE <u>M.B. Bethel, M.D.</u>		26. FUNERAL HOME ADDRESS <u>Overby's Raleigh, N.C.</u>			

I. - - BATTIS

A. GEORGE BATTIS MD (ESTELLE PATE)

1. ARNOLD MILLARD BATTIS b 17 JUL 1909 (VA)  
M&C ITHEL TART WALL

↳ classify as:

- Δ ITHEL TART
- Δ ITHEL TART WALL

NOTE: Arnold M. Batts is Bur at midpines Cem, Wake Co, NC where his wife is shown as Gwendolyn M. Batts - RPA

FROM RPU BIOFILE SYSTEM - 4 MAR 2008

I. Samuel Pearson Nemi

A. Jesse Allen Nemi b DEC 1832 (?) d 1916

m& (1st) AMY ANN ADAMS

m& (2nd) ELLEN COFFIELD

Δ I. Elzabeth Blanche Nemi "Lizzie" b Apt 1867 (?) d Apt 1914

Δ m& (?) Samuel Lewis Montgomery, M.D. d APEX, NC

Δ a. Bays Montgomery

Δ b. Amy Montgomery

Δ C. JULIA LILLY MONTGOMERY

b Apt 1898 (?) d 19 SEP 1993

(Winston-Salem, NC) m& SEP

Δ 1924 (Raleigh, NC) Claudius

Augustine Street, S1, M.D. d 1968

Δ i. Carol Montgomery Street

Δ m& (?) ARCHIE McMILLAN

Δ E) ALEXANDRA McMILLAN

m& (?) - - MORDELA

Δ ii. Claudius Augustine Street, Jr

I. James Adams b 1805

A. James Theophilus Adams -

GEF of Belle

Rita Adams

Rita Adams

B. Amy Ann Adams

Her Teachers at APEX, NC:

Δ MISS RUTH EVANS

Δ JOHN C. LOCKHART

Her Friends:

Δ ANNIE MAE BELL

Δ LUCILLE BETS

Δ ESTHER PATE

Δ ROY PEARSON

Δ GEORGE ROGERS

Δ RALPH POE

→ Possible s/o  
Δ Robert W. McMILLAN,  
Raleigh, NC  
Attorney

ESTHER

PATE

○ Western Wake Herald WED 13 JAN 1990 Apex, NC

I has a nice surprise last week, I got a letter from Esther Pate Marshburn. She had received her first 1990 edition of the Western Wake Herald, a gift from her family in Apex. Esther wrote how surprised she was to see her name in the Apex paper, and she read the paper from "cover to cover". She is proud of being a native of Apex. She cherishes her memories of the happy days with her youth and her children spent in Apex. Esther is teaching 6 piano pupils twice a week. Now she is living with her daughter in Millbrae, California. They are both happy to be together.





I would be most grateful if you would send me a sketch (or print out) of your line back into Johnston Co, NC so that I might compare the names with those in my extensive files. I'll be glad to share with you anything that I find.

I am especially interested in one Greene Co, AL / Johnston Co, NC connection. Enclosed is a copy of the first sheet of my master outline on the Abel Upchurch, Sr / John Upchurch subclan. In 1835 John Upchurch married Jane Wilder. My records show they returned to Johnston Co, NC when they had two children and Jane died in 1840. I would like to know more about this family.

Enclosed are details on my Upchurch Bulletin. Over the last 17 years I have identified and published in this bulletin the names and family relationships of over 40,000 members of the extended Upchurch Family. A copy of our "freedom document" is also provided.

It would be a great pleasure to hear from you.

P.S. I had to guess at the spelling of your name. Sorry if I did not get it right. Phil U



Sincerely yours  
Phil Upchurch

[ROBERT PHILIP UPCHURCH]

○ See str 19 JUN 1999 Eleanor Louise Haber to RPA - Pz491, 2

I. Laura Arco Hughes of the George W. John U VI Subclass  
- Founda U Link.

A. Ruby Mae Brake

i. Barbara Sue Black

a. James Harlan Pate b 15 SEP 1966 (Danville,  
Vermilion Co, IL) md (1st) 27 JUN 1985

(Rossville, Vermilion Co, IL). April

Nichelle Smith b 6 MAY 1966 (Louisville,  
Jefferson Co, KY)

md (2nd) 26 MAY 1990 (Rossville, IL)

Jeri Bette Whitaker b 15 APR 1970  
(Crawfordsville, Montgomery Co, IN)

i. Samantha Marie Pate b 10 APR  
1987 (Barton, Polk Co, FL)

ii. Jason Wayne Whitaker Pate \*  
b 5 MAR 1986

iii. Hannah Leigh Pate b 11 AUG 1990  
(Danville, IL)

iii. Bailey Megan Pate b 9 SEP 1992

\* NOTE: It seems  
clear that in a  
child of Jeri  
Bette Whitaker  
and Nichelle  
James Harlan  
Pate is the  
father or not  
is not made  
clear. At the least  
he would be the  
step-father - RPA



○ See str 19 JUN 1999 Eleanor Louise Baker D RPA - P7491, 2

I. Laura Arco Hughes of the George W. John W. Subclass  
- Junda U Link.

A. Riley Mae Baker

1. Barbara Sue Black

a. James Harlan Pate b. 15 SEP 1966 (Danville,  
Vermilion Co, IL) md (1st) 27 JUN 1985

(Rossville, Vermilion Co, IL). April

Michelle Smith<sup>1)</sup> b. 6 MAY 1966 (Louisville,  
Jefferson Co, KY)

md (2nd) 26 MAY 1990 (Rossville, IL)

Jeri Belts Whitaker<sup>2)</sup> b. 15 APR 1970  
(Crawfordsville, Montgomery Co, IN)

i.<sup>1)</sup> Samantha Marie Pate b. 10 APR  
1987 (Canton, Polk Co, FL)

ii.<sup>2)</sup> Jason Wayne Whitaker Pate\*  
b. 5 MAR 1986

iii.<sup>2)</sup> Hannah Leigh Pate b. 11 AUG 1990  
(Danville, IL)

iii.<sup>2)</sup> Bailey Megan Pate b. 9 SEP 1992

\* NOTE: It seems  
clear that in a  
child of Jeri  
Belts Whitaker  
and Michelle  
James Harlan  
Pate is the  
father or not  
is not made  
clear. At the least  
he would be the  
step-father - RPA

① See Itt 18 AUG 1997 Eleanor Louise Baker to RPA Pg 51

I. George U - Head of clan

A. John U, VI

1. Lucinda U

a. William Benton Hughes

i. Laura Arco Hughes Md (2nd) 21 FEB 1912

(1) Leander Brake "Lee" b 1 AUG 1867.  
 Details on their child Ruby Mae Brake are given below.

② See Itt 19 JUN 1999 Eleanor Louise Baker to RPA - Pg 491

JHPA to 15 SEP 1966

C Danville, Vermilion Co, IL) Md 1st

27 JUN 1985 (Roxmull, Vermilion Co, IL) April

Michelle Smith to

6 MAY 1966 (Lansmull, Jefferson Co, KY).

Md (2nd) 26 MAY 1990

(Roxmull, IL) Jeri

Belt Whitaker to

15 APR 1970 (Crawfords-

mull, Montgomery

Co, IN).

- ..... 10 Ruby Mae BRAKE 1920 -
- ..... (3)+[617] Howard Glenn MATTHEWS 1920 - 1977 d: 20 May 1977
- ..... \*1st Husband of Ruby Mae Brake:
- ..... +[618] James Harlan BLACK 1917 - 1954 m: 07 November 1938
- ..... d: 12 April 1954
- ..... 11 Calvin James BLACK 1941 -
- ..... -[620] Patricia HORATH 1944 - m: 08 September 1962
- ..... 12 [621] Tina Louise BLACK 1967 -
- ..... \*2nd Wife of Calvin James Black:
- ..... +[622] Clara Evelyn HORATH 1946 - m: 02 September 1972
- ..... 12 [623] Timothy James BLACK 1973 -
- ..... 12 [624] Kenneth Lee BLACK 1973 -
- ..... 12 [625] Eric Alan BLACK 1982 -
- ..... 11 [626] Barbara Sue BLACK 1943 -
- ..... +[627] Albert John Randall PATE 1941 - m: 21 September 1962
- ..... 12 [628] Kimberly Jo PATE 1963 -
- ..... 12 [629] James Harlan PATE 1966 -
- ..... 12 [630] Lucinda Sue PATE 1968 - 1968 d: 15 December 1968
- ..... 11 [631] Thomas John BLACK 1945 - 1947 d: 20 March 1947
- ..... 11 [632] John Robert BLACK 1951 -
- ..... +[633] Jeanine Eloyce DAVIS 1952 - m: 22 March 1969
- ..... 12 [634] Phillip Michael BLACK 1969 -
- ..... 12 [635] Brian Jon BLACK 1975 -
- ..... \*2nd Husband of Ruby Mae Brake:
- ..... +[636] Donald Keith JACKSON 1909 - m: 14 March 1956
- ..... 11 [637] Sandra Kay JACKSON 1957 -
- ..... +[638] William Jackson GERARD 1957 - m: 02 February 1980
- ..... 12 [639] Christopher Jackson GERARD 1980 -
- ..... 12 [640] Aimee Nicole GERARD 1982 -
- ..... 11 [641] Marion Hughes JACKSON 1958 -
- ..... +[642] Kellie Marie REGAN 1959 - m: 30 December 1980
- ..... 12 [643] Kevin Wayne JACKSON 1981 -

○ See str 19 JUN 1999 Eleanor Louise Baker to RPA - Pg 491, 2

I. Laura Ann Hughes of the George W. John U VI Subclass  
- Lounda U Lind.

A. Ruliy Mae Brake

1. Barbara Sue Black

a. James Harlan Pate b 15 SEP 1966 (Danville,  
Vermilion Co, IL) md (1st) 27 JUN 1985

(Rossville, Vermilion Co, IL). April

Michelle Smith<sup>1)</sup> b 6 MAY 1966 (Louisville,  
Jefferson Co, KY)

md (2nd) 26 MAY 1990 (Rossville, IL)

Jeri Belts Whitaker<sup>2)</sup> b 15 APR 1970  
(Crawfordsville, Montgomery Co, IN)

i.<sup>1)</sup> Samantha Marie Pate b 10 APR  
1987 (Canton, Polk Co, FL)

ii.<sup>2)</sup> Jason Wayne Whitaker Pate\*  
b 5 MAR 1986

iii.<sup>2)</sup> Hannah Leigh Pate b 11 AUG 1990  
(Danville, IL)

iii.<sup>2)</sup> Bailey Morgan Pate b 9 SEP 1992

\* NOTE: It seems  
clear that in a  
child of Jeri  
Belts Whitaker  
and Michelle  
James Harlan  
Pate is the  
father or not  
is not made  
clear. At the least  
he would be the  
step-father - RPA



- ① Per Attachs #26 West Sts 18 MAY 1975 - Grantors - Franklin Co NC  
" 1828 Wulford U to John Pate - Deed of Trust  
Bk 25 Pg 21"

See file 27 APR 1993 Waylon Line U & R P1

I. Rupert Hugh U of the Mose U / Ruffin & Sub  
Class - Rufus U Line.

A. Emerald (Emeral) Bell Ustrage U, Sr b 11 DEC 1926  
(Lee Co, NC) d 7 APR 1951 (Laurel, MD) (Accident)  
md Betty Blue Lett

1. Emerald Bell Ustrage U, Jr b MAY 1949 d MAY  
1949 (Died at Birth)

2. Mary Lillian U b 31 OCT 1950

B. Roger Clifford U b 21 DEC 1935

md 1st 7 JUL 1972 Julie Pate d 15 SEP 1975 - NO issue

md 2nd 15 OCT 1976 Wilma Franke d 1978 - NO issue

① See Itt 18 AUG 1997 Eleanor Louise Baker to RPA Pg 51

I. George W - Head of clan

A. John W, VI

1. Lucinda W

a. William Benton Hughes

i. Laura Arco Hughes Md (2nd) 21 Feb 1912

(1) Leander Brake "Lee" b. 1 AUG 1867.

Details on their child Ruby Mae Brake are given below.

② See Itt 19 JUN 1999 Eleanor Louise Baker to RPA - Pg 490

KJPA b. 12 SEP 1963

(Length mem. Hosp.)  
Norfolk, Norfolk Co, VA

MA 27 JAN 1985 (HOOPER-  
STON, VERMILION CO,  
IL)

Joe Warner Jones  
b. 9 OCT 1954 (Gideon,  
Pemisicott Co, MO)  
- Two children

- ..... 10 Ruby Mae BRAKE 1920 -
- ..... (3)-[617] Howard Glenn MATTHEWS 1920 - 1977 d: 20 May 1977
- ..... \*~~1st~~ Husband of Ruby Mae Brake:
- ..... +[618] James Harlan BLACK 1917 - 1954 m: 07 November 1938  
d: 12 April 1954
- ..... 11 Calvin James BLACK 1941 -
- ..... -[620] Patricia HORATH 1944 - m: 08 September 1962
- ..... 12 [621] Tina Louise BLACK 1967 -
- ..... \*2nd Wife of Calvin James Black:
- ..... +[622] Clara Evelyn HORATH 1946 - m: 02 September  
1972
- ..... 12 [623] Timothy James BLACK 1973 -
- ..... 12 [624] Kenneth Lee BLACK 1973 -
- ..... 12 [625] Eric Alan BLACK 1982 -
- ..... 11 [626] Barbara Sue BLACK 1943 -
- ..... +[627] Albert John Randall PATE 1941 - m: 21 September  
1962
- ..... 12 [628] Kimberly Jo PATE 1963 -
- ..... 12 [629] James Harlan PATE 1966 -
- ..... 12 [630] Lucinda Sue PATE 1968 - 1968 d: 15 December  
1968
- ..... 11 [631] Thomas John BLACK 1945 - 1947 d: 20 March 1947
- ..... 11 [632] John Robert BLACK 1951 -
- ..... +[633] Jeanine Eloyce DAVTS 1952 - m: 22 March 1969
- ..... 12 [634] Phillip Michael BLACK 1969 -
- ..... 12 [635] Brian Jon BLACK 1975 -
- ..... \*3rd Husband of Ruby Mae Brake:
- ..... +[636] Donald Keith JACKSON 1909 - m: 14 March 1956
- ..... 11 [637] Sandra Kay JACKSON 1957 -
- ..... +[638] William Jackson GERARD 1957 - m: 02 February  
1980
- ..... 12 [639] Christopher Jackson GERARD 1980 -
- ..... 12 [640] Aimee Nicole GERARD 1982 -
- ..... 11 [641] Marion Hughes JACKSON 1958 -
- ..... +[642] Kellie Marie REGAN 1959 - m: 30 December 1980
- ..... 12 [643] Kevin Wayne JACKSON 1981 -



LARRY PATE

LARRY LEE PATE

○ THE COUNCILS - FROM VATD NC - 2ND ED 1978 - BY: IRMA  
RAGAN HOLLAND - [RPU REFERENCE CODE (35)] PG(S) 163  
FROM GENERAL INDEX

PATE

Larry Lee, 102

---

See the 4 DEC 1995 Dana Speight Utley to RPU

I. Roger Diehl Utley of the Maxwell Ruffin & Subdan-Kelly  
F. U. Line.

A. Dana Speight Utley

1. Mary Karen Matthews b. 29 JAN 1944 (Pine-  
hurst, Moore Co, NC) md 12 AUG 1962 (Fayette-  
ville, Cumberland Co, NC) Talton Allen Oliver  
b. 10 SEP 1943

a. Shannon Denise Oliver b. 20 SEP 1967  
(Fort Stewart, Liberty Co, GA) md 1985  
(Fort Ord, Monterey Co, CA) Gerald Wood

i. Alyssa Wood b. 8 APR 1986 (Fort  
Ord, Monterey Co, CA)

ii. Harley Austin Wood b. 26 MAY 1989  
(Nuremberg, Bavaria, Germany).

2. Warren Duncan Matthews, III b. 26 JUN 1947  
(Fayetteville, Cumberland Co, NC)

md (1st) 1965 (Fort Bragg, Cumberland Co, NC)  
Linda Reese Divorced.

md (2nd) 12 JUN 1970 (SC) Christian White-DIV

md (3rd) 25 SEP 1982 (Fayetteville, Cumberland  
Co, NC) Gail M. Queen. Divorced

md (4th) 15 APR 1989 (Laurin, Jones Co, NC)

Sergt Candy Pate. Divorced

a. Michelle Elizabeth Matthews b. 10 JAN 1971  
(Fayetteville, Cumberland Co, NC)

LESLIE PATE

LESLIE WASHINGTON PATE, III

⊙ Apex Herald 12 NOV 1997 Apex, NC

**LESLIE W. PATE**

Leslie Washington Pate III, 52, of Raleigh, passed away November 6, 1997. He was employed with the U.S. Postal Service.

Funeral services were held Saturday, Nov. 8 at Brown-Wynne Funeral Home, Millbrook Rd. Burial followed at Restlawn Memorial Garden.

Mr. Pate is survived by his wife, Dana J. Pate; daughters, Wendy and Tara Pate, both of Raleigh; step-son, Shane Balance of Raleigh; mother, Alma Pate of Apex; brothers, Donald Pate of Raleigh and Phillip Pate of Apex.

Memorial contributions may be made to the Rex Cancer Center, 4420 Lake Boone Trail, Raleigh, N.C., 27607.



① See Itz 18 AUG 1997 Eleanor Louise Brake to RPA Pg 51

I. George W - Head of clan

A. John W, VI

1. Lucinda W

a. William Benton Hughes

i. Laura Arco Hughes Md (2nd) 21 FEB 1912

(1) Leander Brake "Lee" b. 1 AUG 1867.  
Details on their child Ruby Mae  
Brake are given below.

② see Itz 19 JUN  
1999 Eleanor  
Louise Brake to  
RPA - Pg 489  
LSPA b. 19 NOV 1968  
(Danville, Vermilion  
Co, IL) & 15 DEC 1968  
(Chicago, Cook Co, IL)

- ..... 10 Ruby Mae BRAKE 1920 -
- ..... (3) + [617] Howard Glenn MATTHEWS 1920 - 1977 d: 20 May 1977
- ..... \*1st Husband of Ruby Mae Brake:
- ..... + [618] James Harlan BLACK 1917 - 1954 m: 07 November 1938  
d: 12 April 1954
- ..... 11 Calvin James BLACK 1941 -
- ..... - [620] Patricia HORATH 1944 - m: 08 September 1962
- ..... 12 [621] Tina Louise BLACK 1967 -
- ..... \*2nd Wife of Calvin James Black:
- ..... + [622] Clara Evelyn HORATH 1946 - m: 02 September  
1972
- ..... 12 [623] Timothy James BLACK 1973 -
- ..... 12 [624] Kenneth Lee BLACK 1973 -
- ..... 12 [625] Eric Alan BLACK 1982 -
- ..... 11 [626] Barbara Sue BLACK 1943 -
- ..... + [627] Albert John Randall PATE 1941 - m: 21 September  
1962
- ..... 12 [628] Kimberly Jo PATE 1963 -
- ..... 12 [629] James Harlan PATE 1966 -
- ..... 12 [630] Lucinda Sue PATE 1968 - 1968 d: 15 December  
1968
- ..... 11 [631] Thomas John BLACK 1945 - 1947 d: 20 March 1947
- ..... 11 [632] John Robert BLACK 1951 -
- ..... + [633] Jeanine Eloyce DAVIS 1952 - m: 22 March 1969
- ..... 12 [634] Phillip Michael BLACK 1969 -
- ..... 12 [635] Brian Jon BLACK 1975 -
- ..... \*2nd Husband of Ruby Mae Brake:
- ..... + [636] Donald Keith JACKSON 1909 - m: 14 March 1956
- ..... 11 [637] Sandra Kay JACKSON 1957 -
- ..... + [638] William Jackson GERARD 1957 - m: 02 February  
1980
- ..... 12 [639] Christopher Jackson GERARD 1980 -
- ..... 12 [640] Aimee Nicole GERARD 1982 -
- ..... 11 [641] Marion Hughes JACKSON 1958 -
- ..... + [642] Kellie Marie REGAN 1959 - m: 30 December 1980
- ..... 12 [643] Kevin Wayne JACKSON 1981 -

○ Zebulon Record THUR 4 NOV 1999 Zebulon, NC

I. MACK PATE ↑

md (1) Ethel - -

A. Thurman Baxter Pate

md (1) Dorothy Hardy

1. Tommy Pate

B. Coy Pate

#### **Thurman Baxter Pate**

Thurman Baxter Pate, 79, of Zebulon, died Tuesday, Oct. 26, at his home. Funeral service was Saturday, Oct. 30, at L. Harold Poole Funeral Service chapel, Knightdale. Burial was at Gethsemane Memorial Gardens.

He was a self-employed farmer and a tobacco warehouseman. He was a veteran of World War II, serving in the Marine Corps in the Pacific. He was preceded in death by his parents, Mack and Ethel Pate; a brother, Coy Pate; and a sister, Clara P. Whittington.

Surviving: wife, Dorothy Hardy Pate; son, Tommy Pate and his wife, Evelyn,

of Zebulon; two grandsons; sister, Elizabeth Pate Griffin and her husband, Elmo, of Raleigh; nieces and nephews.

Memorial contributions may be made to Hospice of Wake County, 1300 St. Mary's St., Fourth Floor, Raleigh 27605.

○ See Biopile of Joseph Baxton U, SI - Entry 4 MAY 1999

I. Julia U - Head of Class  
 A. Calvin U

1. Benjamin U

a. Joseph Calvin U

i. Joseph Baxton

U, SI md abt 1912

Maggie McLeod

I. DARIE McLEOD  
 m&d) MARTHA PATE

A. MARY McLEOD

B. LUDELA McLEOD

C. ANNIE McLEOD

D. MAGGIE McLEOD

E. HARVEY McLEOD

F. DEWEY McLEOD

G. MURPHY McLEOD

H. WAYLON McLEOD

↳ Drowned in the  
 Eno River as a  
 young man.

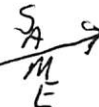



MARY PATE

MARY F

STANFIELD PATE

○ See ~~for~~ 11 APR 1991 Carlton Reed Shaw, Sr DRPM  
Mary F. Stanfield Pate #208 is a relative of CRS, Sr

○ The Zebulon Record THUR 1 FEB 1990 Zebulon, NC

## Local farmer honored by county for soil, water conservation efforts

By DON FULLER  
Record intern

Mike Pate is the last of a dying breed ... a small farmer.

The Zebulon native, however, has plenty of life left in him. He has disked up the secret to surviving the toil of the soil: living off the land also means living for the land.

Pate said, "I've always wanted to farm." As a result, he has taken steps to conserve his land, thus prolonging his self-employment.

Those procedures have not gone unrewarded, both by nature and by man. Not only did 1989 bring his best tobacco crop ever, but it also wrought the Pate family the Wake County "Farm Family Conservation Award" presented annually by the Wake Soil and Water Conservation District.

At a Dec. 7, 1989, ceremony, Pate became the first farmer from the local area to receive the honor.

Pate earned the award by making the effort of offering his land the chance to save itself. He opted for strip-cropping, a practice of alternating crop fields with 125-foot strips of grass. This deterred soil erosion, which can erase 45 to 50 acres of dirt per year.

Pate also covered areas close to his irrigation ponds with grass. This filtered the water runoff coming from the fields, causing only clean rainfall to fill the waterholes.

The processes meant extra time, extra work and taking up spaces that could have been used for cash crop production.

Pate justifies his actions with the fact that the land will reimburse

him in time. "It'll (strip-farming) pay for itself in years to come," Pate said. "The yields will get better."

Pate has showed a devotion to his acreage since childhood. He was raised on this stretch of land until he entered the military.

He then went to work at IBM for 15 years, managing to farm part time on the side. Ultimately though, it was farming that won his heart. He started full-time agriculture work 10 years ago, never looking back at the office duty he left behind.

He recalled the past seasons, remembering the best of times as well as the worst of times. While farming part time in 1977, Pate suffered through the biggest drought he had ever witnessed in this area. "No rain fell that entire summer,"



Mike Pate



he said.

In 1983, the weather shifted into opposite directions during the farming period. The spring was wet, while the summer experienced a dry spell.

1989 brought the deluge of rains that presented new challenges for area farmers. Pate waded through the soggy fields and reaped a bountiful harvest. He even found himself having to irrigate some regions, something no other local farmers had to do.

Pate oversees close to 100 acres. Though he concentrates heavily on his tobacco crops, he is hardly a one-dimensional farmer. He also grows wheat, alfalfa, soybeans and beef cattle.

Tobacco begins to take his attention around February, when he gases his plant beds. He lays down seeds on Valentine's Day.

"I usually seed around love day," Pate laughed. "That way, I'll have a loving crop."

Last year's tobacco influx did romance him, as it was a successful

one. That was his reward for the difficult task. Or so he thought.

The Soil and Water Conservation District sent its board of supervisors to farms all over Wake County. The search for best in the county ended with one glance at Mike Pate Farms, a label the farmer wears proudly across his shirt.

Supervisor Donnie Woodlief later called the farm a "showplace" in the award presentation speech. The selection committee arrived, saw the farm and hailed the victor.

Pate's farm was judged on conservation activities, woodland and wildlife efforts, general appearance, community participation and use of agricultural organizations.

The award banquet, for Pate, offered not only a sense of accomplishment, but also a touch of tasteful satisfaction. "My wife (Frances Pate) and I ate a nice meal," he said.

Almost a month after his acceptance of the award, Pate sat back in his shop, surrounded by machine parts and his trusty sidekick Hound, a dog who has been his faithful com-

panion since they met by accident years ago.

The mooing of the cows outside reminds him it is feeding time. He slowly gets to his feet, preparing to start a new day. His day.

"It's your operation," Pate explained his dedication to his profession. "You make all the decisions. When things go wrong, you can't blame anyone but yourself."

He ambles into the morning air, opens the door of his truck and watches Hound jump into the passenger's side.

Behind the wheel, he grinned as if basking in his independence. That is what farming is all about.

Independence ... and big equipment, he added.

Admiring his award-winning fields of dreams, he drives off. There is, after all, a tractor in the next county he really wants to see.



PHILLIP

PATE

Zebulon Record THUR 12 MAY 1994 Zebulon, NC

Jennifer Pate, a senior at East Wake High School and daughter of Phillip and Ivey Pate of Zebulon, has been recognized by the United States Achievement Academy and named a United States National Award winner in science.

This award is a prestigious honor very few students can ever hope to attain, stated a press release. In fact, the academy recognizes less than 10 percent of all

American high school students, the release said.

Miss Pate is the granddaughter of Norma Strickland and A. Virginia Pate, both of Zebulon.

Nominated for the award by Ragan Spain, a science teacher at East Wake, Miss Pate's biography will appear in the United States Achievement Academy Official yearbook, published nationally.

\*\*\*



Jennifer Pate

○ See str 19 JUN 1999 Eleanor Louise Haber to RPA - Pz491, 2

I. Laura Arco Taylor of the George W. John U VI Subclass  
- Lounda U Link.

A. Burley Mae Stahl

1. Barbara Sue Black

a. James Harlan Pate b 15 SEP 1966 (Danville,  
Vermilion Co, IL) md (1st) 27 JUN 1985

(Rensville, Vermilion Co, IL). April

Michelle Smith<sup>1)</sup> b 6 MAY 1966 (Louisville,  
Jefferson Co, KY)

md (2nd) 26 MAY 1990 (Rensville, IL)

Jeri Belts Whitaker<sup>2)</sup> b 15 APR 1970  
(Crawfordsville, Montgomery Co, IN)

\* NOTE: It seems  
clear that in a  
child of Jeri  
Belts Whitaker  
and Michelle  
James Harlan  
Pate is the  
father or not  
is not made  
clear. At the least  
he would be the  
step-father - RPA

i. Samantha Marie Pate b 10 APR  
1987 (Bartow, Polk Co, FL)

ii. Jason Wayne Whitaker Pate\*  
b 5 MAR 1986

iii. Hannah Leigh Pate b 11 AUG 1990  
(Danville, IL)

iii. Burley Megan Pate b 9 SEP 1992

○ The Naaman Mills Family By W. A. Mills - Pg 89

I. Abraham Mills

A. Naaman Mills

1. Secreta Mills - GGM of RDX

2. Shudrock Mills

a. Harland Jackson Mills - see another extract

b. Thomas Agnes Mills - see below

c. NO FURTHER ISSUE

2. Thomas Haynes Mills (b 11 Aug 1877, d 12 Jan 1934) m 29 Apr 1901 Blanche Estelle Weatherspoon (b 5 May 1882, d 7 Nov 1942), daughter of James Weatherspoon and Margaret Woodward. Married by Bap. Min. Thomas Pate, in Wake Co., NC. Buried at Wake Chapel Chr. Ch. Cem., Fuquay-Varina, NC. He was a farmer. Resided in Wake Co., NC (Holly Springs Twp.) on FC/1920. He lived to age 56. Their children:
- (1) Wade Jackson Mills (b 29 May 1902, d 8 Jul 1902). Buried at Rock Springs Church Cem., Apex, NC.
  - (2) Ruth Wyatt Mills (b 8 Aug 1903, d 5 Jul 1995) m 23 Nov 1921 Elijah Thomas Burchette (b ca 1900, d 19\_\_). Married by JP W.P. Tally, in Wake Co., NC (Holly Springs Twp.). Buried at Wake Chapel Chr. Ch. Cem., Fuquay-Varina, NC. Their children:
    - (A) Elijah Thomas Burchette, Jr. (b 6 Sep 1922) m 19\_\_ Margaret Farmer. He m 2ndly 19\_\_ Margaret Aiken Montague. Elijah and Margaret Farmer's child: Gail Burchette.
    - (B) James W. Burchette (b 18 Aug 1924) m 19\_\_ Fannie Pace. Nfi.
    - (C) Ben Eugene Burchette (b 14 Aug 1931) m 19\_\_ Bibby Steed. Nfi.
    - (D) Ruth Jean Burchette (b 19\_\_) m 19\_\_ Gilbert Wilson. Nfi.
  - (3) Collon Ray Mills (b 20 Jul 1906, d 5 Sep 1906). Buried at Rock Springs Church Cem., Apex, NC.
  - (4) Leland Forrest Mills (b 29 Jul 1907) m 18 Sep 1929 Annie Lou Coley (b ca 1907). Married by Bap. Min. J.S. Farmer, in Raleigh, NC.
  - (5) Mary Margaret Mills (b 16 Apr 1910, d Oct 1982) m 25 Jan 1928 Wiley Perry Howard, Jr. (b ca 1902). Married in Raleigh, NC. Nfi.
  - (6) Hilda Gray Mills (b 29 Jul 1915, d 9 Dec 1994) m 23 Sep 1936 Carlisle N. Jones. Married by JP W.F. Booker, in Raleigh, NC. She m 2ndly 19\_\_ Johnson. She is buried at Wake Chapel Chr. Ch. Cem., Fuquay-Varina, NC. Hilda & Carlisle's child: James N. Jones.
  - (7) Thomas Baxter Mills (b 10 Jul 1916, d 12 Jul 1916). Buried at Wake Chapel Chr. Ch. Cem., Fuquay-Varina, NC.
  - (8) Charlie Willard Mills (b 13 Jan 1918) m 19\_\_\_. Resided in Louisville, KY. Nfi.
  - (9) Victor Davis Mills (b 15 Jul 1921, d 26 Dec 1958) m 19\_\_ Nellie Bryant. Buried at Wake Chapel Chr. Ch. Cem., Fuquay-Varina, NC.
  - 10) Hazel Estelle Mills (b 16 Jul 1924) m 2 Nov 1946 George H. Edwards (b ca 1911). Married in Raleigh, NC. Resided in Philadelphia, PA.



THURMAN

PATE

① Zebulon Record THUR 11 FEB 1999 Zebulon, NC

I. H. B. THOMAS

m d ( ) CORA KING

A. EFFIE THOMAS

m d ( ) FRANCIS S. HARDY

1. JANICE HARDY m d ( ) - - MARTIN

2. DOROTHY HARDY

m d ( ) THURMAN PATE ↑

3. CORA HARDY

m d ( ) HOWARD ALFORD

**Effie Thomas Hardy**

Effie Thomas Hardy, 96, formerly of Raleigh, died early Thursday, Feb. 4, at Guardian Care, Zebulon. Graveside service was Saturday, Feb. 6, at Montlawn Memorial Park.

She was born April 6, 1902, the daughter of H.B. and Cora King Thomas. She was a member of New Hope Baptist Church. She was preceded in death by her husband, Francis S. Hardy, in 1981; and a daughter, Janice Hardy Martin, in 1982.

Surviving: daughters, Dorothy Hardy Pate and her husband, Thurman Pate, of Zebulon, Cora Hardy Alford and her husband, Howard Alford, of Milton, W.Va.; seven grandchildren; eight great-grandchildren; several nieces and nephews.

Arrangements by L. Harold Poole Funeral Service and Crematory.

① The Zebulon Record THUR 6 JUN 1985 Zebulon, NC

**Clara Mae Pate Whittington**

Mrs. Clara Mae Pate Whittington, 63, of Raleigh, died Thursday, May 30. Funeral was 3:30 p.m. Saturday, June 1, at Ephesus Baptist Church. Burial was at Restlawn Memorial Gardens.

Surviving: brother, Thurman Pate of Zebulon; sister, Mrs. Elizabeth Griffin of Raleigh.

THURMAN BAXTER PATE

○ Zebulon Record THUR 4 NOV 1999 Zebulon, NC

I. MACK PATE

md (7) Ethel - -

A. Thurman Baxter Pate ↑

md (7) Dorothy Hardy

1. Tommy Pate

B. Coy Pate

**Thurman Baxter Pate**

Thurman Baxter Pate, 79, of Zebulon, died Tuesday, Oct. 26, at his home. Funeral service was Saturday, Oct. 30, at L. Harold Poole Funeral Service chapel, Knightdale. Burial was at Gethsemane Memorial Gardens.

He was a self-employed farmer and a tobacco warehouseman. He was a veteran of World War II, serving in the Marine Corps in the Pacific. He was preceded in death by his parents, Mack and Ethel Pate; a brother, Coy Pate; and a sister, Clara P. Whittington.

Surviving: wife, Dorothy Hardy Pate; son, Tommy Pate and his wife, Evelyn, of Zebulon; two grandsons; sister, Elizabeth Pate Griffin and her husband, Elmo, of Raleigh; nieces and nephews.

Memorial contributions may be made to Hospice of Wake County, 1300 St. Mary's St., Fourth Floor, Raleigh 27605.

EXTRACT FROM: WAKE TREASURES Vol 20 No 2 SUMMER/FALL  
2010 - BY RPU 4 APR 2011

DEPARTMENT OF AGRICULTURE/STATE BOARD OF AG PGS 71-74

(Note: Extra entries slipped in from N.C. State College - RPU)

1921

△ Comm. Chairman, W. A. Graham  
△ Fourth Dist Rep: Clarence Pal  
Analytical Division -

- △ B. W. KILGORE ..... Director Experiment Station and Extension Service
- △ F. E. MILLER ..... Assistant Director Test Farms
- △ J. M. PICKEL ..... Field Chemist
- △ W. G. HAYWOOD ..... Fertilizer Chemist
- △ E. S. DEWAR ..... Assistant Chemist
- △ B. C. WILLIAMS [CHARLES BURGESS WILLIAMS] ..... Assistant Chemist
- △ G. L. ARTHUR ..... Assistant Chemist
- △ J. K. DALE ..... Assistant Chemist
- △ T. C. KEISEL ..... Assistant Chemist
- △ Miss M. S. BIRDSONG ..... Secretary
- △ J. F. HATCH ..... Clerk and Stenographer
- △ Mrs. L. B. JUDD ..... Stenographer

Agronomy

- △ C. B. WILLIAMS [CHARLES BURGESS WILLIAMS] ..... Agronomist
- △ R. Y. WINTERS ..... Plant Breeding Agronomist
- △ V. R. HERMAN<sup>3</sup> ..... Assistant, Plant Breeding
- △ S. W. HILL ..... Assistant, Plant Breeding
- △ G. M. GARREN ..... Assistant, Plant Breeding
- △ W. F. PATE ..... Assistant, Plant Breeding
- △ S. K. JACKSON ..... Soil Agronomist
- △ M. W. HEMSELS<sup>3</sup> ..... Assistant in Soils
- △ E. C. BLAIR ..... Agent in Sugar Work
- △ A. R. RUSSELL ..... Extension Agronomist
- △ S. F. DAVIDSON ..... Superintendent of Station Farm
- △ W. A. DAVIS ..... Soil Survey
- △ W. D. LEE \* ..... Soil Survey
- △ K. L. CREWS ..... Soil Survey
- △ Louise PICKEL<sup>3</sup> ..... Clerk
- ..... Stenographer

\* AN RPU COLLEAGUE 1950-1960 ERA



○ From: Rev James Henry Wood 1826-1900 pg 48-49

I. Edna Carter of the George W / John W, IV Subdan,  
- Eleanor W Line

A. Leona Anne W'reen b 24 DEC 1903 (Buckey, WA)  
md 1923 (1) Cliff Wright O'Leary

B. Frances Edna W'reen b 24 OCT 1905 (Spokane, WA)  
md 1925 (1) Rayfield Estrada Jenty

C. Merrett Clair W'reen b 17 DEC 1906 (Grandforks,  
British Columbia, Canada) md (1st) 1925 Florence  
Wright md (2nd) (1) Sybil Irene —

D. Elizabeth Hazel W'reen b 18 JUL 1915 (Grandforks,  
British Columbia, Canada)  
md (1st) (1) Berdella David Wlean  
md (2nd) (1) Wilbert Charles Pate r

E. Evelyn Eileen W'reen b 16 FEB 1917 (Grandforks,  
British Columbia, Canada) & 14 FEB 1933  
(Spokane, WA)

① Zebulon Record THUR 6 MAY 1999 Zebulon, NC

- I. Jimmy Hemby  
 md (1) Annie Heath
- A. Edith Rose Hemby
- B. Linda Hemby  
 md (1) Wilton Pate ↑
- C. James Hemby  
 md (1) Jane ↓ -

### Edith R. Hemby

Edith Rose Hemby, 50, of LaGrange, died Friday morning, April 30, at Lenoir Memorial Hospital after a sudden illness. Funeral was Sunday, May 2, at Taylor-Edwards Funeral Home chapel in Snow Hill. Burial was in Snow Hill Cemetery.

She was a lifelong resident of the Arba community of Greene County. She worked as a respiratory therapist at Lenoir Memorial Hospital for 27 years and in recent years worked with National Sleep performing clinical sleep apnea research.

Surviving: parents, Jimmie and Annie Heath Hemby of the home; sister, Linda H. Pate and husband, Wilton, of Ayden; brother, James Hemby and wife, Jane, of Wendell; four nieces, including LeAnn Lyerly of Zebulon; four great-nephews, including Justin Avery of Zebulon; aunt, Essie Heath of Snow Hill.

Memorials may be made to Hull Road Free Will Baptist Church, Route 2, Box 290, Snow Hill 28580; or to Arba Volunteer Fire and Rescue.

- ① See It's 18 OCT 1985 Charlotte Jane Goodwin D R 04  
 James R. Jenks b ? 1865 d 1907 (Apex, NC).  
 and Zelpnia Jane Pate b 1867 d NOV 1943  
 (Apex, NC). Their dau Jeanette Lydia Jenks  
 and Newton Jackson Goodwin, son of  
 Virginia Fisher d of the more W/ Murray of  
 Suldan. Zelpnia and 2nd Thomas  
 Sears, deceased and and 3rd W. J. Wagoner,  
 deceased.