

## Nancy Ann Lewter

XID – 829

**Commentary:** Nancy Ann Lewter, born 1812, married Golden Almon Upchurch. He was the grandson of Nathan Upchurch I, head of Upchurch Clan. Nancy passed away in 1892. Both she and her family lived in Wake County, NC.

**Acknowledgements:** This Biofile was transcribed by Carla J. Michaels, UAFA Volunteer Coordinator in Cary, NC.

**(no number)** See Lewter Family – Entry 1 Aug 2009 – Packet to RPU from Patricia Kimberly Beach – Pages 14, 15, 16

I. Nathan Upchurch I – Head of Clan

A. Tabitha Upchurch born about 1791

1. Golden Almon Upchurch, Sr born 1815

married ( ) **Nancy Ann Lewter**

- 3 **Nancy Ann LEWTER** abt 1812 (b 29 Nov 1801 ?) d btw 1880 and 1900  
 △ m **Golden Almond UPCHURCH** b abt 1815 d btw 1880 and 1900  
 NOTE: Nancy is a confirmed daughter of Henry Lewter per his Will dated 02/1828. Listed in the 1850 Wake Co NC census pgs 202b & 203a with Tabitha Upchurch (b 1791) and Martha Upchurch (b 1821) in their home in White Oak tw. In the 1860 Wake Co NC census on page 50b; the 1870 Wake Co NC census on page 443b; the 1880 Wake Co NC census page 495c. 1870 Wake Co NC census White Oak Township Page 443b  
 Her Obituary:  
 Biblical Recorder: 2 Mar 1892  
 UPCHURCH – Sister **NANCY**, wife of G. A. UPCHURCH, Green Level, Wake County, N. C., went to rest on February 19th, in her eightieth year. In early life she gave her heart to God and for many years has been a member of the Baptist church, faithful and consistent to all its demands. She leaves a husband and several children to mourn her loss.  
 C. W. BLANCHARD
- △ 4 **Golden Almond UPCHURCH Jr** b 12 Apr 1860 d 20 May 1929  
 △ m **Anne Eliza "Anlizer" HARWARD** b abt 1862 [FILE AS NANCY HARWARD]  
 NOTE: Married about 1882. Golden is buried at Green Level Baptist Church in Wake Co NC. Believe he was born in 1861 instead of 1860 as tombstone says. Listed in the 1900 Wake Co NC page census 272a with Anne's mother Fannie H Harward in their home (says Fannie had 1 child). Listed on Apex Road in the 1920 Wake Co NC census page 264a.
- △ 4 **Joseph B UPCHURCH** b abt 1840 d 08/31/1863  
 NOTE: Served in the Confederacy in the Civil War. Enlisted as a Private on 11 March 1862 at the age of 21. Enlisted in Company H, 47th Infantry Regiment North Carolina on 29 April 1862. Promoted to Full Corporal on 01 July 1863 (Estimated day of Prom)  
 POW on 03 July 1863 at Gettysburg, PA. Confined on 09 July 1863 at Fort Delaware, DE.  
 △ Died of disease while a POW Company H, 47th Infantry Regiment North Carolina on 31 August 1863 in Fort Delaware, DE. DISTINGUISHED SERVICE
- △ 4 **Miley / Milie Jane UPCHURCH** b 10 Oct 1844 d 12 May 1920  
 — m Unknown YOUNG  
 □ NOTE: Miley's Name, Dates, Parents, Birth in Wake Co NC, Spouse, Death of Heart  
 △ Dropsy in White Oak township, Wake Co NC, Informant B E Atkins of Apex, NC and  
 — Burial at Salem Baptist Church Cemetery in Apex, Wake Co NC per her NC Death  
 — Certificate on Microfilm at the State Archives.

[Names included: **Nancy Ann Lewter**, Golden Almond Upchurch, Henry Lewter, Tabitha Upchurch, Martha Upchurch, G A Upchurch, C W Blanchard, Golden Almond Upchurch, JR,

Anne Eliza "Anlizer" Harward, Fannie H Harward, Joseph B Upchurch, Miley Jane Upchurch, Millie Jane Upchurch, Young – CJM 04 Oct 2020]

**(no number)** Details in letter 10 Apr 1999 Jerry J Lewis to RPU

Re: I. Nathan Upchurch, I – Head of Clan

A. Tabitha Upchurch

1. Golden Almon Upchurch, Sr

married **Nancy Ann Lewter**

a. Arcanna Delmer Upchurch

married James Adolphus Lewis, son of Guilford Lewis

**James Lewis's name was no doubt Adolphus. After my grandfather's death, my grandmother married a "Dolphus" whose name was actually "Adolphus". Perhaps, James Lewis was referred to in the same way per legal records:**

**Marriage Index:**

Lewis, J.D. of Wake Co. age 30 [JAMES ADOLPHUS LEWIS]  
and A.D. Upchurch of Wake Co. age 32 [ARCANNA DELMER U]  
m. @ G.A.Upchurch residence Nov 22, 1877 [GOLDEN ALMON U, SR]

**Marriage Index:**

Lewis, James D. of East Durham age 61 [JAMES ADOLPHUS LEWIS]  
and Ettie Woods of Apex, age 47  
m. Mar. 5, 1908

**Deeds:**

Guilford Lewis deeds 60 acres for "natural love for my son, James D. Lewis" (Wake County, NC Real Estate Conveyances Vol 140, p. 198, Dec. 12. 1896).

→ [JAMES ADOLPHUS LEWIS]

→ [J. U vs GOLDEN ALMON U, SR]↑

For the father of "Arcanna Delmer" (sp?) - J. Upchurch per my research, I have summarized the marriage license:  
Wake County, age 30, son of Guilford Lewis and Susan Lewis of Wake County to marry A.D. UPCHURCH, age 32, of Wake County, the daughter of J. UPCHURCH and Nancy UPCHURCH of Wake County. Wedding on Nov. 22, 1877.

See **Nancy Ann Lewter**, daughter of Henry Lewter

Names included:

James Lewis	Adolphus	J D Lewis	A D Upchurch
G A Upchurch	Golden Almon Upchurch, Sr		Susan Lewis
Arcanna Delmer Upchurch	James Adolphus Lewis		Guilford Lewis
A D Upchurch	J Upchurch	Nancy Upchurch	

**(1)** Nancy Lewter born 1812 died 1850 – 60, married Golden A Upchurch born 1815. See Golden A Upchurch for their 4 children. Nancy Lewter was daughter of Henry born circa 1775 and Amelia (Kelly) Lewter. Henry moved with his father to Chatham Co, NC before 1800. (32, page 89)

**(2)** See 1860 Census – Wake Co, NC

Ann Upchurch age 47 female is shown as wife of Golden Upchurch age 45. (Assume Ann = Nancy – RPU). (age 47 = born circa 1813)

**(3)** See 1870 Census – Wake Co, NC – White Oak Township

Nancy Upchurch age 58 female is shown as wife of Gold A Upchurch age 55 (age 58 = born circa 1812)

**(4)** See 1880 Census – Wake Co, NC – White Oak Township – Household #94, Family #96

G A Upchurch           white   male   65     farmer

**Nancy Upchurch**   white   female 67     wife

G A Upchurch Jr       white   male   20     son

Mozie Juda            black   female 26     servant

**(5)** See 1850 Census – Wake Co, NC – Western Division

Nancy Upchurch       age 38 female            wife of below, born in NC

Golden A Upchurch   age 35 male              farmer, \$225 RE

**(6)** See notes of RPU 18 Nov 1978 visit to Adelia Jane Kelly

Golden Almon Upchurch Sr's wife Nancy Lewter was a sister of Jack Lewter

**(7)** Obituary – Biblical Recorder, Raleigh, NC

Nancy Upchurch, wife of G A Upchurch, Baptist, Green Level, Wake Co, NC 2 Mar 1892

**(1)** Per attachment #35 – West letter 18 May 1975 – Wake Co, NC – Court House – Wills

“G A Upchurch to Nancy Upchurch 2 Nov 1893 – Book Rec C, Page 182, File 1917”

**(2)** Per attachment #35 - West letter 18 May 1975 – Wake Co, NC – Court House – Wills

“A A Upchurch [should be G A Upchurch – RPU] to Nancy Upchurch et al 2 Nov 1893 – Rec C, Page 182, File 1917”

[Note 1 & 2 = same except for translation error G A Upchurch vs A A Upchurch – RPU]

**(3)** See Will File – Will of G A Upchurch – Wake Co, NC – Written 7 Apr 1891, probated 2 Nov 1893. G A Upchurch, Sr names wife Nancy and their children

**(no number)** Extract of email 17 Jan 2010 Patricia Kimberly Beach to RPU Re: Hardy Lewter 76 acre home tract in Chatham Co, NC adjoining land of Isham Sims Upchurch. See biofile of Hardy Lewter for 3 maps provided by Kim. [Eastern Chatham Co, NC] [See one map interpretation below – CJM 4 Oct 2020]

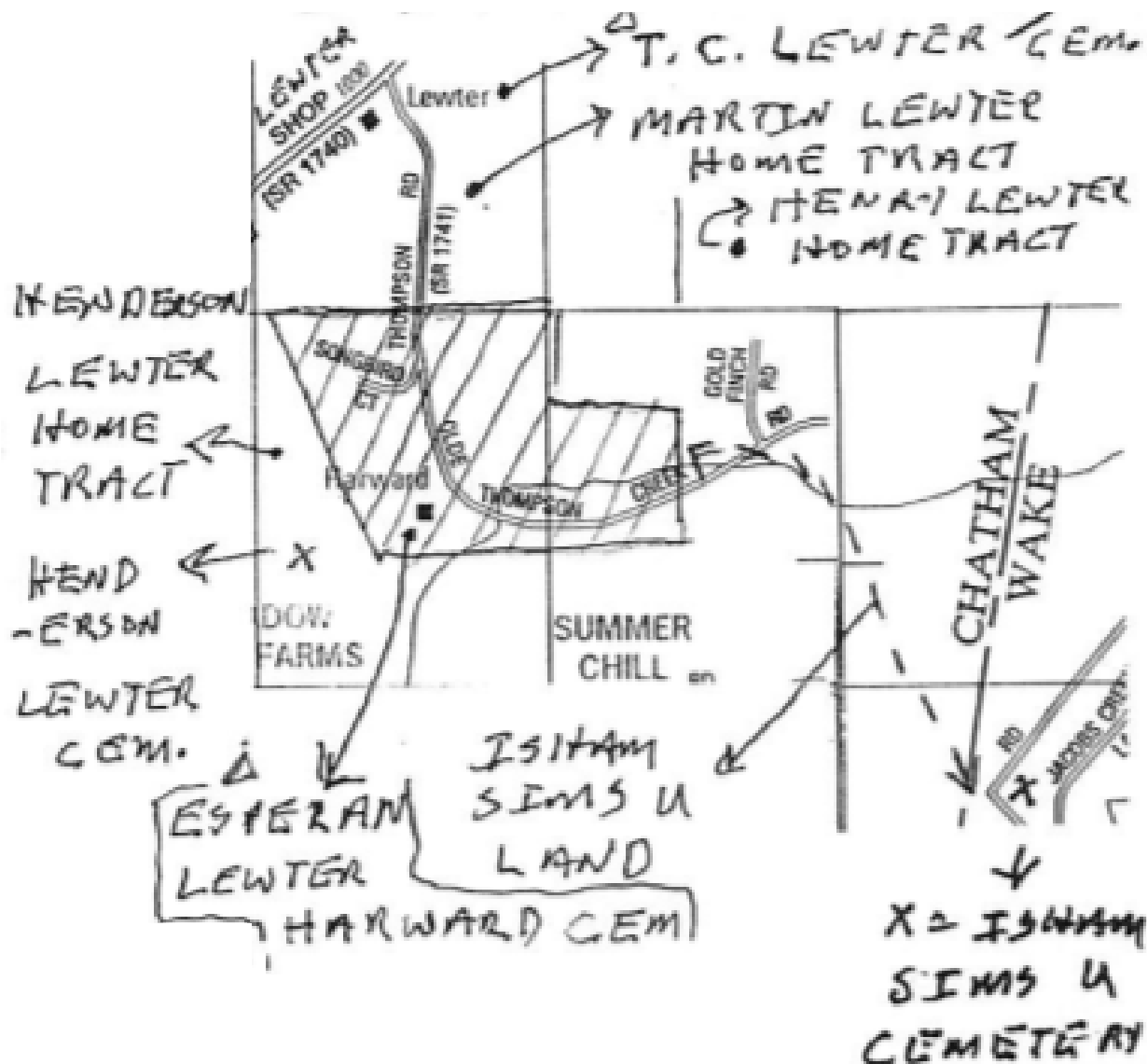

## I. Thomas Lewter

A. Hardy Lewter born about 1743 (VA) died < 1850 (Chatham Co, NC)

married about 1765 ( ) Rebecca Bunn died < 1840

Hardy gave the 76 acres to daughters Barbara and Mary. They to care for him and daughter Lucretia "Cissie". [See Page 82 Lewter Book by West

1. Elias Lewter born 1768 died circa 1815

married Sarah Wood, daughter of John Wood in Northampton Co, NC. See sketch which follows.

2. Henry Lewter born 1778 died circa 1828 in Chatham Co, NC

married Amelia (Miley) Kelly, daughter of Henry in Chatham Co, NC. See sketch. Henry and Amelia had 6 children including:

e. **Nancy Ann Lewter** born 1812 ( ) died 1855 ± 5

married 18XX ( ) Golden Almon Upchurch, Sr (son of Tabitha Upchurch)

They had 9 children including:

- i. Nancy Ann Rebecca Upchurch born Feb 1854 died 1936  
married about 1878 ( ) James Young
3. Thomas Lewter died 1832 in Orange Co, NC. Estate settled by his son, William H Lewter (Court Minutes Orange Co). See sketch.
4. Mary Lewter born 1785, Will 1875 Chatham Co, NC, never married
5. Exum Lewter aka Axum born 1793, married Sarah Ferrell, daughter of Joseph Ferrell of Orange Co, NC (Joseph Ferrell's will dated 7 Nov 1837, proved May Court 1838 Orange Co Wills)
6. Barbara Lewter born 1795 died 1861 in Chatham Co, NC, never married, aka Barbary
7. Martin Lewter born 1797 died before 1861 in Chatham Co, NC, married Peggy Bachelor
8. Lucretia Lewter (Crissie) born circa 1799 died after 1840 in Chatham Co, NC, never married

Barbara Lewter's will bequeathed her 1/2 of 76 acres to Cindy Kelly, Michael Kelly and Marthy Kelly but there is no record they took possession. Mary Lewter's will gives the 76 acres to Nancy Ann Rebecca Upchurch who lived in Wake. Actually, Mary bought Barbara's share from the executor of Barbara's will. Nancy A R (Upchurch) Young sold the 76 acres to S S Rogers who sold it to C M Hunt and W H Hunt. Last owner of the 76 acres tract were R G Thompson and wife, Beulah Ferrell. Martin Lewter purchased his tract from Hardy Lewter. Henderson Lewter farm now owned by Karen Biron, south of the 76 acres was the old Hughes Dairy Farm.