

DICKSON

DICKSON

○ EXCERPT FROM INDEX OF BOOK "THE GOODWIN FAMILY OF CENTRAL N.C." BY THOMAS JERRY GOODWIN, SR - 2009 RPU 24NOV2012. - NOTE: INDIVIDUALS LISTED AS MEMBERS OF THE _____ FAMILY - [WAKE/CHATHAM COUNTIES]

Dickson

Allie Irene 389, 659, 660
Elizabeth (Beth) Ann 658, 696
Katherine Elizabeth 389
Lulie Gillam 389, 661
Margaret Elva 389, 659
Patricia Lee 658, 696
Robert P. 389
William Pedigrew (Pat) 389, 658

ANNIE LAURIE DICKSON

PG-1

XID-4734

Wife of John William U, Jr of the Nathan U, I / Buster U Subclan - Wm Christian U, I

① See Note of RPU 25 FEB 1980 mit to Marie U (XID-1096)

Annie Laurie Dixon and John U, son of John William U of Nathan/Buster U clan. They moved to Arizona for John's health. He died of cancer at age 34. Annie still runs a candy and tobacco store in Phoenix, AZ. Before moving to Phoenix they lived in Lenoir, NC

② Address history. Annie Laurie Dixon lists herself under her late husband's name in the Phoenix AZ phone book

A. 29 APR 1975 + 29 SEP 1979

J. W. U

4118 East Jewell (Jewell)

Phoenix AZ 85008

Phone 955-3518 (Discontinued per operator
29 SEP 1979)

B New address on order for UB rec'd 21 FEB 1980

Mrs John William U

4409 North 56th St

Phoenix, AZ 85018.

③ On 17 AUG 1985 RPU called Annie Laurie Dickson in Phoenix, AZ 949-7280- Briefed her on mit to Honolulu an meeting with her sister-in-law Mary Teresa Soga. Annie Laurie says Wendell (Wendell) Brady is now retired - Her no = 266-2873 Annie has traveled to HI in recent years with her gr Nephew who is almost 16 & likes to play golf. She has just 2 grandsons The 2nd John is age 10. Annie still goes to work regularly but has a retreat at Pine Top AZ. Annie says Wendell has some reluctance to talk about the family. Annie & I agreed to get together. She wants to buy my "book" when it is completed. Annie's two dau live in Phoenix.

- ④ 14 MAY 1987 - Annie Laurie Dickson† called RPU at 2:15 PM from Phoenix (949-7280) and talked to SSU. She is going to England and would like instructions on how to get to Little Gidding. RPU called back in the evening. Annie will sponsor the trip and will be accompanied by her dau Billie & by her gr Norman who is going to Harvard this fall. They will go in July. Munkle has remained to Russell Swain. We had a nice long chat. I invited her to come down for a visit and she invited me to come up.
- ⑤ 10 AUG 1987 - RPU called Annie Laurie Dickson re her ltr of 4 AUG 87. She wants a full set of UB. I will mail same & send bill for \$99. Also I will send copies of 2 recent letters re England. They leave for England 23 AUG 87 and return 5 SEP 87.
- ⑥ 31 JAN 1996 - RPU called ALD† (First called the home 602-949-7280 & got a recording saying it was the Williams Residence (ALD later confirmed this is her number). Then called Upchurch Candy Co at 602-275-4029 & a man answered. He said the other company number was Annie Laurie's - 602-244-0451. She was in but on the phone. I called back later & talked to her. I proposed a visit 9-10 on for SAT 10 FEB 1996. She agreed & said we might go see Munkle (Weaver) (Grady) Swain. She will call Munkle. I will contact ALD† later to finalize the visit.

- ⑦ 5 FEB 96 - called Annie Laurie. She is still OK for SAT 10AM except may have to go to Pine Top. I will call again later in week. She mentioned taking me to lunch. She still lives at 4409 N. 56th St. & her home no. is still 949-72080
- ⑧ 10 FEB 1996 - visited with ALD in her home as planned. Had coffee. She was host for our group at lunch on Scottsdale Road. The group included Annie, her dau Billie Williams (nee Billie June W.) and a friend Peggy. Peggy's husband, who died a couple of years ago, was manager of a wholesale candy distubership in the Phoenix area. She and Annie are close friends. See separate notes re Billie and her comments about her son. Annie is very sharp and still very much in charge of the Uplunch Candy Co. They have four employees one of whom appears to be Billie. Annie asked how to get MC Barbeque. The meeting was very cordial. Annie asked for my address which I provided. When I left she gave me boxes of candy and some nuts. Annie reports that Δ Otis Richard Weaver, Sr. was a heavy consumer of alcohol and that he was mean when he was intoxicated.

(9) Obituary in Iti 13 SEP 2004 Garland Rudolph U, SI DR M

(Copy in Iti 3 JUN 2010 Winkler Frances
weaver & RPU: duplicate, discarded)

(10) Item in Iti 3 JUN 2010 Winkler Frances
weaver & RPU

Annie Laurie Upchurch, 90, of Phoenix passed away September 6, 2004. She and her husband John William Upchurch moved to Arizona from North Carolina in the early 50's and together founded Upchurch Candy Co. She went to the business regularly until June of last year. It is fitting that she left us on Labor Day after a life of many years of happily working. She was a gracious Southern lady remembered for her happy smile, loving and giving personality. She joined together the values of family and business. Her survivors include daughters, Patricia John Hoelle (Carl) and Billie Jeene Williams; grandsons, John Hoelle and Norman Williams; great-granddaughter, Lindsay Williams. Services will be held Saturday, September 11, 2004 at 3:00 pm, Green Acres Chapel of Light, 401 N. Hayden Rd. in Scottsdale.



DATA



Nov. 23, 19
 Mrs. John W. Upchurch of Raleigh, whose marriage was solemnized here yesterday in the Hayes Barton Baptist Church. She was formerly Miss Annie Laurie Dickson, daughter of Mr. and Mrs. Cecil Palmer Dickson of Raleigh.

⑥

-2-

Our farming operations is moving into a new phase. I have just bought a 278 Acre farm and will sell off 120 acres in 10 acre lots - this will be my activity in the real estate business. The rest of the farm I will operate myself using a hired operator. This means I have to buy a tractor and other farm equipment. My wife thinks I have lost my sense. My hired operator starts on 3/5/46 and I will go out and work with him for part of the day cutting down some trees. The rest of our land (1400 acres) is operated by farmer on shares and I don't have to do anything on it.

I trust all is well with you and yours as it is with our brood.

P.S. - please note the enclosed change of address sheet.

Phil U

⑥ sincerely yours
Phil Uphurch
[ROBERT PHILIP UPHURCH]

(7)

ANNIE LAURIE DICKSON

XID-4734

REC'D
1 JUL 1996

6/28/96

Dear Cousin Phil

First of all I want
to say how sorry I am
not to have written
before now to thank you
for the Hinsdale copy -

I enjoyed and read
it right away - brought
back memory - He ^{Hinsdale} - my
Dad and Buck Jones
were all Buddies - but
I was young and really
not as interested as later -
We enjoyed your ^{visit} and hope
you'll come again - Glad
to see you anytime
Annie Laurie
Pauze

⑧

ANNIE LAURIE DICKSON

XID-4734

MICHAEL ENTERPRISES
P. O. BOX 387
Wentzville, MO 63385



28 FEB 1996

A. L. UPCHURCH
4409 N. 56th ST.
PHOENIX, AZ 85018

Dear Cousin Annie Laurie,

A few minutes ago while having breakfast and reading the paper my subconscious, without logic, reminded me that I promised to send you a copy of the Hunsdale book - and had not done so. I rushed downstairs and promptly copied same which is enclosed herewith. I find this book (and all other such Wake Co/Raleigh items) fascinating. I have made a profile sheet for each person in the book - as shown by my mark A.

The Dodd-Hunsdale house was built for William Henry Dodd, Mayor of Raleigh, NC. He married Roxanna Margaret Upchurch "ROX". She was your husband's Great Aunt. Her sister Eleanor married a "MOX" named my Grandfather William George U "BILL". The daughter of this latter couple (Belle Williamson U) became the second wife of John Jones U, Sr - the key wealthy Upchurch in Florida - and on and on.

⑨

-2-

In later generations John Hrusdale Joslin married Margaret Elizabeth Wilson, daughter of my first cousin Frances Lane (Perry) Wilson. This was a short-lived marriage.

I would welcome any comment you might have about the Todd-Hrusdale house and those associated with it. I recall you said you had some knowledge about this situation. You could just jot down your thoughts - or talk and let Billie record - if the two of you would enjoy such an exercise.

Thank you again for the very lovely visit. I must learn not to make such visits so rushed.

😊

Sincerely yours
Phil Upchurch

[ROBERT PHILIP UPCHURCH]

(10)

ANNIE LAURIE DICKSON

XID-4734

MICHAEL ENTERPRISES
P. O. BOX 387
Wentzville, MO 63385



22 FEB 1996

A. L. WACHURCA
4409 N. 56th ST.
PHOENIX, AZ 85018

Dear Cousin Annie Laurie,

Since returning to Missouri I have been busily engaged in one project or another (such as tapes^{!*}). Just now I have finished processing my notes for the various stops on the trip to Arizona.

Thank you very much for having me in your home and for your hospitality. The lunch was very nice. I enjoyed meeting Peggy. It is great that the two of you enjoy doing things together. It was also a great pleasure to meet Billie again. I have written her a special note.

The candy and nuts were most welcome when I returned home. Sallaine always has to have her sweets so I arrived home a hero.

You asked about N.C. Bar-be-Que. I remembered that it had been advertised in The State magazine because we have ordered from Winston, NC as did our daughter last fall. I did not realize

(11)

2.

that Kings had not advertised in The State in 1995 and 1996. However, I kept thumbing back through the issue until I found the advertisement I remembered. It last appeared in DEC 1994. A quick call to the 800 number will tell you if they still ship. A copy of the advertisement is enclosed.

Thanks also for the newspaper article on chocolate. I have converted it to a 8 1/2 x 11" format so it can be put in my files easily. A copy is enclosed.

The day we winter was most enjoyable and it was a beautiful day. We are having a day or so of spring in Musawi now but can look forward to some more winter before spring arrives for good.

It is always great to visit with you and I hope you will drop by to see us in Musawi in due course.

☺ sincerely yours
Phil Yelovich

{ ROBERT PHILIP WENHORN }

Article given to RPA on 10 FEB 1996 by Annie Laurie Dickson
- From: The Arizona Republic / The Phoenix Gazette 10 ED 7 FEB 1996 Phoenix, AZ

Valley experts identify the top chocs

Chocolate,

[SEE PG 2 FOR
QUOTE FROM
BILLIE WILLIAMS
(nee BILLIE
JOVE W)]

[RE:
UPCHURN
CANDY CO.
PHOENIX,
AZ]

early and often

The wraps come off as experts name the best

By Barbara Yost
Staff writer

There may be people in the world who don't like chocolate, but I don't want to know them.

They probably kick dogs and run down little old ladies.

From all accounts, we have the Aztecs to thank for the food known variously as the elixir of the gods, an aphrodisiac and nature's perfect food. Christopher Columbus brought it back to the Spanish court from the New World in 1502. Spanish explorer Hernando Cortes discovered a cache of cocoa beans among Aztec nobility a few decades later.

Cortes conquered Mexico, and chocolate conquered Europe. After Spanish Princess Anne of Austria gave Louis XIII an engagement present of cocoa beans in the 17th century, Europeans finally had something to look forward to for dessert besides a plate of cheese.

Be honest. If you're stranded on a desert island, do you want to be there with rounds of Gouda or mounds of truffles? And if you're surrounded by chocolate truffles, do you really want to be rescued?

Whether chocolate is an aphrodisiac or whether it lives up to its reputation as a substitute for love is moot. Chocolate is its own reward. The smell, the taste, can bring a moment of contentment as no other food can.

Taste in chocolate varies wildly, depending on your palate and what part of the world you come from. Europeans prefer dark, bittersweet chocolate. Chances are, Americans who have sampled European ambrosia do,

too.

Belgians are considered the best chocolatiers in the world. Their candy is the gold standard.

In America, people on both coasts are hooked on dark chocolate. But Phoenix, a local chocolate broker says, "is a milk-chocolate town."

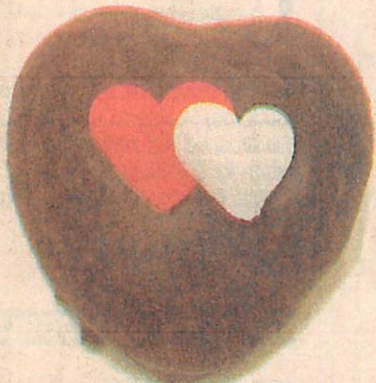

For the heart(s) of your heart, a chocolate-covered marshmallow version of the same from See's ... or perhaps a long-stemmed rose (edible variety) from AJ's.



“Unless you hit your winter visitors, people don’t know any better,” says Billie Williams of Upchurch, a Valley chocolate distributor. Upchurch supplies bulk chocolate wholesale to local candymakers and restaurants.

Milk chocolate has been cut with milk, making it sweeter and, Williams says, less pure than dark chocolate — also known as bittersweet or semisweet.

“It’s like whether you want your coffee straight, or your booze straight,” she says.

But, even in the Valley, “you still have people who appreciate the real thing.”

Upchurch deals in all brands of chocolate from around the world. The best European brands, Williams says, are Perugina from Italy, Lindt and Toblerone from Switzerland, Mackintosh and Rowntree from England and anything from Belgium.

In America, she says, the top brands are Nestlé, Ethel M (a Las Vegas brand from M&M/Mars), Price (out of Kansas City, Mo.), Guittard and Ghirardelli (California).

Surprisingly, Williams calls gold-bound Godiva chocolate “common, common, common.”

“It’s superhard, it has no taste and it’s not as creamy,” she says.

And don’t even mention the chocolates at the bottom of the food chain — Whitman’s, Brach.

How to tell premium chocolate? Williams and her colleagues have the definitive test:

- It should have a rich chocolate fragrance. If it doesn’t smell like good chocolate, don’t put it in your mouth.
- It should have a strong chocolate taste immediately.
- It instantly should melt in the mouth — and in the hand.
- It should be creamy, with no hint of granulation or waxiness.

And, as every chocolate lover knows, it should make you feel good.

One of the tragedies for Valley chocolate eaters is our weather, says Judy Kubinski, owner of Jus’ Chocolate, a custom-order chocolate business in Fountain Hills.

Kubinski, whose hands are still raw from molding and wrapping 1,500 little chocolate footballs for the Super Bowl Host Committee, says chocolate is seasonal. Business booms around Valentine’s Day, Easter and Christmas, and falls 90 percent in the summer.

MOLE POBLANO DE POLLO (CHILE-CHOCOLATE SAUCE FOR CHICKEN)

(From *The Great American Chocolate Contest Cookbook*)

- 1/4 cup lard or solid vegetable shortening (lard is authentic to the traditional dish)
- 2 tablespoons crushed red-pepper flakes
- 6 boneless, skinless chicken breast halves (about 2 pounds)
- 3 cups homemade or canned chicken broth, divided
- 4 corn tortillas (7 to 8 inches in diameter), cut into small pieces
- 1/4 cup tomato sauce
- 1/4 cup minced onion
- 4 cloves garlic, finely minced
- 1 tablespoon unsweetened cocoa, or more to taste
- 1 tablespoon raisins
- 1 tablespoon chopped almonds or walnuts
- 1 tablespoon sesame seeds
- 1 tablespoon shelled pumpkin seeds
- 1 tablespoon peanut butter or chopped peanuts
- 1-1/2 teaspoons granulated sugar
- 1-1/2 teaspoons dried oregano leaves, crushed
- 1/2 teaspoon aniseed
- 1/4 teaspoon ground cinnamon
- 1/4 teaspoon ground nutmeg
- 1/4 teaspoon ground allspice
- 1/4 teaspoon ground ginger
- 1/4 teaspoon ground cumin

Optional garnishes:

- Fresh cilantro sprigs
- 6 ounces semisweet chocolate, melted

To make the chile-chocolate sauce: Preheat the oven to 325 degrees.

Heat the lard in a large skillet over moderate heat until melted. Stir in the crushed red-pepper flakes and saute for 1 minute.

Add the chicken breasts and lightly

brown each side. Remove from the pan and set aside. Using a strainer, remove any remaining crushed red pepper from the lard in the skillet. Reserve the red pepper for later use.

Add 2 cups of the chicken broth to the skillet. Stir in the remaining ingredients except for the optional garnishes and 1 cup chicken broth and reserved red pepper. Heat the mixture to boiling, then reduce the heat, cover, and simmer, stirring occasionally, for 30 minutes. Remove from the heat and set aside to cool.

Pour a small amount of the cooled sauce into a food processor or blender and puree on high speed until the mixture is fairly smooth. Repeat with the remaining sauce.

To prepare the chicken: Combine the pureed sauce and the remaining 1 cup chicken broth in the prepared baking dish and mix well. Add the browned chicken breasts in a single layer, turning them over to coat each side well with the sauce. Sprinkle the breasts with the reserved crushed red pepper.

Bake for 20 to 25 minutes, or until the chicken is tender and the juices run clear when pierced with a fork.

Serve with a garnish of fresh cilantro sprigs or melted chocolate spooned on the side if desired.

Note: You must try this with spoonfuls of melted semisweet chocolate on the side. Either mix the chocolate into your serving, or dip forkfuls of the dish into the chocolate.

Makes 6 main-dish servings.

Approximate values per serving: 563 calories, 28 g fat, 111 mg cholesterol, 35 g carbohydrates, 235 mg sodium, 44 percent calories from fat.

Pouring it on

At the Coyote Springs Brewing Co., which once commissioned a local candymaker to fashion a beer-flavored chocolate, customers can try another innovative item — beer-flavored cheesecake, which comes in a chocolate version.

If you’re looking for other creative ways to incorporate chocolate into your daily menu, try it in:

- Waffles
- Pancakes
- Dumplings
- Chicken casserole? Chicken in a mole (chocolate) sauce is a classic Mexican favorite.

Jus' Chocolate opened in 1983, after Kubinski decided to turn her cooking skills into an enterprise.

She had just finished an apprenticeship as the candymaker for Oscar Taylor restaurant, turning out 123 varieties of truffles, creams, barks and novelty items. From her own commercial kitchen, she then supplied Oscar Taylor's bakery, the Upper Crust, with chocolate dessert shells.

Kubinski took that knowledge and put it into her shop, where vats of melted chocolate are whirring constantly and tiny red squares of foil swirl around her workstation waiting to wrap chocolate hearts.

Much of her business is in commercial products, like the Super Bowl footballs.

"I'm a custom-order person and a niche filler," she says.

Kubinski can turn out almost any company logo or product in chocolate and will cast any item as long as it has clean, simple lines.

A golf company ordered 1,500 white-chocolate golf balls wrapped in gold foil and packed in shag buckets.

One of Kubinski's strangest requests came from the Coyote Springs Brewing Co. in Phoenix — chocolate with beer inside. When filling a chocolate mold with liquid beer proved impossible, she developed a beer-flavored truffle that pleased her clients.

"I don't drink beer, but I tasted them with people who like beer, and they thought they were pretty good," she says.

Among Kubinski's Valentine's Day novelty items is a chocolate teddy bear dressed in a red satin teddy. In milk chocolate, white chocolate and semisweet, it sells for \$25.

Jus' Chocolate retail items are available at the Desert Kettle in Fountain Hills.

Like the people at Upchurch, Kubinski prefers dark chocolate to milk. That's the preference of the sophisticated palate, she says. What makes one brand different from another is its formula.

The best formulas contain a lot of cocoa butter, melt quickly and are free of tropical oils (such as coconut oil), which gives chocolate a waxy aftertaste.

One of Kubinski's specialties is her assortment of chocolate-dipped buttercreams in distinctive Southwest flavors — prickly pear, citrus and jalapeño. The last is tart but not hot. She also sells such classics as raspberry and vanilla creams.

Something new from Lovebud's: Red-foil-wrapped lips give "chocolate kiss" a whole new meaning. Something old from Walgreens: A classic Whitman's Sampler brings back memories. A Valentine's basket filled with assorted candies comes from Cereta's, and Godiva offers a Coeur de Lait milk-chocolate heart and chocolate-dipped chocolate-hazelnut biscotti.

CHOCOLATE WAFFLES WITH FRESH BERRY SAUCE

Waffles:

- 1 cup unbleached all-purpose flour
- 1 cup whole-wheat flour
- 1/2 cup unsweetened cocoa powder, sifted
- 1/2 cup sugar
- 1 teaspoon ground cinnamon
- 2 teaspoons baking powder
- 1/2 teaspoon salt
- 1 cup non-fat milk
- 1/4 cup canola or corn oil
- 1 tablespoon vanilla extract
- 3 egg whites, beaten until stiff but not dry

Strawberries, for garnish (optional)

Berry Sauce:

- 3/4 pound fresh or thawed frozen raspberries, pureed
- 3/4 pound fresh or thawed frozen strawberries
- 2 tablespoons sugar

To make the waffles, combine flours, cocoa powder, sugar, cinnamon, baking powder and salt and mix well. Set aside.

In a separate bowl, combine milk,

oil, and vanilla; mix well and add to the dry mixture. Again mix well. Fold in beaten egg whites, just until blended.



Preheat a waffle iron coated with non-stick vegetable spray. Pour 1/2 cup waffle batter into the center of the hot iron and bake about 6 minutes, or until waffle is crisp. Bake the remaining batter, keeping waffles warm in a covered dish in a 250-degree Fahrenheit oven.

Makes 6 waffles.

To make the sauce, strain raspberry puree to remove seeds, then combine with strawberries and sugar and mix well.

Approximate values per waffle: 348 calories, 11 g fat, 1 mg cholesterol, 415 mg sodium, 28 percent calories from fat. Each tablespoon of sauce contains approximately 11 calories; no cholesterol; no fat; trace sodium.

BLACK FOREST BRUNCH PANCAKES

(From The Great American Chocolate Contest Cookbook)

- 1-1/2 cups all-purpose flour
- 1/2 cup instant chocolate milk powder or sweetened cocoa mix
- 2 tablespoons baking powder
- 1/4 teaspoon instant coffee granules
- 2 large eggs or equivalent egg substitute
- 1 cup milk
- 1/4 cup unsalted butter or margarine, melted

Toppings:

- 2 cups cherry pie filling
- Confectioners' sugar to taste

In a large bowl, stir together the flour, chocolate milk powder, baking powder, and instant coffee.

In a separate bowl, beat the eggs until lemon-colored and light in texture (about 2 to 3 minutes). Add the milk to the eggs and beat again.

Pour the milk and egg mixture into

the dry ingredients and blend until smooth. Stir in the melted butter.

Heat the greased griddle or frying pan over medium-high heat. The griddle is hot enough when a few drops of cold water sprinkled on the griddle bounce and sputter. Ladle large spoonfuls of the batter onto the surface and cook for 2 to 3 minutes. Turn over and cook for about 2 minutes more.

Top the cooked pancakes with the cherry pie filling and sprinkle with confectioners' sugar.

Variation: Substitute another type of fruit for the cherries.

Makes 4 servings.

Approximate values per serving: 570 calories, 10 g fat, 146 mg cholesterol, 89 g carbohydrates, 329 mg sodium, 15 percent calories from fat.



Chocolates are best served at room temperature.

"It's like wine," Kubinski says. "The bouquet is better. The mouth feel is better. The whole experience is better."

The Glendale Chocolate Affaire: Festival of Chocolate and Romance will be held Friday through Sunday in Murphy Park. Chocolatiers will showcase their temptations, kids can make chocolate pizza, and Arizona wines and a Chocolate Sculpture Contest will be showcased at the free event. For information, call 833-7150.

Magazine spills the beans

In its February issue, *Consumer Reports* rates boxed chocolates. Its rankings, from best to worst:

Burdick — "Most chocolatey chocolate, (the bitter chocolate) may be an acquired taste."

Godiva — "Fast-melting, smooth, but not always deemed fresh."

Teuscher — "Presented beautifully . . . smooth, fast-melting."

Fannie May — "Fresh, natural-tasting fillings."

See's — "Firm, fresh-tasting fillings."

Neuhaus — "The chocolate . . . is only average, and the fillings are not very flavorful."

Perugina — "Thick, hard chocolate that is slightly waxy and slow to melt."

Karl Bissinger — "Chocolate is generally better than the sweet fillings."

Russell Stover — "Chocolate is average, the fillings . . . more sweet than flavorful."

Whitman's — "The least chocolatey chocolate . . . candies are slow to melt, with firm fillings that aren't very flavorful."

Price's — "Less chocolatey than most, with fillings that are much more sweet than flavorful."

Valley venues

In addition to the fanciest Valentine's chocolate gifts, here are some sweet treats from shops around the Valley:

See's: Valentine's Calf Box (also available in Panda Box), candy assortment, \$3.80.

Decorated marshmallow heart, 50 cents.

AJ's: Chocolate long-stemmed rose, \$2.99.

Perugina chocolates, 5 ounces, \$7.79.

Allen Wertz 4-ounce assortment, \$4.79.

Godet Belgian white chocolate liqueur, 50 milliliters, \$2.99.

Godiva: Valentine box, four pieces, \$6.

Coeur de Lait milk-chocolate heart, \$3.

Chocolate-dipped chocolate-hazelnut biscotti, \$2.25.

Lovebud's Fine Chocolates (6990 E. Shea Blvd., Scottsdale): Red-foil-wrapped chocolate lips, \$4.95.

Chocolate-dipped strawberries, \$1.95 per pound.

Valentine's mug (\$4.95) filled with chocolate lollipops (\$1.75 and 75 cents).

Walgreens: Russell Stover Valentine's satin box, 8-ounce assortment, \$4.95.

Classic Whitman's Sampler, four pieces, 79 cents.

Clara Stover marshmallow or strawberry cream heart, 50 cents.

Cerreta's (5345 E. Glendale Ave., Glendale):

Valentine's basket, filled with assorted chocolates, \$5.50.

Chocolate teddy bear, \$1.99.

Sugar-free chocolates, \$6.50 per pound.

CHOCOLATE DOUBLE DUMPLINGS

(From *The Great American Chocolate Contest Cookbook*)

Dumpling Dough:

- 1 cup all-purpose flour
- 1/2 teaspoon salt
- 1/4 cup unsweetened cocoa
- 1/2 cup granulated sugar
- 1-1/4 teaspoons baking powder
- 1/2 cup minus 1 tablespoon half-and-half
- 3 tablespoons margarine, melted
- 1/2 cup semisweet chocolate chips
- 1/2 chopped pecans

Chocolate Sauce:
3/4 cup granulated sugar
1/3 cup unsweetened cocoa
1/8 teaspoon salt
3 cups half-and-half
1/2 cup unsalted butter or margarine, melted

Garnish:
1 teaspoon vanilla extract
Fresh whipped cream

To make the dumpling dough: Preheat the oven to 375 degrees. In a medium bowl, combine the flour, salt, cocoa, sugar and baking powder and mix well.

In a small bowl, combine the

half-and-half and melted margarine and stir all at once into the flour mixture, making a soft dough. Stir in the chocolate chips and pecans. Set aside.

To make the sauce: In a large heavy-bottomed saucepan, combine the sugar, cocoa and salt and mix well. Over moderate heat, gradually stir in the half-and-half until the mixture is smooth. Add the butter and bring to a boil, stirring often. Allow the mixture to boil about 3 minutes, stirring constantly.

Remove it from the heat, stir in the vanilla, and pour into the baking dish.

Drop the dumpling dough by heaping tablespoons into the baking dish on top of the sauce. Bake for 30 minutes. Serve the dumplings and sauce warm with whipped cream.

Makes 8 to 10 servings.

Approximate values per serving: 480 calories, 30 g fat, 56 mg cholesterol, 46 g carbohydrates, 232 mg sodium, 57 percent calories from fat.

Short and sweet

• The Aztecs worshipped the god Quetzalcoatl as the provider of *xocolatl* — chocolate.

• Cacao trees have grown for more than 4,000 years in Central America.

• Chocolate was first a beverage, then a food. Montezuma drank his chocolate honeyed and spiced. Spanish women added pepper and other spices.

• Chocolate arrived in the American Colonies in 1755.

• White chocolate is not really chocolate because it contains no chocolate liquor. It is primarily made of cocoa butter.

• People who are lactose-intolerant or do not eat animal products can find dairy-free chocolates at some health-food stores and from People for the Ethical Treatment of Animals by calling (301) 770-8978.

• Diabetics can find sugar-free chocolates at many outlets. The candy is not low in calories, however, and can cause intestinal cramping if eaten in large quantities.

• The fat in chocolate does not raise blood-cholesterol levels.

• In a survey conducted by a women's magazine, 70 percent of female respondents said they would rather have chocolate than sex, according to the Chocolate Manufacturers Association.

• Women prefer their chocolate as candy, ice cream and fudge topping. Men like chocolate-cream pie and chocolate cake.

• Chocolate is extremely sensitive to odors and flavors. Take care to keep it away from smoke and other odors. Seal well when storing in the refrigerator to preserve its taste and guard against moisture.

• Bulk chocolate without nuts has a shelf life of about eight months when stored properly. With nuts, it will store about six months.

• Chocolate is a health danger to dogs. Never feed pets chocolate.

(16) ANNIE LAURIE DICKSON XID-4734

Upchurch
CANDY COMPANY

REC'D
3 APR 1991

914 NORTH 24th STREET PHOENIX, ARIZONA 85008 (602) 244-0451, 275-4029

MAR 19

TO: _____

FROM: _____

RE:

I thought you might be interested
in another Upchurch (the enclosed
card) a young lady Mary Upchurch
Adams I met at the Fancy Ford Show
in Calif - This month - she seemed
quite interested in the Upchurch clan -
Just you are well - and wish I had
more time to visit - Sincerely -
Annie Laurie

needed
to see
6 APR 1991

(17)

ANNIE LAURIE DICKSON

XID-4734

Upchurch

CANDY COMPANY

914 NORTH 24th STREET

PHOENIX, ARIZONA 85008

602-244-0451 • 602-275-4029

Hi!

Enjoying Reading! - letters
are great! Thanks a
million - will call you
upon our return -

Rec'd 17 AUG 1987 ck for Annie Laurie
\$99 signed 14. AUG 87
A.L. Upchurch

A.L. Upchurch
4409 N. 56th St
Phoenix, AZ 85018

put on card + list

After 5 days, return to
Upchurch Candy Co.
Wholesale
914 N. 24th Street
Phoenix, Arizona 85008-6085

(18)

ANNIE LAURIE DICKSON

XFD-4734

MICHAEL ENTERPRISES

P. O. BOX 35804
TUCSON, ARIZONA 85740

6 APR 1991

A. L. UPCHURCH
4409 N. 56th St.
PHOENIX, AZ 85018

Dear Cousin Annie Laurie,

Thanks so much for the tip about Mary Upchurch Adams of Watsonville, CA. I have searched my files and cannot find her. Have now written her a note and will hope to get a reply. I am always excited about new contacts such as this because they usually bring in a flood of new information from a different vantage point.

I thank you often and especially when I am traveling to Phoenix. Have made several trips up in the last several months but just for the day and often with someone. Life seems to be overly full for all of us. Still, I do hope we can visit again before too long. Let me know if you get to Tucson.

All the Best!

Sincerely yours
Phil Upchurch

[ROBERT PHILIP UPCHURCH]

Rec'd
5 AUG 87

11 AUG 87

SSU
send full
set of Bulletin
& invoice for
\$99 RPL
Jane

Aug 4, 87

Dear Cousin Phil:
Thanks so much for your
letter with all the information.
We plan to use it for Upchurch
and Giddin - Under separate
cover I'm sending you a N.Y.
Newspaper clipping about a pick
up at Nat. Airport - I'm probably
know him - I don't - that I know of.
We are leaving the 22 of Aug. Will
be in London first then on to Scot.

2.

St. Andrew and Glasgow
where Norman will play
back on old courses while
our room over looks -
Did you go to the Charter
House Square? Office of
the Society of Genealogists?
I since I'm such an
amateur maybe it would
not be wise to take the
time - the office is close
to St. Pauls Cathedral -
We are staying at the
Placidia Hotel in London,
Plan to take a walk from
there -

3.

Also we are stopping over -
couple of days in Isle
of Man - Norman's Great
Grandmother Isabella Rose
Came from there (on father's
side)
we want to find out if the
Giant Water wheel was named
for her -

I am getting very excited
over the trip - If you think
of anything else of interest
please let me know - Also
be sure and send me all of news
"the Upchurch Bulletin" - I
missed mine ~~or~~ loaned
to some one - Send me a pic -
Thank you again - Sincerely,
Scott! "Bonnie" Amington

Upchurch
914 N. 24th St
Phoenix, AZ 85008

20

ANNIE LAURIE DICKSON

XID-4734

August 11, 1987

Mrs. John W. Upchurch
914 N. 24th Street
Phoenix, Arizona 85008

Dear Annie Laurie:

Today we sent to you by UPS all copies of UPCHURCH BULLETIN
as shown on the enclosed invoice.

Also, attached hereto you will find some additional
* letters which Phil requested be sent to you.

We hope you will have a great vacation in England!

Bon Voyage!

Sincerely yours,

Sallaine Upchurch

Attachments

- * Ltr re visit to Upchurch in England Alan Marshall
McCree, Jr to RPU dated 4/4/87
- + Ltr re visit to Little Gidding in England - Boyd
Bradfield II to RPU dated 14 JUL 1987

(22)

ANNIE LAURIE DICKSON XID-4734

21 JUN 1937

MRS JOHN W. UPCHURCH
4409 NORTH 56TH STREET
PHOENIX, AZ 85018

Dear Cousin Annie Laurie,

My notes from our 11 MAY 1937 phone conversation indicate that you and Billie and Norman will be making your trip to England in July. I had hoped to develop a paper map for you but other things have claimed my time. In hopes of getting something to you in time I will send this note and hope that it helps.

I understand you were considering visiting the village of Upchurch and/or Little Gidding. If you have to make a choice let me encourage you to select Little Gidding as it has far more known connection with the Upchurch family than the village of Upchurch.

The Upchurch village is located in KENT on the Thames River or just south of same. The village does have a very old church dating from about 1200. There are no Upchurch families living in the area now and I have never seen documentation that they ever lived there - although the fact

That the village ⁽²³⁾ is named Upchurch implies that a family of that name lived in the vicinity at one time or another.

We do know that members of our family were living in the community surrounding Little Gidding starting as early as the late 1500's and probably before they were prominent (ministers, business people, land owners, etc) all during the 1600's and 1700's and so there today. We know that our ancestor Michael II left Little Gidding in 1649 and came to America leaving his father there at Little Gidding. We don't know what role Michael or his father played at Little Gidding. I will have an article in the Upchurch Bulletin in due course speculating on this.

Little Gidding is about 50-70 miles northeast of London proper. When I went there on 24 MAY 1979 I rented a car at Heathrow Airport and drove across North London traveling 104 miles and taking 4 hours and 15 minutes to get there. This took me up M-1 (M-1 = like an interstate highway), then to A-10 then to A-14 then to A-1 then turn west off of A-1 on B660 towards Gladon and Great Gidding. When you get to Great Gidding turn left to go to Little Gidding. Little Gidding is a mile or so

(24)

out of Great Gidding. You have to go down a farm lane to get to Little Gidding as it is about $\frac{1}{4}$ - $\frac{1}{2}$ mile off the road from Great Gidding. In returning to London I took a somewhat more westward route and traveled 98 miles taking 2 hr and 40 minutes. Unfortunately on the way back I did not record the routes or towns. On the way up I went through Raynton, Claxton, and Godmanchester. I know all of this is confusing but you really can get there by car.

Some talking to you I have received a letter from our cousin James Russell Yable who went to Little Gidding last fall. They took the train and taxi. An excerpt from their letter is enclosed in case you want to go by train.

I am anxious to learn about your trip to Little Gidding. If you have a chance to call me before you start your trip or to come down to Tucson please do so. Otherwise I will hope to see you when you get back.

Sincerely yours
Phil Upchurch

[ROBERT PHILIP UPCHURCH]

(25)

ANNIE LAURIE ^{DICKSON}
~~DIXON~~

XID-4734

Upchurch

CANDY COMPANY

914 NORTH 24th STREET

PHOENIX, ARIZONA 85008

(602) 244-0451, 275-4029

8.29.80

Enjoyed your letter very much!
Quite a surprise!
Would have answered before
now but was out of town.

TO:

Dear Cousin Phillip: Sorry I

FROM:

Missed you, be sure and see if

RE:

I am at home next time 949-7280
4409 N. 56th St. That's just a short
block from Camelback Rd - in a cul-
de-sac - S.E. corner - has a black
gate at entrance. Would love to meet
you - have enjoyed the Bulletin and
have shared them with my niece who
lives here in town, she's Marie's
daughter from Cal. U.C. Looking forward to
meeting you,
Annie Laurie

REPLY:

(26)

MRS JOHN W. UPCHURCH
4409 NORTH 56TH STREET
PHOENIX, AZ 85018

7 SEP 1980

Dear Annie Laurie,

Thanks for your nice note of 29 AUG 1980.
The leads you provided giving me the
names of the two granddaughters of John
Jordan Upchurch have been quite useful.

This week-end we are assembling
Issue 3 of Upchurch Bulletin Volume 1 so it
should be in the mail in a few days.

My schedule for traveling to Phoenix
is somewhat uncertain at present but
I am sure to have several tapes up
this fall. I'll be certain to give you
a call on one of the tapes to see if
it is convenient to come by. Thanks
for the invitation.

Sincerely yours
Phil Upchurch

{ROBERT PHILLIP UPCHURCH}

(27)

ANNIE LAURIE DICKSON.

XFD - ~~177~~
4734

19 OCT 1980

MRS JOHN W. UPCHURCH
4409 NORTH 56TH STREET
PHOENIX, AZ 85018

Dear Annie Laurie,

This is just a note to thank you for having me in your home for a visit last Wednesday night. I thoroughly enjoyed the visit with you and Billie and only wish that we could have had more time. As it was you were kind to allow the talk to run late into the evening.

Since returning to Tucson I have spent several hours entering the material collected into the files. There are still many points that need clarification. On another visit perhaps I can see you and Billie again and also meet Winkle Brady.

I trust you had a nice visit to Pine Top and that your cabin is progressing well.

Sincerely yours
Phil Upchurch
[ROBERT PHILIP UPCHURCH]

(28)

ANNIE LAURIE ~~DIXON~~
DICKSON

XID-4734

MRS JOHN WILLIAM UPCHURCH
4407 NORTH 56TH STREET
PHOENIX, AZ 85018

21 FEB 1980

Dear Mrs Upchurch

This is to acknowledge receipt of your order for a one year subscription to Upchurch Bulletin and of your \$10.⁰⁰ check in payment for same. Today I took issue on to the printer so we should mail it about March 1, 1980.

Provided herewith are some extra flyers in case you know of anyone who would be interested.

I hope you will like Upchurch Bulletin.

Sincerely yours
Phil Upchurch

[ROBERT PHILLIP UPCHURCH]

ANNIE LAURIE ~~DIXON~~ ^{DICKSON}

XID-4734

(30)

Upchurch

CANDY COMPANY

914 NORTH 24th STREET

PHOENIX, ARIZONA 85008

(602) 244-0451, 275-4029

TO: _____

FROM: _____

RE: _____

7-11-80

[NEE NELLIE MAY SMALL]

I came across Nellie Graff at } ^{1M}
 Pine top last week (P.O. Box 294 } ^{AF}
 who is a former Upchurch - Her sister }
 Phyllis Ciimmupatte - lives in Tucson -
 1040 Schaefer Drive }
 Tucson, Az. 85705 }

IN TUCSON JUL 1974 PHONE BKS
 CIMMIYOTTI, VERN O.
 1040 W. SCHAFFER DR.
 887-1345

REPLY:

Nellie works at the Round House Resort at
 Pine top Country Club - thought you might contact
 them - she told me a few interesting things about
 the Upchurch - Annie Laurie

Upchurch Candy Co.
 914 N. 24th St.
 Phoenix, Ariz. 85008



Michael Enterprises
 P.O. Box 35804
 Tucson, Az. 85740

31

ANNIE LAURIE DICKSON

XID - 4734

Visit to her home 15 OCT 1980

8:30 PM - 11:30 PM - Her dau Billie
Present

733

Ran meat market - Raleigh City Mkt

1097

A nurse - Rex Hosp
~~Attn~~

1098 - Emily
~~Attn~~

1099 -

md

800

b 15 OCT 1869

1093

b 15 JUN 1905

~~4748~~ 4748. Not Leta was Meta Eleanor U

b 17 NOV 1879

she died & was bur in Gainesville FL?
about 1944

Her son was with Gainesville Newspaper

~~4744~~ 4744

Wright Elbert U

b 29 MAY 1882

733 Henry Dodd U

b 15 AUG 1883

734

b 7 DEC 1889

1095

Charles David U

b 11 MAR 1885

~~4747~~ 4747

Eva ~~Margaret~~ Marguarite

b 20 SEP 1891

1096

Marie Thayer

b 29 JUL 1894

1094
b 7 AUG 1897

The above is little but ^{info} entered in
memory by Eddera Kendall Wright
original Billie furnished in name in
Rhumbatta.

1101
has son Richard Grady name at NAAI

4744
has son who is fr & lives in
HI

1093
20 MAY 1971
md 26 NOV 1937 Dayer Burden Byst Cl
Raleigh, NC.
& Phoenix AZ

(Billie)

4735- Patricia John H
b 2 OCT 1938
md Dr Carl Noelle
6545 N. 18th St
Phoenix, AZ 85012
→ son = John Carl Noelle
b 8 JAN 1975

4736

4757

works for Tax Dept Richmond VA

4758

works for VEPCO

4739

[CHARLES DOWD U, JR]

war in WWII Battle of Bulge
injured - never the same afterward

(Mink lives here in Phoenix)

4736 Billie

b 8 OCT 1943

md 14 FEB 1969 (Mexico) ^{hus} Norman Roy Williams.

son Norman Roy Williams II 19 NOV 1969

(Speaks about her war --- hence
they must be his, sep or he is dead?)

4741

(ANN U.)

md Paul

- children 1.
- 2.
- 3.

Johnnie & Annie Jane

lived in Raleigh 2 1/2 yrs (Stanhope Ave in Hayes Barton)

then in Laurelburg 11 yrs

then to Phoenix in 1952

(left NC in 1951 around Phoenix 1952)

married her for her health.

Annie Jane only saw Rambratto in
the 2 1/2 years they lived in Raleigh

Annie Jane lived near Josephine Daniels home
in Raleigh. She ran over one of his plants

Home 607 North Blount St

Judge W. C. Harris Obituary

Supreme Court Judge died TVE at Rex Hosp
age 68 25 yrs on Supreme Court Bench
b 18 AUG 1886

attended UNC graduated in law 1909
mrs Juliet Crease 8 NOV 1911 - 2 children

- ① W. C. Harris
- ② Mrs A. S. Bridges

→ [MARGARET U XED 1099, DAUGHTER OF HENRY DODD U ? - RPW]

Margaret's name = Wallace Alfred

Mrs Harris Obituary - [FLORENCE CAROLINE U]

Died at home of son Mrs Charles C Johnson
90 yrs old - date of W. C. U.
14 children

Judge W. C. Harris of Raleigh
Widow R. Harris - Mgr Ed Norfolk
Virginia Pilot

- C. D. Harris of Louisa KY
- Charles U. Harris of Raleigh
- Lt - Comdr J. H. Harris USN Norfolk
- Gordon P. Harris Albany NY
- L. S. Harris of Wash DC former
head of State Notes Fed. Res. N.C.
- Mrs Charles C Johnson Raleigh
- Mrs M. W. Crocker of Columbus OH

Address (she may be dead now)

Mrs Eva M. Jones
3204 Hanover Ave Apt C
Richmond 21 VA

Obit Rexie Ann ~~Crease~~ Dodd

82 yrs old.
William Clinton U - for 65 yrs a merchant
at 16 E. Hargett St died at residence
107 S. Wilmington St at age 93

There is a James U in Phoenix who is much in debt. Annie Fawne thinks he must have left by now

20 MAR 1955 Its from Marie concerning Wright A. U = .46 the most [WRIGHT ALBERT UJR]

He was a Quartermaster Ship fitter at U.S. Shipyard at Pearl Harbor

He has been there since 1934 when he left Mary 2nd time. He was 1933. He was here in 1930

His oldest son - Caroline 20 yrs

Wright Ernest - 18 yrs

James Franklin 16 yrs

Raheta Fawne 11 yrs

Mary W. wife is 42 yrs

very pretty

Wright has 2 horses

Wright has sister Hilda U

and in New Orleans

Wright had older sister

Eldon died leaving an

inheritance was 18 yrs old.

His mother still in New Orleans

Annie Fawne says her parents did not want her to marry Johnny U (John William U, Jr). She was supposed to be in the minister study or the equivalent without attendants.

Annie Fawne says her father could not stay sober but he always thought grass was greener on the other side of the fence. He moved about a great deal.

He would reach a low point and then become back financially. He had a wholesale business and sold to John William U Jr. She says John Sr could not stay sober either. Her son and her father-in-law would drink together from a bottle under the counter.

At one time Annie Laurie had her mother & father with her in Phoenix. The mother stayed in her home and the father in a rent home as they were divorced. Annie Laurie would periodically take a bottle to her father and leave this at the desk.

Annie Laurie has a story about the U's & the Wright's in the handwriting of Eleanor Kendall (Wright) Upchurch. The Wrights and she came from SC.

Annie Laurie has some pictures of the Upchurches.

Directions on how to get to home of Annie Laurie in Phoenix, AZ

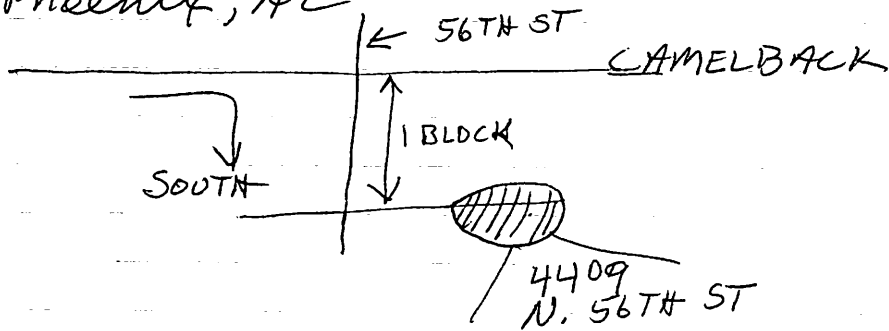

Annie Laurie tried to contact Winable Brady but could not make contact for her to be present on 15 OCT 1980 visit

Belle says proper spelling is DICKSON not Dupes.

John Williams Jr said once before he met Annie Laurie. His 1st wife was from Rocky Mt. & name was Grace Barnes. Her name was always wrong about this one. He paid for her to take her name back. There was no issue

ANNIE LAURIE ~~DIXON~~
DICKSON

XID-4734

(37)

MICHAEL ENTERPRISES

P. O. Box 35804
Tucson, Arizona 85740

20 JUL 1980

MRS JOHN W. UPCHURCH
4409 NORTH 56TH STREET
PHOENIX, AZ 85018

Dear Annie Laurie,

How nice of you to send me the addresses
of Nellie Graff and Phyllis Annunzio. I have written
to Nellie and talked to Phyllis by phone. Phyllis
has a copy of the rare autobiography of her
grandfather John Jordan U, a famous Upchurch. She
is bringing it to my office Tuesday and will
loan it to me. It will be extracted for a
future issue of Upchurch Bulletin. It is quite
a coincidence that I spent 1 1/2 hours in
St Louis on 13 JUL 80 looking for the gravesite
of John Jordan U. My son-in-law there has
since found the exact site and my wife and
I will be there in mid-August so I can take
a picture for publication in U B.

your husband and I were related as follows:

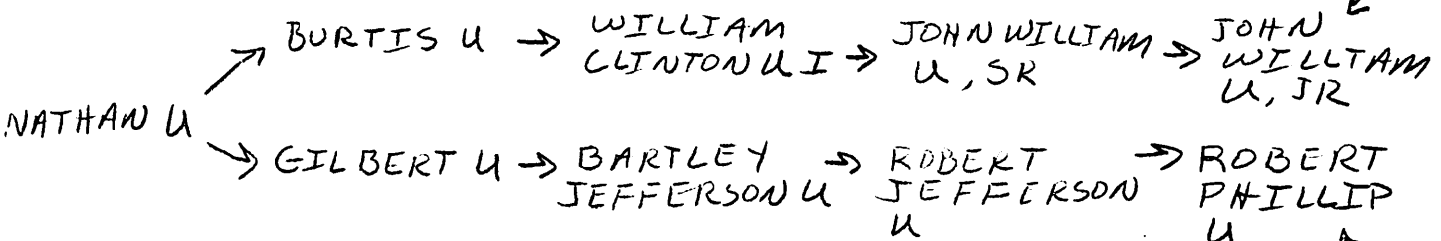

Hence your husband and I were 3rd Cousins.

The Natham U Clan has not been well documented and I have been working on it in some special ways. The two lines sketched on the previous page are of special interest to me and are more tightly interwoven than appears on the surface.

William Clinton U I was the first prominent Upchurch merchant in Raleigh, NC. He came to town from the Green Level area in Western Wake Co, NC about 1840 and for 60 years \pm cut a wide swath in Raleigh. My Grandfather, Bartley Jefferson U, left Green Level about 1860 to serve in the Civil War and a few years after his return settled in the Inwood Church area of Southern Wake Co where my father and I were born. Bartley was in the farming business with his brother William George U. William moved to Raleigh about 1855 \pm and first was associated in business with his 1st cousin William Clinton U I, your husband's grandfather. The plot there is that W. G. U and Eleanor Marie U the daughter of W. C. U I (Eleanor was the sister of your father-in-law). W. G. U was an amazingly successful business man in Raleigh. He died of cancer in 1895 at an unfortunate business point.

Nathaniel Smith U, a brother of W. G. U + Bartley U, moved to Florida in 1858 and gave

rise to a very prominent family there. In due course Belle Williamson U, sister of your father-in-law, and John Jones U, the son of Nathaniel Smith U. After W. G. U died his wife moved to FL but she was returned to Raleigh for burial when she died in 1927. There are several other interesting cross-connections among these families - some of which I am still sorting out.

On 25 FEB 1980 while in Raleigh on a visit I talked to Marie Hayer (Upchurch) Weaver, a sister of your father-in-law. She gave me many details. John William U Sr decided to raise his boys in the country so he bought a 100 acre farm from my grandfather B. J. U. I know the place well. J. W. U. Sr also ran the local Upchurch store for a time. My mother and father were married in the home of your father-in-law on 14 FEB 1920!

I have dropped by your store in Phoenix once but it was after 4:00 PM. Only recently have I sorted out the right names associated with your husband and you. I visit Phoenix quite a few times each year but at irregular intervals. I would really like to visit sometime when it is convenient - or if you come to Tucson, let me know.

Sincerely yours
 Phil Upchurch
 [ROBERT PHILLIP UPCHURCH]

ANNIE LOUISE DICKSON

John W Upchurch

North Carolina Marriages, 1759-1979 birth: 1905
marriage: 24 Nov 1937 Raleigh, Wake, North Carolina spouse: Annie Louise Dickson

BOB

DICKSON

○ Zebulon Record THUR 23 FEB 1995 Zebulon, NC

Susan L. Melton
 Susan "Sister Little" Elizabeth Melton, 72, of Garner, died Tuesday, Feb. 14. Funeral was 11 a.m. Friday, Feb. 17, at Longview Life Faith Center. Graveside service was at Pinelawn Memorial Park, Kinston.
 Surviving: daughter, Linda Wester of the home, daughter and son-in-law, Irene and Freddie Powell of Raleigh; sisters, Doris Hill of Snow Hill; brother, John Little of Kinston; granddaughters and their husbands, Robin and Forrest Kreider of Zebulon, Cathy and Bob Dickson of Raleigh, Tammy and David McDermott of Palm City, Fla.; great-grandchildren, Lindsey Kreider of Zebulon, Matthew Dickson of Raleigh; two step-grandchildren; three step-great-grandchildren.
 Arrangements by Bryan Lee Funeral Home of Garner.

I. — — Little

A. Susan Elizabeth Little^{||} md () — — Melton

1. Linda Melton md () — — Wester

2. Irene Melton md Freddie Powell

B. Doris Little md () — — Hill

C. John Little

|| Granddaughters: (& Husbands)

Robin — — md Forrest Kreider
Lindsey Kreider

Cathy — — md Bob Dickson ↑

Tammy — — md David McDermott

CECIL PALMER DICKSON

○ From Ltr 3 JUN 2010 w/with Frances Williams & RPH
Items taken from newspaper articles on Billie June W
(obit) and Annie Laurie Dickson (Marriage article) and
placed in their profiles.

I. John William W, Jr 5/6 SR of the Nathan W, I/ Buster W
Sublan - William Clinton W, I Ind. -
(Md) (2nd) 26 NOV 1937 (Hayes Barton Baptist Church, Raleigh, NC)
Annie Laurie Dickson D/O M/M Cecil Palmer Dickson of Raleigh.

A. Billie June W

1. Norman Roy Williams, II

a. Lindsay Williams (F)

△ b. Nicole Williams - This child named in obit
of her GM Billie June W d 16 JAN 2006 but
not in obit of her GGM Annie Laurie who
d 6 SEP 2004

DOROTHY MARIE DICKSON

OBITUARY DAILY TIMES - FROM C.J. PETERSON, JR LTR 28 JUN 2003

UPCHURCH, Dorothy Marie (DICKSON); 33; Waukegan IL>Hillsboro KS; Gazette Bulletin; 1998-12-18; arw
UPCHURCH, Dorothy Marie (DICKSON); 33; Waukegan IL>Hillsboro KS; Hutchinson News; 1998-12-22; retftrdoc

FRANK

DICKSON

⊙ My Records 11 NOV 1998

DICKSON, Frank

Marriage

Wife: **Jennie UPCHURCH**

Marriage Date: **25 May 1886**

Recorded in: **Jackson, Texas**

Source: **FHL Number 1010625**

Dates: **1837-1895**

JAMES DICKSON

① see Robert Dickson b 1780-1790 (GA)

JANIE ANN DICKSON

○ The Naaman Mills Family By W. A. Mills - Pg 30, 31

I. Abraham Mills

A. Naaman Mills

1. Loretta Mills - CGM of RPA

2. Matthew Mills

a. John Addison Mills 1824-1884

1. Columbus Washington Mills 1855-1928

Had 9 children ←

F

(I) Commodore Mills 1882-1954

PRESENTED

HERE →

Δ (F) Junius Jay Mills (b 11 Oct 1918, d 6 Mar 1979) m 16 May 1936
 Δ+Δ Novella Stephens. Married in Danville, VA. He is buried at
 Montlawn Cem., Wake Co., NC. Their children:

(a) Delna Ray Mills (b 13 Mar 1937) m 10 May 1957 Joyce Faye
 Atkinson (b ca 1937). Married in Cary, NC.

(b) Junius Carlton Mills (b 18 Aug 1939, d 22 Sep 1990) m 4 Dec
 1959 Walda K. Perkins (b ca 1941). Married in Raleigh, NC. He
 is buried at Montlawn Cem., Wake Co., NC. Their children:

b1) Wesley Charles Mills (Adp) (b 3 Sep 1957).

b2) Joellyn Mills (b 19 Sep 1962) m 21 Jul 1984 Eric Todd.
 Married in Wake Co., NC. Their children:

* Stephani Rena Todd (b 19 Jan 1985).

* Kendal Necole Todd (b 19 Mar 1988).

(c) Ronald Douglas Mills (b 18 Jan 1943) m 7 Aug 1961 Linda
 Edwards. Married in Dillon, SC. Their children:

c1) Angela Carol Mills (b 7 May 1966) m 31 Aug 1984 Gregory
 Hatcher. Married in Dillon, SC. Their children:

* Christopher Hatcher (b 29 Mar 1985).

* Allison Hatcher (b 16 Jul 1988).

c2) Jamie Douglas Mills (b 10 May 1967) m 10 May 1988 Janie Ann
Dickson. Married in Wake Co., NC. Their children:

* Brittany Rae Mills (b 12 Mar 1992).

* Alexander Douglas Mills (b 13 Jan 1994).

(d) Jerry Macon Mills (b 27 Jul 1945, d 8 Jun 1993) m Jun 1962 Jo
 Ann Warren. Married in Dillon, SC. He is buried at Montlawn
 Cem., Wake Co., NC. Their children:

d1) Kimberly Ann Mills (b 23 Oct 1968) m 1 Aug 1992 Glenn Shaw.
 Married in Wrightsville Beach, NC.

d2) Robin Leann Mills (b 11 Jun 1971) m 16 Jul 1994 Donald Wayne
 Morgan. Married in Carteret Co., NC.

d3) Kelley Jo Mills (b 22 Mar 1976).

JOHN DICKSON

① See Robert Dickson b. 1780-1790 (GA)

JOSEPH

DICKSON

○ From Ltr 4 FEB 1997 Janet Lee Lighthill & RPH

While I was dipping into the records this last time, I did look to see what I could find on Archibald Upchurch, and Phebe Lindsey, the mother of X Upchurch. I didn't backtrack yet through the records I have already covered, but I did check everything in this latest batch of records I pulled. I didn't come up with a lot. I did find a marriage bond for Phebe--.

"Granville Marriages 1753-1868", pp. 90.-- "Dickson, Joseph & Phebey Linsey, 17 Dec. 1795; Benjamin Denton, bm; Sneed, wit."

That was the only record I turned up for them. I need to backtrack next time to see if I can find some information on the various Thomas Hill's, so I'll keep an eye out for more on Phebe and child X. What I did not find, was a marriage bond for Archibald Upchurch, though I did find one for Elizabeth Upchurch and William Johnson--

Same book as above, pp. 185-- "Johnson, William & Elizabeth Upchurch, 20 Mar 1838; Lewis Heflin, bm; S G Shearmon, wit."

THIS EXTRACT PLACED IN BIOFILES OF:

JOSEPH DICKSON
PHEBE LINDSEY
PHEBE LINSEY
BENJAMIN DENTON

ARCHIBALD U
ELIZABETH U
WILLIAM JOHNSON
LEWIS HEFLIN
S. G. SHEARMON

LIZZIE BETH DICKSON

TX Births

UPCHURCH	ESHIN	PAUL		07-20-1942	m	GRIMES	LIZZIE BETH DICKSON ↑	WM PERRY UPCHURCH
----------	-------	------	--	------------	---	--------	-----------------------	-------------------

TEXAS BIRTH INDEX - PER C. J. PETERSON, JR 18 JUL 2005
1903 - 1999

Name	Birth Date	Gender	Birth County	Father's Name	Mother's Name
Eshin Paul Upchurch	20-Jul-42	Male	Grimes	Wm Perry Upchurch	<u>Lizzie Beth Dickson</u> ↑

LUCINDA DICKSON (PE1) XID-4938

- ① Per ltr 21 APR 75 from Mrs H. H. Salter to RPA
Lucinda Dixon m 15 FEB 1834 Moser U (b 19 APR 1816) -
 see Burmell U for details.
- ② See Burmell U - Pg 15 provided in Reg White to RPA
Lucinda Dixon was married on 15 FEB 1834 to
 Moser U b 19 APR GA) & 24 JUN 1886 bur Bapt. Cem
 Bedian Grmie Co, TX.
- ③ See Pg 18 Moser U (XID-2030) supplied by Reg White to RPA
 in ltr 30 MAR 1980
Lucinda Dickson (ca 1811) (AL) died probably mid 1850's
 probably in Clarke Co, AL. Her father = Robert Di Dixon
 and her mother = Polly —.
- ④ Item Rec'd in ltr 27 JUL 1990 Marie Elizabeth Ishell
 to RPA - obtained from Alabama Records Vol
 239 Clarke Co, AL, Page 42

BOOK 1832 - 1839

Page 227. Will of William Dickson dated 11 May 1835 probated 5 September 1836.

Sister Sarah White \$5; mother Polly Dickson and my brothers John Dixon, Thomas Dixon, James
 Dixon and my sister Lucinda Upchurch each an equal part. Executors: brothers John and Thomas
 Witness: Morgan Carleton, Barnaby Pope. → [LUCINDA DICKSON]

- ⑤ See ltr 28 NOV 1997 Juanita [42] to Earnestine U to RPA
 The writer uses the spelling LUCRETIA DICKSON
 for LD. (Note: other information including that
 writer her husband Moser U seems to indicate with
 reasonable certainty that the correct/preferred
 spelling for LD is Lucinda Dickson - RPA)

LUCINDA

DICKSON (P62)

X17-4938

6) AL MARRIAGES 1800-1920 In It 21 OCT 2002
Charles John Peterson, Jr Ed. RPU

Alabama Marriage Records, 1800-1920			(COUNTY)
Husband	Wife	Marriage date	Place
Moses Upchurch	<u>Lucinda Dickson</u> ↑	15 Feb 1834	Clarke
Moses Upchurch	Nancy Lary	20 Sep 1852	Clarke
L. B. Champion	Elizabeth Upchurch	03 Aug 1831	Clarke

7) Mg Records 11 NOV 1998

UPCHURCH, Moses

Marriage

Wife: Lucinda DICKSON ?!

Marriage Date: 15 Feb 1834

Recorded in: Clarke, Alabama

Source: FHL Number 1290227

Dates: 1814-1865

MARY

DICKSON

○ From Ltr 23 FEB 2004 Gretchen Gage Mann to RPU

I. Mann U - Head of Class

A. Murray U

1. Martha U

a. Augusta Ann Yates

i. Lorenza Mahlon Mann b 9 NOV 1868 (NC)

d 3 JUN 1939 (Between Cisco & Ranger, TX)

md (1st) () Susan Boyd b 11 MAR 1872 (NC)

d 4 JUL 1918 (Ex. Worth, Tarrant Co, TX) D/O

Lamm Boyd & Mary Dickson ↑

md (2nd) () Joseph Burwie West b () d ()

(Bur. - Greenwood Cem - Weatherford, Parker Co, TX)

ii. James Oscar Mann b 1 FEB 1875 (Wake Co, NC)

d 19 APR 1910 (Eastland Co, TX) (Bur. - Greenwood

Cem., Weatherford TX) md 17 OCT 1899 () Josephine

Burwie West b 2 APR 1882 (Weatherford,

Parker Co, TX) d 19 DEC 1948 () (BUR. - ASH HUS)

↙ (I) Harold West Mann, M.D. b 6 JUL 1901 (Weatherford, Parker Co, TX)

d 27 MAY 1951 (Angleton, Brazoria Co, TX) (Bur. - Rosehill Cem., Tarrant Co, TX)

md (1st) () Lois Eleanor Nefflin^{II} b 10 SEP 1906 (Sonora, McCulloch Co, TX)

d 14 JUL 1996 (San Angelo, TX) (Bur. -) D/O James S. Nefflin b 22 AUG 1961

() d 22 AUG 1953 (Pecos Co, TX) & Myrtle Alma York b 16 JUL 1887 (Leahy, TX) d 18 SEP 1971 ()

md (2nd) 1942 (Texarkana, TX) Josephine Gage Riddle b 1909 (Abilene, TX)

(A)^{II} Lois Carol Mann b 11 APR 1929 (Ex. Worth, TX) d 10 NOV 1996 (San Angelo, TX)

(B) - - Mann (F) md () LeRoy Rudder

(C) Jenny Jo Mann

(D) Gretchen Gage Mann

(II) James Shirley Mann b 17 JUN 1906 (Weatherford, Parker Co, TX)

md () Catherine - - b () d abt APR 1962

MATTHEW

DICKSON

○ Zebulon Record THUR 23 FEB 1995 Zebulon, NC.

Susan L. Melton
 Susan "Sister Little" Elizabeth Melton, 72, of Garner, died Tuesday, Feb. 14. Funeral was 11 a.m. Friday, Feb. 17, at Longview Life Faith Center. Graveside service was at Pinelawn Memorial Park, Kinston.
 Surviving: daughter, Linda Wester of the home, daughter and son-in-law, Irene and Freddie Powell of Raleigh; sisters, Doris Hill of Snow Hill; brother, John Little of Kinston; granddaughters and their husbands, Robin and Forrest Kreider of Zebulon, Cathy and Bob Dickson of Raleigh, Tammy and David McDermott of Palm City, Fla.; great-grandchildren, Lindsey Kreider of Zebulon, Matthew Dickson of Raleigh; two step-grandchildren; three step-great-grandchildren.
 Arrangements by Bryan Lee Funeral Home of Garner.

I. — — Little

A. Susan Elizabeth Little^{II} md () — — Melton

- 1. Linda Melton md () — — Wester
- 2. Irene Melton md Freddie Powell

B. Doris Little md () — — Hill

C. John Little

II Granddaughters: (& Husbands)

Robin — — md Forrest Kreider
Lindsey Kreider

Cathy — — md Bob Dickson
Matthew Dickson

Tammy — — md David McDermott

(PATERNAL)

HUSBAND'S NAME DICKSON, ROBERT

When Born BETWEEN 1780-1790 (30-40 - 1830) Where GEORGIA (1850 US BIRTH RECORD)

Christened _____ Where _____

When Died AFTER 3 NOV 1830 BEFORE 1 JULY 1833 Where CLARKE CO, ALA

When Buried _____ Where (PROB) CLARKE CO, ALA

When Married _____ Where (PROBLY) GEORGIA

Other Wives (if any) Number (1) (2) etc. UNIK

His Father UNIK

His Mother's Maiden Name UNIK

DICKSON, ROBERT
(Husband's Full Name)

POLLY
(Wife's Maiden Name)

This information obtained from
ROBT DICKSON WILL - CLARKE CO, ALA
CENSUS RECORDS

MARR RECORDS - CLARKE CO, ALA

WIFE'S MAIDEN NAME POLLY

When Born BETWEEN 1780-1790 (30-40 - 1830) Where GEORGIA (1850 US BIRTH RECORD)

Christened _____ Where _____

When Died _____ Where _____

When Buried _____ Where _____

Other Husb. (if any) Number (1) (2) etc. _____

Her Father _____

Her Mother's Maiden Name _____

Date JUNE 1968
Compiler ROY WHITE JR
Address P.O. BOX 17106
City HOUSTON State TEXAS

Male or Female	CHILDREN (Arrange in order of birth)	WHEN BORN (Day Month Year)	WHERE BORN (Town or Place)	State or Country	WHEN DIED (Day Month Year)	Married
M	1 <u>DICKSON, JOHN</u>	(25-1850) ABT 1807		(CENSUS) GEORGIA		Date <u>ABT 1829</u> To <u>POPE, MARY OR POLLY</u>
M	2 <u>DICKSON, THOMAS</u>	(20-30 - 1830) ABT 1809				Date <u>15 FEB 1834</u> To <u>GILMORE, BETSEY</u>
F	3 <u>DICKSON, SARAH</u>	(15-20 - 1830) ABT 1811		(CENSUS) GEORGIA		Date <u>14 OCT 1828</u> To (1) <u>WHITE, ROBERT</u>
M	4 <u>DICKSON, WILLIAM</u>	(15-20 - 1830) ABT 1813			<u>PROBLY SOON AFTER</u> <u>11 MAY 1835</u>	Date _____ To _____
M	5 <u>DICKSON, JAMES</u>	(10-15 - 1830) ABT 1815				Date _____ To _____
F	6 <u>DICKSON, LUCINDA</u>	(33-1850) ABT 1817		(CENSUS) ALA	<u>BETWEEN</u> <u>1850 + 1852</u>	Date <u>15 FEB 1834</u> To <u>UPCHURCH, MOSES</u>
	7					Date _____ To <u>son of</u>
	8					Date <u>Burwell II of</u> To <u>James III</u>
	9					Date <u>Burwell II claim</u> To _____
	10					Date _____ To _____

*Rec'd from Julian Gammon sister
15 SEP 1980 It's to me.
RBY*

Alabama, 526 North Main Street, Logan, Utah
known on children and not death date, write
x (Bur). Use reverse side for additional info.

ROBERT
DICKSON

SARAH DICKSON

① See Robert Dickson b 1780-1790 (GA)

THOMAS DICKSON

① See Robert Dickson b 1780-1790 (GA)

W

M

DICKSON

Input of William R. Carradine, RPH - Email 6 JUN 2011

I. James U, II - Head of Clan

A. Burwell U

1. Burwell rules

a. Mary S. U b 4 APR 1851 (Grimes Co., TX)

i. Minnie B. Hoard b 30 MAR 1878 (Grimes Co., TX)

Δ md (4th) A bent 1927 (1) FRANK CLEVELAND CARRADINE b 19 MAY 1885 (1) d 24 JUL 1955 (1) (Bur. - Terrace Cem, Post, GARZA CO, TX) (This was his only mfg)

SS application for Louise Gressett: mother = Ida Mahoney father = C G Gressett everyone knew Billy as Louise's aunt so, this agrees with the theory of Ida being Billy's sister

Δ (I) Ida Lee Mahoney b 16 SEP 1896 (1)
Δ md (1st) (1) Clayton G. Gressett
→ (A) Louise GRESSETT Δ

Δ (II) Eva Smith [AKA Billy Smith]

Also in the Grimes Co. Records: Marriage: Eva Smith to W M Dixon, July 28, 1919

b 10 DEC 1903 (Grimes Co., TX)

md 28 JUL 1919 (Grimes Co., TX)

Δ W. M. DIXON b ABOUT 1899 (TX)

md (2nd) 12 DEC 1930 (Orange Co., CA)

Δ Lynn Earley

And, in the 1920 census: Grimes County W M Dickson, 21, born Texas wife, Eva, 16, born Texas

This, again, is the Eva (Billy?) from the 1910 census.

I found the following record in the Grimes Co. Court House:

Records of Births:

birth date = Dec. 10, 1903

white, girl, alive, legitimate, American

no name

parents = Thos Smith, Minnie Smith

reported by B W Robinson, MD, Bedias

* The Family name DICKSON is common in Grimes Co., TX so have adopted name for. W. M. - RPH Δ

There were a lot of births with "no name" during that time period. This certainly appears to be the Eva of other records, who I think is the same person as Billy Smith Earley.

Have you ever run across Dixon/Dickson before? Do you have any idea who that might be?

WILLIAM DICKSON

① See Robert Dickson b 1780-1790 (GA)