

BLUE JAY POINT COUNTY PARK



**BLUE JAY CENTER
FOR
ENVIRONMENTAL EDUCATION**

• • • • •
**PARK HOURS
GROUNDS:**

8 A.M. - SUNSET,
SEVEN DAYS A WEEK.

BLUE JAY CENTER:
8 A.M. - 5 P.M.,
SEVEN DAYS A WEEK.

TELEPHONE
(919) 870-4330

• • •
**BLUE JAY POINT COUNTY PARK
IS CLOSED**
THANKSGIVING DAY
CHRISTMAS EVE
CHRISTMAS DAY
NEW YEAR'S DAY

PARK RULES AND REGULATIONS

Safety and enjoyment go hand in hand at Blue Jay Point County Park. The following regulations have been established to ensure a safe and pleasant visit.

1. **SPEED LIMIT IS 20 MPH.**
2. **PETS MUST BE KEPT ON A LEASH.**
3. **OPEN FIRES ARE NOT ALLOWED.**
4. **PARK ONLY IN DESIGNATED AREAS.**
No parking on roadsides or outside park gates.
5. **THE FOLLOWING ARE PROHIBITED:**
 - a. *Alcoholic beverages.*
 - b. *Firearms.*
 - c. *Hunting.*
 - d. *Overnight camping.*
 - e. *Swimming.*
 - f. *Collection or removal of any animal, plant or mineral material.*
 - g. *Amplified music.*

Help keep our parks beautiful. Place trash and recycling in the appropriate containers.

Learn more about other parks operated by Wake County Parks, Recreation and Open Space.

Information is available at the park office, in our brochures or you can visit us at:
www.wakegov.com

BLUE JAY POINT COUNTY PARK
3200 PLEASANT UNION CHURCH ROAD
RALEIGH, NC 27614
(919) 870-4330

BLUEJAYPOINT@CO.WAKE.NC.US

Printed on 100% post-consumer recycled paper. LA-10/06

WAKE COUNTY PARKS, RECREATION AND OPEN SPACE



REC'D 4 JUN 2012

BLUE JAY POINT COUNTY PARK



A DAY AT BLUE JAY POINT

A day at Blue Jay Point County Park offers a variety of educational and recreational activities for all visitors. Located on a 236-acre site adjacent to Falls Lake, the park offers individuals and groups many opportunities to learn about and enjoy the natural world.

Environmental Education programming is the park's main attraction. Public programs for all ages are conducted throughout the year.

Organized group programs are available upon request.

Other park attractions include hiking trails, picnic areas, a playground, and open-play fields. Fishing is also available along the shore of Falls Lake.

Whatever your recreational interest might be, there is something for everyone to enjoy during a day at Blue Jay Point County Park.



THE BLUE JAY CENTER FOR ENVIRONMENTAL EDUCATION

The mission and focus of Blue Jay Point is to provide opportunities for Wake County's population to experience environmental education in a natural setting. In that regard, the park's Blue Jay Center for Environmental Education targets local school groups and the general public, in its environmental education offerings. As well, organized groups, such as the Boy Scouts, Girl Scouts, and 4-H Clubs can take advantage of the park's programming opportunities to complement their own organizational missions.

Blue Jay Point offers a wide variety of educational programs in natural history and the natural sciences, including current environmental issues and environmental ethics. More information about these programs is available through the Blue Jay Center for Environmental Education at 870-4330.

The Blue Jay Center houses an exhibit hall that explores many environmental and natural resource themes. Water is the focus of the first set of exhibits, offering a glimpse of the water cycle, the Neuse River basin, the Falls Lake watershed, and the city's reliance on Falls Lake for its supply of drinking water. The next series of exhibits offers visitors a look at many of the perils currently impacting the local environment and highlights steps citizens can take toward its preservation. Finally, the Nature Discovery Room allows visitors an up close look at the natural habitats found at Blue Jay Point, exploring the plants, animals, and ecology of the fields, forests, and streams of the park.

RECREATION AND LEISURE

A day at Blue Jay Point offers visitors an opportunity to relax and enjoy the natural beauty of the park. Some of the attractions at Blue Jay include the following:

- **Blue Jay Gardens.**
This area gives visitors ideas for their own backyard wildlife habitat and native plantings.
- **Picnic areas with grills.**
- **Kids Lot and Tot Lot playgrounds.**
- **Open-play field.**
This large open area is ideal for flying kites, throwing frisbees, and just relaxing in the sun.
- **Hiking and walking trails.**
There are five miles of trails within the park. Hikers seeking extended trail opportunities will discover that Blue Jay's Section VI of the Falls Lake Trail connects with North Carolina's Falls Lake Trail, thus extending the hiking opportunities well beyond the boundaries of Blue Jay Point.
- **Fishing.**
The shores of Blue Jay Point provide informal bank fishing in Falls Lake. NOTE: All N.C. Inland Freshwater Fishing Regulations apply.



RENTALS

Blue Jay Point County Park has facilities for rent to various groups, with priority given to Wake County groups involved in environmental education. More information regarding the various rental facilities available can be obtained by calling the park's administrative office at 870-4330.

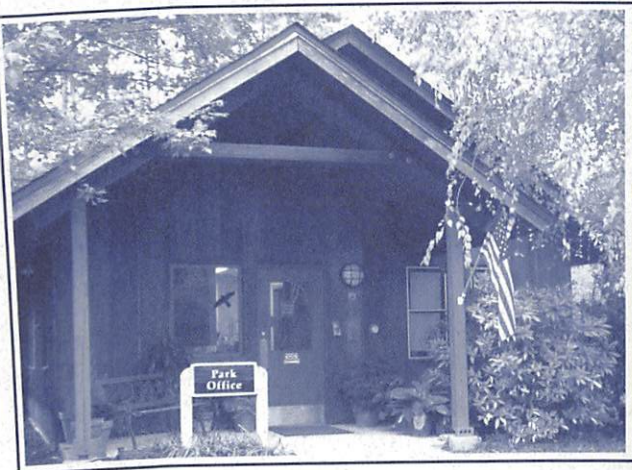

VIEW OF PARK OFFICE

CROWDER DISTRICT PARK
4709 TEN-TEN ROAD
APEX, NC 27539
(919) 662-2850

CROWDERDISTRICTPARK@WAKEGOV.COM

BEEN 40002022



PARK HOURS
8 A.M. - SUNSET,
SEVEN DAYS A WEEK.
(Closing time posted at entrance)

TELEPHONE
(919) 662-2850



CROWDER DISTRICT PARK
IS CLOSED
THANKSGIVING DAY
CHRISTMAS EVE
CHRISTMAS DAY
NEW YEAR'S DAY

Safety and enjoyment go hand in hand at Crowder District Park. The following regulations have been established to ensure a safe and pleasant visit.

1. SPEED LIMIT IS 20 MPH.
2. PETS MUST BE RESTRAINED WITH A 6' LEASH AT ALL TIMES.
3. USE ONLY CHARCOAL IN PARK GRILLS.
4. PARK ONLY IN DESIGNATED AREAS.
No parking on roadsides or outside park gates.
5. THE FOLLOWING ARE PROHIBITED:
 - a. Alcoholic beverages
 - b. Firearms
 - c. Hunting/Fishing
 - d. Overnight camping
 - e. Swimming/Wading/Boating
 - f. Collection, removal, or release of any animal, plant or mineral material
 - g. Amplified music
 - h. Feeding wildlife
 - i. Littering
 - j. Open fires of any kind

Help keep our parks beautiful. Place trash and recycling in the appropriate containers.

Learn more about other parks operated by Wake County Parks, Recreation, and Open Space.

Information is available at the park office and in our brochures or you can visit us at:
www.wakegov.com



CROWDER DISTRICT PARK



A Day at Crowder District Park

A day at Crowder District Park provides a variety of educational and recreational activities for all ages.

Park naturalists offer interpretive, hands-on environmental programs for groups of all ages and interests, as well as outreach programs for schools and community groups.

The park's 33 acres provide recreational opportunities that include over one mile of paved trails, an open play field, sand volleyball, outdoor amphitheater and three picnic shelters with adjacent playgrounds.

The park's 2.7-acre pond is always a favorite stop while at Crowder.



There are three covered picnic shelters with tables and several other picnic tables located throughout the park. Each of the covered shelters has a charcoal grill with restroom facilities and playgrounds nearby. Shelter reservations can be made by calling the park office at (919) 662-2850. Unreserved shelters may be used free of charge on a first-come, first-served basis. Users are always expected to leave the shelter and surrounding areas clean and undamaged. Please follow rules posted on each shelter.

PICNIC SHELTER FEES

(A \$50.00 security deposit is required for each shelter rented and will be refunded if shelters are left clean and undamaged.)

HERON SHELTER (100 person maximum)
Daily (9 A.M. - closing) _____ \$80.00

CARDINAL SHELTER (50 person maximum)
Daily (9 A.M. - closing) _____ \$60.00

ROBIN SHELTER (25 person maximum)
Daily (9 A.M. - closing) _____ \$40.00



Recreation and Leisure

A visit to Crowder offers patrons a chance to relax in a natural setting that offers passive recreational and educational activities for all ages.

- Paved Trails**
 Take a relaxing stroll along accessible trails that wind through the wooded areas of the park and circle Crowder Pond. The length of the outer perimeter trail is 0.8 miles and the length for the pond trail is 0.3 miles. For fitness walking, the total length of the trail is 1.1 miles.
- Open Play Field**
 Enjoy an invigorating afternoon of frisbee, kite-flying, ball playing or sand volleyball.
- 2.7-Acre Pond**
 Observe a variety of wildlife from our boardwalk and observation deck.
- Park Pavilion**
 Relax as you watch wildlife, or sit quietly and read a good book on the observation deck. Please no food, drinks, or smoking in this area.
- Educational Gardens**
 Check out the various gardens located throughout the park. The gardens provide ideas for native plantings and backyard wildlife habitats.
- Playgrounds**
 There are three playgrounds at Crowder, the largest is located near the upper park pavilion and has play equipment for elementary school age and small children. The other two playgrounds are located near the Heron and Robin picnic shelters and are best suited for small children. All are located near parking.
- Outdoor Amphitheater**
 The wooded amphitheater provides the perfect setting for programs and performances. It seats about 50 people and has a wooden platform "stage" area with two built in tables.



Welcome to...

HISTORIC OAK VIEW

For close to 150 years, Oak View was a busy working farm. Although the farmers, crops, and livestock are now gone, the land and its remaining buildings still tell the farm's story. Oak View has seen many changes between its founding in the 1830s and its restoration in the 1990s. Over the years, its crops, animals, buildings, and farming techniques have been modified and even replaced as nature and technology demanded.

A day at Historic Oak View County Park offers visitors a variety of cultural, educational, agricultural, and recreational activities. This 27-acre site includes a number of historic buildings and the Farm History Center, a museum and visitor's center dedicated to telling the story of North Carolina's agricultural development. Visitors are also welcomed to enjoy the park by strolling through the grounds and gardens, picnicking, or fishing in the pond.



SELF-GUIDED TOUR

Completed in 1997, the **Farm History Center (1)** is the only modern building on the site. It provides both an overall orientation to Oak View as well as information about North Carolina's agricultural history. It features the Farmer's Corner, an interactive area for kids.

The Livestock Barn (2), built around 1900, was one of several barns at Oak View. They housed the farm's horses and mules, which were used for the farm labor, and chickens, cows, and hogs which provided income and food for the farm families. Today, kids can experience farm chores in the interactive area named "All in a Day's Work."



The Cotton Gin House (4), also built around 1900, enabled Oak View Farm to gin its own cotton. This process cleaned and separated the cotton lint from the seeds. The gin was active day and night, as neighboring farmers also ginned their cotton here. Next to it is the **Cotton Field (3)**. The field is only a fraction of the size it was in 1860, when the farm exceeded 900 acres. Cotton was the primary crop at Oak View Farm for most of its existence.

The Plank Kitchen (7) was built around 1825, and is the oldest building on the property. It served as a kitchen from 1855, when the Main Farmhouse was built, until the 1940s, when an interior kitchen was constructed. A detached kitchen was a common practice of the time as it eliminated unwanted heat and the threat of fire from the main house. Next to the Plank Kitchen is a small **Garden (6)**, containing plants that were commonly used to flavor foods, scent soaps, and remedy ailments. Also nearby is the farm's **Water Tower (8)**, which was the main water source for the kitchen, livestock barns, and nearby tenant houses.



The Carriage House (9) was built around 1900 and later converted to a garage with two large doors for vehicle storage. Oil from the farm vehicles still stains the wooden floorboards. Today, this building houses the park's restrooms, as well as a restored wagon.

Benton S. D. Williams built the two-story **Main Farmhouse (10)** around 1855, likely with the help of his sons and neighbors. The house draws on a Greek Revival architectural style typified by the columns and the double-portico porch. In the 1940s, the Poole Family built a large addition to the east side of the house in the Colonial Revival style. In front of the house stands a cedar **Gazebo (11)**, built around the turn of the Twentieth Century, and called the "sun house" by Oak View residents.



As early as the 1880s, Oak View employed tenants farmers or sharecroppers as farm laborers. The tenants, who were African American and white families and single men, lived near the Main Farmhouse in homes that stretched in a row alongside the Pecan Grove. This **Tenant House (12)** is not original to Oak View, but is remarkably similar to one of the houses that once stood in this location.

Oak View's Pecan Grove (13) is the largest in Wake County. The original pecan trees were planted during the 1910s and 1920s to supplement the farm's income. They are an example of crop diversification, which became especially important when the boll weevil infestation forced the farm to cease cotton production in the 1920s and 30s. **The Fruit Orchard (15)** is a demonstration garden intended for education and enjoyment by Oak View's visitors.



PLACES FOR KIDS TO LEARN AND PLAY
 The Farmer's Corner, in the Farm History Center, is where children can take a turn at planting and harvesting crops and then cook them up for dinner. There are also children's books on farming and a dress-up area. All In a Day's Work, in the livestock barn, introduces children to farm chores such as milking a cow, gathering eggs, and feeding livestock.



GOATS
 Oak View's Nubian Goats are very friendly. They can be found in one of two outdoor pens or in their stall in the barn. They enjoy treats from visitors, but please check with staff about appropriate foods before feeding them.

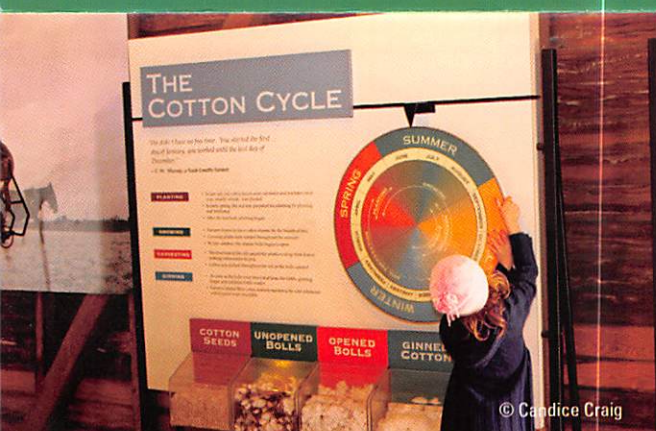

EXHIBITS
 The history of farming in North Carolina generally, and at Oak View specifically, is told through exhibits found in many of the park's buildings. Oak View also hosts a variety of traveling exhibitions, so check our website for current exhibition offerings.

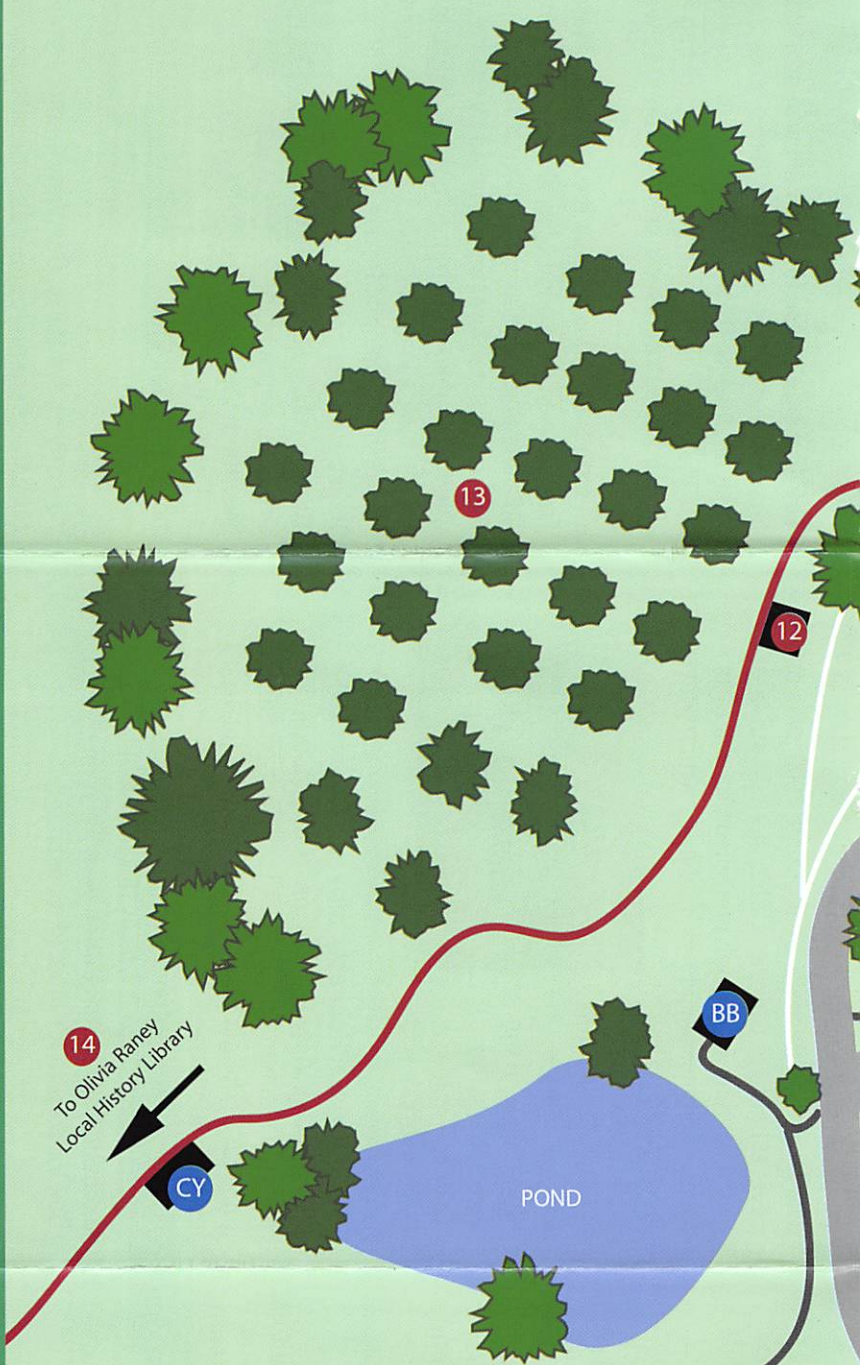

-  Brick Walkway
-  Concrete Walkway
-  Entrance Drive
-  Restrooms
-  Bluebird Shelter
-  Carya Shelter

HISTORIC OAK VIEW

*"Come experience life on a farm
from Wake County's past ..."*



PARK HOURS

GROUNDS:

8:00 A.M. — 1 HOUR BEFORE SUNSET,
SEVEN DAYS A WEEK

BUILDINGS:

8:30 A.M. - 5 P.M., MON - SAT,
1 P.M. - 5 P.M., SUNDAY



HISTORIC OAK VIEW COUNTY PARK IS CLOSED
THANKSGIVING DAY
CHRISTMAS EVE
CHRISTMAS DAY
NEW YEAR'S DAY

PARK RULES AND REGULATIONS

Safety and enjoyment go hand in hand at Historic Oak View County Park. The following rules and regulations have been established to ensure a safe and pleasant visit.

1. SPEED LIMIT IS 20 MPH.
2. PETS MUST BE KEPT ON A LEASH.
3. WOOD FIRES ARE NOT ALLOWED. USE PARK GRILLS ONLY.
4. PARK ONLY IN DESIGNATED AREAS.

No parking on roadsides or outside park gates.

5. THE FOLLOWING ARE PROHIBITED:

- a. Alcoholic beverages
- b. Firearms
- c. Hunting
- d. Overnight camping
- e. Collections or removal of any animal or plant material.
- f. Amplified music
- g. Swimming

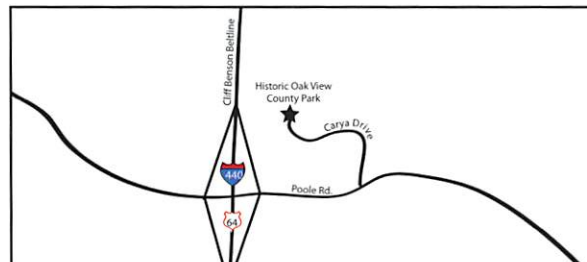

Historic Oak View County Park
4028 Carya Drive
Raleigh, NC 27610
(919) 250-1013

www.wakegov.com/parks/oakview

oakview@wakegov.com

www.facebook.com/oakviewpark

Historic Oak View County Park

REV'D 4 JUN 2012



**Parks, Recreation
& Open Space**

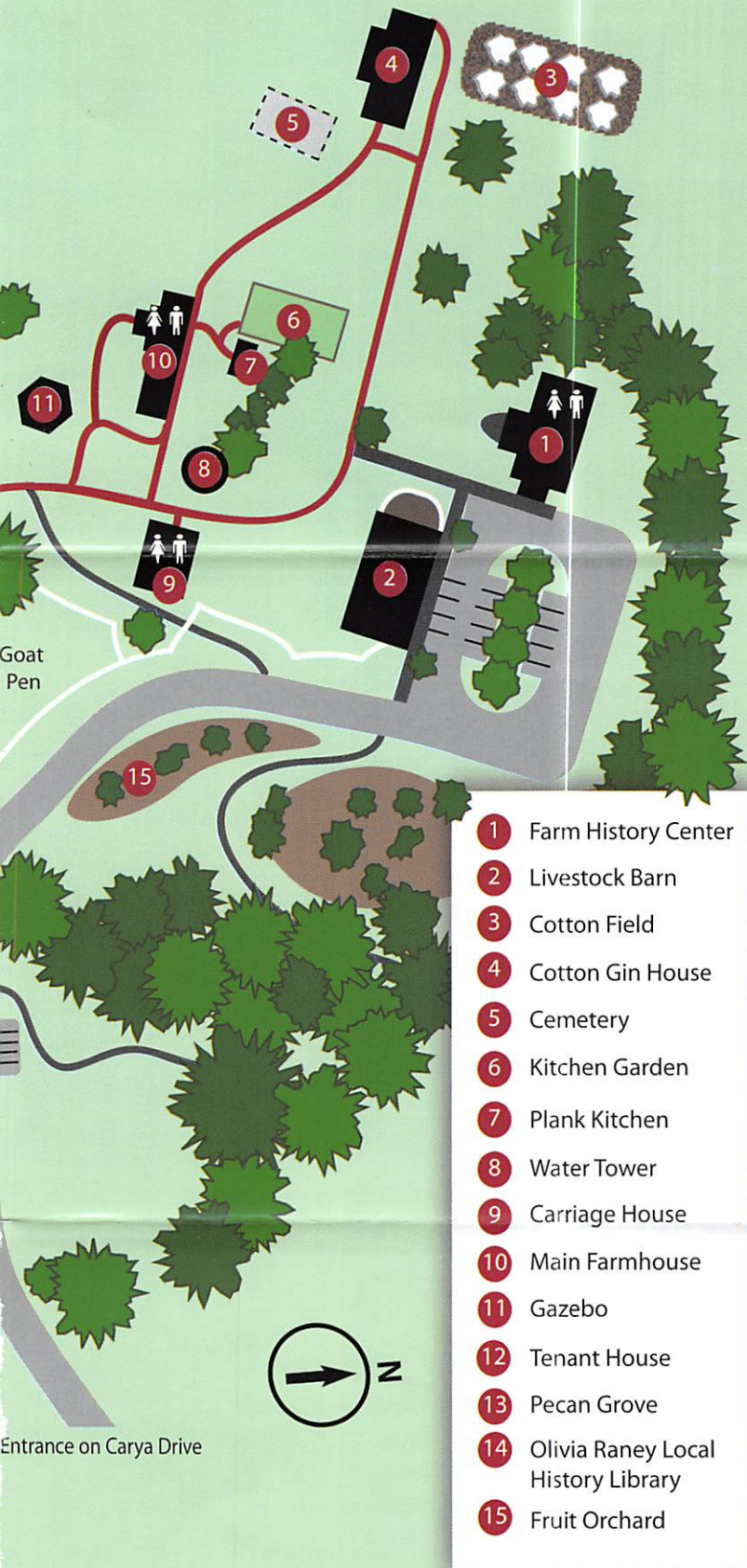

- 1 Farm History Center
- 2 Livestock Barn
- 3 Cotton Field
- 4 Cotton Gin House
- 5 Cemetery
- 6 Kitchen Garden
- 7 Plank Kitchen
- 8 Water Tower
- 9 Carriage House
- 10 Main Farmhouse
- 11 Gazebo
- 12 Tenant House
- 13 Pecan Grove
- 14 Olivia Raney Local History Library
- 15 Fruit Orchard

Map not drawn to scale.



TOURS AND PROGRAMS

Oak View accepts reservations for guided tours for history lovers of all ages, as well as curriculum-based cultural education programs for elementary school-aged students. There are also a variety of free self-guided activities available. Ask any staff member or visit our website for more information about Oak View's programmatic offerings and fees.



SPECIAL EVENTS

Each year, about 10,000 visitors come to Oak View for special events. Highlights include Heritage Day in October and Sleigh Rides and Cider in December. For a calendar of events, please visit our website.



© Candice Craig

RECREATION

A day at Oak View offers visitors an opportunity to relax and enjoy the natural beauty of the site. Picnicking, fishing in the pond (NC Freshwater Fishing Regulations apply), and strolling the pecan grove are popular activities. Oak View's two shelters are available to rent for gatherings.