

○ Zebulon Record 2 FEB 1995 Zebulon, NC

Debra J. Williams

Debra J. Williams, 38, of Knightdale, died Wednesday, Jan. 25. Funeral was 1:30 Sunday, Jan. 29, at Malaby's Crossroad Baptist Church. Burial was at the church cemetery.

Surviving: husband, Linwood A. Williams; sisters, Ruby Mials of Knightdale, Geraldine Hinton of Maryland, Virginia Upchurch of Bridgeport, Conn., Eula Dawson of Zebulon, Mary Whitley of Wendell; aunt, Eva Brown of Wendell.

Arrangements by William Toney's Funeral Home of Zebulon.

- I. Debra J. — [Mrs Debra J Williams]
 md Linwood A. Williams
- II. Ruby — — md — — Mials
- III. Geraldine — — md — — Hinton
- IV. Virginia — — md — — Upchurch
- V. Eula — — md — — Dawson
- VI. Mary — — md — — Whitley
- VII. Eva — — md — — Brown

WILLIAM TONEY FUNERAL HOME - ZEBULON, NC ↑
MALABY CROSSROAD BAPTIST CHURCH near Zebulon, NC

Abundant Life Full Gospel Baptist, U.S. 64-Raymond Drive, Wendell. Pastor, John Galliher. Sunday Bible study, 9:30 a.m.; worship, 10:30. Wednesday, 7:30 p.m.

Baptist Tabernacle, 1599 N.C. 231, Wendell. Sunday school, 10 a.m.; worship, 11 a.m. Wednesday prayer meeting, RAs, GAs, Acteens, Mission Friends, 7:30 p.m.

Beaver's Chapel United Church of Christ, 601 Proctor St., Zebulon. Pastor, William McCoy. Sunday school, 9:45 a.m.; worship (except fifth Sunday), 11 a.m. Prayer, Wednesday night, 7:30; 269-9818.

Bible Baptist (Missionary Independent Baptist), Earpsboro Crossroads, 3 miles south of Zebulon, N.C. 96. Pastor, C.W. Medlin.

Charity Free Will Baptist, U.S. 64 Business, Wendell. Pastor, Jerry Johnson. Sunday school, 9:45 a.m.; worship, 11 a.m., 6:30 p.m.; Wednesday, prayer and Bible study, 7:30 p.m.

Church of God, Perry Road, Zebulon. Pastor, Arnold Laxton. Sunday school, 10 a.m.; worship, 11 a.m., 6 p.m.; Wednesday, 7:30 p.m. 556-3767.

Church of Jesus Christ of Latter-day Saints, Hendricks Dr., Zebulon. Bishop, Karl E. Simmons. Sacrament, 10 a.m.; Sunday school, 11:10 a.m.; priesthood, ladies relief society, noon; youth night, Thursday, 7.

Corinth Baptist Church, N.C. 96. Pastor, Dr. Carl Hedrick. Sunday school, 10 a.m.; worship, 11 a.m. Wednesday Bible study, 7:30 p.m.

Earpsboro Holy Church, 1669 Earpsboro Road, Zebulon. Pastor John S. Howard. Worship, first and third Sunday, 11 a.m.; Wednesday Bible study, 7:30 p.m.; 269-7140.

First Free Will Baptist Church, N.C. 97, one mile west of Zebulon. Pastor, Rev. Earl Gilliam. Sunday school, 10 a.m.; worship, 11 a.m., 7 p.m. Wednesday service, 7:30 p.m.

Friendship Original Free Will Baptist, Middlesex. Pastor, Jacky Raper. Sunday school, 10 a.m.; worship, 11 a.m.

Wednesday Bible study, 7:30 p.m.

Gateway Christian Center, N.C. 231, Middlesex. Pastor, Gerald Wiggs. Sunday school, 10:30 a.m.; worship, 5 p.m. Tuesday prayer, 7:30 p.m. Wednesday worship, 7:30 p.m.

Genesis Church, Edgemont Road, Wendell. Pastor, V.E. Potter Jr. Sunday school, 9:45 a.m.; worship, 10:30 a.m., 6 p.m. Wednesday Bible study, Royal Rangers, Gems, 7:30 p.m.

Hales Chapel Baptist, N.C. 39, Zebulon. Interim pastor, the Rev. Joe Zimmerman. Sunday school, 10 a.m.; worship, 11 a.m. Wednesday prayer, 7:30 p.m.

Hephzibah Baptist, 1794 Wendell Boulevard. Pastor, William Sanderson; education minister, David Edgell; music director, Stuart Sanderson; minister to students, Aaron Wallace; child education minister, Tom Fernandez; recreation director, Lara Beddingfield. Sunday worship, 8:45, 10 a.m.; Bible study, 8:45, 10 a.m.; pre-school, children choirs, youth Bible study, adult equipping university, 5 p.m.; praise, 6:30. Wednesday: family meal, 5:45 p.m.; preschool AWANAs; Prime Time Youth, adult equipping university, worker planning, 6:30 p.m.

Heritage Baptist, 615 Mack Todd Road, Zebulon. Pastor, David Dupree; music director, Joel Dupree; bus ministry director, Lee Marlowe; Heritage Christian Academy Principal Stephen Creech. Sunday: men's prayer, 8 a.m.; Sunday school, 10 a.m.; worship and junior church, 11 a.m.; worship, 6:30 p.m. Wednesday: AWANAs with Wayne Price, 7 p.m.; Bible study and prayer, 7:30 p.m. 269-6504, fax 269-4473, email hbc6@juno.com.

Hopkins Chapel Baptist (Southern), Hopkins Chapel Road, six miles north of Zebulon. Pastor, Earl Roach. Sunday school, 9:45 a.m.; worship, 11 a.m. Wednesday prayer, 7 p.m.

SonRise Baptist (formerly Hunter Ministies), meets at the Zebulon Civic Centre. Pastor, Jeff Hunter. Sunday school, 9:30 a.m.; worship, 10:30 a.m. 269-9677.

Middlesex Missionary Baptist. Pastor,

Church directory

Rev. David Mills. Sunday school, 9:45 a.m.; worship, 11 a.m.

Miracle Center Holiness Church, Rosinburg Road, Zebulon. Overseer, Shaveva Smith. Pastor, Mary Hinton. Sunday school, 10 a.m.; worship, 11 a.m. Bible study, Mondays, 7:30 p.m. Evangelism, Wednesdays, 7:30 p.m.

Mt. Zion Holiness Church, 200 E. Stronach Ave., Zebulon. Pastor, Herman Lucas. Sunday school, 9:45 a.m.; worship, 2, 3 and 4 p.m. Wednesday nights, Bible study and teaching.

New Life Christian Assembly, S.R. 2320, Zebulon. Pastor, Dr. Edward E. Heffington Sr. Sunday worship, 10:30 a.m. Wednesday prayer, Bible study, 7 p.m.; 365-6304.

New Life Community Church, N.C. 39, Zebulon. Pastor, Hattie Stancil. Sunday prayer, 8 a.m.; Sunday school 9 a.m.; worship, 10 a.m. Wednesday prayer 6 p.m.; Bible study, 7. 404-0737.

Oak Grove Presbyterian, Flower Hill Road, Middlesex. Pastor, W.H. "Bill" Jarrett. Sunday worship, 9:30 a.m.; Sunday school, 10:30 a.m.

Original St. Johns Holy Church, Fowler Road. Pastor, N.E. Johnson. Sunday school, 10 a.m. each Sunday; worship service, 11 a.m. every first and third Sunday. Bible study and prayer meeting, Friday nights.

Pearce Baptist, 4634 Pearces Road, Zebulon. Pastor, Mark Cottrell. Sunday school, 10 a.m.; worship, 11 a.m.; Team Kid, 6 p.m. Wednesday prayer, 7 p.m.; choir practice, 8 p.m.

Pilot Missionary Baptist, N.C. 39 and Old U.S. 64, Pilot. Pastor, Shelby Stephens. Sunday school, 10 a.m.; worship service, 11 a.m., 7 p.m. Wednesday prayer, 7:30 p.m.

Pilot Missionary Baptist, Old U.S. 64. Pastor, Horace Mason Jr. Sunday school, 9:45 a.m.; worship (first, second, fourth Sundays), 11 a.m.; Bible study, Wednesdays, 7:30 p.m.; BTU, third Sunday, 11 a.m.

Pine Ridge Baptist, S.R. 1736. Pastor, W.C. Barham. Sunday school, 10 a.m.; worship, 11 a.m. Wednesday prayer, 7:30 p.m.; adult choir practice, 8 p.m. First and third Wednesday — Mission Friends, GAs, RA's and Acteens, 7:15 p.m. Second and fourth Wednesday — youth choir, 7:15 p.m.

Rocky Cross Baptist Church, 13452 Burgess Road, Middlesex. Pastor, Rev. Pat Wood. Sunday school 10 a.m.; worship 11 a.m.; 269-9993.

Samaria Baptist Church, N.C. 97 and N.C. 231. Pastor, Ronnie Pendley. Sunday school, 9:45 a.m.; worship, 11 a.m. and 6 p.m. Wednesday service, 7 p.m.

Social Plains Baptist Church, 639 Hagwood Road, Zebulon. Pastor, William Turner. Sunday school, 10 a.m.; worship, 11 a.m. and 7 p.m. Wednesday prayer, 7:30 p.m.

Spring Hill Baptist Church, 10 miles south of Zebulon off N.C. 96. Pastor, Rev. Cicero Williams. Sunday school, 10 a.m. every first and fourth Sunday; worship, 11:15 a.m. every first and third Sunday; missionary service, noon each second Sunday.

St. Eugene's Catholic Church, 608 Lions Club Road, Wendell. Pastor, Thomas F. Watkins. Saturday Liturgy, 5 p.m.; Sunday Liturgy, 8:30 and 10:30 a.m.; Spanish Liturgy, noon; religious education, 9:20 and 11:30 a.m.; Monday, Wednesday, Friday Liturgy, 10 a.m. 365-7114 (office); 365-3658 (rectory).

St. James Church of Christ, N.C. 222, Route 1, Middlesex. Pastor, Sylvester Holder.

St. John United Holy Church, Jack Mitchell Road, Zebulon. Pastor, Bishop Jesse Jones. Sunday school, 10 a.m. Worship, 11 a.m. the first, third, fourth Sundays. Bible study and prayer, Wednesday at 7 p.m.

St. Marks Missionary Baptist, N.C. 97, Wendell. Pastor, Robert Josey. Sunday school, 10 a.m.; worship, 11 a.m. and 7 p.m. Thursday worship, 7:30 p.m.

365-6800.

St. Matthew Disciple Church of Christ, Zebulon. Pastor, Alvin Dexter Sutton. Sunday school, 10 a.m.; worship second and fourth Sunday, 11:30 a.m. Prayer, Thursday, 7:30 p.m.

St. Paul Disciple Church of Christ No. 1, 1408 Pulley-Gordon Road, Zebulon. Pastor, Kenneth Braswell. Sunday school, 9:45 a.m.; worship, 11:15 a.m. second and fourth Sunday. Bible study and prayer, 7 p.m. Wednesday. Mission, 11 a.m. first Sunday.

St. Paul Disciple Church of Christ No. 2, N.C. 39. Pastor, Rev. Billy Newton. Morning worship, 11 a.m. first and third weeks of each month.

Stokes Chapel Baptist, Old Massey Road, Middlesex. Pastor, J.T. Dunston. Sunday school, 9:45 a.m.; worship, 11 a.m. second, fourth and fifth Sundays. Church conference, 7:30 p.m. Friday after third Sunday; Bible study, 7:30 p.m. Thursday after second Sunday.

Straightway Temple Ministries, Rosinburg Road. Pastor, Shirley L. Demby. Sunday school, 10 a.m.; worship, 11 a.m. Tuesday Bible study, 7:30 p.m.; prayer: Wednesday, 5 p.m. and fourth Saturday, 10 a.m.; evangelism, Friday, 8 p.m.

Trinity Faith Full Gospel, Zebulon Rotary/Woman's Club building. Pastors, W.E. and Bernice Simmons. Fellowship breakfast, first-third Sunday, 8 a.m.; Sunday prayer, 9 a.m.; Bread of Life, 9:35 a.m.; worship, 10:35 a.m., Word of God, children's church, 11:30 a.m.; Wednesday prayer, noon; Bible study, 7:15 p.m.; Friday worship, 7 p.m., women's Bible study, second Tuesday, 7 p.m. 269-2967.

Union Chapel Baptist Church, N.C. 96, three miles north of Zebulon. Pastor, Rev. C.W. Driver. Sunday school, 10 a.m.; worship, 11 a.m., 7 p.m. Wednesday prayer, 7 p.m.

Union Hope Baptist, N.C. 97, five miles east of Zebulon. Pastor Mark Palmer. Sunday school, 10 a.m.; worship service, 11 a.m. and 7 p.m. Wednesday service, 7:30 p.m.

Wakefield Missionary Baptist, 2320

Proctor St., Zebulon. Pastor Nathaniel B. Holloway. Sunday school, 9:45 a.m.; worship, 11 a.m. (except fifth Sunday); Bible study and prayer, Tuesdays, 6 p.m.

Wakefield Central Baptist, Proctor Street off N.C. 96, Zebulon. Pastor, Keith Wagner. Sunday school, 9:45 a.m.; worship service, 11 a.m. Sunday night service, 7. Prayer and Bible study, Wednesday, 6:45 p.m. Offers weekday pre-school.

Watkins Chapel Baptist, N.C. 231-N.C. 39, Emit. Pastor, Wayne Moore. Sunday school, 10 a.m.; worship, 11 a.m. Wednesday service, 7:30 p.m.

Wendell Christian, Old Zebulon Road-Mattox Street, Wendell. Pastor, Rev. Stephen Dunstan. Sunday school, 9:45 a.m.; worship, 11 a.m.; youth groups (Sept.-May), 5 p.m.

White Oak Hill Missionary Baptist, P.O. Box 782, Middlesex. Pastor, Rev. Gaddis Barnes. Sunday school, 10 a.m.; worship, first and third Sundays, 11 a.m.; Bible study, Wednesday, 7:30 p.m.; 269-0097.

World Overcomers Christian Center, 748 Main St., Bunn. Pastor, Eddie Barnes. Sunday school, 9:45 a.m.; worship, 11 a.m. prayer and Bible study, Wednesday, 7:30 p.m.

Zebulon Baptist Church, Gannon and Arendell avenues. Pastor, Rev. Jack Glasgow. Sunday school, 9:45 a.m.; morning worship, 11. Sunday night worship service, 7. Wednesday family night services, 6:30-8.

Zebulon Church of God, West Horton Street. Pastor, Rev. Ray T. Lewis. Sunday school, 9:45 a.m.; worship, 11 a.m. Sunday evening service, 6. Family training, 7:30 p.m. Wednesdays.

Zebulon First Baptist Church, 304 E. Barbee Ave. Pastor, Rev. Edward B. Holloway. Sunday school, 9:45 a.m.; morning worship, 11. Wednesday prayer meeting, 7:30 p.m. Wednesday Bible study, 8:30 p.m.

Zebulon United Methodist, Gannon Avenue-Church Street. Pastor, Rev. Judi J. Smith. Sunday early worship, 8:30 a.m.; Sunday school, 9:45 a.m.; worship, 11 a.m.

ZEBULON, WAKE CO, NC
 BEAVER'S CHAPEL UNITED CHURCH OF CHRIST
 Zebulon Record THUR 14 NOV 1996 Zebulon, NC

Beaver's Chapel United Church of Christ celebrates 104th year

"It Takes a Village" was the theme of the 104th anniversary celebration of Beaver's Chapel United Church of Christ.

It was in 1892 that the church was organized under the leadership of the Rev. B.F. Perry and five members: the Rev. C.W. Richardson, Sarlin Yarborough, John Yarborough, Banister Horton and John Horton. A number of the heirs of those original members are still active with the church.

The 104th celebration began Saturday night with a fellowship banquet at the CCO Center in Zebulon. Pastor William McCoy and members and friends of Beaver's Chapel enjoyed an evening of music by the Capitol City Five, then dinner and a speech by Jonathan F. Koffa.

Koffa, who first came to Zebulon as town planner, then was promoted to assistant town manager and currently serves as interim town manager, grew up in Monrovia, Liberia, in West Africa. He attended Shaw University, then earned a master's of public administration from N.C. State University. He is currently a law student at the University of North Carolina at Chapel Hill.

Koffa delivered an inspiring message on the need for everyone to be active participants in the "village."

Also on the program were three older members of the church: Alma Price, Maddie Morgan and Irene Richardson. The celebration continued with the Sunday morning service. McCoy delivered a strong message relating to diligence.

By Marjorie Ellis McLean



Marjorie's Clipboard

There was much relevance, as members recollected and reviewed their rich and humble heritage. This included how the church derived its name — the first church having been built near Beaver Dam Creek.

The church persevered many trials and tribulations. During the Depression, it became necessary to sell the church. Miraculously, when it was put on the market to be sold, according to church history, only the man who wanted to sell the church bid on the property. It was then that the Rev. Dowd advised members to buy the church back at the auctioned price. This was done, the Depression ended, and the church debt was paid off.

Among the old-timers who played active roles in laying the foundation for today's church were R.P. "Pete" Richardson, Rush Baker, J.T. Locke, Lona Richardson, Daisy Fowler, Christine C. Locke and Irene Richardson.

Many of the children of yesterday — LaVerne and Elsie Locke; Emma Tuck; Barbara Nell Tuck; Mary Price; Catherine Champion; Ray Fowler; Dorothy High; Hattie Pretty; and Gladys, Marjorie, Dorothy and Clara Reid — became active adults in the community. Several have, however, gone to their final resting place. Their impact on the community will long be felt.

Beaver's Chapel continues to impact the community. In the old days, Jonathan Bunn, who worked for Whitley Furniture, would borrow the furniture delivery truck on Sundays and take the young men to church in the back of the truck. Buster Baker, who worked for Toney's Funeral Home, owned a black Cadillac and would transport the women to church if there was no funeral.

Then there were the two choirs, the "note" choir and the regular choir. Henry Pearce, Hubert Fowler, Pete Richardson, Daisy Adams, Ernest Adams, Clifton Champion, Georgia Mae Adams, Marjorie Reid, Gladys Reid, Jonathan Bunn, Mary Ruth Bunn, Hattie Preddy, Shirley Pretty, Mary Price and Emma Tuck were among the choir members.

Beaver's Chapel United Church of Christ continues to be a pillar in the Zebulon community. Over the years, Deacons Clifton Champion, Donnie Beckwith, Garlene Privette, Harriston Hodges, Edward June Miles and Robert Mangun, as well as ministers including T.J. Moore, J.P. Mangun, Dr. W.M. Lake, L.E. Young, M. Ray, R.L. Haith, W. Barton, D. Jones and McCoy, made lasting contributions to the longevity of the church. Dedicated members, including the late Lena Rogers, have influenced what a church, small in numbers, can do when working toward a common goal.

In regard to the church, Marjorie Reid Young, church historian, stated, "Together we develop a progressive village for our children. He (McCoy) challenges us to continue the tradition of being a resource in the village that raises the child."

(Marjorie Ellis McLean is a veteran writer and Zebulon native who submits a weekly column to the Zebulon Record.)

WAKE CO, NC - ZEBULON

- B. F. PERRY, MDE
- C. W. RICHARDSON, MDE
- SARLIN YARBOROUGH
- JOHN YARBOROUGH
- BANISTER HORTON
- JOHN HORTON

STREAM FILE
 (BEAVER CREEK
 -WAKE CO, NC)

ST PAUL CH of CHRIST - ZEBULON, NC

Zebulon Record THUR 2 FEB 1995 Zebulon, NC

ST. PAUL CH. of CHRIST - ZEBULON, NC

LOUIS BOBBITT

Group at St Paul's takes church on the road for its eldest member

By DENA BOYETTE HEIGHT
Record Staff Writer

If Mrs. Maybelle can't make it to church, then we'll have to bring the church to Mrs. Maybelle.

That was the attitude recently of a handful of thoughtful members of St. Paul No. 1 Church of Christ, located on Pulley-Gordon Road, just south of Zebulon.

One churchgoer, Travis Maybelle Bobbitt, who is the oldest living member of the congregation, was celebrating her 101st birthday on Jan. 26. Because of the bad weather, and because Mrs. Bobbitt gets around with the help of a walker, she often finds it difficult to get to church.

But on this special day, this group wanted to bring a service to Mrs. Bobbitt — and they did.

A few from the church missionary department and the choir traveled to Mrs. Bobbitt's, who lives with her daughter, Louise Hall, to give her a surprise birthday gift.

Doris Wright, who was part of the traveling service, said Mrs. Bobbitt told her later she had a feeling she would be receiving a special present that day, and even wished it would be a visit from her church family.

Along with Mrs. Wright, the traveling group consisted of Joyce

ing a gospel program on television.

The flock greeted her with lots of hugs and a bunch of "Happy Birthdays." The service was opened with a song, "I Have Hope In Jesus." Mrs. Wright read from the book of Psalms and the book of Revelations. Mrs. Smith led the group in prayer and they polished off another hymn, "Working on Building a Sure Foundation."

working in the fields, or attending school or church. Food was not plentiful "like it is now. We had to make each penny count."

She married Willie High and had three children — two boys and one girl. Her sons now live in South Carolina and New York.

After her husband passed away, she moved to Zebulon. She swore after her first marriage she'd never marry again, but she ended up eating her words when she met Louis Bobbitt while working in tobacco. The two later married.

For most of her years in Zebulon, she has attended St. Paul No. 1. Best estimates are she has been a member for 50 years.

Not only does she enjoy her church family, but members also said they feel she gives them something in return.

"She's the jewel of our life in church," said Mrs. Wright, who

After the service, the group presented Mrs. Bobbitt with gifts and a floral arrangement from the church.

The birthday girl then gave the group a brief history of her life. Born in 1894, she told them she was raised in South Carolina on a sharecropper's farm, where she was surrounded by cotton and corn. The days were spent either

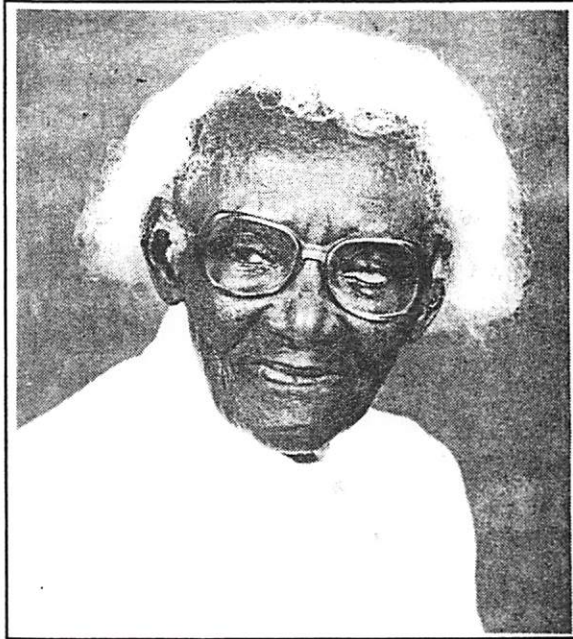

Maybelle Bobbitt

added they prize Mrs. Bobbitt so much they placed her on their float during Zebulon's Christmas parade two months ago. "She's very spiritual, and it's amazing to see how alert she is. It's great just to look at a person like her."

Her neighbors think enough of her that they wanted to give her a birthday present they knew she would cherish — a worship service that was a tender mixture of "love of the Lord" and good friends.

Neighbor of the month

and Mildred Brown, Helen and Charlene Mangum, Hilda Smith, Eva Jones, and Lawrence Wright. When they drove up, Mrs. Bobbitt was getting in the spirit by watch-



Have church, will travel

Photo by Dena Height

Taking their message on the road were (from left) Eva Jones, Doris Wright, Charlene Mangum, Louise Hall (Maybelle Bobbitt's daughter) and Helen Mangum. Not pictured are Joyce Brown, Hilda Smith, Mildred Brown and Lawrence Wright.

HORTON CEM - S. WAKEFIELD RD - ZEBULON, NC - BY RPU 29 MAR 2005

- 1. JOHN SULLIVAN CRAIG LT JG USAF WWII
- 2. 31 JAN 1915 - 17 NOV 1992 OSSW LEE JUSTIN STEWART 26 SEP 1981 - 26 APR 1979
- 3. H/W A. GRAHAM FOWLER 1906 - 1974
- 4. MILDRED C. FOWLER 1912 - 1988
- 5. MACIE G. CHAMBLEE ^{17 NOV 26 NOV} 1910 - 1985
- 6. H/W SHERWOOD S. CHAMBLEE ^{16 AUG 14 JUL} 1914 - 1968
- 7. ELIZABETH W. CHAMBLEE ^{24 JUN 24 DEC} 1916 - 2003
- 8a. H/W ALONZO C. CHAMBLEE 1876 - 1944
- 8b. MARY J. HORTON 1885 - 1940
- 9. H/W ROBERT BLACKWELL HORTON ^{3 DEC 1857} -
- 10. ^{12 FEB 1925} MARY THOMAS PIERCE ^{2 MAY 1861} -
- ^{30 MAR 1925} - HE STARTED CEM 1892
- 11. DIXIE L. HORTON ^{5 APR 8 AUG} 1919 - 1927 D/O
- 12/13 H. C. HORTON & CLIDE - -
- 14. H/W HENRY C. HORTON ^{23 MAY 20 JUN 1881} - 1959
- 15. CLIDE W. - ^{5 JAN 28 MAY 1894} - 1960
- 16. INFANT HORTON 27 FEB 1950 D/O
- 17/18 JEFF HORTON & BLANCHE -
- 19. VANCE BERRY HORTON ^{21 FEB 23 NOV 1888} - 1892 S/O
- 20/21 R. B. HORTON & M. T. -
- 22. ROBERT BELL HORTON ^{31 AUG 9 MAY 1899} - 1900 S/O
- 23/24 R. B. HORTON & M. T. -
- 25. ROCK ONLY
- 26. ROCK ONLY
- 27. ROCK ONLY
- ? 28. LEON A. ADAMS ^{22 JUL 6 NOV 1906} - 1969
- 29. H/W NATHAN L. HORTON ^{15 NOV 18 MAR 1878} - 1953
- 30. ALMA L. - ^{8 MAY 5 MAY 1899} - 1950
- 31. H/W SAMUEL L. HORTON ^{1 OCT 6 AUG 1883} - 1935
- 32. VERNONA J. - ^{31 DEC 30 JUN 1891} - 1979
- 33. SAMUEL DEWARNER HORTON ^{25 DEC 19 MAY 1919} - 1924
- S/O 31/32
- 34. MARTHA JOY PERRY 13 FEB 1943 INFANT D/O
- 35. M/M L. S. PERRY
- ? 36. SAMUEL BARBEE HORTON ^{5 SEP 6 SEP 1954} - 1954
- 37. H/W CHARLIE CLARENCE STRICKLAND
- 28 APR 1890 - 19 JUL 1961
- 38. SALLIE KIVA HORTON ^{7 FEB 18 OCT 1890} - 1918

- 39. H/W LOWERY S. PERRY ^{12 NOV 6 DEC 1915} - 1982
- 40. ADELAIDE S. - ^{26 AUG 2 NOV 1916} - 1999
- 41. RODERICK MARION HORTON ^{31 JAN 3 APR 1930} - 1969
- 42. H/W MARION EARL HORTON ^{23 SEP 8 OCT 1892} - 1968
- 43. GOLDIE JEFFREYS HORTON ^{24 OCT 28 FEB 1893} - 1982
- 44. NEEDHAM EARL HORTON ^{21 AUG 16 FEB 1921} - 1998
- 45. DR CHARLES A (ALLISON) HORTON
- VISITOR IN CEMETERY
- 46. JODA H. - 30 JUL 1897 - 13 SEP 1950
- 47. - W/O L. E. JOHNSON
- 48. H/W JEFFERS CLAY HORTON ^{30 AUG 10 OCT 1914} - 1990
- 49. BLANCHE S. - ^{20 OCT 2 MAR 1913} - 1997
- 50. H/W J. ^{AMES} WYATT HORTON ^{10 AUG 29 DEC 1925} - 1996
- 51. MARIE B. - ^{BEDDINGFIELD 26 FEB 1925} -
- 52. H/W ^{WATKINS} W. CLIFTON HORTON ^{24 AUG 12 MAR 1895} - 1983
- 53. MARY W. - ^{20 MAY 29 SEP 1901} - 1991
- 54. MARY NUNNERY HORTON "PEGGY"
- "MOTHER" 17 APR 1922 - 18 MAR 2002
- 55. BRENDA A. ELLINGTON 1947 - 2004
- 56. H/W EDWARD D. ELLINGTON 14 OCT 1916
- 57. - 20 DEC 1998 - DOROTHY H. -
- 31 JUL 1918 - 15 SEP 2003

* CLIFTON WYATT HORTON

R.B. HORTON CEMETERY - ZEBULON, WAKE CO, NC

○ Family linkages based on the R.B. Horton Cemetery on South Wakefield Rd, Zebulon, NC - Recorded by RPU 29 MAR 2005

I. *Allison Robertson Horton b 1823 → He started the cemetery in 1892

A. Robert Blackwell Horton 3 DEC 1857 - 12 FEB 1925
 md (1) Mary Thomas Pierce 2 MAY 1861 - 30 MAR 1925

NOTED 3
 ROCKS - NO
 INSCRIPTIONS

1. Samuel L. Horton [vs *Samuel Allison Horton?] 1 OCT 1883 - 6 AUG 1935 md (1) Verana *Jeffreys 31 DEC 1891 - 30 JUN 1979

Son of
 * Sidney
 Columbus
 Chamblée

a. Samuel DeWarner Horton 1919 - 1921
 2. Mary J. Horton 1885 - 1940 md (1) Alango C. Chamblée 1876 - 1944

3. Henry *Clay Horton 23 MAY 1881 - 20 JUN 1959 md (1) Clyde Wilkinson 5 JAN 1894 - 28 MAY 1960

a. Dixie L. Horton 5 APR 1919 - 8 AUG 1927
 b. Jeffers Clay Horton 30 AVE 1914 - 10 OCT 1990 md (1) Blanche * Sutton 20 OCT 1913 - 2 MAR 1997
 i. Infant Horton 27 FEB 1950

a. Needham Earl Horton 21 AUG 1921 - 16 FEB 1998
 b. Charles Allison Horton II
 C. Roderick Marion Horton 31 JAN 1930 - 3 APR 1969
 d. Dorothy * Horton 31 JUL 1918 - 15 SEP 2003 md (1) Edward D. Ellington 14 OCT 1916 - 20 DEC 1998
 i. Brenda A. Ellington 1949 - 2004

* Emma Horton md (1) John Sullivan Craig (LTJG USN WWII 31 JAN 1915 - 17 NOV 1992)
 i. * Deborah Craig md (1) * Ralph Lee Stewart, Jr 26 SEP 1901 - 26 APR 1999
 (I) Lee Justin Stewart 1901 - 1999

4. Sallie Kina Horton 7 FEB 1890 - 18 OCT 1918 md (1) Charlie Clarence Strickland 28 APR 1890 - 1961
 5. * Earl Marion Horton (AKA Marion Earl Horton) 23 SEP 1892 - 8 OCT 1968 md (1) Goldie Jeffreys 24 OCT 1873 - 28 FEB 1982

6. Wyatt * Clayton Horton [CLIFTON WYATT HORTON] 24 AUG 1895 - 12 MAR 1983 md (1) Mary Bell * Watkins 20 MAY 1901 - 29 SEP 1997
 a. J. Ames Wyatt Horton 10 AUG 1925 - 29 DEC 1996 md (1) Marie B. [BEDFORD FIELD] b 26 FEB 1925 d - - -

7. Joda * Horton 30 JUL 1897 - 15 SEP 1950 md (1) * Lexie E. Johnson
 8. Vance Berry Horton 21 FEB 1888 - 23 NOV 1892
 9. Robert Bell Horton 31 AUG 1899 - 9 MAY 1900
 10. Nathan L. Horton 15 NOV 1878 - 18 MAR 1953 md (1) Alma * Liles 8 MAY 1879 - 5 MAY 1950

* DETAIL NOT ON MONUMENTS - ADDED BY RPU

|| Charles Allison Horton came to Cemetery on 29 MAR 2005 to visit RPU

NOT LINKED:
 LEON A. ADAMS 22 JUL 1906 - 6 NOV 1969
 SAMUEL BARBEE HORTON 5 SEP 1954 - 6 SEP 1954
 MARY NONNERY HORTON 7 APR 1922 - 18 MAR 2002

a. Marie G. Chamblée 7 NOV 1910 - 26 NOV 1985
 b. Mildred * Chamblée 1912 - 1988 md (1) A. Graham Fowler 1906 - 1974
 c. Sherwood S. Chamblée 16 AUG 1914 - 14 JUL 1968 md (1) Elizabeth W. - 24 JUN 1916 - 24 DEC 2003

NEED CONNECTION TO HORTON FAMILY:
 I. - - HORTON
 A. * Margaret Ireland Horton md (1) Wm Raced Perry.
 i. * PRESLEY PAGE PERRY
 MD INTO UPPOUCH FAMILY

a. Louery Stancel Perry 12 NOV 1915 - 6 DEC 1982 md (1) Adelaide * Strickland 26 AVE 1916 - 2 NOV 1999
 i. Martha Jay Perry 13 FEB 1943 (INFANT)

WAKE
CO, NC

HORTON CEMETERY
ESTABLISHED 1892

2 EBULON, NC = X
BACK TO FRONT

ROWS A →

Recorded Left to Right.

All stones inspected & recorded
by RPD 29 MAR 2005

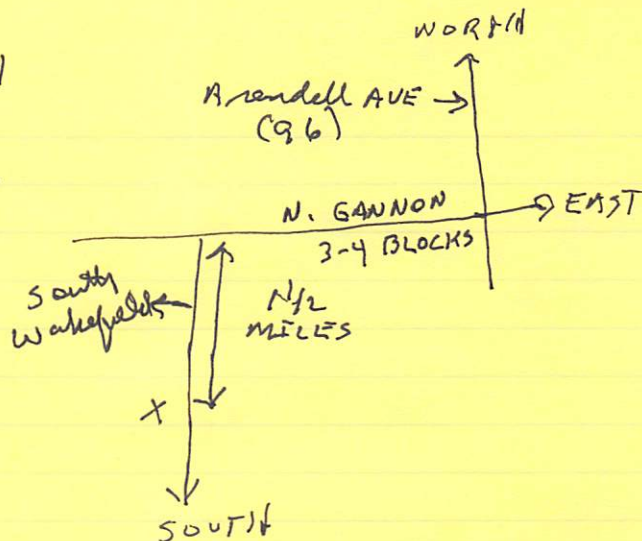

A-1 & 2 - on same stone

John Sullivan GRAIG
LTJG USN WWI
31 JAN 1915 - 17 NOV 1992

Lee Justin Stewart
26 SEP 1981 - 26 APR 1999

A-3 - 1 & 2 W

A. Graham Fowler
1906 - 1974

Maddred C. Fowler
1912 - 1988

A-4
Maie G. Chambliss
? NOV 1910 - 26 NOV 1985

A-5 - 1 & 2 W

Therwood J. Chambliss
16 AUG 1914 - 14 JUL 1968

Elizabeth W. Chambliss
24 JUN 1916 - 24 DEC 2003

A-6 - 1 & 2 W - Alongo C. Chambliss
1876 - 1944

Mary J. Horton - wife [RELATIVE OF
CHARLES A. HORTON]
1885 - 1940

A-7 - 1 & 2 W → Started this cem - Per Charles A. Horton

Robert Blackwell Horton

3 DEC 1857 - 12 FEB 1925

Mary Thomas Pierce

2 MAY 1861 - 30 MAR 1925

A-8-

Dixie L. Horton
5 APR 1919 - 8 AUG 1927
D/O H. C. Horton
& CLYDE Horton

A-9 H & W

Henry C. Horton
23 MAY 1881 - 20 JUN 1959
CLYDE W. Horton
5 JAN 1894 - 28 MAY 1960

A-10 INFANT D/O - 27 FEB 1950

Jeff Horton
& Blanche Horton

B-#1 Vance Berry Horton

21 FEB 1888 - 23 NOV 1892

S/O R. D. Horton

& M. T. Horton

B-2 Robert Bell Horton

31 AUG 1899 - 9 MAY 1900

S/O R. B. Horton

& M. T. Horton

B-2, 3, 4 - Rocks - No microfilm

C-1 Leon A. Adams

22 JUL 1906 - 6 NOV 1969

C-2 H & W

Nathan L. Horton

15 NOV 1878 - 18 MAR 1953

Alma L. Horton

8 MAY 1879 - 5 MAY 1950

G-3 H & W

Samuel A. Horton

10 OCT 1883 - 6 JUL 1935

VERNONA J. Horton

31 DEC 1891 - 30 JUN 1979

C-4 Samuel DeWarney Horton
 25 DEC 1919 - 19 MAY 1921
 S/O S. A. Horton
 & V. J. Horton.

C-5a Martha Joy Berry
 13 FEB 1943
 Infant D/O m/m
 L. S. PERRY

C-5b Samuel Barber Horton
 5 SEP 1954 - 6 SEP 1954

C-6 - N & W
 Charlie Clarence Strickland
 28 APR 1890 - 19 JUL 1961
 Sallie KIVA Horton
 7 FEB 1890 - 18 OCT 1918

C-7 - N & W
 Lowery S. Perry
 12 NOV 1915 - 2 DEC 1982
 Adelaide S. Perry
 26 AUG 1916 - 2 NOV 1999

D-1. Roderick Marion Horton
 31 JAN 1930 - 3 APR 1969

D-2
 N & W
 Marion Earl Horton
 23 SEP 1892 - 8 OCT 1968
 Goldie Jeffreys Horton
 24 OCT 1873 - 28 FEB 1982

D-3
 N & W
 Nedham Earle Horton
 BRD / 21 AUG 1921 - 12 FEB 1998

D-4
 Dr Charles A. Horton [A = Alvin]
 "music was his life"

D-5 - JOHNSON -
Ioda N. Norton
30 JUL 1897 - 15 SEP 1950
w/o L. E. JOHNSON

D-6 H & W
Jefferis Clay Norton [USA]
30 AUG 1914 - 10 OCT 1990
Blanche S. Norton
20 OCT 1913 - 2 MAR 1957

E-1 H & W
J. Wyatt Norton
10 AUG 1925 - 29 DEC 1996
Marie B. Norton
26 FEB 1925 - —

E-2 H & W
W. Clayton Norton
24 AUG 1895 - 12 MAR 1983
Mary W. Norton
20 MAY 1901 - 29 SEP 1991

E-3 Mary NUNNERY Norton "Matts"
17 APR 1922 - 18 MAY 2002
"PEGGY"

F-1 ~~1947~~ Brenda A. Ellington
1947 - 2004

F-2 H & W
Edward D. Ellington
14 OCT 1916 - 20 DEC 1998
Dorothy H. Ellington
31 JUL 1918 - 75 SEP 2003

KESLEY P. PACE CEMETERY - ZEBULON, WAKE CO, NC

PACE CEMETERY RECORDS - GREEN PACE ROAD - ZEBULON, NC
RECORDED BY RPU 29 MAR 2005

PACE FAMILY
□ = IN WAKE
CO, NC HERITAGE
BOOK (FAMILIES
- 589, 590, 591)
OR FIT INTO
FAMILY KNOWN

- A1- Johnnie Scarboro Pace - BRD 18 FEB 1934 - 15 AVE 1998
- A2- Louise Pace Duke - MOT 13 NOV 1916 - 7 OCT 1973
- B1- - - PACE d 1895 AGE 12 YRS
- B2- - - HORTON d 1898 AGE 19 MOS
- * B3- H/W Sylvester V. Horton 30 OCT 1856 - 31 JUL 1918
- Mary Pace Horton 24 OCT 1861 - 26 NOV 1920 [MARY CATRE PACE]
- B4- Fred D. Pace 10 FEB 1896 - 1 SEP 1951 [FRED DAVID PACE]
- B5- Charles W. Pace 15 JUL 1918 - 2 NOV 1933
- B6- Iola Tippet Pace 15 OCT 1893 - 3 MAR 1947
- B7- Charles Wayne Pace SSGT-USAf-KOOL APR 1929 - 2 MAR 1972
- C1- - - PACE 28XXX 1930 - 9 MAY 1901 [REBECCA SCARBROUGH
- C2- Debbie A. Pace 23 SEP 1866 - 1 JUL 1883 → - 28 MAY 1830 - 9 JUL 1901]
- C3- Presley P. Pace 4 JAN 1830 - 24 JUL 1893
- C4- Robert Lee Pace 7 NOV 1897 - 27 JUN 1898 [BRD & STS]
- Ora C. Pace 18 MAR 1889 - 12 MAY 1890
- C5 - Warren E. Pace SSGT shot down + died - Germany
- Bus NEUVILLE EN-CONDRAS - BELGIUM 15 JUL 1921 - 26 NOV 1943
- D0 S/O C.D. PACE & ANNIE G. PACE
- C6- Janny D. Pace 13 OCT 1893 - 20 OCT 1923 [JOHN DANIEL PACE]
- C7- H/W Andrew N. Jones 22 SEP 1873 - 21 JUN 1939
- Annie Pace Jones 6 JUN 1879 - 20 FEB 1991 [ANNIE REBECCA PACE]
- C-8 - MATOKA PACE 4 MAY 1890 - 15 NOV 1952 [LILLIAN MATOKA PACE]
- D-1 Iola V. Pace 14 NOV 1889 - 15 JUL 1918
- D-2 BURLINE L. PACE 22 JUN 1832 - 4 AVE 1909 [WIF OF SAM DUNCH]
- D-3 Emma C. Pace 21 OCT 1867 - 4 MAR 1913 [EMMA CLEVIA PEEBLES]
- D-4 C. D. Pace 23 FEB 1865 - 30 MAY 1954 [CHARLES D. PACE]
- D5 - Annie Green Pace 31 OCT 1886 - 18 JUN 1912
- D6- H/W Percy Page Pace 1 JAN 1892 - 4 MAY 1917
- Lovell Green Pace 21 JUN 1896 - 18 APR 1980
- D7 H/W Charles B. Pace 1901 - 1980
- Annie M. Pace 1908 - 1994 [ANNIE RUTH MANGUM]

□ * Grandparents of Douglas Scaler Chambers
□ S/O FRED DAVID PACE

A copy placed in Burial of each person mentioned - RPU 10 APR 2005

WAKE

CO, NC

PACE CEMETERY

All stones inspected & recorded
by RPU 29 MAR 2005 (1)

4 ROWS A → D (SOUTH TO NORTH (ROAD))

Recorded Left → Right

- Exit US 64 in Zebulon
on NC 96 (Amundell Ave)
go N ^{GREEN} about 1 mile - turn left
on Pace Rd. abt 1 mile.
Cem on South side of Road

Δ A-1 Johnnie Scarboro Pace - Brother
18 FEB 1934 - 15 AVE 1998

Δ A-2 Louise Pace Duke - Mother
13 NOV 1916 - 7 OCT 1973

B-1 - unable to read d 1895

age 12 years - - PACE

B-2 unable to read d 1898

age 19 months - DORRAN

B-3 H & W

Δ Sylvester V. Hartman
3 OCT 1856 - 31 JUL 1918

Δ Mary Pace Hartman
24 DEC 1861 - 26 NOV 1920

Δ B-4 Fred D. Pace
10 FEB 1896 - 15 SEP 1951

Δ B-5 Charles W. Pace
15 JUL 1918 - 2 NOV 1933

Δ B-6 Iola Tappett Pace
15 OCT 1893 - 3 MAR 1949

Δ B-7 Charles Wayne Pace
S Sgt USAF Korea
1 APR 1929 - 2 MAR 1972

C-1 Unstable ~~to~~ Read
28 XXX 1830 - 9 MAY 1901
- - PACE

Δ C-2 Deborah A. Pace
23 SEP 1866 - 1 JUL 1883

Δ C-3 Presley P. Pace
4 JAN 1830 - 24 JUL 1893

C-4 14 & W (?) - on same stone (Bro & Sis?)

Δ Robert Lee Pace
7 NOV 1897 - 27 JUN 1898

Δ Ma C. Pace
18 MAR 1889 - 12 MAY 1890

Δ C-5- Staff Sgt Warren G. Pace
1 JUL 1921 - 26 NOV 1943
Shot down & died over German
Bay NEUVILLE - EN CONTRAZ
Belgium - S/o

Δ C. D. Pace &
Annie E. Pace

Δ C-6 Johnnie D. Pace
13 OCT 1893 - 2 OCT 1923

Δ C-7 John - N & W
Annie Pace Jones
6 JUN 1899 - 20 FEB 1991

Δ Andrew N. Jones
22 SEP 1873 - 21 JUN 1939

Δ C-8 MATOKIA Pace
4 MAY 1890 - 15 NOV 1952

- Δ D-1 Iola V Pace
 14 NOV 1889 - 1 JUL 1918
- Δ D-2 BURLINE L. Pace
 22 JUN 1892 - 4 AUG 1909
- Δ D-3 Emma C. Pace
 21 OCT 1867 - 4 MAR 1913
- Δ D-4 C. D. Pace
 23 FEB 1865 - 30 MAR 1954
- Δ D-5 Annie GUESS Pace
 31 OCT 1886 - 18 JUN 1962
- D-6 H & W
- A Perry PAGE Pace
 15 AN 1892 - 4 MAR 1967
- Δ Luella Green Pace
 21 JUN 1896 - 18 APR 1988
- D-7 H & W
- Δ Charles B. Pace
 1901 - 1980
- Δ Annie M. Pace
 1908 - 1994

○ RECONCILIATION OF TWO LISTINGS OF THE PRESLEY
P. PACE CEMETERY - GREEN PACE RD - ZEBULON, NC

1 BY BILL KEMP ON 5 AUG 1998 (TO RPU by Rebecca
Christensen in #s 24 APR 2005

2 BY RPU ON 29 MAR 2005

A. More complete details - by BK

Two young children of Sylvester V. Norton

Δ . ESSIE DAYNE NORTON d 12 DEC 1895 age 12 yrs

Δ . HALBERT NORTON d 6 MAY 1890 age 19 months

B. For B. L. PACE 22 JUN 1832 - 4 AUG 1909 [MRS SAM BUNCH]

Δ RPU shows B = BURLINE } need to

BK shows B = BERLINE } resolve

[Wahl Co, NC Heritage Book Family # 591 shows B = BURLINE

C. For Charles Wayne Pace

RPU shows b 1 APR 1929 d 2 MAR 1972 } Assume Bill
BK shows b 11 APR 1929 d 21 MAR 1972 } is correct - RPU

D. For L. Walle Green Pace

RPU shows d 1980; BK shows d 1988 - Assume Bill is
correct - RPU

E. For Andrew Jones

RPU shows Andrew N. Jones; BK shows Andrew M. Jones
Assume Bill is correct

F. For Ora C. Pace

RPU shows b 18 MAR 1889; BK shows b 16 MAR 1889
other info shows 16 MAR 1889 is correct.

Wake County, NC - Cemeteries

File contributed for use in USGenWeb Archives by
Wake County USGenWeb

PRESLEY P. PACE CEMETERY

Wake County, NC

Surveyed by Bill Kemp on 8-5-1998

Location: Down Green-Pace Road off of Hwy 96 in Wakefield section of Zebulon, NC

1. PACE, Iola V. Nov 14 1859 July 1 1918
2. PACE, Berline L. June 22 1832 Aug 4 1909
3. PACE, Emma C. Oct 21 1867 Mar 4 1913
4. PACE, C.D. Feb 23 1865 May 30 1954
5. PACE, Annie Guess Oct 31 1886 June 18 1962
6. PACE, Percy Page Jan 1 1892 May 4 1967 mar Lucille
7. PACE, Lucille Green June 21 1896 Apr 18 1988
8. PACE, Charlie B. Nov 17 1901 Nov 24 1980 (Charlie Boy) mar Annie
9. PACE, Annie M. June 25 1908-Jan 1, 1994 (Annie Ruth)
10. Motoka(?) May 4 1890 Nov 15 1952
11. JONES, Andrew M. Sep 22 1873 Jun 21 1939
12. JONES, Annie Pace Jun 6 1899 Feb 20 1991
13. PACE, Johnny D. Oct 13 1893 Oct 2 1923
14. PACE, Warren G. SSgt Jul 1 1921 Nov 26 1943 In memory of _____ son of C.D. and Annie Pace shot down over Germany buried in US Cemetery Neuville-en-Combroz, Belgium, picture on stone
15. PACE, Robert Lee Nov 7 1897 Jun 27 1898
16. PACE, Ora C. Mar 16 1889 May 12 1890
17. PACE, Presley P. Jan 4 1830 Jul 24 1893
18. PACE, Debbie A. Sep 23 1866 Jul 1 1883
19. PACE, Rebecca A. May 28 1830 Jul 9 1901
20. HORTON, Essie Dayne dau of S.V. and Mary Pace Horton Dec 12 1895 age 12
21. HORTON, Halbert died May 6 1890 age 19 months son of S.V. and Mary Horton
22. HORTON, Sylvester V Oct 3 1856 Jul 31 1918 mar Mary
23. HORTON, Mary Pace Aug 24 1861 Nov 25 1920
24. PACE, Fred D. Feb 10 1896 Sep 1 1951
25. PACE, Charles W. Jul 15 1918 Nov 2 1933
26. PACE, Iola Tippet Oct 15 1893 Mar 3 1947

27. PACE, Charles Wayne Apr 11 1929 Mar 21 1972 US Air Force SSgt Korea

28. DUKE, Louise Pace Nov 13 1916 Oct 7 1973

USGENWEB NOTICE: In keeping with our policy of providing free information on the Internet, data may be used by non-commercial entities, as long as this message remains on all copied material. The electronic pages may NOT be reproduced in any format for profit or for presentation by other persons or organizations. Persons or organizations desiring to use this material for purposes other than stated above must obtain the written consent of the file contributor, and contact the listed USGenWeb archivist with proof of this consent. The submitter has given permission to the USGenWeb Archives to store the file permanently for free access.

PACE CEMETERY - ZEBULON, WAKE CO, NC

PACE CEMETERY RECORDS - GREEN PACE ROAD - ZEBULON, NC
RECORDED BY RPU 29 MAR 2005

PACE FAMILY
□ = IN WAKE
CO, NC HERITAGE
BOOK (FAMILIES
- 589, 590, 591)
OR FIT INTO
FAMILY KNOWN

- A1 - Johnnie Scarborough Pace - BRD 18 FEB 1934 - 15 AUG 1998
- A2 - Louise Pace Duke - MDT 13 NOV 1916 - 7 OCT 1973
- B1 - - - PACE d 1895 AGE 12 YRS
- B2 - - - HORTON d 1898 AGE 19 MOS
- B3 - H/W Sigluster V. Horton 30 OCT 1856 - 31 JUL 1918
- * Mary Pace Horton 24 OCT 1861 - 26 NOV 1920 [MARY CATRE PACE]
- B4 - Fred D. Pace 10 FEB 1896 - 1 SEP 1951 [FRED DAVID PACE]
- B5 - Charles W. Pace 15 JUL 1918 - 2 NOV 1933
- B6 - Lola Tippet Pace 15 OCT 1893 - 3 MAR 1947
- B7 - Charles Wayne Pace SSGT - USAF - Korea 1 APR 1929 - 2 MAR 1972
- C1 - - - PACE 28 XXX 1930 - 9 MAY 1901 [REBECCA SCARBROUGH
- C2 - Debbie A. Pace 23 SEP 1866 - 1 JUL 1883 → - 28 MAY 1830 - 9 JUL 1901
- C3 - Presley P. Pace 4 JAN 1830 - 24 JUL 1893
- C4 - Robert Lee Pace 7 NOV 1897 - 27 JUN 1898 [BRD & STS]
- Ora C. Pace 18 MAR 1889 - 12 MAY 1890
- C5 - Warren G. Pace SSGT shot down + died - Germany
- But NEVILLE EN - CONDOR - BELGIUM 15 JUL 1921 - 26 NOV 1943
- + □ s/o C. D. PACE & ANNIE G. PACE
- C6 - Janny D. Pace 13 OCT 1893 - 20 OCT 1923 [JOHN DANIEL PACE]
- C7 - H/W Andrew N. Jones 22 SEP 1873 - 21 JUN 1939
- Annie Pace Jones 6 JUN 1879 - 20 FEB 1991 [ANNIE REBECCA PACE]
- C8 - MATOKA PACE 4 MAY 1890 - 15 NOV 1952 [LILLIAN MATOKA PACE]
- D-1 Lola V. Pace 14 NOV 1889 - 1 JUL 1918
- □ D-2 BURLINE L. PACE 22 JUN 1832 - 4 AVE 1909 [WIF OF SAM BUNCH]
- D-3 Emma C. Pace 21 OCT 1867 - 4 MAR 1913 [EMMA CLIVIA PEEBLES]
- D-4 C. D. Pace 23 FEB 1865 - 30 MAY 1954 [CHARLES D. PACE]
- D5 - Annie Green Pace 31 OCT 1886 - 18 JUN 1962
- D6 - H/W Percy Page Pace 1 JAN 1892 - 4 MAY 1929
- Luvell Green Pace 21 JUN 1896 - 18 APR 1980
- D7 H/W Charles B. Pace 1907 - 1980
- Annie M. Pace 1908 - 1994 [ANNIE RUTH MANGUM]

□ * Grandparents of Douglas Seales Crumhles
s/o FRED DAVID PACE

A copy placed in Briefcase of each person mentioned - RPU 10 APR 2005

Index of Zebulon Town Cemetery Survey, by Willa Bolton Deans and Gordon W. Deans

Editor's note: Following are the introduction and index from the complete work. The full survey has been provided to the Olivia Raney Library.

The cemetery is located in Zebulon, Wake County, North Carolina. Specific location is North Whitley Street off Gannon Ave. (N.C. Highway 97 West) in Zebulon. The public cemetery has approximately 1100 identifiable graves. It is currently being used and is well maintained and preserved by the town.

The contents of these pages may be freely used by individuals for non-commercial genealogical purposes including contributing a print copy to your local non-profit genealogical society, public library, or historical research center, provided this message remains on all copied material AND written permission is obtained from the author.

This cemetery survey was conducted by:
Willa Bolton Deans & Gordon W. Deans
3505 Arrowwood Dr., Raleigh, N.C. 27604
(919) 876-3990
E-mail wbdeans@aol.com

August 2003

Aphabetical Index for Zebulon Cemetery

Alford, Bertha P. 1906 - 2003	Alford, Lillie Taylor 1895-1978
Alford, Bessie Mae 1916-1991	Alford, Martha B. 1913 - 1971
Alford, Cecil Calbert 1920 -	Alford, Maultis S. 1891-1955
Alford, Charles W. 1935 - 1981	Alford, Maves W. 1896-1921
Alford, Degalma G. 1918-1919	Alford, Maylon B. 1914-1987
Alford, Dollie B. 1926 - 1973	Alford, Melba M. 1916-1921
Alford, Dr. James David 1938-2001	Alford, Millard H. 1903 - 1962
Alford, Herbert Forest 1915-1937	Alford, R. Berkley 1910 - 1977
Alford, infant daughter of	Alford, Sonnie Douglas 1921-1991
S.D. & Bessie M. Alford 1950	Alford, Susie B. 1892 - 1968
Alford, Infant son of	Alford, Sylvia Faye 1939-1939
J. R. & Roslyn Alford 1944	Alford, Talmadge B. 1937-1998
Alford, James Raleigh 1907-1982	Alford, Theda Privette 1921 - 1998
Alford, Janis E. 1918-1990	Alfred, DeElla 1861 - 1935
Alford, Jo Perry 1937-	Allman, Edna Bunn 1912-2003
Alford, Jonnie W. 1884 - 1939	Allman, Frederick Lee 1907-1976
	Allman, Lee 1874-1945
	Allman, Mary Ann Angel 1876-1954
	Allman, Mary Peddicord 1906-1992

- Allman, William Andrew, Sr. 1910-1966
 Alphin, Douglas Wayne 1942-
 Alphin, Katherine Long 1944-2001
 Ange, Luther M. 1921-1951
 Antone, Abdolla D. 1882-1957
 Antone, Bettie S. 1892-1971
 Arnold, Anne Yvonne 1932 – 2003
 Arnold, Annie Debnam 1904 – 1966
 Arnold, David R. 1892 – 1959
 Arnold, Johnsey Perry 1919-
 Arnold, Virginia Dare Clark 1920-1998
 Atwood, Mary 1893 - 1968
 Ayscue, Hal Erby 1952-1995
 Ayscue, Janie Brantley 1948-
 Bailey, Amon M. 1891 – 1970
 Bailey, James B. 1944 – 2000
 Bailey, Lula E. 1906 – 2000
 Baker, Armor Floyd 1914 - 1982
 Baker, B. Claude 1901 – 1972
 Baker, Carl Lee 1909 – 1984
 Baker, Darnell Thomas 1925-1992
 Baker, Earl D. 1941 –
 Baker, Frederick V. 1940 – 1969
 Baker, Helen 1908 - 1987
 Baker, J. Simon 1883 – 1960
 Baker, Jane 1928 -
 Baker, Jonah C. 1914 – 1987
 Baker, Judy U. 1939 –
 Baker, Oliver J. 1878 – 1961
 Baker, Pauline H. 1904 – 1982
 Baker, Rosa R. 1888 – 1970
 Baker, Ruby Creech 1928-
 Baker, Susan C. 1882 – 1965
 Baker, Wesley Theodore 1927-1991
 Barbee, George Sprite 1917-1964
 Barbee, George Sprite, M.D. 1887-1953
 Barbee, Infant son of
 G.S. & N.F. Barbee 1915
 Barbee, Neva Flowers 1893-1962
 Barbour, Dwight DeVan 1958 – 1961
 Barham, Fannie C. Horton 1931 – 1957
 Barnes, Lucy Curtis 1909 – 1973
 Barrett, Frances Moseley 1917 – 1996
 Bass, Nancy Bunn 1903-1940
 Bass, William Arthur 1900-1967
 Batchelor, Lou T. 1878 – 1950
 Bell, Bill Everett 1925-1994
 Bell, Harold Everett, infant son of
 Hunter & Lois Bell 1920
 Bell, Iva Pearl McNabb 1898-1966
 Bell, Joris R. 1897-1954
 Bell, Lois P. 1900-1987
 Bell, T. Hunter 1900-1946
 Bell, Thomas H., Jr. 1921-1998
 Billings, Rev. C. M. 1866-1934
 Bisette, Minda F. 1893-1920
 Black, Inez Brantley 1931-1998
 Boddie, Laura Odell 1887 – 1926
 Bogan, Mrs. Lanie M. 1908 - 1984
 Bolton, Ann Dora 1930 – 1932
 Bolton, Fannie W. 1901 – 1968
 Bolton, James W. 1932 – 1970
 Bolton, Willie W. 1905 – 1941
 Boswell, Howard F. 1879 – 1964
 Boswell, Vandelia T. 1880 – 1954
 Bottoms, Myra 1901 - 1987
 Boyette, Allen P. 1912 – 1969
 Boyette, Merle Sue 1911 - 1984
 Boykin, Berry B. 1878 – 1958
 Boykin, Betty Mae Puckett 1947-1999
 Boykin, Donnie B. 1902 – 1979
 Boykin, Laura S. 1909 – 1995
 Boykin, Marlon 1946-2000
 Boykin, Robert S. 1912 – 1966
 Boykin, Rozetty B. 1888 – 1980
 Boykin, Thurman L. 1924 – 1973
 Bradley, Doris F. 1922 – 1982
 Bradley, Jesse B. 1923 – 1982
 Brannan, G. C. 1887 – 1971
 Brannan, Millard C. 1908 – 1986
 Brannan, Pearl Pearce 1886 – 1951
 Brannan, Willie M. 1910 – 1995
 Brannon, James Edwin 1912 – 1978
 Brantley, James 1891 – 1957
 Brantley, Alva Katherine b&d 1924
 Brantley, Annie B. 1925 –
 Brantley, Aradella H. 1868-1950
 Brantley, Aurelia 1894-1947
 Brantley, Barbara Nell 1930 – 1933
 Brantley, Bernard W. 1888-1963
 Brantley, Bertie L. 1925-1995
 Brantley, C. E. (Bruce) 1895-1935

- Brantley, Christopher L. 1895-1962
 Brantley, Christopher S. 1861-1928
 Brantley, Crystal Olive 1914-1917
 Brantley, Dennis B. 1917-1989
 Brantley, Dixie 1910 - 1992
 Brantley, Dorothy C. 1930-
 Brantley, E. Guarica 1867-1906
 Brantley, Ettrice 1899-1989
 Brantley, Flonnie O'Neal 1890-1966
 Brantley, Ida W. 1867-1947
 Brantley, James Glenwood 1917-1919
 Brantley, Jerome B. 1897-1943
 Brantley, Jessie C. 1898-1985
 Brantley, Jodie C. Brewer 1894 - 1974
 Brantley, Julius Askew 1894-1924
 Brantley, Lecy P. 1859-1939
 Brantley, Leondias S. 1886-1964
 Brantley, Martha E. 1923-1986
 Brantley, Mary Leigh 1926-1993
 Brantley, Mary W. 1915-1974
 Brantley, Mildred M. 1908-1945
 Brantley, Nancy 1861 - 1939
 Brantley, Nina E. 1891-1920
 Brantley, Oza May 1906-1992
 Brantley, Paul Vincent 1899-1956
 Brantley, R. Frank 1854-1927
 Brantley, Sherwood 1893 - 1967
 Brantley, Toby B. 1928-1971
 Brantley, W. O., Jr. 1919-1920
 Brantley, W. Oscar 1891-1927
 Brantley, William 1926-
 Brantley, William R. 1855-1930
 Braswell, Ida Bunn 1881-1935
 Braswell, Judson A. 1871-1956
 Braswell, L. Francis 1865-1928
 Braswell, Mary A. 1833-
 Braswell, Oscar A. 1834-1912
 Braswell, Wilson B. 1913-1993
 Bridges, Billy Hill 1935-1936
 Bridges, Ivey Perry 1892-1984
 Brock, George Otis 1918 - 1969
 Brogden, Nancy Louise Brown 1938-
 1999
 Broughton, Carrie G. 1888-1967
 Broughton, Dwight 1910-1911
 Broughton, John 1875-1966
 Broughton, LaRue 1901 - 1997
 Broughton, Lou Whitley 1866-1918
 Broughton, W. S. 1848-1918
 Broughton, W. S., Jr. 1873-1954
 Brown, Aramenta 1910-1988
 Brown, Avern Albert 1923-1945
 Brown, David Scott 1921 - 1989
 Brown, Ethel Hitchcock 1900 - 1973
 Brown, Hazel W. 1913 - 1967
 Brown, Martha Foy 1919 - 1985
 Brown, Robert Vance 1900 - 1984
 Browne, W. Russell 1899 - 1968
 Bruce, Irene Kemp 1912-1989
 Bruce, John 1912-1987
 Bryant, Alton 1939 - 1978
 Bryant, Annie 1890 - 1944
 Bryant, Foye Fuller 1924 - 1990
 Bullock, Brenda M. 1943 -
 Bullock, Dixie Brantley 1910 - 1992
 Bullock, Joel Stanley 1942 - 1999
 Bullock, Willie Edwin 1939 - 1956
 Bullock, Willie L. 1907 - 1989
 Bulluck, Charlie Ray 1939 - 1999
 Bunn, Addie Young 1912 - 2003
 Bunn, Christine 1911 - 1998
 Bunn, Edgar R. 1870-1956
 Bunn, Edna 1912 - 2003
 Bunn, Emma Rilda 1878 - 1943
 Bunn, Essie Nowell 1912 - 1931
 Bunn, G. M. 1874-1927
 Bunn, Gladys 1906 - 1992
 Bunn, Grace McLeod 1905 - 1997
 Bunn, Infant of WB & Essie B. b&d
 1931
 Bunn, Infant of WB & MEJ b&d 1928
 Bunn, Infant of WB & MEJ b&d 1926
 Bunn, Jackson Howard 1900 - 1990
 Bunn, Jackson Howard, Jr. 1937 - 2002
 Bunn, James 1832-1900
 Bunn, James Troy 1909-1911
 Bunn, John Howard 1876 - 1942
 Bunn, Katie 1917 - 1963
 Bunn, Lizzie H. 1878-1933
 Bunn, Mamie Jeffreys 1905 - 1928
 Bunn, Margaret McLeod 1927 -
 Bunn, Mary Westray 1879 -1950

- Bunn, Melba Pearce 1919 – 1996
 Bunn, Minda L. Kemp 1881-1964
 Bunn, Myrcelle 1915 -
 Bunn, Nancy 1903 – 1940
 Bunn, Pattie 1909 - 1991
 Bunn, Paul Vernon 1902 - 1954
 Bunn, Roger Pettigrew 1901-1902
 Bunn, Sarah A. 1840-1911
 Bunn, Sidney Glenn 1908 – 1989
 Bunn, Thelma Long 1912 – 1980
 Bunn, William Bernice 1905 – 1977
 Bunn, William Cullen 1918 – 1978
 Burdick, Lois Earp 1933 – 1984
 Burgess, Annie J. 1910 – 1969
 Burgess, William E. 1905 – 1968
 Byrd, Katherine L. 1904 – 1983
 Byrd, Malcolm M. 1919 – 1999
 Bzik, Joseph J. 1922 – 1982
 Bzik, Mary B. 1920 –
 Cahoon, John B. 1875 – 1949
 Cahoon, Myrtle Holmes 1897 - 1989
 Campen, Mary F. 1887-1965
 Campen, Wilbur C. 1887-1966
 Carlyne, Betty Sue 1947 – 1994
 Carter, Betty 1928-1996
 Carter, David L. 1919 – 1968
 Carter, Infant son of
 J. E. & Urtice Carter 1925
 Carter, Gertrude 1920 - 1998
 Carter, Jeffrey E. 1891-1941
 Carter, Manuel C. 1905-1950
 Carter, Mary P. 1911-1989
 Carter, Urtrice B. 1900-1986
 Cates, Elizabeth H. 1918-1972
 Cates, H. Grady, Sr. 1895-1961
 Cates, Henry G., Jr. 1918-1979
 Causey, Nancy Marie 1942 – 1960
 Cawthorne, Bruce B. 1888-1948
 Cawthorne, John A. 1880-1948
 Cawthorne, John Allen 1909-1982
 Chamblee, Carolyn B. 1911-1963
 Chamblee, Cassandra H. 1886-1973
 Chamblee, Cleveland S. 1884-1952
 Chamblee, Durwood D. 1886-1959
 Chamblee, Ella Whitley 1879-1937
 Chamblee, Elton C. 1934-1980
 Chamblee, Ernestine 1934-
 Chamblee, Estelle 1902 - 1991
 Chamblee, Frederick F. 1919-1959
 Chamblee, Ginger Paulette 1958-1960
 Chamblee, Gregory Cooke 1961-1983
 Chamblee, Kenneth D. 1874-1918
 Chamblee, Lucille 1909-1982
 Chamblee, M. Seymour 1868-1939
 Chamblee, Myra Bottoms 1901-1987
 Chamblee, Oletha 1916 - 1986
 Chamblee, Pleasant D. 1905-1927
 Chamblee, Rev. Edward C. 1908-1998
 Chamblee, Robert A. 1907-1962
 Chamblee, Roxie Alford 1911-1990
 Chamblee, Ruth B. 1886-1946
 Chamblee, Sarah E. 1851-1918
 Chamblee, Sidney C. 1847-1917
 Chamblee, Sue 1872-1921
 Chamblee, Thomas S. 1881-1918
 Chamblee, Tillie G. Ranes 1885-1939
 Chamblee, William "Billy" 1939-2001
 Chamblee, Z. W. 1907-1964
 Chaves, Jonathan F. 1989 – 1991
 Clark, Charlie M. 1884-1967
 Clark, Clair Marshall 1881-1962
 Clark, Daphne Lewis 1924 –
 Clark, David Judson 1901 – 1972
 Clark, Frank Solomon 1892 – 1967
 Clark, Fred G. 1908-1948
 Clark, John A. 1881-1969
 Clark, John A., Jr. 1918-1982
 Clark, Lois P. 1909-1997
 Clark, M. Blanch Tucker 1889-1962
 Clark, Mabel 1901 - 1992
 Clark, Myrtle Gupton 1903 – 1959
 Clark, Virginia Dare 1920 - 1998
 Clark, Whitney L. 1973-1981
 Clayton, G. A. 1888-1930
 Cockrell, Clevie Medlin 1907-1929
 Cockrell, John E. 1907-1950
 Cole, Joseph A. 1937-1993
 Cole, Lois M. 1939-
 Cole, Tony Ray 1960 – 1997
 Coley, Dennis Ray, Sr. 1957-2001
 Colquitt, Fred 1905 – 1985
 Colquitt, Gladys Bunn 1906 – 1992

- Coltrane, Dr. Jesse F. 1882-1976
 Coltrane, Etha K. 1889-1986
 Cone, Anne B. 1926-1999
 Cone, Bertie C. 1876-1923
 Cone, Bettie F. 1871-1972
 Cone, Ellen Ellis 1869-1927
 Cone, Faxton 1917-2002
 Cone, Minnie Gay 1898-1982
 Cone, Nola J. 1880-1932
 Cone, Paul Bertice 1895-1976
 Cone, Susan V. 1872-1922
 Cone, W. G. 1863-1921
 Cone, W. Jerome 1935 - 1973
 Cone, William Henry 1861-1933
 Cone, Willie C. 1888-1924
 Conn, Daphene 1913 - 1969
 Conn, Janet Edwards 1884 - 1973
 Conn, Tollie M. 1880 - 1932
 Conn, Wilber Daniel 1929 -
 Cooley, Joseph L. 1951 - 1990
 Cooper, Charles Due, Sr. 1921 - 1995
 Cooper, Dora Mae Spence 1922 - 1990
 Cooper, Thomas Earl 1943 - 1971
 Corbett, Betty Joann 1934 - 1943
 Corbett, David W. 1952 - 1967
 Corbett, Esten K. 1921-1956
 Corbett, Lila Medlin 1913 - 2003
 Corbett, Oscar O. 1906 - 1966
 Corbett, Pauline Thompson 1909-1981
 Corbett, Sion Zebulon 1906-1973
 Council, Delma Brantley 1906-1965
 Cox, Carlton Reed 1911-1950
 Creech, James Ruffin 1906-1980
 Creech, Ralph 1927-1971
 Creech, Worth Manor 1917 - 1999
 Creech, Zettie Liles 1911-1975
 Creekmore, Baby Boy 1962
 Creekmore, Jimmie Earl 1941 - 1988
 Croom, Charles Samuel 1893 - 1967
 Croom, Nora Pearce 1897 - 1985
 Crowder, Mark Goldon 1896-1968
 Crowder, Myrtie D. 1904-1973
 Culpepper, Dwight Lyman 1884-1958
 Culpepper, Grace K. 1890-1966
 Culpepper, Zollie Nicholson 1887-1960
 Curtis, Charles C. 1935 - 1979
 Curtis, Charley H. 1916 - 1992
 Curtis, Chesley Green 1910 - 1980
 Curtis, Dixon M. 1950 - 1973
 Curtis, Jonnie Sandra 1954 - 1961
 Curtis, Laura Odell 1887 - 1926
 Curtis, Mafar Driver 1924 -
 Curtis, Mary E. Wilder 1912 - 1974
 Curtis, P. G. 1878 - 1952
 Davis, Marvin No dates
 Darr, Aubrey C. 1929-2003
 Davenport, Fred L. 1915-1970
 Davenport, Mary Minnie Fee 1880-1931
 David, Eva A. 1911 - 1968
 David, John Edward 1874-1945
 David, Rena Pearce 1886-1978
 Davis, Alma No dates
 Davis, Bessie Farmer 1881-1952
 Davis, Ferd Leary 1919 - 2002
 Davis, Selma Ann Harris 1923 - 1993
 Davis, Theodore B. 1874-1964
 Davis, Virginia Edwards No dates
 Dawson, Amos C. 1875-1952
 Dawson, Emma R. 1883-1971
 Dawson, Robert W. 1911-1988
 Dawson, Ruby M. 1910-2001
 Deans, Annie 1875 - 1956
 Debnam, Elise 1913 - 1992
 Debnam, Lela Weathersby 1887-1924
 Debnam, Mallie Clifford 1915-1918
 Debnam, Mallie Thurston 1888-1959
 Debnam, Mary Idaline 1918-1920
 Debnam, Mary Mitchell 1890-1968
 Debnam, Mozelle 1918 -
 DeLorenzo, Billie P. 1944 -
 DeLorenzo, David N. 1953 - 1977
 Denton, Addie B. 1888-1932
 Denton, Irene Price 1924 - 2001
 Denton, Vaton Whitley, Sr. 1923 - 1994
 Dew, Addie 1883 - 1970
 Dice, Daphene Conn 1913 - 1969
 Dozier, Robert Martin 1924 - 1985
 Driver, Algar H. 1901 - 1993
 Driver, W. Vance 1897 - 1981
 Duckett, Daphene S. 1892 - 1985
 Duckett, Rex B. 1891 - 1972
 Duke, Billy Mansfield 1924-1958

- Duke, Birtcha Gay 1884-1979
 Duke, Christine 1916 -
 Duke, John Claude 1918-1989
 Duke, Linda Elaine H. 1944-1985
 Duke, Mae Nora O'Neal 1919-1999
 Duke, Willie M. 1889-1952
 Dunn, Dorothy S. 1924 - 1993
 Dunn, Willie G. 1922 - 1986
 Eakes, E. G. 1945-1994
 Eakins, Mary 1904 - 1997
 Earp, Frances 1921 -
 Earp, Jimmy Daylon 1942 - 1990
 Earp, Lois Frances 1933 - 1984
 Eason, Fola McGee 1924 - 2001
 Eason, James Marion 1922 - 1990
 Eaton, Mary 1905 - 1952
 Eddins, Braxton Osborne 1926 - 1988
 Eddins, C. Bernice 1884-1961
 Eddins, Doris 1916 - 2001
 Eddins, Elizabeth Ruth 1914-1994
 Eddins, Jane Syvon 1910 - 1987
 Eddins, K. Harold 1916-1959
 Eddins, Mary E. 1886-1949
 Eddins, Myrtle Lee 1916-1927
 Eddins, Sadie Core 1894-1968
 Eddins, W. A. 1889-1936
 Edwards, Woodrow W. 1920 - 1972
 Ellett, Elizabeth W. 1904-1998
 Ellis, Kerman "Herman" 1913 - 1987
 Ellis, Lee 1946 - 2001
 Ellis, Pearline Watkins 1926 - 1998
 Ervin, Zadock 1921 - 1966
 Evans, Lillian Allen 1920-1993
 Evans, Naomi W. 1890-1990
 Evans, Robert Edwards 1910 - 1986
 Evans, Russell B. 1920-1921
 Evans, W. Dolphus 1884-1972
 Evans, Wilton Donahue 1916-2000
 Faison, Herbert 1905 - 1978
 Farmer, Bessie 1881 - 1952
 Farrington, Doris Eddins 1916 - 2001
 Farrington, William Claude 1917-1993
 Faulkner, Timothy J. 1963 - 1979
 Faulkner, Zollie E. 1895 - 1930
 Ferebee, Ella Guarica 1913-1996
 Ferebee, Harold R. 1915-1971
 Ferebee, Lois B. 1894-1972
 Ferebee, Samuel J. 1891-1960
 Ferguson, Rachel Creech 1945-1999
 Ferrell, H. Orrin 1904-1952
 Ferrell, Ora T. 1891-1977
 Finch, Alma Fisher 1893-1992
 Finch, Bettie Hales Perry 1916-2001
 Finch, Caniza L. 1866-1952
 Finch, Charles Brooks 1934 - 1997
 Finch, Elma Louise 1935
 Finch, Elmer D., Jr. 1911 - 1937
 Finch, Elmer Davis 1892 - 1973
 Finch, Foster Davis 1896-1984
 Finch, J. Stuart 1923 - 1982
 Finch, John D. 1868-1949
 Finch, Joseph F. 1850-1935
 Finch, Journey Graham 1902-1972
 Finch, Kathy Elma b&d 1960
 Finch, Lettie U. 1883 - 1961
 Finch, Margaret Harris 1903-1988
 Finch, Marie Watson b&d 1946
 Finch, Mattie Fowler 1904-1985
 Finch, Minnie Finch 1891 - 1998
 Finch, Neuma Elmo 1927 - 1984
 Finch, Pamela Joy 1954-1993
 Finch, Ruby D. 1925-1929
 Finch, Sallie B. 1868-1955
 Finch, Sanford M. 1883 - 1931
 Finch, Waylon Douglas 1890-1979
 Finch, Wm. Russell, Infant son of
 Foster Davis & Margaret Finch 1931
 Fisher, Ida Love 1866-1928
 Fisher, Rev. George W. 1859-1926
 Flowers, Bertha C. 1882-1961
 Flowers, Charles A. 1855-1935
 Flowers, Clarence A., M.D 1880-1935
 Flowers, DeElla Alfred 1861-1935
 Flowers, Fred J. 1896-1941
 Flowers, Marie B. 1894-1981
 Flowers, Martha 1918 - 1945
 Flowers, S. G. 1885-1944
 Fowler, Charles Edward 1910 - 1941
 Fowler, George Elmo 1918 - 1981
 Fowler, Jerry Wayne 1947 - 1982
 Fowler, Linward Ted 1952 - 1988
 Fowler, Louise P. 1916 - 1982

- Fowler, Seaward New 1952 - 1994
 Fowler, Tiffany Sian b&d 1976
 Fox, Abbie Mc. 1880 - 1961
 Fox, Ada Wagner 1883 - 1958
 Frazier, Jeffrey Todd 1969-1996
 Frazier, Sue F. 1862 - 1932
 Fuller, Coye W. 1891 - 1978
 Fuller, J. B. No dates
 Fuller, Lorindy B. Richardson 1874-1946
 Fuller, Studie U. 1899 - 1978
 Fuller, Walter T. 1914-1997
 Gabriel, Margaret 1911-1915
 Gadd, Robert Waterman 1874-1917
 Gainey, Mildred S. 1913-1989
 Gainey, Ray B. 1913-1955
 Gay, Bertie E. 1888-1960
 Gay, Bertie Geron 1913-1967
 Gay, Grace P. 1910-1997
 Gay, John Paul 1933-1994
 Gay, Lillie Driver 1914-
 Gay, Ora M. 1894-1969
 Gay, Perrine Vail 1933-2002
 Gay, William Percival 1915-1992
 Gill, Allie Ann 1884 - 1957
 Gill, Clara Catrina 1906 - 1981
 Gill, Ezra Burtie 1878-1941
 Gill, J. E., Jr. 1913 - 1940
 Gill, James Edgar 1874 - 1934
 Gill, Silvanious Z. 1880-1936
 Gill, Swannora G. 1917 - 1958
 Gill, Sylvanious P. 1911 - 1993
 Gill, Victoria Brantley 1880 - 1953
 Godwin, Maxine Robertson 1909-1955
 Gordon, Bessie Vann 1895-1974
 Gordon, Henry 1919-1974
 Gordon, Oscar Rolan 1914-1977
 Gordon, Vivian Perry 1919-2002
 Gordon, W. Brent 1922-1943
 Gordon, W. O. 1892-1950
 Green, LaRue B. 1901-1997
 Green, W. Lester 1898-1991
 Griffin, Iva Helen 1894 - 1991
 Grimes, Gertrude Y. 1907 - 1986
 Grimes, Woodrow W. 1916 - 1979
 Griswold, Katie Bunn 1917-1963
 Griswold, Willie G., Sr. 1917-1962
 Gupton, Myrtle 1903 - 1959
 Haithcock, Daphne C. 1900-1987
 Hales, Betty 1916 - 2001
 Hales, Fred P. 1889-1969
 Hales, Viola L. 1895-1980
 Hales, Wilbur Cone 1923-1994
 Hall, Elsie B. 1936 - 2000
 Hall, Ida Hunt 1883-1974
 Handy, Pacia Louise 1913 - 1994
 Harper, Bettye Brooks 1926-1927
 Harper, Bettye Finch 1928-1933
 Harrell, James T. 1890-1970
 Harris, Eva 1901 - 1974
 Harris, Jack R. 1906-1930
 Harris, Pattie Bell Chamblee 1881-1952
 Harris, S. W. 1869-1928
 Harris, Selma Ann 1923 - 1993
 Harrow, Maudie Brantley 1902-1989
 Harrow, Richard Nelson 1937-1984
 Hewitt, Ila J. 1912 - 1970
 Hicks, Ann 1921 - 1997
 Hicks, Billy Thomas 1953-1976
 Hicks, Cleo 1923 - 1987
 Hicks, Cleveland C. 1914-1996
 Hicks, Flossie B. 1883-1961
 Hicks, G. Cleveland 1883-1951
 Hicks, George Millard 1920-1923
 Hicks, Jesse Willard 1916-1983
 Hicks, Mary Moore 1916-1979
 Hicks, Mary Nowell 1922-1983
 Hinton, Charlotte Lane 1944
 Hinton, G. Worth 1911-1983
 Hocutt, Betty Joan H. 1950 - 1977
 Hodge, Doris M. 1935 - 1990
 Hodge, Jesse Ray 1930 - 1986
 Hollingsworth, Minnie W. 1881-1971
 Holmes, Myrtle 1897 - 1989
 Holt, Marvin Lumus 1917-2000
 Honeycutt, Alma Davis No dates
 Honeycutt, William Allen No dates
 Hood, Faye 1941 - 2001
 Hood, Gracie Richardson 1909-1984
 Hood, Herbert Gray 1909-1991
 Hood, Walter Bryant 1931-1951
 Hopkins, Christine Duke 1916-

- Hopkins, Willie B. 1917-1983
 Horton, Henry J. 1905 - 1963
 Horton, John D. 1884-1937
 Horton, John Wesley 1846-1885
 Horton, Martha 1857 - 1928
 Horton, Martha Strickland 1844-1927
 Horton, Mary Emma 1872 - 1937
 Horton, May Kemp 1888-1963
 Horton, Veva Tant 1906 - 1986
 House, A. Roy, Sr. 1887 - 1956
 House, Augustus Roy, Jr. 1925 - 1933
 House, Mary Dunford 1891 - 1977
 Ihrie, Elizabeth 1927 -
 Ihrie, Mabel Clark 1901 - 1992
 Ingham, Eula Brantley 1913-1984
 Ingham, Kenneth L. 1908-1965
 Ingold, Ruby M. 1914-1918
 Jackson, Raymond 1928 - 1983
 Jeffreys, Mamie E. 1905 - 1928
 Jewell, Joyce Temple 1926-2000
 Johnson, B. Howard 1882 - 1949
 Johnson, Charlie E. 1897 - 1967
 Johnson, Emma B. 1905-1991
 Johnson, Gladys Stell 1898 - 1988
 Johnson, McClellan J. 1902-1961
 Jones, Betty Carter 1928-1996
 Jones, Blonnie H. 1928 - 1993
 Jones, Clellie W. 1896-1922
 Jones, Earl 1914 - 1979
 Jones, Elvertis 1920 - 1986
 Jones, Mollie H. 1894 - 1964
 Jones, Pearl 1891 - 1952
 Jones, Robert Edwin 1889 - 1948
 Jones, William E. 1883 - 1964
 Jones, Woodrow W. 1916-1963
 Joyner, Anne 1904 - 1993
 Joyner, Annie Deans 1875-1956
 Joyner, Dona Gay 1899-1977
 Joyner, Edgar L. 1901-1951
 Joyner, Helen Baker 1908-1987
 Joyner, James Roy 1908-1994
 Joyner, Robert C. 1896-1970
 Joyner, W. Patrick 1874-1950
 Keller, Myrle Carrington 1905-1983
 Keller, William Harry 1893-1951
 Kemp, Cascile Gary 1919-
 Kemp, George Carl 1915-
 Kemp, Irene 1912 - 1989
 Kemp, J. Bennett, Sr. 1888-1951
 Kemp, John Green 1883-1953
 Kemp, Maude H. 1893-1980
 Kemp, Minda L. 1881 - 1964
 Kemp, Lily Biscoe 1886-1971
 King, Dorothy Oakley 1924-1969
 King, Richard Martin 1951-1994
 Klun, William Donald 1936-1995
 Kohler, Katherine H. 1900-1989
 Kohler, Louis L. 1877-1969
 Kronsbein, Dianne B. 1947 - 1995
 Kronsbein, Paul E. 1938 -
 Lamm, Robert Dewey 1980 - 1996
 Lane, Nannie K. 1898-1977
 Lanier, Angela Faith b&d 1972
 Lanier, Melvin Kenneth b&d 1954
 Lanier, Melvin M. 1926 -
 Lanier, Wilma N. 1930 -
 Lassiter, Adolphus 1914 - 1986
 Lassiter, Essie 1911 -
 Lawrence, Rebecca Pearce 1921-1998
 Lee, David Laurance b&d 1985
 Lewis, Bruce S. 1905 - 1990
 Lewis, Carrie Chamblee 1876-1969
 Lewis, Emet Cecil 1901 - 1938
 Lewis, Eula Pearl 1896 - 1989
 Lewis, Ralph G. 1891 - 1962
 Lewis, Sue Frazier 1862 - 1932
 Lewis, W. Earlie, Jr. 1930 - 1932
 Lewis, W. N. 1844 - 1932
 Lewis, William E. 1902 - 1957
 Lewis, Wyndal F. 1932 - 1951
 Liles, Alice 1861 - 1936
 Liles, B. 1909-1946
 Liles, Beulah Minor 1921-1998
 Liles, Clee 1902-1968
 Liles, J. K. 1877-1938
 Liles, Joyce 1932 - 1996
 Liles, Katie Bet White 1899-1940
 Liles, Leigh Ann 1960-1962
 Liles, Lola Roper 1911-1927
 Liles, Mary C. 1884-1955
 Liles, Richard Wesley 1907-1970
 Liles, Rudolph 1926-1985

- Liles, Sam 1879-1961
 Liles, Willie W. 1914-1920
 Lilly, Infant son of
 Mr/Mrs Richard M. Lilly 1965
 Lineberry, Alice Ann Oliver 1936-1970
 Lombardo, Mamie Lee 1902 - 1950
 Long, J. Edgar 1904-1951
 Long, James Lehman 1937-1945
 Long, Janice Pauline 1946-1994
 Long, Katherine 1944 - 2001
 Long, Lehman B. 1910-1948
 Lyden, Wilfred Alva 1928 - 1996
 Macon, Willie N. 1895-1940
 Malone, Clenard William 1927 - 1986
 Mancino, Joyce Liles 1932-1996
 Mangrum, Guy 1876-1950
 Mangum, Etha S. 1912-1988
 Mansker, Crawford P. 1911-1983
 Mansker, Ercelle P. 1915-1990
 Marle, Elisa Debnam 1913-1992
 Marle, George Paul 1914-1985
 Marshall, Clair 1881 - 1962
 Marshall, Ernestine M. 1919-1994
 Martin, Billy Irvin 1938 - 1992
 Massey, Infant son of
 Helen Palmer & L. M. Massey 1920
 Massey, Ben Frank 1920 - 1993
 Massey, Beth O'Dear 1926 - 1998
 Massey, Frances Barrett 1917 - 1996
 Massey, Guy Cecil 1885 - 1933
 Massey, Guy Cecil, Jr. 1911 - 1954
 Massey, Helen Russell Palmer 1896-1920
 Massey, Jeffrey Leroy 1966 - 1987
 Massey, John Thomas O'Dear 1900 - 1983
 Massey, Leroy L. 1883 - 1934
 Massey, Mary Atwood 1893 - 1968
 Massey, Merritt Lloyd 1897 - 1944
 Massey, Pearl Jones 1891 - 1952
 Massey, Peyton Howard 1889-1958
 Massey, Robert Daniel 1913 - 1995
 Massey, Roselle Sears 1898-1975
 May, Isabella Hayes 1862-1938
 May, John H. 1904-1972
 May, Rufus H. 1861-1941
 McClain, Eliza D. 1918 - 1984
 McDevitt, Gertrude Carter 1920-1998
 McDevitt, Howard Kermit 1918-1986
 McDonald, George Francis 1914 - 1981
 McGee Repsie L. 1902 - 1965
 McGee, Bobby T. 1934-1990
 McGee, Fola 1924 - 2001
 McGee, Wylie Z. 1896 - 1937
 McLeod, Grace 1905 - 1997
 McNabb, Iva Pearl 1898 - 1966
 McSwain, Delia Morgan 1900 - 1974
 McSwain, George O. 1920 - 1956
 McSwain, Jessie Ralph, 1890 - 1970
 Medlin, Albert V. 1895-1942
 Medlin, Albert V. II B. & D. 1958
 Medlin, Betty 1873-1943
 Medlin, Clevia 1912 - 1998
 Medlin, Edna 1880-1968
 Medlin, Jimmy Deve, Sr. 1934 - 1986
 Medlin, John N. 1874-1938
 Medlin, Lila 1913 - 2003
 Medlin, Lala S. 1895-1942
 Medlin, Mamie Lee 1902-1950
 Medlin, Martha H. 1874-1930
 Medlin, Marvin C. 1879-1937
 Medlin, Owen C. 1904-1938
 Medlin, Thais 1912-1998
 Medlin, Walter I. 1883-1931
 Merritt, Elizabeth - d. 1999
 Mills, Allen M. 1942 - 1987
 Minor, Rachel Winstead 1916 - 1986
 Mitchell, Ada S. 1892-1983
 Mitchell, C. P. 1895-1956
 Mitchell, Delane 1985 - 1986
 Mitchell, Fairy Jeffreys 1919 - 1990
 Mitchell, Lucia Flowers Miller 1899-1989
 Mitchell, Luther 1921 -
 Mitchell, Mary 1890 - 1968
 Mitchell, Roosevelt T. 1939 - 1998
 Mitchell, Vernon M. 1885-1955
 Mizelle, Clyde Edgar 1894-1932
 Moore, Annie S. 1905-1966
 Moore, Bobby Jene 1946-1948
 Moore, Cleo Hicks 1923-1987

- Moore, Dorothy J. 1943 –
 Moore, Eldredge S. 1923-1924
 Moore, Gwen Perry 1938 - 1991
 Moore, James W., Sr. 1936 – 1985
 Moore, Lois D. 1915-1966
 Moore, William E. 1902-
 Moore, Worth H. 1925-1926
 Morgan, Charlie A. 1873 – 1939
 Morgan, Clarence Dallas 1912 – 1976
 Morgan, Lilly B. 1876 – 1944
 Morgan, William Andrew 1926-1993
 Morgan, William D. 1949-2001
 Morris, Ellen B. 1877-1961
 Morris, Iva Dean 1919-1983
 Morris, Royal Carlie 1905-1987
 Morris, Willard 1917-1991
 Morris, William Walter 1881-1945
 Moss, Allie Overton 1895-1979
 Moss, Cpl. William Clinton 1920-1942
 Moss, Frank G. 1926-
 Moss, Janice Creech 1932-
 Moss, Margaret McLeod Bunn 1927 –
 Moss, Susan Elizabeth b&d 1972
 Moss, William Henry 1893-1971
 Moxley, Helen Macon 1918-1998
 Moxley, Wilbur E. 1919-1975
 Mullen, Willard 1913 – 1993
 Murray, Annie Bryant 1890-1944
 Murray, Bobby Julius 1933-1987
 Murray, Chalmus W., Sr. 1914-1998
 Murray, Etta M. 1888-1956
 Murray, James D. 1923-2003
 Murray, Jessie Allison 1886-1971
 Murray, Jimmy E. 1941-1952
 Murray, Myrtie M. 1917-1999
 Nowell, Essie Belle 1912 – 1931
 O'Dear, John Thomas 1900 – 1983
 Oakley, Babara 1932 - 1985
 Oakley, Benjamin F. 1901-1949
 Oakley, Bennie Everette, Jr. 1960 –
 Oakley, Cora W. 1889 – 1965
 Oakley, Dorothy 1924 – 1969
 Oakley, Eleanor 1928 - 1990
 Oakley, Frank R. 1888 – 1959
 Oakley, Irene C. 1892-1974
 Oakley, James P. 1923 – 1973
 Oakley, Lona W. (Wall) 1921 – 1997
 Oakley, Luther Babe 1902-1984
 Oakley, Mildred 1922 - 2001
 Oakley, Sally Louise 1958 – 1997
 Oakley, Vernon R. 1938-1942
 Oakley, Walter A. 1883-1950
 Oliver, Alice Ann 1936 - 1970
 Oliver, Eva A. David 1911-1968
 Oliver, William E. 1909-1951
 Outlaw, James Bryan M.D 1879-1927
 Outlaw, Mary Westray Bunn 1879-1950
 Pace, Lula 1919 - 1999
 Padgett, William Chris 1948-1949
 Page, Eva Harris 1901-1974
 Page, Fred Leon, Jr. 1895-1970
 Palmer, Helen Russell 1896 - 1920
 Parker, Clarence E. 1884-1937
 Parker, Donna Faye 1961 – 1963
 Parker, Ethel C. 1891-1978
 Parrish, Alice Marie 1947 – 1948
 Parrish, Demock S. 1914-1996
 Parrish, Floyd M. 1914-1989
 Parrish, J. Harvey 1898 – 1991
 Parrish, Kenneth Barbee 1961-1977
 Parrish, Lessie C. 1909-2000
 Parrish, Rexford Sprite 1925 – 1996
 Parrish, Truemella A. 1902 – 1986
 Parrish, Wallace 1942-2001
 Parrish, Willard 1907-1977
 Parrish, William Dayton 1919 – 1984
 Parsons, Phillip S. 1853-1918
 Pate, Calvin McCoy 1912 – 1979
 Pate, Virginia B. 1917 – 2002
 Patterson, Goy 1909 – 1971
 Patterson, Patricia G. 1957 - 1996
 Pearce, Alice Liles 1861-1936
 Pearce, Anna Belle 1920-1926
 Pearce, Baby Boy b&d 1951
 Pearce, Bayard T. 1919-1995
 Pearce, Cyrus Frederick 1923 – 1970
 Pearce, David 1892-1950
 Pearce, David C., Jr. 1920-2001
 Pearce, Diana Jane 1949 –
 Pearce, Doris F. 1925-2003
 Pearce, Edgar S. 1896 – 1974
 Pearce, Eleanor Frances 1923-1924

- Pearce, Elizabeth Ihrie 1927 -
 Pearce, Frederick W. 1925-1928
 Pearce, Harold Sprite 1928-1936
 Pearce, Harry Bennett 1890-1954
 Pearce, James G. 1870-1943
 Pearce, James Leamon 1921 - 2000
 Pearce, James Leamon, Jr. b.&d. 1946
 Pearce, Jane Baker 1928 -
 Pearce, Joe Turner 1900-1967
 Pearce, John Wallace 1917-2001
 Pearce, Joseph R. 1921-1945
 Pearce, Lona O'Neal 1901-1958
 Pearce, Melba 1919- 1996
 Pearce, Melvin S. 1917-1980
 Pearce, Myrtie B. 1921 - 2003
 Pearce, Nannie Watson 1889-1988
 Pearce, Ned Ruffin 1879-1918
 Pearce, Nonie M. Arnold 1887-1936
 Pearce, Ollie White 1898 - 1969
 Pearce, Pattie Keron 1931 - 1964
 Pearce, Pearl J. 1896-1993
 Pearce, Pearl 1886 - 1951
 Pearce, Rena 1886 - 1978
 Pearce, Ronald Lionel 1934-1939
 Pearce, Roscoe Cyrus 1897 - 1942
 Pearce, Virginia Kemp 1917-2001
 Pearce, Wade Hampton 1883-1940
 Peddicord, Mary 1906 - 1992
 Perkins, Mildred Oakley 1922-2001
 Perry, Pattie Keron Pearce 1931 - 1964
 Perry, Aleigh 1932 -
 Perry, Betty Hales 1916 - 2001
 Perry, Blonnie Pierce 1903-1996
 Perry, Carole Lynn b&d 1958
 Perry, Crystal 1926 -
 Perry, Gwen 1938 - 1991
 Perry, H. R. 1872 - 1965
 Perry, J. Clifton 1907 - 1926
 Perry, Jo 1937 -
 Perry, Lesa Jan b&d 1962
 Perry, Lois C. 1907 - 1995
 Perry, Mayland G. 1906 - 1992
 Perry, Oscar W., Jr. 1941 - 1977
 Perry, Ronald Lee 1913-1948
 Perry, Wade W. 1904 - 1960
 Perry, Windel Hayes 1927 - 1990
 Pierce, Blonnie Phillips 1903 - 1996
 Pierce, Carl Everett 1897-1987
 Pierce, Hearvy S. 1920-1965
 Pierce, J. Howard 1876-1944
 Pierce, Virginia P. 1876-1918
 Pippin, George Oliver 1912 - 1994
 Pippin, Gertie Medlin 1914 -
 Pippin, Martha F. 1918-1945
 Pitts, Ada Grissom Died 1919
 Pitts, Dora B. Overton 1879-1946
 Pitts, Emma A. Chamblee 1882-1916
 Pitts, Roscar Sidney 1915-1939
 Pitts, William Needham 1880-1950
 Pitts, William Needham, Jr. 1914-1920
 Poole, Lela M. 1912 - 1974
 Poole, Lonnie E. 1908 - 1969
 Pope, Annie E. 1915 -
 Pope, F. Jack 1900 - 1978
 Pope, M. Archie 1935 - 1993
 Pope, Sherrie Kay 1957 - 1966
 Porter, David Lee 1958 - 1986
 Powell, John C. 1884-1970
 Powell, Minda U. 1888-1966
 Powers, Cabell C. 1910-2002
 Powers, Vernon C., Sr. 1906-1985
 Poythress, George W. 1882-1976
 Poythress, Maude E. Tucker 1887-1967
 Pranger, Louis John 1925 - 2000
 Pranger, Myrcelle Bunn 1915 -
 Price, Doris Jean 1911 - 1995
 Price, Floyd Daylon, Sr. 1908 - 1975
 Price, Foster, b&d 1931
 Price, Hugh P. 1905-1977
 Price, Ivon Odell 1905 - 1975
 Price, Lena Bell Carter 1915 - 1992
 Price, Malcon A. 1889 - 1944
 Price, Minnie Smith 1889 - 1984
 Price, P. no dates
 Price, Roland Howard 1917-1974
 Price, Roy Shelby 1933 - 1959
 Prince, Milton M. 1895 - 1960
 Prince, Oma Long 1896 - 1967
 Privett, Rella W. 1882-1966
 Privett, Riley M. 1870-1944
 Privette, Albert David 1892-1973
 Privette, Effie O'Neal 1897-1977

- Privette, F. Donald 1938 - 1970
 Privette, Infant son of
 Eugene & Doris Privette 1937
 Privette, Joseph Dan 1929-2003
 Privette, Joseph V. 1901-1953
 Privette, Madie G. 1905-1963
 Privette, Vivian 1919 - 2000
 Privette, Theda 1921 - 1998
 Privette, Winnie Williams 1932-1991
 Pulley, Albert Lee 1910 - 1987
 Pulley, Alton 1904 - 1980
 Pulley, Barbara Kay b&d 1966
 Pulley, Bertha 1906 - 2003
 Pulley, Hattie M. 1906 -
 Pulley, Joseph Alexander b&d 1971
 Pulley, Lowell R., Jr. b&d 1969
 Pulley, Merle Sue Boyette 1911 - 1984
 Quinn, Amanda Gaye b&d 1979
 Ranes, Tillie G. 1885 - 1939
 Ray, Ella P. 1872-1968
 Reames, David F. 1859-1919
 Reames, Odis D. 1902-1920
 Richardson, Alie Ann Gill 1884-1957
 Richardson, Bonnie D. B. & D. 1910
 Richardson, Burbon H. 1875-1961
 Richardson, Burbon H., Jr. 1919-1991
 Richardson, Clifford D. 1909 - 1975
 Richardson, Edwin C. 1908-1991
 Richardson, Garland L. 1907-1977
 Richardson, Gladys R. 1922 - 1998
 Richardson, Gracie 1909 - 1984
 Richardson, James E. 1921-1922
 Richardson, Maebelle A. 1914-1983
 Richardson, Mary E. 1915-1974
 Richardson, Sidney Lee 1940-1996
 Richardson, Thais Medlin 1912-1998
 Richardson, Vance H. 1910-1990
 Ritchie, Jeanne B. 1925-1966
 Robbins, Lucille B. 1914 - 1988
 Robertson, Hallie Preston B.& D. 1898
 Robertson, John T. 1868-1939
 Robertson, Lyman Shepherd B. & D.
 1902
 Robertson, Mary Emma Horton 1872-
 1937
 Robertson, Maxine Elizabeth 1909 -
 1955
 Robertson, Myron Baxter 1896-1918
 Sanders, Luther Burgron 1893 - 1968
 Sanders, Nellie Christene 1903 - 1962
 Santucci, Frank E. 1909 - 2002
 Saunders, Infant no dates
 Saunders, Infant twin sons of
 G.M. & D.M. Saunders 1916
 Saunders, Margaret B. & D. 1910
 Saunders, Raymond Brook 1908-1918
 Saunders, Wesley Augustus 1906 - 1974
 Schafer, Anne Joyner 1904-1993
 Scroggins, Pattie Bunn 1909-1991
 Seawell, Carver Elias 1902 - 1982
 Seawell, Loraine Woodlief 1907 - 1996
 Sessoms, Lillie M. 1893-1958
 Shew, Ricky Lynn 1967 - 1985
 Sims, Estella 1922 - 2003
 Smith, Alma H. 1909 - 1986
 Smith, Brandon L. 1984 - 1985
 Smith, Horace A. 1903 - 1975
 Smith, James 1903 - 1985
 Smith, Oletha Chamblee 1916-1986
 Smith, Oscar Y. 1889-1961
 Smith, Willie Earl 1956-1996
 Smithers, Laura M. 1905 - 1985
 Smithers, Wesley R. 1906 - 1980
 Southall, Furney P. 1874-1937
 Southall, Mary E. Clark 1878-1925
 Spears, Judson Junius 1908-1999
 Spears, Lossie Ella 1906-1995
 Spivey, Julia Ann Tysor 1890-1967
 Spivey, Oden B., Jr. 1926-1994
 Spivey, Oden Budd 1889-1948
 Stallings, Barbara Oakley 1932-1985
 Stallings, Charlie G. 1900-1981
 Stallings, Columbus Tant 1913 - 1994
 Stallings, Donald Wayne 1902-1997
 Stallings, George F. 1916-1946
 Stallings, Joel C. 1872-1919
 Stallings, Pauline Pearce 1907-1999
 Stallings, Robert Cimion 1914-1920
 Stallings, Stephen E. 1915 - 1973
 Starling, Birdie M. 1901-1916
 Starling, Maggie L. 1873-1952

- Starling, Rev. G. W. 1862-1935
 Stell, Florence P. 1870 - 1950
 Stell, Pittman 1869 - 1966
 Stephenson, Eleanor Oakley 1928-1990
 Stone, Eliza A. 1854-1925
 Strickland, Hazel H. 1908-1996
 Strickland, J. Marshall 1915-1988
 Strickland, Jimmy M. 1945-2002
 Strickland, Leavy 1860-1916
 Strickland, Loomis 1907 - 1968
 Strickland, Mamie T. 1889-1967
 Strickland, Martha Horton 1857-1928
 Strickland, Nettie Winstead 1911 - 1963
 Strickland, Ollie E. 1881-1966
 Strickland, Susie Pace 1889-1981
 Strickland, W. Milton 1890-1962
 Strickland, William H. 1892-1922
 Strickland, Willie Weston 1916 - 1994
 Tant, Anne Hicks 1921-1997
 Tant, Bobby R. 1947 - 1949
 Tant, Corbett R. 1918-1989
 Tant, Deborah Carol 1958 - 1959
 Tant, Lula Pace 1919 - 1999
 Tant, Paula J. 1955 - 1956
 Tant, Pauline J. 1929 -
 Tant, Rupert B. 1910 -1950
 Tant, Spencer L. 1926 - 2001
 Tant, Spencer N. 1948 - 1949
 Tant, Thomas Earl 1919 - 1967
 Taylor, Craig Michael 1983 - 1986
 Taylor, George T. 1863-1946
 Taylor, Lillie 1895 - 1978
 Temple, Allison Co. 1918 - 1966
 Temple, Cleo Boykin 1918-1999
 Temple, Edd C. 1896-1940
 Temple, Edd Orris 1937
 Temple, G. Keith 1936 - 1998
 Temple, George Henry 1916-1977
 Temple, Gordon Lee 1915-1991
 Temple, Helen M. 1912-1969
 Temple, J. Maylon 1894-1990
 Temple, Jennie E. 1894-1971
 Temple, Jesse H. 1905 - 1985
 Temple, Joyce 1926 - 2000
 Temple, L. Russell 1913-1969
 Temple, Lonie H. 1893-1968
 Temple, Lorenza R. 1886-1950
 Temple, Mary E. 1905-1952
 Terry, Estelle Chamblee 1902-1991
 Terry, John G. 1905-1960
 Terry, Maida Estelle 1936
 Thurman, Raymond B. & D. 1940
 Timberlake, Faye Hood 1941-2001
 Timberlake, Thomas Gray 1937-1996
 Tracy, Christine Bunn 1911 - 1998
 Tracy, Lawrence Wesley 1909 - 1991
 Trevathan, Robert Milton 1922 - 1960
 Trevathan, Vivian Privette 1919 - 2000
 Tucker, Betty R. 1853-1939
 Tucker, Maude E. 1887 - 1967
 Tucker, Nannie K. 1898 - 1977
 Tucker, Norman Allen 1892-1944
 Tucker, M. Blanch 1889 - 1962
 Turner, Helen Jarrell 1910 - 1994
 Turner, Leona B. died 1998
 Turner, Tommie 1906 - 1994
 △ Upchurch, Bertha M. 1897 - 1957
 △ Upchurch, Willie E. 1884 - 1970
 Vande Viver, Augusta W. 1925-
 Wade, Cammie V. 1904-1960
 Wade, Herbert Cloid 1903-1983
 Wakefield, Infant son of
 Wm. C. & Annie C. Wakefield 1919
 Walker, Sandra Shaw 1964 - 2000
 Wall, Ayden Russell 1897 - 1964
 Wall, Frances B. 1857-1950
 Wall, Frank B. 1918-2000
 Wall, G. W. 1865-1924
 Wall, Helen R. 1923-1986
 Wall, Mark M. 1895-1968
 Wall, Michael Gill 1955-1972
 Wall, Pearl Edmundson 1903 - 2000
 Wall, Pearl I. 1900-1981
 Wallace, David Manning 1968 - 1986
 Wallace, Jake Dallas 1944 - 1982
 Watson, C. Milton 1892-1973
 Watson, Lucy B. 1901 - 1987
 Watson, Vevie Nowell 1891-1961
 Weathersby, Charles A. 1933-1961
 Weathersby, Charlie G. 1883-1951
 Weathersby, Ida Murray 1893-1992

- Weathersby, Irvine W. 1896-1990
 Weathersby, Jack 1926-
 Weathersby, Jean Bunn 1928-
 Weathersby, Lela 1887 - 1924
 Weathersby, Thad C. 1889-1979
 Wells, Amos A., Sr. 1896 - 1978
 Wells, George W. D. 1920 - 1939
 Wells, Lucy Ann B. 1872 - 1961
 Wells, Minnie F. 1899 - 1948
 Wells, W. Henry 1862 - 1961
 Wheless, Lou C. 1879-1955
 Wheless, S. M. 1857-1926
 Wheless, Undine D. 1908-1984
 Wheless, William C. 1903-1972
 Whitaker, Mary Westray Bunn 1879-1950
 White, Ashley Glenn 1908-1974
 White, Durward L. 1904 - 1993
 White, Kate B. 1874-1961
 White, c 1899 - 1940
 White, Mae Southall 1899-1976
 White, Mary Eakins 1904 - 1997
 White, Percy L. 1893-1967
 White, Phillip A. 1868-1936
 Whitley, Dullie T. 1880-1959
 Whitley, Fannie 1901 - 1968
 Whitley, Georgia Williamson 1882-1948
 Whitley, Infant son of
 J.B. & Mamie Godwin Whitley 1923
 Whitley, J. M. 1865-1944
 Whitley, Jodie 1868-1928
 Whitley, Lou 1866-1918
 Whitley, R. J. 1861-1924
 Whitley, Robert Joe 1898-1988
 Whitley, Sue R. Chamblee 1872-1921
 Whitley, William Channie 1904-1932
 Wiggins, Alan Billy 1958 -
 Wiggins, Daniel L. 1923 - 1993
 Wiggins, Kathleen Searles 1956 - 2001
 Wiggs, Delanie W. 1871-1942
 Wiggs, Eppie Gilmore 1902-1973
 Wiggs, Eppie P. 1847-1932
 Wiggs, Ida Navada 1886-1922
 Wiggs, Martha S. 1851-1921
 Wiggs, William L. 1872-1934
 Wilder, James Russell 1939-1997
 Williams, C. T., Jr. 1917-1970
 Williams, Calvin Thomas 1881-1947
 Williams, George Sherwood 1911-1929
 Williams, Iva Helen Griffin 1894-1991
 Williams, Joseph Henry 1873 - 1926
 Williams, Keston Keith 1920-1981
 Williams, Lindsay 1981 - 2003
 Williams, Martha Ann 1901-1984
 Williams, Pattie P. 1919 - 1996
 Williams, Russell 1917 - 1972
 Williams, Thomas Ecwood 1922-1924
 Williamson, Georgia 1882 - 1948
 Wilson, David 1909-1989
 Wilson, Kyle Bryant 1966-1987
 Wilson, Lalla Chamblee 1914-1982
 Wilson, Missouri H. 1877 - 1937
 Winstead, George D. 1887 - 1946
 Winstead, Addie Dew 1883 - 1970
 Winstead, George B. 1920 - 1972
 Winstead, Hazel 1913 - 1967
 Winstead, Julia Grace 1917 - 1918
 Winstead, Lina B. 1919 - 1989
 Winstead, Pearl Finch 1889 - 1952
 Winstead, W. Herbert 1878 - 1961
 Wood, Dollie Mae 1936 - 1995
 Wright, Avon M. 1926-1980
 Wright, Clarence 1913-1987
 Wright, James E. 1879-1948
 Wright, Mary A. 1889-1975
 Yarborough, Fred 1934 - 1983
 Yarborough, Maggie L. Wms 1901 - 1997
 Young, Addie D. 1912 2003

WAKE
CO, NC

ZEBULON CEM
Zebulon, NC

All stones inspected by
RPA 29 MAR 2005
From HW 96 Proceed

East on Garrison St
3-4 blocks to
N. Whitley St - cross
1 block North on
this street.

Looked for interesting stones
First from N. Whitley to
Main N-S path. + on to
NS paved interior road
Found no U's - Damp
paths noted.

West of center paved road

△ H & W Sanford M. Finch [SANFORD MOSES FINCH]
24 DEC 1883 - 18 JAN 1931

△ Lettie U. Finch [LETTIE EUDORA U] [s/o James Bartlett U, I of
24 APR 1883 - 3 MAY 1961 Nathan U, I / Bertie U
Subclass - Gilbert Bertie
U line]

H & W

□ Willie E U [WILLIAM E. U, SR] [s/o James W. U - Richard
13 JAN 1884 - 24 JAN 1970 U, III / Burkely U Subclass

□ Bertha M. U [BERTHA MAE LONG] - Ambrose Amos U line]
11 SEP 1897 - 28 FEB 1957

H & W

△ Coye W. Fuller [COYE WAYNE FULLER]
1891 - 1948

△ Sodie U. Fuller [SODIE UPCHURCH] [s/o James W. U - Richard
1899 - 1948 U, III / Burkely U Subclass
- Ambrose Amos U
line]

WAKE CO, NC - ZEBULON

○ The Zebulon Record THUR 1 FEB 1990 Zebulon, NC

Cemetary beautification progressing

Plans to beautify the Zebulon Town Cemetery are slowly progressing due to efforts of the Zebulon Cemetary Beautification Committee.

"We have had a lot of good response to the letter we sent out in December," reported former Zebulon Mayor Frank Wall two weeks ago. "We sent out about 320 letters to people who have plots or family in the cemetery. A number of them have written us back and enclosed

more names of people they think would be interested in contributing."

Wall, Betsy Green, Edna Bunn Allmon, Janie Hinton and Christine Hopkins make up the committee.

The money being raised for the beautification fund — all through voluntary donations — will go toward the landscaping of the four entrances to the cemetery.

"We don't want anything that is going to be a maintenance prob-

lem," Wall explained, "but we do want something that is going to look nice."

Landscaping work will be done by Pearce Nursery in Zebulon.

The highlight of the project is a white marble sign which has been donated by Taylor Wiggins of Wiggins Monument in Rolesville. The sign will be erected on one of the stone columns at the Whitley Street entrance.

The remainder of the land not currently plotted is due to be surveyed soon, Wall said.

"I'm anticipating that we will receive more letters," he said. "We'd like to clean up some of the other areas in the cemetery, pull some trees and put some gravel or something on the connector streets."

The town spent \$133,000 last year to pave, curb and gutter three of the cemetery's main streets.

— MARY BETH NEWHART