

MARY D

4

Mary D. Upchurch

North Carolina
Marriages, 1759-1979

marriage: 29 Oct
1893

Raleigh, Wake, North
Carolina

spouse: John D. Will

○ Action in Franklin Co, NC to settle the Estate of
Ambrose Amos U who died Intestate in said County
Item in Email 11 MAY 2009 Nancy Joan Parrish to RPU

Franklin County NcArchives Court.....Upchurch, Ambrose July 2, 1894 *****
Copyright. All rights reserved. <http://www.usgwarchives.net/copyright.htm> <http://www.usgwarchives.net/nc/ncfiles.htm>
***** File contributed for use in USGenWeb Archives by: Susan Davis Δ
sdavis124@msn.com September 28, 2008, 5:10 pm Source: Franklin County Written: July 2, 1894 Franklin County In
the Superior Court In the matter of the administration of the estate of Ambrose Upchurch, deceased before BB
Morsenbury, CSC. W.G. Upchurch, being sworn, doth say: That Ambrose Upchurch, late of said County, is dead,
without leaving any Will and Testament, and that he is the proper person entitled to Letters of Administration on the
estate of the same Ambrose Upchurch. Further, that the value of said real estate, so far as can be ascertained at the
date of this application, is about \$200.00, and that W.G. Upchurch, Penina Green wife of Trish Green, Jane Alford wife
of Moses Alford, Franky Williams, Fanny Brantley wife of Allan Brantley, Martha Carter wife of Fred Carter, Agnes
Phillips wife of L.B. Phillips, J.W. Upchurch, Walter Upchurch, Vance Upchurch, James N. Upchurch, Charles Upchurch,
Deline Upchurch, Lela Upchurch, Della wife of Doll Gay are entitled as heirs and distributes thereof. Sworn to and
subscribed before me this 2 day of July 1894. Clerk Superior Court W.G (mark) Upchurch File at:
<http://files.usgwarchives.net/nc/franklin/court/upchurch670nwl.txt> This file has been created by a form at
<http://www.genrecords.net/ncfiles/> File size: 1.6 Kb

On 25th 1894 W. G. U [William Gaston U s/o Ambrose Amos U] in
Superior Court of FC, NC testifies that Ambrose died Intestate
leaving an estate of approximately 200 + he offers to Administer
Here at same stated to be:

W. G. U (s/o AAU); Penina Green [Elen Ann Penina U - D/o AAU]
wife of TRISH GREEN [Nathaniel D. Green "Trish"]; Jane Alford
[Elizabeth Jane Ann U - D/o AAU] wife of Burkley Moses Alford;
Franky Williams [Frances Ann U D/o AAU] - wife of Simon
Joseph Williams; FANNY BRANTLEY [Fannie Ann U - D/o AAU],
wife of Allan Brantley [ATLAS BRANTLEY]; Martha Carter
[Martha Ann U] - w/o Fred Carter [FED CARTER]; Agnes Phillips
[Agnes Ann U] D/o AAU - wife of L. B. Phillips [Lemin B. Phillips];
J. W. U s/o AAU [James W. U]; Della Gay [GD/O AAU by her
son John W. U, dec'd] [ADELLA FRANCES U] w/o DOLL GAY
[WILLIAM ETON GAY] + Children of late Calvin Bryant U s/o AAU:
James N. U; Vance U [Sylvania Vance U]; Deline U [Adaline
S. U] [+ Charles U + Lela U possible children of Calvin Bryant U]
[Four children of Calvin Bryant U not in document: JUNEVS U;
Mary D. (U) will; Walter R/B U; unnamed daughters]

MARY D. U

①

XID - 4150

① See Franklin Co, NC Census - Extracted by RPH

1890 - Calvin U 23 M Farmer

Adaline U 28 F Keep house [Adaline Purnett]

Walter U 2 M

Mary U \uparrow 4/12 F

Dililah Purnett 13 F

Franklin Brantley 13 M

1880 - Mary D. U Female age 10 Jan, Domestic labor
in in home of father Calvin U (Calvin Bryant U)

② I. Richard U, III - Head of Clan

A. Burchely U, Sr

1. Ambrose Amos U

a. Calvin Bryant U

i. Mary D. U \uparrow

MARY D

U

(2)

XID-4150

○ Ancestry.com input 11 MAR 2008 - RPH - for me MARY D. U

1900 CENSUS - RALEIGH, NC, →
JOHN D. WILL BORN NY

1910 CENSUS - WARD NO 1
RALEIGH, WAKE CO, NC

1930 - CENSUS - RALEIGH, NC

Household Members:	Name	BORN	Age
	John D Will	FEB 1872	28
	Mary L Will	MAY 1873	27
	Horace J Will	SEP 1894	5
	John D Will	APR 1897	3
	Baby Will	SEP 1897	8.12 [GEO J. WILL]

Household Members:	Name	N. SALISBURY ST. BAPT	Age
	John D Will	BNY	1871 39
	Mary D Will	WIF [MARY D. U]	1872 38
	Harrie J Will	SON [HORACE J]	1895 15 WIFE
	John D Will	SON	1897 13
	George J Will	SON	1900 10
	Everet V Will	SON	1903 7
	Clara A Will	DAU	1905 5
	Eugene C Will	SON	1908 2
	Adeline Upchurch	MIL WID	1839 71 → [ADALINE A. PRIVETT]
	Juneus Upchurch	WIFE	1882 28
	Dasie Buffaloe	BOARDER	1889 21

Household Members:	Name	B. BAPT	Age
	John D Will	1870	60
	Mary D Will	1873	57
	Paul Will	1924	6

I. Richard W, III - Head of Clan

A. Berkeley U

1. Ambrose Amos U

△ a. Calvin Bryant U 1845-1892 (Burroughwood Cem, Raleigh, NC)
△ MA 29 JAN 1866 (Franklin Co, NC) Adaline A. Punnett b 20 OCT 1838
() d 1 MAY 1923 () (BUR-AS HUS)

△ i. Mary D. U b MAR 1873 ()

GS PAUL WELL b ABOUT 1924
△ MA About 1893 () John D. Will b FEB 1872 (NY)

△ (I) Horace J. Will b SEP 1894
△ (II) John D. Will b APR 1897
△ (III) George J. Will b SEP 1899
△ (IV) Everett V. Will b About 1903
△ (V) Clara A. Will b About 1905
△ (VI) Eugene C. Will b About 1908

△ ii. JUNEUS U b About 1882

Note: As of 11 MAR 2008 I am unable to locate Adaline A. (Punnett) U on the 1900 Census.

MARY P

U

○ KY UPCHURCH BIRTHS-DOWNLOAD IN LTR 20 JAN 2001
 CHARLES JOHN PETERSON, JR TO RPA PG (16)

Certif	Child's name	MO	DY	YR	County	Mother	Regist	Regist	Text	Text	Text33	Tex
41981	UPCHURCH MARVIN ALLEN	9	15	1967	CMBLD	PIERCEY PHYLLIS	1967	10	84	E	1967	1 11
90564	UPCHURCH MARVIN O	11	17	1945	RUSEL	CONNER GERTIE			184		1959	9
14844	UPCHURCH MARY J	2	3	1955	WAYNE	BRAKE VELA			30		1955	9
31608	UPCHURCH MARY E	6	10	1939	WAYNE	LOU VERA		9	64		1939	
32338	UPCHURCH MARY LELA	7	30	1997	OLDHM	DUNCAN JENNY	1997	8	65	R	1997	2 6
38457	UPCHURCH MARY J	1	30	1933	CMBLD	BRUNNINGTON OLIVIA		9	77		1937	
51617	UPCHURCH MARY D	11	14	1933	WAYNE	MORRIS RUBY		9	104		1933	
54363	UPCHURCH MARY	4	14	1936	WAYNE	RAMSEY RUBY		9	109		1936	
60500	UPCHURCH MARY E	12	6	1927	CLNTN	DICK VELMA			121		1927	9
90428	UPCHURCH MARY SUE	5	25	1937	WAYNE	ALEXANDER MARIE	1997	2	183		1997	28 4
92767	UPCHURCH MARY J	1	30	1933	CMBLD	BREWINGTON OLIVIA		9	196		1951	
29896	UPCHURCH MASYN ALEXIS	7	30	1996	HARDN	YU CHUNG	1996	8	60		1996	2 19
28971	UPCHURCH MATTHEW ALEXANDER	8	19	1993	BOYLE	BLANDFORD SANDRA	1993	9	58	M	1993	1 3
26615	UPCHURCH MICHAEL SHANE	8	10	1985	DAVES	ALLEN SALLY	1985	8	54	A	1985	1 20
55609	UPCHURCH MICHAEL JOE	12	12	1976	PLSKI	CRISWELL BRENDA	1977	1	112	S	1976	1 4
56971	UPCHURCH MICHAEL EUGENE	11	14	1970	PLSKI	LOWE BETTY	1970	11	114	L	1970	1 30
58352	UPCHURCH MICHAEL G	10	26	1956	WAYNE	SHEPPHERD DORCUS			117		1956	9
11037	UPCHURCH MICHAELA ROSE	3	22	1995	OLDHM	DUNCAN JENNY	1995	3	23	R	1995	2 27
41232	UPCHURCH MICHELE ANNE	8	6	1970	PLSKI	DENNEY BRENDA	1970	8	83	J	1970	2 26
18689	UPCHURCH MICHELLE LYNN	5	15	1970	JEFFN	SPAIN FAYETTA	1970	6	38		1970	2 2
29104	UPCHURCH MIKAYLA SAGE	8	19	1996	DAVES	RUSSELBURG JENNIFER	1996	8	59	L	1996	2 27
62234	UPCHURCH MILVA D	11	28	1934	WAYNE	MORVERI RUBY		9	125		1935	
20867	UPCHURCH MISTY DIANE	5	19	1985	WAYNE	CATRON BRENDA	1985	5	42	G	1985	2 24
28753	UPCHURCH MISTY ELLEN	6	21	1979	PLSKI	DISHMAN BRENDA	1979	7	58	G	1979	2 9
50813	UPCHURCH MITCHEL ALLEN	12	7	1984	PLSKI	PREWITT JUDY	1985	1	102	L	1984	1 22
18797	UPCHURCH MONA M	4	5	1931	MOCRY	MEADOWS CARRIE		9	38		1938	
51292	UPCHURCH MONEDA LYNN	11	19	1978	JEFFN	MATTINGLY LINDA	1978	12	103	L	1978	2 4
3130	UPCHURCH MONICA RAYE	2	4	1974	GREEN	MCFARLAND GLENDA	1974	2	7	C	1974	2 22
12470	UPCHURCH MYRTLE	2	18	1944	WAYNE	DISHMAN ETTER			25		1944	9
11889	UPCHURCH NANCY G	2	15	1937	MTCLF	UPCHURCH MARY		9	24		1937	
27366	UPCHURCH NANCY M	6	6	1926	CLARK	SMITH GLADYS			55		1926	9
37415	UPCHURCH NANNIE L	8	16	1933	WAYNE	DISHMAN ETTA		9	75		1933	
48377	UPCHURCH NATHAN ROY	12	21	1995	JEFFN	BLONIEEN ANN	1995	12	97	M	1995	1 28
58848	UPCHURCH NETTA A	11	14	1927	WAYNE	UPCHURCH NORA			118		1927	9
54086	UPCHURCH NICHOLAS ALAN	12	24	1979	PLSKI	BROWN BEVERLY	1980	1	109	L	1979	1 3
11329	UPCHURCH NIKKI DANIELLE	3	13	1994	PLSKI	ANDERSON CAROLYN	1994	3	23	S	1994	2 22

① Mary U mar dau of South Wood U Sr b 15 JUL 1882.
she mrd Clyde M. Thompson. On FEB 1969 she
lived 520 Early Street, Savannah, GA. She has two
children Clyde Jr & Charles Thompson.
see Calvin Kelly U.

② [South Wood U Sr is son of John Winton U Sr
of More U / Ruffin U Subclan - RP4]

○ Info in ltr 24 MAY 2006 Calvin Kelly U to RPH - This info sent to him in 1992 by me Helen Christine U. Cal says she has since died as have her siblings

MRS HELEN WPCURCH
POPPELL
736 E. 45TH ST.
SAVANNAH, GA
31405

I. Mose U - Head of clan

A. Ruffin U

1. Kelly F. U

a. John Winton U, Sr b 15 JUN 1858

- ↓
- i. South Wood U, Sr b 15 JUL 1882 (Hampton, SC) d 7 JAN 1943
md 24 DEC 1908 (Springfield, GA) Theresia Mae Seckinger "Tressie"
b 23 OCT 1891 (Effingham Co, GA) christened DEC 1891 Bethel
Jethers Church, Springfield, GA d 17 MAY 1980 (Savannah, GA)
(Bus - Methodist Church Cam. Springfield, GA) D/o Walton Morgan
Seckinger & Lena Mae Wiles
- (i) Helen Christine U b 17 AUG 1909 (Springfield, GA) md 14 FEB 1938 C)
Clyde J. Poppell
- (ii) William Walton U b 19 DEC 1910 (Springfield, GA) d 17 OCT 1983
md 1 JUL 1933 Lerah Turner
- (iii) South Wood U, Jr b 1 DEC 1912 (Springfield, GA) d 23 JUN 1982
md 15 SEP 1934 C) Alma Wells
- (iv) Mary Davis U b 7 MAY 1916 (Springfield, GA)
md 4 JAN 1931 C) Clyde Maxwell Thompson
- (v) Kenneth Seckinger U b 28 NOV 1914 (Springfield, GA)
md JUL 1942 C) Sara Cook

① See It 10 JUL 1980 Elva Eva Burkhalter to RPH

Pg 17 - Mary Delaney U ↑ b 26 DEC 1859 d SEP 1932
mar dau of Matilda D. U (of Richard U III / Calumet U Clan)
and of Michael U (of Charles / Charity U Clan)

② See It 18 JUN 1988 Virginia Biann Kenney to RPH

1860 Census Randolph Co, AL

Michael U 30 M Farmer b GA [of Michael U]

Georgia A. M. U 19 F Housewife b GA

Charity S. U 3 F b AL [Charity Serina U]

Mary D. U 6/12 F b AL [Mary Delaney U ↑]

Charity S. U 66 F b NC.

③ See It 22 FEB 1989 Ray Olan Sparks to RPH

Mary Delaney U ↑ b AL d 11 NOV 1933 (Bonnie, TX) (Bur
at Pleasant Valley, TX between Post Oak, TX and
Buffalo Springs, TX. and James Harrison Sparks
b 1861 (Marian Co, TN) d 1900±? (Bur - Sallisaw, OK)
They had ten children.

④ See It 24 MAR 1989 Ray Olan Sparks to RPH

2 ea Frank Sparks was b in or near Sallisaw, OK
on 17 AUG 1897. His parents were James Harrison
Sparks and Mary Delaney U ↑ b 26 DEC 1859 d 11 SEP 1933.
Mary ↑ was widowed about 1900. About this time she
bought a small farm near Buffalo Springs, TX
and that is where she raised her large family
of about ten youngsters. Mary d 11 NOV 1933
according to a photo of her gravestone. She had
only ten children as far as I know.

④ - CONTINUED

1900 Census - City of Saltspring, OK

James H. Sparks b JUL 1860 age 39 b AL

Mary D. Sparks F wife b DEC 1859 age 40 b AL

+ 8 children and 2

Manson U M Boarder b SEP 1861 (AL) age 38

Arcola U F Boarder b DEC 1890 (TX) age 9

⑤ See Sparks Family Biog - Entry 5 APR 1993

James Harris Sparks (not Hanson) b ca 1861 (Marshall Co, AL md 29 AUG 1878 (in the home of D. U, the bride's father - Marshall Co, AL) Mary Delaney U d 11 NOV 1933

(Bowie, Clay Co, TX) (Bur - Pleasant Valley near Buffalo Springs, Clay Co, TX). The father of James gave permission for the marriage most likely because James was only 17 and under age. Mary's first child was born 3 weeks after the marriage and the 2nd 9 months later so this may have been a "shotgun" marriage. There were 10 children - 4 b AL, 3 somewhere in TX and 3 in OK.

We do not know how James made a living or how well he supported his family. He d ca 1900 at age 40 - after JUN 1899 (his son born 9 APR 1900) and before NOV 1902 at which time Mary was a widow living land in Pleasant Valley, TX. Clay Co, TX Records (Vol 44 Pg 184) show a deed whereby Mrs M. D. Sparks (nee M. D. H.) bought 145 acres for \$1450 from M/M H. H. MORGAN. Source of money unknown as is why she picked Pleasant Valley - may have lived there

○ From Ltr 12 DEC 2000 Phyllis Annie Campbell Ed RA
Re MARY DELANEY U & JAMES HARRISON SPARKS

I do have a copy of the Bonds of Marriage of James H. Sparks and Mary D. Upchurch. They were married 29th Aug. 1878 in Marshall Co. Alabama. Michael Upchurch was a bondsman and it was at D. Upchurch.

From there I pick up the story of Mary & James in Sallisaw, OK. James died and Mary buried him there but I don't know the cemetery. They had 8 children. Charlie stayed in OK. The others ^{L, [10-K & U]} moved with Mary to Pleasant Valley in Texas.

Item in It 1 SEP 2003

Phyllis Annis
Campbell &
RPA - Re Location
of Pleasant Valley
Cemetery, Clay
Co, TX

Pleasant Valley cem.
is right there where the
X is. The school house was
across the road and was used
for a place of worship. Some
of the early settlers were J.C. McGowan,
my great granddad, and M.G. Campbell,
my granddad.

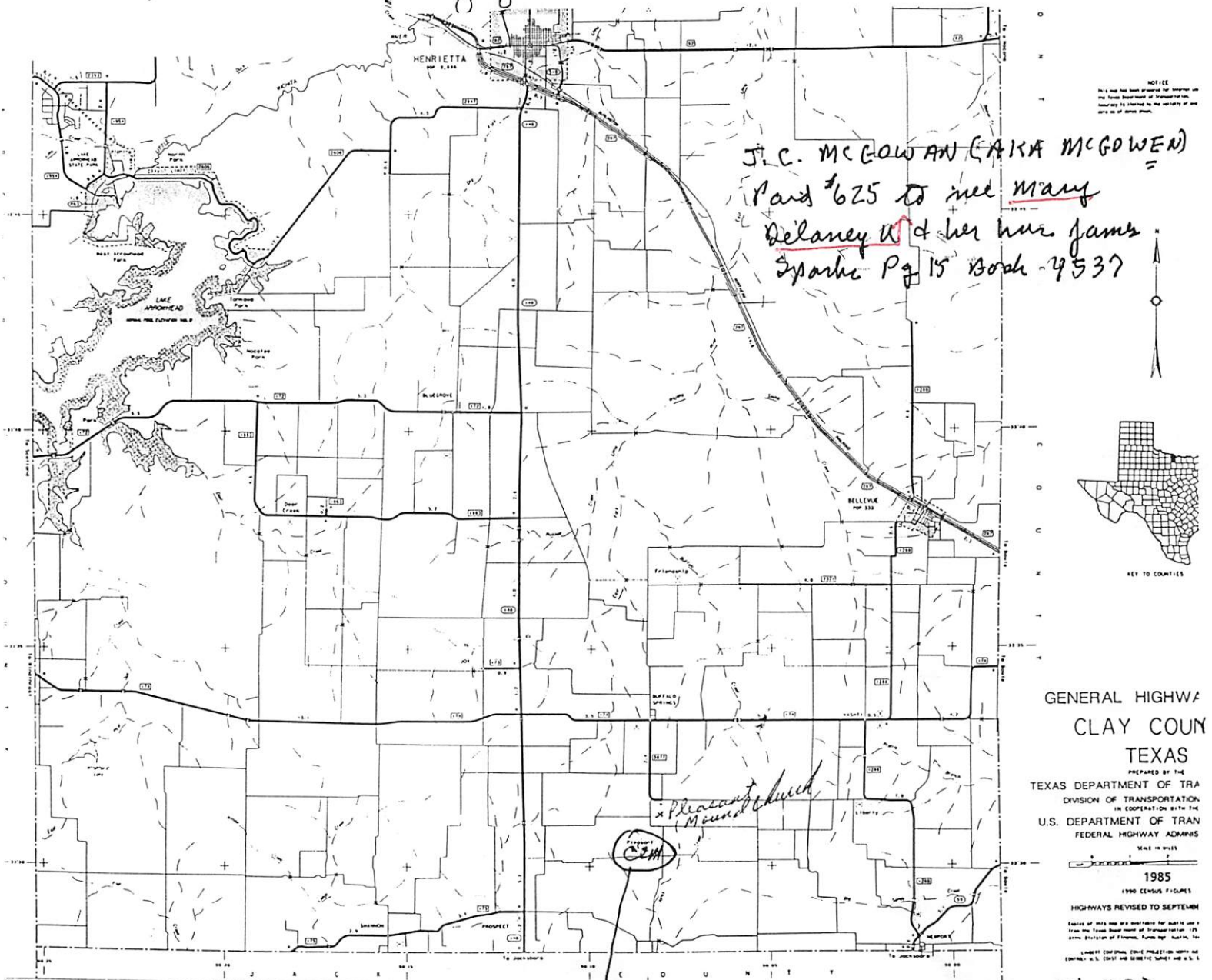

PLEASANT VALLEY CEMETERY APT
3 MILES SOUTH OF BUFFALO
SPRINGS, CLAY CO, TX

My Records 11 NOV 1998

SPARKS, James H.

Marriage

Wife: Mary D. UPCHURCH ^

Marriage Date: 29 Aug 1878

Recorded in: Marshall, Alabama

Source: FHL Number 1035276

Dates: 1877-1884

^ Mary Delaney U is of the Lunsford U line in the
Richard U, III / Clalurn U I subline.

see Ltr 12 JUN 2003 Phyllis Annis Campbell DAPA

Mary Delaney U b 26 DEC 1859 (AL) d 11 SEP 1933
(Pleasant Valley, TX) md 29 AUG 1878 (Marshall Co, AL) James
Harris Sparks b 12 JUL 1860 (Boaz, AL) d 23 JAN 1902 (Sallisaw,
OK)

○ From the 18 FEB 1996 Ray Alan Sparks & RPA [1900 CE SUS INDIAN TERRITORY, OK - Cherokee Nation Flint TSP11 NR. 23 E]

James H. Sparks b. JUL 1860 (AL) age 39 [JAMES HARRIS SPARKS]
Head of Household

Mary D. Sparks - WIF b. DEC 1859 (AL) age 40 [nee MARY DELANEY U]

Charles W. Sparks SON b. JUL 1883 (AL) age 16 [CHARLES WASHINGTON SPARKS, SR]

1) Robert M. Sparks SON b. DEC 1885 (AL) age 14 [ROBERT MICHAEL SPARKS]

James W. M. Sparks SON b. APR 1888 (TX) age 12 [JAMES WILLIAM SPARKS]

Pearly Sparks DAU b. SEP 1889 (TX) age 10 [PEARL LEOLA SPARKS]

Nettie B. Sparks DAU b. AUG 1891 (TX) age 8 [NETTIE BELLE SPARKS]

Mattie E. Sparks DAU b. MAR 1895 (IND. TERR) age 5 [MATTIE ELLA SPARKS]

Frank Z. Sparks SON b. AUG 1897 (IND. TERR) age 2 [ZEA FRANK SPARKS]

Ivy D. Sparks SON b. APR 1900 (IND. TERR) age 1/2 [DOY ORAL SPARKS]

2) { Marion Upchurch BO b. SEP 1861 (AL) age 38 [MARION FRANKLIN U]
ARCOLA Upchurch BO b. DEC 1890 (TX) age 9 [ARCOLA U]

Notes of RPA - 18 JUL 2003

1) Note that Mary Delaney U named her son "Michael", presumably after her father John Michael U.

2) The census shows "BO" presumably for "Boards" which could well be true. However Marion Franklin U is a brother of Mary Delaney U. Tentatively, it is assumed that Arcola is his daughter. Note that Arcola was b. in TX so Mary U & Marion must have moved from AL to TX more or less together and then from TX to OK more or less together.

○ See Sparks Family
for article "Tracing
the Sparks Family
History pg 13-16 from
Document Rec'd by
RPA from Ray Alan
Sparks - 18 FEB 1996

I. Richard U, III - Head of Clan
A. Clalun U, I

1. Lunford U

a. Georgia Ann
Matilda D. U

i. Mary
Delaney U
md C)
James
Harris
Sparks

This excerpt
based on
SPARKS
research
tracks Mary

& James from AL to TX
to OK to TX. Matilda
traveled with her son
Mary, Matilda md
John Michael U "Damp"
S/o Chantry U & GS/O
Charles U - Head of Clan.
There is no sign of
"Damp" in this excerpt

At that time the West was starting to attract settlers from the southern states who were suffering from the stultifying aftermath of the Civil War, the influx of "carpetbaggers" from the North, and the general social upheaval. Moving was made easier by the railroads that were penetrating into areas that had formerly only been accessible by horseback or wagon. The rails got to Nocona, Texas about 1887 from the East. Then Bowie was connected to the rail system on July 1, 1882, as the Fort Worth and Denver City Railway Company laid track toward Wichita Falls. To attract customers and develop freight business the various railway companies advertised heavily in the southern states about the bountiful conditions out west, where land was cheap, fertile, well watered, and available at the end of the rails. That was all true, of course, but they didn't talk much about the Indians.

Well, James and Mary surely read the advertising and made the decision to move. It is even likely that other members of the very large families, both the Sparks and the Upchurches, had already preceded them and wrote them letters of encouragement. The gravestones in the various cemeteries in Texas and Oklahoma attest to their presence in those days. So James and Mary traveled to Texas probably by rail to Nocona, and by wagon over to Pleasant Valley where they bought eighty acres of farm land in what was known as Block No. 87 of Wood Co. School Lands. Their next three children were born there in Clay County.

We can only guess what happened to make them dissatisfied in Pleasant Valley. It is likely that some of the extended family, both Sparks and Upchurch, had moved into Indian Territory and had written letters about the fertile land, with abundant rainfall, and how much more profitable it was to farm up there. Probably James made a trip to Sallisaw to check it out for himself. Anyhow, the decision was made and they sold their eighty acres on Sept. 27, 1893 to J. C. McGowan for \$625. The legal document of sale is found at the Court House, Henrietta, in book #4537. Both James and Mary signed their names with an x.

The family moved to the area around Sallisaw where the rest of their children were born. We do not know where their farm was located but they apparently did fairly well. It is likely that they had cattle and horses, pigs and chickens as was customary in those days. Probably the children did not receive much schooling. The worst part of it was the lack of protection from bands of rebellious Indians. Sure, peace treaties had been signed, and the leaders and most of the tribes were willing to abide by the laws. But, even as now, some Indians were poor, resentful and willing to steal in order to even things up. And so James and the family experienced repeated thefts of their horses, cows, etc. and when they would hole up in their log cabin, aim their guns through the cracks to shoot at the intruders they got return fire. We are told that on one of these raids, James was shot by an Indian and he died January 23, 1902. As of now, June 1993, we do not know how the estate was settled, but somehow Mary got some money out of it and returned to the same area in Clay County where she and James had lived before. The County Clerk of Clay County in Henrietta has in the book of records Vol. 44, page 184 a deed dated Nov. 20, 1902 showing that Mrs. M. D. Sparks paid \$1450, cash, to buy 145 acres of land in Pleasant Valley from Mr. and Mrs. H. H. Morgan. It was again, a part of the Wood Co. School Land. Mary at that time was almost 42 years old, widowed, with eight or nine children at hand. Charles had stayed in Sallisaw, but she had her granddaughter, Ida Mae Rogers, to rear following the death of Leola, who was Mary's firstborn. Mary must have been a very courageous and tough frontier woman in order to cope with that situation. We can just guess that some kindly neighbors, friends and relatives helped her from time to time.

There was at least one big improvement over Sallisaw, no renegade Indians. And there was a nearby school and a Freewill Baptist Church, occupying the same small building, making it possible to expose the kids to a bit of civilizing polish. The children gradually grew up and by 1918 they were all married and gone. Mary was 58 years old. In order to keep the farm going, she had a small three room house built about 150 feet from the main farm house where she could live alone, while she rented out the main house to whatever family that would come in and work the farm for her. At various times there was R. M. (Rob), and James W. (Will), and Mattie's husband, J. "Doug" Thompson, and Nettie's husband, George McGowan. Maybe there were some others. The farm was not well managed nor consistently. Farm animals were sold to cover bad management, and a debt was incurred of \$350. against the property. Mary's mind began to slip about 1927, and for several years the land taxes were not paid. Family members took advantage of her. Finally some of the family arranged to have the County Judge declare her incompetent, and let her affairs be handled by an administrator.

Mary died November 11, 1933 without leaving a will. It was in the midst of a general depression, and farms were not worth much money. When the Judge had the property appraised, and sold to the highest bidder on the courthouse steps in Henrietta, there was only one bidder, and that was A. D. Cozart. He paid about \$9.00 an acre, but only \$600 in cash, assuming all the unpaid taxes and the debt incumbering the property. When all the doctors bills, and other final expenses were paid, there was only about \$290. of Mary's estate to be distributed to her ten heirs. About \$29. for each family, or their heirs.

See Sparks Family for article "Tracing the Sparks Family History" - pg 13-16 - Rec'd 18 FEB 1996 from Ray Alan Sparks
NEW INFORMATION:

I. Francis Mancin Sparks, a blacksmith, b. about 1813 (SC) d. after 1870 (AL) m.d. (p SC) Elizabeth Horn - This couple was in Butler Co, GA for 1850 census but soon moved to Among, Etowah Co, AL (which is about 8 miles from Boaz, Marshall Co, AL where John Michael U "Dump" lived)

A. James Robert Sparks "Bob" b. 8 MAY 1832 (SC) [born just before parents m.d. but made legitimate by adoption in Marshall Co, AL in 1859] m.d. 4 JAN 1855 (DeKalb Co, AL) Margaret E. Brock. They soon moved to adjoining Marshall Co, AL. [They were in Marshall Co, AL for 1860 & 1870 census but about 1880 moved to Eufaula, Greene Co, AL after selling inheritance in Marshall Co AL

[NOTE:

This SPARKS
-UPCHURCH

enclave in of 160 A in 1877 & 500 A in 1878]

NE AL (SE

of MONTSVILLE)

included MARSHALL,

DEKALB & ETOWAH

Counties. It is

a coincidence

that James Robert

Sparks in 1880 moved

to Eufaula, Greene Co,

AL where the

ABEL U, SA Clan

located

1. James Harris Sparks b. abt 1861 m.d. 29 AUG 1878

(Marshall Co, AL) * Mary Delaney U b. 26 DEC 1855

[m.d. by Jose F. Miller, J.P. in home of her Father D. U - presume D = "DUMP" = * John Michael U - RPA]. James was underage and required permission of his father to marry. Mary was 7 months older than James. Their first child "Leola" was born a month after the marriage. Their 10 children were born - 4 in AL, 3 in TX

Georgia Ann Matilda D. U, her dau Mary Delaney U & Mary's son Zea Frank Sparks are bur at Pleasant Valley Cem, Clay Co, TX - Matilda in an unmarked grave. James Harris Sparks and his MOT are buried in Brakesland Cem, 6 miles from Sallisaw, OK. Earlier reports had James an Indian & born in TN - but not so per IVA EDMONDSON of Albertville, AL

MARY DELANEY U

(9)

○ Item in Ltr 18 FEB 1996 Ray Dean Sparks & APA - copies placed in
ZEA FRANK SPARKS Profiles of Zea Frank Sparks & Mary
Delaney U & moved from the latter (6)

He lived; he "was" a lot of things, but "family man" was not one of them. He was my father, but I never got to know him. Even if he had lived beyond his 33 years it's not likely we would have been drawn close to me for he and mother were separated and planning on divorce when the accident happened. Now, sixty years after his death, and I've just passed my 73 rd birthday, I wonder if I can conjure up what he was like?

Zea is an unusual name coming from a tradition in the Sparks line of which the earliest I have found is that of Zerah Sparks who was born in 1784. It seems that in each generation after that time, one of the boys would be named with a variation of that Z name. He was born in or near Sallisaw, Indian Territory, Oklahoma on August 17, 1897, the ninth child of James Harris Sparks and Mary Delaney Sparks.

The parents, although apparently illiterate (they signed documents with x marks) were successful farmers because they not only reared a large family, but created enough value in the farm so that the widow Sparks was able to sell it for a substantial sum when James died. When Zea was born most of the family was still intact, and all probably worked on the farm. The oldest, Maggie, had just turned 18; Charles was 15; R.M.(Rob) was almost 12; J. William (Will) was 9 1/2; Pearl was 8; Nettie was 6; and Mattie was 2 1/2.

Zea never got to know his father for James died sometime in early 1902. At that time Oklahoma was not yet a State of the USA (not until 1907) and Indian records if kept at all, were not well preserved. Consequently we don't know why nor exactly when James died. We can assume that the widow Sparks didn't like living in Indian Territory, because she chose to sell out and move back down to the Clay County, Texas area very close to where she and James had farmed just before moving up to the Cherokee Nation in September 1893.

James and Mary had sold their first farm in Clay County to J. C. McGowan in 1893 for \$625. On her return to Texas she bought 145 acres for \$1450. in cash (I wonder how much other funds she had left over from the sale of the Oklahoma farm?). That was November 1902 and she lived there until she died in November 1933 just a few weeks short of her 74th birthday.

It is likely that Zea was fussed over and cared for by his three sisters until the last baby, Oral, was born in April 1900. So when the family got back in Texas in 1902 Zea was probably displaced as the family pet by baby Oral. Just guessing, of course. The older brothers were big enough to work the farm, although the oldest, Charles had elected to remain in Sallisaw. The next, R. M. (Rob), then 17, didn't marry until nearly four years later and he probably took a major role in running the new farm.

What was it like on the farm at that time? Stories by my Mother and anecdotes in the Buffalo Springs Community History Book tell the story of a much slower paced and simpler society than that of today, 1993, some 90 years later. Transportation was by horse, either horseback or by wagon pulled by a horse. Shopping was for staple foods: sugar, flour, kerosene for the lamps, cloth for sewing at home, shoes and anything else that could not be made at home.

Many things could be provided by dint of hard work on the farm: garden vegetables, eggs, milk, canned fruit, and maybe even salt pork if the farm had some pigs. Most households made their own soap by combining wood ashes with animal fats. Water came from a dug well, as the water table was not very deep. Usually the well would be dug near the house, for it had to be carried in buckets, and it needed to be located apart and uphill, if possible, from the outdoor toilet. Some more progressive kitchens had a hand pump installed for cold well water. Later on the even more progressive farms would have a windmill pumping water into an elevated tank, with pipes leading into the kitchen. But running hot water was not an option in the early 1900s in Buffalo Springs area.

The land was cultivated by a single plow drawn by a horse (or mule) and a man plodding along on foot guiding the plow into rows as best he was able. Cotton, at that time, was the main cash crop, and the success of the crop depended on rainfall, for irrigation on large plots was not in use in that area. A large family was an asset on the farm, because even the small children could be used to chop weeds and pick cotton at harvest time. My Mother, Audrey, told me stories of life on the farm and she emphasized that the girls had to do a lot of the menial tasks: pick cotton, weed the garden and the cotton crops, chop wood, haul water, clean the chicken house, look for eggs, milk the cows, churn the butter, clean the house, cook, wash dishes, etc, etc.

The first school in Buffalo Springs was built about 1887 on land donated by J. B. Young, and the first teacher was Robert Akins. It would have been a one room school at first, but by the time when Zea would have started, about 1905, a new six room school was built on two acres nearer the town of Buffalo Springs. The new building, built in 1904, had a second story and above it all a tall belfry with a large brass bell for announcing class openings and dismissals. A class picture taken in 1909 shows about 85 children, mostly under ten years old, some as young as five. Books were bought by the parents and handed down to each child as required. The kids from Pleasant Valley would have had to walk about two miles, carrying their lunch from home in tin syrup buckets.

However, school was of lesser importance than getting the cash crops harvested, and so there were times aplenty when the boys, and even the girls, just skipped classes for a few weeks to pick cotton. Education was not highly regarded, and most boys dropped out before finishing the eighth grade.

Local churches were the focus of most social activities. Audrey spoke fondly of attending a "foot washing" Baptist Church, which most likely was really called the Missionary Baptist Church, established in 1898 and which had an organ. She claimed that she became more skilled at playing the organ than the preacher's daughter was.

It is almost certain that Zea Frank and Audrey first met in a church setting, and it is likely that Audrey already had played the organ in the neighboring community, only ten miles away, of Windthorst, where her grandfather, Thomas Leslie Hudson, had a prosperous farm. Audrey's mother, widowed in 1909, had sold her farm near Gomez, Texas and moved in with her father "temporarily" for seven years until in 1916 she bought 160 acres in Pleasant Valley. There had

(11) (8)

been occasions for visiting before then, for Ina's sister Adella (Aunt Dell) and her husband Fred Maxey also had a farm in Pleasant Valley, and the two families were very close. That is how Ruby, who was Audrey's oldest sister, had become acquainted with James William (Will) Sparks, whom she married in 1914. Will was an older brother of Zea.

By the year 1916, both Zea and Audrey were grown and marriageable. Of the Sparks family, only Zea and Oral were still unmarried. Ina Black's family had, besides Audrey, her sister JoAnne 13, and brother Harvey 7.

The older brothers would have taken the major job of running the farm until marrying and starting on their own. R. M. (Rob) was about 17 when the family came back to Buffalo Springs in 1902. The next boy was James William (Will), just 14. Then three girls: Pearl, 13; Nettie, 11; Mattie, 7; Zea, 5; and finally Oral 2 1/2. The widow Sparks, Mary Delaney, was just 43, and probably quite able to give guidance and direction to her brood.

Rob didn't marry until 1906 and I'm not sure how long he stayed on Mary D's farm, for he and his wife stayed in the vicinity at least until 1928 where all of their eight children were born. It is not likely that Zea ever had to take full charge of running the farm, even under Mary's guidance. But it is quite certain that he helped the family with the "boy type" jobs up until and just after the time he married. My Mother told me as much. Mother also said that Mary was much more strict with the girls than with the boys. For instance, when there were weekend parties (presumably church sponsored) the girls were not allowed to start getting ready until the last detail of house cleaning and dish washing was done, long after the boys had left with the wagon. I surmise that she wanted to "protect" them and not let befall them the same kind of pre-marital pregnancy that she herself had suffered.

In a time before television and radio, the young people found more wholesome ways to entertain themselves. Hunting and fishing sports were a favorite of the boys, along with pitching horseshoes and playing dominoes and card games. Doll parties were for the younger girls, and church socials were fun for the older ones, also the occasion for meeting young men. In this environment, it may be surprising to find lax sexual morality among young women, but it is true. For instance, among the Black sisters Audrey and Ruby were "straight laced", but Kate and JoAnne were "liberated women" well ahead of their time, belonging more to the mores of the 1990s than the 1910s. As for the Sparks boys, none were especially virtuous, and they likely found church not so much a place to find religion as it was a place to meet girls.

Zea was a good looking six footer when Audrey moved in down the country lane from the Sparks farm. It wasn't long before he proposed marriage, but she wasn't quite ready to make her choice, probably because of misgivings about his character. He didn't smoke nor drink, but he had not paid much attention to his education and she was well ahead of him in that respect, for she had already received her certificate for teaching the first four grades. (Ruby had also attended the Normal School in the summer for a few weeks to get her certificate, and she was already teaching in a one-room school, making about \$30. a month.). However, Audrey got a chance at a better job in nearby Lawton, Oklahoma, where her sister Kate had a job with the telephone

company. It was wartime, the boys were registering for the draft, and there was an Army base near Lawton. As it turned out, Audrey got a job with the telephone company, and moved into a much more cosmopolitan society at Lawton, living near Kate, meeting lots of young, attractive and eligible men. She had a marvelous time, found a degree of financial independence, and almost fell in love with a young Polish man from back East. But Zea kept in touch with her with letters and phone calls, urging her to come back. He already had his draft papers and a date to be inducted into the Army when the armistice was signed, and he didn't have to go. About that time Audrey came back on a visit to Pleasant Valley, and allowed herself to be persuaded.

He outlined a prosperous future for them, away from the farm, in the fabulous new "oilfields" at Burkburnett, not far away, where farm boys could learn new skills and make lots of money. And so they were married in a private ceremony in the Methodist Church in Buffalo Springs, September 10, 1918. He had to stay on the farm just long enough to finish harvesting the cotton crop before they would launch themselves into their bright future.

While Audrey had been in Lawton, Zea flirted with a couple of other girls just in case that Audrey would refuse him at last. Of course, it was dangerous to his relationship with Audrey, but he took the risk. Then, a couple of weeks after they were married, there was a picnic party after church services, and Zea walked arm-in-arm with one of his old girl-friends, allowing Audrey to walk behind them, unattended. Audrey was furious, not the kind for violence or loud talk, but the cold kind, seeking revenge. She found her's in the bedroom, withholding her love, being very cold and unresponsive.

Zea was not accustomed to being thwarted by women for he was spoiled, handsome and by the standards of Buffalo Springs, he was a smooth, desirable catch. His response to Audrey's tactics was to seek his pleasure elsewhere, not to entirely replace his own bedroom but rather to supplement it. In this way their relationship was soured almost from the very beginning.

They went to Burkburnett while it was in a raw, boomtown phase, too many people, too few houses, muddy streets, horse drawn wagons, few cars, board sidewalks, but jobs for any young able bodied farm boy that could manage a team of horses. Zea got a job right away and he learned that the better jobs were on the floor of the oil well derricks. He learned those rough tasks too, and began to make \$5.00 a day, more money than he had ever seen before. I was born, their first child, in March of 1920 in Petrolia which is just a few miles from Burkburnett, where they had rented a small place. But, for some unexplained reason, they left and moved back to the vicinity of Burk and lived in a makeshift structure, maybe a tent erected on a wooden platform. Audrey related to me that Zea had a brief illicit liaison with an older, foreign woman who was the proprietress of a grocery store while they lived there.

Then they moved to the "C. Burke Lease" into a good (for those times) oil company owned house, two bedrooms, living room, kitchen and porch. It had a covered garage, a well, a storm cellar, and a pen (probably Zea erected it) for a Jersey milk cow. Zea had a job looking after a field of proven wells that had been set to pump oil, night and day, powered by a central power station. His job was to watch over the operation, and take corrective action if anything went

wrong. Most of the time things went smoothly, and although the job and benefits were good, it was a boring job for a young guy, leaving him isolated from other people for long periods.

That was a period of relative prosperity for Zea and Audrey.. My brother June Donald (he later changed his name) was born there. They bought their first car, a Model T Ford, for about \$500. But their relationship went down hill. Audrey had a visit from her brother-in-law, Leonard Howell, who had married JoAnne, Audrey's sister in 1918. Leonard had a sorry tale to tell, for after four years of marriage and two children, JoAnne had left him and the children and moved to Wichita Falls, and was making her living as a prostitute. Further, he had spied on her enough to know that she had been having meetings with Zea while he was supposedly been on his rounds out in the oil field, inspecting the machinery.

This was not something new in his behavior, but it seemed especially hurtful, doing it with her sister. She told Zea that she would only stay with him until Ray and Don could be a little older, and she in turn could find a job and become independent. No doubt, their relationship became very strained, especially in the bedroom but it was not until about 1927 that a definite break came about. They were living on the Wagner Lease in a company house, out in some primitive acreage near a river, about 15 miles from Vernon, and Zea had another job tending pumping equipment. This time he even had a helper, a long time friend named Clarence Mitchell. Now Clarence and Lucille Mitchell and the Sparks duo had been friends for four years, even attending picnics and dances together.

One day Zea informed Clarence that he needed to make a trip to town and asked Clarence to keep an eye on things. But this trip was a part of a pattern that made Clarence suspicious, and so he followed along after a bit, and dropped in on his house. Sure enough, there was Zea with Lucille. He threatened to kill Zea, and he had a gun with him.. He told Zea that he had to leave the area, quit the job they had shared, and if he ever saw him again he would kill him. He also told Audrey the whole sordid story.

The family moved for a couple of weeks up to Vernon before breaking up. Zea had such a bad record with the oil companies that he was on a "blacklist" and so he decided to go to barber school. (I think the school was in Wichita Falls.) Audrey's sister Kate, divorced now, was working in the post office in Pyote, Texas and Kate told her that she could have a job if she cared to move in with her for a few weeks.

Pyote had been a tiny country town of two hundred people until oil was discovered in the vicinity, bringing a couple of thousand strangers. Newcomers had to erect tents, or primitive wooden shacks, or live in rudimentary trailers. Kate was upscale, with a fifteen by forty foot wooden shack, with sheetrock over the two by fours, inside and out. Outdoor toilet, but running water. Kate was divorced from Fred, and had besides her two sons, Joel and Earl, had her mother Kate living with her. We piled in on that crowded space and lived there for about a year.

Nearby town of Wink was twice as large and was undergoing the same sort of forced growth as Pyote had suffered. The living arrangement in Pyote was so bad that when Audrey found a job opening at the Wink telephone office she took it. Zea showed up about that time, looking for a

job, for he had apparently not found anything in barbering. Anyhow he helped us move into a tent in Wink. Some developers had subdivided acreage near the ballpark into small lots and provided just two improvements: piped in water with a faucet, and an outdoor toilet. We had to buy a fifteen by fifteen wooden platform and a canvas tent to fit over it. Zea tried to ingratiate himself with Audrey, but too much damage had been done. He left to find work and make a separate life for himself. But living alone with no help was a bad situation, too, with nobody home with two boys ages eight and six. By the time school would start in September, Kate had moved up to Wink also, and was working with the post office. She had bought a house and lot right in town, a fairly respectable house with an indoor toilet. There was a small shack on one edge of the property, and soon we moved our family of three into it. The big advantage was that Ina was there to look after the kids. All four of us boys attended school in a new brick school facility, the best we had ever seen. The only time I can remember seeing Zea during that year, was once he came by with a fairly new four-door Chevrolet. He had found a job somewhere, had saved a little money, had reformed (he said) and wanted to rejoin the family.

Audrey then found a better job with the post office in Hobbs, New Mexico, seventy miles north of Wink, in a new office where she could teach the Postmaster how things should be run. We moved into a fairly decent old house and from time to time Zea would show up and stay for a short time. When the oil company found out that he was on the "list" he lost his job. I remember going out into the field with him one time when he inquired about getting a job without success. He seemed to put up a bold front, but in retrospect he seemed a sorrowful, desperate man. That was about 1930, a bad time for anybody looking for a job, and being blacklisted. But Zea couldn't get back into Audrey's good graces, much as he tried to seek her forgiveness.

Ina moved up to stay with us, as Kate had come into some insurance money when Joel was killed. Kate was able to quit her job and move to Arizona with Earl and so Ina came up to help us in Hobbs. At that time we were living in a shack twelve by forty, that was owned by Kate. It had running water, with an outdoor toilet. It was in that house that I saw Zea alive for the last time. He came by one day, out of work and desperate, begging to stay overnight, and so Audrey let him share her bed. Then he begged to have sex with her, but she adamantly refused, because she feared getting some venereal disease, knowing that Zea had likely been sleeping with various prostitutes. The quarelling went on all night, and the next morning she forced him to leave and said that he was not to come back. That was sometime in 1930.

He disappeared into the Texas scene, and I believe that he changed his name to Leo F. Sparks to defeat the blacklist. We got the news that he had been killed in an accident on the drilling floor of a rig about fifteen miles out of Shamrock, Texas on the 28th of March, 1932. There was no autopsy made of the body, and the undertaker, M. M. Nix and Co., merely described the cause of death, "accident at oil well". Cora Fay Thompson, age 18 at that time, was fond of Zea, and she and her family, (her mother Mattie was Zea's sister) lived in Shamrock, saw him often and liked him. Cora Fay accompanied the undertaker to take the body down to the Pleasant Valley Cemetery, in Clay County where was buried on March 31. The death certificate which reads

"Leo F. Sparks" says that he was divorced. I was ten and Don was eight. We came with Audrey to the funeral, which was right next door to where they had both gone to church, down the lane where their families, the Blacks and the Sparks, had their farms, and they had first come to know one another. When they opened the casket we looked on his face for the last time. We were long accustomed to his absence. We didn't have much feeling about it, and we didn't cry.

Now sixty years have passed, and I wonder about the strange man who was my father. He was a person, as I see it, with plenty of potential, but he was a miserable failure in life. He was unfaithful to a wife who would not tolerate unfaithfulness. He refused to accept her verdict, and instead of changing his behavior, he defied her and persisted in seeking the company of other women. And he thought that Audrey should yield to his authority, and accept him with all his faults. His idea of marriage relations were formed out of what? No self respecting woman would have tolerated such infidelity. Maybe he had a disease when he died. We'll never know. Would he have made something of his life if he had lived? I feel sorrow and pity for the man I never really knew. I'm sorry he didn't straighten up and be a good father to me. And I'm sorry that he made such a mess of his life.

See Ltr 18 FEB 1996 Ray Alan Sparks D RPU - For Picture of 36 people at Sparks Reunion - JUN 1929

Individuals new to RPU files from the picture are as follows: (In CAPS) * = Not New, In Picture [] Name used in Picture

I. * Mary Delaney U of the Richard U, III / Clarence U Subban - Lunsford U Lind [Mary D. Sparks] mrs

A. * Robert Michael Sparks [ROB]

1. ELMO SPARKS

4. LOUISE SPARKS

2. STERLING SPARKS

5. VIRGIL SPARKS

3. GLADYS SPARKS

B. * James William Sparks [Will, Preacher] m d () * Belva - -

C. * Pearl Leola Sparks m d () * A. CALTER JONES [COL JONES]

1. EDNA JONES

D. * Nettie Belle Sparks m d () * George McGowan

1. George Lee McGowan [LEE] 3. Elsie Irene McGowan

2. * Mattie Irene McGowan 4. Lillie Belle McGowan [LILLIE] m d () BEN WHITE

E. * Mattie Ella Sparks m d () * Jackson Douglas Thompson

1. CORENE THOMPSON

F. * Zea Frank Sparks

G. * Roy Oral Sparks [ORAL] m d () * Frances Rogers

1. WYATT SPARKS ; 2. JAMES SPARKS

3. BILLIE JEAN SPARKS

Also in Picture: * Georgia Ann Matilda D. U [Matilda U] - mot of Mary Delaney U + Mary's brother * Marion Franklin U [Marion Frank U] & Mary's sister * Eula Fally U [Eula Uphurch Innman] + 9 Not identified / linked by RPU

○ See Sparks Family Entry 5 APR 1993 Pages 7-11

This document has been extracted previously for Ysurch details.

Added information is now being gleaned re the movement of the early generations of the Sparks Family prior to the mfg of James Harris Sparks to Mary Delaney U in 1878 in Marshall Co, AL. Perhaps the two families linked up before both families moved to AL from GA about 1850

I. Zerah Sparks b abt 1784 (p Pittsylvania Co, VA) d abt 1868 (Marshall Co, AL). Most of his life spent in area of Spartenburg + Union Cos, SC but moved to BUTTS CO, GA 1844 then to Marshall Co, AL. He lived in NC for a short time before 1844

A. Francis Marion Sparks b abt 1813 (SC) moved with FAT to Butts Co, GA in 1844 at which time he was already md. Was an 1850 Butts Co Census. Between 1849 + 1850 Marion & brother James went to Marshall Co, AL to homestead land. In 1853 they & their FAT moved to Little Mills Valley near Delahunty, DeKalb Co, AL. Marion is also reported to have moved to Annora, Etowah Co, AL abt 5 mi S of Boay, Marshall Co, AL. In 1957 the FAT moved to Marshall Co, AL

1. James Robert Sparks "Bob" b 8 MAY 1832 (SC) - to Butts Co, GA with parents in 1844 & then with them to AL in 1853

md 4 JAN 1855 (DeKalb Co, AL) Margaret E. Brock b 1834 (VA)

Moved to Marshall Co, AL shortly after mfg.

I. Richard U, II

A. Richard U, III

1. Clahum U, I

a. Lunsford U

i. Georgia Ann Matilda D. U

B. Charles U

1. Chantey U

a. John Michael U "DUMP"

a. James Harris Sparks b abt 1861 md 29 AUG 1878 (Marshall Co, AL) Mary Delaney U b 26 DEC 1859 (AL)

NOTE: In 1835 the Cherokee Nation Ceded Land in AL leading to creation of DeKalb, Cherokee & Marshall Cos, AL - See AL File for APU Colored Map.

NOTE: Need to check on possible Ysurch activity in BUTTS Co GA & Against Henry Co, GA on South

THE STATE OF TEXAS,

Know all Men by these Presents:

COUNTY OF Clay

THAT vs. H. H. Morgan and M. E. Morgan husband and wife

of the County of Clay

and State of Texas

for and in consideration of

the sum of Fourteen hundred and fifty DOLLARS,
to and in hand paid by Mrs. M. D. Sparks, the receipt of which is hereby

acknowledged

have GRANTED, SOLD AND CONVEYED, and by these presents do GRANT, SELL AND CONVEY, unto the said Mrs. M. D. Sparks

of the County of Clay

and State of Texas

all that certain

Tract or parcel of land situated in Clay County, Texas, consisting of 145 acres as follows:

No. 1. first tract: Beginning at N.W. corner of Block No. 109. Thence South 1420 yds. to N.E. corner of N.E. Dunham tract out of Sd. Wood Co. School Land. Thence West 576 yds. a stalk on Sd. Dunham N.E. line. Thence North 1420 yds. to N.E. line of Block No. 109. Thence East on Sd. N.E. line 576 yds. to the place of beginning containing 136 acres of land.

2nd tract: Beginning at the South West corner of tract No. 1 Thence West 227 yds. Thence North 372 yds. Thence East 227 yds. to the West line of said 130 acre tract. Thence South 372 yds. to the place of beginning containing 15 acres of land. Said land being a part of a 451 1/2 acre tract of Wood County School Land.

→ [NEE MARY DELANEY U - From Sparks Family Document dated SA PR 1993 - pg 5

TO HAVE AND TO HOLD the above described premises, together with all and singular the rights and appurtenances thereto in anywise belonging unto the said Mrs. M. D. Sparks and her

heirs and assigns forever. And unto hereby bind and heirs, executors and administrators, to WARRANT AND FOREVER DEFEND, all and singular the said premises unto the said Mrs. M. D. Sparks and her

heirs and assigns, against every person whomsoever lawfully claiming or to claim the same or any part thereof.

WITNESS our hands at Port Neches, this 20th day of November A. D. 1902

Signed and delivered in Presence of

H. H. Morgan
M. E. Morgan

THE STATE OF TEXAS,

County of Jack

BEFORE ME, P. H. M. Roberts a Justice of the Peace

and ex officio Notary Public

In and for Jack

County, Texas, on this day personally appeared H. H. Morgan and

M. E. Morgan wife of H. H. Morgan known to me personally

to be the persons whose names are subscribed to the foregoing instrument, and acknowledged to me that they executed the same for the purposes and consideration therein expressed.

And the said M. E. Morgan wife of the said H. H. Morgan having been examined by me privately and apart from her husband, and having the same by me fully explained to her, she, the said M. E. Morgan acknowledged such instrument to be her act and deed, and she declared that she had willingly signed the same for the purposes and consideration therein expressed, and that she did not wish to retract it.

Given under my hand and seal of office, this 20th day of November A.D. 1902
{L. S.} P. H. M. Roberts a Justice of the Peace & ex officio Notary Public.
Jack County Texas

Filed for Record the 2nd day of November 1902, at 1 o'clock A.M., and Recorded the 3rd day of November 1902 at 2:30 o'clock P.M.

By _____ Deputy.

C. S. Karst
Clerk Clay County, Texas

Records for Charity S. U 1798-1880⁺ D/o Charles U, Head of clan
and her son John Michael U "Dumpy" 1829-1903 - RAL 7 JUN 2011
I. Charles U - Head of clan 1850 CENSUS GA 1860 CENSUS - AL
A. A. Charity S. U 1798-1880⁺ HENRY CO. DIST RANDOLPH CO. SOUTHERN
MO () - NONE FOUND 42 DIV. PO = LOUISIANA

A1. James Monroe U, II
2) K CSA b 1834 (Henry Co., GA) d 13 DEC 1892
Cousins (Clark Co., TX) Md ()
A R Sarah Eliza U 1838-1925 D/o
Clahum U, I & G/D/o Richard U, III Head of clan
3) 2) John Michael U "DUMP" b 1 JUL 1829
2ND K Henry Co., GA ne Hancock Co., GA) d
COUSINS 3 MAR 1903 (Wellington, Collingsworth Co., TX)
ONCE Md 1836 (Henry Co., GA) Georgia Ann
RE- Mauda D. U b 22 FEB 1840 (Henry Co., GA)
MOVED d 22 JAN 1921 (Wellington, TX) D/o
Lansford U, G/D/o Clahum U, I.
A a. Charity Serena U b 12 JAN 1857 (AL)
A b. Mary Delaney U b 26 DEC 1859 (AL)
A c. William Michael U b SEP 1862
A d. Marion Franklin U b
A e. Georgia Ann Janice U b 7 DEC 1869
A f. Eula Fally U b 7 NOV 1872
A g. Martha Missouri U b 7 AUG 1875
C (Marshall Co., AL)
A h. Minnie Arizene U b 1 JUN 1878
A i. La Murre U (LEMOSE?) b 7 OCT 1881 (AL)
A j. John Sherman U b 4 AUG 1885 (AL)

Michael Upchurch 1830 30 GA
Georgia A M Upchurch 1841 19 GA
Charity S Upchurch 1857 3 AL
Marv D Upchurch 1859 6/12 AL
Charity Upchurch 1794 66 NC
1870 CENSUS - AL
RANDOLPH CO. LOUISIANA

FARMER 150/100
Milon Upchurch 1829 41
Georgia A Upchurch 1840 30
Charity S Upchurch 1857 13
Marv D Upchurch 1860 10
William Upchurch 1863 7
Marion Upchurch 1865 5
Gere Ann Upchurch 1869 6/12
Charity Upchurch 1791 79

1880 CENSUS AL
MARSHALL COUNTY

Michal Upchurch GA 1829 51
Matilda G. Upchurch GA 1840 40
William M. Upchurch 1863 17
Franklin M. Upchurch 1867 13
Vice G. Upchurch 1869 11
Ulas F. Upchurch 1872 8
Martha M. Upchurch 1876 4
Miney A. Upchurch 1868 2
Charita Upchurch NC 1798 82

1900 CENSUS - TX
CASS CO - JUSTICE
PRECINCT 6

Michael Upchurch JUL 1828 71 GA
Matilda Upchurch SEP 1838 61 AL
John S Upchurch AUG 1885 14 AL

1) La Murre born after 1880 and left the home before 1900 hence does not appear in her parents home on either the 1880 or 1900 census
2) The Master Outline for this couple maintained with the Richard U, III / Clahum U, I Subclan - Sarah Eliza U Line
3) The Master Outline for this couple maintained with the Richard U, III / Clahum U, I Subclan - Lansford U Line

○ RPU PROPOSED LINKAGE FOR WALTER R. U b ABT 1869 (NC)
 At one point this family was in the Greensboro/Charlotte,
 NC area but then settled in Clarke Co, GA (Athens) or in
 adjoining Oconee Co, GA. I speculate that Walter R. U md (1st)
 and had child A, then md 2nd & had B, C & D
 " (HYPOTHETICAL)

I. WALTER R. U b 1869 (NC) md (1st) — — —
 MO (2ND) () ALICE J. —² b ABOU 1884 [AKA HALLIE J. —]

A. ¹ Charles Latimer U, I b 25 FEB 1894 (GA) d 6 NOV 1936
 (Clarke Co, GA) md () Mary Dwyer b ABT 1882 ()
 d 3 FEB 1953 (Clarke Co, GA)

1. George Vance U b 1903 (NC) md (Greenville, SC)
 Marjorie E. West b 1904

a. Charles Latimer U, II b 27 OCT 1925 (Charlotte, NC)
 [→ Athens after 1930] md () Sally Nash

b. Mary Lou U b 1927

c. George U b after 1930 - lived Blairsville, Union Co, GA

2. John C. U [C = CHARLES OR CALVIN] md (Greenville, SC)
 ELINOR I. GALLOWAY

a. Vance W. U b 1921

3. Charles Bernard (BERNARD?) md Celeste Knight - ^{of} ~~Dallas~~ ^{AL}

4. Mary Delia U [↑]

5. Herman Boyd U b 24 NOV 1916 (GA) d 26 JUN 1975 (Clarke Co, GA)

B. ² Walter C. U b ABT 1914 (NC) [AKA Walter R. U] d 12 AUG 1987 (Clarke Co, GA)

C. ² William B. U b ABT 1916 GA [b 5 NOV 1915] d 15 MAR 1973 (CLARKE Co, GA)

D. ² Letha M. U b ABT 1919

D. ² Letha M. U b

① CENSUS RECORDS - OCONEE CO, GA

1920

	WILDCAT TSP
△	ED 129, p. 16, dwelling 302, family 308
	C. L. Upchurch 40 NC
	wife Mary 38 NC
△	son George 17 NC
△	John C. 14 NC
△	Charles V. 12 NC
△	<u>Mary</u> 7 NC
△	Herman 3 3/12 GA

1930

	BOGART
	ED 13, p. 1, dwelling 3, family 3
△	Walter R Upchurch 60 HEAD 1869 NC
	Alice J Upchurch 45 WIFE 1884
△	Walter C Upchurch 15 SON 1914
△	Wilbur B Upchurch 13 SON 1916
△	Letha M Upchurch 10 DAU 1919

For Oconee Co, GA there is only 1 Upchurch family listed in 1920 and one for 1930 as shown above. The are clearly different. However, note that they started in NC

- ① Mary Delores U b 14 NOV 1933 md 1956 George Fishner
Mary is dau of Hugh Silas U, gd of Cullen Bryant U
& gd of Silas Melvin U of George/Shadrach U
Clan (29, Pg 148).
- ② see Ltr 17 JAN 1992 Melva Davis U to RPH
I. Bretcher Cullen U {AKA Cullen B. U & incorrectly
as Cullen Bryant U} of the George U Shadrach
U Subclan - Mover U line.
A. Silas Hugh U [AKA Hugh Silas U]
1. Mary Delores U
- ③ See Ltr 13 FEB 1992 Melva Davis U to RPH
MDU d APR 1982 md George TISHNER, They had four
children.
- ④ See Ltr 9 MAR 1992 Melva Davis U to RPH
MDU d 11 APR 1983 and to live in Cem in Tipton, IN
- ⑤ See Ltr 22 JUN 1992 Melva Davis U to RPH
MDU b Monticello, KY d 16 APR 1983 (Tipton, IN)
md 25 JUN 1955 (Monticello, KY) md George Tishner
d 8 APR 1933 (Tipton, IN). They had just four children
- ⑥ See Ltr 13 JUL 1999 Cynthia Charlene Tishner to RPH
For MDU the correct spelling is DELORES - she
is mother of Cynthia

MARY DEMENT U

①

○ RPU Assembled Input for MARY DEMENT U D/O
 William Archibald U, Sr of the William U III Class -
 - 2 NOV 2013

JUN 5 1974		NORTH CAROLINA STATE BOARD OF HEALTH OFFICE OF VITAL STATISTICS		16673	
REGISTRATION DISTRICT NO. 24-92		LOCAL NO. 839		CERTIFICATE OF DEATH	
NAME OF DECEASED		MARY UPCHURCH LASSITER		DATE OF DEATH	
1. MARY		UPCHURCH LASSITER		2. May 3, 1974	
SEX	COLOR OR RACE	STATE OF BIRTH	DATE OF BIRTH	AGE	TIME
Female	White	North Carolina	Nov. 2, 1906	67	
PLACE OF DEATH		CITY OR TOWN	STATE	COUNTY	
Forsyth		Winston-Salem	North Carolina	Forsyth	
NAME OF HOSPITAL OR INSTITUTION		INSIDE CITY LIMITS		STREET ADDRESS OR R.F.D. NO.	
Forsyth Memorial Hospital		Yes		3514 N. Cherry St.	
MARRIED, NEVER MARRIED, WIDOWED, DIVORCED	SURVIVING SPOUSE	STREET ADDRESS OR R.F.D. NO.		CITY LIMITS	
Married	James E. Lassiter	3514 N. Cherry St.		Yes	
CITIZEN OF WHAT COUNTRY	SOCIAL SECURITY NUMBER	USUAL OCCUPATION	KIND OF BUSINESS OR INDUSTRY		
U.S.A.	240-76-7218	Owner & Operator	Beauty Salon		
FATHER'S NAME		MOTHER'S MAIDEN NAME			
William A. Upchurch		Annie Bryan			
17 Mr. James E. Lassiter, 3514 N. Cherry St., Winston-Salem, N. C.					
PART I DEATH CAUSED BY					
1. 12X Immediate Cause: Bronchopneumonia					
2. 12X Contributing Cause: Emphysema					
3. 12X Other Significant Conditions: Hematuria, left kidney, unproven exfoliation					
PART II OTHER SIGNIFICANT CONDITIONS					
20. Hematuria, left kidney, unproven exfoliation					
21. ACCIDENT, SUICIDE, HOMICIDE, OR UNDETERMINED					
22. ABOVE THE DECEASED WAS RECOGNIZED DEAD AT					
23. SIGNATURE OF PHYSICIAN					
24. SIGNATURE OF MEDICAL EXAMINER OR ACTING MEDICAL EXAMINER					
25. SIGNATURE OF FUNERAL DIRECTOR					
26. SIGNATURE OF EMBALMER					
27. DATE RECD BY LOCAL REG					
28. SIGNATURE OF EMBALMER					
29. SIGNATURE OF EMBALMER					
30. SIGNATURE OF EMBALMER					
31. SIGNATURE OF EMBALMER					
32. SIGNATURE OF EMBALMER					
33. SIGNATURE OF EMBALMER					
34. SIGNATURE OF EMBALMER					
35. SIGNATURE OF EMBALMER					
36. SIGNATURE OF EMBALMER					
37. SIGNATURE OF EMBALMER					
38. SIGNATURE OF EMBALMER					
39. SIGNATURE OF EMBALMER					
40. SIGNATURE OF EMBALMER					
41. SIGNATURE OF EMBALMER					
42. SIGNATURE OF EMBALMER					
43. SIGNATURE OF EMBALMER					
44. SIGNATURE OF EMBALMER					
45. SIGNATURE OF EMBALMER					
46. SIGNATURE OF EMBALMER					
47. SIGNATURE OF EMBALMER					
48. SIGNATURE OF EMBALMER					
49. SIGNATURE OF EMBALMER					
50. SIGNATURE OF EMBALMER					
51. SIGNATURE OF EMBALMER					
52. SIGNATURE OF EMBALMER					
53. SIGNATURE OF EMBALMER					
54. SIGNATURE OF EMBALMER					
55. SIGNATURE OF EMBALMER					
56. SIGNATURE OF EMBALMER					
57. SIGNATURE OF EMBALMER					
58. SIGNATURE OF EMBALMER					
59. SIGNATURE OF EMBALMER					
60. SIGNATURE OF EMBALMER					
61. SIGNATURE OF EMBALMER					
62. SIGNATURE OF EMBALMER					
63. SIGNATURE OF EMBALMER					
64. SIGNATURE OF EMBALMER					
65. SIGNATURE OF EMBALMER					
66. SIGNATURE OF EMBALMER					
67. SIGNATURE OF EMBALMER					
68. SIGNATURE OF EMBALMER					
69. SIGNATURE OF EMBALMER					
70. SIGNATURE OF EMBALMER					
71. SIGNATURE OF EMBALMER					
72. SIGNATURE OF EMBALMER					
73. SIGNATURE OF EMBALMER					
74. SIGNATURE OF EMBALMER					
75. SIGNATURE OF EMBALMER					
76. SIGNATURE OF EMBALMER					
77. SIGNATURE OF EMBALMER					
78. SIGNATURE OF EMBALMER					
79. SIGNATURE OF EMBALMER					
80. SIGNATURE OF EMBALMER					
81. SIGNATURE OF EMBALMER					
82. SIGNATURE OF EMBALMER					
83. SIGNATURE OF EMBALMER					
84. SIGNATURE OF EMBALMER					
85. SIGNATURE OF EMBALMER					
86. SIGNATURE OF EMBALMER					
87. SIGNATURE OF EMBALMER					
88. SIGNATURE OF EMBALMER					
89. SIGNATURE OF EMBALMER					
90. SIGNATURE OF EMBALMER					
91. SIGNATURE OF EMBALMER					
92. SIGNATURE OF EMBALMER					
93. SIGNATURE OF EMBALMER					
94. SIGNATURE OF EMBALMER					
95. SIGNATURE OF EMBALMER					
96. SIGNATURE OF EMBALMER					
97. SIGNATURE OF EMBALMER					
98. SIGNATURE OF EMBALMER					
99. SIGNATURE OF EMBALMER					
100. SIGNATURE OF EMBALMER					

FIND A GRAVE



Mary Upchurch Lassiter

Birth: Nov. 2, 1906
 North Carolina, USA
 Death: May 3, 1974
 Winston-Salem
 Forsyth County
 North Carolina, USA

Wife of James E. Lassiter; daughter of William A. and Annie (Bryan) Upchurch.

Burial:
 Oakwood Cemetery
 Raleigh
 Wake County
 North Carolina, USA

Created by: Rich Kreiss
 Record added: Jun 15, 2012
 Find A Grave Memorial# 91949295

Name: Mary Upchurch Lassiter
 [Mary Upchurch Upchurch]

Gender: Female

Race: White

Age: 67

Birth Date: 2 Nov 1906

Birth Place: North Carolina, United States

Death Date: 3 May 1974

Death Location: Winston-Salem, Forsyth

Spouse's Name: James E Lassiter

Father's Name: William A Upchurch

Mother's Name: Annie Bryan

Residence: Winston-Salem, Forsyth, North Carolina

MARY DEMENT U

②

MEMBERS OF THE WM U, III CLAN GRANVILLE CO → WAKE CO, NC - 12002013

1850 CENSUS NC TAB
GRANVILLE CO CREEK

William Johnson MD 1777 73
Elizabeth Johnson WIFE 1800 50
Archibald Upchurch 1811 19
FARMER

1880 CENSUS - NC FISHING
GRANVILLE CO CREEK

1860 CENSUS - NC TABS
GRANVILLE CO. CRK

W Johnson FARMER 1770 90 NC
Elizabeth Johnson 1800 60
Archibald Upchurch 1833 27
Mary Upchurch 1840 20
Wily Falkner M 1810 50
Vivily Falkner F 1834 26

1870 CENSUS NC
GRANVILLE CO - FISHING
CRK

Mary E Upchurch 1839 31
Willie Upchurch 1860 10
Nowtew Blacknell 1857 13
NEWTON BUCKNELL
WORKS ON FARM

Name FARMER Age
Mary Upchurch MD 1844 36
Willie A. Upchurch SON 1861 19

1900 CENSUS - NC
RALEIGH, WARD 3

1910 CENSUS - NC
RALEIGH, WARD 3

Name MD 21YRS Age
William A Upchurch MD 1863 47
Annie Upchurch WIFE (L) 1873 37
Bessie Upchurch DAUGHTER 1894 16
William Upchurch SON 1897 13
Louis Upchurch SON 1901 9
Annie Upchurch DAUGHTER 1904 6
Mary Upchurch DAUGHTER 1907 3
Percy Thomas BOARDER 1879 31
BOOK KEEPER LIVERY STABLE

I. WM U, III - b1774
1800 MD 1808 (GC, NC)

HELENIETH JENKINS
A. "X" male
MD (L) ELIZABETH
- b1800 - SNE

MD (AND) WILLIAM
JOHN SON b1770/1771

ARCHIBALD
H. U b1832 d5 NOV 1862

(LSA) MD NOV 1859 (GC, NC)

MARY E. DEMENT

A. WM ARCHIBALD U, SR
b21 AUG 1860 (GC, NC)

d15 APR 1913 (RALEIGH, NC)

MD (D) ANNIE GERTHORE
BRYAN

A. JOSEPH BALDY U
b22 FEB 1891 d1939

MD (L) LYDA U
NATHAN U, I/ BUNTS U SUBCLAN

A. BESSIE HEWES U b1894

MD (L) EUGENE CONRAD - 3 CHILDREN

A. W. A. JR 1Y FEB 1896 (1894) d3 MAR 1951 - NM

A. M. LOUIS BRYAN U b1901 - NM

A. ANNIE ELIZABETH U b15 OCT 1902 d15 DEC 1995

A. MARY DEMENT U b1907

MD (L) JAMES EDWIN LOSSITER, ARMY
COMMANDER USN

Name LIVERY STABLEMAN Age
William A Upchurch MD AUG 1860 39
Annie Upchurch WIFE (L) JUN 1870 29
Joseph B Upchurch SON FEB 1881 9
Bessie H Upchurch DAUGHTER MAR 1899 6
William A Upchurch SON FEB 1896 4
Manna Upchurch SON (LEWIS) MAY 1900 0

1920 CENSUS - NC
RALEIGH WARD 3
WP

Anna G Upchurch MD 1871 49
William Upchurch SON 1897 23
Loren Upchurch SON 1901 19
Anna Upchurch DAUGHTER 1904 16
Mary Upchurch DAUGHTER 1907 13
Dorothy Conrad GGC (I) 1914 6
Mary Conrad GGC (II) 1917 3
E B Conrad GGC (III) 1917 2
Hannah Dunnegan SVT 1870 50

1930 CENSUS - NC
WAKE CO - RALEIGH

Annie G Upchurch WIFE 1871 59
Annie E Upchurch DAUGHTER 1904 26
Mary L. Light DAUGHTER 1907 23
William A Upchurch SON 1896 34
Louis Upchurch SON 1901 29
Percy Thomas ROOMER 1878 52
BRICK MASON

1940 CENSUS - NC
WAKE CO, RALEIGH

Name FILE CLERK Age
Bessie Conrad MD 1894 46 NC
E B Conrad SON (SR) 1918 22
Annie Upchurch MOTHER WP 1871 69
William A Upchurch BRO 1896 44
Leulin B Upchurch BRO 1903 37
Annie A Upchurch SISTER 1905 35

600 S. SALISBURY STREET

MARY DEMENT U

① See notes of RPH 25 FEB 1980 Visit to Annie Elizabeth U.
in Raleigh, NC

Her sister Mary Dement U and former Edmund
Tassiter Attorney. He was a commander
in Navy.

Annie & Mary are ~~not~~ dau of
William Archibald U Sr.

② See Jt 4 NOV 1980 Evelyn Foutle U to RPH

Mary [DEMENT] U d 1974

③ See Jt 12 DEC 1980 Evelyn Foutle U to RPH

Mary U d in 1974 and is bur at Oakwood Cem
Raleigh, NC. She had her own beauty shop.
She and James Tassiter, a lawyer who still
lives in Winston Salem, NC. I don't know
his address but Annie E. Upchurch does.

MARY DIXON U.

- ① Per Ada Morgan 1050215 - Mary Dixon U in Charles
Latimer U. - See Charles Latimer U.

○ From Email 1 MAR 2010 Donna Maynard & RP

I. Jubal U, I-Head of Clan

A. Stephens U

1 Geneva Anna U

a. John Calvin U, I

i. Mary Doris U b. 12 JUN 1910



- △ (3) Mary Doris b. Wake Forest, NC on 12 June 1910 □ d. Raleigh, NC on 14 April 1986. She married William Melieus Lynam (b. Wake Forest, NC on 6 April 1912 □ d. 20 November 1966 in Wake Forest, NC) They had six children:
- △△ 1) Carolyn Muriel (b. Nov. 30, 1933) married (1) Frank Mitchell (b. 9 September 1931 □ d. 21 May 1960 buried at Oak Grove Cemetery) They had one child, Michael Frank Mitchell (b. 24 October 1958 Raleigh, NC) married Katherine Turner of Charlotte, NC on 17 June 1983. (2) Samuel Alton Memory on 2 December 1963. They had one son, Samuel Alton □ AI □ Memory (b. 25 May 1965 □ d. 13 February 1991). (3) Collis Lewis divorced
- △ 2) Willim Milton □ Bill (b. Wake Forest, NC 25 May 1935 □ d. 14 December 1992 buried at Crestview Cemetery, Marriottsville, Md.) married Jacqueline Leister of Baltimore, Md. (b. 28 February 1937). They had two children: William Milton □ Billy □, Jr. (b. 21 October 1961 Baltimore, Md) married (1) Freda (A.) Megan Lynn 3 Apr 1990 Baltimore, Md (B.) Rachael 9 May 1992 Baltimore (2) Tammy Spindler (A.) William Milton III 15 Nov 1999. Stephanie Lynne (b. 12 November 1963 Baltimore, Md.) married Richard Matthews (A) Jerod William Matthews 4 Aug 1999 Balt. Md
- △ 3) Sandra Marie (b. 26 February 1937 □ d. 9 July 1987 buried at Dorchester Memorial Gardens, Summerville, SC) married Billy Gene Buffalo 3 May 1958. They had two children:
- △△△ 1. Karen Buffalo (b. 7 November 1959 Raleigh, NC) married (1) Eddie Carl Garrison (A) Carla Marie Garrison b. 1983 d. 16 Jan 1999 Buried at Dorchester Memorial Gardens, Summerville, SC (2) Arnold McClary
- △△ 2. Gregory Gene Buffalo (b. 26 April 1965 Charleston, SC) married Lorie Norris of Dunn, NC. (A) Leia Norene 18 Nov 1996
- △ 4) Tony Mac (b. 24 October 1940 Wake Forest □ d. 25 February 1990 buried at Wake Forest Cemetery) married (1) Charlotte Harris (b. 4 July 1942 Buckhannon, WVa) They had two children:
- △△ 1. Tonya Ann (b. 3 May 1964 Raleigh, NC) married Kevin Bisby of Moline, Illinois. (A) Brandon Alexander 13 Jan 1995 (B) Ashley Lane 2 July 1998
- △△ 2. Tracey Alicia (b. 21 April 1967) (2) Irene Atkinson (divorced)
- △△ 5) Roy Leon (b. 8 February 1943 Wake Forest, NC) married Donna Maynard (b. 27 August 1943 English, W.Va) They had two children: Angela Carol (b. 24 July 1964) married Robert A Suggs of St Pauls, NC. Christa Michelle (b. 28 August 1968)
- △△ 6) Judith Gaynell (b. 8 June 1944 Wake Forest, NC) married Peter Wish (b. 20 April 1942 Camden, NJ)

○ Photographs Given to RPU by Donna Maynard - 25 JUN 2010

There were Photo sheets 1 and 2 as shown below. Photo sheet 1 has been placed in Profile of John Calvin U. Photo sheet 2 has been placed in Profile of Mary Doris U - Machine copies have been placed as indicated by (A).

I. Julia U, I - Hand of Clara

A. Stephen U

1. Geneva U

a. (John Calvin U) (A) md (Keniza Ethel Hicks)

PHOTO SHEET #1

PHOTO
SHEET
#2

1. William Ray U

2. Mary Doris U (A) md (W^m Melville Lynam)

(A) ← (E) Carolyn Muriel Lynam

(B) ← (U) W^m Milton Lynam, Sr

(C) ← (U) Sandra Marie Lynam

(D) ← (U) Tany Mae Lynam

(E) ← (U) Ray Leon Lynam md (DONNA MAYNARD)

(F) ← (U) Judith Gaynelle Lynam

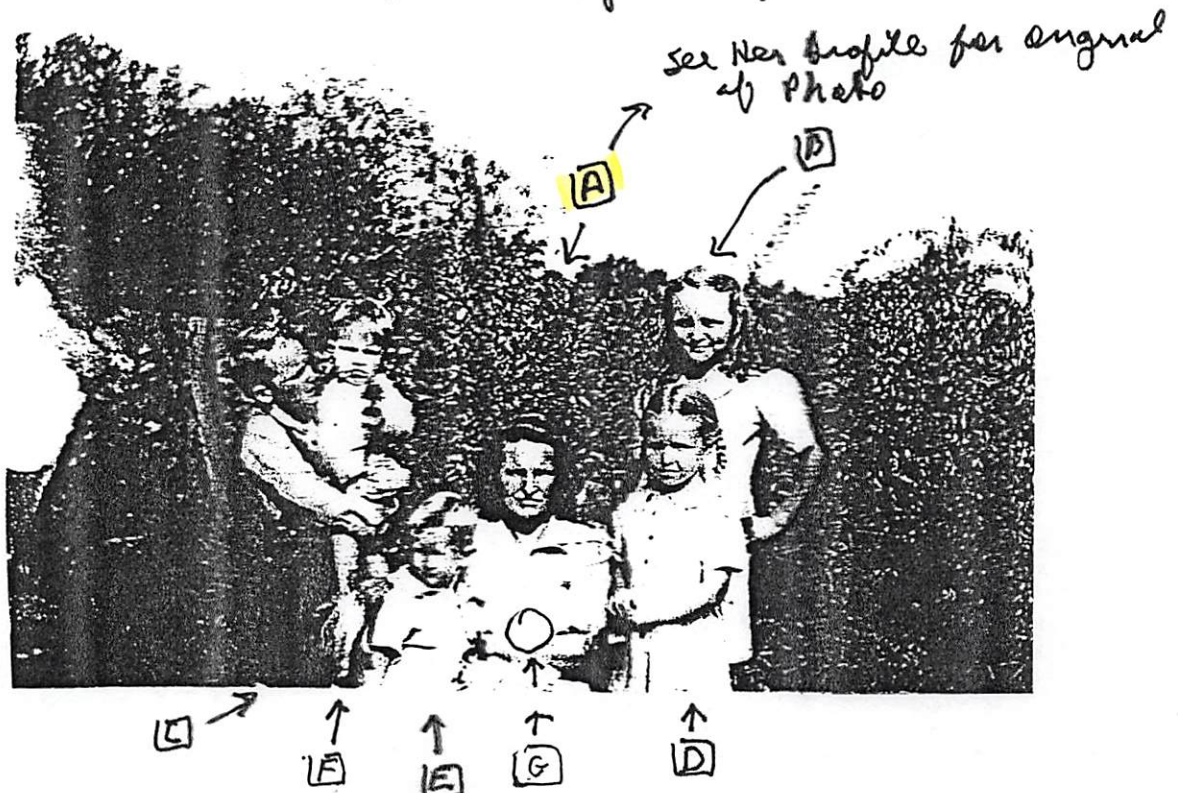

2 front



2 back of photo

William Roy
Upchurch

Mary
Doris Upchurch Lynam

Mary Doris Upchurch Lynam
Baby in Lap - Judith Dayrell Lynam
Boy Standing with her arm around his is
Tony Mac Lynam -

Boy holding Boy William Milton Lynam
Boy in Arms - Lisa Lynn Lynam
girl - next to Mother - Sandra Weirig
older girl - Carolyn Muriel Lynam

○ Extract of Email 14 SEP 2009 Donna Maynard to RPU

I. Subal U, I - Head of Clan

A. Stephen U

1. Geneva Ann U

Δ A. John Calvin U bur Oak Grove Bapt Ch Cem, Youngsville,
Franklin Co, NC md Kenya Ethel Nicks (Bur - AS HOS)

Δ 1. Geneva Elyan U md (1st) Leamon Tilley¹
md (2nd) TOLLIE GREEN MOORE²

Δ (I)¹ William Tilley

Δ (II)¹ Raymond Tilley

ΔΔΔ (III)² Alvin Moore; (IV)² Milie Moore; (V)² Robert Moore; HAROLD

ΔΔΔΔ (VI)² Virian Moore; (VII) Maynard Moore; (VIII) Linwood Moore; (IX) MOORE

Δ ii. Mary Davis U (Bur - Wake Forest Cem, Wake Forest, NC)

Δ md (1) William Melvin Lynum (BUR - AS WIF)

Δ iii. Ester Elyah U d 4 MAR 2000

ΔΔ (I) Albert Woodhief, Jr; (II) Mary Frances Woodhief;

ΔΔΔ (III) James Woodhief; (IV) Jo Ann Woodhief; (V) Edna Mae Woodhief

iv. Willard Thomas U Bur MD md (1st) Eva Mae Edwards¹
md (2nd) WEL - - - NO ISSUE

Δ (I) John Calvin U

Δ (II) Celia Rose U

v. Mary Catherine U

Δ (I) Lois Funderburk

Δ (II) Rose Funderburk

} RPU NOTE ONE OF THESE IS
PROBABLY THE SAME AS
Δ DELORES FUNDERBURK - 15 SEP 2004

MARY DORIS U

(4)

XIN. 56878

○ PARTIAL EXTRACT OF ARTICLE 786 ^Δ THE LYNAM FAMILY IN FRANKLIN CO., NC HERITAGE BOOK - 1908 - BY ROY LEON LYNAM 6 FEB 1943

I. CHARLES W. LYNAM b 5 NOV 1870 ()

1920 CENSUS - WAKE CO, NC

d 16 APR 1896 () (BUR - LYNAM CEM.

OFF SID MITCHELL RD, FRANK. CO, NC

MD 30 OCT 1841 (GRANVILLE CO, NC

Δ ALLANDA BRIDGES b () d () (BUR -

AS NUS) - HAD 11 CHILDREN

Δ D. ALEXANDER L. LYNAM "SCRAP"

1848 - 1901 (BUR - AS FAT) MD 1870

Δ (WAKE CO, NC) SARAH ELIZABETH

MANGUM b 15 APR 1852 () d 14 FEB

Δ Δ 1937 - D/O TELSTINA RAY & SAMUEL MANGUM, JR - HAD 2 CHILDREN

Δ Δ 2. BESSIE LYNAM b 2 MAY 1890 () d 3 DEC 1962 () MD () JOHN E. PLEASANT

Δ Δ a. ODELL S. PLEASANT (F) b 28 DEC 1910 () d 9 DEC 1949 () MD C. B. DAVIS

b. NO FURTHER ISSUE

Δ 1. CHARLES BURIN LYNAM b 11 OCT 1895 () d 16 DEC 1928

Δ MD 7 OCT 1896 () CORDELIA D'NEAL "DELIA" - HAD 10 CHILDREN

Δ M. WILLIAM MELIEUS LYNAM "SMILES" b 6 APR 1912 () d 20 NOV 1966

Δ MD () MARY DORIS UPCHURCH b 12 JUN 1910 () d 14 APR 1986

NOTE: THIS

EXTRACT OF

ARTICLE

786 IS

INCOMPLETE

AS IT MOSTLY

SHOWS THE

DIRECT LINE

OF THE NUS

OF MARY DORIS U

POSSIBLE D/O JOHN CALVIN U b 8 MAY 1877 (WAKE CO, NC)
d 20 JAN 1938 (WAKE FOREST, NC) & G/D/O GENEVA U OF THE JUBAL
U, I/STEPHEN
U. SUBCLAN

Δ 1. CAROLYN MURIEL LYNAM b 30 NOV 1933 () c

Δ 2. WILLIAM MILTON LYNAM "BILL" b 25 MAY 1935 () d 14 DEC 1992

Δ 3. SANDRA MARIE LYNAM b 26 FEB 1936 () d 9 JUL 1987

Δ 4. TONY MAC LYNAM b 24 OCT 1941 () d 25 FEB 1990

Δ M. ROY LEON LYNAM b 8 FEB 1943

MI. ??

MI. NO FURTHER ISSUE

→ PRESUMED AUTHOR
OF ARTICLE 786

1930 CENSUS - WAKE CO, NC

WAKE FOREST

Name	RENTS	MD	B	ABT	Age
* Herbert Pearce	HEAD	24.28		1894	36
1. Nina M L Pearce	WIF		[8 JUL 1897]	1898	32
* Herbert Pearce	SON			1920	10
4. * James W M L Lyman	BIL		[6 AUG 1903]	1913	17
7. * Charles B Lyman	BIL		[6 SEP 1910]	1911	19
8. * William B Lyman	BIL		[6 APR 1912]	1909	21
9. Gladys S Lyman	SIL		[2 NOV 1913]	1914	16
10. Ella J Lyman	SIL		[26 NOV 1916]	1917	13
* COTTON MILL WORKER					

○ Pearce - Lyman - Upchurch Connection

This 1930 Census Record comes from an RPH followup & an article (#786) in The Franklin Co, NC Heritage Book Re The Lyman Family

William Melicus Lyman b 6 APR

1912 C shown on 1930 Census as William B. Lyman age 21

(b apt 1909). This William Melicus Lyman and Mary

Doris U b 12 JUN 1910 (see separate extract) [Married D/o John Calvin U & G D/o Geneva Ann U (2 partner CAS RAY) and G D/o Stephen U and G G D/o Jubal U, I - Head of Clam - RPH 26 FEB 2009]

In this 1930 Census William Melicus Lyman, a future husband of an Upchurch female, is shown as a BTL in the home of his named sister NINA MAY LYMAN b 8 JUL 1897 and her husband James Herbert Pearce b 6 JUL 1893 (7 & 31 DEC 1969 who m 21 AUG 1926. Article 786 shows they had no children in spite of the above Census shows a son Herbert Pearce b about 1920

[Note: As of 23 FEB 2009 I am unable to link the two Pearces shown here & other Pearces in my People System - RPH]

1930 CENSUS - WAKE CO, NC - WAKE FOREST

Name	RENTS	IND	28	B	A	B	Age
* Herbert Pearce	HEAD			1894			36
Nina M L Pearce	WIF			1898			32
* Herbert Pearce	SON			1920			10
* James W M L Lyman	BTL			1913			17
* Charles B Lyman	BTL			1911			19
* William B Lyman	BTL			1909			21
Gladys S Lyman	SIL			1914			16
Ella J Lyman	SIL			1917			13
* COTTON MILL WORKER							

CORRECT SPELLING &

= LYMAN

not LYMAN

MARY DORIS

U

⑥

XID-56878

① 1930 CENSUS - WAKE CO, NC - WAKE FOREST TSP
 (Note so far unable to link this family. They are Family
 No 47 on 1920 census & No 25 on 1910 census - all Wake Forest TSP

John U 52 Head b 1877 (ND) [John Calvin U]

Katie U 42 wife b 1887 [Catherine Hicks]

Mary D. U 19 DAU b 1910 [Mary D U]

E. Mabel U 16 DAU b 1913

[on 1920 census "Elizabeth U" occupies this age slot]

Thaman U 13 SON b 1916

[on 1920 census "Willard" occupies this age slot]

Catherine U 10 DAU b 1919 [Mary Catherine U]

Death Record presumably for Doris U XID-7494

Source Vendor: NC Department of Health. North Carolina Deaths, 1983-87

SSN 244-10-3259

North Carolina Death Collection, 1908-2004

FROM ANCESTRY,
 COM - IMAGE OF
 CERTIFICATE
 NOT AVAILABLE

Name: Mary Doris Lynam [Mary Doris U]	Residence City: Wake Forest
Gender: Female	Residence County: Wake
Race: White	Residence State: North Carolina
Marital Status: Widowed	Date of Death: 14 Apr 1986
Father's Last Name: U	Death City: Raleigh
Age: 75	Death County: Wake
Date of Birth: 12 Jun 1910	Death State: North Carolina
Birth Location: North Carolina	institution: General Hospital
Birth State: North Carolina	Attendant: Physician
	Burial Location: Burial in state

- ARTICLE 1004 "OUR TIMBERLAKE ANCESTRY" FROM FRANKLIN CO, NC
HERITAGE BOOK 2008 BY: ANGELA LYNAM SUGGS, CHRISTA LYNAM
BETTY MAYNARD
- I. - - TIMBERLAKE "T" CAROLINE CO, VA FROM ENGLAND LATE 1600'S
 A A. RICHARD T. - CALLED "PORT ROYAL IMMIGRANTS"
 A B. JOSEPH T } MOVED TO MIDDLESEX CO, VA [MD AGE 11?? - RAU] 17
 A C. FRANCIS T } b 1687 (ENGLAND) d 1826 MD 1698 (VA) SARAH - - CHILDREN
 A I. FRANCIS T. b 1712 (MIDDLESEX, VA) d DEC 1762 (NORTHUMBERLAND CO, VA)
 A MD 9 MAR 1730 (LANCASTER, VA) JUDITH LAWSON - 9 CHILDREN
 A A. FRANCIS T. b 6 JUN 1758 (NORTHUMBERLAND CO, VA) MOVED TO FRANK-
 LIN CO, NC - KILLED - LIGHTENING 10 JUN 1830 (FRANKLIN CO, NC)
 A PUT IN REV. MD 31 MAY 1779 (FC, NC) NANCY POINDEXTER - 9 CHILDREN
 A I. JAMES POINDEXTER 1780-1847
 A A MD (1ST) SARAH JONES MD (2ND) SHERROD NANCY
 A II. EPHRAIM RODITUS T. "EPPY" 1783-1855
 A MD (1ST) 12 DEC 1807 SALLY JONES
 A MD (2ND) 26 OCT 1831 LOLL EDNA WIGGS
 "LUEDNA" b - d 6 APR 1886
 (I) -> (III)
 A A II. SALLY T. 1784-1821 MD () LITTLETON SLEDGE
 A A III. POLLY T. b 1786 MD () ELISHA G. ALLEN
 A IV. RICHARD T. 1788-1860
 A A MD (1ST) MARY NEAL; MD (2ND) TABITHA TRICE
 A V. NANCY T. 1790 - < 1849
 A MD () JOSEPH MURPHY
 A VI. JUDITH T. 1792 - > 1960
 A MD () ABNER LAYTON
 A VII. FRANK T. 1795-1825
 A MD () FRANCES SNEED
 A VIII. JULIUS T. 1797-1828
 A MD () TEMPERANCE FREEMAN
 (A) KENIZA ETHEL HICKS MD () JOHN CALVIN U
 A A (I) MARY DORIS U MD () WM MILIEUS LYNAM
 A (a) CAROLYN MURIEL L. b 30 NOV 1933 MD (1ST)
 A A FRANK MITCHELL; MD (2ND) SAM MEMORY; MD (3RD) COLLIS LEWIS
 A (b) WM MILTON L. b 25 MAY 1935 d 14 DEC 1992
 A MD () JACQUELINE LEISTER
 A (c) SANDRA MARIE L. b 3 MAY 1937 d 9 JUL 1987
 A MD () JILLY GENE BUFFALOE
 A (d) TONY MAC L. b 24 OCT 1941 d 25 FEB 1990
 A A MD (1ST) CHARLOTTE HARRIS; MD (2ND) IRENE ATKINSON
 (E) MARTHA ANN T. b 1808-1874
 A MD () WM WIGGS
 (II) W M T. b 1811 MD STROTHER
 (III) NANCY T. b 1813
 A MD () HENRY JOYNER
 (IV) EMELINE T. b 1817 d 1898
 A MD () WILLIAM JOYNER
 (V) ELIZABETH ANN T. 1833-1899
 A MD () JAMES LAWRENCE HICKS
 (VI) ANN REBECCA T. b 16 JAN 1836
 A d 24 JUN 1917 MD (1ST) THOMAS
 HOLLINGSWORTH - KILLED CW
 A MD (2ND) ATLAS R. COOKE
 (VII) JULIUS POINDEXTER T. 1901
 A MD () MARTHA CLIFTON
 (VIII) FRANCIS J. T. 1840 CW
 (IX) LUCY J. T. b 1844
 A MD () THOMAS A. WIGGS
 (X) RICHARD L. T. b 1847-1872
 (XI) JAMES SIDNEY T. b 2 DEC 1849
 A d 9 OCT 1905 MD () MATTIE HACKNEY
 (XII) MARY JANETTE T. b 2 DEC 1849
 d 8 SEP 1925 MD ()
 A FRANKLIN B. FREEMAN
 (XIII) JOHN EPHRAIM RODITUS T. ARKIE
 d 1853-1916 MD MORRISETTE
 (E) Roy Leon Lynam, b.
 February 8, 1943 married Donna Maynard.
 (F) Judith Gaynelle, b. June 8, 1944 married Peter
 Allen Wish.

MARY DORIS U

FROM: FRANKLIN CO, NC HERITAGE BOOK 2008

ARTICLE 703 "JAMES LAWRENCE HICKS & BENJAMIN THOMAS HICKS

BY: DONNA MAYNARD LYNAM [COPIES MADE FOR ALL NAMED-RPN 2 MAR 2009]

I. JAMES LAWRENCE HICKS b APT 1825 d 1885-1900 (FRANKLIN CO, NC)

MD 8 FEB 1848 (BRIDES HOME, LOUISBURG, NC)
ELIZABETH ALM TIMBERLAKE b APT 1833(?)
d 1898 (?) D/B EPHAPHRODITUS TIMBERLAKE
& LUEDENA WIGGS

James Hicks was a blacksmith, wheelwright, carpenter and built fine furniture. He was also a farmer. James made wheels for the Confederate Army during the Civil War.

A. ANNIE HICKS b APT 1858 d AS CHILD

B. LUCY HELEN HICKS b 1 JUN 1859 MD JUL 1877
RICHARD ROBERT HOLMES

They had eight children: (1) Annie L. born April 1881 (2) Blanche born January 1883 (3) William E. born May 1885 (4) Valaria born March 1887 (5) Mattie born July 1890 (6) Eveline born May 1893 (7) Sallie Edna born January 1895 (8) Minda born July 1897.

C. EDWIN HICKS b 1860 DIED IN MTS 20'S

D. ANNA VALARIA JUSTICE b JAN 1861 d 3 AUG 1930
MD 1881(?) JOHN WILLIAMS ANDREWS

Anna and John had eight children: (1) Addie Foster (b. January 21, 1883- d. December 15, 1950) married Andrew Rodgers; (2) David Lawrence (b. November 6, 1886- d. March 22, 1969) never married; (3) John

E. BENJAMIN THOMAS HICKS "TOM" b 1 DEC 1865 (LOUISBURG, NC) d 15 JUL 1938 (WAKE FOREST, NC)
MD (1ST) 22 NOV 1885 (?) ELIZA CAROLINE

Gregory (b. January 3, 1889- d. August 12, 1972) married Josie Todd; (4) Robert Grover (b. March 19, 1890- d. May 8, 1969). Bob, as they called him, never married; (5) Lanie Gray (b. May 12, 1891- d. June 30, 1964) married Walter Ivan Baker; (6) Undine Decotress (b. January 1894- d. Jan 17, 1928) married J.O. Hagwood June 30, 1916; (6) Lucy Vee (b. July 8, 1896- d. May 27, 1981) married Robert Youle Ellington; (8) Daniel Joshua (b. May 23, 1902 - d. February 4, 1962) married Daphne Johnson.

TIMBERLAKE b APT 1867 d 29 MAR 1899 - [5]
MD (2ND) 1899 (?) NANCY A. MENGA "NANNIE"
d 1 JUN 1901 - NO ISSUE LISTED [0]

MD (3RD) 1901 (?) FANNIE W. POOLE d 29 MAR 1905 [2]

MD (4TH) 1906 (?) MINNIE EDWARDS [2]
d 6 SEP 1916

MD (5TH) 21 JUL 1917 (?) SARAH HARDING [0]

They had five children: (1) Keniza "Katie" Ethel (b. April 4, 1887- d. January 8, 1974) married John Calvin Upchurch (b. May 4, 1877- d. January 20, 1938) on May 25, 1904; (2) James Burton (died as a baby); (3) Sarah Lillian (b. January 22, 1892- d. November 28, 1951) married William "Elvis" Davis on March 8, 1908; (4) Iva Moultrie (b. August 13, 1894- d. 1949) married Rosa Wright on March 25, 1912; (5) Julius Sidney (b. April 22, 1897- d. December 25, 1954) married Bessie Royster of South Boston Virginia. Eliza Caroline "Carrie" died before giving birth to their sixth child.

1. KENIZA ETHEL HICKS "KATIE" ← - - -

MD 25 MAY 1904 (?) JOHN CALVIN U

b 4 MAY 1877 L d 20 JAN 1938

a GENEVA ELIZA U b 6 MAR 1905 d 26 FEB 1976

MD (1ST) (?) LEAMON PILLEY; (2ND) TOLLEY MOORE

b. WILLIAM RAY U b 11 DEC 1906 (?) d 24 NOV 1960

MD (?) VIOLA DUPROSE

c. MARY DORIS U b 12 JUN 1910 (?) d 14 APR 1986

MD 28 AUG 1933 (?) WILLIAM MELIEUS LYNAM

d. ETHEL ELIZABETH U b 1 DEC 1912 d FEB 2000 MD (?) ALBERT WOODLIET

e. WILLARD THOMAS U b 1 NOV 1915 d ?

MD (1ST) (?) EVA MAE EDWARDS; MD (2ND) NELL - -

f. MARY CATHERINE U b 24 MAY 1919 d 7 FEB 1996

MD (?) LUTHER FUNDERBURK

They had two children; James Lawrence (b. December 1, 1902 - d. October 10, 1942) and Elizabeth Virginia Dare (b. January 12, 1905 - d. 1905).

They had two children: Edward Elbert (b. April 5, 1907 - d. September 13, 1965) and William Mckenly (b. October 21, 1911 - d. March 1978).

① See Ltr 19 SEP 1996 Donna Marie Byrd to RPA

I. Harmon U - Head of class

A. Benjamin U

1. Osburn U

a. Phillip Osburn U and Zephra Vining Tomme,
daughter of John William Tomme & Judith Wood Collins

ii. Mary Duren U b. 4 JUL 1880 (La Grange,
Troup Co, GA) d. 7 FEB 1961 (Atlanta,
Fulton Co, GA). m. 14 FEB 1906
(La Grange, Troup Co, GA). William
Edward De Loach, b. 5 JAN 1881
(Deer Co, GA) d. 31 JAN 1958 (La Grange,
Troup Co, GA) son of James
Phillip De Loach "Pelt" & Martha
S. Talley "Mellie". Mary & William
had four children.

Donna writes "my ggm MDU was a very beautiful woman, very petite, with beautiful, dark auburn hair. She and my ggt lived in the home built by her father in 1909. My GM still lives in the home today (GM = William McGee). MDU died when I was 16. I lived across the street from her and spent time with her every day. She was a special part of my life. I have pictures of MDU and also of her parents.

② See Ltr 10 NOV 1996 Donna Marie Byrd to RPA

MDU lies in Shadowlawn Cemetery, La Grange, Troup Co, GA