

ADAMS CEM- FUQUAY- WCNC

See Fuquay

(Between Fuquay Varina & Holly Springs)

AIRPORT BOULEVARD MORRISVILLE - W6NC

See Monksville

△ AIRPORT BOULEVARD CEM

AKA △ SORRELL GROVE CEM

ALLEN CEM - BARTON CRK TWP - WENC

- See Barton Crk TWP

AKA John Allen Cem.

ALLEN CEM - WHITEOAK TWP - WCNC

see White Oak TWP



APEX CEM - APEX - WC NC  
See Apex

There are 2 Wake Co, NC cemeteries that bear the name of HILLCREST - apparently unrelated

- △ Hillcrest Cem No 1 - In Town of Cary, NC and still goes by the name of Hillcrest Cemetery
- △ Hillcrest Cem No 2 - In Town of Apex, NC - originally called Hillcrest Cem and now goes by the name of Apex Cemetery ↑ (AKA Apex City Cem)

APEX FIRST BAPT CH CEM #2 - APEX - WCNC

See Apex

APEX METHODIST CEM. APEX - W L N C

See Appt

AUBURN CHRISTIAN CH. LEM - GARNER - W.C.N.C.

See Garner

BAGWELL CEM - GARNEN - W LNC

See Garner

Cemetery Transcription  
Library[What's New](#) | [Search Records](#) | [Browse Cemeteries](#) | [Publish Transcription](#) | [Cemetery Blog](#) | [Partners & Links](#)[Home](#) > [United States](#) > [North Carolina](#) > [Wake](#) > [Bailey Cemetery](#)

## Bailey Cemetery Falls, Wake County, North Carolina

Contributed by Shirley Olson, Feb 05, 2003 [[shirley32olson@yahoo.com](mailto:shirley32olson@yahoo.com)]. Total records = 3.

I have transcribed from records of the U.S. Army Corps of Engineers, which were graciously supplied by Curtis T. Pope, Realty Specialist, NC Mgmt. Team.

Bailey Cemetery; Originally to be reinterred with the others in Falls Community Cemetery, family members requested reinterment in Youngsville Town Cemetery, Youngsville, NC, in the family plot. They are listed here as part of the reinterment project.

**Bailey, Susan E.** b. 9 Aug 1860, d. 22 Oct 1929

**Bailey, Wyatt M.** b. 4 Jan 1852, d. 23 Jan 1920

**Bailey, Zollie C.** b. 8 Jan 1862, d. 19 Feb 1932

### More North Carolina Genealogy Records:

- [North Carolina Marriage Bonds, 1741-1868](#)
- [North Carolina Marriage Collection, 1741-2000](#)
- [North Carolina Death Collection, 1908-1996](#)
- [North Carolina Birth Index, 1800-2000](#)
- [North Carolina Census, 1790-1890](#)
- [State Census of North Carolina, 1784-1787](#)
- [North Carolina Taxpayers, 1701-1786](#)
- [North Carolina Will Abstracts, 1660-1790](#)

Copyright © 1997-2007, Interment.net | [Privacy Policy](#) | [Terms of Use](#) | [Contact Us](#)

BALDWIN CEM - APEX - WCNC

See APEX

BANKS CEM - SE WAKE CO - WCNC  
ATTACHED





[What's New](#) | [Search Records](#) | [Browse Cemeteries](#) | [Publish Transcription](#) | [Cemetery Blog](#) | [Partners & Links](#)

[Home](#) > [United States](#) > [North Carolina](#) > [Wake](#) > [Banks Cemetery](#)

## Thomas Banks Cemetery Wake County, North Carolina

Lat: 35°38'14"N, Lon: 78°40'20"W

Contributed by Robert M. Butler, Dec 11, 2001 [[rmbnc@worldnet.att.net](mailto:rmbnc@worldnet.att.net)].  
Total records = 4.

From Raleigh, travel US 401 South toward Fuquay Varina. After you pass Wake Technical College, go 1.1 miles and turn left onto Banks Road (SR 2724). Go 2.4 miles on Banks Road. The cemetery is in a field on the left about 50 yards off Banks Road.

All the trees have recently been cut and the cemetery has been cleaned of underbrush.

I did an onsite reading in December of 2001.

They are not accepting burials now, all kin have moved.

*- Robert M. Butler*

**BANKS, Dalton Duval**, b. Jul 9, 1870, d. Jul 4, 1899  
**BANKS, Hershia Rand**, b. Oct 9, 1832, d. Apr 15, 1910  
**BANKS, Thomas, Dr.**, b. Oct 15, 1831, d. Oct 26, 1910  
**SMITH, Eliza Betty**, d. Feb 2, 1841, Wife of Jonathan Smith, Died in 41st Year of Her Life

Misc:

There is one foot stone inscribe, 'CSB'  
There are graves marked with plain field stones

### More North Carolina Genealogy Records:

- [North Carolina Marriage Bonds, 1741-1868](#)
- [North Carolina Marriage Collection, 1741-2000](#)
- [North Carolina Death Collection, 1908-1996](#)
- [North Carolina Birth Index, 1800-2000](#)
- [North Carolina Census, 1790-1890](#)
- [State Census of North Carolina, 1784-1787](#)

BANKS CEM - SCTWP - WLNC

See SCTWP

MADISON BARBEE CEM

WAKE CO, NC

① The above inspected by RPM on 21 SEP 1982 - 28 m located just north of the <sup>original</sup> North terminus of SR 1620. This terminus has now been extended eastward out to SR 1613. - Fence 12' X 20'

- ① South stone (fallen over) 30" high X 18" wide

Δ Madison Barbee 5 JUL 1845 - 7 AUG 1913

- There is a footstone without inscription

- ② North stone (fallen over) - matches ①

□ Mother - wife of Madison Barbee

Δ DELANEY F. CARLTON

- 20 SEP 1843 - 29 OCT 1924

- Footstone reads D. F. B.

- ③ 1 one grave to North - Footstone without inscription, No headstone

- ④ outside fence to the west

Δ 18" high 12" wide - Infant dau of E. P. and I. A. Barbee. 14 SEP 1907

[See also 27 pg 100 - Madison Barbee<sup>Δ</sup> is son of William Barbee. The E. P. Barbee<sup>Δ</sup> listed is no doubt Edgar Patterson Barbee<sup>Δ</sup> (a brother of Madison Barbee<sup>Δ</sup> and I. A. B. = Ida Alberta Mason. F in Delaney F. Carlton = Delaney Francis Carlton<sup>Δ</sup>.)

- By Robert P. Ymlund

<sup>A</sup> BARNABAS JONES CEM - SCTWP - WCNC  
Filed Ar <sup>↗</sup> See SCTWP

[<sup>A</sup> JONES, BARNABAS]

BAYLEAF BAPT CH CEM WAKE CO, NC  
BARTONS CREEK

RE BAYLEAF BAPTIST CHURCH CEMETERY  
BARTONS CREEK TOWNSHIP, WAKE CO, NC

my ~~interest~~ was stimulated by interaction with  
Walter Francis Nashline on 17 DEC 2013 as he is a  
member of the Bayleaf B. C. which he says now has  
several thousand members.

29 DEC 2013 - took up the cem on find a grave

RESULTS -

- NO UPN URCHES
- RAY - ONLY ONE LISTED - SEE BELOW

△

**Alma Harrison Ray**



Added by: Mary Ann Loss

Birth: 1874  
Death: Mar. 2, 1938

Daughter of Phil, and Frances Nipper Harrison

△ △

Family links:

Spouse:  
△ Alfonso Columbus Ray (1855 - 1939)\*

Children:  
Infant Ray\*

\*Calculated relationship

Note: Additional Information from Wake  
County Death Certificate

Burial:  
Bayleaf Baptist Church Cemetery  
Raleigh  
Wake County  
North Carolina, USA

[Edit Virtual Cemetery info](#) [?]

Created by: BeeManTim  
Record added: Sep 27, 2007  
Find A Grave Memorial# 21789577

## BECK CEMETARY

- WAKE CO, NC

This Cemetery is on the south side of Highway 50  
just N of Sandy Plain in Wake  
County - between Newse River + Durham Colne  
I named it "Beck Cemetery".

C. H. Beck 11 SEP 1844 - 29 JUN 1897

His wife LAVINIA b 6 JUN 1843 d 23 JUN 1915

No W's, Ray's, Edwards', Cass's.

Visited Saturday June 24, 1978 in route  
Raleigh - Creedmoor NC.

- By Robert P. Yurchak



BETHANY CHURCH

Impacted by RPA

23 FEB 1981 - In Eastern & CEM, WAKE CO, NC  
Wahelo, NC in NE corner  
of Roads 1003 & 2409/2227

Δ ① Ma U -

3 OCT 1900 - 30 DEC 1928

Stone

1' x 2'

"C"

← wife of J. A. Creech.

but recent  
flowers

- ② LYMAN W. WATSON 4 OCT 1919

6 MAR 1974

→ may or  
may not be Upchurch

→ [JAMES RICKMAN  
BELL, JR]  
see sign  
at next  
"Upchurch"

- ③ "A" Upchurch

Δ A. Alla Cotton Upchurch 3 JUL 1878 - 31 MAR 1953

Δ B. Waylan A. Upchurch 7 DEC 1867 - 20 JUL 1942

Δ ④ 1' x 2' - Doughty Upchurch 10 MAR 1903 - 18 DEC 1919

Δ ⑤ 1' x 2' - Essie Upchurch wife of

Δ ← J. R. Bell

28 NOV 1897

23 SEP 1922

Δ ⑥ "B" Kate C. Cotton → 15 MAR 1881

Δ ← wife of H. A. Upchurch 15 JUL 1946

Δ ⑦ 1' x 2' Nanette F. Upchurch

10 SEP 1880 28 JAN 1966

Δ ⑧ H. A. U is bur there on <sup>James Rickman Bell, Jr.</sup> but I missed his stone

- By Robert P. Upchurch

Bethel Christian

BETHEL CHRISTIAN  
CHURCH, WAKE  
CO, NC

CHURCH JUST WEST OF  
HOLLOMANS X ROADS  
IN WESTERN WAKE CO, NC

R PU looked for above on 11 NOV 1978  
and could not find same

- By Robert P. Upchurch

Church <sup>(disbanded)</sup> was sold, the building, and moved  
for a residence. Cemetery is at least  
75 yds on N side of road. 3 mi (?) from X roads.

Δ L(ee) C. Upchurch 1871-1940

Pearlie (Stone) Upchurch, wife of L.C. 1881-1934

Δ William Thasnie Upchurch 1 Jun 1896 - 1 May 1915  
(one report has it Jommie)

□ + □ (" " says they were parents of Norah and Annie Lee Shelton  
brother 25!

One report said 5 unmarked graves before  
CP & L moved in 93 that are unmarked  
from cemetery all around that area.  
Also some to Collins Grove. I have list  
of those moved (family name) most all  
unmarked except for <sup>field-</sup>stones/rocks.

THIS SHEET FROM LTR 30 NOV 1996 Irene Glenn DRA

Γ L.C.U = LEONZA C. U of the Manu / Whitney U Subdan  
Candis U line - RPU



BETHLEHEM CEM- KNIGHTDALE - W C NC

See Knightdale

(AKA Bethlehem Baptist Cem)

BEULAH CONGREGATIONAL  
CHRISTIAN CHURCH  
Founded 1887

WARE  
CO, NC

Located in Wake Co, NC on State Road  
2224 just west of SR 2300. Inspected  
by RPH 23 FEB 1981. No evidence  
found.

- By Robert P. Yehuda

BEULAH CEM- GARNER - W.C.N.C

See Garner

At Beulah Methodist Church

○ From Profile of Miley Albert Perry "MONK" - Entry 28 JUL 2007  
Monk reports that the BURL PERRY who gave the land was

Burrell Perry  
Brother of  
Monks GGGP  
Redden  
Perry

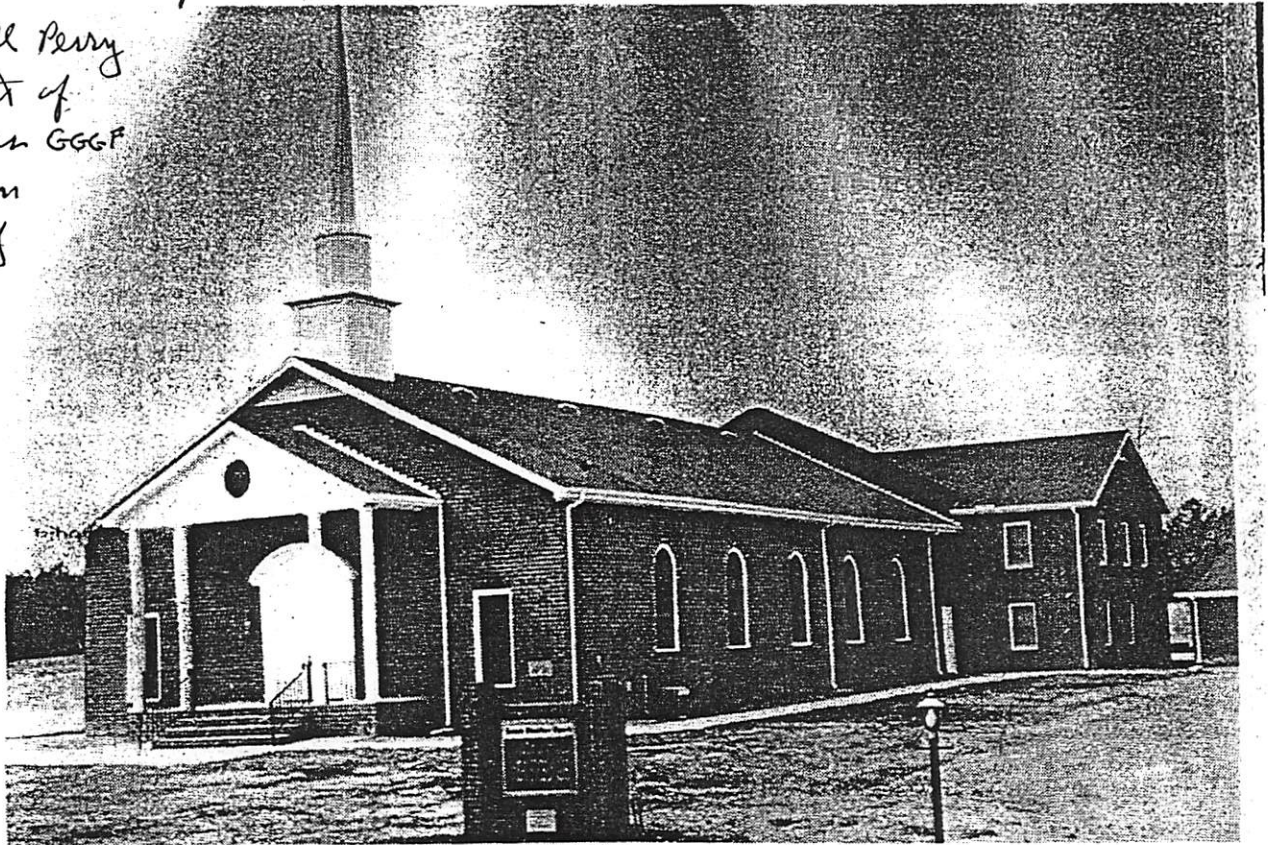

New Beulah Christian Church will be dedicated Sunday

## Beulah will dedicate building

Beulah Christian Church will have a dedication service for the new church building Sunday at the 11 a.m. worship service.

Guest speaker for the special service will be the Rev. W.C. Barham Jr. Old and new members are invited.

Following the service there will be a covered dish dinner.

For 99 years Beulah has been an enduring and active church and congregation. It started from a branch off the Rolesville Baptist Church under the leadership of Virginia Terrell.

Around 40 members attended the church which held services under a bush

arbor on Pulleypoint Road in 1887.

Calvin Mitchell gave the land for a building which was constructed in 1932, and Burl Perry later gave the land where the church was moved and where it is still located. A new wing was added in 1940 and in 1956 a new classroom was built at the back. The brick veneer and stained glass windows were added in 1962, and in 1963, the church got its first full-time minister.

The church brought two acres of land from Lucy Perry Yeargin in 1967 for a parsonage. Over the year the church has had 25 part-time and full-time pastors.

They dug a well in 1900 and added a

bathroom in 1969-70. Other improvements were made through the years, and then last year the new church was started.

Revival services will start Monday at 7 p.m. with the Rev. Lewis Harward as guest preacher. Plan to attend.

The Women's Missionary group will meet Saturday at 7 p.m.

As the youth choir from the Wake Cross Roads Baptist Church sang Sunday, I thought 'how God can work through each of us if we will let him. I thought how the angels in heaven must sound, and I thank God for his grace.

—Ida Raybon

○ Per Call of Miley Albert Perry @ 8 PM 30 JUL 2007 "MONK"  
monk reports that BEULAH CHURCH is on Mitchell Road  
in Eastern Wake Co, NC quite near the historic Burrell  
Perry home.

CROSSFILE: BURRELL PERRY

BEULAH CHRISTIAN CHURCH, WAKE CO, NC



## Blalock Cemetery Wake County, North Carolina

Hwy. 42E  
Wake County NC

Lat: 35°35'19"N, Lon: 78°41'07"W

Contributed by Shirley Olson, Mar 31, 2002  
[shirley32olson@yahoo.com]. Total records = 17.

Directions from Raleigh, NC: From the south side of Raleigh take Beltline exit # 298, (Hwys. 401, 70 & 50). Stay on 401 South to Fuquay Varina. Turn left at the light at the intersection of 401 and Hwy. 55, and another quick left onto Hwy. 42. About 5 miles east on Hwy. 42, not far after crossing Old Stage Rd., is this small walled cemetery on the left. It is rather weedy but not seriously overgrown. Park by the side of the road.



Click photo to enlarge



Click photo to enlarge

Blalock Cemetery is no longer in use, it sits on the side of the road and appears to be without any caretaker.

I surveyed this cemetery on Mar 27, 2002.

- Shirley Olson

**Adams, Alonzo B.**, b. 15 Aug 1881, d. 29 Oct 1904, s.o. J.O. & Annie E. Adams  
**Blalock, ?????**, b. 26 Mar 1908, d. 5 Apr 1908  
**Blalock, Andrew**, b. 20 Sep 1854, d. 18 Apr 1935  
**Blalock, Baby**, b. 19 Nov 1917, d. 28 Nov 1917, child of Mr./Mrs. N.E. Blalock  
**Blalock, Bruce**, b. 18 Jun 1903, d. ????, stone broken, unreadable, s.o. J.M. & Dora Blalock  
**Blalock, Carl Jackson**, b. 25 Nov 1922, d. 2 Jul 1924  
**Blalock, Christiana**, b. 13 Jul 1828, d. 12 Oct 1908  
**Blalock, Dora**, b. 1861, d. 1919, w.o. Jim Blalock  
**Blalock, Estha**, b. 25 Mar 1887, d. Sep 1890, dau.o. J.M. & Dora Blalock  
**Blalock, Hugh**, b. 20 Feb 1820, d. 4 May 1899  
**Blalock, Lucy Pearl**, b. 14 Feb 1916, d. 18 Oct 1916  
**Blalock, Mary Isabella**, b. 31 Dec 1860, d. 5 Dec 1932  
**Blalock, Orus Raymond**, b. 29 Aug 1909, d. 31 Oct 1910, s.o. Orus & Ruby Blalock  
**Blalock, Patsy**, b. 4 Sep 1794, d. 20 Feb 1891  
**Blalock, Sallie**, b. 27 Sep 1818, d. 1 May 1907  
**Jackson, Tyson**, no dates, s.o. S.H. & P.G.  
**Jones, Hubert Jr.**, b. 7 Apr 1921, d. 19 May 1923

BLANCHARD PLUS CEM

1. <sup>Δ</sup> GREENLAWN MEM GONS ← FILED 1 - FUQUAY, NC
2. <sup>Δ</sup> SUGGS FUNERAL HOME
3. <sup>Δ</sup> BLANCHARD PLUS CEM ↗

This cemetery is in North Fayette - Vannia, WENC  
It appears to be owned by the Suggs Funeral  
Home but may be referred to by 1, 2 or 3

△ BRIER CREEK MEMORIAL CEM., RALEIGH, WAKE CO, NC

○ Inspected by RPU & SSA on 12 MAY 2008 T

Drove from Greensboro to Raleigh  
arriving about 2:30 PM. Went by what  
was called Raleigh Veterans Cem on HWY  
7 & I-540 to pay our respects to Pat & Terry.  
The cemetery name has been changed to  
BRIER CREEK MEMORIAL CEM. It is on ACC BLVD  
Phone (919) 596-3299. The main entrance is  
the adjoining Shopping Center on Briar Creek Blvd.

Note: This seems to be a new name for what I  
recall as being <sup>△</sup> Raleigh Memorial Cemetery  
or something like that

RALEIGH MEMORIAL PARK & MAUSOLEUMS  
7501 GLENWOOD AVE 27612 - RALEIGH, NC

ON 27 SEP 2005 RPU WALKED ENTIRE  
AREA BETWEEN THE TWO MAUSOLEUMS  
AND RECORDED 8 INSCRIPTIONS  
OF INTEREST

Area 1 - South of Walk

- △ 1. Robert Valen U - USN  
4 DEC 1933 - 4 AUG 1991  
NO SPOUSE

- △ 2. BETTY U MILLER - BELLOVED WIFE  
22 NOV 1923 - 4 FEB 1991 - NO SPOUSE
- △ 3. GRANTAM VANCE CHAMBLEE  
1919 - 1995 } H&W
- △ 4. JACKIE RUMMEL CHAMBLEE  
1921 - 1981

[ will file under name  
BETTY UPCITURCH  
in case the "u"  
actually stands  
for UPCITURCH  
- RPU ]

- △ 5. CAREY DUNCAN RAY 1933 - 1983 }  
△ 6. YVONN TILLEY RAY 1935 - 2003 }  
H&W
- △ 7. DR ERNEST C U 1917 - 1995
- △ 8. ELIZABETH TALLEY U 1920 - X



VISITED 10 OCT 2004 **RALEIGH MEMORIAL PARK CEMETERY**  
 BY RPA & LIN PENNY (SEE PAGE 3 FOR DETAILS)  
**RALEIGH, NC** ①  
 GLENWOOD AVE RALEIGH MEMORIAL PARK CEM. - RALEIGH, CO, NC WAKE

- D, 1 Anna M. U Sec 3 Lot 2233 Sp 3  
 - (5-30-74 (Date of burial) # 1034  
 - [s/o ROFUS MERRIMON U - NATHAN U, I/BURTIS U SC - GILBERT U - BURTIS U LOVE] - 1988  
 [Anna M. U 1906 - 1974  
 OSSW MERTER N. U 1906
- △ C, 2 Audrey Michael U Sec 3 Lot 2191 Sp #4  
 - 12-29-82 # 2191 [s/o # 5]  
 - [AVERY COUNCIL U - s/o # 1]  
 [A. Michael U  
 17 MAR 1966 - 24 DEC 1982
- △ C, 3 Arney C. U Sec 3 Lot 2772 Sp #2  
 - 7-2-94 # 4534  
 - [CLARENCE MILTON U, JR s/o SR OF MORSE U / Fulliam U  
 Suburban - Hanson U two]  
 [Arney C. U  
 Belonda HURVIFAY  
 22 DEC 1928 - 30 JUN 1994
- △ F 4. Clarence M. U Sec 3 Lot 2481 Sp #1  
 - 12-16-72 # 838  
 □ owner Helen U  
 - [WIFE OF THURMAN HOWELL U]  
 [C. M. U, Jr  
 3 AUG 1926 - 15 DEC 1972
- △ C, 5. Eliza Short U. Sec 3 Lot 2191 Sp 3  
 - 1-31-02 - # 6655  
 □ owner Thurman H. U [ELIZA  
 [SHORT DANIELS] + Spouse on Stone for 1 mo  
 - [s/o # 1]  
 [Eliza D. U  
 Tech USA WW II  
 13 FEB 1924 - 28 JAN 2002
- 6. Ernest U Sec 4 Lot 4272 Sp #1  
 - B-18-1995 # 4858  
 - [ERNEST CARL U s/o WM FAULKNER U  
 of the Sherwood U / Eliza U  
 SC - W M U June  
 s/o GEORGE EUGENE U, SR  
 [me CAROL JESSAMINE WILLIAMS w/o WALTER EARLAND U Nathan, I / Burtis U SC  
 - Gilbert Burtis U June]
- △ 7. Jesse W. U Sec 3 Lot 409 Sp #4  
 A 4-18-74 # 1018  
 A + A [vs 14 vs 24 ??] [AOS - Williams  
 Hubert Parr 1893 - 1966 Gladys Bequell  
 1901 - 1985  
 [Jesse Williams U  
 1895 - 1974
- △ G, 8. John U Sec 3 Lot 2602 Sp #1  
 - 4-23-96 [SEE ALSO # 16]  
 - [John Williams U  
 4 DEC 1903  
 20 APR 1996  
 OSSW Ruby Ross U  
 15 JAN 1916  
 18 DEC 1978



Δ E<sub>1</sub> 9. John Lee U, Jr Sec 3 Lot 2168 Sp3  
11/28/50 # 6339

John Lee U, Jr AVN  
Cadet USAF WWII  
3 JAN 1920 - 22 NOV 2000  
OSS W

□ E<sub>2</sub> 10. Mary S. U Sec 3 Lot 2168 Sp4  
2/7/97 # 5250

Mary S. U  
25 JAN 1904 - 4 FEB 1997

→ [MARGIE ALICE CREEK]

□ B<sub>2</sub> 11. Margie C. U Sec 3 Lot 609 Sp2  
12-01-1995 # 4920

1908-1995

□ owner Robert B. U [ROBERT BRYAN U] (SEE #14 BELOW)

→ [WIF OF #1]

□ 12. Martha H. U Sec 3 Lot 2233 Sp4  
6-18-88 # 3239

Δ 13. Patricia <sup>Δ</sup> Alongo U. Sec CN Crypt #159  
12-13-02 # 6966 Chart A

Δ owner Barbara Renee U.

→ [ROBERT BRYAN U s/o HERMAN EDGAR U - Richard U, III James U, III  
Subclass - Kearney U, III]

Δ B<sub>1</sub> 14. Robert B. U Sec 3 Lot 609 Sp1  
7-23-84 # 2491

1896-1984

→ [ROBERT VADEN U s/o EDGAR G. U; s/o HOMER F. U Richard U, III James U, III SC  
Kearney U, III]

□ 15. Robert V. U. Sec 4 Lot 1384 Sp1  
8-6-91 # 3842

□ E<sub>2</sub> 16. Ruby U Sec 3 Lot 2602 Sp #2 [SEE ALSO #8]  
12-20-78 # 1643

→ [SARA FOREST U - DAU OF #3]

□ 17. Sara F. U Sec 3 Lot 2259 Sp3  
owner L. W. Monnette [GF/O #17  
11-11-72 # 826



Friend C3 → [BOBBIE LEE U-D/O# 1]

Bobbie U. Denton 1937-1996

+ Adjacent Stew

Kenneth Lee Denton 3 APR 1956 - 22 JUN 1984

↳ [s/o BOBBIE LEE U]

Near C3 Monesette

Lamson W 1901-1995

Abie F 1906-1985

↳ [see Bertha Bannan]

Vallin C. RAY

Bertha B. RAY

2ND LT USA WWI OSW

Beland Wife & mat

26 MAY 1887 - 23 NOV 1975

23 DEC 1899 - 28 JAN 1976

↳ [s/o Robert Emerson Ray; s/o Bochner Ray]

RPA & Linwood Penny spent about 2 1/2 hours on 1 OCT 2004 visiting the Raleigh Mem PK Cem. We first got access to the Rolodex of the main office & copied details for 17 Upchurch entries. There was no map available to help us locate any particular gravesite - even in a section, so we elected to inspect every gravesite in section #3. Did not go to other sections. The Upchurch sites were found randomly over section #3. Notes made upon inspection is shown embodied by



RESTLAWN MEM. GDN. CEM. RALEIGH, WAKE CO, NC

○ Information gathered by RPU & SSU in RESTLAWN MEMORIAL GARDENS CEMETERY, RALEIGH, WAKE CO, NC on 20 JUL 2001. There are two Upshaws groups buried here - one involves the twin sisters of RPU [NOT COVERED HERE] and the other members of the John Rice U, I line in the Nathan U, I / Buster U subline - more especially the family of SION ODELL U who is the son of BERTIE ODELL U & the grandson of JOHN RICE U, I. Details from the office records + ○ copied in the cemetery and [ ] added by RPU from his records.

[FAT] Δ MR SION ODELL U PLOT 11-GE-0136-C03  
d 21 NOV 1977 (SION U b 1900)

[MOT] Δ LETTIE GREEN U PLOT 11 GE 0136 C04  
d 22 JAN 1982 (LETTIE G U b 1902)

[DAU] Δ DILLIE U PLOT 11 GE 0136 A03 [DILLIE JOSEPHINE U]  
d 10 APR 1992 (DILLIE J b 1933)

[SON] Δ BERTIE ODELL U PLOT 11 GE-0136  
d 7 NOV 1961 (b 12 FEB 1939)

[SON] Δ (JAMES M. U b 1934 No death date) [JAMES MELTON U]  
This son not in book. Apparently still living as of 20 JUL 2001

BRITT CEM - GARNER - WCNC

SEE GARNER

# Interment.net

Cemetery Transcription  
Library

[What's New](#) | [Search Records](#) | [Browse Cemeteries](#) | [Publish Transcription](#) | [Cemetery Blog](#) | [Partners & Links](#)

[Home](#) > [United States](#) > [North Carolina](#) > [Wake](#) > [Britt Family Cemetery #2](#)

## Britt Family Cemetery #2 Wake County, North Carolina

Neils Branch Road, Wake County, NC

Lat: 35°38'37"N, Lon: 78°37'30"W

Contributed by Shirley Olson, Mar 16, 2002  
[[shirley32olson@yahoo.com](mailto:shirley32olson@yahoo.com)]. Total records = 8.

From Raleigh Beltline take 401 S. (Exit # 298) to SR. 1010, turn left and go 4.9 miles to a left turn onto Neils Branch Rd, a dirt road. Go .04 miles on Neils Branch Rd., don't get discouraged. Pull over where another dirt road branches, there is a parking spot on the side of the roads.



[Click photo to enlarge](#)



[Click photo to enlarge](#)

A family cemetery. About 100 feet on the left side of Neils Branch Road a low cement block wall is visible, 2 large magnolia trees are within the walls, and a small group of tombstones.

As usual in Wake County, a large subdivision is under way in this rural area dotted with small horse farms. A cul de sac is staked out that will put this cemetery in back of a home site.

The cemetery is in fairly good condition, all the tombstones except one is clearly readable. There is undergrowth and small trees that are not yet a hindrance.

I surveyed this cemetery on Mar15, 2002.

- *Shirley Olson*

**Britt, Elether Rorer**, b. 19 Mar 1881, d. 5 May 1967, "Sister" \*  
**Britt, Iva Leonida**, b. 3 Feb 1889, d. 23 May 1961  
**Britt, Lucetty Catie**, b. 17 Mar 1861, d. 19 Jul 1934, w. o. Troy R. Britt  
**Britt, Malissa Alma**, b. 28 May 1896, d. 8 Dec 1989  
**Britt, Pearl Floyd**, b. 1 Feb 1891, d. 9 Mar 1980  
**Britt, Rachel Rebecca**, b. 3 Feb 1893, d. 7 Jul 1893  
**Britt, Stella Catie**, b. 2 Sep 1884, d. 17 Oct 1900  
**Britt, Troy R.**, b. 2 Jun 1855, d. 7 Feb 1896

Misc:

\* monument off it's base

There is a small rough stone firmly in place and presumably a tombstone but not readable.

Brown - Wynn Funeral Home - Raleigh, NC  
MON ~~FEB~~ - 26 FEB 1980 Visit by R. P. U.

H. J. Brown, Co C helped me = Randy — )

1929 - No U's

Format: There is an alphabetical listing - then a page no which gives details

1928 - No U's

Mr J. H. Ray - charged to ~~W. I. U.~~ pg 228  
Pendene 710 Sasser - died dex Hoop  
& 5 DEC 1928 - Cert. Phy = Bell

Randy says  
Met Mary  
Neyser  
Naddled - Marie  
same before  
1900.

1930 - W. D. Uchunch Pg 111

pg 111 / William D. U. - Pendene Cary Rt 1  
& at Pendene 15 AUG 1930 bur Ashery 17 AUG 1930  
Cert Phy = R. J. M. Templeton &  
Goods ordered by R. J. Conrad charged to Mr U.

(Wake County Health Dept Vital Records  
at Wake Co - a good place to go per Randy)  
see Mr Woodlief.

1931 - 2nd set

[LEWIS BRICKHOUSE U]

[LAURA JANE U]

L. B. Uchunch - pg 88 - charge to Mrs W. J. Oakley

Pendene = East Durham NC

Died = Highway 90 & 12 JUN 1931

Cert Phy - Coroner Waring. Bur Wake Co NC 14 JUN 1931

Goods ordered by Mrs W. J. Oakley

2626 Praters Rd, E. Durham, NC

1932 No U's

1924 No U's

1925 #1: Mrs E. M. Perry deceased pg 83 & 1 APR 1925  
Pendene = New Rt 2, & dex Hoop

changed to W. I. Uchunch

Cert Phy = Wolkerson - bur Northside, NC

Goods ordered by L. L. Rainier, 2028 Hillsboro St, changed to W. I. Uchunch, New

#2 Mr Uchunch deceased pg 24?

changed to Mrs W. I. Uchunch

W. M. G. Uchunch 200 Firewood Ave died at Pend.

& 25 SEP 1925. Cert Phy = Waring (Coroner)

NC Rt 2  
G. A. Rainier  
Wake Forest Rt 2

Andrea Merriam U

d Rex Hosp

d 29 MAY 1974

h 30 MAY 1974 Pal. Mem. Park } [MERTIE HOWELL]

Charged to Mrs Mertie H. U. 29 Bagnell Ave 2760

h 16 JAN 1906, Wake Co NC

1926 #1 Deceased ~~Albie~~ Albie Williams - hox = Cary, NC

charged to W. D. Ysurch pg 4 Cary Rt 1

d 12 FEB 1926 - cert Phy Templeton

hux Cary -

~~#2 ?~~

~~charged to J. B. Ysurch~~

~~pg 50~~ } False entry in records

#3 Deceased J. B. Ysurch pg 194

charge to J. B. Ysurch

1927

#1 Deceased Eleanor M. Ysurch

charged to D. O. Ysurch pg 218

d Jacksonville, FL d 4 OCT 1927 hux Oak City

ordervy Delmas D. U of f. FL.

#2 Deceased Vernon Ysurch

charged to Charles Harris pg 201

Residence - County Home died - residence

d 13 SEP 1929 cert Phy = Jensen

hux City Cem. 14 str

Good ordered by Charles U. Harris.

PA = Cash - Mrs Moring = 45

PR C.D.H. = 10



1922

→ ADDIS S. U

- #1 Mrs Addie Est(?) Yrchurch (D) 157 → widow  
Res = 209 N. Salisbury St. d at Res  
d 17 MAY 1922 - bur near Wake Forest NC 18 MAY 1922  
Cort Phy = Freeman.  
Goods ordered by Otr Jones, Wake Forest NC
- #2 W. M. Yrchurch 162. W. N. Pool = deceased  
→ ordered Goods along with C. T. Hester Res Neuse Pt 2  
→ Com. N. Bank. → [LEWIS BRICK HOUSE W] d Res Hosp  
bur Family Cem. (bur 22 MAY 1922 d 21 MAY 1922
- #3 L. B. Yrchurch 280. Infant = deceased  
Child of Mr + Mrs L. B. U. Yrchurch of Neuse NC Pt 2  
d Res Hosp. 21 SEP 1922 - Cort Phy = A. C. Campbell  
bur = Neuse - 21 SEP 1922 - ordered by  
W. P. Massey charged to L. B. U.
- #4 Bryant Yrchurch 381 Joseph H. Yrchurch  
Joseph Henry U d 24 DEC 1922 - bur Melbourne 25 DEC 1922  
Cort Phy = Wilherson. - Charged to Bryant U.
- #5 ~~H. E.~~ Yrchurch 388. Mrs Frances Yrchurch  
deceased = Joseph Henry Yrchurch  
Res = Caydence Mills, Raleigh NC  
d = 24 DEC 1922 Cort.  
deceased = Mr Frances J. U.  
Res = 416 S. Pearson St. d at Bendene  
d 28 DEC 1922.  
Cort Phy = J. W. McGee - bur City Cem  
bur 29 DEC 1922  
Charged to H. E. Yrchurch 510 Hillside St.

1923 #1 Mrs Addie Yrchurch deceased 174  
Charged to J. C. Yrchurch  
→ Res Whitaker Mill Rd - d 1 MAY 1923 - widow  
Cort Phy Bell - Burt Oakwood  
Service at Wake Forest  
Charge to J. C. Yrchurch

- Δ #2 W. W. Upchurch deceased 310  
 Δ charged to Miss Genevieve Upchurch (?)  
 → No 208 Chamberlin St. & at Residence 12 SEP 1923  
 Cert Phy = McEee, Ben Dahwood.
- Δ + Δ Goods ordered by A. N. Upchurch - charged to Miss Gertrude Upchurch  
 Δ #3 deceased Mrs W. W. Upchurch of Raleigh  
 Δ charged to Mrs Genevieve U. 412  
 → Deid = Richmond VA.  
 by Dahwood -  
 Δ charge to Miss Gertrude<sup>??(sp)</sup> Upchurch (see pg 310)
- Δ 1935 - deceased = Mrs IDA. N. U. [IDA BLANCHE HORTON]  
 Δ d Columbia GA 15 OCT 1937 cerebral hemorrhage  
 Δ by 15 JAN 1870.  
 Δ by 18 OCT 1937 Dahwood  
 Δ charge to W. E. Upchurch Columbia, GA [WILLIAM ERNEST U]  
 Δ Cash paid by H. R. Mott.
- Δ 1946-47 - deceased = JUNIUS C. Upchurch  
 Δ d 113 Park St Raleigh, NC 6 APR 1946  
 Δ Cert Phy Dr Bryan. by Dahwood  
 Δ by 9 OCT 1878.  
 Δ cause. Arteriosclerosis/Hypertension/Heart Disease  
 Δ charge to Mrs W. C. GILL 113 Park St.
- Δ 1948-1949 None
- Δ 1952-1953 None
- Δ 1950-1951 deceased = J. Serwood U  
 Δ d Rex Hosp. 17 JUN 1950. by 19 JUN 1950  
 Δ Carcinoma Pancreas by Dahwood  
 Δ by 28 SEP 1870  
 Δ Cert Phy = Dr. Lane Upshlet  
 Δ [Charge to Mrs Mary Tudor Hardy Upchurch → Δ  
 Δ 1200 16th St NW Washington DC.  
 Δ Jean Branford Abby.

1940-1942 - None

1960-61 - none

1958-59 - None

1956-57 - None

△ 1954-55 deceased = Oelmen D. Upchurch  
 d Jacksonville FL - 19 MAR 1955  
 bur Dahwood 21 MAR 1955  
 born 1881.  
 Change to S.A. Kyle Funeral Home  
 Jacksonville, FL

1968 - none

1967 - None

1966 - None

△ 1965 - deceased = Cora Dunn Upchurch  
 d 13 MAY 1965 in Jacksonville FL  
 bur 17 MAY 1965 Dahwood 82 yr old  
 Changed to Kyle McTellar, Inc 17 West Duval St  
 Jacksonville FLA  
 Mrs George T. Angus  
 Jacksonville FL 5746 Cedar Forest Dr S

1964 - None

1971 - None

1970 - None

1969 - None

1962-63 -

△ 1974 #1 deceased AUBA Member U: 29 MAY 1974  
 bur 16 JAN 1906 - bur 30 MAY 1974 Rab. Mem. Park  
 Change to Mrs Mertie H. Upchurch [MERTIE HOWELL]  
 29 Bagwell Ave 27607

△ #2 deceased Charles Clinton U d 18 FEB 1974.  
 bur 20 FEB 1974 Dahwood Cem - died May 1974  
 born 17 OCT 1895-  
 Change to dau Mrs Elizabeth Upchurch  
 912 Dixie Trail 27607

PVT 4-159-341 ent 31 JUL 1918  
 Dec 3 JAN 1919  
 Δ 1974 #3 Deceased = Rufus Pearson U  
 d at 740 Smallwood Dr 5 NOV 1974  
 bur 9 NOV 1974 Montlawn Mem Park  
 born 5 DEC 1904  
 change to William T. Uychurch  
 3105 Comstock Rd 27604

1972 #1 Deceased Clarence Milton Uychurch, Jr  
 d Wake Mem Hosp 15 DEC 1972  
 bur 16 DEC 1972 Raleigh Mem Park  
 b 3 AUG 1927  
 Address - Johnston Co, NC  
 change to Helen G. Uychurch  
 2464 Derby Drive 27610

#2 Deceased Edgar Graham U  
 d Rex Hosp ~~31~~ 28 JUL 1972  
 bur 31 JUL 1972 Oakwood  
 born 20 NOV 1907  
 Address Wake Co NC  
 Change to Mrs Vera L. Uychurch  
 211 Gaston St 27605

#3 Sara Forest Uychurch  
 d 707 Boanets Dam Rd 9 NOV 1972  
 bur 17 NOV 1972 Ral Mem Park  
 Address Raleigh NC  
 change to Father: Amary C. Uychurch  
 3921 Fernwood Dr 27612

→ recent note says:  
 change to Mrs Marilyn M. Uychurch  
 707 Boanets Dam Rd 27607

1975 - Deceased ~~Lydia~~ LYDIA Uychurch Uychurch  
 d Manor Care, Wilmington NC 7 MAY 1975  
 bur 9 MAY 1975 Montlawn Mem Park  
 born 25 JUL 1897 Add: Wake Co NC  
 change to Mrs Evelyn U. Morgan (dau)  
 Ste #6 Box 178  
 Wilmington, NC 28401

Δ 1975 - Miss Maude Uplund  
 5548 R  
 died Eremus, NC  
 bur 4 DEC 1975 - Inwood Byst Ch.

Charge to: Eremus Funeral Home  
 Eremus, NC 28339

No death date given.

Δ 1977 - received Mrs Rosalie Coats Uplund<sup>Δ</sup>  
 at Rex Hospital 16 NOV 1977  
 bur 18 NOV 1977 - Montlawna<sup>Δ</sup>

born 14 MAR 1910 Wake Co, NC

Charge to: Mrs V. C. Poindeexter  
 5200 Old Stage Rd  
 Raleigh, NC 27603

Service provided at Garner, NC

1976 - None

1973 - None

BUFFALO CEM - SCTWP - WENC

ON Tryon Rd - R. Bramhette - see SCTWP

CARLTON CEM - LEESVILLE TWP - W C NC

See Leesville TWP



A.F. AM

CAROLINA BIBLICAL GARDENS - WAKE CO, NC

○ FROM LTR 31 JAN 2004 Ann Pee to RPU

Included was the obituary shown below  
for Ernestine G. Upchurch of Raleigh, NC -  
FROM: News & Observer 2 JAN 2004 (FRI). Ann  
provides a note

## Black Lady

### RPU COMMENTS:

- Note that the obit provides  
no clue as to how the  
deceased got her Upchurch  
name - whether by birth  
or by marriage.
- Note that her sons have  
the last name BRANTLEY
- Note that the 2001 Raleigh,  
NC Phone Book has no  
Upchurch listed for DACIAN  
ROAD
- Assume from the obit & Ann's note  
that <sup>△</sup> LEA FUNERAL HOME is for  
Blacks, primarily, and possibly  
also. <sup>△</sup> CAROLINA BIBLICAL GARDENS ↑  
- both institutions presumed to be  
in Wake Co, NC.
- Crawlfile for ALTON BRANTLEY

### Ernestine G. Upchurch

RALEIGH - Ernestine G. Upchurch  
of 536 Dacian Road, Raleigh, died  
Tuesday.

Funeral services Saturday 1 p.m.  
at Lea Funeral Home. Burial, Caroli-  
na Biblical Gardens.

Surviving: daughters, Mirinda  
Meeks, Miranda Green and Betty  
Young, all of Raleigh; sons, Bruce  
Brantley of Fayetteville and Alton  
Brantley of Raleigh; sisters, Mary  
Hocutt, Wilma Gill, Eula Alston,  
Rosa Lee Poole and Ella M. Allen,  
all of Raleigh; nine grandchildren; a  
host of nieces, nephews, other rela-  
tives and friends.

Visitation, Lea Funeral Home  
12:30-1 PM Saturday.

A Lea Funeral Home Service.  
231-1000

AF-AM

CARY 1st UCC-CEM - CARY- WENC

See Cary

CATARA CEM - SCTWP - WCNC

See SCTWP

(At Catara Springs Christian Church)

CENTRAL BAPT CEM - WENDELL - WCNC

· see Wendell

(TWO VERSIONS)

CHRISTIAN CHAPEL CHURCH

WAKE CO, NC

Visited by RPU 19 NOV 1978  
This is the Colored Church.  
Just NW of Friendship on South  
side of Road.

△ JAN U b 1854 d APR 1915

△ ERNEST J U 15 JUL 1889 - 1 JUN 1947

△ U → CLAUDE L. 6 SEP 1885 - 26 JAN 1971

△ H&W → BETHNIA B. 7 APR 1894 -

△ WILSON → JOHN 1888 - 1961

△ H&W → LAURA U. 1888 - 1963

→ (Mayor Margaret Lee  
Uplunch - RPU)

△ = Entered in Profiles - 25 NOV 1978 - RPU

By Robert P. Uplunch

CITY CEM - RALEIGH - WCNC

See Raleigh

CLEMENTS-COTTEN CEM - MORRISVILLE - W.C.N.C.

See Monument



COLLINS GROVE BAPTIST  
CHURCH & CEMETARY - WAKE CO, NC

Visited by RDU 19 NOV 1978  
Located  $\frac{1}{2}$  mile East of Holloman  
X Roads in Wake Co, NC.

No Ur found - Church still in operation

By Robert P. Yehuda

CROSS CEM - DURANT RD - WAKE CO, NC

○ Notes of RPA Call 11 OCT 2004 to Everette Henry Cross

Carol (Roberson) Brum of Six Forks Baptist Church had suggested I call Everette re the history of Six Forks Baptist Church & Cemetery [He is a 2nd cousin of RPA] He does not recall much about Six Forks Baptist Church as his parents moved from the area to the Pool Road south of Raleigh, NC about 1933 when Everette was 5 years old (b. 1928). However his Grandparents Louvenia J. Cross & John Richard Cross were members at the Church. However they are buried at the CROSS CEM on DURANT RD, Wake Co, NC This road is just North of the Outer Beltway & runs from Six Forks Rd to Falls of the Neuse Road. The cem is preserved in CROSSGATES Subdivision. There are few if any monuments with inscriptions but in addition to Louvenia & Richard their children Everette recalled as being buried there are: Ida Louisa Cross [corroborates with other info] & her son who died age 3 + others but Everette used nicknames.

Everette implies that Richard & Louvenia had a homestead where the Cross Cemetery is located.

Everette is a brother of Mary Clara Cross who was a valuable correspondent of RPA in the 1985-1995 era.

Everette was cordial & agreed it would be nice to visit when I visit NC.

Everette does not know who was the Father of John Richard Cross, his GF

CROSS CEMETERY  
SIX FORKS AREA - WAKE CO, NC

From Recollection of Robert Phillip Yarburch  
on 17 OCT 1993

The above mentioned cemetery is located on the west side of State Road 1005 north of Six Forks in Wake Co, NC as shown by the red (X) on the attached map. I have never been to this cemetery but from what I have been told it must be no more than one or two miles north of Six Forks and then off into the woods to the left. I am related to the Cross Family member buried in this cemetery and would be pleased to correspond with any interested party.

Robert Phillip Yarburch





CROSS GRAVEYARD - WAKE CO, NC

○ See Sojourn Notes Re RPU MAY 1995 Visit Ed Raleigh, NC. Had a chance encounter with Benton Franklin Clyton, Jr

30 MAY 1995 (TUE)

Before breakfast RPU looked for Cross Graveyard in NW quadrant of Falls House & Stuckland Rd. Did not find same. Encountered Benton Franklin Clyton, Jr "sonny" who knew my Uncle Franklin & lived often in his home. Sonny lived in the home just west of Garter Johnston in 1947-1948. He knew Uncle Getty & was a close friend of Betty U. Sonny taught school at Millbrook five years & worked away from Raleigh but retired in Raleigh. He is on a State Retirement Board.

His GF Edgar Remus Massey - Still living - Raleigh  
↳ His GF Shirley ( ) Massey

His GF - Arthur Benton Clyton

His F = Benton Franklin Clyton, Sr

He lives at 8520 Newcourt Rd  
Raleigh, NC 27615 919-676-0187

He wants details on U.B.



LOCATION OF CROSS CEM. BARTON CREEK TOP WAKE CO, NC

Joins Map 1113

35°53.15' 8 790,000 FT 3 35°54.45' 4 35°54.00' 6 35°54.00' 7 35°53.15' 9



SEE GRID CO HR  
1 WANSBERRY CT  
2 COPPERSMITH CT

SEE GRID FB GB  
1 WATERFORD PARK LA  
2 ROYAL KINGS LA  
3 KENNETH VILLAGE CT

SEE GRID GR 68  
1 WATERFORD PARK LA  
2 ROYAL KINGS LA  
3 KENNETH VILLAGE CT

SEE GRID GR 68  
1 WATERFORD PARK LA  
2 ROYAL KINGS LA  
3 KENNETH VILLAGE CT

SEE GRID GR 68  
1 WATERFORD PARK LA  
2 ROYAL KINGS LA  
3 KENNETH VILLAGE CT

SEE GRID GR 68  
1 WATERFORD PARK LA  
2 ROYAL KINGS LA  
3 KENNETH VILLAGE CT

SEE GRID GR 68  
1 WATERFORD PARK LA  
2 ROYAL KINGS LA  
3 KENNETH VILLAGE CT

AF-AM

DOUGLAS AVE CN. CEM - HOLLY SPRINGS - W C NC

See Holly Springs



EBENEZER CH - LEEVILLE TWP - W C NC

↳ See Leeville TWP

EBENEZER BAPT CH CEM- RALEIGH - W C NC

see Raleigh

EBENEZER - UMC CEM - GARNER - W CNC

See Garner

EDWARDS CEMETARY (X)

Visited by RDU 25 FEB 1980

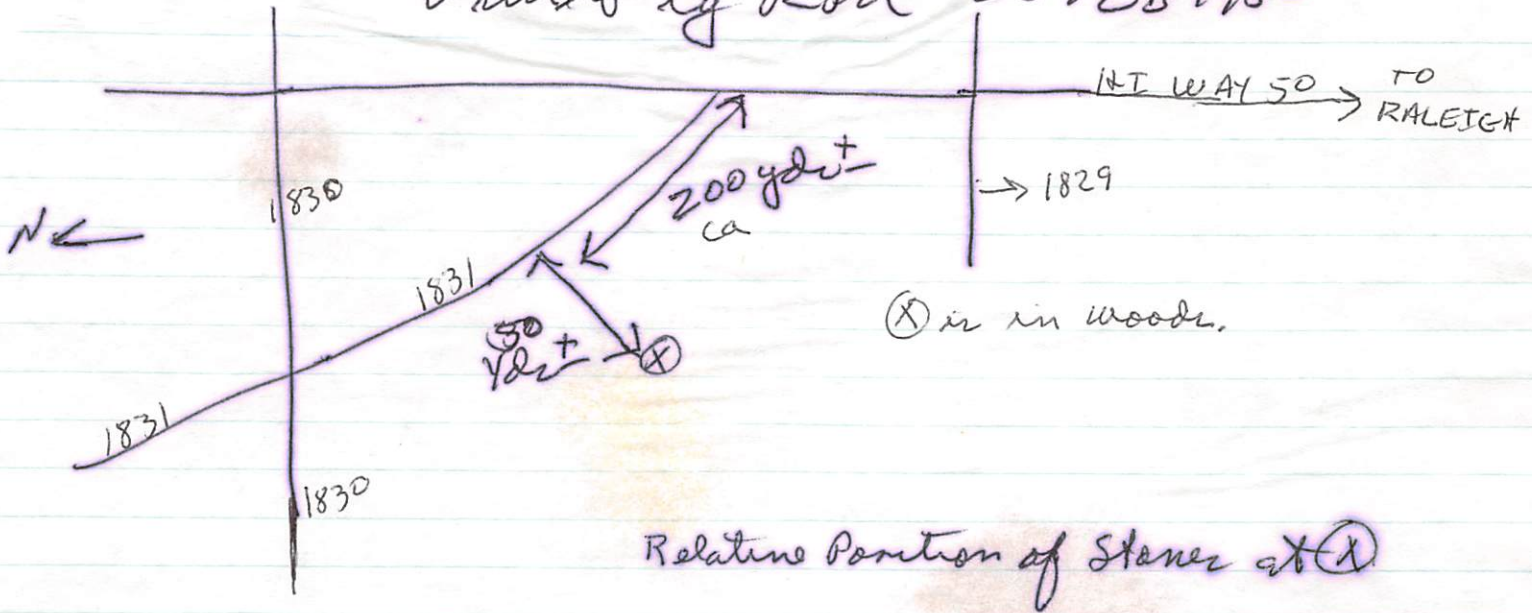

Relative Position of Stones at (X)

A B C D E

A = 1' wide 18" high - curved at top  
 "Infant of Mary & J.T. Edwards"

B = 15" wide 24" high  
 "J.T. Edwards born 1862  
 died March 15, 1908 EGE 46"  
 ↳ this way on stone

C = Base in there - stone missing

D = No stone - but Green cup  
 maybe 10-20 yrs old

E = 1' wide 18" high  
 "John ED Borned June 25, 1892  
 Died April 5, 1899.

25' North of A are 2 sunken spots - like grass  
 To the West about 10' are two upright  
 stones - like markers

- By Robert P. Edwards



ADDED COMMENTS ON THE  
EDWARDS CEMETERY ON  
STATE ROAD 1831 IN WAKE CO, NC

I was informed about the existence of this cemetery in 1978 by family members. I am told that other Edwards family members were buried there and I have some of the names. The family relationships are complex and in some respects obscure. I would be happy to correspond with anyone having an interest in the Edwards Families of Wake Co, NC

Robert Phillip Upchurch  
17 OCT 1993

○ Excerpts from Notes of RPA Visit 24 JUN 1978 to Ernest M. Nypier in Wake Co, NC

I. Tommy Nypier - raised his family across the street from Soapstone Church. Tommy and Eugene D. Crow were good friends

A. Ernest M. Nypier

B. Norwood Wilson Nypier

Re the Edwards Cem NW corner of Creedmoor Hwy & 6 Forks - Seesville Road:

Ernest has no knowledge of this site. This area was known as the Wilson Farm. Ernest says the area was owned by a colored couple RAID DOSIER & JOHN DOSIER. It was bought by A. J. BAILEY. Ernest said Ernest Bunn might know but he died about 1976. Ernest Bunn has a brother Bud Bunn who might have info.

The land in the SE corner was owned by C. J. LASSITER and the Lassiter House is still standing

ELEVATION BAPT CH CEM - RALEIGH - WCNC

See Raleigh

EMERY CEM - SCTWP. WENC

See SCTWP

(on Tryon Rd)

EPHESUS GEN - SCTWP - WCNC

See SCTWP

(AA Ephesus Baptist Church)

EDWARDS CEMETERY - WAKE CO, NC

○ See Profile of Lorena Thompson - Entry 23 JUN 1978

- On this date Lorena & my Aunt Lucy & my sister Ernestine toured the Six-Forks Area of Wake Co, NC. References were made to certain of my ancestors & their relatives which fit within the framework given below:

NOTE: The confusion continues on how the family name of WARREN and EDWARDS are properly applied here - RPU 31 AUG 2003

I. Sally Warren d 1914 "MUTT" m.d. - - EDWARDS

A. COUSEY d abt 1940 [PAULINE?]

AKA AS PAULINE EDWARDS WHO m.d. - - ABRAMS BUT MATTIE SEEMED TO BE HER MATTIE EDWARDS ?? - RPU

1. Mattie Edwards

a. Bessie Edwards [Bessie Elvora Edwards] → Bessie Elvora Creighton [FAT = Eugene D. Crow]

b. A baby died as an infant - no name learned. [Lorena says FAT probably WARD LYNN as he named Mattie]

2. Sallie Edwards

↳ MONK EDWARDS "MUTT's Sister" m.d. AL KING

II. - - - "MUTT's Sister" m.d. AL KING

The above references were made while visiting the "EDWARDS" Cemetery west of Rd 1831 across from the home of Eugene D. Crow. The tour group agreed this is where Mattie & the other Edwards are buried. The land here was owned by the WILSON family. Lorena came to the burials here of Sallie Creighton and a Baby - a child of Mattie born after Bessie. Adolphus Creighton dug the grave for Mattie here. Lorena does not recall Cousey having the name Pauline. Cousey left MUTT with all the little children and the Lynn family came to the rescue - WARD LYNN, IRVING LYNN & EMMA LYNN - siblings. Cousey had been living on the Wilson Place - Bessie was born on "the corner" [HWY 50 & 6 FORKS RD?] Lorena was living at Hamie Super Creek when Bessie was born.