

GAY

○ EXCERPT FROM INDEX OF BOOK "THE GOODWIN FAMILY OF CENTRAL N.C." BY THOMAS JERRY GOODWIN, SR - 2009 RPU 24NOV 2012. - NOTE: INDIVIDUALS LISTED AS MEMBERS OF THE \_\_\_\_\_ FAMILY - [WAKE/CHATHAM COUNTIES].

Gay

- Carol Teresa 423, 584
- Deborah Susan 422, 584
- Delbert Proctor 422, 584
- Irving P. 584

(65)

GAY

EXCERPTS from Notes of RPU NC Trip 9-23 OCT 2007 Pg 7-8-9  
 11 OCT 2007 Input from Simon NMN Rogers - Danni's TSP, FC, NC



- ① 1 of 4 Little Perry Phillips Tracts sold abt 1914. Bought by Simon Rogers, Sr
- ② Tract later bought by Simon Rogers, the Younger
- ③ Dallas Pearce owns - was in 3 parts - owned by Stephenson Pearce
- ④ Dallas Pearce bought from E. G. Richards
- ⑤ Benjamin Baker owned land in area. This tract is his DAUGHTER Sarah Baker who sold to BROOK BROWN now Neil

- ⑥ 1 of 4 L.B. Phillips 1914 Tracts - to Russell Perry then to Simon Rogers, the Younger
- ⑦ Lawrence Davis Perry
- ⑧ 40A Simon Moses Pearce → Las Perry → Lutter Perry → Danny Gray Perry
- ⑨ Brock Perry → Charles & Las Perry → E. G. Perry & Sam Perry
- ⑩ Brock Perry Home

- ⑪ From Perry Estate to Leland Johnson (Archie Whitley unvalued)
- ⑫ Place where Green Perry died was owned by Las Perry
- ⑬ BAKER LAND
- ⑭ GAY LAND

GAY

○ EXCERPT from Notes of RPA NC visit 9-23 OCT 2007 - Pg 2?  
Visit to Benny Foster Perry on 17 OCT 2007 - Input from him

- ⑬ <sup>△</sup> GAY LAND - LANDLOCKED BUT ALWAYS HAD ACCESS
- ⑭ <sup>△</sup> PRIVETTE LAND - OWNERS OF ⑬ & ⑭ MD SISTERS  
△ MINTA & NETTIE PEARCE
- ⑮ LAND OF <sup>△</sup> JOHN PEARCE
- ⑯ LAND OF <sup>△</sup> JACOB PEARCE & BEFORE HIM <sup>△</sup> ACRIL PEARCE
- ⑰ OLD BAKER FARM →  
△ JAMES PERDUE & THEN DEVID ED
- ⑱ <sup>△</sup> ARNOLD LAND - OWNED BY THE WIDOW & 2 CHILDREN
- ⑲ <sup>△</sup> WESLEY B. PERRY CEM (DIED IN CIVIL WAR - VA)

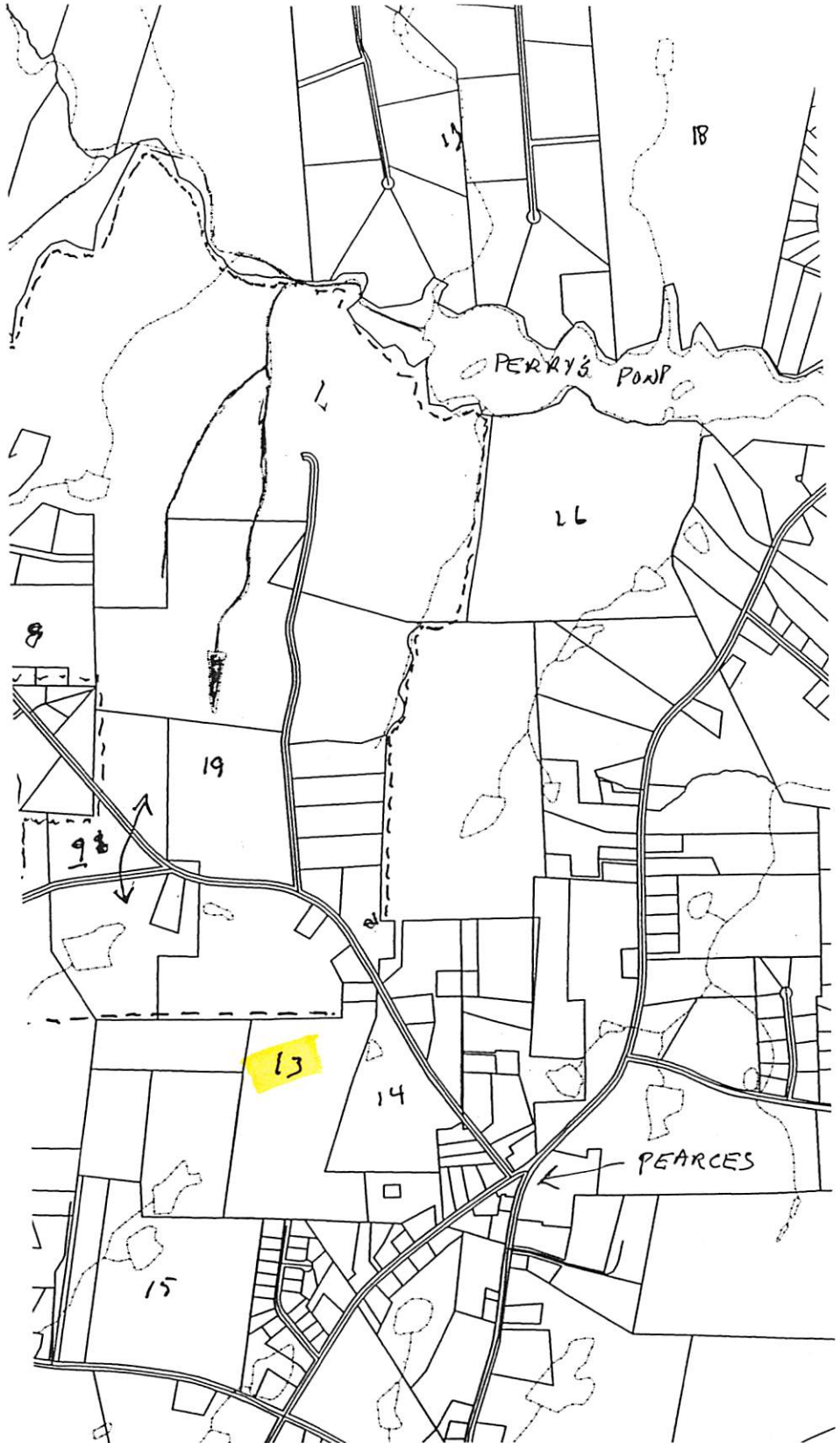

GAY FAMILY

○ From Ltr 5 MAY 1980 Ben Lane U, Sr to RPU  
Ben reports:

There is a good article on the Gay family pages 74-79 from the History of Fayette County Ga 1821-1971 published December 1977 by the Fayette County Historical Society. It is in the Archives State of Georgia. They came from North Carolina and evidently have remained in Georgia - Fayette County.

CROSSFILE: GAY FAMILY; THOMAS GAY U, SR

GAY FAMILY

○ Item in It's 8 MAR 1960 Martha Lucy U to Alice Brown Gay  
Crossfile: GAY FAMILY; BARNES FAMILY

[Thomas Gay U, Sr - presumed s/o Charles U, Head of clan - m d  
Patience C. Barnes. Martha is trying to show historic  
relationships between the GAY, BARNES & UPCHURCH  
Families - RPU]

I think the gay and Upchurch relationship dates back to the latter part of the 17th century or the early part of the 18th. Henry Gay was in the Isle of Wight in 1683. He married Joanne, had three sons, Henry, Thomas, and John. He died, and his widow married Robert Lawrence Jr. who left land to his step-sons. Later Priscilla Upchurch married Turner Lawrence. In 1788 Henry Gay left in his will property to Stephen and Patty Barnes. Jethro Barnes the father of Patience who married Gay Upchurch was one of the witnesses. The Upchurches, Gays, and Barnes lived very close to each other in Henry County. I wish you would send me what you have on Thomas Gay and Barnabas Gay in North Georgia. Thomas Gay, wife Patience, in his will of 1784 left all of his land in Georgia to his son Thomas Gay. In North Carolina Thomas Gay and the Upchurches lived on Mocoson Creek, and there were several business transactions between them as well as being witnesses to other transactions. Their lands were adjoining. The same names run in the three families.

# GAY FAMILY

## CARTER - GAY WOOD FAMILIES

I. Joe, Bertha Carter md Rosa Gay<sup>!!</sup> - possibly dau of John Gay  
 b. 17 OCT 1890

A. Cecil Carter

B. Pearl Carter b. 1913 md Pressie Wood

1. Vivian Wood

2. Charles Pressie Wood "Woody" [Mayor of Lizard City, NC] b. 1913

md 1st Kay <sup>Francis</sup> Brannon<sup>!!</sup> - she md 2nd Albert M. Perry

md 2nd Shirley A - she md 1st - - & had a dau Robin Wood Vaughan

!! Probable Family.

I. John Gay

A. Rosa Gay

B. Donna P. Gay

C. Walter L. Gay  
 b. ca 1907 d.  
 14 OCT 1988 (Wendell, NC)

md Mary Woods

1. Walter Ross Gay

2. Josephine

Marie Gay md -- Evans

3. Verawia

Ann Gay md -- Friddan

D. Connie B. Gay

b. ca 1914 d. 4 DEC 1989

CMC Jean, VA. md 1st ---

md 2nd Katherine --

1. William Gay

2. Judy Gay

md -- Berkeley

3. Cecelia Gay

md -- Ashley

4. Caroline Gay

a. Donna Stan Wood md 28 SEP 1985 (Wendell, NC)  
 Terry Lee Milligan. He had 2 dau from 1st mg  
 ? April Dawn Milligan + Lisa Marie Milligan

b. Robin Perry Wood md Calum Neal Vaughan

i. Brandon Neal Vaughan

c. Jeey Wayne Wood md 21 SEP 1991 (Wendell, NC)  
 Mary Elizabeth Baker, dau of Wayne Baker

d.!! Lany Dennis Wood md Lisa McCormac

i. Shannon Denise Wood b. 8 JUL 1981

e.!! Phillip Charles Wood, M.D. b. 13 SEP 1951 (Raleigh, NC)

d. 25 OCT 1987 (San Francisco, CA)

f. Donald E. Wood

g. Senora Jean Wood ♀ md -- Denton

h. Dale Perry

i. --- ♀ md Lemar Pender

3. Jodie Wood

4. Josephine Wood "Jo" d. DEC 1992 md Herbert Shirley

5. Rachel Wood md John --

6. William Bertie Wood "Bill"

7. Sally Wood R.N. b. 27 JAN 1939 md Maurice --  
 a. Patna -- md Sam Heybreun