

① NOTES OF RPU CALL 8 DEC 94 & EDGAR - [817-641-3574]

□ I 32676 (John Edgar Gooding)
□+△ A Edgar Dalton Gooding and Lena Richardson
— No children

△+△ B. Lena Lanerne Gooding and Perry Quinlan Turner
— b. 27 SEP 1926 (Junction, Kimble Co, TX)

△+△ 1. Rocky Quinn Turner and Emendloyn Lambert
— Deceased - No issue

△+△ 2. Tamara Lynn Turner and Robert Smith
— Deceased - No issue

△ C. Billy Joe Gooding b. 21 FEB 1930 (Amarillo, Pan
— San Patricio Co, TX). never married

△+△ D. Wanda Joyce Gooding and Roger Kendall
— Eberhart b. 29 APR 1930 (Austin, Travis Co, TX)

△+△ 1. Susan Gayle Eberhart and Charles Odem Barnard

△+△ 2. John Donald Eberhart and Tommy Colston
△+△ E. Johnnie Jean Gooding and Carroll Vester
— Taylor [Vester from her family]

△ a Ashley
— Elizabeth
— Barnard
△ a Zachary
— Donald
— ~~Barbara~~
— b. 3 JUN 1989

△+△ 1. Sharon Alison Taylor and Michael Bowers

△+△ 2. Randy Carrell Taylor and Bonnie Ann
— Wright b. 17 JAN 1945 (Austin, TX)

F. Edith Kay Gooding b. 20 MAR 1972
— Mulholland (MOC) and Sanford Nelson

△ a. Brandon
— Michael
— Bowers
— b. 30 NOV 1976 (Austin, TX)

△+△ 1. Kristi Kay Mulholland and Quinton Allen
— Borough

△ 2. Shawn Nelson Mulholland b. 4 SEP 1975
— still single

△ b. Chryssanne
— Cody
— Bowers b. 8 MAR 1983

△ → (a) Quinton Page Kaitlyn Morgan b. 21 APR 1993

△ a Daniel Benner Taylor b. 25 JUN 1987 (FT Worth, TX)

△ b. Gabriel Scott Taylor b. 11 JUL 1988 (") d. 12 JUL 1988 (FT W, TX)

△ c. Nathaniel Rabonny Taylor b. 3 JUN 1990 (")

△ d. Jennifer BOWLERAN Taylor b. 7 JUL 1994 (")

① CONTINUED

□ I. ^{XID} 1994 (Susie Mae Gooding) b (Kruppa, Uvalde Co, TX)

Δ+Δ A. Herman Weldon Williams and Dixie Dorsett

Δ 1. Stanley Weldon Williams b 21 AUG 1949 (Austin, TX)

Δ and Foretha Wilber.

Δ a. Michelle Rena Williams b 25 AUG 1971 (Austin, TX)

Δ b. Mundy Gayle Williams ♀ b 28 FEB 1981 (")

Δ c. Adam Joseph Williams b 25 AUG 1986 (")

B Δ+Δ → Gilbert Williams and Alice Groenbeek

↳ b 1914 (Kruppa, Uvalde Co, TX)

□ II 32674 [MARY WILMERTH GOODING]

Δ+Δ A. Edgar Webster Nicely b 7 JUL 1919 and Ocie Scott Kennedy

- No issue

Δ+Δ B. Orville Lee Nicely and Ruth Cheser

- ↳ b 3 FEB 1922 (Whitewright, TX)

Δ 1. Rodney Lee Nicely b 5 FEB 1951 - SS

Δ 2. Krista Lee Ann Nicely ♀ b 31 JAN 1962 - SS

Δ C → Christine Nicely b 22 DEC 1925

Δ and Leslie Leon Boyd

- No issue

Δ D. Jack Nicely b 12 SEP 1928 (Whitewright, TX)

- d 14 SEP 1928

Δ+Δ E. Joe Frank Nicely and Mary Mullins

b 27 JUL 1930

Δ 1. Donna Beth Nicely b 30 MAY 1953 (Denson, TX)

Δ and Carl Ray Cox

Δ 2. Kenneth Joe Nicely b 10 APR 1959 d 13 AUG 1964

- ↳ fell from tractor under a disk - driven by FATHER

Δ 3. Carla Renee Nicely b 27 JAN 1961 and

Δ Gary Delane Patton [related to Gen Patton]

Δ+Δ 4. Eddie Randall Nicely and Pelly Ann Cannon

↳ b 25 JUL 1965

① - CONTINUED

III 32675 [Salma Ora Gooding] and BUTLER

Δ A. Bobbie Butler b 1918 d 1919 (Salinal, Uvalde Co, TX)

Δ B. Hattie Desia Butler b 5 DEC 1920 (")

Δ+Δ+Δ and (1st) Grant PAYNE b 1918 (Uvalde Co, TX) and 2nd Henry Hottenhouse 57-60

Δ C. William James Butler news in News of Neal - m'd 1967-
b 21 APR 1925 (Engleside, San Patroco Co, TX)
killed auto accident 5 JAN 1941

Δ+Δ → 1. Mary Estelle Payne and Nelson J. Long

Δ 2. Joe David Payne b 13 SEP 1942 (Uvalde Co, TX)

Δ m'd Ola Mae Wiley

Δ 3. Jonathan Grant Payne b 17 OCT 1947

Δ m'd Alma Lopez

Δ 4. Amy Fynne Hottenhouse

IV 32677 [Walter EUGENE GOODING]

Δ A. Alena Mae Gooding b 18 JUL 1938 (Amarillo, San

Δ Patroco Co, TX) and Vernon Ralph Gelling

Δ 1. Judy Alena Gelling b 12 JUN 1954 (Austin, TX)

Δ 2. Joyce Marie Gelling b 6 MAR 1956

Δ 3. Cindy Lou Gelling b 27 SEP 1959

Δ 4. Carol Lea Gelling b 1 OCT 1964

Δ B. Clyde Eugene Gooding b 1 NOV 1943

Δ and Belores Ross

- has issue - no details avail

Δ C. (Twin) Jennie Paul Gooding b 2 SEP 1946 (Austin, TX)

Δ and Annette Burchette

- has issue probably - no details avail

Δ D. (Twin) Lettie Marie Gooding

Δ and John Fry and in Los Angeles

① - CONTINUED

D.V. 32678 (Elloyd Freeman Gooding)

Alvarado, TX Johnson Co, TX - There are a lot
of U's there

Ed was in Belgium in WWII when he got word
of his youngest sibling's birth. Ed returned to TX and
worked for a time then went into law enforcement
work in TX. He was eventually a TX ranger. He
is now retired and has a health condition. He
is also the caregiver for his wife who has had
a stroke. He has a great interest in family history
and has hired someone to do work for him
since he cannot travel.

② 29 SEP 1995 EDGAR called & we talked and then I (RPW)
called him back and we talked some more.
Today he plans to visit the area of Alvarado
in Johnson Co, TX to learn more about
Wynch connections in that area. He says
there are quite a few there. His phone no
= 817-641-3574. RPW could not locate U's in
Johnson Co, TX in 1910 TX census or in 1880
Texas census. Ed reports that Summer is
in Lamar Co, TX

③ 16 OCT 1995 Called EDGAR to thank him for his letter of
11 OCT 95 which arrived today & to report that this group
of U's living in eastern Johnson Co, TX are of the Richard
U, III / Dalton U subline - Richard U, IV line. I will send

③ - CONTINUED

Ed a more detailed report later. Ed says that Steve Ballard has excellent records and is researching the Upchurch family. Kenneth Odell U has a large amount of information in his head and can recite dates of birth, etc. Ed noted that Ken's yard at his home has become a junkyard.

I told Ed our TX Trip has been reprogrammed for next spring. I discussed the prospects of a meeting in the Dallas/Ft Worth area. He wants to come.

④ 24 OCT 1995 - RPA called EGG

Δ + Δ The Kenneth U from whom Edgar got information Δ + Δ recently was Kenneth Odell U, Sr. He is the one Δ who uses his carport and driveway to store Δ various materials that have accumulated. Kenneth, Sr Δ has issue from his 1st wife (Ruby Lou Nell Cooper) but Δ not from his 2nd wife (Eppie Delight Cheuron). Δ Eppie Delight Cheuron was b. Lone, WA according to - some source but in fact may have been born Δ + Δ in Canada when her mother went across - the border for a brief visit.

⑤ 20 NOV 1995 - RPA called EDG and thanked him for recent letters. They will be processed sometime after Thanksgiving. Told him I have 4 1995 UB issues in mail to him & will put him on 1996 galio He appreciated that. I spent to send him \$50

⑤ - CONTINUED.

To help pay for gas/phone. He said that was not necessary. He is glad to help.

He visited Kenneth Odell U in AM and found him well into his first 6 pack of the day. He says Kenneth is an alcoholic. Kenneth says he was always told his father was R.L. U (initials only - as opposed to Richard Lawrence U, Jr.).

He has info from Marion Frances U line. There were 6 children. Mrs. Buford Jean of Hillsboro, TX included. Her brother was named - Harry, Marion, Robert ~~Na~~ U - Robert named (named by Ed) "Hal".

Hal wants info. His daughter Mary K. Sullivan of Floreana, TX has written info & will share. Hal wants an amount Ed \$15.

Ed will check his sister re using her church for MAR/APR U church behind in West Ft Worth, TX near I-20. She has been there 30 years, he will check.

We discussed the Lyndon Johnson book. Ed met Cole Steensen & also Frank Hamer. He said 2/3rd of Ranger resigned when Ma Ferguson took over as Governor.

⑥ 15 JAN 1996 - called EDGAR & told him I had caught up on processing his letters & thanked him for them. He will try to work with Tarrant Co Hist Soc for a place to hold letters & will get back to me. For Librarian he suggests Cleburne, Hillsboro & Ft Worth.

⑦ 19 FEB 1996

Called EDGAR and thanked him for his letter of 29 JAN 1996. Told him arrangements have been made for a lecture in Ft Worth, TX. He will not come because he does not like to drive in traffic or at night. We agreed, tentatively, to spend TUE 9 APR 1996 together. He suggests a motel/restaurant near his place. I suggested Pluto, TX as a possible burial site for Kenyon Bannan U. He will look into this.

⑧ 23 FEB 96 - Called Ed - He says the Pluto Cem Marker for Kenyon Bannan U has just K. B. Upchurch & the date he reported. For Jennie the stone has Jennie L., wife of J. H. Powers, dau of W. A. U & R. J. U. Ed will get the Johnson Co, TX motel name & phone no & call me. It is on east side of I 35 south of Barberon, TX

Ed called back - Says the Restaurant & motel is "Bill & Marty's Famous Seafood" at 2701 I-35 W
Phone (817) 447-1277

⑨ 11 MAR 96. Talked to Ed. Arranged to meet him for breakfast at 7:30 AM on TUE 9 APR 1996. He has heard from Rudy U. He has talked to Kenneth Odell U again.

EDGAR DALTON GOODING

XI 7-35516

REC'D
23 FEB 1996

Edgar D. Gooding
900 Ivanhoe
Cleburne, Texas 76031

Dear Cousin Robert,

Feb 20, 1996

After our phone conversation last evening my curiosity went wild. This morning I decided to do something about it. I saddled up early and went to Itasca. From there I learned directions to the Pluto community. There are two cemeteries there but the first one I checked out yielded nothing. All the markers were dated after 1900. I obtained directions to the second and hit pay dirt. This is a very old cemetery and has been abandoned. It is grown up in brush and trees and is on the banks of a creek. I was told it floods frequently. I talked with a Mr. Cockerham who lives near this cemetery. [This is the same name as your number 10063] He did not know of any relative ever marrying an Upchurch. He is not into family research however and I may have opened another can of worms. She was the wife of James Everett Upchurch Sr. b. 11 Sept 1893, your number 10055.

Back to the Pluto cemetery. I found the marker for Kenyon Brannon Upchurch b. 3 May 1839 d. 7 Dec 1893 Husband of M.S. Upchurch but there was no marker for her, exactly. At the foot of K.B.s marker was another marker marked Sarah M. Upchurch b. 27 Aug 1829 d. 22 Feb 1894. These dates do not correspond with your biofile for the wife of Kenyon Brannon Upchurch. The initials are also backwards and the marker is at the foot of K.B. and not by side. Also in the same area is a marker R.E. Upchurch b 1854 d. 1897. Nothing else. Also in the same area is a marker Jennie L. Upchurch wife of J. H. Powers, daughter of W.A. & R.J. Upchurch, b. 1869 d. 1893. These were not in a family plot as such but all were in the same area with no markers between. I checked all the headstones in this cemetery that are visible and there were no more Upchurch.

This cemetery and the Pluto community is in Ellis county by about a mile or so. It is just off F.M. Roads 934 & 66 between Itasca and Maypearl. I am enclosing a rough sketch of the area which should give you a general idea where The Pluto community lies. My Atlas shows a F.M. Road 916 but it runs from Grandview to Maypearl. 934 runs directly through the middle of Itasca.

I hope this is a big a relief to you as it is to me. Kenyon Brannon Upchurch has bugged me ever since you told me you were trying to locate his burial site. I suppose 25 years as a Texas Ranger instilled in me the inability to give up. Now, like the ancient mathematician Pythagoras I can exclaim EUREKA!!!

Ed

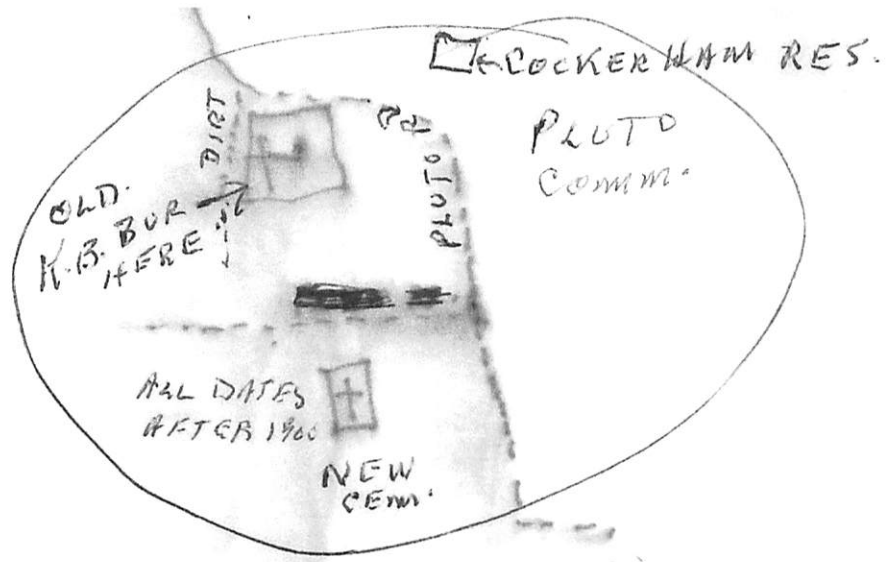

ELLIS COUNTY LINE (APPROX)
 HILL

GRAVEL RD

TO MAYPEARL
 904

TURNER CEM.
 (ALL TURNERS)

TURNER CEM

TURNER

926

TURNER

PLUTO CEM - ELLES CO, TX

Report of Edgar Dalton Gooding
who inspected the cemetery
on 20 FEB 1996 (REC'D 23 FEB 1996-R)

DETAILS ON MARKERS:

Δ 1. KENYON BRANNON U

h 3 MAY 1839 & 7 DEC 1893

Δ 2. SARAH M. U h 27 AUG 1829

& 22 FEB 1899

Δ 3. R. E. U h 1854 & 1897

Δ 4. JENNIE L. U h 1869 [GINNY LUEVENYER U]

& 1893 [WIFE OF

Δ 5. J.N. POWERS]

Δ 6. DAU OF W. A. U & → [WILLIAM HENRY U, I]

Δ 7. R. J. U [RHODA JANE LAYTON]

I. Richard U, III - Head of clan

A. Calvin U, I.

1. Richard U, IV

→ a. Kenyon Brannon U,

b. William Henry U, I

→ md Rhoda Jane Layton

→ i. Ginny Luevenyer U
"Jennie"

[Note: From this we learn that "Jennie md J.H. Powers
The identity of #2 and #3 is not yet known - RPU)

[Called Ed 23 FEB 1996 - He says the marker for Kenyon
Brannon U reads simply K. B. Uchuck with the
dates shown as slightly different from my records
For Jennie the marker reads "Jennie L.; wife
of J. H. Powers, dau of W. A. U and R. J. U.

EDGAR DALTON GOODING

XII-35516

REC'D
28 AVE 1995

Edgar D. Gooding
900 Ivanhoe
Cleburne, Texas 76031

Mr. Robert P. Upchurch
P. O. Box 337
Wentzville, Missouri

Sir:

△+□ In reference to our telephone conversation the latter part of 1994 regarding the family of Theodosia Ernestine Upchurch. She was the daughter of Henry Alvin Upchurch and married William Harvey Gooding in Wayne County Kentucky and was my grandmother. If you remember I gave you a rundown on her family to the great-grandchildren. It was my understanding that in turn you were to send me the Upchurch lineage back to the first Michael Upchurch that came to the New World in about 1620 or so.

△+△ I realize from your letter of 29 Nov 94 that you were in the process of moving from Arizona to Lake St. Louis, Missouri and probably have not gotten your records straight as yet. I have not given up on you. I lost my beloved wife of 44 years in February of 1995 and also lost interest in just about every thing else. Needless to say the research stopped along with everything else in my life for the longest time. I finally made up my mind it was not going to get any better and we must go on as bad as it hurts. The emptiness will remain along with the survivors guilt feelings but we have to live with those.

→ (LENA
RICHARD-
SON)

I hope you and your family are enjoying your new home. From your letter I gathered that you were well pleased with it at the time you wrote the letter. I hope to hear from you soon. Until then I remain,

Sincerely yours

Ed

Edgar D. Gooding
900 Ivanhoe
Cleburne, Texas 76031

P.S. I have no idea what the postage will be but I will send you the amount by return mail.

MICHAEL ENTERPRISES
P. O. BOX 35804
TUCSON, ARIZONA 85740



Dear Ed

The complications of moving from Arizona to Missouri have finally caught up with us. It is not uncommon for me to run 4 - 8 weeks behind in processing genealogical information but I can see that this is going to get worse before it gets better. We are well pleased with our new home in Lake St. Louis, MO, to which we took title on 31 AUG 94. Our household goods and genealogical records will be shipped to MO in mid-September but I will not be there full time until mid-November. Both Sallaine and I will be back and forth some. I am sending this message to let you know that I have a letter from you on family history that remains unprocessed. It is deeply appreciated and I WILL get to it in due course.

Until November 1, 1994, you can continue to write to me at the above address. Items mailed November 1 or after should be addressed to me at:

R. P. Upchurch
MICHAEL ENTERPRISES
P. O. Box 387
Wentzville, MO 63385

29 NOV 94

Thank you for your patience.

Ed - our stay in Tucson was extended some - but on 1 DEC 94 we leave to drive to MO for good. For the last 3

Sincerely yours,
Robert P. Upchurch, Editor
UPCHURCH BULLETIN

^{RPU:s} months we have mostly been living in an apartment in Tucson with our "stuff" in our new home in MO. Your excellent letter arrived 7 NOV 94. I'll get to a more proper response in due course. In the meantime - don't give up on me.
Phil Upchurch

EDGAR DALTON GOODING

XID-35516

Sept 4, 1994
Edgar L. Gooding
900 Ivanhoe
Cleburne, Texas 76031

REC'D
7 NOV 1994

↑

□ Robert Phillip Upchurch
— Michael Enterprises
— P. O. Box 35804
— Tucson, Arizona 85704

PM FORT WORTH, TX

— Sir:

□ + □ I would like to work a little horse trade with you. I am enclosing a
+ □ Family Group Sheet for Will Gooding and Theodosia Upchurch. She was my
□ + □ grandmother. I am the son of John Edgar Gooding and Nellie Elza Winslett.

□ + □ + □ I wrote to Lewis Upchurch in Clearwater, Florida. He forwarded my request
□ + □ to Ervin Upchurch of White Bluff, Tennessee who in turn referred me to
□ + □ you. Ervin said you have the most complete collection of Upchurch history
□ + □ in existence. You may have the information enclosed on Theodosia Upchurch.
— If not and you consider this information important enough I would like
□ + □ to swap for a Family Group Sheet on Michael Upchurch, father of George
□ + □ Upchurch. I have an excerpt from a book by Ada Morgan that gives the
□ + □ family of George Upchurch and Rachel Bethshares. It does not give the
— date and place of birth for either one or the date and place of marriage.
— Neither does it give the date nor place of death and burial. This
□ information would be greatly appreciated. It does give his 7 children.

THEODOSIA ERNESTINE U

Δ + Δ I met Ballinger Upchurch and Dica Huddleston Upchurch, the younger brother
Δ + Δ of my grandmother, in Austin, Texas in the 1950s. They were in their 70s
— at that time but you could still see the frame of a very large and stout
Δ man in him. Dica smoked a corncob pipe but had a petite porcelain pipe
A + A + A + A she smoked when in public places. She was a character. They lived in
Δ Coos Bay, Oregon at the time and he had retired from the lumber business.
Δ + □ Grandmother died a few years after that meeting. At the time I was a
Δ State Trooper with the state of Texas and arranged for an escort for her
Δ + Δ to Uvalde where she was buried beside Will Gooding.

COPIED FOR BALLINGER & DICA

— The following is their life together as told to me by Will Gooding in
Δ + Δ the late 1930s while he and my father were farming together in Aransas
Δ + Δ Pass, Texas: Will Gooding asked for the hand of Theodosia of Henry Alvin
Δ + Δ Upchurch but was refused. The two later eloped and were married. When
Δ + Δ Henry learned of this he came after Will armed. They learned of this and
Δ + Δ fled to what was then Fentress County, Tennessee where they remained
Δ + Δ until Henry cooled off. He never spoke to his daughter after that time.

JOHN EDGAR GOODING

COPIED FOR HENRY ALVIN U

— About 1895 several members of the Gooding family headed West. The first
Δ + Δ two daughters were born in Wayne County. They settled in Caldwell County
Δ + Δ Missouri after four months travel by wagon. Their third child was born
Δ in Caldwell County. They moved on to Greely County, Kansas where Will and
Δ + Δ his father obtained land and built homes. Will's mother died in Greely
Δ + Δ County. She was Rebecca Chrisman d/o Harvey Chrisman of Wayne County.

OF WILL & THEODOSIA

[LINE]

COPIED FOR WILL & THEODOSIA

Family Group Record

Write places as: Eng. or St. Martins, Birmingham, Warwick, Tryon, Pulk, NC
 Write date as: Christian Joseph STEVENSON 5 Aug 1988

Husband's name		William Harvey GOODING		SOURCES OF INFORMATION
Born	8 June 1868	Place	Mount Pisgah, Wayne Co. KY	Family Bible of
Chr.		Place		May Williams, dau
Mar.	5 Jan 1889	Place	Wayne Co. KY	of Will and Theod
Died	11 Aug 1941	Place	Blewitt, Uvalde Co. TX	dosia Gooding
Bur.	14 Aug 1941	Place	Uvalde, Uvalde Co. TX	
Father	John M. Gooding		Mother	Rebecca Chrisman
Husband's other wives	None			
Wife's name		Theodosia Ernestine UPCHURCH		
Born	9 Apr 1874	Place	Monticello, Wayne Co., KY	Same and
Chr.		Place		LDS library, Salt
Died	22 Aug 1955	Place	Austin, Travis Co. TX	Lake City, Utah
Bur.	27 Aug 1955	Place	Uvalde, Uvalde Co., TX	
Father	Henry Alvin UPCHURCH		Mother	Susannah Hurt
Wife's other husbands	None			
Children List each child (whether living or dead) in order of birth				
1 Sex	Name	Spouse		
F	Susie May Gooding	Sam Williams		
Born	21 Jul 1891	Place	Mt Pisgah, Wayne Co., KY	Same
Chr.		Place		
Mar.	9 July 1915	Place	Knippa, Uvalde Co., TX	
Died	5 May 1984	Place	Austin, Travis Co., TX	
2 Sex	Name	Spouse		
F	Mary Wilmurth Gooding	Edgar Nicely		
Born	11 June 1893	Place	Mt Pisgah, Wayne Co., KY	Same
Chr.		Place		
Mar.	13 Aug 1917	Place	Austin, Travis Co., Texas	VS W WHITEWRIGHT, TX
Died	21 May 1941	Place	Whitewright, Grayson Co., TX	VS FANNIN CO [BUTLER]
3 Sex	Name	Spouse		
F	Sally Ora Gooding	Joseph Abner Butler		
Born	14 Apr 1897	Place	Polo, Caldwell Co., Missouri	Same
Chr.		Place		
Mar.	5 Jan 1916	Place	Uvalde, Uvalde Co., TX	VS UVALDE VS SAEIDA, MEDINA CO, TX
Died	14 Sept 1950	Place	Blewitt, Uvalde Co., TX	
4 Sex	Name	Spouse		
M	John Edgar Gooding	Nellie Alza Winslett		
Born	5 Nov 1902	Place	Horace, Greely Co., Kansas	Same Bible
Chr.		Place		
Mar.	20 Jan 1923	Place	Ingleside, San Patricio Co., TX	
Died	29 Sept 1983	Place	Fort Worth, Tarrant Co., TX	
5 Sex	Name	Spouse		
M	Water Eugene Gooding	Camelia Mitchell		
Born	14 Dec 1908	Place	Uvalde, Uvalde Co., TX	Family Bible
Chr.		Place		
Mar.	3 April 1937	Place	Austin, Travis Co., TX	
Died	10 Dec 1978	Place	Austin, Travis Co., TX	
Other marriages and necessary explanations				

EDGAR DALTON GOODING

XID-35516

Edgar D. Gooding
900 Ivanhoe
Cleburne, Texas 76031

REC'D
16 NOV 1995

Dear Cousin Robert,

Nov 13

It gripes me no end to send a report like I am sending you but this is the best I can do with these people. Getting into the grandchildren of the different families you get into the newer generation and they have married, divorced, remarried, moved and have made it just about impossible to run the FAMILY lines any further down than I have done. I realize they are lacking details on top of details but you are dealing with people that are not interested in the least in family history and most of those I have contacted seem to be doing good to make ends meet from day to day. They seem to be the poorest of the poor and there is a definite disinterest in family records. They are scattered from hell to breakfast and it would take a ream of paper and at least a year investigation to run all the ex's to ground. I wish I could fill in more blanks for you but what I am sending is the absolute total of what I could learn.

There is no written record except at the court house here and it only has marriage records. Birth and death records are not open to the general public as yet. I have scoured the libraries in Alvarado, Grandview and Hillsboro and have just about worn out a pair of sneakers walking cemeteries in tow counties. I still hope to hear from the researcher in Hillsboro on the burial place of Kenyon Brannon Upchurch. Kenneth Odell Upchurch said Kenyon was a brother to his grandfather, Richard Lawrence SR., but had no idea where he was buried. I am waiting on him to get in touch with his children and learn who they married and his grandchildren. Some of his children he has not seen in over ten years. He knows where they were the 1st time he heard but that is all. We will see how that turns out.

I am sending along a family sheet on James Leslie Daugherty who married Dorothy Jean Upchurch. The family members think he lives somewhere in Fort Worth but are not sure. It goes with the family of Will Rogers Upchurch family. I received it after sending the other family sheets on Will's family.

I have not heard from Doshia Neal as yet but will send you the information as soon as she gets it to me. Neither have I been able to reach Kristi and Tab Randolph. I have their number but they both work and at their age stay home very little. Whatever information I get I will forward it to you. I have a meeting set with Steve Bullard tonight and will get the missing details on his lineage. There is not much else I can do down here but will keep my ear to the ground for more information.

Sincerely,



Family Group Record

Write date as: 5 Aug 1988
Write places as: Tryon, Full, NC or St. Martins, Birmingham, Warwick, Eng

Husband's name		<i>James Leslie Daugherty</i>		SOURCES OF INFORMATION
Born	5 Jul 1940	Place	Fort Worth Tarrant Co.	
Chr.		Place		<i>Janis Adelle Upchurch mother of Dorothy</i>
Mar.	12 Aug 1958	Place	Kennedale Tarrant Co. TX	
Died		Place		
Bur.		Place		
Father		Mother		
Husband's other wives <i>none</i>				
Wife's name		<i>Dorothy Jean Upchurch</i>		
Born	26 Dec 1950	Place	Chelmsford Johnson Co. TX	
Chr.		Place		
Died		Place		
Bur.		Place		
Father	<i>W. Eld Rogers Upchurch</i>	Mother	<i>Janis Adelle Poje</i>	
Wife's other husbands <i>none</i>				
Children List each child (whether living or dead) in order of birth				
1 Sex	<i>F</i>	Name	<i>Rena Daugherty</i>	Spouse
Born	10 Aug 1960	Place	FT Worth	<i>Marj B. FT Worth Cynthia Garrison</i>
Chr.		Place		
Mar.		Place	<i>Mansfield</i>	<i>1. Christian - Cynthia Garrison 2. Richard Allen Daugherty Dorothy</i>
Died		Place		<i>Josie Garrison Nussell</i>
2 Sex	<i>M</i>	Name	<i>Floyd Allen Daugh</i>	Spouse
Born	10 July 19	Place	FT Worth	<i>--</i>
Chr.		Place		
Mar.		Place	<i>no further issue</i>	
Died		Place		
3 Sex	<i>X</i>	Name		Spouse
Born		Place	<i>no further issue</i>	
Chr.		Place		
Mar.		Place		
Died		Place		
4 Sex		Name		Spouse
Born		Place		
Chr.		Place		
Mar.		Place		
Died		Place		
5 Sex		Name		Spouse
Born		Place		
Chr.		Place		
Mar.		Place		
Died		Place		
Other marriages and necessary explanations				

14 WILMA LOUISE UPCHURCH CONTINUED.

- Δ 3. DONNIE LEE BARROW B. 25 AUG 1948 (CLEBURNE JOHNSON CO. TX) LIVING
- Δ M. TOMMY BRYAN JOHNSTON B. 25 JAN 1948 (CLEBURNE JOHNSON CO. TX LIVING)
- Δ 3 MAR 1964 (CLEBURNE JOHNSON CO TX) (LIVING)
- Δ a. ROBERT BRYAN JOHNSTON - B. 3 AUG 1965 (CLEBURNE JOHNSON CO. TX) LIVING
- Δ b. COURTNEY ROCHELLE JOHNSTON - B. 8 AUG 1967 (CLEBURNE, JOHNSON CO. TX) LIVING
- Δ c. MELONY CHARISE JOHNSTON - B. 28 JUNE 1969 (CLEBURNE, JOHNSON CO. TX) LIVING
- Δ 4 BILLY HOWARD BARROW B. 30 JUNE 1950 (FT WORTH-TARRANT CO. TX) LIVING
- Δ M. PEGGY JEAN CAVITT B. 20 OCT 1953 (CLEBURNE JOHNSON CO. TX) (LIVING)
- Δ 1 JAN 1969 (CLEBURNE JOHNSON CO. TX) LIVING.
- Δ a. BILLY DARREN BARROW B. 10 JUNE 1970 (CLEBURNE JOHNSON CO. TX) (LIVING)
- Δ b. JASON SCOTT BARROW B. 1 JAN 1972 (CLEBURNE JOHNSON CO. TX) (LIVING)
- Δ c. RHONDA JEAN BARROW. B. 20 JAN 1974 (CLEBURNE JOHNSON CO. TX) (LIVING)
- Δ NO FURTHER ISSUE

#3

□
-
△
-
□
△
-
↓

DESCENDANTS OF JOSEPH ALBERT UPCURCH.

CANCER

G. JOSEPH THOMAS UPCURCH B. 10 APR 1929 (JOHNSON CO. TX) D. 18 AUG 1992 -
~~FT WORTH TARRANT CO. TX~~ BUR. ~~SAME~~ (TYE CEM. BURLISON JOHNSON CO TX)
 M. MARY [] (MARRIED SEVERAL MORE TIMES)
 & TOMMIE LEE UPCURCH B [] (LIVES FT WORTH) (PHONE UNLISTED)

~~DESCENDANTS OF ANDERSON BRACE UPCHURCH~~

DESCENDANTS OF JOSEPH ALBERT UPCHURCH

- WILL ROGERS UPCHURCH B. 2 MAR 1931 (CLEBURNE JOHNSON CO. TX) LIVING
- M. JANIE ADELE POPE BOBMAN 1934 (ALVARADO JOHNSON CO. TX) LIVING
- 15 DEC 1949 (CLEBURNE JOHNSON CO. TX)
- Δ a. DOROTHY JEAN UPCHURCH B. 26 DEC 1950 (CLEBURNE JOHNSON CO. TX) ^{LIVING}
- Δ M. JAMES DAUGHERTY B. 12 AUG 1953 (CLEBURNE JOHNSON CO. TX) LIVING
- 12 AUG 1970 (KENNE DALE, TARRANT CO. TX)
- Δ b. HENRY JOE UPCHURCH B. 3 FEB 1953 (CLEBURNE JOHNSON CO. TX) LIVING
- M. Danna LOUISE () 16 NOV 1971 (ALVARADO JOHNSON CO. TX) LIVING
- Δ c. ROGER DEAN UPCHURCH B. 2 APR 1955 (CLEBURNE JOHNSON CO. TX) LIVING
- M. LISA ANN VASSAR 12 AUG 1975 (WEATHER FORD, PARKER CO. TX) LIVING
- Δ d. WILMA LOUISE UPCHURCH B. 10 DEC 1956 (CLEBURNE JOHNSON CO. TX) LIVING
- M. LEONARD EARL O'PRY (FT WORTH, TARRANT CO. TX) 2 FEB 1976 LIVING
- Δ e. LILLIE LOUELLA UPCHURCH B. 1 MAY 1960 (CLEBURNE, JOHNSON CO. TX) LIVING
- M. CURTIS LYNN ERWIN 5 NOV 1976 (CLEBURNE JOHNSON CO. TX) LIVING
- ~~NO FURTHER ISSUE~~
- Δ f. JOHN PAUL UPCHURCH B. 19 NOV 1963 (CLEBURNE JOHNSON CO. TX) LIVING
- M. PATRICIA LEONA SANDERS B. () 8 JAN 1982 (WILLOW SPRINGS JOHNSON CO. TX) 8 JAN 1982
- Δ g. DAVID WAYNE UPCHURCH B. 8 JAN 1946 (CLEBURNE JOHNSON CO. TX) LIVING
- M. RHONDA RAYE HENRY B. () 31 OCT 1991 (GRANDVIEW, JOHNSON CO. TX)

↓

DESCENDANTS OF JOSEPH ALBERT UPCHURCH (CONT)

5. □

Δ E. ARLETTA JOE UPCHURCH B. 6 MAR 1933 (JOHNSON CO. TX) (LIVING)
Δ M. MORRIS CALVIN MCLAUGHLIN ()

Δ A. RAE NELL MCLAUGHLIN B. (

) (DALLAS CO. TX)

Δ+Δ B. LOU LAINE MCLAUGHLIN B. (

) DALLAS CO, TX) M. (

- } ALLEN DAVIS

Δ+□ C. DIXIE LEE MCLAUGHLIN B. (

) DALLAS CO, TX) M. (

} BILLONE

↓

MEMORANDUM OF JOSE ALBERT UPCHURCH (CONT)

- 6 □
- Δ F. CECIL DEAN UPCHURCH B. 8 APR 1935 (JOHNSON CO, TX) D. 1972 (NOBENTON, GEORGIA. INDUSTRIAL ACCIDENT. BUR. SAME.
-
- Δ M. (#1) BARBARA JEAN MC CLOUD B. () (FARMERSVILLE COLLIN CO, TX).
- Δ M. (#2) MAURALEE ROWDEN B. () ()
-
- Δ + Δ a CECIL DEAN UPCHURCH JR. (MOTHER WAS BARBARA JEAN MC CLOUD)
- Δ + Δ b VICKI LYNN UPCHURCH (MOTHER WAS MAURALEE ROWDEN)
- Δ + Δ c. Janette UPCHURCH (" " " " ")
- Δ + Δ d Sandy UPCHURCH (" " " " ")



DESCENDANTS OF JOSEPH ALBERT UPMURCH.

6. SALLY MARCELE UPMURCH B. 19 SEP 1939 (CLEBURNE JOHNSON CO. TX) LIVING
M. THOMAS GARZA GONZALES B. 13 JAN 1938 (COVINGTON, JOHNSON CO. TX) LIVING.
25 NOV 1959 (WAXAHARIE, ELLIS CO. TX) LIVING.

1. SHERA LOUISE GONZALES B. 5 FEB 1968 (CLEBURNE JOHNSON CO. TX) LIVING
M. WESLEY DEAN PARKER BC) (CLEBURNE JOHNSON CO. TX)
a. APRIL LYNN PARKER
b. CLAD BRYAN PARKER

NO FURTHER ISSUE

2. BONNIE JEAN GONZALES B. 19 JUN 1959 (CLEBURNE JOHNSON CO. TX) LIVING

~~M. MISTY JEAN~~
M. DANNY MASON FARRINGTON BC)
a. MISTY JEAN FARRINGTON
b. SHANNON MASON FARRINGTON

NO FURTHER ISSUE

3. KAREN SUE GONZALES B. 4 NOV 1960 (JOHNSON CO. TX) M. ED MIHELLOVETS
a. HEATHER MIHELLOVETS

ED 12 APR 1992 (MIDLOTHIAN) (BUR ALVARADO, TX)

4. LANA GONZALES B. 1 JUN 1961 (JOHNSON CO. TX) M. JEFFERY DABREL VIE (JOS)
a. NO ISSUE.

5. THOMAS GARZA GONZALES JR. B. 23 AUG 1962 (JOHNSON CO.) NOT MARRIED
a. THOMAS LEE GONZALES
b. CODY JOHN WAYNE GONZALES

NO FURTHER ISSUE.

↓

DESCENDANTS OF JOSEPH UPCHURCH (cont)

8

□
|
Δ
-
Δ
-
Δ
A
-
-
↓

H. FRANK ANDERSON UPCHURCH B. 8 JUL 1947 (JOHNSON CO. TX) D. 23 MAY 1972
(ALVARADO, JOHNSON CO. TX) Bur. SAME. (CANCER)
M. JANICE DAWN GREENE B ()

a. TODD JOSEPH UPCHURCH
b. TINA MARIE UPCHURCH
c. NO FURTHER ISSUE

MISSING DETAILS ON THE FAMILY OF 20 OCT 1995
SUSIE MAY (GOODING) WILLIAMS

- 1) For Herman Meldon Williams
 - a) when was he born?
 - b) still living?
 - c) Did he have just one child?
 - d) when and where did he marry?
 - e) For Dixie Dorsett
 - i) what is her full maiden name?
 - ii) when and where born?
 - iii) still living?
 - f) For Stanley Meldon Williams
 - i) when and where did he marry?
 - ii) Did he have just three children?
 - iii) Did Michelle Rena Williams marry/have issue?
If so, details?
 - iv) Full maiden name of Lorelba Wilber and
when and where was she born?
- 2) For Gilbert Moses Williams
 - a) when in 1914 was he born?
 - b) still living?
 - c) when and where did he marry?
 - d) Does he have any children? If so, details?
 - e) what is the full maiden name of Abbie
Grosenbeck and when and where was she
born? Is she still living?
 - 3) For Samuel Moses Williams
 - a) Did he die 6 MAR 1948 or 5 MAR 1948?

MISSING DETAILS ON THE FAMILY 2 OCT 1995
OF MARY WILMERTH (GOODING) NICELY

- 1) For Edgar Webster Nicely
 - a) where was he born?
 - b) still living?
 - c) when and where did he marry?
 - d) For one Scott Kennedy
 - i) when & where was he born?
 - ii) still single?
- 2) For Orville Lee Nicely
 - a) still living?
 - b) when and where married?
 - c) Did he have only two children?
 - d) For Rutha Chesser
 - i) Full maiden name?
 - ii) when & where born?
 - iii) still living?
 - e) where was Rodney Lee Nicely born?
 - f) where was Kristi Lee Ann Nicely born?
- 3) For Christine Nicely
 - a) what is her full maiden name?
 - b) where was she born? still living?
 - c) when and where did she marry?
 - d) For Leslie Leon Boyd
 - i) when and where was he born?
 - ii) still living?
- 4) For Jack Nicely
 - a) what was his full name?
 - b) where did he die?
 - c) where is he buried?

-2-

MARY WILMERTH (GOODING) NICELY - CONTINUED

5) For Joe Frank Nicely

a) where was he born?

b) still living?

c) when and where did he marry?

d) Did he have only few children?

2) For Mary Muller

i) what is her full maiden name?

ii) when & where was she born?

iii) still living?

6) For Donna Betty Nicely

i) when and where did she marry?

ii) when & where was Carl Ray Cox born?

iii) Did she have children? If so, details?

7) For Kenneth Joe Nicely

i) where was he born?

ii) where did he die?

iii) when is he buried?

8) For Carla Renee Nicely

i) where was she born?

ii) when & where did she marry?

iii) when & where was Gary Delane Patton born?

iv) Did she have children? If so, details?

i) For Eddie Randall Nicely

i) where was he born?

ii) when & where did he marry?

iii) when and where was Polly Ann Cannon born?

iv) Did she have children? If so, details?

MISSING DETAILS ON THE FAMILY 2 OCT 1995
OF SALLIE ORA (GOODING) BUTTLER

- 1) For Robert Joseph Butler
 - a) when in 1918 was he born?
 - b) when in 1919 did he die?
- 2) For Hattie Dossia Butler
 - a) still living?
 - b) Did she have just four children?
 - c) when and where did she marry the 1st, 2nd & 3rd times?
 - d) For Grant Payne
 - i) what is his full name?
 - ii) when & where was he born?
 - iii) still living?
 - e) For Henry Hattenhouse
 - i) what is his full name?
 - ii) when & where was he born?
 - iii) still living?
 - f) For Henry Wear
 - i) what is his full name?
 - ii) when & where was he born?
 - iii) still living?
 - g) For Mary Estelle Payne
 - i) when & where was she born?
 - ii) when and where did she marry?
 - iii) Did she have children? If so, details?
 - iv) Full name of mother of Larry & when & where born?
 - h) For Joe David Payne
 - i) when & where married?
 - ii) Did he have children? If so, details?
 - iii) when & where was Ma Mae Wiley born?
 - i) For Jonathan Grant Payne
 - i) where was he born? ii) when & where married?
 - iii) Did he have children? If so, details?
 - iv) Full maiden name of Alma Lopez & when & where born?
 - j) For Amy Lynne Hattenhouse
 - i) when & where born?
 - ii) Did she marry/have children? If so, details?
- 3) For William James Butler
 - a) when did he die?
 - b) where is he buried?

MISSING DETAILS ON THE FAMILY 2 OCT 1995
OF JOHN EDGAR GOODING

- 1) For John Edgar Gooding & wife - All OK
- 2) For Edgar Dalton Gooding
 - a) was your wife full maiden name ANGELENA RICHARDSON or did she have an additional first or middle name?
- 3) For Lema Laverne Gooding & Family - All OK
- 4) For Billy Joe Gooding - All OK
- 5) For Wanda Joyce Gooding
 - a) what is the full maiden name of Tammy Colston?
- 6) For Johnnie Jean Gooding & Family - All OK
- 7) For Edith Kay Gooding & Family - All OK

MISSING DETAILS ON THE FAMILY OF WALTER EUGENE GOODING 2 OCT 1995

- 1) For Walter Eugene Gooding
 - a) Did he marry 3 MAR 1937 or 3 APR 1937?
- 2) For Alena Mae Gooding
 - a) when and where did she marry?
 - b) Did she have any four children?
 - c) when & where was Vernon Ralph Gelling born?
 - d) Did any of her children marry? have issue? If so, details?
 - e) where was Joyce Marie Gelling born?
 - f) where was Cindy Lee Gelling born?
 - g) where was Carol Lee Gelling born?
- 3) For Clyde Eugene Gooding
 - a) where was he born?
 - b) when & where did he marry?
 - c) Full maiden name of Belores Ross & when & where was she born?
 - d) Details on his children?
- 4) For Lennie Paul Gooding
 - a) when and where did he marry?
 - b) Full maiden name of Annetta Burdette & when & where born?
 - c) Details on his children?
- 5) For Lettie Marie Gooding
 - a) when did she marry?
 - b) Full name of John Fry and when & where was he born?
 - c) Details on her children (if any)?

MISSING DETAILS ON THE FAMILY
OF FLOYD FREEMAN GOODING

20 OCT 1995

- 1) For Floyd B. (NMN) Gooding, Sr
 - a) For Farley Brent Gooding
 - i) when in 1960 born?
 - ii) where born?
 - b) For Crystal Gayle Gooding
 - i) when in 1960 born?
 - ii) where born?
- 2) For Norma Jeann Gooding
 - a) was her 1st marriage 1 NOV 1958 or 11 JAN 1958?
 - b) was her 2nd marriage 1 NOV 1965 or 23 DEC 1966?
 - c) was her 3rd marriage 17 MAY 1977 or 5 JUN 1969?
 - d) Is Maxie Edward Brune still
 - e) For the five sons of Bill Boyk Daniels
 - i) where were each of the five born?
 - ii) Did they marry / have issue? If so, details?
 - f) For Barbara Louise Wallace
 - i) was her 1st marriage 10 AUG 1978 or 20 APR 1978?
 - ii) I show 2nd marriage 19 JUN 1978 - seems wrong ???
 - iii) For Gustav Faust Fritziuf
 - (I) when in 1953 was he born?
 - (II) where was he born?
 - iv) For D. A. Gaudreil
 - (I) what is his full name?
 - (II) when and where was he born?
 - v) where were each of her six children born?
 - g) For Kimberly Dawn Brune
 - i) where was she born?
 - ii) where did she marry?
 - iii) when and where was Alan Dale Schneider born?
 - iv) did she have any children? If so, details?

EDGAR DALTON GOODING

XIA-35576

REC'D
20 SEP 1995

EDGAR D. GOODING
900 IVANHOE
CLEBURNE, TX 76031

Robert Phillip Upchurch
Wentzville, MO

Dear Robert,

First let me thank you for the wealth of information you sent me on the Upchurch clan. I have been mulling over the missing details you requested - trying to determine the best format to reply. Hope this form works.

- 1) For John Edgar Gooding
 - a) where buried? Forest Oaks Cemetery, Oak Hill, Travis County, TX
 - b) number of children? six (6) only. (Since I wrote you I have seen their marriage license. They were married
 - c) for Nellie Elza Winslett
 - 1) where born: Tucumcari, Quay County, New Mexico./in Rockport, Aransas Co. TX)
 - 11) where she died? At home in Austin, Travis County, Texas
 - 111) where buried? Forest Oaks Cemetery, Austin, Travis County, TX

Correction

- 2) For Edgar Dalton Gooding
 - a) where born? Ingleside, San Patricio Co., TX
 - b) when born? July 10, 1924
 - c) where married? Hempstead, Waller Co., TX
 - d) when married? September 8, 1950
 - e) For Lena Richardson
 - 1) full maiden name? Angelena Richardson
 - 11) when born? 3 February, 1918
 - 111) where born? Elmore City, Garvin Co., Oklahoma
 - 1V) when she died? 20 February, 1995
 - V) where she died? Huguley Hospital, Fort Worth, Tarrant Co., TX
 - VI) where buried? Greenacres Memorial Cemetery, Cleburne, Johnson Co., TX. (Masonic section)

- 3) For Loma Laverne Gooding
 - a) when she married? 20 Aug 1952
 - b) where married? Las Vegas, Clark Co., Nevada
 - c) how many children? two (2)
 - d) Any Grandchildren? No
 - e) For Perry Quinlan Turner
 - 1) when was he born? 25 March 1924
 - 11) where was he born? Sulphur Springs, Hopkins Co., TX

- 3) Loma Laverne Gooding - continued
 - f) For Rocky Quinlan Turner
 - 1) when & where he was born: 5 April 1954 - Houston, Harris Co., TX
 - 11) when & where married? 10 June 1974 - Fort Worth, Tarrant Co., TX
 - 111) full name of spouse? Gwendolyn Lee Lambert DANGERFIELD, CAMP CO, TX
 - 1V) when and where born: September 15, 1960 (DIVORCED - NO ISSUE)

- g) For Tamara Lynn Turner
 - 1) when & where born: 28 Dec 1956 - Fort Worth, Tarrant Co., TX
 - 11) when & where did she marry? 22 July 1980 - Fort Worth, Tarrant Co., TX
 - 111) full name of spouse & when & where born? Robert Allan Smith -b 22 July 1957 Fort Worth, Tarrant Co., TX

- 4) For Billy Joe Gooding
 - a) still living? Yes.

See Anible File for Bible of Theodosia Earnestine U

- △ 5) For Wanda Joyce Gooding
- a) when & where was she born? - 17 April 1932 - Aransas Pass, San Patricio Co. TX
 - b) when & where did she marry? 24 Sept 1954 - Austin, Travis County, TX.
 - c) did she have only two children? Yes only two (2)
 - △ d) For Susan Gayle Aberhart
 - I) when & where was she born? 14 Jan 1956 - Austin, Travis Co., TX
 - II) when & where married? 6 June 1981 - Austin, Travis County, TX
 - III) Only one (1) child
 - △ IV) when & where was Charles Odom Bernard born? 3 April 1946 - Austin, Travis Co
 - △ V) when & where Ashley Elizabeth Barbard born? 21 Jun 1988 Austin Travis Co., TX
 - △ e) For John Donald Aberhart
 - I) when & where was he born? 23 May 1963 - Austin, Travis Co., TX
 - II) when & where married? 12 Jan 1984 - Austin, Travis Co., TX
 - III) how many children? One (1)
 - △ IV) full name of spouse? Tammy Colston b. Dumas, Moore Co., TX 17 Dec 1962
 - △ V) when & where was Zachary Donald Aberhart born? 3 Jun 1989 - Austin Travis Co
- △ 6) For Johnnie Jean Gooding
- a) when & where was she born? 29 May 1934 - Aransas Pass, San Patricio Co., TX
 - b) when & where was she married? 7 May 1952 - Austin Travis Co., TX
 - c) how many children? Two (2)
 - △ d) when & where was Carroll Vester Taylor born? 4 Feb 1935 - Taylor Williamson Co (the origin of the name Vester is unknown. It was Carroll Taylor's father's name. Carroll Vester Taylor is a Baptist minister but came from a very dysfunctional family. His father left the family, remarried and moved to California.)
 - △ e) For Sharen Alison Taylor
 - I) when & where was she born? 17 Aug 1953 - Oakland, Alameda Co. Cal. Navy Hosp
 - II) when & where did she marry? 1 Sept 1971 - Georgetown, Williamson Co., TX
 - III) she had only two (2) children
 - △ IV) full name of her husband? Michael Wayne Bowers
 - V) when & where was he born? 31 Mar 1948 - Bristol, Washington Co., VA
 - △ VI) where was Cheyenne Cody Bowers born? Fort Worth, Tarrant Co., TX
 - △ f) For Randy Carroll Taylor
 - I) when & where was he born? 27 Jan 1957 - Fort Worth, Tarrant Co., TX
 - II) when & where was he married? 29 Sept 1979 - Fort Worth, Tarrant Co., TX
 - III) Had only four (4) children
 - △ IV) when & where was Bonnie Ann Wright born? 14 Mar 1960 - Rome, New York TX
 - △ V) where is Gabriel Scott Taylor buried? Westland Cemetery, Fort Worth, Tarrant
- △ 7) For Edith Kay Gooding
- a) when & where was she married? 29 Nov 1968 - Austin, Travis Co., TX
 - b) she had only two (2) children Co., TX
 - △ c) when & where was Sanford Nelson Williams born? 3 Jun 1947 - Hereford, Leaf Witt
 - △ d) For Arieti Kay Williams
 - I) where was she born? McCamey, Upton Co., TX Bexar, Co.,
 - II) when & where did she marry? 14 Nov 1992 - San Antonio, ~~Bexar~~, TX
 - III) she had only one child
 - △ IV) when & where was Quinton Lurough born? 24 Aug 1968 - Laramie Wyoming
 - △ V) where was Paige Kaitlyn born? Mission, Hidalgo Co., TX
 - △ e) For Shaun Nelson Williams
 - I) where was he born? Lovington, Lea co., New Mexico
 - II) marital status? still single but on a hot trail!!!!

Missing details on family of
Theodosia Ernestine Upchurch Gooding

Dear Robert,

- 1) for Theodosia Ernestine Upchurch
- a) Did she have only six children? Yes. Only six (6)
 - b) for William Harvey Gooding
 - 1) enclosed is copies of entries in the Bible of Theodosia Upchurch which will answer many question posed in your query. It indicates William Harvey was born in Parmleysville. Mount Pisgah and Parmleysville are only five miles apart and the family lived on a farm about half way between. These entries in her Bible are in her own hand. That Bible is now in possession of Norma Jean Daniell.
↳ [Mrs NORMA JEAN GOODING]
 - 2) where did he die? William Harvey Gooding died on the front porch of the home of Sally Ora Buttler, his daughter, at the Blewitt Mining Company about ten miles south of Blewitt, Texas in Uvalde Co., TX
↳ [Mrs SALLIE ORA GOODING]
- 2) for Susie M. Gooding
- a) is the M. for May or Mae? refer to Bible entry which indicates May.
 - b) did she die on 2 May 1984 or 5 May 1984? she died 5 May 1984
 - c) where is she buried.? Austin, Travis Co., TX
 - d) did she have just one child? No. She had two (2) Herman Weldon Williams and Gilbert Moses Williams.
 - e) for Samuel Moses Williams
 - 1) where was he born, died and buried? b. Knippa, Uvalde Co., Tx. died 5 Mar 1948 Austin, Travis Co., TX buried same.
- 3) for Mary W. Gooding Nicely
- a) is the W for Wilmerth or wilmurth? refer to Bible entry. indicates Wilmerth.
 - b) where is she buried. Whitewright, Fannin Co., TX
 - c) did she have just five children? Yes. Five (5) children
 - d) did she marry in Whitewright or Austin TX.? she married in Whitewright TX.
 - e) for Edgar Theodore Nicely
 - 1) where was he born, die and where buried? b. Kingston, Roane Co., Tennessee died on his farm near Whitesright 19 June 1966. buried Whitewright Fannin Co
- 4) for Sallie Ora Gooding
- a) is it Sallie or Sally? Refer Bible entry as Sallie.
 - b) did she die in Uvalde or Blewitt? She died in hospital in Uvalde
 - c) where is she buried? Uvalde Cemetery, Uvalde co., TX.
 - d) did she have just three children? Yes. Three (3) children. First child died at age one. buried in Uvalde Cemetery. Name was Robert Joseph Buttler.
 - e) For Joseph Abner Buttler
 - 1) when born, where born, when and where he died? b. 17 Oct 1892 in Blue Ridge, Collin Co., TX. died 1 March 1960, Veterans Hospital. Kerrville Kerr Co., Tx. Buried in Uvalde Cemetery, Uvalde County TX.
- 5) for John Edgar Gooding (see separate list)
- 6) for Walter Eugene Gooding
- a) where is he buried? Austin Memorial Cemetery, Austin, Travis Co., TX.
 - b) Did he have just four children? Yes. Four (4) children
 - c) did he marry 3 Mar or 3 Apr? refer Bible entry. Indicates 3 April 1937
 - d) for Camelia Mitchell
 - 1) what was her full name? Camelia Mildred Mitchell
 - 2) when and where was she born? 22 Mar 1921 in Austin, Travis Co., TX
 - 3) when and where did she die and where buried? d. 7 Feb 1991, Austin Travis County TX. Buried Austin Memorial Cemetery, Austin, Travis Co., TX.

- △ 7) For Floyd Freeman Gooding
 - a) Did he die 17 Jul or 18 Jul 1981? He died 17 Jul 1981
 - △ b) For Floyd Freeman Gooding
 - △+△ 1) for the son and daughter who died at birth? The children who died at birth were the son & daughter of Floyd B. Gooding. They were given the names of Harley Brent and Crystal Gayle. Both were stillborn in 1960 but neither parent will talk about their death or give information.
 - △+△ Floyd B. Gooding is the son of Floyd Freeman Gooding. He was given his father's first name and the initial of his mother's first name. The two infants who died were born in Beaton Hospital in Austin, Travis Co., TX
 -
 - △ c) For Norma Jean Gooding
 - 1) where was she married first time? Austin, Travis Co., TX. 11 Jan 1958
 - 11) married second time to Maxie Edward Brune, Austin, Travis Co., TX. 23 Dec 1966
 - married third time to Bill Boyd Daniell 5 Jun 1969.
 - △ 111) where did William Edward Wallace die? Mrafa, Presidio Co., Tx. 17 Mar 1960
 - △ 1V) did Norma Jean raise the children of Bill Boyd Daniell? Yes.
 - △ d) For Barbara Louise Wallace
 - 1) where was she born? Austin, Travis Co., TX
 - 11) where did she marry first time? Austin, Travis Co., TX 20 Apr 1978
 - 111) when & where did she marry second? 15 Jun 1978 Austin, Travis Co., TX
- △ No further information available on Norma Jean Gooding family. This is all I have.

□+□ I am not sure how much narrative information you are interested in but I am sending along information on the migration of Will Gooding and Theodosia Upchurch from Greely County Kansas to Svalde County Texas ca 191906-7. You said you gave lectures on the Upchurch history. This may give you some fodder for such lectures. Hope you find it interesting. It is written as it was told to me by Will and Theodosia during the time we lived on the same farm in San Patricio County near Aransas Pass, Texas. in the 1930s.

△ Grandma Gooding, as she was affectionally called, was a gentle woman but had a stern streak that was obvious in her way of life. Will was a great practical joker. To pull off a good prank was the highlight of his day. His father and grandfather were both Baptist ministers. Will was a religious person who prayed daily and I couldn't possibly count the times he has placed his hand on my head & prayed for me when illness struck. Both were quiet people and talked about themselves only when asked. OH. how I wish I had asked more!!!

P.S. If I have omitted any info please let me know.

△ Copied for profiles of
William Harvey Gooding
& Theodosia Earnest

EQ

○ From Ltr 20 SEP 1995 Edgar Dalton Gooding to RBA

△+△ William Harvey Gooding (Will) asked for the hand of Theodosia Upchurch in marriage
△+△+△ but was denied by her father, Henry Alvin Upchurch. The two eventually eloped and
△+△+△ were married. Henry Upchurch came after them, armed, but the two slipped out the
- back way and fled to relatives in Tennessee with the help of a horse and buggy.
△+△ Upon learning they were legally married Henry Upchurch returned home. He set in
△+△ motion legal action to disinherit his daughter and never spoke to her again in his
△+△ lifetime. Will and Theo eventually returned to Wayne County Kentucky to settle.
△+△ Two daughters were born in Wayne County Kentucky and sometime before 1897 Will and
△+△ his family left Kentucky for Kansas. They settled in Greely County, Kansas. One
△ daughter, Sally Ora was born on the way in Polo, Caldwell County Missouri. Will
△ homesteaded land, built a house and bought cattle. They were wiped out by a
△ blizzard around 1905. One child, John Edgar Gooding, was born in Horace, Greely
△ County Kansas. Will sold the house and land, bought a large freight wagon for
△ the household good and a smaller wagon for the family and clothing and food. He
- purchased six head of mules, hitched four to the big wagon, two to the smaller
△ wagon and headed South. John Gooding remembered parts of the trip. They had a
- small dog that would trot along under the wagon in the shade until he got tired
△ then they would let him ride inside. Will said the route followed what is today
△ generally along Highway 83. He said the streams were clean and full of fish and
△ game such as quail, turkey, deer and rabbit. They would buy staples such as flour,
△+△ coffee, etc. as they came through small settlements along the way.
△+△ They eventually settled in Uvalde County where Will went to work on a ranch breaking
△+△ horses and mules. Two more boys were born in Uvalde County.
- The Upchurch line can be traced back to England where there is a family crest.
- It is little wonder the hand of such a well bred lady would be denied a "Shanty"
△+△ Irishman such as Will Gooding. Theodosia said the twinkle in his deep blue eyes
△+△ won her heart. They lived long and happy lives and raised six healthy children.

EDGAR DALTON GOODING

XID-35516

REC'D
12 OCT 1995

900 IVANHOE
CLEBURNE, TX 76031

☐ Dear Cousin Phil,

October 7

- Please find enclosed some missing details as per your request of
- 2 October. I am still working on the Upchurch line in Eastern
- Johnson County. This is the most difficult group of people I have
- ever tried to put together. They are all related, 1st, 2nd and
- third cousins as well as double cousins but they don't visit and
- even though they live within easy driving distance of each other
- they know very little about each family. In fact one of them got
- the impression I was writing a book and was going to make a bunch
- of money and asked me to leave his home. No, truthfully the man
- has had two strokes and his wife has terminal cancer and he told
- me he did not feel like answering any questions on the matter. I
- can sympathize with him as I lost my dear wife in February this year.

☐ Details on family of Mary Wilmerth Gooding Nicely.

- △ 1) For Edgar Webster Nicely: He was born in Whitewright, Fannin
△+△ County, Tx. and is still living. He married Ocie Scott Kennedy
△ 8 Mar 1944 in Durant, Bryon Co., Oklahoma. Ocie Scott Kennedy
△ was born 13 Jul 1916 in Whitewright, Fannin Co., TX. She died 19 Dec,
△ 1968 and was buried 22 Dec 1968 in Lake Jackson, TX. Edgar Webster
△ Nicely remarried (date unknown) to Mary Ruth Gentry. No issue.
- △+△ 2) For Orville Lee Nicely: He is still living and married Ruth Marie
- Chesser 11 Oct 1947 in Denison, Grayson Co, TX. and had only two
△ children. Rodney Lee was born 5 Feb 1951 in Whitewright, Fannin
△ Co., TX and is still single. Their daughter Kristi Lee Ann was
△+△ born 31 Jan 1962 in Whitewright, Fannin Co., TX. She married Larry
- Tab Randolph 15 June 1994. No issue.
- △ 3) For Christine Nicely: Her full name is just Christine (Nicely)
△ Boyd. She was born in Whitewright, Fannin Co., Tx and is still
△+△ living. Her husband, Leslie Leon Boyd was born in 28 Dec 1922 in
△ Durant, Byron Co., Oklahoma. He died 23 Aug 1992 in Bonham, Fannin
△ Co., TX. He was buried in Whitewright, Fannin Co. TX 26 Aug 1992.
△ Christine has not remarried. No Issue.
- △ 4) For Jack Nicely: He died at 3 days old and given only the name of
△ Jack. He is buried in Whitewright, Fannin Co., TX. where he died.
- △ 5) For Joe Frank Nicely: He was born 27 JUL 1930 in Whitewright,
△+△ Fannin Co., Tx. and is still living. He married Mary Elizabeth
△+△ Mullins 31 Mar 1931 in Durant, Bryon Co., OK and they had only 4
△ children. Mary Elizabeth Mullins was born 13 July 1943 in Calera.
△+△ Byron Co., OK. and she is still living. For Donna Beth Nicely, their
△ daughter, she married 31 Mar 1973 in Telephone, Fannin Co., Tx.
△+△ Her husband, Carl Ray Cox, was born 24 Mar 1953 in Snyder, Scurry
△+△ Co., TX. The children of Carl Ray Cox and Donna Beth Nicely are:
△ Dustin Randall Cox, born 31 Oct 1977 in Sherman Grayson Co., TX.
△ Kara Lee Cox, born 19 Nov 1978 in Sherman, Grayson Co., TX
△ Kylie Seth Cox, born 18 Apr 1984 in Sherman, Grayson Co., TX.

△+△+△ For Kenneth Joe Nicely, son of Joe Frank and Mary Elizabeth Nicely:

△ He was born in Sherman in the Wilson Jones Hospital. He died on his father's farm 13 Aug 1964 and is buried in the Telephone Cemetery in Fannin County. He was 5 years old.

△ For Carla Renee Nicely: She was born in Denison, Grayson Co., TX and was married 4 Mar 1978 in Bonham, Fannin Co., Tx. Her husband Gary Delane Patton was born 9 Nov 1959 in Bonham, Fannin Co., TX.

△+△ Their children were as follows:

△ Amanda Jo Patton born 28 Jul 1978 in Sherman, Grayson Co., TX.

△ Lindsay Renee Patton born 18 Sept 1980.

△ Cory Delane Patton born 27 Mar 1983.

△ For Eddie Randall Nicely: He was born in Whitewright, Fannin Co., TX.

△+△ He married Polly Ann Cannon 2 Jan 1985 in Telephone, Fannin Co., TX.

△+△+△ Polly Ann was born 28 Feb 1968 in Whitewright, Fannin Co., TX. Their children were as follows:

△ Sarah Renee Nicely born 4 Jun 1985 in Sherman, Grayson Co., TX

△ Adam Scott Nicely born 24 Apr 1989 in Sherman, Grayson Co., TX.

□ Missing details for Susie May Gooding Williams.

△ 1) Herman Weldon Williams was born 12 Apr 1916 and is now deceased.

△+△ He died 14 Oct 1987 in Austin, Travis Co., TX. He had two children as follows:

△ Stanley Weldon Williams

△ Samuel Herman Williams born 29 Jan 1952 in Austin., Travis Co., Tx.

△+△ He married Susan Marie Watts in Austin Travis Co., Tx . 5 Feb 1968.

△+△+△ They had one child, Keisha Marie Williams born 3 Apr 1969. Samuel Herman Williams married #2. Susanne Faye Reinhardt 6 Jun 1971. No issue.

△ For Stanley Weldon Williams: He married in Austin, Travis Co., 22 Jan

△+△+△ 1987 to Debbie Anne Lowden. Their children were as follows:

△ Michelle Rena Williams born 25 Aug 1971 in Austin, Travis Co., TX

□ Mindy Gayle Williams born 28 Feb 1981 in Austin, Travis Co., TX.

△ Stanley Weldon Williams married #2 Jun 1985 in Austin, Travis Co., TX.

□ One child to this marriage: Adam Joseph Williams born 25 Aug 1986.

△+△ His second wife was named Loretta Ann Wilts born 29 Nov 1966 in Asheboro, North Carolina.

□ 2) For Gilbert Moses Williams: The information previously submitted on Gilbert is all the info I am able to obtain. Every member of the family I have contacted knows nothing of his whereabouts.

△ 3) For Samuel Moses Williams: Died 6 Mar 1948.

DETAILS FOR JOHN EDGAR GOODING FAMILY

1) OK

□ 2) The full maiden name of the wife of Edgar Dalton Gooding was Angelena Richardson.

3) OK

4) OK

△+△ 5) Full name of wife of John Eberhart was Tami Lynn Colston not Tammy.

□ Rest of family OK

Walter Eugene Gooding family

- 1) Walter Eugene Gooding was married 3 April 1937.
- 2) Alena Mae Gooding was married 5 August 1995 in Austin, Travis Co., TX.
She had four children by her husband Vernon Ralph Gelling who was born 23 aug 1930 in Wall, Pennington Co., South Dakota. Her children were as follows:
- Judy Alena Gelling who was born 12 Jun 1954 in Austin, Travis Co., TX.
She was married to Kevin Lee Nelson 16 June 1972 in Gwinner, Sargent co., North Dakota. No knowledge of any children.
- Joyce Marie Gelling who was born 6 Mar 1956 in Huron, Beadle Co., S. Dakot
No knowledge of any children. She married Lee Allen Nelson 2 Nov 1973 in Gwinner, Sargent Co., N. Dakota.
- Cindy Lou Gelling 27 Sept 1959 in Marshall, Lyon Co., Minnesota. Married Roger Peterson 12 Aug 1976 in Webster, Day Co., S. Dakota. No knowledge of any children.
- Carol Lea Gelling was born 1 Oct 1964 in Oakes. Dickey Co., N. Dakota.
She married Steven Ray Relusky 20 Sept 1985. No knowledge of Children.
(I only carried this line to the 1st cousins once removed.)
- 3) Clyde Eugene Gooding was born 1 November 1943. He married Delores Ross (date and place unknown) No knowledge of children from this marriage.
- 4) Lonnie Paul Gooding was born 2 Sept 1946 in Austin, Travis Co., TX
He married Anne Etta Burchett in Fort Worth, Tarrant Co., Tx on 27 Nov 1965. No Knowledge of children to this marriage.
- 5) Lottie Marie Gooding was born 2 Sept 1946 (a twin to Lonnie) in Austine, Travis Co., Tx. She married John Fry in Los Angeles, California. No date known and no information on children to this marriage.

Floyd Freeman Gooding family

- Floyd B. Gooding was named after his father (first name) and the initial of his mother's last name (Dorsett). The first two children of he and Pat Stigall were twins that lwere still born. Both parents refuse to discuss this birth in any manner and I respect that decision.
- Norma Jean Gooding. The only information I have is her first marriage to William Edward Wallace. This marriage date I have indicates 11 Jan 1958. I did not carry the other marriages nor the childre of Bill Boyd Daniell as they were her step children. She did raise these children however. The only child to this marriage is Barbara Louise Wallace born 13 aug 1959 in Austin, Travis Co., Tx. Her address is Norma Jean Daniell, Box 534G, Rockdale, Texas 76567 if you wish to contact her direct.
- The Hattie Dosiainformation I have mailed to her in Houston as she has an unlisted phone number. As soon as I hear from her I will forward the information to you. That is Hattie Dosiia Buttler.
- Hope this information meets with your approval.

Sincerely,

EDGAR DALTON GOODING

XFD-35516

MICHAEL ENTERPRISES
P. O. BOX 387
Wentzville, MO 63385

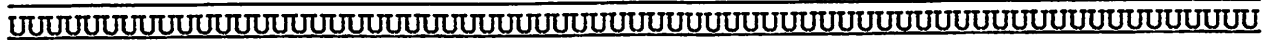

2 SEP 1995

EDGAR D. GOODING
900 IVANHOE
CLEBURNE, TX 76031

Dear Cousin Ed.

Many thanks for your recent letter which arrived on 28 AUG 1995. It prompted me to pick your previous packet out of about 40 waiting to be processed. Let me explain.

Our move from AZ to MO has continued to unfold nicely. As anticipated I have been spending on the average about 20 hours per week each on family history, farming and real estate and getting a lot done in each area. However, each area deserves to have more time. I am now in the process of reworking minutes and it will all work out. However, the family history backlog of packets/letters that built up over the six months when our "stuff" was pushed up has been difficult to process. Still, I am gradually getting on top of that also.

When I talked to you on 8 DEC 1994 I was most pleased to get family details from you. These were published in Upchurch Bulletin Vol 15

Number 4 (about 60 names). However, I only partially processed the list. Only since your recent letter arrived have I found the time to go back and complete the processing of the names obtained from you on 8 DEC 94. However, all is now properly placed on the Master Outline and in the various Biopics and I am in a position to commence working with you. I am sorry for the delay.

I was very sorry to learn of the passing of your wife. I knew from your earlier note that she required special care. My wife and I are also very close. We recently celebrated our 47th wedding anniversary. I too would find her loss a big blow. Please accept my condolences.

Enclosed are several items as follows:

1. An 11" x 17" Chart on the first six generations of Uphurder in America. I have highlighted your line and mine. Our common ancestor is James U, I.
2. A copy of my Master Outline for the Henry Alvin Uphurder line in the George U/John U, VI Subplan. This covers Henry Alvin U, his children and grandchildren. Continuation sections (26, 28, 40-43) are included to descendants of the children of Theodora Ernestine (U) Gooding.

3. Two lists of questions - one about your Grandmother and her family and one about your father and his family. I will be grateful for any answers you have or can get. I realize we may never get everything.
4. Details on the Upchurch Bulletin
5. A copy of the 5 Page 10 Item Biopile on Henry Alvin U
6. A copy of our 10 DEC 1994 "Freedom Document"

Ed, it is great to have you as a cooperator and I hope we can continue to exchange information. I'll try to be more prompt in the future.

Present plans are that we will spend two weeks in Texas this fall visiting various counties where there is Upchurch history. I will probably give one or two "Upchurch" lectures. This trip will probably be right after Thanksgiving. The recent issue of the Upchurch Bulletin reports on a similar trip we made to TN/NC earlier this year.

With all best wishes



Sincerely yours
Phil Upchurch

{ROBERT PHILIP UPCHURCH}

SOME MISSING DETAILS ON THE FAMILY 25 SEP 1995
OF THEODOSIA ERNESTINE (LUPCHURCH) GOODING

1) For Theodosia Ernestine

a) Did she have just six children?

b) For William Barney Gooding

- i) Was he born at Palmersville or at Mt Pleasant in Wayne Co, KY?
- ii) Did he die at Austin, TX or at Blewett in Unalaska Co, TX?

2) For Susie M. Gooding

a) Is the "M" for MAY or MAE?

b) Did she die 2 MAY 1984 or 5 MAY 1984?

c) Where is she buried?

d) Did she have just one child?

e) For Samuel Mosee Williams

i) where born, where died, where buried?

3) For Mary W. Gooding

a) Is the "W" for WILMERTH or WILMURTH?

b) Where is she buried?

c) Did she have just five children?

d) Did she marry in Whitesburg, TX or Austin, TX?

e) For Edgar Theodore Nixey

i) where born, where died, where buried?

4) For Sallie Ora Gooding

a) Is it SALLIE or SALLY?

b) Did she die in Unalaska, TX or Blewett, TX?

c) Where is she buried?

d) Did she have just three children?

e) For Joseph Almer Butler

i) when was he born?

ii) where was he born?

iii) when & where died?

iv) where buried?

(2) [For Theodosia]

5) For John Edgar Gooding - see separate list

6) For Walter Eugene Gooding

a) where is he buried?

b) Did he have just four children?

c) Did he marry on 3 MAR 1937 or 3 APR 1937?

d) For Gamelia Mitchell

i) what was her full maiden name

ii) when and where was she born?

iii) when and where did she die?

iv) where is she buried?

7) For Floyd Freeman Gooding

a) Did he die 17 JUL 1981 or 18 JUL 1981?

b) For Floyd Freeman Gooding

i) For the son & daughter who died at birth - were they given names (if so what), when and where did these births/deaths take place?

c) For Norma Jean Gooding

i) when did she marry the first time?

ii) where did she marry the second time?

iii) where did William Edward Wallace die?

iv) Did Norma Jean help raise the fine children of Bill Boyd Daniel? (If so I will assign numbers)

d) For Barbara Louise Wallace

i) where was she born?

ii) where did she marry the first time?

iii) when and where did she marry the second time?

iv) when in 1953 and where was her 1st husband born?

v) Full name of D. A. Gauthier and when & where born?

vi) where were her six children born?

e) For Kimberly Dawn Brown

i) where born? where married?

ii) when & where was Alan Dale Schneider born?

iii) Did she have any children?

MISSING DETAILS ON THE FAMILY
OF JOHN EDGAR GOODING

2 SEP 1995

1) For John Edgar Gooding

- a) where is he buried?
- b) Did he have just six children?
- c) For Nellie Elza Winslett
 - i) where was she born?
 - ii) where did she die?
 - iii) where is she buried?

2) For Edgar Dalton Gooding

- a) when were you born?
- b) where were you born?
- c) when were you married?
- d) where were you married?
- e) For Lena Richardson
 - i) what was her full maiden name?
 - ii) when was she born?
 - iii) where was she born?
 - iv) when in FEB 1995 did she die?
 - v) where did she die?
 - vi) where is she buried?

3) For Lena Laverne Gooding

- a) when did she marry?
- b) where did she marry?
- c) Did she have just two children?
- d) Does she have any grandchildren?
- e) For Perry Brinlan Turner
 - i) when was he born?
 - ii) where was he born?

3) For Loma Laverne Gooding - CONTINUED

f) For Rocky Quinn Turner

- i) when and where was he born?
- ii) when and where did he marry?
- iii) what is the full maiden name of Gwendolyn Lambert and when & where was she born?
Is her name spelled GWENDOLYN or GWENDOLYN?

g) For Tamara Lynn Turner

- i) when and where was she born?
- ii) when and where did she marry?
- iii) what is the full name of Robert Smith and when and where was he born?

4) For Billy Joe Gooding

a) Is he still living?

5) For Wanda Joyce Gooding

- a) when and where was she born?
- b) when and where did she marry?
- c) Did she have just two children?

d) For Susan Gayle Eberhart

- i) when and where was she born?
- ii) when and where did she marry?
- iii) Did she have just one child?
- iv) when and where was Orsley Odson Bernard born?
- v) when and where was Ashley Elizabeth Bernard born?

e) For John Donald Eberhart

- i) when and where was he born?
- ii) when and where did he marry?
- iii) Did he have just one child?
- iv) Full maiden name of Tammy Colston and when and where was she born?
- v) when and where was Zachary Donald Eberhart born?

6) For Johnnie Jean Gooding

- a) when and where was she born?
- b) when and where was she married?
- c) Did she have just ~~two~~ children?
- d) when and where was Carroll Vester Taylor born?

[I am interested in the name VESTER - it is so my ungr. mother was a VESTER]

e) For Sharon Alison Taylor

- i) when and where was she born?
- ii) when and where did she marry?
- iii) Did she have just ~~two~~ children?
- iv) what is the full name of her husband and when and where was he born?

v) where was Cheyenne Cody Bowers born?

f) For Randy Canoll Taylor

- i) when and where was he born?
- ii) when and where was he married?
- iii) Did he have just four children?
- iv) when and where was Bonnie Ann Wright born?
- v) where is Gabriel Scott Taylor married?

7) For Edith Kay Gooding

- a) when and where was she married?
- b) Did she have just ~~two~~ children?
- c) when and where was Sanford Nelson Williams born?

d) For Kristi Kay Williams

- i) where was she born?
- ii) when and where did she marry?
- iii) Did she have just one child?
- iv) when & where was Quinton Allen Burroughs born?
- v) where was Page Hailyyn Morgan Burroughs born?

e) For SHAWN Nelson Williams

- i) where was she born?
- ii) Is she still single?

you have played a large role in helping to
 define the family & thought you should have
 a copy of them. you can see where the
 descendants lived, married, died, etc. if more
 copies of any or all of this material would be
 needed please let me know. Any improvements
 you have for the market outline will be
 appreciated. However, I recognize that this
 is not a group in your best line. you
 just happen to be in the midst of a
 launch of instant camera

The specific individuals who have made
 inputs are shown by a "c" on the left
 hand side of the contribution page beside
 the contribution name.

Here are comments, if any, on the letters from
 you I have just provided.

#1 Re: 130095 - re contribution system '5 - David Robert
 comments - No comments

#2 Re: 130095: Re Will Roger & Family, etc
 re contact the gene & family or I understand over
 the phone. The study William come in
 a real one. I can understand why the family
 is reserved in their reaction

#3 Re: 130095, Re: 160095 - re Anderson trace & Family, etc
 No comments - except you organized the data well

#4 Re: 130095, Re: 180095 - re visit to Stans Island
 great input! Thank you for the information you
 William Henry II, I & his wife - shown where they lived

#5 letter 3 DEC 95 Re Robert Powell.

See David Powell like a good contact since the
get-over her journal home. I look like I
will get right from her & take a many
to my apartment which you have sent. I have a
copy of their poetry book now.

#6 letter 7 DEC 1995 Re Kenyan Government, I

It is great that you continue to look for
me government. I'll contact his embassy only
I think in Kenya and see if he has a
heart for us. I'm looking for me that he should have
been found in Kenya.

you reported on finding the government of

David Powell. I enclosed in a copy of my paper
for him and his parents. You can see I find
questioned this relationship. - later I got a

your letter of 11 DEC 95 and made another

entry. The ~~great~~ room given clear. However,
I still wonder about the age of the mother
and have not yet arranged an ID for
David Powell or send him on the matter
entire

#7 letter 11 DEC 1995 Re 15 DEC 95 - re Robert Powell
no comment.

you have performed a great service for the
exiled Lyburn Family in helping to document
the family members in your area and I
appreciate it very much

Since talking to you I found my records on the name for unclaimed matrons established by James T. U in Arlington, TX, (They were in my Texas file!!). Enclosed is a copy of the mansion/Dolph article which pretty well tells the story. Also provided is a Recap sheet (15 years A-D) based on my making one more effort to identify the father of this James T. U - no luck. Somehow we will figure it out. I have several more items in the file but they pretty much tell the same story. He is reported to have been born at Bosqueville, TX which I learn is in McLean Co next to Waco. However, there is one hint that he may have been born in Bosque County. This is a very interesting aspect of our Yulmurd family heritage. I hope to see the cemetery in April.

April 4-17, 1996 looks good for our TX trip. I am looking forward to seeing you.



Sincerely yours
Phil Yulmurd

{ ROBERT PHILIP
U PCT VRCIT }

EDGAR DALTON GOODING

XID- 35516

1900 EVANHOE

CLEBURNE, TX 76031

Dear Cousin Robert

REC'D
13 NOV 1995

- + □ I do believe I have the family of Will Rogers Upchurch
- and Jamie Adeli Pope near completion. Please accept this information as is. I realize some details are lacking but Jamie Adeli Pope promised to get more detail during the upcoming holidays, Thanksgiving and Christmas, as the children come home. We will see. There is one daughter and
- husband missing from this and she is Fillee Lou Elka Upchurch
- and her husband Curtis Lynn Erwin. They live in Arkansas. The family says they live in Marlin but the Post office shows no zip code for a Marlin. I believe it to be Malvern. Perhaps you can check that family easier than I. We will see.

I have spent less time on major murder cases than I have on this family's research. My research on my own family, Gooding, is lagging behind. I would ask that you attempt to correspond with the Jesse L. Upchurch clan in Fort Worth. At my age I do not trust my reflexes to drive in the traffic congestion. The Palo grounds and home I found in Burnison is only a playground and they are seldom there. It would be sheer luck if I caught them there. I think that approach would work better.

- + □ I have sent one last request to Dasha Neal (W.D. Neal) in Houston. Her phone number is unlisted. As soon as I hear from her, if I do, I will forward it to you.

- + □ I have the Joseph Albert Upchurch and Lou Ella Williams family getting their family information together. That will probably be after the holidays as well as the family is scattered all over and we are back one generation and there will be more people involved.

- I also have a researcher in Hill Co. attempting to locate the burial place of Kenyan Branan Upchurch I. He is not buried in Starca, Hill Co., Tex.

- + □ I also have attached information on the Williams brothers. A note attached to that explains. I took a good cousin getting this information.

Sincerely,
Ed

Family Group Record

Husband's name		SOURCES OF INFORMATION	
Born	5 Jul 40	Place	FT Worth Tarrant Co. TX
Chr.		Place	
Mar.	12 Aug 1958	Place	Keene Dale Tarrant Co. TX
Died		Place	
Bur.		Place	
Father	not available	Mother	not available
Husband's other wives			
None			
Wife's name		SOURCES OF INFORMATION	
Born	26 Dec 1936	Place	Chelbone Johnson Co TX
Chr.		Place	
Died		Place	
Bur.		Place	
Father	Will Posen upchurch	Mother	Janis Adelle Pope
Wife's other husbands			
None			
Children List each child (whether living or dead) in order of birth			
1 Sex	F	Name	Renee Marie Daugherty
Born		Place	FT Worth Tarrant Co TX
Chr.		Place	
Mar.		Place	Manefield Tarrant Co. TX
Died		Place	
2 Sex	M	Name	Floyd Allen Garrison
Born		Place	FT Worth Tarrant Co.
Chr.		Place	
Mar.		Place	Unmarried
Died		Place	NO Issue
3 Sex		Name	
Born		Place	
Chr.		Place	
Mar.		Place	
Died		Place	
4 Sex		Name	
Born		Place	
Chr.		Place	
Mar.		Place	
Died		Place	
5 Sex		Name	
Born		Place	
Chr.		Place	
Mar.		Place	
Died		Place	
Other marriages and necessary explanations			

Write places as: Tryon, Va, NC or St. Martins, Birmingham, Warwick, Eng

Write date as: 5 Aug 1988

SOURCES OF INFORMATION

Janis Adelle Pope upchurch
 upchurch Daugherty

no DOB available

Children: 1. Kristin Ann Garrison
 2. Josh NMW Garrison

no DOB available

no further issue

Family Group Record

Husband's name		<i>Henny gale w/church</i>		SOURCES OF INFORMATION	
Born	<i>13 Feb 1953</i>	Place	<i>Claburne Johnson Co. TX</i>		
Chr.		Place			
Mar.	<i>16 Nov 1971</i>	Place	<i>Claburne 2nd Johnson Co.</i>		
Died		Place			
Bur.		Place			
Father	<i>Will Rogers w/church</i>		Mother	<i>Jamie Adele Pope</i>	
Husband's other wives					
Wife's name					
Born	<i>29 Mar 1950</i>	Place	<i>FT Worth</i>		
Chr.		Place			
Died		Place			
Bur.		Place			
Father	<i>Wilson Benton Smith</i>		Mother	<i>Jene Emmitt</i>	
Wife's other husbands					
Children List each child (whether living or dead) in order of birth					
1 Sex	<i>F</i>	Name	<i>Donna michelle w/church</i>	Spouse	
Born	<i>23 Mar 1988</i>	Place	<i>Claburne 2nd</i>		
Chr.		Place			
Mar.	<i>N/A</i>	Place			
Died		Place	<i>No further issue</i>		
2 Sex		Name		Spouse	
Born		Place			
Chr.		Place			
Mar.		Place			
Died		Place			
3 Sex		Name		Spouse	
Born		Place			
Chr.		Place			
Mar.		Place			
Died		Place			
4 Sex		Name		Spouse	
Born		Place			
Chr.		Place			
Mar.		Place			
Died		Place			
5 Sex		Name		Spouse	
Born		Place			
Chr.		Place			
Mar.		Place			
Died		Place			
Other marriages and necessary explanations					

Write places as: Tryon, Pull, NC or St. Martins, Birmingham, Warwick, Eng

Write date as: 5 Aug 1988

Family Group Record

Husband's name		SOURCES OF INFORMATION	
Born	2 Apr 1957	Place	Claburne
Chr.		Place	
Mar.	29 Aug 1975	Place	Weatherford
Died		Place	
Bur.		Place	
Father	Wiel Roses Upchurch	Mother	Jane Adele Poje
Husband's other wives			
Wife's name			
Born	2 Oct 1958	Place	Claburne
Chr.		Place	
Died		Place	
Bur.		Place	
Father	Floyd N.M. Vassar	Mother	Eva Jean Thomas
Wife's other husbands			
Children List each child (whether living or dead) in order of birth			
1 Sex	M	Name	Roger Dean Up. Jr. - Spouse Darla Jean Prichett
Born	9 Jun 1977	Place	FT Worth Tarrant Co. TX
Chr.		Place	
Mar.	11 Jun 1994	Place	Joshua Johnson Co TX
Died		Place	no issue
2 Sex	F	Name	Christi Dean Upchurch Spouse
Born	28 Dec 1978	Place	Claburne FT Worth Tarrant Co. TX
Chr.		Place	
Mar.		Place	
Died		Place	
3 Sex	M	Name	Willie Floyd Upchurch Spouse
Born	24 July 1986	Place	FT Worth Tarrant Co. TX
Chr.		Place	
Mar.	NA	Place	
Died		Place	
4 Sex	M	Name	Ricky Allen Upchurch Spouse
Born	23 Dec 1982	Place	Claburne Johnson Co. TX
Chr.		Place	
Mar.	NA	Place	Texas
Died		Place	
5 Sex	M	Name	Henry Dwayne Up. Spouse
Born	23 Dec 1982	Place	Claburne Johnson Co. TX
Chr.		Place	
Mar.		Place	
Died		Place	
6 Sex	F	Name	Pamela Sue B. 15 July 1984 no issue Spouse
Died		Place	FT Worth Tarrant Co. TX
Other marriages and necessary explanations			
no further issue			

Write places as: Tryon, Polk, NC or St. Martins, Birmingham, Warwick, Eng.

Write date as: 5 Aug 1988

#6

Family Group Record

Children of Herman Williams, (Duke Perrett) John Edgar Gooding
 Sallie Mae - Sister of Louise Mat. Goodine - Sallie
 Family of Samuel and Mae Gooding

Husband's name		Samuel Herman Williams		SOURCES OF INFORMATION	
Born	29 Jan 1952	Place	Travis Co., TX, Austin	Norma Demuell	
Chr.		Place		Ed Gooding	
Mar.		Place			
Died		Place			
Bur.		Place		Samuel Williams	
Father		Place		in Person	
Husband's other wives		B. 11-Jun 1955, Austin, TX. Mother			
Wife's name		Margie Susanne Renbert (1) no issue			
Wife's name		Susan Marie Watts			
Born	6 Jun 1960	Place	Austin, Travis Co., TX		
Chr.		Place			
Died		Place			
Bur.		Place			
Father	John Henry Watts	Mother	Mary Belle Smith		
Wife's other husbands					
Children List each child (whether living or dead) in order of birth					
1 Sex	Name	Keisha Marie Williams ^{Spouse} dau. of Susanne Watts			
Born	4 Mar 1969	Place			
Chr.		Place			daughter of Susan Watts
Mar.		Place			
Died		Place			
2 Sex	Name	<u>NO further issue</u> ^{Spouse}			
Born		Place			
Chr.		Place			
Mar.		Place			
Died		Place			
3 Sex	Name				
Born		Place			
Chr.		Place			
Mar.		Place			
Died		Place			
4 Sex	Name				
Born		Place			
Chr.		Place			
Mar.		Place			
Died		Place			
5 Sex	Name				
Born		Place			
Chr.		Place			
Mar.		Place			
Died		Place			
Other marriages and necessary explanations					

I believe this to be the correct information
 on Stanley Weldon Williams and Samuel Herman Williams.
 Stanley is now serving time for child malistration and both families are very uncooperative and angry at me for calling them. Sorry but it is the best I can do under the circumstances. I will try no more.
 Ed

Write places as: Tryon, Polk, NC or St. Martins, Birmingham, Warwick, Eng.

Wri. me as: Christian Joseph STEVENSON
 Write date as: 5 Aug 1988

EDGAR DALTON GOODING

XFD-35516

Dear Cousin Robert. REC'D 13 NOV 1995

- Please find enclosed the lineage on upchurch from
- David Robert Lawrence upchurch year 75A on XFD 19950
- I told you in one of my letters upchurch names keep
- popping up. This was one I had run out and was
- going to send it as soon as it was fleshed out.
- Every drop of information available is included.
- Pershing ~~Earl~~ upchurch is living in a nursing home
- in Colorado. The kids are scattered from Godley to
- Burlington + Ft Worth. I may have to float a loan to
- pay the phone bill. But it is much easier on me
- than driving and probably cheaper. my gasoline bill
- will make you do a double take.
- All I like now is the Joseph Albert upchurch and
- + □ Lovelle Williams family or Kenneth Edell upchurch
- family.
- It looks like we may have to go with what we have on
- the Walter Eugene Gooding family.
- + □ Clyde is somewhere in Florida, Rena may is somewhere
- in the Dakotas. Lattie is in an institution in Austin under
- psychiatric care and nobody knows where Jannie is.
- There is none of the family left in Austin.

□ EQ

- 7900 IVANHOE

- CLEBORNE, TX 76031

Family Group Record

Write places as: Tryon, Polk, NC or St. Martins, Birmingham, Warwick, Eng.

Write me as: Christian Joseph STEVENSON
Write date as: 5 Aug 1988

Husband's name		Pershing Earl Upchurch		SOURCES OF INFORMATION
Born	8 Feb 1919	Place	Itasca Hill Co. TX	Pershing Earl Upchurch
Chr.	5 Jan 1944	Place	FT Worth Tarrant Co TX	
Mar.	5 June 1944	Place	FT Worth Tarrant Co TX	
Died		Place		
Bur.		Place	Advanced nursing Home	
Father	David Robert Lawrence Upchurch		Mother	Elizabeth Jane Washen
Husband's other wives	B. 10 Jan 1880		B. 4 Jan 1878 D. 1 Jan 1959	
Wife's name		Nanathy Jean Cunningham		
Born	26 Dec 1925	Place	Bosque Co. TX	
Chr.		Place		
Died	15 Nov 1987	Place	FT Worth	
Bur.		Place	Same	
Father			Mother	
Wife's other husbands		(Several but unknown)		
Children List each child (whether living or dead) in order of birth				
1 Sex	Name			Spouse
Born		Place		
Chr.		Place		
Mar.		Place		
Died		Place		
2 Sex	Name			Spouse
Born		Place		
Chr.		Place		
Mar.		Place		
Died		Place		
3 Sex	Name			Spouse
Born		Place		
Chr.		Place		
Mar.		Place		
Died		Place		
4 Sex	Name			Spouse
Born		Place		
Chr.		Place		
Mar.		Place		
Died		Place		
5 Sex	Name			Spouse
Born		Place		
Chr.		Place		
Mar.		Place		
Died		Place		
Other marriages and necessary explanations				

See attached family group sheet

Family Group Record

Write places as: Tryon, Polk, NC or St. Martins, Birmingham, Warwick, Eng.
 Write me as: Christian Joseph STEVENSON
 Write date as: 5 Aug 1988

Husband's name		<i>Billy Wayne Calhoun</i>		SOURCES OF INFORMATION
Born	<i>13 Jul 1945</i>	Place	<i>Sulphur Springs TX</i>	<i>Edna Earl Upchurch</i>
Chr.		Place		
Mar.	<i>28 Aug 81</i>	Place	<i>FT Worth</i>	
Died		Place		
Bur.		Place		
Father	<i>Rosa Leroy Calhoun B.1916</i>		Mother	<i>Allie Geneva</i>
Husband's other wives		<i>B.1990 Athens, Miss</i>		
Wife's name		<i>Edna Earl Upchurch</i>		
Born	<i>3 Apr 1907</i>	Place	<i>Hillsboro</i>	
Chr.		Place		
Died		Place		
Bur.		Place		
Father	<i>Pershing Earl Upchurch</i>		Mother	<i>Dorothy Jean Cunningham</i>
Wife's other husbands				
Children List each child (whether living or dead) in order of birth				
1 Sex	Name	Spouse		
Born	Place			
Chr.	Place	<i>NO ISSUE</i>		
Mar.	Place			
Died	Place			
2 Sex Name Spouse				
Born	Place			
Chr.	Place			
Mar.	Place			
Died	Place			
3 Sex Name Spouse				
Born	Place			
Chr.	Place			
Mar.	Place			
Died	Place			
4 Sex Name Spouse				
Born	Place			
Chr.	Place			
Mar.	Place			
Died	Place			
5 Sex Name Spouse				
Born	Place			
Chr.	Place			
Mar.	Place			
Died	Place			
Other marriages and necessary explanations				

Family Group Record

Write places as: Tryon, Polk, NC or St. Martins, Birmingham, Warwick, Eng.
 Write me as: Christian Joseph STEVENSON
 Write date as: 5 Aug 1988

Husband's name		David Elwood Upchurch SR.		SOURCES OF INFORMATION	
Born	7 Sept 1908	Place	Ft.asca Mill Co TX		
Chr.		Place			
Mar.	1 Mar 1969	Place	Houston Harris Co. TX		
Died		Place			
Bur.		Place			
Father	Pershing Earl Upchurch		Mother	Norathy Jean Cunningham Davis	
Husband's other wives		none			
Wife's name		Edna Darlene Pearson			
Born	31 Aug 1909	Place	Houston Harris Co TX		
Chr.		Place			
Died		Place			
Bur.		Place			
Father	John Wesley Pearson		Mother	Janice Marie Thompson	
Wife's other husbands		none			
Children List each child (whether living or dead) in order of birth					
1 Sex	M	Name	David Elwood Upchurch Jr.	Spouse	Cheryl Denise Miles
Born		21 Mar 1970	Place	FT Worth Tarrant Co TX	
Chr.			Place		
Mar.		10 June 1991	Place	FT Worth Tex	#1. David Elwood Upchurch III B. 29 Jul 1993 FT Worth Ft Worth
Died			Place		#2. Antoinette Blake Upchurch B. 8 Mar 1995
2 Sex	F	Name	Denesa Darlene Leoda Upchurch	Spouse	Rudolph Wm Ponce
Born		27 Sept 1974	Place	Mexico (no further information)	
Chr.			Place		
Mar.		3 Feb 1993	Place	FT Worth	#1 Sydney Brooke Ponce B. 29 May 1994
Died			Place		
3 Sex		Name	No further Issue		Spouse
Born			Place		
Chr.			Place		
Mar.			Place		
Died			Place		
4 Sex		Name			Spouse
Born			Place		
Chr.			Place		
Mar.			Place		
Died			Place		
5 Sex		Name			Spouse
Born			Place		
Chr.			Place		
Mar.			Place		
Died			Place		
Other marriages and necessary explanations					

Family Group Record

Husband's name		Ronald Ray Walker		SOURCES OF INFORMATION	
Born	3 mar 1944	Place	Hillsboro		
Chr.		Place			
Mar.	9 aug 1968	Place	FT Worth		
Died		Place			
Bur.		Place			
Father		Mother	Lucy Jackson Walker		
Husband's other wives					
Wife's name		Glenda Davis Upchurch			
Born	21 aug 1950	Place	Hillsboro		
Chr.		Place			
Died		Place			
Bur.		Place			
Father	Pershing Earl Cunningham	Mother	Dorothy Jean Cunningham		
Wife's other husbands					
Pershing Earl Cunningham					
Children List each child (whether living or dead) in order of birth					
1 Sex	F	Name	Kathy Jean Walker Darden	Spouse	Randy Wayne Darden
Born	29 mar 1969	Place	FT Worth		1. Callie Jean Darden B. 31 Jan 1992
Chr.		Place			
Mar.	21 Oct 1990	Place	Everman, Tarrant Co.		
Died		Place			
2 Sex	M	Name	Ronald Ray Walker Jr.	Spouse	
Born	18 Feb 1975	Place			
Chr.		Place			
Mar.		Place	not married		
Died		Place			
3 Sex		Name	No further issue		
Born		Place			
Chr.		Place			
Mar.		Place			
Died		Place			
4 Sex		Name			
Born		Place			
Chr.		Place			
Mar.		Place			
Died		Place			
5 Sex		Name			
Born		Place			
Chr.		Place			
Mar.		Place			
Died		Place			
Other marriages and necessary explanations					

Write places as: Tryon, Full NC or St. Martins, Birmingham, Warwick, Eng.

Wri. me as: Christian Joseph STEVENSON
Write date as: 5 Aug 1988

Family Group Record

Write places as: Tryon, Polk, NC or St. Martins, Birmingham, Warwick, Eng.

Husband's name		Garry Wayne Upchurch		SOURCES OF INFORMATION	
Born	25 Sept 1951	Place	Hillsboro		
Chr.		Place			
Mar.	10 Sept 1976	Place	FT Worth		
Died		Place			
Bur.		Place			
Father	Pershing Earl Upchurch		Mother	Dorothy Jean Cunningham	
Husband's other wives					
Wife's name					
Jackie Kay Watson					
Born	23 July 1959	Place	Cleburne, Tex		
Chr.		Place			
Died		Place			
Bur.		Place			
Father	Bobby Jack Watson B. 23 Nov 1935		Mother	Maami Joyce Wall	
Wife's other husbands					
Children List each child (whether living or dead) in order of birth					
1 Sex	M	Name	Stephanie Maami Jean Up -	Spouse	
Born	8 July 1980	Place	FT Worth		
Chr.		Place			
Mar.		Place			
Died		Place			
2 Sex	F	Name	Debra Shonie Up	Spouse	
Born	29 May 1985	Place	Casper Wyoming		
Chr.		Place			
Mar.		Place			
Died		Place			
3 Sex	F	Name	Rebecca Sue Up -	Spouse	
Born	16 Apr 1987	Place	Oklahoma City -		
Chr.		Place			
Mar.		Place			
Died		Place			
4 Sex		Name		Spouse	
Born		Place			
Chr.		Place			
Mar.		Place			
Died		Place			
5 Sex		Name		Spouse	
Born		Place			
Chr.		Place			
Mar.		Place			
Died		Place			
Other marriages and necessary explanations					

Family Group Record

Write places as: Tryon, Fuil, NC or St. Martins, Birmingham, Warwick, Eng.

Wri. me as: Christian Joseph STEVENSON
Write date as: 5 Aug 1988

Husband's name		<i>William Hallis Upchurch</i>		SOURCES OF INFORMATION
Born	<i>6 May 1954</i>	Place	<i>Whitney</i>	
Chr.		Place		
Mar.	<i>18 June 1975</i>	Place	<i>Chalson Texas</i>	
Died		Place		
Bur.		Place		
Father		Mother		
Husband's other wives				
Wife's name		<i>Carol Ann Barnett</i>		
Born	<i>21 Nov 1954</i>	Place	<i>Kansas City</i>	
Chr.		Place		
Died		Place		
Bur.		Place		
Father	<i>Oliver Raymond Barnett B. Ark.</i>		Mother	<i>Wanda Lucille Smulle</i>
Wife's other husbands				
Children List each child (whether living or dead) in order of birth				
1 Sex	<i>F</i>	Name	<i>Jennifer Lynn Upchurch</i>	
Born	<i>6 Feb 1977</i>	Place	<i>Willsboro</i>	
Chr.		Place		
Mar.		Place		
Died		Place		
2 Sex	<i>M</i>	Name	<i>Jason Hallis Up.</i>	
Born	<i>1 Dec 1981</i>	Place	<i>FT Worth.</i>	
Chr.		Place		
Mar.		Place		
Died		Place		
3 Sex	<i>M</i>	Name	<i>Jeffery Wayne Upchur</i>	
Born	<i>4 Dec 1985</i>	Place	<i>Oklahoma City</i>	
Chr.		Place		
Mar.		Place		
Died		Place	<i>no further issue</i>	
4 Sex		Name		
Born		Place		
Chr.		Place		
Mar.		Place		
Died		Place		
5 Sex		Name		
Born		Place		
Chr.		Place		
Mar.		Place		
Died		Place		
Other marriages and necessary explanations				

REC'D
18 NOV 1995

7900 IVANHOE
CLEBURNE, TX 76031

①

Dear Cousin Robert,

Nov 13

The visit with Steve Bullard was productive but not as much as I had hoped. Two important factors came to light. (1st) Steve's mother is not Mina Gay ^W but Lucille Douglas W. (2nd.) I wrote you William Henry Up. I. C. SA. 5th Ala Cav. was buried in Alvarado which is error. He is buried in Itasca, Hill Co. TX near from the top. The following is all the information Steve Bullard's records contain.

1) Where Anderson Brace W was born is unknown. He was a member of the Alabama Cav and was in the battle of Bloody Pond in Alabama. He had 13 children. He married 1st in FT Worth + 2nd in Covington, Johnson Co. TX ~~as was~~
Dixie Brona Whitehead was buried in Covington TX.
Lattie Douglas Whitehead was born 9 Jun 1895 in Godley Johnson Co. TX. She died 6 Jun 1961 place unknown probably Godley as she is buried in Falls Creek Cem. Hood Co. TX. She is a sister to Dixie Brona Whitehead.

2) Amy Up. where she was born is unknown. She died in Fort Worth and buried same but date unk. Where she married is unknown. She and Lee Joseph Pond had children as follows:
Amy Lee Up B. () D. () FT Worth TX.
m. Lee Joseph Pond B. 18 Sept 1899 (place unk) D. 14 Sept 1998
Bur. FT Worth. a wife. (Bur. Jallissville TX)

1. Letha Savannah Pond B. 18 Nov 1921. D. 12 Jun 1952

2. Clifford Lee Pond B. 11 May 1923 D. 3 Jul 1954 -

3. ~~Robert Charles Pond B. 7 Dorothy Louise Pond B. 17 Aug 1925~~

4. Mary Ellen Pond B. 27 Nov 1927

- Δ 5. Robert Charles Pond B. 7 Feb 1929 D. 3 mar 1972
- Δ 6. Olen Eugene Pond. B. 11 Sept 1930
- Δ 7. Evelyn Wylene Pond. B. 2 July 1932
- Δ 8. Douglas Edward Pond B. 1 mar 1934
- Δ 9. Jahnnie mae Pond B. 14 may 1935 ~~14 days~~
- Δ 10. Thomas Alvis Pond B. 24 Dec 1937 D. 28 Dec 1937
- 11. Buried in Graham, Young Co. TX. Lived 3 days only
- Δ 11. Louis Glennell Pond B. 30 Dec. 1938.

no further issue. → [born? - RPA]

This is all the information Steve had on their family.

3) There is a puzzle on Joseph Albert up His marker in Alvarado Cem shows he died 1907 which his daughter Wilma Louise says is correct. Steve's record indicates 1903 also on his first marriage (1st) indicates 20 June 1924 Steve's records indicate 18 Aug 1923. when he married 2nd indicates Johnson Co only. Only information on Sybil Barrow is that she is still living. Joseph Albert up had only eight children [9 have only? - RPA]

4) Fannie up is all that is indicated on records of Steve Bullard

She is still living in FT Worth. Her children were as follows

- 1. Herbert Weldon Bruce B. 17 may 1924 FT. Worth.
- 2. Anita Lois Bruce B. 5 Feb 1931 FT Worth.

When she married 1st + 2nd unknown. Full name of e Herbert Bruce + when - where born - still living unknown
 f Ralph Emerson Gilpen is dead. M. 28 Dec 1944 Okla D. 4 Jul 182 Okla.

5) Mina Day up is not Steve Bullard's mother. She died in Cherokee Johnson Co. TX when she married 1st + 2nd unknown

Full name of C. J. Johnson unknown. He is dead
 Silas Bullard's middle name unknown. Still living FT worth

△+△ e. For Elbert Sessums. When + where born unknown. He died FT Worth Tarrant Co. date unknown.

△ f. Adopted 2 children + gave Sessums name as follows:

△+△ (1) Lawan Wm Sessums (2) David Eugene Sessums

- g. Names of Grandchildren unk. → Mrs Floyd Anderson - RFD

△ (6) Floyd Henderson up church B. 25 Aug 1915 Hill Co. D. unk.

△+□ when he married is unknown. Lois Pamnia is the

□ only name known. She is still living. As far as is

□+△ known she had one child. Floyd Allen up church ^{no other} info.

△ (7) Charles Turner up. died in Ellis Co. Bur. Mt Peak Cem. Hill Co.

□+□ Nothing is available for Irma Jean Fisher except she had

△+△ two children. (1) Carl Edwin up church (2) Barbara Sue up ^(deceased)

△ (8) Lavis Randolph up died (date unk) Fort Worth.

□ Lillian up (only) is still living when + where born unk.

△ Children as follows. 1. Richard Lee up

△ 2. Helene up.

△ 3. Tommy up

△ 4. Kathleen up.

△ 5. Betty up. no further issue

△ (9) William Henry up. died in Jamesa, Dawson Co. TX

- when + where married unknown. Only information on

△ Sonia Lavern Hart is still living (possibly in Jamesa)

△+△+△ They had one child. Records indicate Judy Gail up. (only)

△ (10) Mary Ella up. B. Nov 1932 (only) Bur. Falls Creek Cem

- in Hood County.

Δ+Δ
Δ+Δ
-
Δ
□+□
Δ
Δ
-
Δ
Δ
Δ
Δ
Δ
-
Δ
Δ
-
Δ
Δ
-
Δ
Δ
Δ
Δ
Δ+Δ
-
-
-
-

11) Lucille Douglas Up is mother of Steve Bullard.
She died in Royce City, Dallas Co. TX. ~~She~~ She
married in Hamilton, Hamilton Co. TX. 27 Feb 1943
Stephen Andrew Bullard died V.A. Hospital Dallas Co.
They had children as follows.

1. Barbara Darlene Bullard B. 16 May 1944 (Cleburne)
(Meridian Bosque Co. TX) M. James Clayton Jones
M. 28 Jan 1965 Cleburne Johnson Co. TX.

a. Jamie Calson Jones B. 25 Feb 1965 - Cleburne
m. Brenton Marvin Hart B. 7 Feb 1966 Cleburne.

1. Brandon James Hart B. 6 Jul 1990
no further issue

b. Stephanie Ann Jones B. 25 Dec 1970 Cleburne
M. John Robert Harnden B. 13 Aug 1972 - TAFB
San Patricio Co. TX. *no issue.*

2) c. Steve Anderson Bullard B. 13 Oct 1946 (Meridian
Bosque Co. TX) M. Mary Rose Amundson ^{29 Jun 1968} Cleburne.
B. 5 Dec 1946 (San Diego, Cal) 29 Jun 1968

3) D. Dannie Lewis Bullard. B. 3 Sept 1948 (Meridian
Bosque Co. TX.) m. Cynthia Ann Rawlins ~~Bosque Co. TX~~
27 Feb 1970 (Cleburne TX) B. 22 Jul 1951 Cleburne TX

1. David Lewis Bullard B. 27 Sept 1970 (Clifton
Bosque Co. TX.) M. Blend Gale Blewins - *(not married)*

2. Christopher Wayne Bullard B. 5 Oct 1973 (Ft Worth)
(Single)

3. Bryan Daniel Bullard B. 20 May 1982 Ft Worth
no further issue.

Dannie Lewis m. #2. Linda Carol Smith Jackson
B. 16 July 1946 - (Alabama) M. 19 July 1995 (no issue)
(no further issue)

Δ B. Rosetta yater up - B. Sommer 1925 Hill Co. Living (Divorced)

Δ+□ M. Mark nms Bullard (First Cousin) Md (2nd) ? Mossenbacher

Δ 1. Darnell Eugene Bullard

Δ 2. Marcus Antelics Bullard D. at Bertha.

Δ 13) Jo Ann up. died Cleburne Johnson Co. TX 24 May 1954

- Bur Falls Creek Cem. Hood Co. TX.

Δ 14) Carol Ann up is still living in Riesel, MS Clennox Co.

□ M. Erman () Owen B. ()

Δ 1. Debra Kay Owen B. ()

Δ 2. Jerry Wayne Owen B. ()

Δ 3. Ronnie Lee Owen B. ()

- no further issue.

□+□ Steve tried for a week to reach Carol Ann up. by phone as did I but without success. If contact is made in the future I will complete her family.

□+□ I am enclosing death notices for William Henry up and wife Margaret for whatever use you can make of them. I still intend to try on Kenneth Odell up of Alvarado and a few other loose ends.

Ed

ITEMS PLACED IN BIOFILES OF
WILLIAM HENRY U, I
LYDIA MARGARET NUGITES



EDGAR DALTON GOODING

XFD-35516

Edgar D. Gooding
900 Ivanhoe
Cleburne, Texas 76031

REC'D
5 DEC 1995

Dear Cousin Robert,

Dec 2, 1995

First let me thank you for the Upchurch bulletins. They are not only crammed with information but make for very interesting reading. I have not finished the first one yet but will be before I am finished. We are supposed to decorate our church today.

* { I am enclosing some information I received from the daughter of Robert Harrel Upchurch. I drove to Hillsboro and located him on a rural route several miles out of town. (He and his daughter indicate this is his correct middle name). While there I also contacted MS. Cleo Davis at 817-582-3603 for the burial place of Kenyon Brannon Upchurch but her home burned recently and she is in a big hassle with her insurance company plus sickness in her family. She said she would try as soon as she could.

I realize there are many blanks in this information and I wrote in what information I was able to whittle out of the various families but as I stated they are more concerned with paying the bills and putting food on the table than in family research. Ms. Sullivan did include names and numbers of people who may be of some help to you. Those in Alvarado and Itasca I have contacted and obtained what information they would furnish. I know some of them think I am writing a book and intend to make a pile of cash and are reluctant to give family information for that reason.

I will continue to keep my ear to the ground and forward any more information I pick up. Hope this helps you a little further along.

Sincerely,

Ed

* COPIED FOR BIOFILE OF CLEO DAVIS
(How does she fit in ?? - RPU)

MY GRANDPARENTS

In the Year of Our Lord,
Nineteen Hundred Eleven,
A marriage was formed that
Was sanctioned in Heaven.

Few modern-day marriages
Rise to the rank
Of devotion established
By Winnie and Frank.

They struggled and scraped through
Some mighty lean years,
Abundance of heartaches,
And sorrows and fears.

But burdens were lightened
And joy was sustained
In the depth of this union
Where love and hope reigned.

My grandparents' presence
Is still kept alive
In the hearts of the children
By whom they're survived.

Preserved now in memories,
Not dreamed or glossed over,
Dwell scenes of a husband
And wife who've crossed over.

You can see them yourself in
The goodness inherent
In the souls of my kindred
Who knew them as parents.

Their lives can still reach us
And bid us to enter
A home in which Jesus
Is placed at the center.

I give thanks for this couple
Now living with Him,
And for those who remembered
To tell me of them.

In memory of
Marion Francis Upchurch
and Winnie May Scott Upchurch

Copyright © Mary Sullivan 1995

More from the Upchurches



Including poems by:
R. H. "Hal" Upchurch, Mary K. Upchurch
Sullivan, M. E., "Buddy" Upchurch,
Christine Upchurch, Susan Upchurch Zorn,
Harry H. Upchurch, Dale R. Upchurch,
Anne Upchurch Gricks, Alice Upchurch Jean,
and Wm. "Bill" H. Upchurch, Jr.

The Book:
(100 poems & memories. Spiral-bound. \$10.50)

Bringing In The Sheep

The Booklets:
(Average 10 poems. \$2.00 per booklet.)

The Tale Of The Cross-Eyed Bear
Re-Generation

Staging Our Own Song

The Whisper

You Had To Be There

Friendship 'n' Kinship

The Storm

Braving the Elements

Tackling the Tough Stuff

Attention Please: Mail & Free-Mail

We Dig Our Dogs

Bustin' With Love

November, 1995

For further information, please contact:

Daisy Print

Route 1, Box 100

Florence, Texas 76527

(512) 863-4813

6. Marion Edwin Upchurch, born February 29, 1924, in Texas. *Will Co. Tx*
From marriage to Christine Briley

a Susan Carol Upchurch, born January 4, 1948, in Texas.
From marriage to Ronald Zorn

i Miriam Elizabeth Zorn, born January 17, 1978, in _____

b John David Upchurch, born January 27, 1951, in Texas.
From marriage to Audrey _____ : (divorced)

i Marc _____ Upchurch, born August 15, 1972, in Texas.

ii Mindy Christine Upchurch, born July 23, 1975, in Texas.

List of current (as of November, 1995) address/telephone numbers of second and third-generation descendants of Marion Francis Upchurch is attached.

Initially Prepared by: Mary K. Upchurch Sullivan
Route 1, Box 100
Florence, Texas 76527-9729
(512) 863-4813.

a. Kenneth Chester Upchurch, born January 29, 1941, in Hill County, Texas.
From marriage to Carol Lee Crandall:

- i. Kenneth Coy Upchurch, born November 24, 1967, in Texas.
Married Karmen I. Tullos.
- ii. Kerry Lee Upchurch, born May 26, 1970, in Texas.

b. Ronald Keith Upchurch, born January 17, 1943, in Texas.
From marriage to Linda

- i. Crystal Lynn Upchurch, born September 8, 1979, in Texas.

c. Amanda Lee Upchurch, born _____, in Texas.
From marriage to Milton Cranfill

- i. _____
- ii. _____
- iii. _____

4. Robert Harrell Upchurch, born May 4, 1918, in Texas. *Hill Co. TX. Son Angela, Tom Green Co. TX*
From marriage to Geraldine Heath: *B. 23 Jun 1920 ~~Hill Co. TX~~
marriage M. 4 Sept 1941, Dallas, Dallas Co. TX. (Swimming)*

a. Hal Rhea Upchurch, born November 4, 1943, in Texas. *Barger, Hutchinson Co. TX*
From marriage to Jane Aylesworth (divorced)

- i. Tory Evan Upchurch, born _____, in _____
- ii. Todd Alan Upchurch, born _____, in _____
From marriage to Cindy Hamm (divorced)
- iii. Whitney Elizabeth Upchurch, born November 28, 1988, in Texas.

b. Mary Kay Upchurch, born June 8, 1948, in Pampa, Texas. *Gray Co.*
From marriage to Michael Knowles (divorced)

- i. Carla Michelle Knowles, born October 11, 1969, in Denver, Colorado.
(Subsequent legal name change to Michelle Heath.)
(a) Elijah Christian, born June 10, 1995, in Williamson County, Texas.
- ii. James Matthew Knowles, born December 9, 1970, in Cheyenne, Wyoming.

5. Alice Marie Upchurch, born March 24, 1921, in Texas. *Hill Co. TX*
From marriage to Buford Jean:

a. Buford Randall Jean, born May 14, 1948, in Texas.
From marriage to Barbara _____ (divorced)

- i. James Randall Jean, born February 6, 1971, in Texas.
- ii. John Buford Jean, born December 31, 1972, in Texas.
From marriage to Lieu _____
(a) Jacob _____ Jean, born August 8, 1994, in Texas.

b. Harrell Rex Jean, born August 13, 1953, in Texas.
From marriage to Pamela Gay Williams

- i. Jeffrey Ryan Jean, born November 20, 1978, in Texas.
- ii. Lindsey Suzanne Jean, born September 20, 1985, in Texas.

H REX JEAN
RR 1 BOX 104A
ITASCA TX 76055
(817) 687-2597

B RANDALL JEAN
1057 RED BUD LN
ROUND ROCK TX 78664
(512) 244-0822

KENNETH C UPCHURCH
502 N KING ST
ITASCA TX 76055
(817) 687-2484

RONALD K UPCHURCH
RR 1 BOX 95
BLUM TX 76627
(817) 687-2551

AMANDA L UPCHURCH CRANE
602 ADAMS ST
ITASCA TX 76055
(817) 687-2854

WM H UPCHURCH JR
5311 LACREEK ST
SPRING TX 77373
(713) 376-0170

BOBBY UPCHURCH
1305 S MAIN ST
MONAHANS TX 79756
(915) 943-3732

GARY UPCHURCH
3903 RIDGE LN
EASTLAND TX 76448
(915) 943-3732

HAL R UPCHURCH
BOX 1767
ODESSA TX 79761
(915)

MARY UPCHURCH SULLIVAN
RR 1 BOX 100
FLORENCE TX 76527-9729
(512) 863-4813

JOHN D UPCHURCH
RR 2 BOX 221B
HILLSBORO TX 76645

SUSAN C UPCHURCH ZORN
209 E MAIN ST
WABASH IN 46992
(219) 563-2030

DARLA D UPCHURCH DUDLEY
BOX 270
GRANDVIEW TX 76050
(817) 866-2403

E ANNE UPCHURCH GRICKS
BOX 172
NOLANVILLE TX 76559
(817) 547-3817

HARRY H UPCHURCH
BOX 43
ITASCA TX 76055
(817) 687-2517

W HOWARD UPCHURCH
703 COLLEGE ST
GRANDVIEW TX 76050
(817) 866-3970

R H (HAL) UPCHURCH
RR 2 BOX 221A
HILLSBORO TX 76645
(817) 582-9279

ALICE M UPCHURCH JEAN
800 E MAIN
ITASCA TX 76055
(817) 687-2227

M E UPCHURCH
RR 2 BOX 221
HILLSBORO TX 76645
(817) 582-2906

DALE R UPCHURCH
1057 CHAMBERLAIN ST
CORPUS CHRISTI TX 78404
(512) 855-9836

EDGAR DALTON GOOPING

XFD-35576

REC'D
9 DEC 1995

Dear Cousin Robert,

Dec 7, 1995

Yesterday morning I woke up with Kenyon Brannon Upchurch on my mind. I have no reason why but I suppose it stems from my days in law enforcement. Those loose ends can come back to haunt you. Anyway I drove to Hillsboro and to the County Clerk's office and asked for a death record. Their records begin in 1903 so I went to the department with the deeds and wills. I found the enclosed documents there. You may have these already but since I was there I thought I would go ahead and get them. I then drove over to Hill College to their Confederate Library. All I could find in my notes was the name but I took a shot and checked for Kenyon Brannon Upchurch in the same military unit as William Henry Upchurch. BINGO. There he was.

The Hill County court house burned last summer but most of the records that are required to be kept by law were in a steel vault and were preserved. The various offices usually found in the court house are scattered around town in tin barns, old warehouses and wherever they can find space. Just across the street from the building where the clerk's office is located is the "Old Hill County Cemetery" I walked that out row by row but found nothing but vandalism. There must be at least 500 or more graves there and I would guess there are no more than 50 or 60 headstones that have not been damaged by vandals.

- + □ I drove to Itasca and went to the cemetery there. I found the grave of William Henry and Lydia again and since I was there someone has been there and cleaned it up and place a marker at Lydia's grave. In the same plot is the marker of Marion Frances Upchurch but ot for his wife Winnie Mae. There is also
- △ + □ a marker for a child, David Rex Jean, that I believe is the
- + □ infant son of Alice Marie Upchurch and Buford Jean. The child
- was born 4 Jul 1974 and died 17 July 1974. While there I
- walked out all the old section of the cemetery looking for
- △ Kenyon BRannon without results. According to the probate record
- △ he left a very nice estate and you would think he would have
- a large marker. As you can see the probate does not mention
- a wife or children. It is possible the attorneys wound up with
- most of the estate as their fee. There are numerous small
- △ cemeteries scattered over the country so maybe he will turn up.
- △ Ms. Cleo Davis, cemetery historian for Hill county, is going
- △ + △ to do more research as soon as she can get to it. Her house
- △ burned and she is in a big ahssle with her insurance company
- plus sickness in the family.
-
- Hope this fills in a few blanks for you.

Sincerely,

Ed

*Copied thru letter for profile
of Kenyon Brannon U, I.*

*Note - Four estate records and one item re CSA served
on Kenyon Brannon U, I placed in his profile - RDM*

EDGAR DALTON GOODING

REC'D
15 DEC 1995

Dear Cousin Robert

Dec 11, 1995

In my last letter I forwarded some name of people that were buried in the Itasca cemetery and some that were missing. This bothered me so I decided to cross reference the names with our local library. We have a County cemetery committee headed by a Mr & Mrs Lanfear that is kept up to date. They locate and clean old cemeteries, maintain a roster of these cemetery markers and with the help of our local sheriff and convict help they try to repair damage done by vandals.

- In our library I located quarterlies from Hill County and the
- names of deceased from the grave markers that are in place at
- the time of the search. As I told you in that letter some
- additions had been made and the Upchurch plot had been cleaned
□+□ up. The name of Winnie May Scott, wife of Marion Frances. was
- missing. The quarterly was printed in 1990 and it contains the
- name of the following people in the Upchurch plot along with
□+□ William Henry Upchurch and Lydia Margaret Hughes. Since the roster
- was made from the existing headstones in 1990 the vandals have
- been at work since that time.

△ #1. Chester Albert Upchurch b. 8 Aug 1915 d. 21 MAR 1983
△ Spouse: Maggie Lee Bailey b. 5 Dec 1918. Living in 1990

□ #2. Marion Frances Upchurch b. 1886 d. 1981
△ Spouse: Winnie May Scott b. 1894 d. 1973

△ #3. David Rex Jean b. 4 Jul 1974 d. 17 Jul 1974
□+□ Beloved son of Buford and Alice Marie Jean (ALice Marie Upchurch)

△ #4. Marcus B. Epps b. 7 Oct 1893 d. 23 Feb 1974 (I don't know
- where this name fits in but the markers states CPL US Army)

□ #5. Infant Girl UPchurch. is listed on the library roster but it
- does not indicate the family she belonged to.

This is a rather large plot and when I was down there walking out the area the only names there was William Henry and Lydia. Lydia had only a small metal marker placed by the funeral home but on my return her marble marker was in place and had obviously been broken and repaired. The other markers had been placed but no new earth had been turned. The markers had apparently been located and replaced by someone.

Sincerely,

Edgar D. Gooding
900 Ivanhoe
Cleburne, Texas 76031

ER

Gery recently sent me the funeral document for Margaret Upchurch, old maid daughter of Richard Upchurch, IV. A copy of her 4 Page 9 items Biopill is enclosed. Note that the church at Plato is identified as BARRY CHAPEL. Also note that as of Margaret's death on 6 NOV 1928 her only living sibling (among the children of Richard Upchurch, IV) was J. C. Upchurch of VAUGHAN. I take this to be JOHN C. UPCHURCH (XID-2775) - see enclosed Master outline sheet. I note that Vaughan is in Hill County on Highway 56 just west of I-36.

Ed, if you happen to be down near Vaughan and have time to check on the cemeteries close to this town I would be most interested to learn if there are any records of the Upchurch Family. Since John C. Upchurch died sometime after 1928 there might be people in the community who would remember him - maybe he even has relatives (descendants) in the area today. This is not a critical matter but if it fits your schedule it might give us a few more bits of information.

Your heritage area of Wayne Co, KY continues to receive a lot of attention. I have several dozen of descendants of George Upchurch who make input from time to time. Our records keep getting better.

I have committed myself to write a book covering the first seven generations of the Upchurch Family in America. I had hoped to have this done by the end of 1996 but that is now seen as unrealistic. Work on it has to come after family history correspondence, writing the Upchurch Bulletin and farm work.

Our farm work is going great. I have hired a part-time farm worker and bought some farm equipment. We are presently working to set a 31 acre pasture - then come a fence - then come some cows (1997).

I hope this finds you well and merrily about.

☺ Sincerely yours
Phil Upchurch
[ROBERT PHILIP UPCHURCH]

10) Photo taken on 10 APR 1996 by Gerald Bailey Tyler
and sent to RPA in LA. Taken at
Pluto Cemetery, Ellis Co, TX

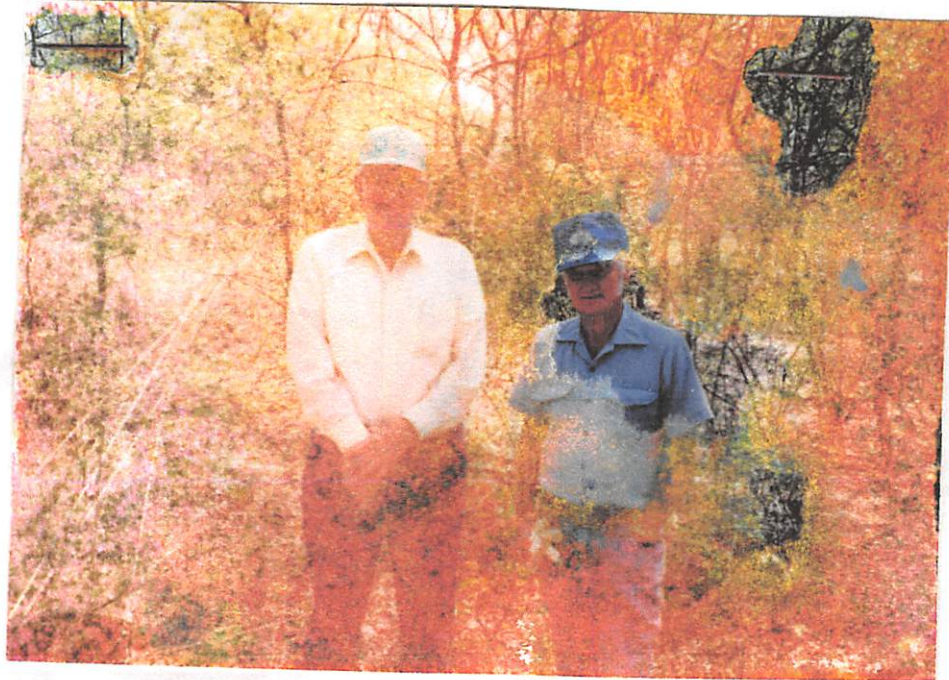

A. B

A = EDGAR DALTON GOODING ?

B. ^A JOHNNY BAILEY

and ~~they~~ help a great deal to get a feel for Texas as it was and as it changed.

We have proceeded to place copies of the U.B. in 7 Texas libraries - Dallas, Ft Worth, Austin, Houston, Corsicana, Texarkana and the Confederate Library at Hillsboro. This should give excellent coverage.

I am working on a trip report to include in the next U.B. and you can see more detail on what we did.

Since returning home I have figured out how the Rev James T. U (who had the home for unwed mothers put in). He is the one we went to Waco & Boggsville to check on. He is the son of James Courtney U, the gr of Courtney U & the gr of Moser U (Head of the Moser U Clan). The Rev is my 4th cousin once removed. I'll tell this story more completely in the U.B. in due course. The problem now is that I have so much material it is not possible to present it all and certainly not in the next U.B. issue.

We enjoyed our visit to the Texas Ranger Museum in Waco and wished we could have spent more time. It was nice of you to treat me to dinner. My oysters were great (I had them 4 times in Texas - they seem better there than in AZ or MO).

Thanks for the Ellis Co, TX marriage records. Enclosed is a copy of the record showing how far I have progressed in processing the details. I can identify all except individuals 15 & 16. I have put down two possibilities but don't know if either of them are correct.

If you get a chance to meet your cousin Cheryl Robin Abbot at Mesquite, TX you should do so. She is really upbeat and it lifts your spirit to visit with someone who is so positive and energetic. Her mother Jane (Upchurch) Abbot, who lives with her, is also quite pleasant.

I'll be in town again as I can collect my suits.



Sincerely yours
Phil Upchurch

[ROBERT PHILIP UPCHURCH]

DEAR COUSIN ROBERT, ^{REC'D} 22 MAR 1996 APR 15, 1996

HOPE TO FILL IN A FEW MORE BLANKS. WE ARE TRYING TO LOCATE A MINISTER FOR OUR CHURCH. I AM ON THE PULPIT COMMITTEE AND OUR AREA MINISTER SENT US A ROSTER OF RESUMES. WE HAVE A POSSIBLE AND THE AREA MINISTER OUT OF FT WORTH SET HIM UP TO PREACH IN HILLSBORO ON THE 24TH OF THIS MONTH. I WENT DOWN TODAY TO GET LOCATIONS AND SUCH SO WHILE THERE I COLLECTED THE FOLLOWING MARRIAGES FROM THE COUNTY CLERK'S OFFICE. LOTS OF INITIALS BUT WITH THE SPOUSE'S NAME THEY CONNECT.

- > [RICHARD LAWRENCE U, SR] - > [HARRY HOLLAND U]
 O R.L. UP. } 30 JUL XID 2778 Δ H. H. UP } 30 APR 3857
 O CYNTHIA GREEN } 1882 XID 2783 O L. MUNCY } 1938 38708
 - > [WILLIAM ROBERT U] - > [CHESTER ALBERT U]
 O WILLIAM R. UP } 31 JUL XID 1949 O C.A. UP CHURCH } 15 NOV 38581
 O DORA LOONEY } 1898 XID 1995 O M.L. BAILIF } 1939 38711
 - > [JOHN C U]
 Δ J.C. UP. } 10 Aug 2775
 Δ J. WINGINGTON } 1899 2783

- > [HENRY CLIFTON U]
 Δ H.C. UP } 24 MAR 19899
 O DAISY HILL } 1907 19905
 - > [GEORGE RICHARD U]
 Δ G.R. UP. } 10 NOV 10052 O
 Δ HATTIE RODGERS } 1907 10060 -

THIS IS ALL THE MARRIAGES ON RECORD FOR THE UPCHURCH LINE.

Δ WILLIAM A. UP } - -
 Δ E.E. DENNIS } 1910
 - > [WILLIAM A U]
 Δ W.A. UP } 29 JUN XID 19897
 Δ H. HONE/CUTT } 1912 19903
 - > [HENRY CLIFTON U]
 Δ HENRY UP } 29 APR 19899 -
 O E. BIGGS } 1914 19906

ED
 O (I MANAGED TO SCROUNGE A COUPLE OF DEATH RECORDS BEFORE THE BOSS LADY CAUGHT ME. SAID RECORDS NOT FOR PUBLIC VIEW??) > [HATTIE HUNNICOTT]
 Δ HATTIE UP. D. 31 OCT 1948. HILLSBORO.
 O WIFE OF WILLIAM ~~UP~~ UP WHO WAS KILLED BY BUS. YOUR XID 19897

Δ J.C. UP } 15 JUN
 Δ M.A.L. WATSON } 1914
 - > [FELIX MARVIN U]
 O MARVIN UP } 31 MAR 19932
 O MAGGIE DENNIS } 1923 19945
 - > [JOSEPH ALBERT U, II]
 Δ J.A. UP } 18 AUG 38525
 Δ LUELLA WILLIAMS } 1923 38552 -

Δ + Δ INFANT UP. MALE CHILD (STILL BORN) 4 JUL
 SON OF CHARLES UP. & VELMA CUNNINGHAM
 - > [CANNOT PLACE - RPU]
 ATO Δ DAVID L. UP 6 APR 1947 (FATHER J.R. UP.)

Δ D.R. UP } 3 NOV
 Δ MAE WEST } 1927
 - > [WILLIAM HOWARD U, SR]
 Δ W.H. UP } 28 AUG 38580
 O R.L. MCCORD } 1931 38588

Ed Gooding
 900 Zumbae
 Cleburne, Tex 76031

done with him. more to the west. so when we get up on WED 10 APR 96 at Burlington instead of heading immediately to Corvallis we will go first to Hillsboro where we will meet cousin Gerry at the Confederated Branch Library at Hill Co, junior college at 9:00 AM. He has two under that line in Hillsboro and will invite them to join us. We will spend most of that day (WED) in the Hillsboro Area. We would be delighted to have you join us if you are available and so inclined. you have visited all these places and have described them to me. Late in the day I will still need to get over to Corvallis as we are obligated to be there at 7:00 PM.

The schedule for TUESDAY 9 APR 1996 remains unchanged.

Gerry is the son of Verian Bailey who is the daughter of Margaret Susie Mosher who is the daughter of Amey Ann U. Amey is a sister of Kenyon Brannon U & William Henry U, F. Gerry is extremely interested in family history and has sent me a number of packets. We only recently got in contact when he contacted

some people in Henry Co, GA to learn about
his Upchurch heritage there. They knew of my
interest and put me in contact with him
(or vice versa).

I have sent packets to the Dallas, Ft Worth
and Austin papers about the trip and the
lectures. They may or may not use this
material. Genny gets the Dallas paper and
will be alert for any mention of the trip/
lectures. Do you normally see any of the
above papers?

The trip is shaping up nicely and
all of your effort has been of tremendous
help.



Sincerely yours
Phil Upchurch

[ROBERT PHILIP UPCHURCH]

MORRIS C. McGLATHI } 1953
 NINA WAY UP BEAVE } 7 JUN
 ELBERT W. JOSSUMS JR } 1955
 WILLIAM HENRY UP } 27 AUG
 SONYA LAURANO HART } 1947
 LOUIS R. UP } 28 AUG
 LILLIAN FAYNE MISCH } 1947
 JOSEPH J. UP } 1 MAY
 BILLIE JEAN SHIPMAN } 1948
 BETTY JEAN UP } 22 MAY
 FRED L. SHIPMAN } 1948
 ALICE MARIE UP } 4 JAN
 RUFORD JEAN } 1948

I REMEMBER WE MADE SOME OF THESE
 BUT THIS MAY BE A DIFFERENT
 OR HAVE SOME COLLECTIONS
 Standing
 1948
 June, July 48

Dear Cousin Robert,

REC'D 14 MAR 1996

I CLEANED OUT THE JOHNSON COUNTY COURT RECORDS AND THE FOLLOWING IS THE MARRIAGE THEY HAVE ON RECORD. THE UPENRUCH NAME'S FIRST.

ROSETTA YATER UPENRUCH } 21 MAR 1973
MAX LYNN COLVIN

~~CECILIA~~ UP } 27 F
STEVE ALLEN BULLARD } 194

JUDY GAIL UP } 23 DEC 1968
JAMES RAY CARPENTER

CHARLEY UP } 22 MAR 1939
EMA JEAN FISHER

MARGARET ANN UP } 24 MAY 1961
JERRY LYNN WILSON

MARY NAFF UP } 20 DEC 1959
ARTHUR LIPPA

JOE ALBERT UP } 25 MAY 1957
SYBIL LORENE BARROW

2ND SUB → NINA MAY UP } 30 JAN 1938
SILAS BULLARD

SONA LAVERNE UP } 4 OCT 1958
ROBERT EDMOND TUCKER

1ST SUB? NINA MAY UP } 28 FEB 1929
CHARLEY J. JOHNSON

JAME RUSSELL UP } 28 AUG 1923
FRANCIS LUCILLE COLVIN

FANNIE UP } 5 OCT 1923
HUBERT BRUCE

CECIL DAVID UP } 21 JAN 1925
MAUNA LEE ROWDEN

BEATRICE UP } 24 DEC 1926
R. L. STUBBLEFIELD

ROSETTA YATER UP } 18 NOV 1952
MARK BULLARD

AMIE UP } 22 JUL 1920
S. J. POND

ALETA SUE UP } 28 MAR 1955
MORRIS C. MEGLOTHIN

W. R. UP } 28 FEB 1918
ELLEN TRIBBLE

NINA MAY UP AGE 40 } 7 JUN 1955
ELBERT W. SESSUMS JR.

2 → ANDERSON BRACE UP } 20 SEP 1912
LOTTIE WHITEHEAD

WILLIAM HENRY UP } 27 AUG 1948
SONYA LAVERNE HART

THE BIRTH-DEATH RECORDS ARE NOT YET AVAILABLE FOR PUBLIC USE. THEY ARE IN THE PROCESS OF FIXING THIS

LOUIS R. UP } 28 AUG 1947
LILLIAN IRENE MISCHER

I REALIZE WE HAVE SOME OF THESE BUT THIS MAY FILL IN A FEW BLANKS OR MAKE SOME CORRECTIONS

JOSEPH J. UP } 1 MAY 1948
BILLIE JEAN SHIPMAN

~~F. L. SHIPMAN~~
BETTY JEAN UP } 22 MAY 1948
FINIS L. SHIPMAN

ALICE MARIE UP } 4 JAN 1943
RUFORD JEAN

Ed Hooding
900 Duane
Cleburne, Texas 76031

ED

Dear Cousin Robert,

REC'D 14 MAR 1996

I CLEANED OUT THE JOHNSON COUNTY COURT RECORDS AND THE FOLLOWING IS THE MARRIAGES THEY HAVE ON A RECORD: THE UPCHURCH NAMES FIRST.

- RICK ANDERSON BRACE U
 ROSETTA YATER UPCHURCH } 21 MAR 1973
 MAX LYNN COLVIN } 1973
[3RD MG? - RPA]
- RICK ANDERSON BRACE U
 JUDY GAIL UP } 23 DEC 1968
 JAMES RAY CARPENTER } 1968
RICK ANDERSON BRACE U
- RICK ANDERSON BRACE U
 MARGARET ANN UP } 24 MAY 1961
 JERRY LYNN WATSON } 1961
- RICK ANDERSON BRACE U
 JOE ALBERT UP } 25 MAY 1957
 SYBIL LORENE BARROW } 1957
RICK ANDERSON BRACE U
- RICK ANDERSON BRACE U
 SONA LAVERNE UP } 4 OCT 1958
 ROBERT EDMOND TUCKER } 1958
[LUCILLE DEAN U, SR]
- RICK ANDERSON BRACE U
 JAME RUSSELL UP } 28 AUG 1923
 FRANCIS LUCILLE COLVIN } 1923
RICK ANDERSON BRACE U
- RICK ANDERSON BRACE U
 CECIL DAVID UP } 21 JAN 1925
 MAUNA LEE ROWDEN } 1925
RICK ANDERSON BRACE U
- RICK ANDERSON BRACE U
 ROSETTA YATER UP } 18 NOV 1952
 MARK BULLARD } 1952
RICK ANDERSON BRACE U
- RICK ANDERSON BRACE U
 ALETA SUE UP } 28 MAR 1955
 MORRIS C. MCGLOTHLIN } 1955
RICK ANDERSON BRACE U
- RICK ANDERSON BRACE U
 NINA MAY UP AGE 40 } 7 JUN 1955
 ELBERT W. JESSUMS JR. } 1955
RICK ANDERSON BRACE U
- RICK ANDERSON BRACE U
 WILLIAM HENRY UP } 27 AUG 1948
 SONYA LAVERNE HART } 1948
- RICK ANDERSON BRACE U
 LOUIS R. UP } 28 AUG 1947
 LILLIAN IRENE MISCHE } 1947
[LILLIAN IRENE MUSICK]
- RICK ANDERSON BRACE U
 JOSEPH J. UP } 1 MAY 1948
 BILLIE JEAN SHIPMAN } 1948
- RICK ANDERSON BRACE U
~~W. L. SHIPMAN~~
 BETTY JEAN UP } 22 MAY 1948
 FINLS L. SHIPMAN } 1948
- RICK ANDERSON BRACE U
 ALICE MARIE UP } 4 JAN 1943
 BUFORD JEAN } 1943

RICK ANDERSON BRACE U
 LUCILLE UP } 27 FEB 1943
 STEVE ALLEN BULLARD } 1943
[STEPHEN ANDREW BULLARD]

RICK ANDERSON BRACE U
 CHARLEY UP } 22 MAY 1939
 IMA JEAN FISHER } 1939

RICK ANDERSON BRACE U
 MARY NAFF UP } 20 DEC 1939
 ARTHUR LIPPA } 1939

RICK ANDERSON BRACE U
 NINA MAY UP } 30 JAN 1933
 SLAS BULLARD } 1933

RICK ANDERSON BRACE U
 NINA MAY UP } 28 FEB 1929
 CHARLEY J. JOHNSON } 1929

RICK ANDERSON BRACE U
 FANNIE UP } 5 OCT 1923
 HUBERT BRUCE } 1923
[FLORA BEATRICE U]

RICK ANDERSON BRACE U
 BEATRICE UP } 24 DEC 1926
 R. L. STUBBLEFIELD } 1926

RICK ANDERSON BRACE U
 AMIE UP } 22 JUL 1920
 J. J. POND. } 1920
[AMY LEE U]

RICK ANDERSON BRACE U
 W. R. UP } 28 FEB 1918
 ELLEN TRIBBLE } 1918
[WILLIAM ROBERT U]

RICK ANDERSON BRACE U
 ANDERSON BRACE UP } 20 SEPT 1912
 LOTTIE B. WHITEHEAD } 1912

THE BIRTH-DEATH RECORDS ARE NOT YET AVAILABLE FOR PUBLIC USE. THEY ARE IN THE PROCESS OF FIXING THIS

I REALIZE WE HAVE SOME OF THESE BUT THIS MAY FILL IN A FEW BLANKS OR MAKE SOME CORRECTIONS

ED

Ed Gooding
 900 Ivanhoe
 Cleburne, Texas 76031

EDGAR DALTON GOODING

REC'D
29 JAN 1996

Dear Cousin Robert,

As per our telephone conversation I have made some contacts in Fort Worth regarding your Texas tour. I first contacted a MS. Dixie Bennet who is this years president of the Fort Worth Geneological Society. She informed me they are booked up for the Spring of 1996. They have speakers coming from Virginia and several other places. They have the ideal location and facilities for the lecture and you might wish to contact her and see if something can be worked out. Here is her phone number in case you wish to contact her. Ms. Dixie Bennet, (817) 457-3330. She evidently wirks outside the home because I got an answering machine several times until I called her later in the evening. You might wait until late evening befor calling.

Ms. Bennet recommended a Ms. Karen Trimble in the University of North Texas Health Science Center at 3500 Camp Bowie Blvd., in Fort Worth. The phone number is 817-735-2000. The have the rooms available for such gatherings at a nominal fee. I did not contact her as I tought it would be better for you to contact her direct. The zip for Camp Bowie address is 76107.

Personally I would prefer the location at the Fort Worth Geneology Society. It would seem that they could fit you in some time during the time you are going to be here. Ms. Bennett did say to let her know if you made the other arrangements and she would make a note of it and a date in their monthly bulletin.

I have made several attempts to contact Jesse L. Upchurch by phone but he is always out, in conference or tied up in some other way. I asked Ms. Bennett to try to contact him and pass on your offer of a private audience for him and his family and I will keep trying to contact him myself.

I hope this information is helpful and you can find a location in Fort Worth for your lecture. I am espicially looking forward to meeting you and you wife on your Texas tour. I have been mulling over in my mind which of the Upchurch families in this area would nbe the most helpful and have the best information. I will have that worked out in time for your visit. Looking forward to meeting you during the visit to Texas.

Sincerely,



Edgar D. Gooding
900 Ivanhoe
Cleburne, Texas 76031

EDGAR DALTON GOODING

XID-35516

MICHAEL ENTERPRISES
P. O. BOX 387
Wentzville, MO 63385



31 OCT 1995

EDGAR D. GOODING
900 IVANHOE
CLEBURNE, TX 76031

Dear Cousin Edgar,

As I mentioned in our phone conversation on 24 OCT 1995 I had finished processing your letter of 11 OCT 1995. I have waited to respond until I could receive & process your letter of 24 OCT 1995 that was in the mail when we talked. That has now been done.

The information that Nattie Donna Neal sent was useful. I have incorporated it and have prepared a new list of questions for the Salbe oval (Gooding) Butcher family which is enclosed. Based on your comment you may not feel comfortable in going back to her for more detail. I'll leave that up to you. We can usually sense when it is best to back off. It would be nice if we could have contact with some of her children. It would also be nice if we could find one that had an interest.

Enclosed is a copy of what I propose to publish (two copies) in the U B re William Henry A, I. you may wish to share a copy with Steve Bullard. (+ a 3rd copy in case Kenneth Adell U. S. would like one)

I would welcome any comments. We hope to print this before Thanksgiving. The Photo is Great!

I'll keep my fingers crossed on the project on the Jesse L. Yerlunch Group. Good Luck!

I have augmented my Biopic with what you sent on the Winklett family. Your GF and my father were alike - except my father was hung up on cotton rather than open ranges. He learned to grow cotton as a young man and never could switch to something else even when the hell seemed made it uneconomical. We have stopped in Tucuman quite a few times - for lunch, dinner & to spend the night traveling between St Louis & Tucson.

I enclose a copy of Page 3 of your 24 OCT 1995 letter to me. This mentions Adele Hughes as wife of Will Rogers II. I show his wife to be Jane Adele Pope. Have I missed something? Enclosed is a copy of my Biopic (2 Pages 10 items) on Kenyon Brannon II. He died in a train wreck in Texas in 1893. I don't know where he was buried - maybe in Texas??

Enclosed is a Voided Sheet to show you how the William Henry II Group looked before I included the information you collected.

Enclosed are three copies of the Master Outline for Richard II, II his children and grandchildren with continuation sections 32 & 116. One copy is for you, shows Kenneth II, ← → shows Steve Ballard

one in for Steve Bullard and one in for Kenneth
U (if he wants one).

I have enclosed questions on what is missing
on continuation sections 32 & 116 in case you can
get Steve and Ken to help with them. A set
is provided for you and a set for each of them.
I am not sure how it is best to proceed
to get more details and would appreciate
your advice. I am certainly willing to wait
if that would help.

Please let Steve & Ken know that I have
more details to share if they are interested.

I really appreciate your efforts in helping
us advance the Richard U, IV line in
the Richard U, III / Calum U, I subclass.
Richard U, IV was my grandfather's 2nd cousin.

All the Best!

☺ Sincerely yours
Phil Upchurch

[ROBERT PHILLIP UPCHURCH]

MISSING DETAILS ON THE FAMILY 31 OCT 1995
OF SALLIE ORA (GOODING) BUTTLER

- 1) For Sallie Ora Gooding & Husband - All OK
- 2) For Robert Joseph Buttle
 - a) when in 1918 was he born?
 - b) when in 1919 did he die?
- 3) For Hattie Dossia Buttle
 - a) where did she marry the 1st, 2nd, and 3rd times?
 - b) Did she have only four children?
 - c) Where in LA was Grant NMN Payne born?
 - d) For Harold Vincent Neal
 - i) where in KS was he born?
 - ii) where is he buried?
 - e) For Mary Estelle Payne
 - i) Is her husband Joseph Dean Long or Milton Joseph Long Sr.?
 - ii) Did she have just four children?
 - iii) where was Judy Ann Long born? Did she marry / have issue? If so details?
 - iv) where was Carrie Sue Long born, where died, where buried?
 - v) where was Milton Joseph Long, Jr. born? Did he marry / have children? If so, details?
 - vi) where was James Budley Long born, where died, where buried?
 - f) For Joe David Payne
 - i) when and where married?
 - ii) where in LA was Ola Mae Wiley born?
 - g) For Jonathan Grant Payne
 - i) where was he born?
 - ii) when and where did he marry?
 - iii) Full maiden name of Alma Lopez, when born, where buried in Mexico?
 - iv) Did he have any children?
 - h) Did Amy Lynne Otten have marry / have issue? If so, details?
- 4) For William James Buttle
 - a) where did he die?
 - b) where is he buried?

1) For Anderson Bruce II

- a) where in AL was he born?
- b) did he have any children?
- c) where did he marry the 1st and 2nd times?
- d) where is his grave located?

2) For the Douglas Whitehead

- i) when and where born?
- ii) where buried?
- iii) in the record of his grave?

3) For Army Joe II

- a) where was the born?
- b) when & where died & where buried?
- c) where married?
- d) did he have any children? if so, details?

4) For the Joseph Pond

- i) when & where born?
- ii) when & where buried?

5) For Joseph Albert II

- a) was he born 4 MAR 1903 or 4 MAR 1902?
- b) did he marry the 1st time 18 AUG 1923 or 20 SEP 1924?
- c) when and where did he marry the 2nd time?

6) For Sylvia Barnes

- i) when & where born?
- ii) still living?
- e) did he have just eight children?

7) For Annie II

- a) where is her full maiden name?
- b) still living?

8) Ask the have children? if so, details?

- c) Ask the many the 1st & 2nd times?
- d) where did the marry the 1st & 2nd times?

- e) Full name of her husband? where & when born? still living?
- f) when & where was Ralph Emerson Gelpen born? still living?

- 5) For Mina Gay U
- where did she die?
 - when & where married the 1st and 3rd times?
 - Full name of C. J. Johnson and when and where born? Still living?
 - Full name of Selas Bullard and when and where born? Still living?
 - Full name of Elbert Sessums and when and where born? Still living?
 - Full names of her children & when & where born?
 - Full names of her grandchildren (if any) and when and where born?
- 6) For Floyd Anderson U
- where born and when died?
 - when and where married?
 - Full maiden name of Lois Pamina and where born? Still living?
 - Did he have children? If so, details?
- 7) For Charles Turner U
- where did he die?
 - where was Irma Jean Fisher born? Still living?
 - Did he have children? If so, details?
- 8) For Louis Randolph U
- still living?
 - Full maiden name of Lillian Musik and when and where born? Still living?
 - Did he have children? If so, details?
- 9) For William Henry U, II
- where did he die?
 - when and where did he marry?
 - when and where was Jama Janene Hart born, still living?
 - Did he have children? If so, details?
- 10) For Mary Ella U
- when in NOV 1932 did she die?
 - where did she die?

11) For Louella Douglas U

a) where did she die?

b) when and where did she marry?

c) where did Stephen Andrew Bullard die?

d) Did she have any children? If so, details?

12) For Rosetta Yates U

a) when and where did she marry?

b) Full name of Mark Bullard and when and where was he born? still living?

c) Did she have any children? If so, details?

13) For Jo Ann U

a) where did she die?

14) For Carol Ann U

a) still living?

b) when and where did she marry?

c) Full name of Erman Owen and when and where born? still living?

d) Did she have children? If so, details?

MISSING DETAILS ON THE FAMILY 31 OCT 1995
OF RICHARD LAWRENCE UPCHURCH, JR

- 1) For Richard Lawrence U, Jr
 - a) where did he marry the 1st and 2nd times?
 - b) For Mary Berryhill
 - i) Is her middle name JEWEL or JEWELL?
 - ii) still living?
 - c) Did he have just four children?
- 2) For Kenneth Odell U, Sr
 - a) Did he have just six children (including two adopted)
 - b) Is Ruby Lou Nell Cooper still living?
 - c) when and where did he marry the 2nd time?
 - d) For Effie Delight Cheuren
 - i) where was she born (Ione, WA or CANADA?)
 - ii) still living?
 - e) Did Kenneth Odell U, Jr marry/have children? If so, details?
 - f) Did Bonnie Leona U marry/have children? If so, details?
 - g) Did Fred Robert U marry/have children? If so, details?
 - h) Did Cindy Lou U marry/have children? If so details?
 - i) For Patricia Lynn Porter
 - i) when and where born?
 - ii) Did she assume the Upchurch name?
 - iii) Did she marry/have children? If so, details?
 - j) For Mark Paul Porter
 - i) when was he born?
 - ii) Did he marry/have children? If so, details?
- 3) For George Brandon U
 - a) was he born 14 JUN 1932 or 14 JAN 1932?
 - b) when and where married?
 - c) when & where was Clara Sue Seay born?
 - d) Did he have children? If so, details?
- 4) For Mary L. U
 - a) Does the "L" stand for LOU or LUE? b) Born 20 MAR 1934 or 21 MAR 1934?
 - b) Did she marry/have children? If so, details?
- 5) Did James Linwood U marry/have children? If so, details?

EDGAR DALTON GOODING

XFD-35516

MICHAEL ENTERPRISES
P. O. BOX 387
Wentzville, MO 63385

=====

EDGAR D. GOODING
900 IVANHOE
CLEBURNE, TX 76031

5 NOV 1995

Dear Cousin Ed,

Thanks for yours of 31 OCT 1995 which I have now received. I am almost keeping up with you!

The details on the David Robert H family are most welcome. He is a son of James R. H who was a brother to William Henry H, I whose picture you sent to me. Enclosed is a copy of the Master Outline for James R. H and his children with continuation section 75 which covers descendants of David Robert H. Previously I had only the name Pleshing Earl H so the details on 75 C are new to me. I will welcome more information on the family. Note that David Robert I have the full name David Robert Lawrence which may or may not be correct. Also some records show him as Robert David H.

I have corrected my records to show the correct information on where the children of Will Rogers H were married. It was good of you to go to the courthouse to check these details.

Enclosed is an updated set of questions on the family of Susie May (Gooding) Williams. We keep getting closer. My main concern now is to know the 1st & 2nd names of the two sons of Herman Nelson Melham. We have their names - but which was 1st and which 2nd.

For the Mary Wilmetts (Gooding) Nriely family we are in great shape. The only missing detail is the date and place of birth of Larry Tab Randolph.

Thanks for the tip on Norma Jean - I'll treat the issue carefully.

I had not heard the story about the potatoes. It is true, I think, that we tend to make our ancestors more glorious than they were. For the Upchurch family we often have to say "they were the salt of the earth" - which is supposed to be something good.

I am in the process of preparing for the next issue of the U B which we hope to print before Thanksgiving. Enclosed is a draft of an article to be included concerning the 1880 TX census. Let me know if you have comments, corrections, etc. Thought you would like to have this as a base of understanding. Also, there is a partially done the way for our trip to TX next MAR/APR.



Sincerely yours
Phil Upchurch

(ROBERT PHILIP UP/CHURCH)

MISSING DETAILS ON THE FAMILY 510001993
OF SUSIE MAY (GOODING) WILLIAMS

- 1) For Susie May Gooding & Husband - All OK.
- 2) For Gilbert Mosey Williams
 - a) when in 1914 was he born?
 - b) Is he still living?
 - c) when and where did he marry?
 - d) Did he have children? If so, details?
 - e) For Alvie Groenbech
 - i) what was her full maiden name?
 - ii) when and where born?
 - iii) still living?
- 3) For Herman Meldan Williams
 - a) where is he buried?
 - b) when and where did he marry?
 - c) For Dixie NMM Dessett
 - i) when and where born?
 - ii) still living?
 - d) For Stanley Meldan Williams
 - i) was his wife Loretta Ann maiden name spelled WILKS, WILTS?
 - ii) Need to clarify dates of marriage, which was 1st & 2nd wives and which wife was mother of which children?
 - iii) when and where did Michelle Rene Williams marry?
 - iv) when and where was Ruben Gene Tamblinga born?
 - v) Do Michelle & Ruben have any children?
 - e) For Samuel Herman Williams
 - i) where did he marry Margarete-Susanne Reinhardt?
 - ii) when and where was Margarete Susanne Reinhardt born?
 - iii) Need to confirm dates of marriage & which was 1st wife
 - iv) Is Kersta Marie Williams still single?

EDGAR DALTON GOODING

XJD-35516

REC'D
3 NOV 1995

1900 IVANUDE
CLEBURNE, TX 76031

Dear Cousin Robert

Oct 31, 1995

Thought I should answer your letter of 21 Oct even though I have very little additional information to forward to you. I am not through with the Upchurch families in this area. The more I find the more seem to pop up. Just yesterday afternoon I found a new branch I believe will lead back to a new line. The early information is as follows:

David Elword Upchurch Sr. b. 7 Sept 1948 in Hillsboro, Hill Co., TX
m. Edna Darlene Pearson 1 Mar 1969 b. 31 Aug 1949 in Houston, Harris
Co., TX. Their Children are:

#1. David Edward Upchurch Jr. b. 21 Mar 1970 Fort Worth, Tarrant
Co., Tx. m. Cheryl Denise Miles b. 9 Sept 1972 in Fort Worth,
Tarrant co., TX. 10 June 1991 in Fort Worth, Tarrant Co., Tx

#2. Denesa Darlene Leoda Upchurch b. 15 Dec 1974 in Fort Worth, Tx.
m. Rudulpho (nmn) Ponce b. 27 Sept 1974 in Mexico.

David Jr. & Cheryl have two children. #1. David Elword Upchurch III
b. 29 Jul 1993 in Fort Worth, Tarrant Co., TX. #2. Austin Blake
Upchurch b. 8 Mar 1995 in Fort Worth Tarrant Co., Tx.

Denesa Darlene & Rudolpho (NMN) Ponce have one child. Sydney Brooke
Ponce b. 29 May 1994

The father of David Elword Upchurch Sr is Pershing Earl Upchurch
who now lives in a nursing home in Hillsboro and his wife is dead.

Her name was Dorothy Jean Cunningham Gant. He was married several
times.

The father of Pershing Earl was David Robert but no further info.
I intend to go to Hillsboro soon to follow up on this line. Also
I am not through with the Upchurch line in Eastern Johnson County.
One correction on that line. The places of birth given on the

children of Will Rogers Upchurch and Janie Adele Pope is in error.
The cities named are where they were married not born. I went to

the Johnson County Courthouse here and found marriage dates on 3
of the children of this couple as follows: John Paul Upchurch and
Patricia Leona Sanders were married 7 Jan 1982 in Willow Springs

Johnson County, TX. Lillie Louella Upchurch and Curtis Lynn Erwin
were married 5 Nov 1976 in Cleburne, Johnson Co., TX. David Wayne
Upchurch and Rhonda Raye Henry were married 31 Oct 1991 in Grand-
view, Johnson Co., Tx. Now that is straight so lets move on.

(ALSO CHANGED FOR FIRST FOUR CHILDREN OF WILL ROGERS)

Enclosed is details on the Mary Wilmerth Gooding.

It seems a trip to Austin is going to be necessary to straighten
out the information on the family of Susie May (Gooding) Williams
and Walter Eugene Gooding. This will be for my files as well as
yours. A word of caution here and please don't start a family fued.
Be careful with information from Norma Jean Daniell. It seems if
the information she obtains does not fit she will make it fit.
Bless her heart she seems to be determined to connect the Gooding
line with

□ line with one Frank Gooding who established Gooding, Idaho and the
□ county was named for him. He was eventually Governor of the state.
□ I have been curious for years where the city got its name so wrote
□ to the County Clerk years ago and she sent me his history. He is not
□ connected to our lineage as yet. Also her grandmother was named Lee.
□ Now she is claiming she is related to Robert E. Lee. I love her and
□ try to help her every way I can but you must be careful with her
□ information. I requested you to write to her for her family info
□ for that reason. She has sent me several different dates on various
□ members of her family and when I question her she makes it fit. I
- am telling you this in confidence so again please keep it that way.

□ Enclosed is a corrected family sheet on the family of Samuel Herman
270 + 20 Willams and Stanley Weldon Williams I obtained from my sister who
240 + 20 obtained it from Dixie(NMN) Dorsett. I believe this is correct. I
□ will double check this information when I go to Austin to get the
- other family information straightened out. You may wish to hold this
□ until you hear from me again in case it is still not correct.

□ I am shure you have heard the saying about the potato.

- "If you base your present worth on your ancestry you are like a
- potato, the best part is underground."

- Sincerely,

□ 

Missing Details on many Wilment Micely

□
△ (2) a. Deie Scott Kennedy died in Lake Jackson Matagorda Co. TX.
△ 19 Dec 1968. She was buried Pilot Grove Cem. Grayson Co. TX

△ b. Edgar Webster Micely married 2nd time in Lake Jackson
- Matagorda Co. TX on 7 Sept 1974

△ c. 2nd wife was Elise Ruth Gentry mat Mary. She was
- born in Taft, San Patricio Co. 19 Oct 1917 and is living.

△ (3) a. Ruth Marie Chesser was born 19 July 1925 in Whitehouse
△ Fannin Co. TX. and she is still living.

△ b. Kristi Lee Ann Micely was married in Whitehouse
- Fannin Co. TX.

□ Larry Tab Randolph is new to the family and information
- is scarce. ??? more when available.

△ (4) Christine Micely was married 5 Sept 1947 in Denison ^{Grayson} Co. TX

△+△ (5) Farm of Joe Frank Micely father of Kenneth Joe Micely
- is located 5 mi N.W. of Telephone Fannin Co. TX
△ i Lindsay Rene Patton born Sherman Grayson Co. TX
△ ii Cory Delane Patton born same.

Family Group Record ^{Sally} Grandchildren of May Gooding Williams

Write places as: Tryon, Polk, NC or St. Martins, Birmingham, Warwick, Eng.

Husband's name		Stanley Weldon Williams		SOURCES OF INFORMATION	
Born	21 Aug 1909	Place	Travis Co. Austin, TX.	Deitel (WMA) Darsett	
Chr.		Place			
Mar.	22 Jan 1957	Place	Austin, Travis Co. TX		
Died		Place			
Bur.		Place	Living		
Father	Norman Weldon Williams		Mother	Leila (WMA) Darsett	
Husband's other wives	Janetta Wilks #2 no issue.				
Wife's name					
Lebbie Lawden					
Born	2 Jan 1970	Place	Austin, Travis Co. TX	Same	
Chr.		Place			
Died		Place			
Bur.		Place			
Father		Mother			
Wife's other husbands					
Children List each child (whether living or dead) in order of birth					
1 Sex	F	Name	Michelle Rene Williams	Spouse	Ruben Gene Tambunga
Born		25 Aug 1971	Place	Austin Travis Co. TX	
Chr.			Place		Same
Mar.			Place		
Died			Place		
2 Sex	F	Name	Mindy Gayle Williams	Spouse	
Born		28 Feb 1981	Place	Austin, Travis Co. TX	Same
Chr.			Place		
Mar.			Place		
Died			Place		
3 Sex	M	Name	Adam Joseph Williams	Spouse	
Born		26 Aug 1986	Place	Austin Travis Co. TX	
Chr.			Place		
Mar.			Place		
Died			Place		
4 Sex		Name		Spouse	
Born			Place		
Chr.			Place		
Mar.			Place		
Died			Place		
5 Sex		Name		Spouse	
Born			Place		
Chr.			Place		
Mar.			Place		
Died			Place		
Other marriages and necessary explanations					

Wri. me as: Christian Joseph STEVENSON
Write date as: 5 Aug 1988

Family Group Record

Write places as: Tryon, Fuil, NC or St. Martins, Birmingham, Warwick, Eng.

Husband's name		<i>Samuel Herman Williams</i>		SOURCES OF INFORMATION
Born	<i>29 Jan 1952</i>	Place	<i>Austin, Travis Co TX</i>	<i>Wife Dorsett</i>
Chr.		Place		
Mar.	<i>3 Feb 1968</i>	Place	<i>Austin, Travis Co TX.</i>	
Died		Place		
Bur.		Place		
Father	<i>Herman Weldon Williams</i>		Mother	<i>Wife (Wm) Dorsett</i>
Husband's other wives		<i>Marjorie Susanne Reinhardt (H) Missouri.</i>		
Wife's name		<i>Susan Marie Watts</i>		
Born	<i>6 June 1960</i>	Place	<i>Austin, Travis Co. Texas</i>	<i>Sam</i>
Chr.		Place		
Died		Place		
Bur.		Place		
Father		Mother		
Wife's other husbands				
Children List each child (whether living or dead) in order of birth				
1 Sex	<i>F</i>	Name	<i>Keisha Marie Williams</i>	Spouse
Born	<i>4 Mar 1969</i>	Place	<i>Austin, Travis Co. TX</i>	<i>Sam</i>
Chr.		Place		
Mar.		Place		
Died		Place		
2 Sex		Name		
Born		Place		
Chr.		Place		
Mar.		Place		
Died		Place		
3 Sex		Name		Spouse
Born		Place		
Chr.		Place		
Mar.		Place		
Died		Place		
4 Sex		Name		Spouse
Born		Place		
Chr.		Place		
Mar.		Place		
Died		Place		
5 Sex		Name		Spouse
Born		Place		
Chr.		Place		
Mar.		Place		
Died		Place		
Other marriages and necessary explanations				

Wri. me as: Christian Joseph STEVENSON
Write date as: 5 Aug 1988

EDGAR DALTON GOODING

XJD-35561

REC'D
17 OCT 1995

Dear cousin Robert,

October 11, 1995

Well, I believe I finally gathered as much information as is available on the Johnson County Upchurch clan. As I told you in my previous letter it has been a difficult struggle because very few if any had any records in writing. The search began in Alvarado but wound up just about all over Eastern Johnson County and into Hill County. I believe I have the pages numbered in order of the families but you may find them in error. Please check them carefully as I know you will.

I walked cemeteries in both Johnson and Hill counties and found grave markers for many of those listed. I also checked the Johnson County court records for marriage or birth dates on the Will Rogers Upchurch children without results. He nor his wife had any records of their dates of birth or marriage. Only who they were married to and not all of them. I got the best break from a tip from Will Rogers Upchurch on a Steve Bullard in Cleburne. I contacted him and learned he is researching the Upchurch and Whitehead families. I obtained a lot of good info from him. I know these are far from complete but I gleaned every dropped of information available.

It would appear this group of the Upchurch clan is tied in with the North Carolina or Virginia clan as most of them originate from William Henry Upchurch, a veteran of the Civil War. I am enclosing his pension number I obtained from the Confederate Library on the Hill College Campus in Hillsboro. Also the forms you can send for his military record if you wish. I could have gotten it but thought you might already have it. I did obtain a copy of his unit number and rank. He and his son, Anderson Brace Upchurch are the progenitors of the Johnson County clan.

SENT IN
FORMS
1 NOV 1995

There is one exception and that is Kenneth Odell Upchurch. I am not able to connect him to the others by name. He does not know if he is related or not. The Hill county court house burned completely last year and destroyed all records but I found a Funeral home there with the most complete set of records I have ever seen for a funeral home. Most of the Hill County information came from there.

I am stuck on my Gooding line with my G-G-grandfather William P. Gooding in South Carolina. I have contacted every source I know but it seems Sherman didn't leave much on his march to Atlanta. If you have an entree in that area I would appreciate you letting me know. I would like to get behind him and see where the Gooding line goes. I have all his children's bonds of marriage and they only show South Carolina and married in Eastern Tennessee with no counties. Hope this meets with you approval.

Sincerely,

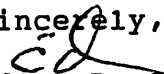
Edgar D. Gooding
900 Ivanhoe
Cleburne, Texas 76031

Family Group Record

3

Write places as: Tryon, Polk, NC or St. Martins, Birmingham, Warwick, Eng.

Husband's name		Mansion Francis Upchurch		SOURCES OF INFORMATION
Born	28 Aug 1886	Place	Prospect Bradley Co. Tennessee	Personal
Chr.		Place		W. H. H. H. H.
Mar.	1 Jan 1910	Place	Itasca Hill Co. TX	William
Died	2 CA 1936	Place	Itasca Hill Co. TX	Howard
Bur.		Place	" Cemetery	
Father	William Henry Upchurch		Mother	Lydia Margaret St Hughes
Husband's other wives				
none				
Wife's name		Winnie Margaret Scott		
Born		Place		
Chr.		Place		
Died		Place		
Bur.		Place		
Father			Mother	
Wife's other husbands				
Children List each child (whether living or dead) in order of birth				
1 Sex	M	Name	Harry Walland Upchurch	Spouse
Born		Place	Greenbriar Johnson Co. TX	
Chr.		Place		
Mar.		Place	Winnie from stroke wife has Terminal Cancer?	
Died		Place	(Living Itasca Hill Co. TX)	
2 Sex	M	Name	William Howard Upchurch	Spouse
Born		Place	Greenbriar Johnson Co. TX	#1 Rosa Suelle McCord
Chr.		Place		#2 Ellen Margaret Heston
Mar.		Place		
Died		Place		
3 Sex	M	Name	Hubert Albert Upchurch	Spouse
Born		Place	Itasca Hill Co. TX	
Chr.		Place		
Mar.		Place		
Died		Place		
4 Sex	M	Name	Hubert Harold Upchurch	Spouse
Born		Place	Itasca Hill Co.	
Chr.		Place		
Mar.		Place		
Died		Place		
5 Sex	F	Name	Alice Marie Upchurch	Spouse
Born		Place	Itasca Hill Co. TX	
Chr.		Place		
Mar.		Place	#6 M. Mansion Edwin Upchurch	
Died		Place	Born 29 Feb 1924 Itasca Hill Co. TX	
Other marriages and necessary explanations				

Wri. me as: Christian Joseph STEVENSON
Write date as: 5 Aug 1988

Family Group Record

4

Write places as: Tryon, Polk, NC or St. Martins, Birmingham, Warwick, Eng.
 Write me as: Christian Joseph STEVENSON
 Write date as: 5 Aug 1988

Husband's name		Joseph Albert Upchurch		SOURCES OF INFORMATION
Born	CA 1903	Place	Wet Country	Personal Knowledge with Pastor Upchurch
Chr.		Place		
Mar.		Place		
Died		Place		
Bur.	Anderson	Place	Itasca Hill Co. Itasca Cemetery	
Father	Albert Bruce Upchurch	Mother	Dixie Arona Whitehead	
Husband's other wives		Albert Bruce Upchurch		
Wife's name		Lou Ella Williams		
Born	CA 1913	Place	Hill Co. TX Hill Co.	
Chr.		Place		
Died	CA 1956	Place	Hill Co. - Itasca Co.	
Bur.		Place	Itasca Cemetery	
Father		Mother		
Wife's other husbands				
Children List each child (whether living or dead) in order of birth				
1 Sex	F	Name	Wilma Louise Upchurch	Spouse
Born		Place		J. R. (only) Hillman
Chr.		Place		
Mar.		Place		
Died		Place		
2 Sex	F	Name	Dixie Betty Jean Upchurch	Spouse
Born		Place		Fernis Shipman
Chr.		Place		
Mar.		Place		
Died		Place		
3 Sex	M	Name	Will Roscoe Upchurch	Spouse
Born		Place		Jane Adelle Pope
Chr.		Place		
Mar.		Place		
Died		Place		
4 Sex	F	Name	Arletta Sue Upchurch	Spouse
Born		Place		Morris Mc Sanghlin
Chr.		Place		
Mar.		Place		
Died		Place		
5 Sex	M	Name	Cecil Dean Upchurch	Spouse
Born		Place		
Chr.		Place		
Mar.		Place		
Died		Place		
Other marriages and necessary explanations				
(over)				

Family Group Record

5

Write places as: Tryon, Polk, NC or St. Martins, Birmingham, Warwick, Eng.

Husband's name		William Howard Upchurch		SOURCES OF INFORMATION
Born	Place	7-Sept 1913	Greenbriar Johnson Co TX	
Chr.	Place			Personal Knowledge
Mar.	Place			
Died	Place			
Bur.	Place		(Graves) in Frankliew Johnson Co.	
Father	Place	Manion	Upchurch	Mother
Husband's other wives	#2 Ellen Margaret Nightowier (no issue)			
Wife's name		Rosa Lucille Mrs Coyd		
Born	Place	1 Oct 1914	Waco - MacKenna Co. TX	
Chr.	Place			
Died	Place	1-Nov. 1976	Monkhouse Ward Co. TX	
Bur.	Place		Same	
Father	Place			Mother
Wife's other husbands				
Children List each child (whether living or dead) in order of birth				
1 Sex	Name	Billy Howard Upchurch		Spouse
Born	Place	5 Oct 1939	Gorman Eastland Co. TX	
Chr.	Place			
Mar.	Place			
Died	Place			
2 Sex	Name	Gary Eugene Upchurch		Spouse
Born	Place	17 Sept 1949	Gorman Eastland Co. TX	
Chr.	Place			
Mar.	Place			
Died	Place			
3 Sex	Name	Bobby Joe Upchurch		Spouse
Born	Place	24 Nov 1953	Gorman Eastland Co. TX	
Chr.	Place			
Mar.	Place			
Died	Place			
4 Sex	Name			Spouse
Born	Place			
Chr.	Place			
Mar.	Place			
Died	Place			
5 Sex	Name			Spouse
Born	Place			
Chr.	Place			
Mar.	Place			
Died	Place			
Other marriages and necessary explanations				

Wri. me as: Christian Joseph STEVENSON
Write date as: 5 Aug 1988

Family Group Record

Husband's name		Will Rogers Upchurch		SOURCES OF INFORMATION	
Born	2 Mar 1931	Place	Clchuone Johnson Co. TX	Personal	
Chr.		Place		Knowledge	
Mar.	15 Dec 1949	Place	Clchuone Johnson Co. TX	Will Rogers	
Died		Place		Upchurch	
Bur.	1995	Place			
Father	Joseph Albert Upchurch		Mother	Lou Ella Williams	
Husband's other wives					
Wife's name					
Janie Adelle Pake					
Born	8 Mar 1930	Place	Alvarado Johnson Co TX		
Chr.		Place			
Died	Jan 1995	Place			
Bur.		Place			
Father			Mother		
Wife's other husbands					
Children List each child (whether living or dead) in order of birth					
1	Sex	Name	Spouse		
F		Dorothy Jean Upchurch	James Daugherty		
Born		Place			
Chr.		Place			
Mar.		Place			
Died		Place			
2	Sex	Name	Spouse		
M		Jenny Gae Upchurch	Danny Englehart		
Born		Place			
Chr.		Place			
Mar.		Place			
Died		Place			
3	Sex	Name	Spouse		
M		Roger Dean Upchurch	Anne Vassar		
Born		Place			
Chr.		Place			
Mar.		Place			
Died		Place			
4	Sex	Name	Spouse		
F		Wilma Louis Upchurch	Leonard O'Pray		
Born		Place			
Chr.		Place			
Mar.		Place			
Died		Place			
5	Sex	Name	Spouse		
M		John Paul Upchurch	Patricia Ann Sanders		
Born		Place			
Chr.		Place			
Mar.		Place			
Died		Place			
Other marriages and necessary explanations					
Over					

Write places as: Tryon, Polk, NC or St. Martins, Birmingham, Warwick, Eng.

Wri. me as: Christian Joseph STEVENSON
Write date as: 5 Aug 1988

Family Group Record

9

Write places as:
of St. Martins, Birmingham, Warwick, Eng.
Tryon, Polk, NC

Wri. me as: Christian Joseph STEVENSON
Write date as: 5 Aug 1988

Husband's name		Richard Lawrence Upchurch Sr.		SOURCES OF INFORMATION	
Born	CA 1857	Place	Alabama (Indian Territory) or Georgia		
Chr.		Place			
Mar.		Place	(Reported to be 1/2 Cherokee)		
Died		Place			
Bur.		Place			
Father		Mother			
Husband's other wives					
Wife's name		Cynthia Paroline Greene		Personal examples Kenneth Upchurch	
Born	26 Oct 1864	Place	Indian Territory (Alabama or Georgia)		
Chr.		Place			
Died		Place			
Bur.		Place			
Father	Cynthia Caroline Greene was (orphan) girl of 16 when she was stolen by Richard L. Upchurch who made her his wife.				
Wife's other husbands					
Children List each child (whether living or dead) in order of birth <i>she had a given English name by Richard.</i>					
1 Sex	F	Name	Lizzie Upchurch		Spouse
Born	PA 1884	Place	Arkansas		Houston L. Frankes
Chr.		Place			
Mar.		Place			
Died		Place			
2 Sex	F	Name	Callie Upchurch	Spouse	
Born	CA 1886	Place	Arkansas		
Chr.		Place			
Mar.		Place			
Died		Place			
3 Sex	F	Name	Wallie Upchurch	Spouse	
Born	CA 1886	Place	Arkansas		
Chr.		Place			
Mar.		Place			
Died		Place			
4 Sex	F	Name	Ezra Brandon Upchurch	Spouse	
Born	CA 1890	Place	Texas		
Chr.		Place			
Mar.		Place			
Died		Place			
5 Sex	M	Name	George Oliver Upchurch	Spouse	
Born	CA 1892	Place	Texas		
Chr.		Place			
Mar.		Place			
Died		Place			
Other marriages and necessary explanations					

Kenneth lives 1002 Fannin
Alvarado, TX.
Johnson Co.

Family Group Record

9

Husband's name		SOURCES OF INFORMATION	
Kenneth Odell Upchurch		Personal knowledge	
Born	12 Jul 1928 Place Ft Worth Tarrant Co. TX		
Chr.			
Mar.	15 June 1950 Place Fairfield Freestone Co. TX		
Died			
Bur.			
Father	Richard Lawrence	Mother	Willie Gene Massaway
Husband's other wives		EFFIE DELIGHT CHEVRON - B. 12 JUL 1923 IGN, WASHINGTON	
Wife's name		SOURCES OF INFORMATION	
Ruby Lou mill Cooper		Personal knowledge	
Born	20 June 1933 Place Fairfield, Freestons Co. TX		
Chr.			
Died			
Bur.			
Father		Mother	
Wife's other husbands			
Children List each child (whether living or dead) in order of birth			
1 Sex	Name	Spouse	
M	Kenneth Odell Upchurch Jr.		
Born	4 Oct 1951 Place Buffalo, Freestone Co TX		
Chr.			
Mar.			
Died			
2 Sex	Name	Spouse	
F	Bonnie Leona Upchurch		
Born	24 Oct 1953 Place Pentalis, new milico		
Chr.			
Mar.			
Died			
3 Sex	Name	Spouse	
M	Fred Robert Upchurch		
Born	16 Aug 1955 Place Lubbock, Lubbock Co. TX		
Chr.			
Mar.			
Died			
4 Sex	Name	Spouse	
F	Cindy Jan Upchurch		
Born	20 Mar 1958 Place Arsanillo, Patter co. TX		
Chr.			
Mar.			
Died			
5 Sex	Name	Spouse	
F	Patricia Lynn Porter (adopted)		
Born		Spain (military family)	
Chr.			
Mar.	Mark Paul Porter (adopted)		
Born		B. Oklahoma City, Oklahoma Co. OK.	
Died			
Other marriages and necessary explanations			

Write places as:
Tryon, Polk, NC or St. Martins, Birmingham, Warwick, Eng.

Wri. me as: Christian Joseph STEVENSON
Write date as: 5 Aug 1988

EDGAR DALTON GOODING

XFD-35561

REC'D
26 OCT 1995

EDGAR D. GOODING
900 IVANHOE
CLEBURNE, TX 76031

①

Dear Cousin Robert,

Oct 24, 1995

A few corrections and bit of additional information to some of our previous correspondence. First, regarding the additional information requested on the family of Hattie Dosia Neal: [nee HATTIE DOSIA BUTTLER]

- △+△ She now lives in Houston and is not in the best of health. She did not know when Robert Joseph Buttler was born in 1918 nor when he died in 1919. She said she never heard her mother say anything about Robert. Her 1st, 2nd and 3rd marriages were as follows:
 - △ #1. Married Grant (NMN) Payne 5 Jan 1938
 - △ #2. Married Henry Ottenhouse 24 Aug 1957
 - △ #3. Married Harold Neal 16 April 1967

△+△ Grant Payne had no middle name. He was born 11 Mar 1913 in Louisiana. He died 26 Dec 1956 in Uvalde, Uvalde County, TX. Buried same.

△+△ Henry Mitchell Ottenhouse (no H in last name). He was born 12 June 1922 in Uvalde, Texas. They were divorced in 1960 and he is still living.

△+△ Harold Vincent Neal was born 16 Apr 1921 in Kansas. He died 22 Oct 1967 in Bakersfield, California.

△+△ Joe David Buttler, son of Hattie Dosia, had no children.

△ Ila Mae Wiley was born 11 Sept 1936 in Louisiana.

△+△ The full name of Alma Lopez is unknown as she was born in Mexico.

△ Amy Ottenhouse was born 31 Jul 1958 in Uvalde, Texas.

At the bottom of the page of questions I sent her was the following information. I could not find where I had requested it but I will send it along:

→? △+△ Hattie Dosia Neal's first child was Mary Estelle Payne B. 12 Nov 1939 in Fort Sam Houston, Bexar County, Tx. She married Joseph Dean Long 14 Sept 1957 in Uvalde, Texas. Joseph Long was born 9 Mar 1936 in Freer, Duval Co., TX. Their children were as follows:

- ? △ #1. Judy Anne Long b. 5 Sept 1958
- △ #2. Carrie Sue Long b. 21 Apr 1959 d. 22 Apr 1959
- △ #3. Milton Joseph Long Jr. b. 1 Aug 1960
- △ #4. James Bradley Long b. 6 Aug 1962 d. 17 Jun 1973

△+△ Hope this fills in some blanks for you. As I said Hattie Dosia is four years older than I and I am 71 years old. She is the only member of her family left and her health is failing. I believe this just about rung her out as far as family information.

Sincerely,

ED

↓

[PHOTO FILE 95-11]

△ Please find attached picture of William Henry Upchurch and his wife
△+△+△+□ Lydia. They are both buried in the Alvarado Cemetery as I have seen
□+△ both their headstones. His son was Anderson Brace Upchurch who is
△ buried in the Falls Creek Cemetery in Hood County. Steve Bullard,
- from whom I obtained these photos, has been to that cemetery and
△ has seen the headstone of Anderson Brace Upchurch.

△ He had the original photograph and had copies made from the original
△ and they added a tint of yellow to make it look older. Steve gave me
△+△ most of the information I sent you in the family group sheets. He
□ would like very much to make a swap for his lineage back from William
△+△ Henry Upchurch. He gave me a name of a person he thought was the
□+□ father of William Henry Upchurch and I put it on his family group
- sheet but in your conversation by phone you stated the it was not
□+□ correct. I mentioned this to Steve and he agreed that your information
□+□ was probably correct as he was giving me the information from memory.

I made a trip to the National Archives in Fort Worth in an attempt to locate a record of some of the Upchurch families in Northern Johnson County but was unable to locate any records there. The lady assisting me said I would probably have much better luck with the more recent families from the Fort Worth Public Library. I intend to make a paseado up that way in the next day or two to see what I can find. I need to go up there anyway to look up some records on my Gooding line. Also my Mother's family. While there I will keep the Upchurch line in mind. The Jesse L. Upchurch on Jay Lane in Burleson may not be back from Africa for several weeks.

[NEE NELLIE ELZA WINSLETT]

△* My mother was a Winslett. Her father was Arthur Gibson Winslett. He was born in Henderson County near Athens and as a young man his father moved to Hood County. My grandfather left home at 14 and worked for cattle outfits all over north Texas and Eastern New Mexico. It is believed he married my grandmother in Cheyenne, Roger Mills County, Oklahoma but I have been unable to confirm this. My mother was born in Tucumcari, New Mexico but New Mexico has very skimpy records or none at all. According to family lore he was a typical rowdy Texas cowboy. He married at 28 and by then the range had been fenced and he moved from pillar to post apparently looking for the open range he had once know but no longer existed. He scattered kids from Northern New Mexico to South Texas and it has been one wild ride chasing them down.

I have gotten completely off the subject matter of this letter so I will close and get this in the mail. Hope you had a safe trip to New York and are safely back home by the time this letter gets there. Thank you for the information you have given me and I hope I can run down some of the Upchurch families up North.

Sincerely,
Ed

* COPIED FOR BIOFILES OF:
△ NELLIE ELZA WINSLETT
△ ARTHUR GIBSON WINSLETT
** COPIED FOR BIOFILE OF STEVE BULLARD

- The following is some additional information on the JOhnson County
Upchurch clan. As I said before these people seem to know very little
about each other but I got them to scratching their heads and came up
- with the following additional information.

→ □ + ? For the children of Will Rogers Upchurch and Adele hughes

- △ #1. Dorothy Jean Upchurch b. 26 Dec 1950, Kennedale, Johnson Couty., TX
- △ #2. Henry Joe Upchurch b. 13 Feb 1953, Alvarado, Johnson Co. TX
- △ #3. Roger Dean Upchurch b. 2 Apr 1955, Weatherford, Parker Co., TX
- △ #4. Wilma Louise Upchurch b. 10 Dec 1956 Fort Worth, Tarrant Co., TX
- △ #5. Lillie Louella Upchurch b. 1 May 1960 Cleburne, Johnson Co., TX
- △ #6. John Paul Upchurch b. Willow Springs, Johnson Co., TX b. 19 Nov 1963
- △ #7. David Dwayne Upchurch b. 18 Jan 1966, Grandview, Johnson Co., TX

□ For Family of Joseph Albert Upchurch

- △ #1. Joseph Albert Upchurch b. 4 mar 1907 d. 12 May 1965, Cleburne Johnson Co., Tx bur. Alvarado Cemetery. Born Hill County
- △ #2. Lou Ella Williams b. 11 Jan 1910, Hill County d. 12 Sept 1956 ALvarado, Johnson Co., Tx bur. Alvarado Cemetery. m. 20 Jun 1924

□ + □ Children of Joseph and Lou Ella:

- △ #1. Wilma Louise Upchurch b. 22 Sept 1925
- △ #2. Dixie Billye Jean Upchurch b. 28 Aug 1927
- △ #3. Joseph Thomas Upchurch b. 10 Apr 1929 d. 1992 Bur. Tye Cemetery Johnson County, Burleson, TX. Industrial accident, welder-Alabama.
- #4. Will Rogers Upchurch b. 2 Mar 1931 m. 15 Dec 1949
- △ #5. Arletta Sue Upchurch b. 6 Mar 1933
- △ #7. Sally Marcele UPchurch b. 19 Sept 1937
- △ #8. Frank Anderson Upchurch b. 8 Jul 1947
- △ #6. Cecil Dean Upchurch b. 8 Apr 1935 (out of sequence)

→ □ You mentioned a Kenyon Brannon Upchurch but I have been unable to locate the name in JOhnson County so far. Will Keep trying

△ * { Also the Upchurch failies in Burleson, northern Johnson County and Southern Tarrant County (Fort Worth) are as you said, very, very wealthy. The one that seems to have all the records is a Jesse L. Upchurch at 109 Jay Lane, Burleson. I went to his house twice. The first time I could find nobody except a mexican stable boy. Jesse has a string of polo ponies, stalls, polo field with everything groomed to perfection. The boy could not speak English but I speak Spanish and learned Jesse was not at home. The stable boy said they were going to have a polo match that afternoon around 3 PM. I never liked to bother a man at work or play so I came back the next day. I struck up a conversation with the stable boy and finally learned Jesse and his wife, his brother and wife are all on a photo safari in Africa. The stable boy said they sometimes stay several weeks. The boy did tell me Mr. Upchurch was originally from Kentucky and he sometimes buys horses for his polo string there and ships them to his home in Burleson. If I can get next to this gentleman I might strike a bonanza of information. Then again I may get the boot.

Ed

EDGAR DALTON GOODING

XID35516

MICHAEL ENTERPRISES
P. O. BOX 387
Wentzville, MO 63385



21 OCT 1995

EDGAR DALTON GOODING
900 IVANHOE
CLEBURNE, TX 76031

Dear Cousin Ed,

As mentioned in our recent phone conversation I really appreciate the work you did on the Upchurch family in eastern Johnson Co, TX. I still need to review your letter of 11 OCT 1995 but it is clear these people belong to the Richard U, III / Cleburne U, I Subclan and to the Richard U, II line in that Subclan. I'll get back in touch on this group as soon as I have received your letter.

In the meantime, I wanted to respond to your letter of 7 OCT 1995 which has now been fully received. We are all indebted to you for your painstaking work in documenting the family of Theodosia Ernestine (Upchurch) Gooding. As you suggested, I have written to Norma Daniell in an attempt to get missing details for the descendants of Floyd Freeman Gooding. She and I had several exchanges in 1993 but I have not heard from her since. A copy of my 21 OCT 1995 letter to her is enclosed

Enclosed is an updated copy of the master outline for Theodora and her children and continuation sections for all 6 children. You will note we have a complete set of data for Theodora & her husband and their children and their spouses. We have a perfect set of details for all of the 37 individuals in your father's family so there are no more questions to ask there. We hope Norma will respond regarding the missing details on her father's family. This leaves four sets of questions for the other four children of Theodora. A single sheet for each of these is enclosed showing what is missing. The question is how to proceed from here on these four. Perhaps you have a few of the answers you could send these lists off to someone you think might answer, or if you prefer I will be glad to write someone if I have an address and a name to write. For the most part we are getting down to fine points that are not really critical. If we just need to move on to other aspects of family history, that will be OK. I don't want either you or I to push too hard where it is not likely to

be helpful. Your advice will be appreciated.

The Uplunch Group needs of you is of much interest. You mentioned a Jesse U over the phone and I recalled that this is one of our "uncounted" groups. Enclosed is a copy of the 3 page 5 items profile on Jesse L. U, Sr and one page on his son Jr. plus two other sheets on Jesse L. U which could be Sr or Jr or yet a 3rd Jesse L. U.

In due course I will be putting up our two week family history trip to TX. We are certain to pass through your part of TX. As I mentioned, I would like to give an Uplunch lecture somewhere in the Dallas / Ft Worth Area. It is a matter of finding a room that is reasonably nice that will hold up to 100 people (although only 20 may show up - you never can tell) and that is free or does not cost too much. Our trip should be in MARCH or APRIL 1996.

With deep appreciation for your continued interest and help.

Sincerely yours
Phil Uplunch

{ ROBERT PHILIP UPLUNCH }

MISSING DETAILS ON THE FAMILY
OF SUSIE MAY (GOODING) WILLIAMS

21 OCT
1995

- 1) For Susie May Gooding & Husband - All OK
- 2) For Herman Meldon Williams
 - a) where is he buried?
 - b) when and where did he marry?
 - c) For Dixie Dersett
 - i) what is her full maiden name?
 - ii) when and where was she born?
 - iii) Is she still living?
 - d) For Stanley Meldon Williams
 - i) when was his marriage to Debbie Anne Lowden?
(I have 22 JAN 1987 which seems wrong)
 - ii) when in JUN 1985 did he marry Lorella Ann Wultz?
 - iii) when and where was Debbie Anne Lowden born?
 - iv) did any of his children yet marry/have issue?
 - e) For Samuel Herman Williams
 - i) when and where was Susan Marie Watts born?
 - ii) where did he marry the 2nd time?
 - iii) when and where was Susanne Faye Reinhardt born?
 - iv) where was Keisha Marie Williams born and did she marry/have children?
- 3) For Gilbert Moses Williams
 - a) when in 1914 was he born?
 - b) Is he still living?
 - c) when and where did he marry?
 - d) did he have any children? If so, details?
 - e) For Alice Grosenbeck
 - i) what is her full maiden name?
 - ii) when and where was she born?
 - iii) Is she still living?

MISSING DETAILS ON THE FAMILY
OF MARY WILMERTH (GOODING) NICELY

21 OCT
1995

- 1) For Mary Wilmertha Gooding & Husband - All OK
- 2) For Edgar Webster Nicely
 - a) where did Eric Scott Kennedy die?
 - b) when and where did he marry the 2nd time?
 - c) For Mary Ruth Gentry
 - i) when & where born?
 - ii) still living?
- 3) For Orville Lee Nicely
 - a) when and where was Ruth Marie Chesser born? still living?
 - b) For Kristi Lee Ann Nicely
 - i) where did she marry?
 - ii) when and where was Larry Tab Randolph born?
- 4) For Christine NMN Nicely
 - a) when and where did she marry?
- 5) For Jack NMN Nicely - All OK
- 6) For Joe Frank Nicely & wife - All OK
 - a) For Donna Betty Nicely & family - All OK
 - b) For Kenneth Joe Nicely
 - i) where was his father's farm?
 - c) For Carla Renee Nicely
 - i) where was Lindsay Renn Patton born?
 - ii) where was Cary Delane Patton born?
 - d) For Eddie Randall Nicely & family - All OK.

MISSING DETAILS ON THE FAMILY
OF WALTER EUGENE GOODING

21 OCT 1995

- 1) For ~~Walter~~ Eugene Gooding & wife - All OK.
- 2) For Alena Mae Gooding & Husband - All OK
 - a) For Judy Alena Gooding
 - i) when and where was Kevin Lee Nelson born?
 - ii) Did she have children? If so, details?
 - b) For Joyce Marie Gelling
 - i) when and where was Lee Allen Nelson born?
 - ii) Did she have children? If so, details?
 - c) For Andy Lou Gelling
 - i) Full name of Roger Peterson and when and where was he born?
 - ii) Did she have children? If so, details?
 - d) For Carol Lea Gelling
 - i) where did she marry?
 - ii) when and where was Steven Ray Relusky born?
 - iii) Did she have children? If so, details?
- 3) For Clyde Eugene Gooding
 - a) where was he born?
 - b) when and where did he marry?
 - c) Full maiden name of Deborah Rose & when & where born?
 - d) Details on his children, if any?
- 4) For Jennie Paul Gooding
 - a) Is his wife's maiden name BURCHETT or BURCHETTE?
and when & where was she born?
 - b) Details on his children, if any?
- 5) For Lettie Marie Gooding
 - a) when did she marry?
 - b) Full name of John Fry and when & where was he born?
 - c) Details on her children, if any?

MISSING DETAILS ON THE FAMILY
OF SALLIE ORA (GOODING) BUTTLER

21 OCT 1995

- 1) For Sallie Ora Gooding & Husband - All OK
- 2) For Robert Joseph Buttler
 - a) when in 1918 was he born?
 - b) when in 1919 did he die?
- 3) For Hattie Rosia Buttler
 - a) Did she have just four children?
 - b) when & where were her 1st, 2nd & 3rd marriages?
 - c) Full name of Grand Payne, and when and where was he born? still living?
 - d) Full name of Henry Hattenhouse and when and where was he born? still living?
 - e) Full name of Henry Neal and when and where was he born? still living?
 - f) Is she still living?
 - g) For Mary Estelle Payne
 - i) when and where born?
 - ii) when and where married?
 - iii) Full name of Milton J. Long and when and where was he born?
 - iv) Did she have children? If so, details?
 - h) For Joe David Payne
 - i) when and where married?
 - ii) when & where was Maie Wiley born?
 - iii) Did he have children? If so, details?
 - i) For Jonathan Grant Payne
 - i) where born? ii) when & where married?
 - ii) Full maiden name of Alma Lopez & when & where born?
 - iii) Did he have children? If so details?
 - j) For Army Lynne Hattenhouse - i) when & where born?
ii) Did she marry/have issue? If so, details?
- 4) For William James Buttler - where born, where married?

Provided herewith is a copy of my 5 Page
 11 Item Biopic on John Yulurch, VI (XFO-143).
 He is your Greatgreat Grandfather and the father
 of Henry Alvin Yulurch. This John U, VI
 is the head of the George U / John U, VI
 Subdan. I thought you might be interested
 in this bit of family history.

Thanks for the copy of Theodosia's Bible.
 I have a special file for Bible records.

It now appears that our two week
 family history trip to Texas will be
 made next FEB or MAR rather than
 this fall. Too many things needed
 to be done. This will allow me
 more time to get my Yulurch
 Texas records in order. In the
 meantime I'll look forward to
 working with you by mail.

☺ Sincerely yours
 Phil Yulurch
 [ROBERT PHILIP UPLURCH]