

REC'D 17 SEP 1994
\$2.25

GOUSHA

(57)

OKLAHOMA

R O A D M A P

INCLUDING

Mini-Maps of Admore,
Bartlesville,
Enid, Lake Texoma
Recreational Area,
Lawton, Muskogee,
Oklahoma City,
Ponca City, Tulsa.

PLUS mileage
chart and list of public
recreational areas.



(79)

OKLAHOMA

1981 Map

OFFICIAL STATE TRANSPORTATION MAP
FOR FREE DISTRIBUTION



RAND McNALLY \$250

Oklahoma

STATE MAP

38

Including

- Bartlesville
- Lawton
- Muskogee
- Norman
- Oklahoma City
- Tulsa
- Ft. Smith, AR
- Joplin, MO
- Wichita Falls, TX

Plus

- Lake Texoma Recreation Area
- State Index
- State Park Chart
- Places of Interest
- Toll Road Chart
- City-to-City Mileage Log

ISBN 0-528-96974-9



UPC

6 70609696974 9

OKLAHOMA

9

AND METROPOLITAN MAPS OF OKLAHOMA CITY • TULSA

WITH CITY MAPS OF ARDMORE • BARTLESVILLE
ENID • LAWTON • MUSKOGEE • PONCA CITY
LAKE TEXOMA RECREATIONAL AREA

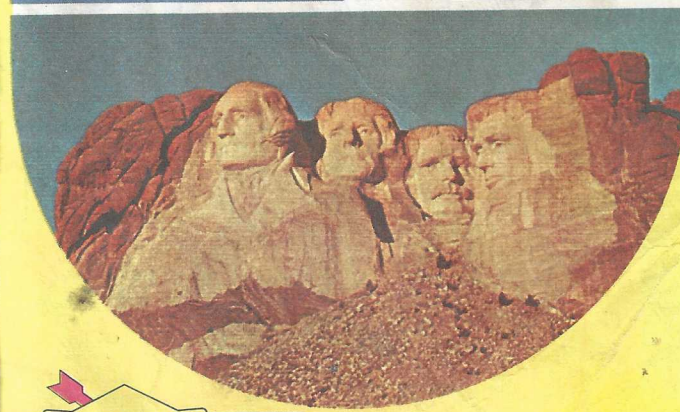
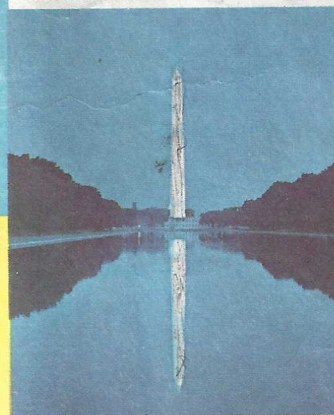

Sun Oil Company

OKLAHOMA

○ Input from 9 DEC 2011 Jk Lang Kent U & RPU re
 his ancestor/relative who moved from MS → TX → OK - TWINS
 - RPU
 12 DEC
 2011

Lang's Note: "This is a copy of a hand drawn diagram
 of Tussy, OK in the late Teen's or early twenties. It was
 drawn by W. D. Upchurch's
 nephew Jess Strickland.
 This was how Jess remembered
 it. His father was Sam Strickland,
 W. D. Upchurch's cousin"

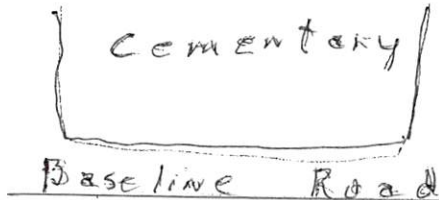

N
 ↑

W. D. Upchurch's
 nephew Jess Strickland.
 This was how Jess remembered
 it. His father was Sam Strickland,
 W. D. Upchurch's cousin"

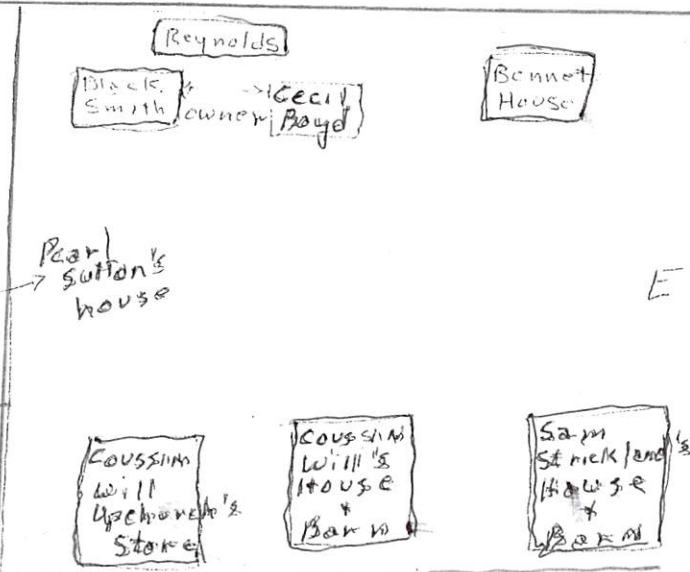
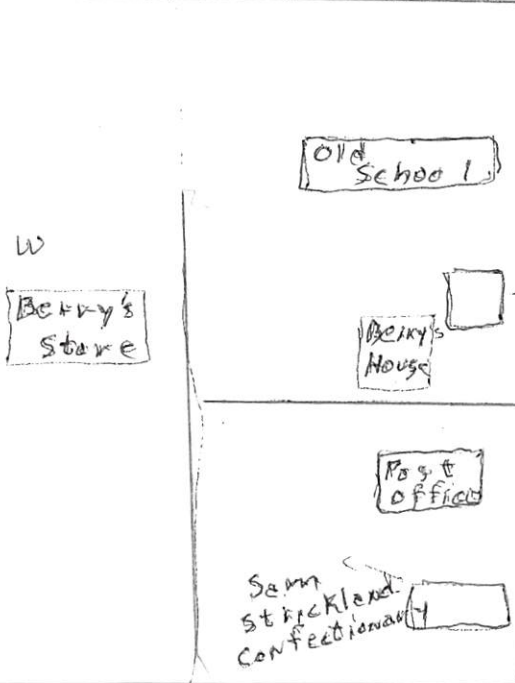

- I. Allen Strickland b 1988 (NO)
- A. David W^m Strickland
- △ 1. Samuel B. Strickland "SAM"
- △ a. Jesse Glenn Strickland "JESS" 1914 - 2008
- 2. Martha J. Strickland md (?) A.S. Upchurch b 1825 (NC?)
- a. David Allen U, I b 1871 d A2
- △ b. William Daniel U b 1871 d OK
- i. Roy Phillip U
- △ (j) Lang Kent U

COPY TO
 OK
 GEOGRAPHICAL
 FILE

