

NPS Form 10-900  
(Rev. 10-90)

OMB No. 1024-0013

United States Department of the Interior  
National Park Service

NATIONAL REGISTER OF HISTORIC PLACES  
REGISTRATION FORM

This form is for use in nominating or requesting determinations for individual properties and districts. See instructions in How to Complete the National Register of Historic Places Registration Form (National Register Bulletin 16A). Complete each item by marking "x" in the appropriate box or by entering the information requested. If any item does not apply to the property being documented, enter "N/A" for "not applicable." For functions, architectural classification, materials, and areas of significance, enter only categories and subcategories from the instructions. Place additional entries and narrative items on continuation sheets (NPS Form 10-900a). Use a typewriter, word processor, or computer, to complete all items.

1. Name of Property

historic name Caraleigh Mills

other names/site number Fred Whitaker Company

2. Location

street & number 421 Maywood Avenue not for publication N/A  
city or town Raleigh vicinity N/A  
state North Carolina code NC county Wake code 183 zip code 27619

3. State/Federal Agency Certification

As the designated authority under the National Historic Preservation Act of 1986, as amended, I hereby certify that this X nomination      request for determination of eligibility meets the documentation standards for registering properties in the National Register of Historic Places and meets the procedural and professional requirements set forth in 36 CFR Part 60. In my opinion, the property X meets      does not meet the National Register Criteria. I recommend that this property be considered significant      nationally      statewide X locally. (      See continuation sheet for additional comments.)

Jeffrey Crow SHPO  
Signature of certifying official

4/2/01  
Date

North Carolina Department of Cultural Resources  
State or Federal agency and bureau

In my opinion, the property \_\_\_\_\_ meets \_\_\_\_\_ does not meet the National Register criteria. ( \_\_\_\_\_ See continuation sheet for additional comments.)

\_\_\_\_\_  
Signature of commenting or other official \_\_\_\_\_ Date

\_\_\_\_\_  
State or Federal agency and bureau  
=====

4. National Park Service Certification  
=====

I, hereby certify that this property is:  
\_\_\_\_ entered in the National Register \_\_\_\_\_  
\_\_\_\_ See continuation sheet. \_\_\_\_\_  
\_\_\_\_ determined eligible for the \_\_\_\_\_  
National Register \_\_\_\_\_  
\_\_\_\_ See continuation sheet. \_\_\_\_\_  
\_\_\_\_ determined not eligible for the \_\_\_\_\_  
National Register \_\_\_\_\_  
\_\_\_\_ removed from the National Register \_\_\_\_\_  
\_\_\_\_ other (explain): \_\_\_\_\_

\_\_\_\_\_  
Signature of Keeper \_\_\_\_\_ Date  
of Action

5. Classification  
=====

Ownership of Property (Check as many boxes as apply)

- private
- public-local
- public-State
- public-Federal

Category of Property (Check only one box)

- building(s)
- district
- site
- structure
- object

Number of Resources within Property	
Contributing	Noncontributing
<u>  1  </u>	<u>  3  </u> buildings
<u>  0  </u>	<u>  0  </u> sites
<u>  1  </u>	<u>  0  </u> structures
<u>  0  </u>	<u>  0  </u> objects
<u>  2  </u>	<u>  3  </u> Total

Number of contributing resources previously listed in the National Register   N/A  

Name of related multiple property listing (Enter "N/A" if property is not part of a multiple property listing.)   N/A

=====

6. Function or Use

=====

Historic Functions (Enter categories from instructions)

Cat: INDUSTRY/PROCESSING/EXTRACTION Sub: Manufacturing Facility

\_\_\_\_\_

\_\_\_\_\_

\_\_\_\_\_

\_\_\_\_\_

\_\_\_\_\_

Current Functions (Enter categories from instructions)

Cat: WORK IN PROGRESS Sub: \_\_\_\_\_

\_\_\_\_\_

\_\_\_\_\_

\_\_\_\_\_

\_\_\_\_\_

\_\_\_\_\_

=====

7. Description

=====

Architectural Classification (Enter categories from instructions)

OTHER: Italianate Industrial

\_\_\_\_\_

\_\_\_\_\_

Materials (Enter categories from instructions)

foundation STONE

roof METAL

walls BRICK

CONCRETE

other \_\_\_\_\_

Narrative Description (Describe the historic and current condition of the property on one or more continuation sheets.)

=====

8. Statement of Significance

=====

Applicable National Register Criteria (Mark "x" in one or more boxes for the criteria qualifying the property for National Register listing)

- A Property is associated with events that have made a significant contribution to the broad patterns of our history.
- B Property is associated with the lives of persons significant in our past.
- C Property embodies the distinctive characteristics of a type, period, or method of construction or represents the work of a master, or possesses high artistic values, or represents a

significant and distinguishable entity whose components lack individual distinction.

- D Property has yielded, or is likely to yield information important in prehistory or history.

Criteria Considerations (Mark "X" in all the boxes that apply.)

- A owned by a religious institution or used for religious purposes.  
 B removed from its original location.  
 C a birthplace or a grave.  
 D a cemetery.  
 E a reconstructed building, object, or structure.  
 F a commemorative property.  
 G less than 50 years of age or achieved significance within the past 50 years.

Areas of Significance (Enter categories from instructions)

Industry  
Architecture  
\_\_\_\_\_  
\_\_\_\_\_  
\_\_\_\_\_  
\_\_\_\_\_

Period of Significance 1892-1951  
\_\_\_\_\_  
\_\_\_\_\_

Significant Dates 1892  
1930  
1938

Significant Person (Complete if Criterion B is marked above)  
N/A

Cultural Affiliation N/A  
\_\_\_\_\_  
\_\_\_\_\_

Architect/Builder Unknown  
\_\_\_\_\_

Narrative Statement of Significance (Explain the significance of the property on one or more continuation sheets.)

=====  
9. Major Bibliographical References  
=====

(Cite the books, articles, and other sources used in preparing this form on one or more continuation sheets.)

- Previous documentation on file (NPS)  
 preliminary determination of individual listing (36 CFR 67) has been requested.  
 previously listed in the National Register  
 previously determined eligible by the National Register  
 designated a National Historic Landmark  
 recorded by Historic American Buildings Survey # \_\_\_\_\_  
 recorded by Historic American Engineering Record # \_\_\_\_\_

Primary Location of Additional Data

- State Historic Preservation Office  
 Other State agency  
 Federal agency  
 Local government  
 University  
 Other

Name of repository: \_\_\_\_\_

=====  
10. Geographical Data  
=====

Acreage of Property 14.28 acres

UTM References (Place additional UTM references on a continuation sheet)

	Zone	Easting	Northing	Zone	Easting	Northing
1	<u>17</u>	<u>712060</u>	<u>3959960</u>	3	17	712240 3959680
2	<u>17</u>	<u>712230</u>	<u>3959960</u>	4	17	712100 3959680

See continuation sheet.

Verbal Boundary Description (Describe the boundaries of the property on a continuation sheet.)

Boundary Justification (Explain why the boundaries were selected on a continuation sheet.)

=====  
11. Form Prepared By  
=====

name/title Nancy Van Dolsen

organization \_\_\_\_\_ date 20 September 2000

street & number 1601 Highland Drive telephone 252.243.7861

city or town Wilson state NC zip code 27893

=====  
Additional Documentation  
=====

Submit the following items with the completed form:

Continuation Sheets

Maps

A USGS map (7.5 or 15 minute series) indicating the property's location.  
A sketch map for historic districts and properties having large acreage  
or numerous resources.

Photographs

Representative black and white photographs of the property.

Additional items (Check with the SHPO or FPO for any additional items)

=====  
Property Owner  
=====

(Complete this item at the request of the SHPO or FPO.)

name Brownfields Redevelopment International, LLC

street & number 130 Edinburg South, Suite 200 telephone 919.388.8777

city or town Cary state NC zip code 27511

=====  
Paperwork Reduction Act Statement: This information is being collected for  
applications to the National Register of Historic Places to nominate properties  
for listing or determine eligibility for listing, to list properties, and to  
amend existing listings. Response to this request is required to obtain a  
benefit in accordance with the National Historic Preservation Act, as amended  
(16 U.S.C. 470 et seq.).

Estimated Burden Statement: Public reporting burden for this form is estimated  
to average 18.1 hours per response including the time for reviewing  
instructions, gathering and maintaining data, and completing and reviewing the  
form. Direct comments regarding this burden estimate or any aspect of this form  
to the Chief, Administrative Services Division, National Park Service, P.O. Box  
37127, Washington, DC 20013-7127; and the Office of Management and Budget,  
Paperwork Reductions Project (1024-0018), Washington, DC 20503.

United States Department of the Interior  
National Park Service

NATIONAL REGISTER OF HISTORIC PLACES  
CONTINUATION SHEET

Caraleigh Mills  
Raleigh, Wake County, North Carolina

Section 7 Page 1

---

### Setting

Caraleigh Mills stands between the railroad tracks and Maywood Avenue, presently surrounded by an open grass lawn and woods. Early twentieth-century houses constructed for mill workers stand on the north side of Maywood Avenue, across from the mill. A concrete drive leads into the mill complex from Maywood Avenue past a one-story frame building that serves as an office and guardhouse. A chain link fence surrounds the mill property, with a gate at the drive. A small parking lot is located on the east side of the office building.

### Mill Building, 1892, ca. 1900, ca. 1910, ca. 1919, late 1950s, Contributing

The mill building is comprised of the original 1892 building, which accounts for the majority of the structure, and many smaller additions. The building developed during a period of five building campaigns: the original 1892 construction, a ca. 1900 expansion, a circa 1910 addition, a ca. 1919 wing and warehouse, and a modernization in the late 1950s (see plan and exhibit 1, *Sanborn Insurance Map*, 1914).

The original building is a two-story, brick, Italianate structure with an intact monitor roof that stands on a raised stone foundation. The original building features full two-story pilasters defining narrow bays that are the width of the windows. At the top of each pilaster, a small solid, curved bracket is at the base of a shaped rafter end, projecting the full depth of the roof overhang. Most of the windows on the second floor retain their original segmental-arched twelve-light upper sash and twelve-light bottom sash. The windows on the first floor, and some of those on the second, have been bricked-up and/or have louvers inserted, but the size and form of the openings are still easily read. The 1892 building is composed of a 325 foot by 100-foot main block, which served as the area for weaving on the first floor and for spinning on the second floor during the early twentieth century. Two doors are located on the façade elevation. A single metal door (dating to the 1950s) covered by a metal awning leads into the 1892 original building, and a single metal door (also dating to the 1950s) covered by a flat-roof portico opens into the ca. 1919 wing.

At the rear (south side) of the 1892 main block are a series of smaller spaces that occupy a ca. 1900 addition measuring approximately 80 feet by 300 feet. This addition is also two-story brick on a stone foundation with twelve-over-twelve segmental-arched windows, but it features a corbelled brick cornice and lacks the pilasters. Built to serve as the area for beaming on the first floor and warping on the second, this addition was reconfigured for office space, bathrooms, a repair shop, and kitchen in the northern portion. A four-story water tank tower was constructed onto the south elevation of this section; a remnant of this tower still projects above the roofline.

Furnace and machine shops were also built in ca. 1910 to the south of the 1892 main block and to the east of the ca. 1900 warping and beaming section. This slightly L-shaped section extends

United States Department of the Interior  
National Park Service

NATIONAL REGISTER OF HISTORIC PLACES  
CONTINUATION SHEET

Caraleigh Mills  
Raleigh, Wake County, North Carolina

Section 7 Page 2

---

approximately 75 feet south of the original building. This section features slightly recessed two-story panels corbelled at the top, and a heavily corbelled cornice. The square-in-section brick furnace stack still rises from the east wall of this section. The furnace room retains four cast iron boilers dating from the early and mid-twentieth century. Two small (8 feet by 16 feet and 19 feet by 20 feet) additions were built onto the rear of the furnace and machine shop ell during the 1950s.

In ca. 1910, during the third building campaign, a brick two-story, L-shaped wing was constructed onto the west end of the original building and the ca. 1900 addition. A four-bay, flat-roof section approximately 25 feet wide was built at the north end to house the finishing and warping part of production. Pilasters rise through a flat parapet on the façade, and all windows have been bricked. Curved exposed rafter ends are located on the east and south elevations. A 96 foot by 80 foot warehouse forms the base of the "L." The warehouse portion stands one-story on a raised basement, which is punctuated with square twelve-light metal windows. The rear wall of the warehouse section has been rebuilt with concrete block.

A fourth major building campaign occurred ca. 1919, when a large brick wing was built onto the east end of the 1892 building and the ca. 1910 furnace and machine shop addition. This section has a shallow gable roof, and rectangular metal windows composed of thirty-five lights with two inset hopper windows that contain nine lights each. This addition features pilasters and shaped rafter ends. The front of this addition measures 74 feet by 72 feet and stands two stories, while the rear section, 105 feet by 81 feet is one-story. A tower was once located at the northeast corner of this section, and a portion of this tower extends above the roofline. Also ca. 1919, a brick one-story warehouse (59 feet by 104 feet) was built to the southeast of the mill building. The warehouse features weather boarded walls, sliding wood doors, and parapet end walls and partition. The interior of this building is one open space, and most likely the raw goods were stored here when they arrived at the complex.

In the late 1950s, after the Fred Whitaker Company acquired the company, a final building campaign took place. In 1956, 1958, and 1959, one-story concrete block additions with flat roofs of varying heights were constructed onto the east and west wings of the building, and a concrete block wing was added to the ca. 1919 warehouse building that stands southeast of the original mill. These additions have no windows and no decorative finishes.

Inside of the mill, the pre-1950s additions retain their diagonal wood floors and two wood staircases (in the original section and in the ca. 1910 finishing and warping section) with board balustrades and chamfered newels. The exposed brick walls have been painted numerous times. The original metal sliding doors that provided access between the various sections remain intact throughout the building. The ceilings and roofs of the large open areas are supported by rows of evenly spaced square posts. All of the milling equipment has been removed from the building. The 1950s sections have exposed block walls and poured concrete floors.



United States Department of the Interior  
National Park Service

NATIONAL REGISTER OF HISTORIC PLACES  
CONTINUATION SHEET

Caraleigh Mills  
Raleigh, Wake County, North Carolina

Section 7 Page 3

---

**Reservoir, ca. 1900, Contributing**

A reservoir appears on the 1914 *Sanborn Insurance Map* at this location and with this form, although it most likely has been rebuilt since then. The present structure is a concrete block circular tank that stands approximately two feet tall. The reservoir is located approximately 60 feet south of the mill building.

**Water Softener House, ca. 1956-1958, Non-contributing**

The water softener house is a one-story, flat-roof, concrete block building, measuring 16 feet by 26 feet, that stands approximately 20 feet south of the mill building. The building is painted white, and has overhead doors on the east and south elevations, and two divided-light metal windows on the west and north elevations.

**Corrugated Metal Shed, ca. 1970, Non-contributing**

This one-story, gable-front shed stands to the west of the water softener house. Sided with corrugated metal, the building measures approximately 10 feet by 14 feet.

**Office, ca. 1970, Non-contributing**

Standing on the north side of the mill, the one-story, frame office building faces east, and also acts as a guardhouse to the mill complex. The building is sided with vinyl, and has three multi-light fixed sash windows and a door on the east elevation, facing the drive into the complex.

United States Department of the Interior  
National Park Service

NATIONAL REGISTER OF HISTORIC PLACES  
CONTINUATION SHEET

Caraleigh Mills  
Raleigh, Wake County, North Carolina

Section 8 Page 1

---

### Summary

Caraleigh Mills is eligible for the National Register of Historic Place under Criteria A and C in the areas of industry and architecture respectively. Caraleigh Mills represents a change in textile manufacturing that occurred during the late nineteenth century when hydroelectric development and improvements in textile production technology made it possible for textile mills to operate anywhere (they were no longer bound by geographic considerations to make power) there was an available workforce. In Raleigh, these trends led to the introduction of the textile industry during the 1890s. In 1891, a group of Raleigh businessmen, led by Alfred Augustus Thompson, spearheaded the construction of Caraleigh (a combination of Carolina and Raleigh) Mills in what was then an undeveloped area beyond southwest Raleigh. The mill was completed in 1892 and was the largest of Raleigh's six textile manufactories. The mill grew rapidly, and was expanded in ca. 1900, ca. 1910 and ca. 1919. Under a succession of owners, Caraleigh Mills made cotton and woolen sheet goods, and raw yarn until 1956 when the Fred Whitaker Company purchased the mills and shifted production to synthetics such as nylon. The mill operated until 1999. Although the general activity at the mill continued unchanged after 1951, these activities do not meet Criteria Consideration G as exceptionally significant, therefore the period of significance ends in 1951.

Caraleigh Mills is one of three remaining late nineteenth-century textile mills in Raleigh. An excellent example of the Italianate style adapted for industrial buildings, Caraleigh Mills features full-height pilasters surmounted by brackets, decorative brickwork, and segmental-arched windows. Despite its continued use as a factory until 1999, the mill building retains its late nineteenth-through-mid-twentieth-century appearance. While the most noticeable changes is the bricking in of many of the windows, the original fenestration remains apparent. The pre-1950 additions to the building are visually unobtrusive, reflecting the massing and materials of the original building.

### Historical Background

In 1891, a group of Raleigh businessmen formed a company to construct a textile manufactory at the edge of the Norfolk-Southern Railway tracks in what was then an undeveloped area beyond southwest Raleigh. The officers of the new company had a spur line built directly to the factory building, which they had located on a street they named Maywood Avenue. The mills, named Caraleigh (a combination of Carolina and Raleigh) were built of brick made in Goodwin's brickyard, located on present-day U.S. 401.<sup>1</sup> The president of the company was Alfred Augustus Thompson, the mayor of Raleigh from 1886 to 1887, president of Commercial National Bank, and the president of another textile company, Raleigh Cotton Mills.<sup>2</sup> D.E. Everett served as Vice-President, and F.O. Moring as Secretary and Treasurer. The mills flourished during the 1890s through the early 1920s,

---

<sup>1</sup> Caraleigh: A Forgotten Mill Village, n.a., n.p., 1961, 1-2.

<sup>2</sup> Grady Lee Carroll, *They Lived in Raleigh: Some Leading Personalities from 1792-1892* (Raleigh: Southeastern Copy Center, 1971): 312.

United States Department of the Interior  
National Park Service

NATIONAL REGISTER OF HISTORIC PLACES  
CONTINUATION SHEET

Caraleigh Mills  
Raleigh, Wake County, North Carolina

Section 8 Page 2

becoming the largest of the six textile manufactories in Raleigh, and one of two mills that produced sheet goods.<sup>3</sup> The company employed 235 adults, who earned between \$12.00 and \$13.00 per week in 1892, as well as a number of children who were paid ten cents per day. Thirty years later, workers earned between \$40.00 and \$50.00 per week.<sup>4</sup>

At the time of its construction in 1891, there were no houses within the vicinity of Caraleigh Mills where the workers could live. The company laid out Thompson and Morgan streets, building brick and frame houses for their employees. In 1904 Thompson, the president of the mills, donated land on Gilbert Avenue for Caraleigh Baptist Church. That same year, the officers of the mills matched \$500 of the Wake County Board of Education's budget with \$500 so that a school for grades one through four could be built within the mill village. This school was replaced in 1925 by a larger building that served grades one through seven.<sup>5</sup>

The financial condition throughout the North Carolina textile industry started to deteriorate during the mid-1920s, due to the great tremendous increase in production that glutted the market.<sup>6</sup> With the decline in the market for textiles and the approach of the nationwide economic depression, Caraleigh Mill closed in 1929. The Raleigh newspaper, *The News and Observer*, featured a series of articles on the hardships suffered by the residents of Caraleigh after the closing of the mill. Residents of the village disparaged the articles, asserting that they were not as poor and down on their luck as the newspaper had stated.<sup>7</sup>

The mills reopened in 1938 under new management. The new company paid \$25,000 for the mill building, which included no equipment since the machinery had been sold for scrap materials. Five years later the Lawton Company of Bridgeton, R.I. and Greenville, S.C. purchased the mills, renaming the company Premier Worsted and switching the product from sheet goods to raw yarn. In 1952, the mill changed hands once again, becoming American Woolen.<sup>8</sup>

The Fred Whitaker Company purchased the mills in 1956, switching the product line to synthetics, thus ending Caraleigh Mills's production of cotton and woolen goods. In 1957, the City of Raleigh annexed the village.<sup>9</sup> The Fred Whitaker Company owned and operated the mill until 1999.<sup>10</sup> The mill is presently being studied for its potential rehabilitation into office space and condominiums.

<sup>3</sup> Charlotte Abbate and Mary L. Reeb. National Register of Historic Places Nomination for Pilot Mill, Raleigh, Wake County, North Carolina January 1989, page 8/3. North Carolina State Historic Preservation Office, Raleigh, North Carolina.

<sup>4</sup> Caraleigh: A Forgotten Mill Village, 2.

<sup>5</sup> Caraleigh: A Forgotten Mill Village, 3-4.

<sup>6</sup> Brent D. Glass, *The Textile Industry in North Carolina* (Raleigh: Division of Archives and History, North Carolina Department of Cultural Resources, 1992) 60.

<sup>7</sup> Caraleigh: A Forgotten Mill Village, 4.

<sup>8</sup> Caraleigh: A Forgotten Mill Village, 5-6.

<sup>9</sup> Caraleigh: A Forgotten Mill Village, 11.

United States Department of the Interior  
National Park Service

NATIONAL REGISTER OF HISTORIC PLACES  
CONTINUATION SHEET

Caraleigh Mills  
Raleigh, Wake County, North Carolina

Section 8 Page 3

---

### Architectural Context

Caraleigh Mills is one of three remaining late nineteenth-century textile mills in Raleigh. An excellent example of the Italianate style adapted for industrial buildings, Caraleigh Mills features full height pilasters surmounted by brackets, decorative brickwork, and segmental-arched windows. Despite its continued use as a factory until 1999, the mill building retains its late nineteenth through mid-twentieth-century appearance. The pre-1950 additions to the building are visually unobtrusive, reflecting the massing and materials of the original building. Although the windows have been bricked-in (with different color brick which allows the original fenestration pattern to remain visible) on the first floor of the original mill, the original sixteen-over-sixteen windows remain intact on the second-floor of the building. The original monitor roof, which provides light through the clerestory windows for the second floor, is as first constructed.

In his work on the textile industry in North Carolina, Brent Glass summarizes the typical appearance of the mills constructed at the end of the nineteenth century; his depiction, which follows, perfectly describes Caraleigh Mills:

Mills built in the latter decades of the nineteenth century...conformed to standards imposed by the New England machinery manufacturers, and, more important, by New England factory insurance mutuals that had developed criteria for what they called "slow burning construction." The new mills were always brick, usually two-story structures with flat roofs, large windows, and heavy interior timbers. Brick firewalls separated the main mill from other sections in which fires were likely to occur or spread rapidly: the picker room, the warehouse, the engine and boiler room, and the stair tower. Other safety features included...an independent cistern....<sup>11</sup>

As Glass also noted, ornamentation only appeared on these buildings "in the form of elaborate cornice work or in diverse roof designs."<sup>12</sup> Caraleigh Mills fits Glass's description. The original mill and most of the historical additions are two-stories, built of brick with heavy wood support timbers, brick firewalls separating the sections of the mill, with an original cistern (labeled reservoir tank on the Sanborn Insurance maps), and a flat roof with a central monitor.

Although these textile manufactories were once prevalent throughout the state, they are being demolished as more companies close their operations. In North Carolina, textile-related employment decreased twenty-eight percent between 1975 and 1985, causing these buildings to become obsolete

---

<sup>10</sup> Murray F. Gould of Historic Preservation Advisors, Interview with Nancy Van Dolsen, 26 May 2000.

<sup>11</sup> Glass, 38.

<sup>12</sup> Glass, 38.

United States Department of the Interior  
National Park Service

NATIONAL REGISTER OF HISTORIC PLACES  
CONTINUATION SHEET

Caraleigh Mills  
Raleigh, Wake County, North Carolina

Section 8 Page 4

and threatened.<sup>13</sup> In Raleigh only three of the six late nineteenth-to-early-twentieth-century mill buildings survive. Pilot Mill, constructed in 1894 is also a two-story brick industrial building with some Italianate details; the original mill building was subsequently enlarged in 1903 and sometime before 1914. Unlike Caraleigh Mills, most of the physical expansion of Pilot Mills occurred through the construction of separate buildings rather than additions to the original building. Pilot Mill, the second largest mill operation in the city, was placed on the National Register of Historic Places in 1989. Two other textile mills stand within Wake County, Glen Royall Cotton Mill constructed in 1900 in Wake Forest (NR 1999), and the Falls of the Neuse Manufacturing Company in Falls vicinity (NR 1977). The brick Royall Cotton Mill stands a story taller than Caraleigh Mills but none of its original windows survive. The Falls of the Neuse Manufacturing Company was constructed in 1854-1855 as a paper mill, and was converted to a textile mill in 1899. As a three-story granite building constructed to operate on waterpower, the Falls of the Neuse Manufacturing Company features a completely different form and plan from late nineteenth-century textile plants designed to utilize electric power.<sup>14</sup>

Caraleigh Mills is significant as the largest extant late nineteenth-century industrial building in Raleigh, and as a well-preserved example of an increasingly less common type of significant industrial building.

#### Industrial Context

Caraleigh Mills represents a change in textile manufacturing that occurred during the late nineteenth century when improvements in textile production technology and hydroelectric development made it possible for textile mills to operate with unskilled labor anywhere there was an available workforce. Between 1885 and 1915 the number of textile mills in North Carolina grew from 60 to 318. By 1915 more than 51,000 men, women, and children worked in the textile industry, more than five-times the number just thirty years earlier.<sup>15</sup> As in other Piedmont cities, business leaders in Raleigh saw the economic potential of textile manufacturing. Caraleigh Mills, constructed in 1892, was one of the earliest textile mills built in the city.<sup>16</sup> Raleigh was one of the first cities in North Carolina to have electric power, although until the 1910s, the power was used only for the textile mills, streetcars, and street lighting.<sup>17</sup>

This new generation of mills relied on hydroelectric-generated power and the proximity to the railroad. The Falls of the Neuse Manufacturing Company, built in 1854-1855 to operate on

<sup>13</sup> Glass, 100.

<sup>14</sup> Kelly Lally, *The History & Architecture of Wake County, North Carolina from British & African Settlement to 1941* (Raleigh, N.C.: Wake County Government, 1994) 256-257; 270-271.

<sup>15</sup> Glass, 34-35.

<sup>16</sup> Helen Patricia Ross, "Raleigh Comprehensive Architectural Survey Final Report." 4 June 1994, 8. North Carolina State Historic Preservation Office, Raleigh, North Carolina.

<sup>17</sup> Ross, 7.

United States Department of the Interior  
National Park Service

NATIONAL REGISTER OF HISTORIC PLACES  
CONTINUATION SHEET

Caraleigh Mills  
Raleigh, Wake County, North Carolina

Section 8 Page 5

---

waterpower, was converted to a textile mill in 1899, and to electric power later that same year, illustrating the impact that electric power had upon the industry.<sup>18</sup> Caraleigh Mills, which was built to operate on electric power, was built alongside the railroad, with a spur line directly to the factory. Caraleigh Mills depended upon the railroad both to receive shipments of raw materials and to ship out goods, which were unfinished cloth or yarn that needed another step of production before being sold.

At its peak production during the first quarter of the twentieth century, Caraleigh Mills's 235 employees operated 10,816 spindles and 325 looms that produced unfinished sheet goods. Pilot Mill, the only other textile manufacturer in Raleigh that made sheet goods, had a production capacity that fell short of Caraleigh Mills by about 25 percent.<sup>19</sup> The other four mills—Raleigh Cotton Mills, Martin Knitting Mills, Melrose Knitting Mills, and Raleigh Hosiery Company—manufactured hosiery yarns or finished hosiery and undergarments. Glen Royall Mill in nearby Wake Forest manufactured cotton muslin, and at its peak during the first decade of the twentieth century, had 16,000 spindles in operation.<sup>20</sup> Caraleigh Mills, however, is the largest of the six historic textile manufactories in Raleigh, and, along with Pilot Mills and Raleigh Cotton Mill, is one of only three that still stand.

---

<sup>18</sup> Lally, 257.

<sup>19</sup> Abbate and Reeb, 8/3.

<sup>20</sup> Lally, 271.

United States Department of the Interior  
National Park Service

NATIONAL REGISTER OF HISTORIC PLACES  
CONTINUATION SHEET

Caraleigh Mills  
Raleigh, Wake County, North Carolina

Section 9 Page 1

---

**Bibliography**

Abbate, Charlotte and Mary L. Reeb. National Register of Historic Places Nomination for Pilot Mill, Raleigh, Wake County, North Carolina. January 1989. North Carolina State Historic Preservation Office, Raleigh, North Carolina.

"Caraleigh: A Forgotten Village," n.a., n.p., 1961. Typescript, Caraleigh Mills Survey File, North Carolina State Historic Preservation Office, Raleigh, North Carolina.

Carroll, Grady Lee. *They Lived in Raleigh: Some Leading Personalities from 1792-1892*. Raleigh: Southeastern Copy Center, 1971.

Glass, Brent D. *The Textile Industry in North Carolina*. Raleigh: Division of Archives and History, North Carolina Department of Cultural Resources, 1992.

Gould, Murray F. of Historic Preservation Advisors, Interview with Nancy Van Dolsen, 26 May 2000.

Harris, Linda L. *An Architectural and Historical Inventory of Raleigh, North Carolina*. Raleigh: The City of Raleigh Planning Department and The Raleigh Historic Properties Commission in cooperation with The North Carolina Division of Archives and History, 1978.

Harris, Linda L. Caraleigh Mills Survey Form, October 5, 1976. North Carolina State Historic Preservation Office, Raleigh, North Carolina.

Lally, Kelly. *The History & Architecture of Wake County, North Carolina from British & African Settlement to 1941*. Raleigh, N.C.: Wake County Government, 1994.

Ross, Helen Patricia. "Raleigh Comprehensive Architectural Survey Final Report." 4 June 1994. North Carolina State Historic Preservation Office, Raleigh, North Carolina.

Sanborn Map Company. *Sanborn Insurance Map, Raleigh, North Carolina*. New York: Sanborn Insurance Company, 1896, 1914.

United States Department of the Interior  
National Park Service

NATIONAL REGISTER OF HISTORIC PLACES  
CONTINUATION SHEET

Caraleigh Mills  
Raleigh, Wake County, North Carolina

Section 10 Page 1

---

**Boundary Description**

The proposed boundary follows the current tax parcel, 1703.18218569.

**Boundary Justification**

The boundary includes all of the historic resources associated with the industrial production of Caraleigh Mills.



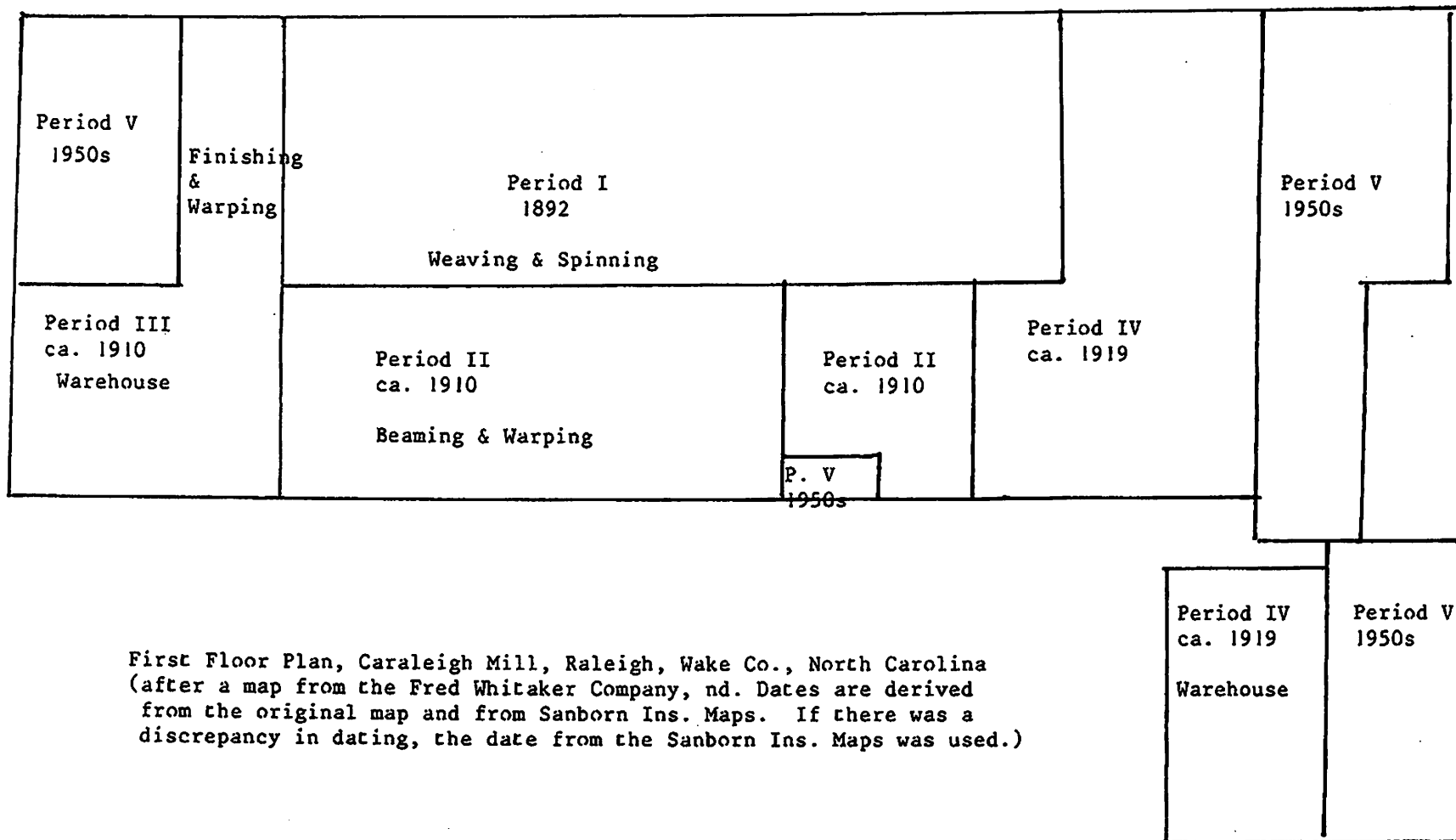

First Floor Plan, Caraleigh Mill, Raleigh, Wake Co., North Carolina  
(after a map from the Fred Whitaker Company, nd. Dates are derived  
from the original map and from Sanborn Ins. Maps. If there was a  
discrepancy in dating, the date from the Sanborn Ins. Maps was used.)

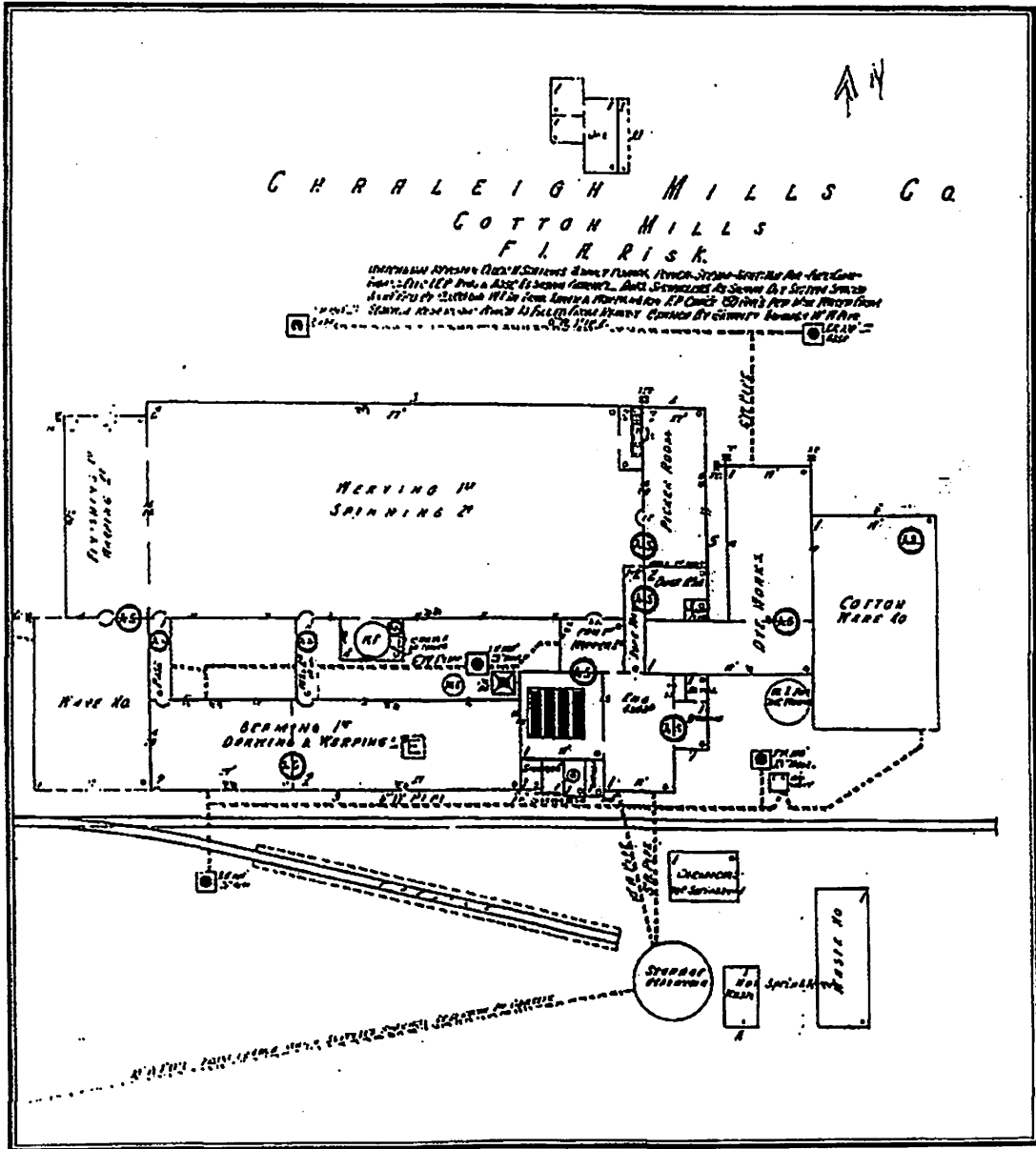

Caraleigh Mills, Raleigh, Wake County, North Carolina  
 1914 Sanborn Insurance Map

NC/WC - MILLS - CARALEIGH COTTON MILL

○ RPU Entry - 1 JUN 2017

On 29 MAY 2017 Eetic Upchurch emailed RPU an undated map of Caraleigh Mills Co.

showing the location of the mill and of the town and of nearby properties [Filed roads

(NC)  
(WC) MILLS <sup>△</sup>

A notable feature was MAYWOOD DAIRY FARM. It is to be presumed the map was made in the early 1890's and that the MAYWOOD DAIRY FARM was owned by <sup>△</sup>William George Upchurch

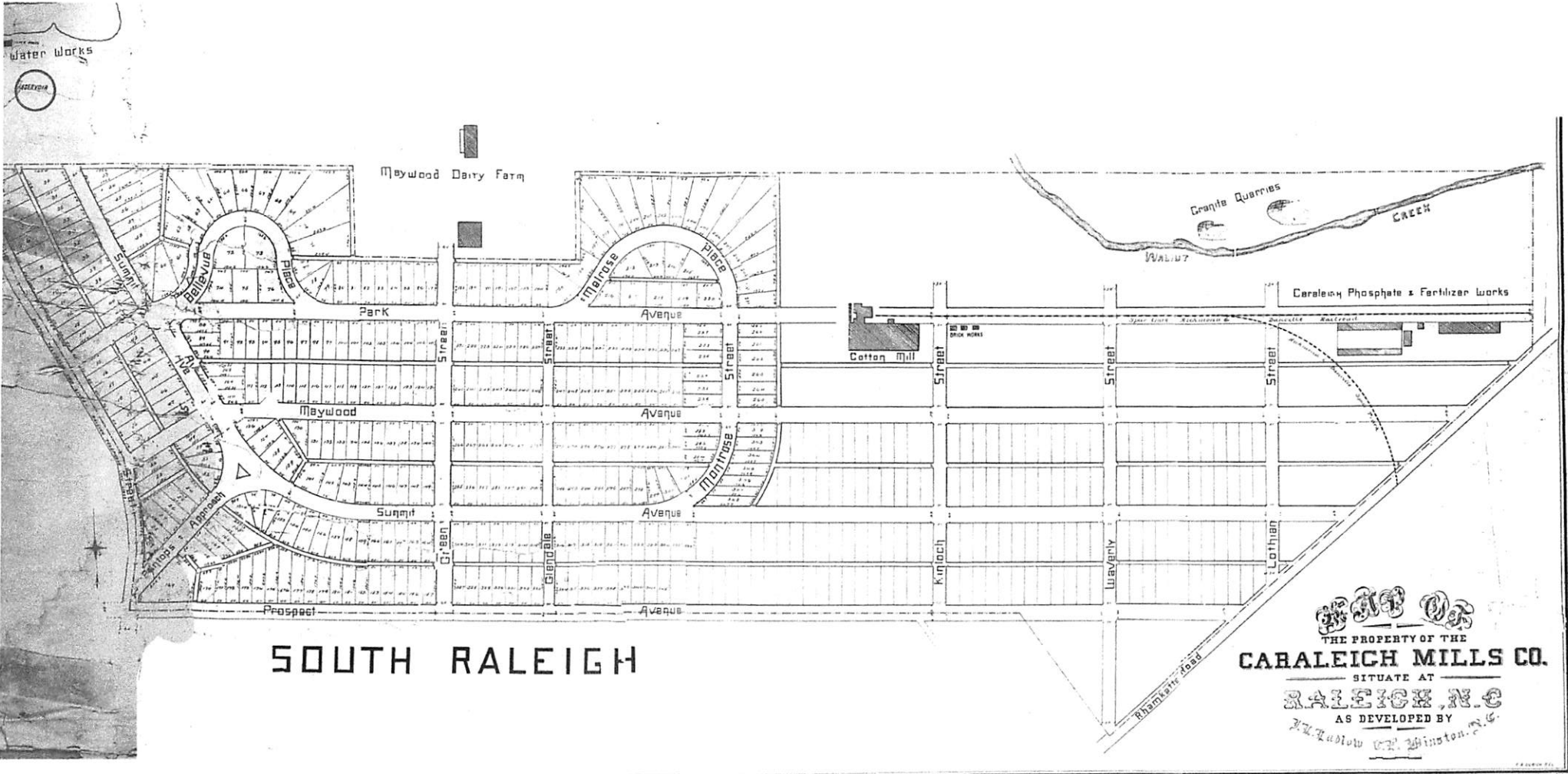

# SOUTH RALEIGH

  
 THE PROPERTY OF THE  
**CARALEIGH MILLS CO.**  
 SITUATE AT  
**RALEIGH, N.C.**  
 AS DEVELOPED BY  
 J. L. WILSON & CO., Winston, N.C.

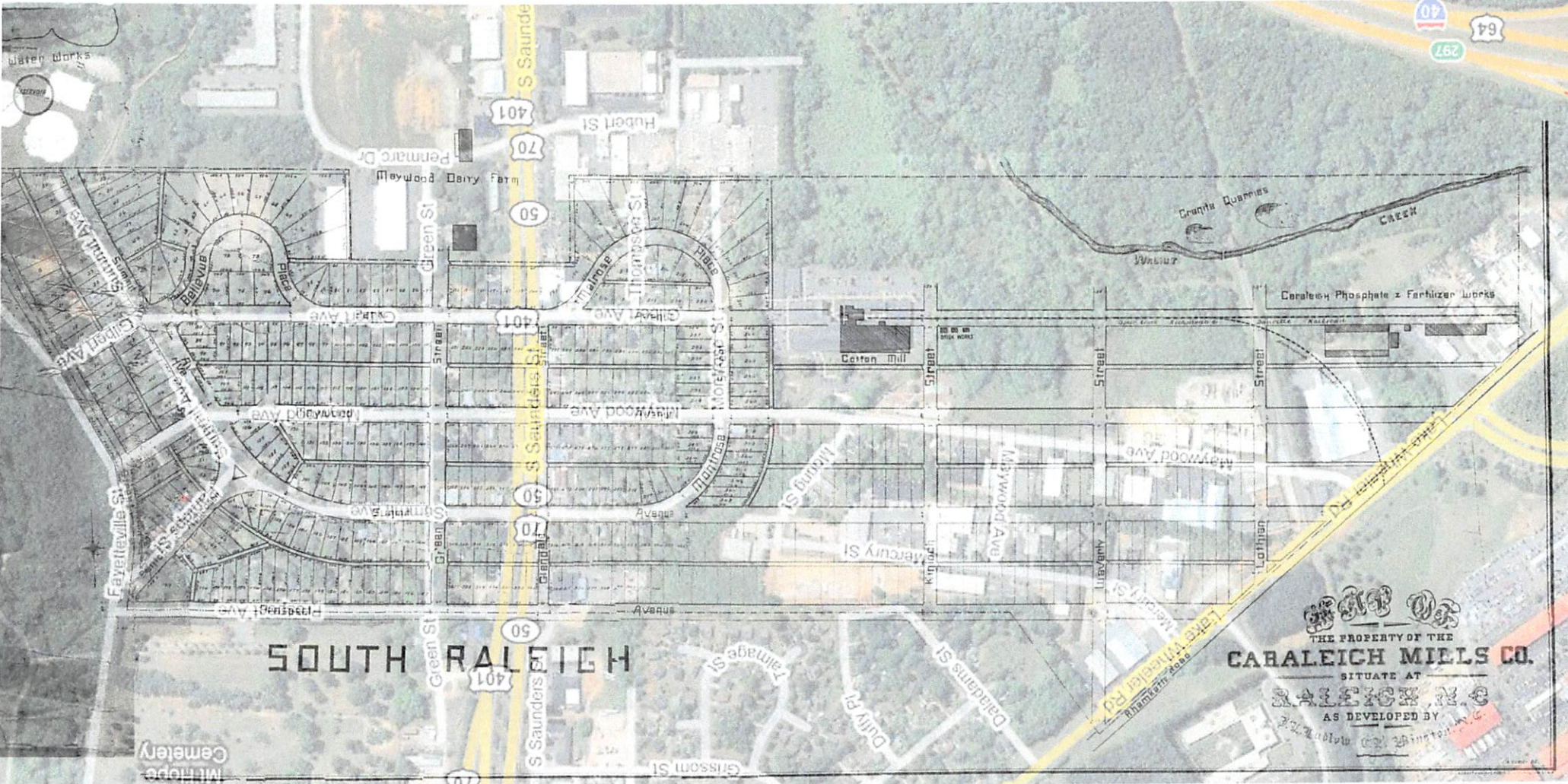

SOUTH RALEIGH

THE PROPERTY OF THE  
**CARALEICH MILLS CO.**  
SITUATE AT  
**RALEIGH, N.C.**  
AS DEVELOPED BY  
The Carolina Phosphate & Fertilizer Co., Winston, N.C.

64  
297  
40

401  
70  
50

401  
50  
70  
50

50  
401  
50

Water Works

Camery  
Mt Hope

Cranita Quarnies  
CREEK

Carolech Phosphate & Fertilizer Works

Cotton Mill

Lake Richmond Rd  
Bridleway

Permanc Dr  
Dairy Farm

Hubert St

Thomas St

Green St

Linwood Ave

Green St

Green St

Glisson St

Lamage St

Duffy Pl

Daladams St

Linwood Ave

Linwood Ave

Linwood Ave

Linwood Ave

Linwood Ave

Linwood Ave

Linwood Ave

Linwood Ave

Street

Street

Street

Street

Street

Street

Street

Street

Street

Street

Street

Street

Street

Street

Street

Street

Street

Street

Street

Street

Street

Street

Street

Street

Street

Street

Street

Street

Street

Street

Street

Street

Street

Street

Street

Street

Street

Street

Street

Street

Street

Street

Street

Street

Street

Street

Street

Street

Street

Hi Peggy and Phil,

I do not know if you guys have a copy of this map of Caraleigh. It shows the mill village of Caraleigh, Caraleigh Cotton Mill, Caraleigh Phosphate and Fertilizer Works, the railroad spur line to both entities, W.G.'s Maywood Dairy Farm, the brick works, the granite quarry and Walnut Creek.

We know that the bricks for Caraleigh Cotton Mill were not produced here, but granite from the quarry was used in its construction. This is the first reference to Maywood Farm as a dairy that I have seen. Maywood most likely encompassed all this at one time and W.G. sold the land to the investors of both enterprises or used it as equity in the ownership. This must also be what some referred to as W.G.'s Walnut Creek farm. The railroad spur line was a hard fought battle with the city and neighbors.

Another piece of the puzzle?

Gettis

[https://www.google.com/search?q=caraleigh+phosphate+and+fertilizer&client=safari&hl=en-us&prmd=simvn&source=lnms&tbm=isch&sa=X&ved=0ahUKEwjMjv7Z8JPUAhVFeCYKHT-AC\\_MQ\\_AUICigC&biw=768&bih=937#imgrc=73rBBmtdxT2BHM](https://www.google.com/search?q=caraleigh+phosphate+and+fertilizer&client=safari&hl=en-us&prmd=simvn&source=lnms&tbm=isch&sa=X&ved=0ahUKEwjMjv7Z8JPUAhVFeCYKHT-AC_MQ_AUICigC&biw=768&bih=937#imgrc=73rBBmtdxT2BHM):

Sent from my iPad

Copyright © 2003-2017. All rights reserved.

NEUSE MFG CO., WAKE CO., NC

○ RE LANDS OF DAVID GILL, IV OF WAKE CO. NC REPORTED IN A 15 PAGE JESSE GILL, II DOCUMENT FOR RPU 7 JUN 2011  
 Jesse Gill, II (an ancestor of RPU) had a brother Isaac Gill who had a son David Gill, IV who died about 1882. Documents 15, 16, 17, 20 pertain to the land he left and on which the meager details provided are shown below. A separate extract has been made on the people involved.

DOC 15 - 15 DEC 1882 - Wake Co, NC - The 11 children of David Gill, IV agree to a division - land poorly described. - Land appears to be in New Light TWP. - on J. B. ALLEN line and on H. C. RAY line.

DOC 16 - Wake Co. NC Court - JAN 1884 Terms - 3 Tracts  
 #1 The "Home Tract" in New Light + Wake Forest TWP's Joint lands of heirs of J. A. WICKS dec'd, GEO. W. THOMPSON, GEO. B. ALLEN, A. J. HARTSFIELD, ALF DUNN, NEUSE MFG CO. 1,025 Acres m/l  
 #2 CRENSHAW Tract - Neuse TWP - heirs J. L. DUNN, heirs of J. B. LASSITER, dec'd, N. BOLTON, NEUSE MFG Co., Purchased by David Gill, IV from JOHN M. CRENSHAW - 333 Acres  
 #3 Tract in Bartons Creek TWP - Stake in PHILIP THOMPSON corner - E 55 1/2 pole to stake - REBECCA THOMPSON corner - S 159 pole to stake - SARAH MANGUM corner - W 55 1/2 pole to stake PHILIP THOMPSON corner - N with his line to logcany. 55 1/2 Acre m/l - Connected to David Gill, IV by H. P. GILL

DOC 17 - No new land info

DOC 20 - Tract 1 600 Acres - David Gill, IV Land - Joint lands of GEO. B. ALLEN and MIKE THOMPSON (now owned by Mrs WEST on the North, and by D. D. GILL & J. M. CRENSHAW on the East, and by THE RALEIGH PAPER Co on the South, and by J. FOSTER ROGERS on the West.

Tract 2 - 333 Acres - Lies South of the Neuse River, bounded on the east by Mrs B. W. JUSTICE, on the south by W. O. RIDDICK and on the west by ADDISON LOWERY

Tract 3. 164 Acres - Lot 1 in Division of David G. IV land on north by H. C. RAY, on east by LOT 3 on south & west by H. C. RAY and J. M. CRENSHAW

RALEIGH PAPER CO., WAKE CO., NC

RE LANDS OF DAVID GILL, IV OF WAKE CO. NC REPORTED IN A 15 PAGE JESSE GILL, II DOCUMENT TO RPU 7 JUN 2011  
 Jesse Gill, II (an ancestor of RPU) had a brother Isaac Gill who had a son David Gill, IV who died about 1882. Documents 15, 16, 17, 20 pertain to the land he left and on which the meager details provided are shown below. A separate extract has been made on the people involved.

DOC 15 - 15 DEC 1882 - Wake Co, NC - The 11 children of David Gill, IV agree to a division - land poorly described. - Land appears to be in New Light TWP. - on J. B. ALLEN line and on H. C. RAY line.

- DOC 16 - Wake Co. NC Court - JAN 1884 Terms - 3 Tracts
- #1 The "Home Tract" in New Light & Wake Forest TWP's Joint lands of heirs of J. A. HECKS dec'd, GEO. W. THOMPSON, GEO. B. ALLEN, A. J. HARTSFIELD, ALF DUNN, NEUSE MFG CO. 1,025 Acres m/l
  - #2 CRENSHAW Tract - Neuse TWP - heirs J. L. DUNN, heirs of J. B. LASSITER, dec'd, N. BOLTON, NEUSE MFG Co., Purchased by David Gill, IV from JOHN M. CRENSHAW - 333 Acres
  - #3 Tract in Bartons Creek TWP - Stake in PHILIP THOMPSON corner - E 55 1/2 pole to stake - REBECCA THOMPSON corner - S 159 pole to stake - SARAH MANGUM corner - W 55 1/2 pole to stake PHILIP THOMPSON corner - N with his line to logcabin. 55 1/2 Acre m/l - conveyed to David Gill, IV by H. P. GILL

DOC 17 - No new land info

DOC 20 - Tract 1 600 Acres - David Gill, IV Land - Joint lands of GEO. B. ALLEN and MIKE THOMPSON (now owned by Mrs WEST on the North, and by D. D. GILL & J. M. CRENSHAW on the East, and by THE RALEIGH PAPER CO on the South, and by J. FOSTER ROGERS on the West.

Tract 2 - 333 Acres - Lies South of the Neuse River, bounded on the east by Mrs B. W. JUSTICE, on the south by W. O. RIDDICK and on the west by ADDISON LOWERY

Tract 3. 164 Acres - Lot 1 in Division of David G, IV land on north by H. C. RAY, on east by LOT B on south & west by H. C. RAY and J. M. CRENSHAW



# COMPANY MILL - WC, NC

FROM STORIES IN STONE BY TOM WEBER - 2011  
 ABOUT THE 6,000 ACRE WM B. UMSTEAD STATE PARK FORMED 1934  
 AND THE FAMILIES WHO HAD LIVED THERE - RPU 25 JUL 2012

EXCERPT PGS 15 & 11  
 TO REVEAL LOCATIONS  
 ROADS / STREAMS  
 PLACES

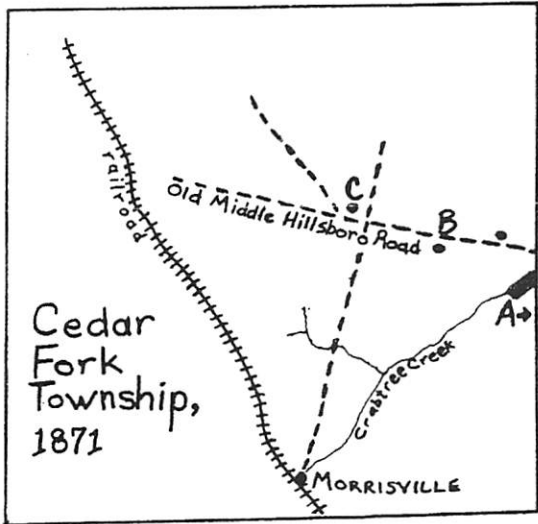

A) the Company Mill pond on Crabtree Creek,  
 B) the O. Page homestead, and C) Adams Crossroads.

## WAKE COUNTY STREAMS:

- ▷ RICHLAND CREEK
- ▷ CRABTREE CREEK
- ▷ SYCAMORE CREEK

- ▷ REEDY CREEK

## WAKE COUNTY PLACES:

- ▷ EBENEZER CHURCH & COMMUNITY
- ▷ SORRELS STORE
- ▷ ADAMS X ROADS (NOW RD AIRPORT)
- ▷ COMPANY MILL (PAGES MILL) 1810
- ▷ A DAMPER / DICKINSON STORE

## WAKE COUNTY ROADS:

- ▷ OLD MIDDLE HILLSBORO RD
- ▷ GRAYLYN RD
- ▷ EBENEZER CHURCH RD
- ▷ SWITCHBACK RD

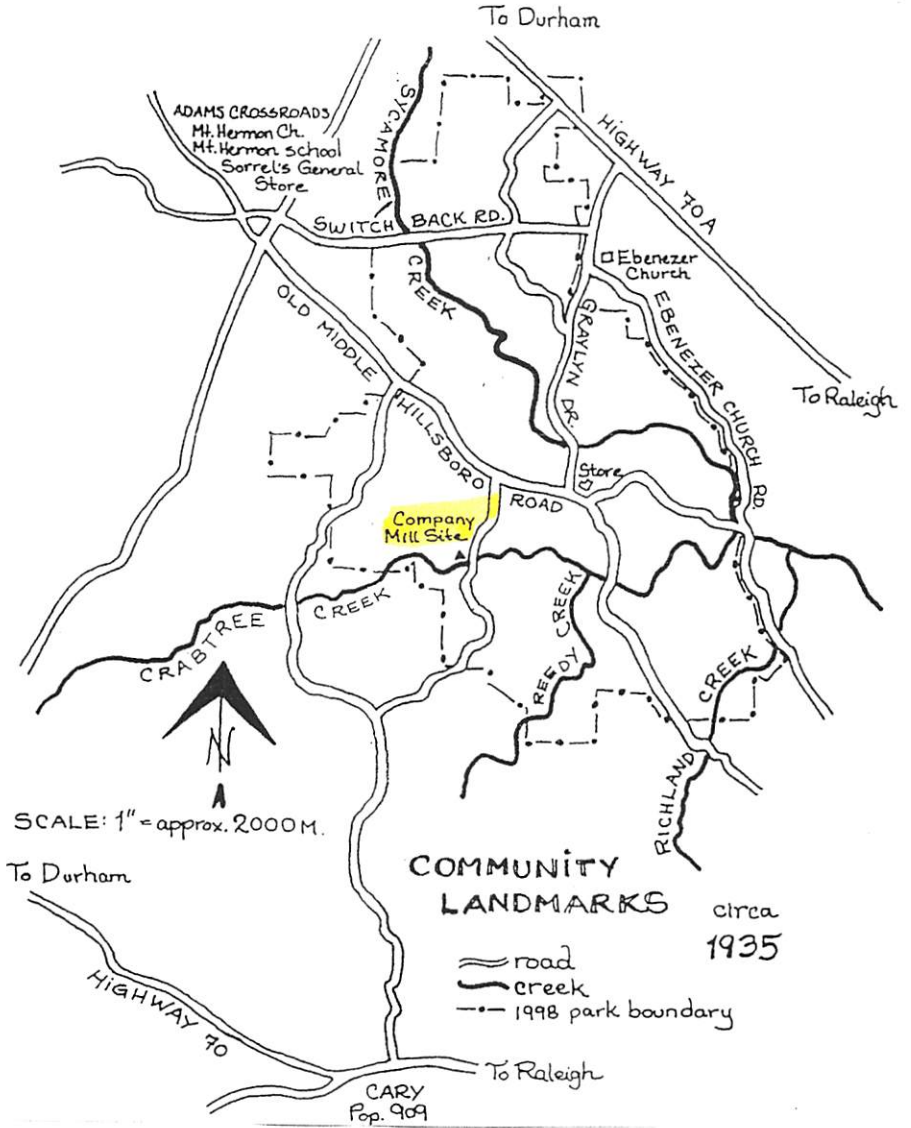

COMMUNITY LANDMARKS circa 1935

- road
- creek
- - - 1998 park boundary

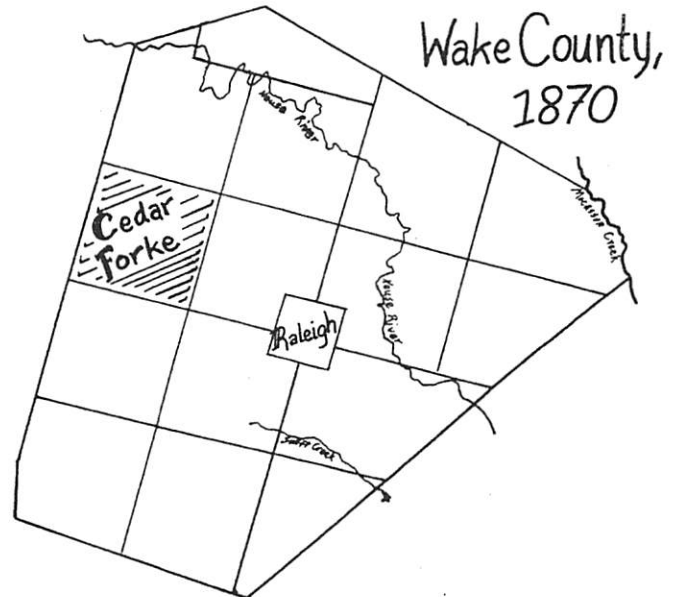

# PAGE'S MILL - WC, NC

○ From STORIES IN STONE BY TOM WEBER - 2011  
 ABOUT THE 6,000 ACRE WM B. UMSTEAD STATE PARK FORMED 1934  
 AND THE FAMILIES WHO HAD LIVED THERE - RPU 25 JUL 2012

EXCERPT PGS 15 & 11  
 TO REVEAL LOCATIONS  
 ROADS / STREAMS  
 PLACES

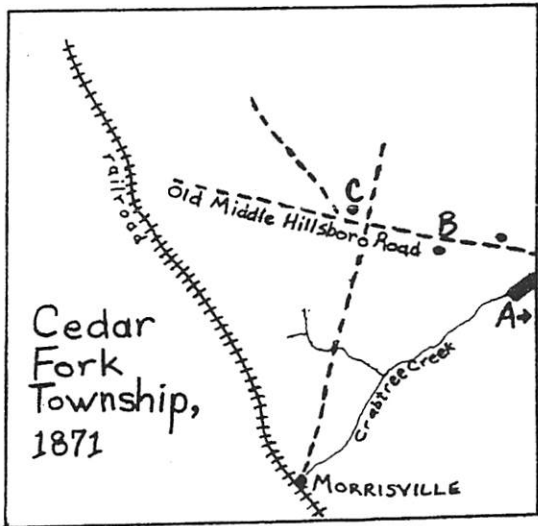

A) the Company Mill pond on Crabtree Creek,  
 B) the O. Page homestead, and C) Adams Crossroads.

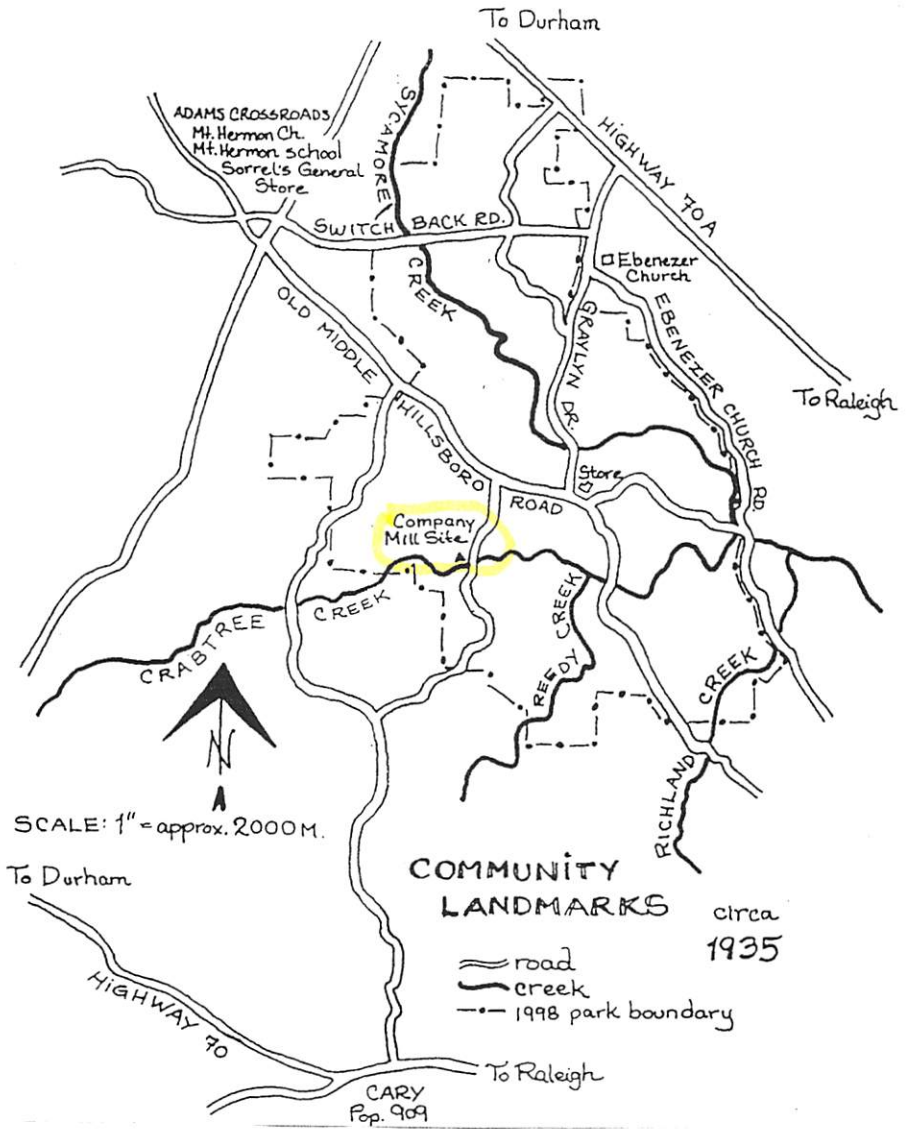

## WAKE COUNTY STREAMS:

- △ RICHLAND CREEK
- △ CRABTREE CREEK
- △ SYCAMORE CREEK

## △ REEDY CREEK

## WAKE COUNTY PLACES:

- △ EBENEZER CHURCH & COMMUNITY
- △ SORRELS STORE
- △ ADAMS X ROADS (NOW RD AIRPORT)
- △ COMPANY MILL (PAGE'S MILL) 1810
- △ A DAMPIER / DICKINSON STORE

## WAKE COUNTY ROADS:

- △ OLD MIDDLE HILLSBORO RD
- △ GRAYLYN RD
- △ EBENEZER CHURCH RD
- △ SWITCHBACK RD

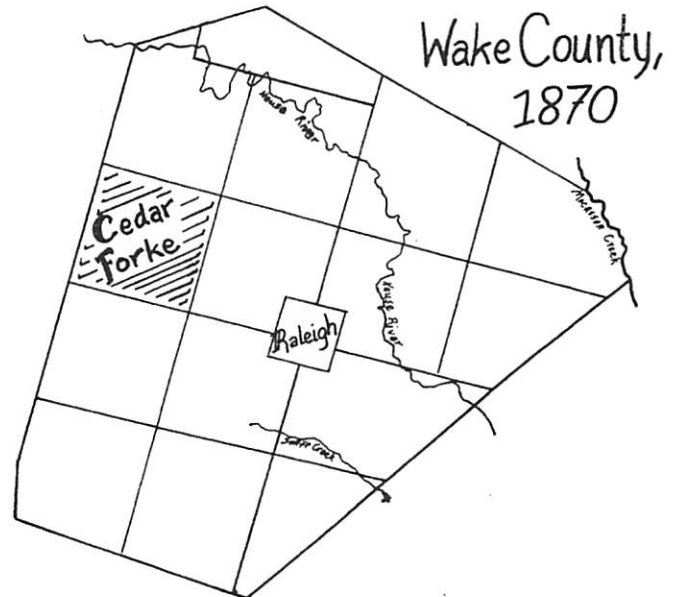

MILLS - WAKE CO, NC

○ PAPER MILLS IN WAKE CO, NC - FROM: WAKE  
→ CAPITAL COUNTY OF N.C. BY E. R. MURRAY PP 281, 282

#### INDUSTRY

Leaders throughout Wake County continued to encourage the establishment of other local industries, stressing the need to keep capital at home rather than spend it for goods purchased out-of-state. Each new enterprise or expansion of an existing one was greeted with enthusiasm by newspapers' correspondents as well as their editors. An editorial typical of many in the period was the following from the *Standard* regarding an expanded metalworking establishment: "We record this [news] with pleasure, as another evidence of the prosperity of this community, as well as of the pervading determination of the people to depend upon their own resources and skill, instead of looking North for manufactured articles."<sup>75</sup>

**Paper Mills.**<sup>Δ</sup>—In one industry, *Register* editor Joseph Gales had taken his own advice and established in 1808 Wake County's first paper mill. He not only made his own paper for the printing office but also sold some of the mill's products and utilized local waste products into the bargain by buying rags for use in manufacturing the paper. His was one of three paper mills eventually located in Wake County during the antebellum period. The Gales mill in its third location, on Crabtree Creek, was known as the Raleigh Paper Mill. After 1833 it had a succession of owners and lessees. It was damaged by at least two fires in 1841 and about 1850, but continued to produce paper until the second year of the Civil War.<sup>76</sup>

The mid-1850s brought competition from two new paper mills on the Neuse River. At Falls, the Neuse River Manufacturing Company was in 1856 supplying newsprint to nine periodicals published in Raleigh as well as to numerous others throughout the state. In 1860 its fifteen male and ten female employees were producing 520,000 pounds of paper annually.

<sup>74</sup> *Register* (s-w), Oct. 20, 1858; *N.C. Laws, 1858-1859*, c. 108; *Register* (s-w), Mar. 19, 1859, Dec. 8, 1858, Mar. 25, 1857; *Standard* (w), Jan. 12, Dec. 14, 1859.

Two of the first private residences in Raleigh to be lighted with the new acetylene gas, both structures designed by William Percival in 1858, were the Rufus Sylvester Tucker villa that stood until 1968 across St. Mary's St. from St. Mary's College, and the Carter B. Harrison residence at 18 Seaboard Ave. near the soon-to-be-built Peace Institute until 1962. William B. Bushong, "William Percival, an English Architect in the Old North State, 1857-1860," *N.C. Historical Review* 47 (Summer 1980):310-339, especially 326, 333. Dr. Hogg's pitcher was inherited by his granddaughter, Elizabeth Dortch of Raleigh. Interview with Miss Dortch, July 22, 1976.

<sup>75</sup> *Register* (s-w), Aug. 26, Sept. 5, 1845; *Standard* and *Star* cited in *Register* (s-w), Aug. 15, 1845; *Standard* (s-w), Nov. 1, Apr. 30, 1851.

<sup>76</sup> See above, chap. 7 at n. 20; *Register* (s-w), Feb. 16, 1841; *Rasp*, June 25, July 30, 1842; *Star*, July 27, 1842; *Standard* (s-w), Sept. 25, 1850, Nov. 1, 1851; see below, chap. 13 at nn. 32-33.

The mill changed hands frequently; owners after Gales included William N. Schauck, several members of the Sater family, the Manteo Mills in 1850, and Waterhouse and Bowes during the Civil War. It eventually came to be known as Whitaker's Mill. *Wake Deed Book* 13:523, and later deeds and newspaper notices; and see below, chap. 13 at nn. 32-33.

Under a succession of owners, the mill continued to manufacture paper throughout the Civil War and afterward. Several miles downstream, Milburnie Mills also made paper beginning in 1855. Sion H. Rogers was president of the company; H. W. Husted, treasurer. By 1860 the mill had nineteen male and twelve female employees and also had an annual output of 520,000 pounds of paper.<sup>77</sup>

NEUSE MFG CO PAPER MILL, WAKE CO, NC

FROM THE BIOFILE OF W<sup>M</sup> JACKSON HICKS  
- ENTRY 18 JUL 2016 BY RPH  
BACKGROUND:

1. WJH IS A DIRECT ANCESTOR OF COOPERATOR  
△△ WARREN P. HARVEY A G/O GUY JONES, SR
2. WJH MOVED TO RALEIGH, NC ABOUT 1854  
△ & THERE IN 1878 MD (?) JULIA LOUISE HARRISON
3. WJH WAS HUGEY SUCCESSFUL. SOME EXCERPTS

- A. CONSTRUCTED/EQUIPPED THE <sup>△</sup> NEUSE MFG  
CO. PAPER MILL AT THE FALLS OF THE  
NEUSE, WAKE CO, NC - DURING THE CIVIL  
WAR HE TURNED THE MILL INTO A POWDER  
MILL
- B. AFTER THE WAR HE WAS ASSOCIATED WITH  
△△ THOMAS H. BRIGGS, SR & JAMES DODD IN THE  
CONSTRUCTION BUSINESS
- C. IN 1869 TOOK OVER AS SUPERINTENDANT OF  
△ CONSTRUCTION & ASST. ARCHITECT OF CENTRAL  
PRISON. COMPLETED 1881. BECAME "STATE ARCHITECT"
- D. BUILT EXECUTIVE MANSION, HOLLADAY HALL, EX  
△△△ ARCHITECTS SAMUEL SLOAN, A. G. BAUER, CHARLES  
L. CARSON
- E. 1884 - FORMED: SEPARK, HICKS & CO
- F. 1896. PRES. N. C. BLD & SUPPLY CO. - ASSOCIATE  
△△ W. J. ELLINGTON & C. P. SNUGGS
- G. 1898 - BECAME SUPERINTENDANT OXFORD ORYIND  
ASYLUM IN GRANVILLE CO, NC (FOUNDED BY  
△ MASONS 1872) - FOLLOWED BY R. L. BROWN IN 1901  
NOW. MASONIC HOME FOR CHILDREN

MILLS - WAKE CO., NC.

○ FROM: THE N. C. GENEALOGICAL SOCIETY JOURNAL  
Vol 35 No 4 NOVEMBER 2009 - PAGE 368

CROSSFILE:

- △ STEWART E. DUNAWAY
- △ WAKE CO, NC - MILLS
- △ WALNUT CREEK -  
STREAMS - WC, NC
- △ BOOKS OF INTEREST

*Wake County N.C. Mill Records (1772-1872)*. By Stewart E. Dunaway. Published by the author, 2221 Mandy Lane, Hillsborough, NC, 27278; e-mail [sedunaway@embarqmail.com](mailto:sedunaway@embarqmail.com); [www.lulu.com/sedunaway](http://www.lulu.com/sedunaway). 2009. Glossy cardstock cover, perfect bound, 8.5" x 11". 141 pages. Index. \$19.95 (e-mail first for shipping charges).

According to the author, this publication is "one of the most informative books on mill activity in the Piedmont." This book provides clear, readable images of the original mill petitions that are held at the North Carolina State Archives. Four historic maps, Collett (1770), Price-Strothers (1808), MacRae-Brazier (1833), and an 1865 map of North Carolina, are provided for reference. Locations mentioned in the documents include Hines Mill, Lick Creek, Marlow Creek, Pool Mill, Rogers Mill, Smith's Creek, Turner Mill, Walnut Creek, Watts Mill, and Yates Mill. Anyone with ancestors in the milling (flour, meal, or saw) business who lived in what is now the Triangle area will find this book useful.

Many of you may remember that Doug Swords gave a talk a few years ago to WCGS members about his project to document the surviving (and not surviving) Wake county mills -- both mapping and photographing those whose remnants he can locate.

He is now seeking funding to try and finish this project,

<http://www.kickstarter.com/projects/millproject/who-was-carrie-h-beautiful-mysteries-from-the-past> -- check out the video and also scroll below that for text and images about this project.

Diane :-)

Diane Richard

WCGS, VP Communications + Editor, Wake Treasures

dianerichard@mosaicrpm.com

---

[Reply to sender](#) | [Reply to group](#) | [Reply via web post](#) | [Start a New Topic](#)  
[Messages in this topic \(1\)](#)

**RECENT ACTIVITY:** [New Members 1](#) |  
[Visit Your Group](#)

**YAHOO!** GROUPS

[Switch to: Text-Only](#) • [Daily Digest](#) • [Unsubscribe](#) • [Terms of Use](#)

---

Copyright © 2003-2012. All rights reserved.

## Kickstarter

- [Discover great projects](#)
- [Start your project](#)

Search projects

- [Blog](#)
- [Help](#)
- [Sign up](#)
- [Log in](#)

Previous Next

# Who Was "Carrie H"? : Beautiful Mysteries From The Past

by [Doug Swords](#)

- [Home](#)
- [Updates 2](#)
- [Backers 5](#)
- [Comments 0](#)
  
- [Raleigh, NC](#)
- [Photography](#)

**Funded!** This project successfully raised its funding goal just now.







Carrie's Capstone

**A map showing the locations of mills and mill remains in Wake County, North Carolina (Raleigh) and a digital photography archive would be the actual work products of this project and our legacy to future generations. Even if you don't live here, you could be part of the team that makes this information available forever. Every backer will receive a digital version of the map, suitable for printing, framing, and leaving to YOUR future generations.**

Water powered flour or grist mills were once important community centers and the earliest example of harnessing the natural power of falling water to create the basic staples of our diet: flour and corn mill. Everyone has seen a road or street with the word "mill" as part of the name. Revolutionary and Civil War battles were fought to gain control of them; some of them were converted to produce gun powder during times of war. Artists have rendered them in paintings for hundreds of years.



Falling water has both power and beauty

These mills sustained us but, like many things, were quickly obsoleted once electricity became widely available and large, commercial milling operations began. The water wheel mills were abandoned during the forward march of technology. However, if you search along watercourses off the beaten path you can still find relics of another time: the silent, dignified remains of these old servants.



So few are left standing...

There is a national movement to breach and remove old mill dams. Some of these dams are beautiful works of art and we should document as many of them as possible before they are destroyed. The very methods used to build these dams were amazing and the craftsmanship superb. Something should be left behind to tell their stories. Some of these dams have very interesting stories indeed.

Help me bring to completion a long term project started in 1978 to locate, map and photograph the remains of water mills built in Wake County, North Carolina as early as 1710. We have already located 100 of approximately 170 sites; time is of the essence as they are quickly being destroyed to make room for shopping centers and housing developments. Sadly many of the known locations are falling victim to vandalism.



Dr. Karl Wegmann (left) and me clearing debris from a dry laid wheel pit built before the Revolutionary War.

These sites are fragile and in some cases only a few stones of the foundation remain. In other cases there are nearly complete mills hidden in remote locations. This project has been ongoing almost 35 years and is now at the point where we really need to create the products from this research: the map, a searchable image archive and an atlas and other guide materials. And maybe, most importantly of all, we need to find the answer to that one intriguing question: Who was Carrie H?

Help me produce something that will provide a permanent repository of information for future generations of researchers and especially children who will never have the opportunity to see one of these early industrial wonders.

And in the process help me solve the mystery of "Carrie H".



March 17, 1978...the day the project was started.



Some of these mill dams are tricky. We didn't find this one until I moved that big stick...with fellow photographer Eric Jones.



The Huffine Mill Dam



Secret location, all that remains of a mill foundation from the mid 18th century



Detail of dam built in 1753 showing the pond drain gate.



Built in the 18th century and still standing....

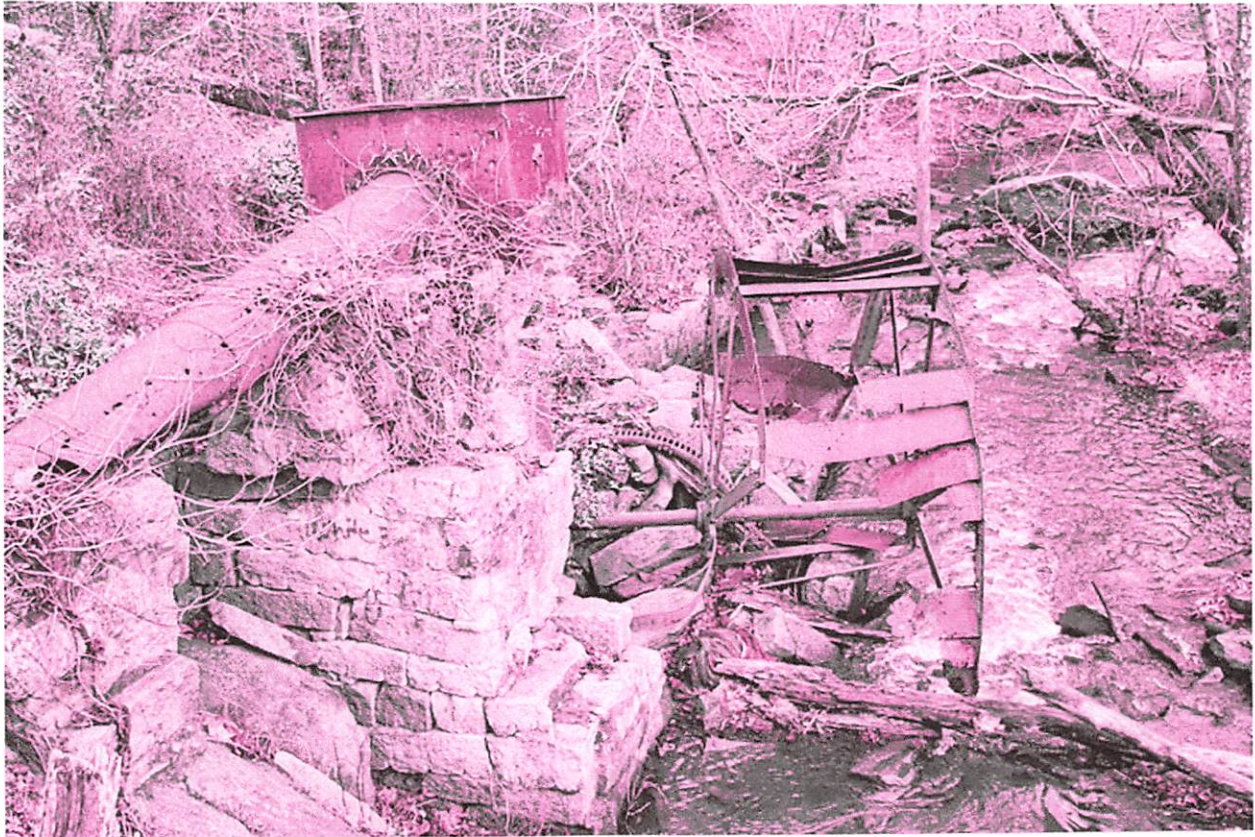

Sometimes after weeks of searching all you find are the rusted out remains of a mill destroyed by fire or flood.....



Sometimes you only find one remaining stone....



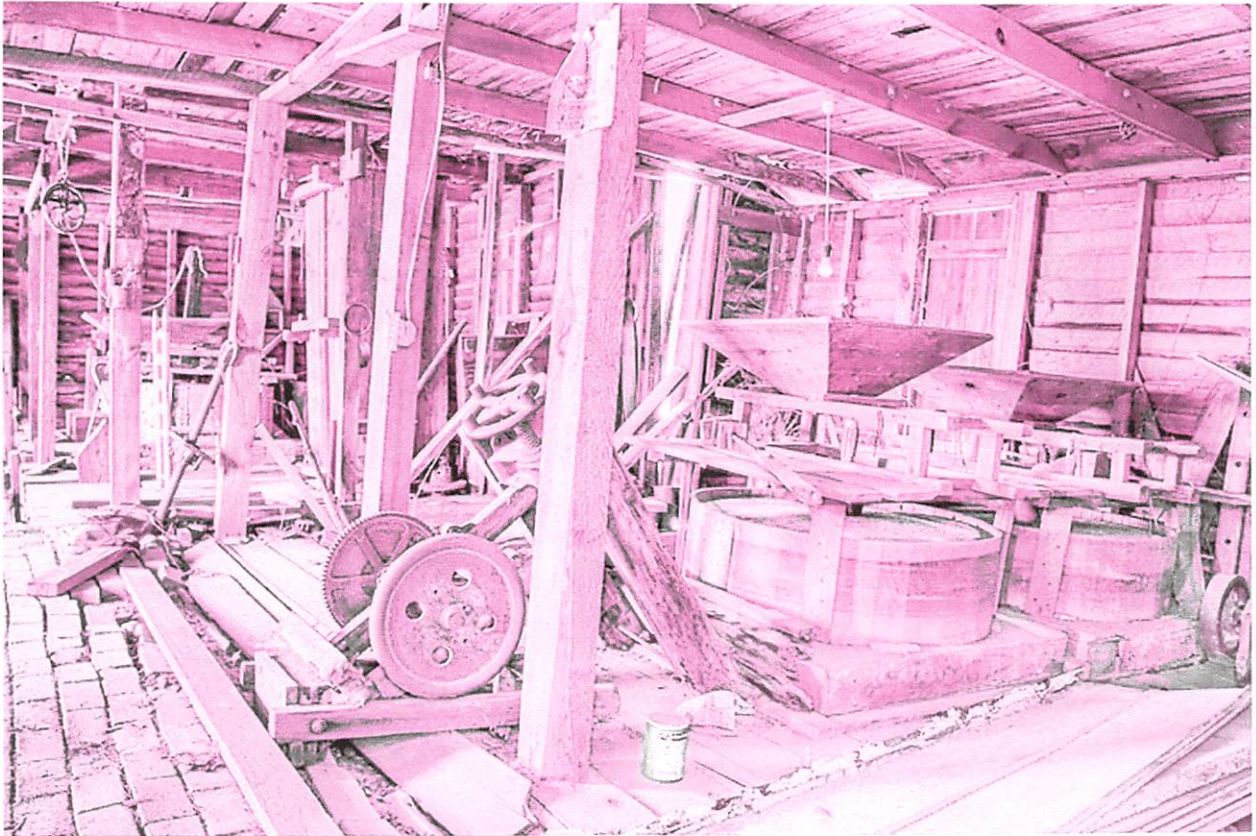

Sometimes, miles from the nearest road, you will find it all, left just as it was before all the men went off to WWI



And sometimes you will find stonework cut and carefully placed by a master European stonemason

**And finally-she was *important* to him. We found her name engraved on the underside of the capstone of a dam built around 1710. Her name was "Carrie H". I wonder if she ever knew.....**

Thanks for supporting this project.

## FAQ

**Have a question?**If the info above doesn't help, you can ask the project creator directly.

[Ask a question](#)

[Report this project to Kickstarter](#)

5

Backers

\$390

pledged of \$25,000 goal

58  
days to go

[Back This Project \\$1 minimum pledge](#)

**THIS PROJECT IS NOT LIVE**This is only a draft that the creator has chosen to share.

**Funding Suspended**Funding for this project was suspended 1 day ago.

**Funding Canceled**Funding for this project was canceled by the project creator 1 day ago.

**Funding Unsuccessful**This project reached the deadline without achieving its funding goal on October 12, 2012.

**This project is purged and only visible to staff.**

[How Kickstarter works.](#)

This project will only be funded if at least \$25,000 is pledged by Friday Oct 12, 8:45pm EDT. [How Kickstarter works.](#)



**Project by**

[Doug Swords](#)

[Raleigh, NC](#) [Contact me](#)

- First created 0 backed
- Has not connected Facebook

[See full bio](#)

•

[Pledge \\$15 or more](#)

[1 Backer](#)

[A beautiful, high resolution digital image of a standing mill, suitable for printing up to 30x40 inches plus a PDF of the mill map. Update: This level will also contain digital scans of antique NC maps from as early as the 18th century. These maps are works of art in themselves.](#)

[Est. delivery: Oct 2012](#)

•

[Pledge \\$25 or more](#)

[1 Backer](#)

[A KML \(Google Earth\) file showing the locations of approximately 700 mill sites in North Carolina where remains can still be seen plus the \\$15 reward PLUS GPS file sets for Garmin and TomTom units so you can go on your own mill hunting excursions.](#)

[Est. delivery: Oct 2012](#)

•

### [Pledge \\$50 or more](#)

[2 Backers](#)

[A DVD with hundreds of images of old mills I have taken over the years plus some vintage black and white photos taken long before the days of digital cameras plus the \\$25 reward PLUS rare out-of-print milling periodicals from the early 1900s.](#)

[Est. delivery: Oct 2012](#)

•

### [Pledge \\$200 or more](#)

[1 Backer](#)

[Beautiful printed map suitable for framing approximately 20 by 24 inches plus the previous rewards.](#)

[Est. delivery: Oct 2012](#)

•

### [Pledge \\$500 or more](#)

[0 Backers](#)

[Guided group tour with other \\$500 contributors to some of the hidden treasures: mill remains that have been seen by very few people in the last 100 years plus a poster sized print of the Wake County Mill Map.](#)

[Est. delivery: Oct 2012](#)

•

### [Pledge \\$750 or more](#)

[0 Backers](#)

[Museum quality canvas wrap \(30x40\) of one the most beautiful standing mills in this area plus the \\$50 level reward.](#)

[Est. delivery: Oct 2012](#)

•

### [Pledge \\$1,000 or more](#)

[0 Backers](#)

[48x60 inch Wake County Mill Map printed on heavy stock with wooden rails, mounted and ready to hang.](#)

[Est. delivery: Nov 2012](#)

•

### [Pledge \\$2,000 or more](#)

[0 Backers \(limited 5 of 5 left\)](#)