

JOHN

PEARCE

AREA

UPCHURCH - RAY - PEARCE RELATIONSHIPS - FROM PGS 926, 927 NATL
& RAY FAMILIES 2ND ED. 1997 BY RPU 26 JUL 2010 [] = PER RPU

[X. NATHAN PEARCE b 9 JUL 1735 (VA) HE & WIFE & CHILDREN TO MOCCASIN CREEK AREA OF NC 1791)

P1111 Nathan Pearce
D. before 26 March 1796 (when Nancy Pearce, widow of Nathan Pearce, was granted her 62 and 1/3 acres of the land to be divided [Franklin Co., NC Will Book B, p. 36 (ref. 3)])
M. to Nancy _____ (maybe Weston) [NANCY SARAH WESTER]
Parents of ?, record of 6 children
P1111 Stephen Pearce
B. 1756-1765 (less than 45 in 1800 Census and more than 45 in 1810 Census for Franklin Co., NC)
D. in Wake Co., NC
M. to Elizabeth _____
Parents of 4 children

P1112 Arthur Pearce
D. before 26 March 1796 (when Nancy Pearce, widow of Arthur Pearce, was granted 41 acres for her dower land [Franklin Co., NC Will Book B, p. 36 (ref. 3)])
M. to Nancy _____ (see above)
Parents of 2 children (Philip Pearce was named guardian for these children after Arthur's death)

P1113 Phillip Pearce (fought in the American Revolutionary War) [33]
B. 1756-1765 (younger than 45 in 1800 Census and older than 45 in 1810 Census for Franklin Co., NC)
D. ? buried old Bryant Stallings Graveyard, near Moccasin Creek in Franklin Co., NC
M. 1778
To Nancy Bunn
Parents of 6 children
P1114 Elizabeth Pearce
B. ca 1766 North Carolina
D. 13 November 1844 Shelby Co., IN, buried Ray/Center Cemetery, Shelby Co., IN
M. Bond dated 29 March 1783 Franklin Co., NC (Bondsman, Charles Upchurch; Witness, J. Rice)

To Thomas Ray [R12] (Son of William Ray, Sr.)
Parents of 7 children
For record, see Thomas Ray [R12]
P1115 John Pearce
B. ca 1768
D. 03 January 1845 (age 77 years) buried Brandywine Center/Ray Cemetery, Shelby Co., IN
M. to Clarissa [TENTATIVELY CLARA FRANCES U] D/O RICHARD A., III
Parents of ?, record of 1 child

P11151 Martha Pierce
B. 27 February 1812 North Carolina
D. 30 January 1896
M. 25 December 1832 (Bible record) Shelby Co., IN
To Zebedee Ray [R1213] [Son of Hutson [R121] and Margaret (Byerly) Ray]
Parents of 12 children
For record, see Zebedee Ray [R1213]

P1116 James Pearce [b ABOUT 1758]
D. before 1795 Franklin Co., NC (Guardian account for his children was assumed by Phillip Pearce from the former guardian John Martin [Franklin Co. NC Will Book C, p. 40]. Thomas Ray [R12] was the administrator for James Pearce's estate [Franklin Co., NC Will Book B, p. 19].)
M. to Mary _____ (because she received one-third of the estate of James Pearce)
Parents of 5 children (named as orphans, would have been minors in 1795 when their father died)

P11111 Charlotte Pearce
M. to _____ Upchurch [JUBAL U., I]
P11112 Elizabeth Pearce
M. 19 March 1808 Franklin Co., NC
To Simon Carpenter
P11113 Mary Pearce
M. to _____ Perry [JAMES PERRY, JR]
P11114 Cherry Pearce
M. 09 October 1815 Franklin Co., NC
To Drewry Denton

2) HIS SON NATHAN PEARCE, JR
b 23 MAY 1783 MD (2ND)
SUSAN U POSSIBLE D/O
BENJAMEN U.

P11121 Cordy Pearce
P11122 Willie Pearce
[MOSES U TOOK OVER AS GUARDIAN 1799]

I. W^m RAY, SR - HAD MOCCASIN CREEK LAND IN MID 1700'S

A. W^m RAY, JR

A. I. JOHN RAY - LIVED IN CHATHAM CO, NC THEN IN RANDOLPH CO.

B. HUDSON RAY - d IN REV

I. ZEBEDEE RAY

MDC) MARTHA PEARCE G/D

RICHARD U, III

C. CHARLES RAY d IN REV

D. THOMAS RAY - REV

3) HIS SON JOHN PEARCE, II b 10 NOV 1787 COULD BE THE ONE WHO MD IDELCOBLE (FC, NC) FRANCES U

P11161 Willie (Wills) Pearce
M. 12 November 1823 Wake Co., NC
To Sally Hoggwood (Bondsman, John Pierce)
P11162 Beedy Pearce
M. 27 August 1816 Wake Co., NC
To George Bell (Bondsman, Littleberry Horton)
P11163 Betsy Pearce
P11164 Penny Pearce
M. 21 March 1811 Wake Co., NC
To Littleberry Horton (Bondsman, William Horton)
P11165 Patsy Pearce
M. 19 December 1821 Wake Co., NC
To Calvin Nowell (Bondsman, John Nowell)
[RPU SHOWS SHE MD 10 SEP 1816 (FC, NC) HALEY PEARCE]

JOHN

PEARCE

○ Page 931 of Book. Nail & Ray Families 2nd Ed 1997

I. RICHARD U, III - Head of Clan

△ A. CLARA U

△ MD (C) JOHN PEARCE

RPW NOTE: Here John Pearce is supporting the relation of Mrs. Sarah (Pearce) Ray widow of Thomas Ray for a REV WAR pension R#4-2736200

These two Complexes, named in the Moccasin Creek Area of NC & then merged together to Randolph Co, NC before 1820 and then to Shelby Co, TN

Deposition of John Pierce

State of Indiana Hancock county Be it known on this the 18th day of May in the year 1842 Before me Andrew F. Hatfield a Justice of the Peace of Said county of Hancock personally appeared John Pierce a resident of Said county aged 76 years of Soundmind and memory who being by me duly Sworn on his oath Saith that he is the brother of Elizabeth Ray of Shelby county Indiana who is the widow of Thomas Ray deceased who died in Said county of Shelby Twelve years ago last fall during the revolutionary war and from the earliest recollection of this deponent he resided in the county of Franklin near the line of Wake county in the State of North Carolina with his fathers family and a near neighbour to the father and family of Said Thomas Ray while the Said war was raging in Carolina and other Southern States about the fall of the year 1779 and when this deponent was a lad he thinks about 13 or 14 years of age the Said Thomas Ray being thereabout two years or upwards older than this deponent he the Said Thomas was drafted to Serve in the army for 3 months it was understood at that time among the family and neighbours that Said Thomas was not quite of Sufficient age to be drafted but his father did not go to prove his age and he Thomas went with Several others of the neighbours and Served and when his term expired he hired as a Substitute for one of the neighbours Jacob Wheeler for 3 months and after that time was out he returned home but was very Soon called out again and went Still on from one campaign to another till the war was about threew in that part of the country I think he must have served in all near two years from the general conversation and report in the neighbourhood he was in the battle at Eutaw Springs he came home Soon after that battle with a Slight wound on his neck and another on his foot he brought home one of the red coats of the british there were Several persons who I know out in the Service at the Same time to wit—John Segraves Sen John Segraves Jun Charles Ray hudson Ray Jefse buh John Pierce Richard Pierce William Wheeler Shadrach Medlin Philbert Peirce John Rainwater Anderson Nunery James Peirce Joseph Pery Roger Craig andrew Jackson John Martin Starling Cooper Tanner alford who was a Mager in the Service I do not know where any of these persons are or wheather any of then are living Except I have had a late account from Andrew Jackson he was yet alive at that time Hudson Ray was wounded in battle and died in the hospital and Charles Ray died a prisoner with the British they were both Brothers to Said Thomas the next winter after the war was over in those parts the Said Thomas Ray and my Sister Elizabeth was Married at my fathers residence in franklin county by Tanner Alford a Magistrate I was present and Saw them Married they lived Together until the death of Said Thomas Ray as above mentioned they had Several children to wit—Hudson Ray James Ray Gilley Ray Sarah Ray Susana Ray Martha Ray and Chaney Ray this deponent cannot State positively that he is ecactly correct as to the dates or as to his own age or the age of said Thomas Ray the family Records of this deponents father and family was given up in the time of the war to be Sold to pay expences of the war this deponent remembers that Some man came to his fathers house for money or property for that purpose and his father had nothing for them but the Bible which he Gave up and that had the record of their ages in it Elizabeth the widow of Said Thomas is about Two years older than this deponent

his
(Signed) John U Pierce
mark

Witnesses---
Wiley Wray
James M. McCorkhill (?)

Sworn to and Subscribd the day and year first above written-----Andrew F. Hatfield
Justice of the Peace

JOHN

PEARCE

D AHT 1766

XTD-2947??

① Use of the Given name JOHN in the PEARCE Family of WAKE & FRANKLIN COS, NC 1750-1900 & UPCHURCH Connections

I Nathan Pearce b 1735(?) d 1821 (FCNC) m d 1756(?) Nancy West

A. Phillip Pearce [1 of 4 BRO] b 1754(?) d 1812/1834 (FCNC) m d (?) Nancy Gunn

XFD 4203 * I. John Pearce b 1787(?) d (FCNC) (BOR-FCNC) m d (FCNC) Francis U D/o Benjamin U

33869 a. John Pearce "Jack" b AHT 1810

b. Benjamin Pearce

33886 i. John H. Pearce b AHT 1853 (FCNC) 1857

2. Nathan Pearce b 1783(?) d 1867 (FCNC) (Bur Nathan Pearce cem., FCNC) m d (1st) Susan U b 1790 (FCNC) d (FCNC)

- possibly D/o Benjamin U m d (2nd) 1867 (FCNC) Mary A. Tippet b 1834

a. Acel N. Pearce b 1814 (FCNC) d 1880 (FCNC)

4460 i. John Calvin/Clyton Pearce b 1838 (FCNC) d 1924

(FCNC) (Bur Pearce Church) m d 1861 (FCNC) Lenna Jane Pearce - an Upchurch Descendant

ii. Bryant Pearce b 1849 (FCNC)

(F) John Robin Pearce b 1875(?) d 1948(?)

iii. Doctor Wiley Pearce b 1848 (FCNC) d 1930 (FCNC)

(F) John Walter Pearce b 1876 (FCNC) d 1941 (FCNC)

b. Solomon Pearce CSA b 1831 (FCNC)

i. William Burrell Pearce / Robert Burrell Pearce

(F) John B. Pearce b 1887 (FCNC) m d -- SANFORD

c. Burrell Pearce

i. Robert Pearce b AHT 1850

(F) John Valentine Pearce b 1874 (FCNC) d 1957 (FCNC)

* John Pearce b 1787 m d Frances U D/o Benjamin U & John Pearce b 1766 m d Frances Clara U D/o Richard U, III BUT to which of these 2 marriages does the IDEG 1803 mg of John Pearce to Frances U apply - RPH 30 JUL 2007

* John Pearce [1 of 4 BRO] b AHT 1766(?) d (?) Shelby Co, IN m d (?) Clara U D/o Richard U, III [WAS SHE CLARA FRANCES U?] RPH 27 JUL 2010

| | | | |
|-------------------------------------|-----------------------|-----------------------|-----------------------|
| OTHER JOHN'S IN PEARCE FAMILY b AHT | JOHN P 1812 - WCNC | JOHN A. P 1849 - WCNC | JOHN A. P 1859 - FCNC |
| | JOHN J. P 1837 - FCNC | JOHN H. P 1847 - WCNC | S/O ARNIBALD P - 1831 |
| | S/O ARNIBALD P 1804 | S/O BERRY P 1818 | JOHN P - 1860 - FCNC |
| | JOHN P 1840 - WCNC | JOHN P 1858 - WCNC | S/O MARGARET P - 1831 |
| | S/O JOHN 1812 | S/O WESLEY P 1828 | JOHN WALTER P - |

b ADT 1766 d SHELBY CO, IN

② INTRODUCTION: John Pearce b ADT 1766 m'd Clara U d/o Richard U, III

This Profile is designed to accumulate data on John Pearce b ADT 1766 who was one of four sons of Natham Pearce b 1735. ^[A] John Pearce 1766 is clearly the John Pearce who m'd Clara U the only daughter of Richard U, III. This couple moved to Randolph Co, NC and then on to Shelby Co, IN. [CLARA = CLARA FRANCES U?]

Care must be taken to avoid confusing John Pearce b 1766 with others in Franklin Co, NC by the name of John Pearce - especially ^[B] John Pearce b 1787 who m'd Frances U d/o Benjamin U

[NOTE: It is unclear if the 1 DEC 1809 mg of Frances U to John Pearce is for ^[A] or ^[B]

③ On 18 MAY 1795 West to R.P.U. - #27 - Conveyance - Franklin Co, NC

A. 1801. Moses U from Phillip, Steven, John and Arthur Pearce - For 100 lbs - 300 Acres beginning Oak Mock Branch up said Branch to a Spanish Oak, West to the Gay's + Daddock Bell's Corner - North to John Perry's line - East along line to Perry Base line - wit - Thomas Gay Jurat, Ann X Pearce - signed - Phillip, Stephen, John + Arthur X Pearce - DEC Session - Oath Thomas Gay Book 3 Pg 164

B. 1796 - Moses U from John Pearce for 48 lbs - 160 Acres bounded Spanish Oak Moses U line - South - Pine Thomas Gay line - West along Gay line to Moses U Corner - witness Phillip Pearce, Jurat, Thomas Pearce - signed John X Pearce

DEC Session 1801 Book 3 Pg 173

NOTE: It appears Moses U had land in Dunn's TSP FCNC and that in 1796 he added 160 Acres + in 1801 300 Acres both from Pearce land. - so Moses had 460+ Acres as of 1801

④ See Pg 7 Download in Ltr 7 MAR 2000 Floira Pauline U.D. RPL

6. NATHAN⁴ PEARCE (NATHAN³, PHILLIP², GEORGE¹) was born July 9, 1735 in VA, and died February 26, 1821 in Franklin Co., NC. He married SARAH WESTER June 24, 1756.

Notes for NATHAN PEARCE:

1st of 12 children - moved to Northampton Co., NC

Nathan and Sarah had 7 children 5 sons. These 5

sons in 1771 moved to what was then Bute Co., later Franklin Co., NC and settled on the east side of Moccasin Creek.

Nathan Pearce was No. 80 on the Muster Role of Captain James Fason of North Hampton Co. NC 1732-1774 in Colonial Soldiers of the South.

Children of NATHAN PEARCE and SARAH WESTER are:

- i. ARTHUR⁵ PEARCE, d. Abt. 1795, Franklin Co. NC.
- ii. PHILLIP PEARCE, b. July 24, 1754; d. February 25, 1812, Franklin Co., NC.
- iii. STEPHAN PEARCE, b. Bef. 1756.
- iv. JAMES PEARCE, b. Abt. 1758; d. Franklin Co., NC.
- v. JOHN PEARCE, b. Abt. 1766; d. Shelby County, Ind..
- vi. ELIZABETH PEARCE, b. Abt. 1767, Franklin County, NC; d. November 13, 1844, Shelby County, Indiana.

I. NATHAN PEARCE, I. b. 9 JUL 1735

⑤ Per fls 23 AUG 1977 Edythe Toppett to RPL (Attachment 9 MAR 77 theob) John Pearce was in Randolph Co NC & gave power of attorney to William Rhea to collect from him from estate of Richard U Jr. [Note - presumption is that John Pearce and a dau of Richard U Jr; Bookner U, son of Richard U Jr, had moved to Randolph Co NC about that time - RPL]

See will file - Franklin Co NC 1818 Bk F - Devision of land of Richard U Jr. John Pearce appears to have and only dau of Richard U Jr as John Pearce & wife are listed as receiving a 1/8 th share from the estate - 28 acres in Franklin Co NC. No name given for Pearce's wife. [Note that this distribution list gives no Pace person whereas original petition to divide listed a John Pace & wife Clara but no Pearce - Maybe original Pace name was intended to be Pearce - RPL]

⑥ Items from Profile of Patry Pace - Entry 6 NOV 1987

A. Franklin Co, NC - Will Bk F Pg 24 1817

At the sale of the estate of Richard U, III
6 of his 8 children were present & bought
items. There is no evidence in the
listing that the son who was John
Pearce was present. However the records
do show that John Pearce & wife
got land from the estate.

⑦ See Pg 26 of 2 FEB 1978 It's Elva E. Burkhalter to RPH

A. "Bunkley U - 1815-17, Pg 120. Division of lands of Richard
U to John Pearce & wife, Sion (M.), Berkley, Forkin,
Briton, James, Clabon, Bucker, Pg 23 - Sale of
Richard's estate to Sooby, Bucker, Briton,
Berkley, Sion (Adm.), Jubal, Clabon, Abel, James,
Bunkley, (Believe Bunkley to be a misspelling
of the name Berkeley or Berkley) A. M."

⑧ see will file for Petition DEC 1817 Franklin Co NC to divide
land of late Richard U Jr. Name Clara or Jane of Richard
U Jr & her husband John Pace. The 350 acres to be divided
is said to be next to lands of John Pace.
(John Pace = John Pearce).

⑨ Franklin Co, NC - Will Book F - Bradley Pg 55

445-(120) Division of lands of RICHD. UPCHURCH dec'd. Legatees were JOHN PEARCE & wife, SION
UPCHURCH, BERKLY UPCHURCH, LARKIN UPCHURCH, BRITON UPCHURCH, JAMES UPCHURCH,
BUCKNER UPCHURCH, CLABON UPCHURCH. Commissioners: WM. HARRISON, J. PERRY, THOS.
DUNN. Jun Ct 1818.

⑩

DEED:

FRANKLIN CO, NC

15 JAN 1794

obtained by RPH &
John Lee U, Jr on
15 OCT 1996

DEED BK 10 PG 164 [Not found in Reference 4D]

| | | |
|-------------------------|------|----------|
| Philip Pearce (Phillip) | } To | Arthur |
| Steven (Stephen) Pearce | | (Arthur) |
| <u>John Pearce</u> | | Pearce |

47 Acres - Spring Branch

Adjourn: Moses U

John Pearce

Witness: Moses U, Thomas Gay

JUN COURT
1795[NOTE: The date would fit for the John Pearce
to be John Pearce to AGT 1766 - RPH 30 JUL 2007]

⑪ John Pearce of Randolph Co, NC appointed
William Rhea of Wake Co, NC as his attorney
to receive from the estate of Richard
U [III], deceased, for whom Sion U, is
administrator 8 SEP 1818. Franklin Co, NC
Deed Bk 17 Pg 360 (41, Pg 112).

⑫ Franklin Co, NC - Will Book F - Bradley - Pg 59

479-(140) Inventory of property of RICHARD UPCHURCH dec'd, sold by SION UPCHURCH admr 12 Dec 1817.
Legatees were JOHN PEARCE, BUCKNER UPCHURCH, SION UPCHURCH, BRITON UPCHURCH,
CLABOURN UPCHURCH, BURKLY UPCHURCH. Buyers were GREEN L. PERRY, BENJAMIN BOLTEN,
JOHN CARPENTER, MERRITT INGRAM, KY MASSEY, NATHAN PEARCE, JESSE DENKINS, SHERROD
B. MARTIN, JOHN BOLTON.

JOHN
b 1766

PEARCE

(13) Re The Marriage on 1 DEC 1808 (Franklin Co, NC) of
Frances U to John Pearce

As of 30 JUL 2007 I am unable to determine
to which of the two following marriage the
record applies (RPA)

NEPHEW . ^Δ John Pearce b 1787 md (^Δ) Frances U d/o Benjamin U

UNCLE . ^Δ John Pearce b 1766 md (^Δ) Clara U [AKA
Clara Frances U] d/o Richard U, III.

If the 1808 m_y was for John Pearce b 1787 he would
have been marrying at age 21 which is OK for
a first marriage

If the 1808 m_y was for John Pearce b 1766 he would
have been marrying at age 42 which makes it
likely that it was a 2nd m_y for him

More records on the children of the two marriages
may shed some light on this matter.

Unrelated to the above issue is a 3rd ^Δ Frances U
b Aht 1807 who md 1829 (WVNC) Blake Baker. There
is conflicting evidence as to whether she was
Frances U d/o John U or Mrs Frances U, widow
of Melford U, s/o James U, VII & Gs/o Richard U, III

As Attach #29 West It 18 MAY 1975 - Franklin Co NC Marriage Bonds
" Frances U m John Pearce 1 DEC 1808 - Bondsman
& witness = Nathan Pearce "

see It 10 JUL 1980 Elva Era Burkhalter to RPA

Pg 14 - Clara Frances U b 1795, dau of Richard U Jr [III] md
1 DEC 1808 John Pearce. West = Nathan Pearce.

○ Relevance of attached article "Genealogy: New Ancestors for Elizabeth Pearce, Wife of Thomas Ray" - from Nail-Roy Newsletter February, 2018 - Notes of R 14 25 MAR 2018; (Document filed with Profile of Elizabeth Pearce) Ray

This excellent research gives new evidence re the third wife of Robert Pitt whom he married in England on 2 JUN 1629 - Her name ELIZABETH TOMKINSON - the 3rd of the 3 wives. A sketch of the descendancy:

NOT KNOWN TO HAVE BEEN IN NC

- 1. Robert Pitt and (3rd) Martha Tomkinson
- ↓
- 2. Hester Pitt
- ↓
- 3. Hester Bridges
- ↓
- 4. Patience Williamson
- ↓
- 5. Ann Exon
- ↓
- 6. Ann Westray and Nathan Pearce - Pioneer settlers Franklin Co, NC

The heritage of these 2 shown as 1 → 6 has upchurch relevance in

- a. Elizabeth Pearce and (7) Thomas Ray
- b. John Pearce and (7) Clara U. P/O Richard U, III

These two couples moved to Shelby Co, TN

that the line established is pertinent to the heritage of the children of John & Clara

JOHN

PEARCE

○ EXCERPT from Notes of RPH NC visit 9-23 OCT 2007 - Pg 27
Visit to Benny Foster Perry on 17 OCT 2007 - Input from him

- ⑬ [△] GAY LAND - LANDLOCKED BUT ALWAYS HAD ACCESS
- ⑭ [△] PRIVETTE LAND - OWNERS OF ⑬ & ⑭ MO SISTERS
[△] MINTA & NETTIE PEARCE
- ⑮ LAND OF JOHN PEARCE
- ⑯ LAND OF JACOB PEARCE & BEFORE HIM [△] ACRIL PEARCE
- ⑰ OLD BAKER FARM →
[△] JAMES PERDUE & THEN DEVID ED
- ⑱ [△] ARNOLD LAND - OWNED BY THE WIDOW & 2 CHILDREN
- ⑲ [△] WESLEY B. PERRY CEM (DIED IN CIVIL WAR - VA)

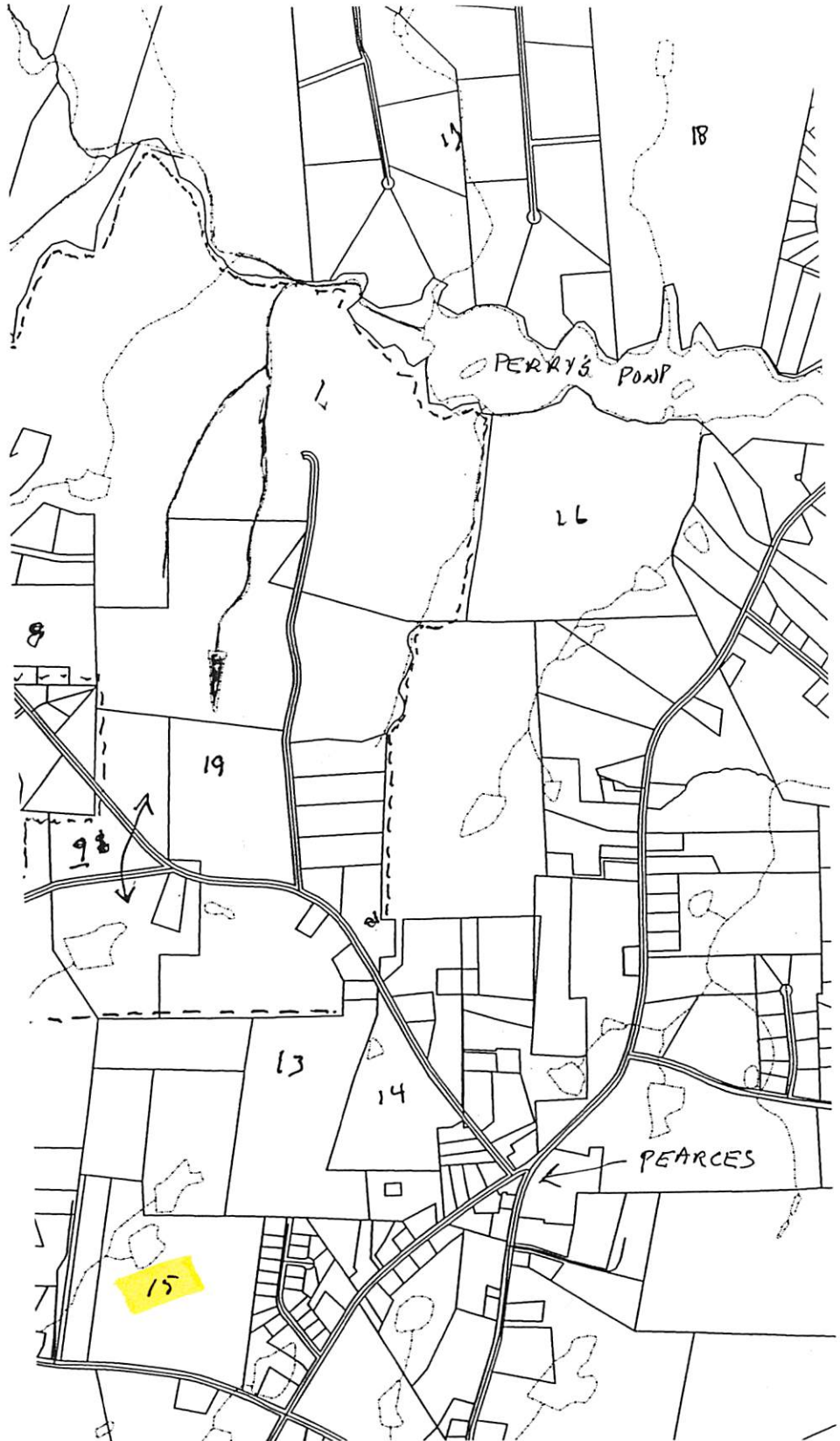

JONN

PEARCE

○ I turn an an Attachment to an email 30 APR 2010 Janet Lyons
Margaret & APU - Residency Court for John Pearce b. 1766 (NC)
who m.d. (2nd) about 1790 to Clara U. measured p/o Richard U., III
P1115 John Pearce

↓
The children
to Clara
1796, 1812,
1816 all
belong to
the R.U., III
Clara U
Subelan
- There
sheet yet
to be
extracted
or if
1 AUG 2010

We are certain that John Pearce/Pierce was Elizabeth Pearce Ray's brother because John gave testimony for her in court for her application for a Revolutionary War Pension, as the widow of Thomas Ray. What is more difficult to document is the path that John Pearce/Pierce took from Wake and Franklin Counties in North Carolina to Shelby Co., IN. In addition, his daughter Martha married Zebedee Ray [R1213], a son of Hutson Ray [R121]. There was a John Pearce in Rowan Co., NC, in the 1820 and 1830 Censuses, but he appears to have been born in about 1790, which would make him too young. The John Pearce in Randolph Co., NC, appears to be part of another Pearce/Pierce family. So, I'm not sure we have located him.

P1115 John Pearce

- B. 1766 North Carolina
- D. 03 January 1845 (age about 77 years) buried Brandywine Center Cemetery, Shelby Co., IN (beside his sister Elizabeth Pearce Ray)
- M1(?) 06 March 1786, Wake Co., NC (bondsman, Isom Sims)
To Saleh Sims
- M2 about 1790 (? Clara Francis Upchurch, 01 December 1808, Franklin Co., NC)
To Clarissa (Clara) _____
- B. 14 October 1764
- D. 04 November 1869 Poweshiek Co., IA

Parents of ?, record of three
Record follows

- P11151 Sarah Pierce (Data from Bev Knoll-Hegstrom, Perry, IA, June 2001 e-mail: BevHegt@aol.com. In the 1850 Census for Jackson, Johnson Co., MO, Sally and Samuel had at least 5 children: Francis A., age 20, born Tennessee; Jacob L. or S., age 20, born Tennessee; Charles and Pleasant R., both male, age 15, and born Missouri; Mary E. age 12, born Missouri; perhaps two more daughters, the wife of A. G. Beard, who was not in the Ferguson household, with children Sarah C Beard, age 7, born Missouri, and Wm P Beard, age 2 born Missouri; also the wife of Samuel Castles, age 33, born Pennsylvania, who was not in the Ferguson household, with children Mary L. Castles, age 6, born Missouri, and Francis, age 1, male, born Missouri)
- B. ca 1796 in Franklin or Randolph Co., NC (1850 Census, Jackson, Johnson Co., MO.)
- D. 06 March 1861 Eliza, Mercer Co., IL
- M. to Samuel Ferguson
- B. ca 1792 Randolph Co., NC
- D. 24 December 1855 Eliza, Mercer Co., IL

P11152 Martha Pierce

- B. 27 February 1812 North Carolina
- D. 30 January 1896
- M. 25 December 1832 (Bible record) Shelby Co., IN
- To Zebedee Ray [R1213] [Son of Hutson [R121] and Margaret (Byerly) Ray]
- Parents of 12 children
- For record, see Zebedee Ray [R1213]

P11153 Sion Pierce (Data from Bev Knoll-Hegstrom, Perry, IA, June 2001 e-mail:

- BevHegt@aol.com)
- B. 25 February 1816 Randolph Co., NC
- D. 04 December 1902 Seely Twp., Guthrie Co., IA
- M. 06 January 1841 Hancock Co., IN
- To Sarah Elin or Ellen Jackson
- B. 24 August 1816 in NC
- D. 27 December 1900 Seely Twp., Guthrie Co., IA

**Parents of 5 children
Record follows**

Sion Pierce

Sion was the third child of John Pearce [P1115] and Clarissa _____. He was born in Randolph Co., NC, and was in Indiana by the 1840s. Later in his live he moved to Iowa.

P11153 Sion Pierce (Data from Bev Knoll-Hegstrom, Perry, IA, June 2001 e-mail: BevHegt@aol.com)

B. 25 February 1816 Randolph Co., NC

D. 04 December 1902 Seely Twp., Guthrie Co., IA

M. 06 January 1841 Hancock Co., IN

To Sarah Elin Jackson

B. 24 August 1816 in NC

D. 27 December 1900 Seely Twp., Guthrie Co., IA

Parents of 5 children

P11153-1 James Albert Pierce

B. 04 December 1842 Hancock Co., IN

D. 02 October 1920 Coon Rapids, Guthrie Co., IA

M. 12 December 1863 Poweshiek Co., IA

To Lavina Marion Brown

B. 28 September 1845 in NY

D. 21 August 1912 Guthrie Co., IA

Parents of 5 children

P11153-11 Ethzelda Pierce (aka Ethie)

D. Aft. 1931 in OK

M. 07 December 1890 Guthrie Co., IA

To John Oscar (Ruks) Rukes

Parents of 1 child

P11153-111 Sylvia Rukes

P11153-12 Emma May Pierce

D. 01 August 1901 in OK

M. 25 December 1890 Guthrie Co., IA

To William Luckinbill

Parents of 1 child

P11153-121 Arley Luckinbill

P11153-13 Henry Oscar Pierce

B. 1869

D. 1950

M. 25 November 1900

To Lydia L. Kester

P11153-14 Ray Clark Pierce

B. 10 February 1873 Guthrie Co., IA

D. 11 August 1953 in Carroll, Carroll Co., IA

M. 25 December 1895 Panora, Guthrie Co., IA

To Maude Amelia Holroyd

B. 26 June 1879 Glidden, Guthrie Co., IA

D. 04 February 1920 Guthrie Co., IA

Parents of 7 children

P11153-141 Perle Bryan Pierce

B. 04 June 1897 Guthrie Co., IA

D. 23 April 1953 Guthrie Co., IA

M. 27 July 1916 Guthrie Co., IA

To Velma Irene Scott

B. 3 March 1899 in IA

D. 27 May 1962 Guthrie Center, Guthrie Co., IA

Parents of 4 children

P11153-1411 Ivan Ray Pierce

B. 02 January 1917 Guthrie Co., IA
M. 14 February 1939
To Ruby Maxine Bull
b. 23 May 1919
Parents of 5 children
P11153-14111 Allen Ray Pierce
B. 10 August 1940
P11153-14112 Bryan Lee Pierce
B. 20 September 1941
P11153-14113 Jerry Dennis Pierce
B. 16 May 1945
P11153-14114 Danny Lynn Pierce
B. 3 December 1948
P11153-14115 Leslie Ivan Pierce
B. 29 November 1955
P11153-1412 Ila May Pierce
B. 26 October 1918 Guthrie Co., IA
M. 20 June 1937 Coon Rapids, Carroll Co. IA
To Charles Tremain Robinson
B. 19 August 1914 Detroit, MI
Parents of 3 children
P11153-14121 Charles Scott Robinson
B. 13 April 1938 Guthrie Co., IA
P11153-14122 Perle Ray Robinson
B. 10 October 1940 Guthrie Co., IA
P11153-14123 Ila Jeannette Robinson
B. 5 June 1941 in Guthrie Co., IA
P11153-1413 Nyal Franklin Pierce
B. 06 April 1920 Guthrie Co., IA
M. 4 June 1944 Guthrie Co., IA
To Beth May Robinson
B. 20 April 1926 Auburn, NY
Parents of 4 children
P11153-14131 Gregory Nyal Pierce
B. 06 November 1944 Jefferson, Greene Co., IA
P11153-14132 Mary Elizabeth Pierce
B. 14 December 1946 Manning, Carroll Co., IA
P11153-14133 Roger Charles Pierce
B. 30 October 1950 Manning, Carroll Co., IA
P11153-14134 Janice Joy Pierce
B. 01 March 1959 Guthrie Center, Guthrie Co., IA
P11153-1414 Hazel Irene Pierce
B. 19 August 1924
P11153-142 Clarence William Pierce
B. 03 March 1899 Guthrie Co., IA
D. 11 August 1962 Des Moines, Polk Co., IA
M. 30 October 1918 Coon Rapids, Carroll Co., IA
To Eve Smouse
B. 09 December 1896 Coon Rapids, Carroll Co., IA/Coon
Rapids, Greene Co., IA
D. 05 January 1962 Indianola, Warren Co., IA
Parents of 6 children
P11153-1421 Warren R Pierce
P11153-1422 Clark A Pierce
P11153-1423 Eugene Pierce
P11153-1424 Leon Pierce

P11153-1425 Lee Pierce
P11153-1426 Evelyn Mae Pierce
B. 20 April 1924 Guthrie Co., IA
D. 11 August 1980
M. to ?? Kenyon

P11153-143 William Lester Pierce
B. 21 February 1902 Guthrie Co., IA
D. 11 June 1989 Stratford, IA
M. 29 August 1929 Guthrie Co., IA
To Cecile Wanita Scott
B. 2 May 1905 Guthrie Co., IA
D. 14 October 1989 Story Co., IA
Parents of 2 children

P11153-1431 Donna Louis Pierce
P11153-1432 Lester Dean Pierce

P11153-144 Daisy Irene Pierce
B. 19 May 1903
M1 to Raymond D. Monroe
Parents of 1 child

P11153-1441 Clarence Leonard Holmes
B. 30 August 1925
D. 17 March 1964
M. to Jeanette ??
M2 16 August 1931 Jefferson, Greene Co., IA
To Chas Holmes
Parents of 1 child

P11153-1442 Clarence Leonard Holmes
B. 30 August 1925
D. 17 March 1964
M. to Jeanette ??

P11153-145 Ethel May Pierce
B. 17 January 1905 Guthrie Co., IA
D. 13 February 1996 Grinnell, Poweshiek Co., IA
M. 30 January 1923 Carroll Co., IA
To Francis Lott Smouse
B. 14 September 1893 Carroll Co., IA
D. 18 April 1967 Des Moines, Polk Co., IA
Parents of 4 children

P11153-1451 Helen Maude Smouse
B. 22 October 1923 Carroll Co., IA
D. 23 February 1999
M1 to Walter C. Crouch
M2 to William H. Knight

P11153-1452 Madaline Smouse
B. 22 March 1926
M. to Richard P. Kemp

P11153-1453 Marvin Lott Smouse
B. 10 December 1929 Audubon Co., IA
M. to Margaret Devilbiss

P11153-1454 Karen Mae Smouse
B. 27 September 1942
M. to Jasper Belcher

P11153-146 Helen Elizabeth Pierce
B. 06 January 1907
M. 17 June 1925 Coon Rapids, IA
To Hans Kallesen

B. 9 February 1896 Guthrie Co., IA
 D. 12 July 1960 Audubon Co., IA
 Parents of 6 children
 P11153-1461 Anna Rosetta Kallesen
 B. 14 November 1928 Guthrie Co., IA
 M. to Earl Hansen
 P11153-1462 Majorie Darlene Kallesen
 B. 05 July 1930 Guthrie Co., IA
 To Ralph Peterson
 P11153-1463 Ethel Delores Kallesen
 B. 8 August 1932
 M. to Jerry Foster
 P11153-1464 Helen Violet Kallesen
 B. 16 September 1934 Guthrie Co., IA
 M. to Jerry Richards
 P11153-1465 Maude Eloise Kallesen
 B. 23 May 1938 Iowa City, IA
 M. to Wayne Wilson
 P11153-1466 Darryl Hans Kallesen
 B. 23 October 1945 Iowa City, IA
 M. to Ann Shlensky
 P11153-147 Velma Grace Pierce
 B. 18 July 1915 Guthrie Co, IA
 M. 04 November 1933 Jefferson, Greene Co., IA
 To Albert Wesley Palmer
 B. 21 November 1911 Guthrie Co., IA
 D. 31 July 1989 Des Moines, Polk Co., IA
 Parents of 3 children
 P11153-1471 Donald Albert Palmer
 B. 30 August 1935 Guthrie Co., IA
 M. 13 October 1956 Auburn, Sac Co., IA
 To Janice Rose Hill
 B. 01 December 1938 Whittemore, Kossuth Co., IA
 D. 12 January 2001 Souix Falls, SD
 Parents of 6 children
 P11153-14711 Donald Alan Palmer
 B. 2 March 1957 Lake City, Calhoun Co., IA
 M. 13 January 1976 LeMars, IA
 To Cheryl ReNee Thelen
 B. 11 September 1958 Le Mars, Plymouth Co., IA
 P11153-14712 David Ray Palmer
 B. 29 March 1958 Belmont, Wright Co., IA
 M. 08 January 1977 LeMars, IA
 To Marilyn Kilker
 B. 2 July 1957 Le Mars, Plymouth Co., IA;
 P11153-14713 Terri Ann Palmer
 B. 18 September 1959 Le Mars, Plymouth Co., IA
 D. 18 September 1959 Le Mars, IA
 P11153-14714 Gerri Ann Palmer
 B. 18 September 1959 Le Mars, Plymouth Co., IA
 D. 18 September 1959 Le Mars, IA
 P11153-14715 Deborah Jeanne Palmer
 B. 29 September 1960 LeMars, Plymouth Co., IA
 M1 11 August 1979 LeMars, Plymouth Co., IA
 To Allen Joseph Kellen

B. 25 December 1957
M2 09 January 1992 Las Vegas, NV
To David Luverne Helmrichs
B. 17 September 1959
M3 07 August 1998
To Duane Sheets
P11153-14716 Dale Edward Palmer
B. 04 January 1963 Le Mars, Plymouth Co., IA
D. 08 November 1969 LeMars, Plymouth Co., IA
P11153-14717 Dean Wesley James Palmer
B. 12 February 1964 LeMars, Plymouth Co., IA
M. 12 March 1983 LeMars, Plymouth Co., IA
To Gail Leslie Koopman
B. 02 October 1964 Hawarden, IA
P11153-1472 Gerald Ray Palmer
B. 07 June 1939 Iowa City, Johnson Co., IA
M. 27 January 1962 Kandiyohi, Kandiyohi Co., MN
To Arlene Frances Terlisner
B. 01 September 1942 Carroll, Carroll Co., IA
Parents of 5 children
P11153-14721 Cheryl Kay Palmer
B. 22 April 1963 Willmar, Kandiyoho Co., MN
M. 03 March 1984 Perry, Dallas Co., IA
To Delbert Dean Moore
B. 18 September 1961 Perry, Dallas Co., IA
P11153-14722 Steven Douglas Palmer
B. 23 May 1964 Willmar, Kandiyoho Co., MN
M. 16 August 1986 Perry, Dallas Co., IA
To Shelley Rae Klug
B. 27 March 1964 Independence, IA
P11153-14723 Patricia Elizabeth Palmer
B. 29 September 1965 Perry, Dallas Co., IA
M. 30 April 1988 Perry, Dallas Co., IA
To Michael Craig Van Cleave
B. December 1959
P11153-14724 Sandra Christina Palmer
B. 18 April 1967 Perry, Dallas Co., IA
M. 25 October 1986 Perry, Dallas Co., IA
To Douglas Duane Stone
B. 23 March 1963 Des Moines, Polk Co., IA
P11153-14725 Brian Ray Palmer
B. 29 August 1968 Perry, Dallas Co., IA
P11153-1473 Rita Maude Palmer
B. 4 June 1942 Guthrie Co., IA
M. 26 June 1960 Greene Co., IA
To Ernest Irving Knoll
B. 4 September 1937 Willow Twp., Greene Co., IA
Parents of 5 children
P11153-14731 Beverly Elaine Knoll
B. 02 May 1961 Manning, Carroll Co., IA
M. 30 May 1981 Dawson, Dallas Co., IA
To Brent Dean Hegstrom
B. 02 May 1957 Perry, Dallas Co., IA
P11153-14732 Phillip Eugene Knoll
B. 06 May 1962 Carroll, Carroll Co., IA
M. 22 February 1984 Perry, Dallas Co., IA

To Debra Lynn Eades
B. 18 January 1960
P11153-14733 Connie Marie Knoll
B. 26 July 1965 Jefferson, Greene Co., IA
M. 13 August 1986 Perry, Dallas Co., IA
To Micheal Joe Smothers
P11153-14734 Keith Allen Knoll
B. 14 November 1967 Perry, Dallas Co., IA
P11153-14735 Annette Denise Knoll
B. 03 March 1970 Perry, Dallas Co., IA
P11153-15 James Emmett Pierce
B. 09 February 1878 Witchita Twp, Guthrie Co., IA
D. 02 June 1942 Witchita Twp , Guthrie Co., IA
P11153-2 Elizabeth Pierce
B. 1845 Hancock Co., IN
M. to Thomas Johnson
P11153-3 Tilman Howard Pierce
B. 1848 in Indiana
D. 26 February 1936 Guthrie Co., IA
M. to Elizabeth Ann Dowdell
P11153-4 John Franklin Pierce
B. 14 March 1854 (?) Mercer Co., IL
D. 11 March 1867 Jefferson Twp., Poweshiek Co., IA
P11153-5 Anna (Areena) Pierce
B. 1857
M. to ?? Lookhart

JOHN

PEARCE

○ From Book: Nash & Ray Families 2ND ED. 1997. Abstracts
of Ray & Pearce Records Examined by Aultman
FRANKLIN CO., NC Pgs 948, 949, 950, 951

Γ John Pearce m'd Clara U d/o Richard U, III

The RAY part of the Book is about Elizabeth Pearce (sister
of John) who m'd Thomas Ray - Rev. Soldier. The two
couple left the Moccasin Creek Area of NC & moved
to Rutherford Co, NC → Rowan Co, NC → Shelby Co., IN

1794 March 15, Deed Book 1, p. 272. (repeated) Elisha Strickland of Wake Co., NC, sold 300a
on Turkey Creek to William Morgan of Nash Co., NC, for 30 pounds. Bounded: Bryant's
corner. Signed Elisha Strickland. Witnesses: Richard Upchurch, John (X) Pearce, and
Jonathan (X) Upchurch. Proved March Term 1797. (1)

Γ RPU Note - This seems to be my first encounter with Jonathan
U. - If he had to be 18 to be a witness he would
have been born 1776 or earlier - hence probably a G-5/p
Richard U, II. - 27 JUL 2010

○ From Book: Nath & Ray Families 2ND ED. 1997. Abstracts
of Ray & Pearce Records Examined by Arthur
FRANKLIN CO., NC Pgs 948, 949, 950, 951

┌ John Pearce m'd (d) Clara U D/o Richard U, III
The RAY part of the Book is about Elizabeth Pearce (sister
of John) who m'd Thomas Ray - Rev. Soldier. The two
couple left the Moccasin Creek Area of NC & moved
to Rutherford Co, NC → Rowan Co, NC → Shelby Co., IN

1794 January 15, Deed Book 10, pg. 164. Philip Pearce, Stephen Pearce, and John Pearce
of Franklin Co., NC, sold 47a on Spring Branch to Arter Pearce of Franklin Co., NC,
for 10 pounds. Bounded: Moses Upchurch and John Pearce. Signed Phillip Pearce,
Stephen Pearce, and John Pearce. Witnesses: Moses Upchurch and Thomas Gay. (2)

RPH NOTE - 27 JUL 2010 - The four Pearce men are presumably
brothers. Siblings James Pearce & Elizabeth Pearce not
mentioned. All children of Nathan Pearce b 1735 - d FC, NC 1771

1794 February 14, Deed Book 10, p. 165. Deed 1340. Philip Pearce, Steven Pearce, and
Arthur Pearce of Franklin Co., NC, sold 160a to John Pearce of same for 50 pounds.
Bounded: Thomas Gay and Moses Upchurch. Witnesses: Moses Upchurch and Thomas
Gay. (2)

JOHN

PEARCE

○ From Book: Wail & Ray Families, 2ND Ed. 1997 - Abstracts
of Ray & Pearce Records Examined by Authors
RANDOLPH CO., NC - Pg 960 & 962.

- 1802 1(?) October, Deed Book 8, p. 344. Deed (Indenture). **John Ray** bought 91a from Jacob Hoover of Randolph Co., NC, for \$395.00 (?). The land is part of Philip Byerly's old survey on a branch of the **Ubase** (?). Registered August Term 1803. □
- 1815 Tax Lists. In Capt. **Rush's** Dist. **Thomas Pierce**, **Ansel Pierce**, **John Pierce** (A.P. and J.P. listed together), **John Wray**, **Thomas Wray**, **Hutson Wray** (J.W., T.W., and H.W. listed together), and **James Wray** (J.W. on same page as other Wrays. Pierces are one page earlier.). (7) □

JOHN

PEARCE

○ From Book: Nair & Ray Families 2ND ED. 1997. Abstracts
of Ray & Pearce Records Examined by Author
FRANKLIN CO, NC Pgs 948, 949, 950, 951

† John Pearce m(d) Clara W D/o Richard U, III

The RAY part of the Book is about Elizabeth Pearce (Sister
of John) who m(d) Thomas Ray - Rev Soldier. The two
couple left the Moccasin Creek Area of NC & moved
to Rutherford Co, NC → Rowan Co, NC → Shelby Co., IN

1795 November 15, Deed Book 1, p. 233. John Peirce sold 50a on Morris' Branch to Jubel
Upchurch (both of Franklin Co., NC) for 30 pounds. Bounded: on Benjamin Arnals' (sic)
line where John Peirce formerly lived. Signed John (X) Pierce. Witnesses: John
Carpenter, Jurat, and Charity (X) Mazy. Proved December Term 1795. (1)

○ From Book: Nail & Ray Families 2ND ED. 1997. Abstracts
of Ray & Pearce Records Examined by Aulhane
FRANKLIN CO, NC Pgs 948, 949, 950, 951

↑ John Pearce m'd Clara U D/o Richard U, III
The RAY part of the Book is about Elizabeth Pearce (Sister
of John) who m'd Thomas Ray - Rev Soldier. The two
couple left the Mecklenburg Area of NC & moved
to Rutherford Co, NC → Rowan Co, NC → Shelby Co., IN

1794 March term, County Court Minutes (original), p. 398(?). The Last Will and Testament of
James Peirce was exhibited and proved by Benjamin Wheeler and Moses Upchurch, two
of the subscribing witnesses thereto and on M.O.R. and at the same time Thomas Ray
qualified as executor thereto and returned an inventory of the estate of oath (?work)
M.O.R. Ordered that the executor of James Peirce sell such part of the parishable estate
as he thinks necessary and make report to the next court.

1794 March 24, Will Book A. p. 174. Sale of estate of James Pirce, dec'd. Buyers on 24
March 1794 were Mary Pirce, James Sanders, Dred Jones, James Butler, Richard Pirce,
and John Crawley. Buyers on 20 December 1794 were Mary Pirce, William Parish, Elisha
Strickland, Adam Barn, John Pirce, James Bud Lee, Benjamin Upchurch, Wille Garris,
Daniel Bagwell, Joshua Cane, John Martin, Dred Wheeler, Jacob Strickland, Hardy
Griffin, William Dunn, James Bolton, Benjamin Wheeler, Philip Pirce, and Charles
Upchurch. Thomas (R) Ray, Admr. (7)

1794 March term, County Court Minutes (original), p. 399(?). Thomas Ray was appointed
guardian to Beady Pierce, Betsy Pierce, Penny Pierce, Patsy Pierce, and Willie Pierce,
orphans of James Pierce, dec'd. Bond was 500 pounds with Richard Upchurch and
Benjamin Wheeler, his securities.

JOHN
b ABY 1766

PEARCE

DEED:

FRANKLIN CO, NC

15 MAR 1794

DEED BK 8 PG 216 [Mentioned in Reference 41 Pg 23]

Esther Strickland to William Morgan
(of Wake Co, NC) (of Nash Co, NC)
[WILLIAM MORGAN]

300 Acres on Turkey Creek in Franklin Co, NC

Adjoins: County line
— Bryant

Witness: Richard U
John Pearce
Kinchen Upchurch

[NOTE: The dates would fit for either John Pearce
to be John Pearce b. 1766 - RPK 30 JUL 2007]

obtained by RPK &
John Lee U, Jr. on
15 OCT 1990

○ RPU Thoughts about tricky UPCHURCH - PEARCE - RAY RELATIONS
 - REFERENCE NATL & RAY FAMILIES 2ND ED AND RPU RECORDS
 - BY RPU 26 JUL 2010

- I. Nathan Pearce, I b 9 JUL 1735 - He + 5 Sons + 1 Daughter of Franklin Co., NC - Moccasin Creek Area 1775±
- △ A. Elizabeth Pearce b About 1767 } to Randolph Co., NC } NO U
 m d () Thomas Ray b About 1762 } and then to Shelby } HERE-
 Co., IN } TAGE
- △ B. Philip Pearce b 24 JUL 1791
- △ 1. John Pearce, II. b 12 NOV 1787 () d () (Ben Family Cem
 3 miles SW of Payson Springs Baptist Church, Franklin Co., NC
 m d () - - - - - UPCHURCH - Possibly the Frances
 U who m d 1 DEC 1808 (FC, NC) John Pearce - She
 is possibly D/o Benjamin U.
- △ C. John Pearce, I b About 1766 () d (Shelby Co., IN)
 m d () Clara U (Clarice) D/o Richard U, III

• There seems to be little doubt that John Pearce who lived close to his sister Elizabeth (Pearce) Ray in Randolph Co., NC was the John who married the only daughter of Richard U, III who died intestate in FC, NC in 1816. His son-in-law John Pearce + his wife drew lot #1 of 28 Acres (Need to find where John sold this). A clincher is that John Pearce in Randolph Co., NC appeared WILLIAM RHEA in FC, NC to recover his right to a portion of the estate of Richard U, III.

- The records from IN show the wife of John Pearce b 1766 was "CLARISE" hence CLARA.
- The children of Richard U, III were born from 1774 to 1795 with a daughter born in 1793. Richard U, III m d 2nd 14 SEP 1796 (FC, NC). His young son show up in his name on the 1800 census but no young daughter b 1793. Perhaps she was staying with relatives.??
- In the 1790-1810 era it is unlikely you would find a female with her name CLARA & FANNES
- On balance I am inclined to say that the 1808 marriage was for John Pearce b 1787 and Frances U possible D/o Benjamin U - NOT for John Pearce b 1766 and Clara U

JONN

PEARCE

DEED:

FRANKLIN CO, NC

24 OCT 1799

DEED BK 3 PG 82

reborned by RPA

& John Lee U, Jr

on 15 OCT 1990

William Martin to Robert Parish
[ROBERT PARRISH]

255 Acres (355?)

Adjoining:

John Pearce

— Morgan

County line

— Massey

Witnesses:

John Carpenter

Benj. Upchurch

March Term 1807 = proved

~~ed~~ - John Carpenter

South side of Tar Pines
& on waters of Turkey
Creek

wolf Harber Grants;

Piney Prong;

Spring Branch

NOTE: The dates would fit for this John Pearce to
be John Pearce to ADT 1766 RPA 30 JUL 2007)

JOHN

PEARCE

○ For Addition to BIOFILES OF JOHN PEARCE b 1766 and
CLARA FRANCES U. D/O RICHARD U., III - Presumed IN & W

A. In Ltr 23 APR 2010 RPU wrote to Janet Ray

"John Pearce b. 1766 md 1808 (FC, NC) Clara Frances U.
They moved to IN. Clara in the light of have been
a G/O Richard U., II"

B. Email 26 APR 2010 - Janet Ray to RPU

Dear Phil,

I had one of those "ah-ha" moments when I read your letter dated 23 April 2010. Your Upchurch/Nail-Ray collaboration is paying off for Nail-Ray.

So, my John Pearce ~~Pierce~~ married Clara Frances Upchurch in 1808 in Franklin Co., NC! I had not made the connection because I've had initially assumed that John went to Randolph Co., NC, shortly after he married Selah Sims on 06 March 1786 in Wake Co., NC, but when John showed up in Indiana he was married to Clara/Claisa (last name unknown). Clara Francis Upchurch would fit though because his two youngest children were born after 1808—Martha in 1812 and Sion in 1816. The birth date that her family has for Clara is 14 October 1764 and the 1850 Census in Shelby Co., IN, has that she was born in Virginia and the 1860 Census in Jefferson, Poweshiek Co., IA, has North Carolina. She died 04 November 1869 and was buried in Poweshiek Co., IA. She was 50-ish when she had her two youngest children—which might/would/could be explained by her being married in only 1808. (John's oldest daughter, Sarah who was born about 1792 in North Carolina, would then have been his child with his first wife Selah Sims.) Okay, that works for me!

Phil, Bev Knoll-Hegstrom, Bethany Roberts, and Carol Masse are descendants of Clara's daughter Martha Peirce who married Zebedee Ray (grandson of Thomas Ray of Franklin and Wake Co., NC). Please fill us in on Clara's Upchurch ancestors!

Best regards,

Janet

C. Email 30 APR 2010 - RPU to Janet

Hi Janet---

With your message in hand it appears we may have the option of doing some digging to get a few things straight. Note that the attachment to my 23 APR 2010 letter to you states that the 1808 marriage of John Pearce b. 1766 was to an Upchurch lady presumed to be the GD/O Richard Upchurch, II, called by various names—Clara Frances U., Frances A. U, and Frances U. My feeling is that there are two ladies here, one a daughter of Benjamin U and one a daughter of Richard U., III. Both of these first cousin females married a Pearce. As I study the matter I am now unsure which Frances married which Pearce. One of the husbands was John Pearce b. 1766 he being the son of Nathan Pearce, I b. 1735 and being the brother of the Elizabeth Pearce who married your Thomas Ray. The other husband was John Pearce, II b. 1787, son of Phillip Pearce b. 1754.

One of the couples stayed in NC and I have a large collection of descendants of this couple the uncertainty of the parentage of both husband and wife notwithstanding.

The other couple moved to IN and it is from this couple that a daughter Martha Pierce appeared and for whom you have contact with living descendants. I am assuming that you or they have good records for this family. If I can be provided with an outline of this family I will study it going backwards to see if I can get to the point where we begin to learn more about the two couples and their parentage. If you have all ready sent what I request just give me a clue and I will go over the data.

I feel we may be close to peeling back a few pages of history. If my comments above need to be set straight in any way please let me know.

Please be patient with me as I have two major out-of-state trips planned between now and June 15 and that always clutters mind and desk.

Phil Upchurch

JOHN

PEARCE, I

FROM NAIL-RAY ASSOCIATION NEWSLETTER - SEP 2011 - RPU 16 NOV 2011

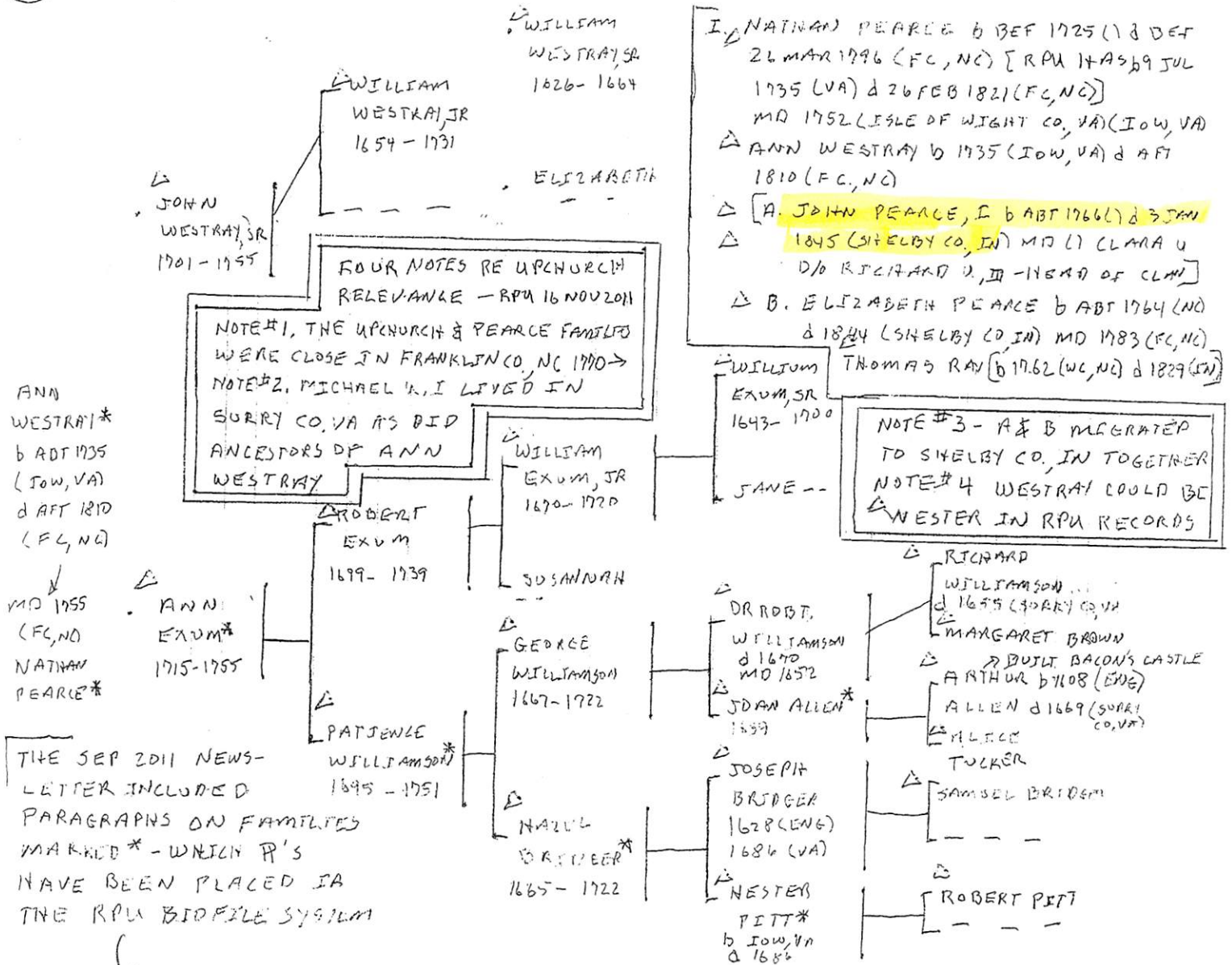

THE SEP 2011 NEWS-LETTER INCLUDED PARAGRAPHS ON FAMILIES MARKED * - WHICH R'S HAVE BEEN PLACED IN THE RPU BIOFILE SYSTEM

PEARCE FAMILY. Elizabeth Pearce and Thomas Ray were married in 1783, Franklin Co., NC. Elizabeth was born abt 1764 NC, died 1844 Shelby Co., IN. She was the mother of seven children: Hutson, James, Gilly, Susannah, Martha, Sarah, Chaney. Elizabeth was a daughter of Nathan Pearce and Ann Westray, who were married abt 1752, Isle of Wight Co., VA (IoW, VA). Nathan was born bef. 1725 (21 yrs bef. 1746 first land record) d bef. 26 Mar 1796, Franklin Co., NC. Nathan was a son of Phillip Pearce and Sarah (---). Phillip was born bef. 1663 (21 yrs bef. 1684 first record; gift of land from father) died 1728 IoW, VA. Phillip was a son of George Pearce and Anne (---). George was born bef. 1648 (21 yrs bef. first record as Nansmond smith, 1669) died bef. 09 Apr 1705 IoW, VA. George was possibly a son or brother of John Pearce born bef. 1645 (21 yrs bef. 1666 records). George Pearce received four patents, totaling 3100 acres: one in 1674 for 2100 acres, one in 1681 for 2500 acres (including the 2100 acres in the 1674 patent plus an additional 400 acres), another one in 1681 for another 400 acres, and one in 1701 for 200 acres.

JOHN PIERCE

① Per Attach #27B West St. 18 MAY 1975 - Conveyance Franklin Co NC

" 1795 Jubal U from John Pierce 30 lbs - 50 acres
lying Manumie's land on Budgets Annuals line,
plantation on which John Pierce formerly lived.
With John Carpenter (Jurat), Charley & Mosey.
Signed John Pierce Dec Ct 1795 Book 8 Pg 176. "

② Per Attach #24 West St. 18 MAY 1975 - Conveyance Franklin Co NC

A. " 1795. Jubal U from - John Pierce - Bk A. Pg 233 "

B. " 1799 Richard U Jr - from John Pierce Bk 9 Pg 104 "

- Extract of Elizabeths Pearce to AHT 1767 (FC, NC) Application for Pension based on service of Husband [△] Thomas Ray to AHT 1762 (WC, NC) service in Revolution. Copy of 4 page application placed in Profiles of Elizabeth & Thomas & in RAY FAMILY FILE - Revolution.

On 9 MAY 1842 Elizabeth at age 75 or 76 living in Address TWP, Shelby Co, IN with son James & Hudson gave testimony to support her application. In 1842 6 of 7 ch living she mtd Tomm early 1782 at age 16 by [△]TANNER ALFORD. They moved to Randolph Co, NC then to Rowan Co, NC then in 1822 to Indiana

Thomas lived on his father's (William Ray, Sr) large farm in Wake Co, NC on Moccasin Creek. Elizabeths lived just across creek with her father [William Pearce, I b 1750 1735] Starting in 1799 Thomas served 5 three month enlistments one of which was as a substitute for [△]JACOB WHEELER Charles & Hudson, brothers of Thomas, died in service others who served:

- | | | |
|----------------------|-----------------------|------------------|
| △ John Seagraves, Sr | △ John Seagraves, Jr | △ Daniel Ray |
| △ Jesse Bunn [BUNN] | △ John Pearce | △ Wm Wheeler |
| △ Philbert Pearce | △ John Sanders | △ Thomas Sanders |
| △ Alexander Tomblen | △ Anderson NUNEAT | △ Richard Pearce |
| △ James Pearce | △ Joseph PARR [PERRY] | |

On 18 MAY 1842 John Pierce, brother of Elizabeth added more names of those who served:

- | | | |
|--------------------|------------------|-------------------|
| △ Shadrach Medlen | △ John Bainwater | △ Roger CRAIG |
| △ Anderson Jackson | △ John Martin | △ Starling Cooper |

JOHN

PEARCE

○ Added inputs from Janet (Morgan) Ross re the 2 Franklin Co, NC couple who moved from Franklin Co, NC to Indiana - burial at RPU 14 MAR 2017 - A = 8:55 AM; B = 10:39 AM

A The mystery of John Pearce is still fairly unsolved. We know that Elizabeth had a brother John, who is buried next to her in Indiana (and so we know his death date). We know his approximate birth date from his deposition for Elizabeth's Revolutionary War Pension Application, and we know he had a daughter Martha who married Zebedee Ray, son of Hutson Ray and grandson of Elizabeth Pearce and Thomas Ray. Other information is softer.

B As for John Pearce, there is a possibly good candidate for a or the son of John Pearce who lived in a nearby county to Shelby Co., IN. One problem with that that man is that Y-DNA from one of his descendants does not match that of men from the Phillip Pearce family. Also, his mother was named Clarissa and a Find-A-Grave post says her maiden name was Jones. So, more work needs to be done there to connect dots, and I've not been interested in researching that family. I've tried to get descendants of Zebedee Ray and Martha Pearce to take the Family Finder test and will keep nudging them. If they have more matches with Upchurch families than others in the Nail-Ray family have, I think that would be supportive evidence that Martha's mother was an Upchurch. Sigh.

I. Nathan Pearce 1725 - 1796

A. Elizabeth Pearce and Thomas Ray

1. Hutson Ray

a. Zebedee Ray ←

Δ B. John Pearce

Δ mact Clara/Clarissa U - presumed
D/o Richard U, III.

Δ 1. Martha Pearce

and L. Zebedee Ray ←

a. A candidate son lived near Shelby Co, IN & his mother was Clarissa & she was nee Jones